

Please show the property lines to demonstrate compliance with:
 LDC 6.2.3.B.e. Measurement at Property Boundaries. Light levels measured at the property line of the development site adjacent to residential property or public right of way shall not exceed 0.1 foot candles as a direct result of the on-site lighting. All light fixtures mounted within 15' of any residential property line of the site shall be classified as IES Type II or Type III, or fixture demonstrated to provide similar distribution patterns and shielding properties. Fixtures shall be fitted with "house side shield" reflectors on the sides facing the residential property line.

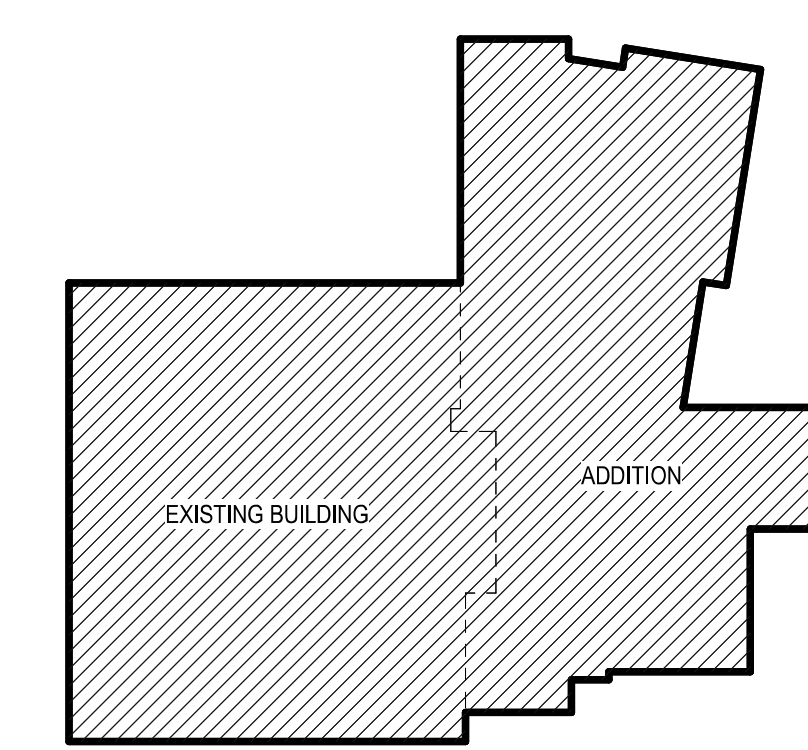

KEY PLAN

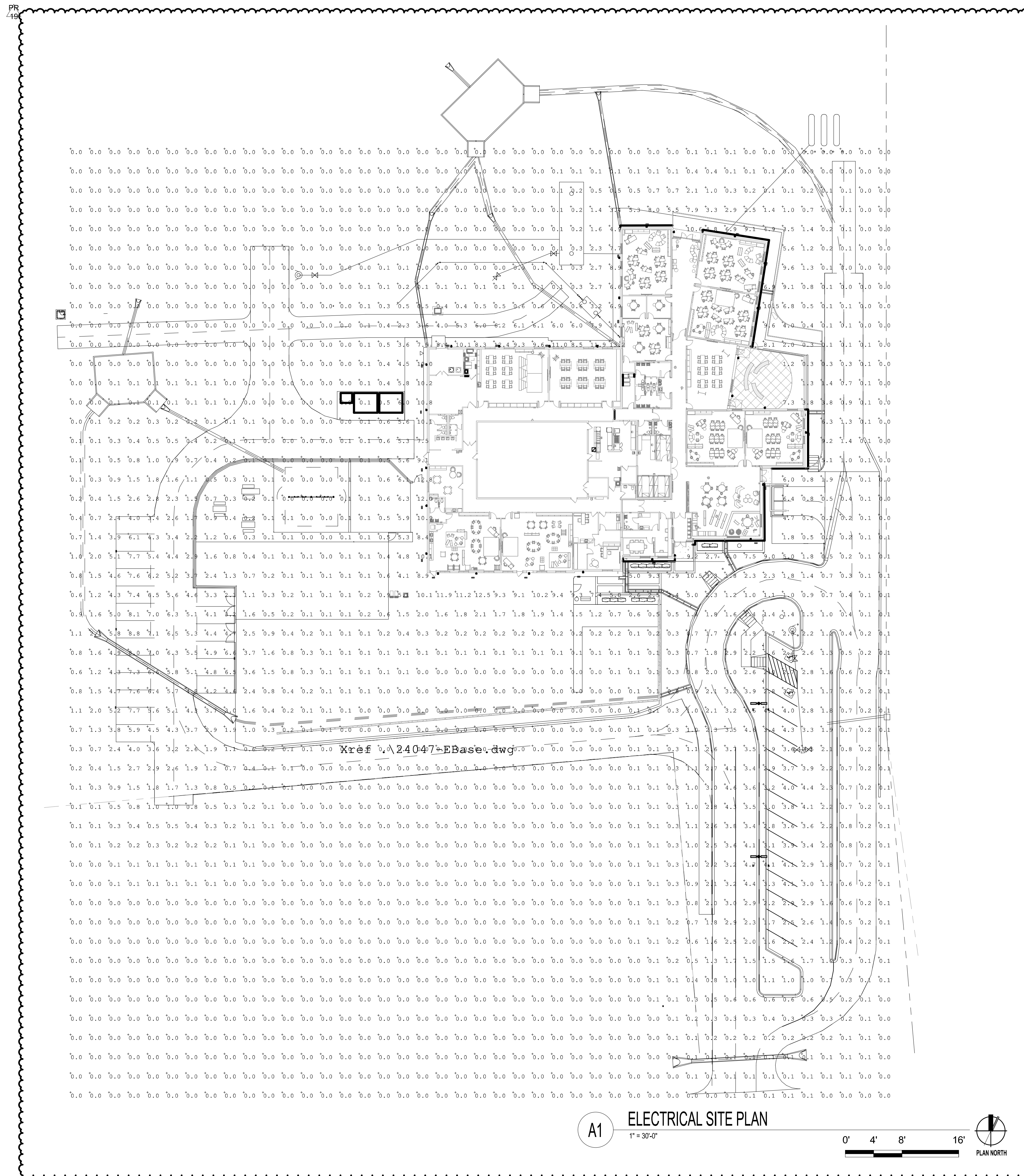
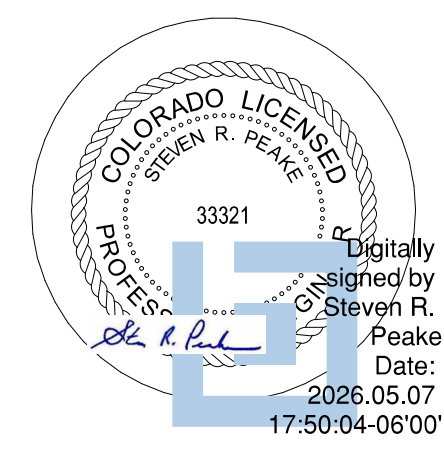

REVISION	DATE
CONSTRUCTION DOCUMENTS	
Project Number	024159.00
Date	MARCH 14, 2025
Drawn By	ESD
Checked By	SMF
Copyright:	
ALL DRAWN AND WRITTEN INFORMATION APPEARING HEREIN SHALL NOT BE DUPLICATED, DISCLOSED OR OTHERWISE USED WITHOUT THE WRITTEN CONSENT OF MOA ARCHITECTURE	

Sheet Name
 ELECTRICAL SITE PLAN
 PHOTOMETRICS

ES102