

Planning and Community Development  
2880 International Cir. Suite 110  
Colorado Springs, CO 80910

FIRST-CLASS



US POSTAGE  
ZIP 80910  
02 7H  
0001332609  
JUN 11 2025



Cinco Land & Exploration, Inc  
8811 Gaylord Drive  
HOUSTON, TX 77024

-R-T-S- 770244004-1N 009 07/10/25

RETURN TO SENDER  
INSUFFICIENT ADDRESS  
UNABLE TO FORWARD  
RETURN TO SENDER

NOTI

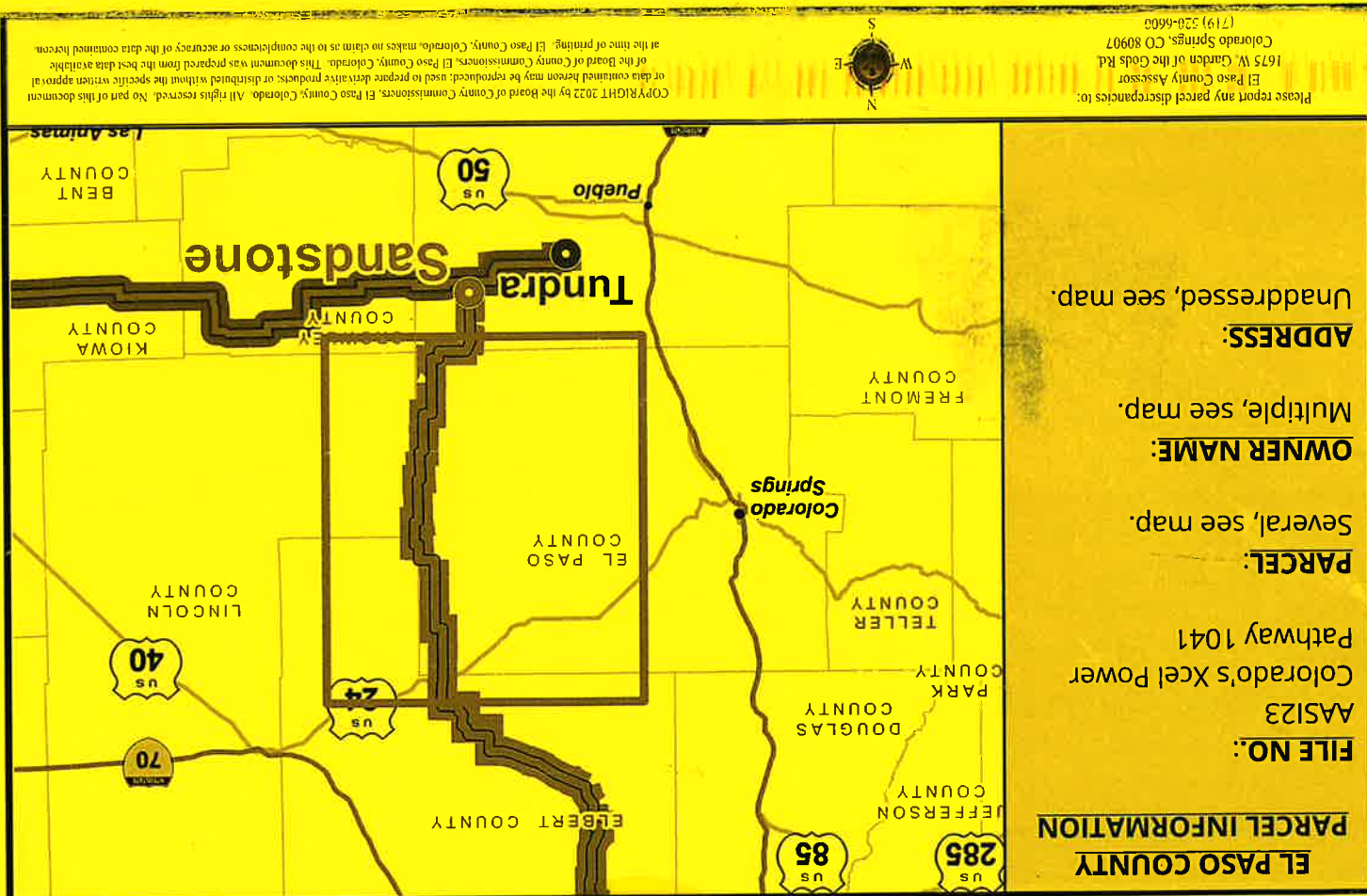

Planning and Community Development  
2880 International Cir. Suite 110  
Colorado Springs, CO 80910

DENVER CO 802

21 JUN 2025 PM 6 L

FIRST CLASS



US POSTAGE PITNEY BOWES

ZIP 80910  
02 7H  
0001332609

\$ 000.69  
JUN 20 2025

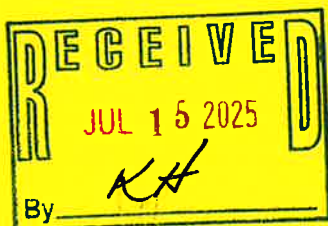

Handwritten signature 'VTH'.

Star Ridge Resources, LLC  
PO Box 98  
SEWICKLEY, PA 15143

Handwritten 'ANK?'.

NOTICE OF PUBLIC UTILITY

NIXIE 152 FE 1 6007/08/25

RETURN TO SENDER  
NOT DELIVERABLE AS ADDRESSED  
UNABLE TO FORWARD

ECI: 80910314835 \*0596-06812-08-31

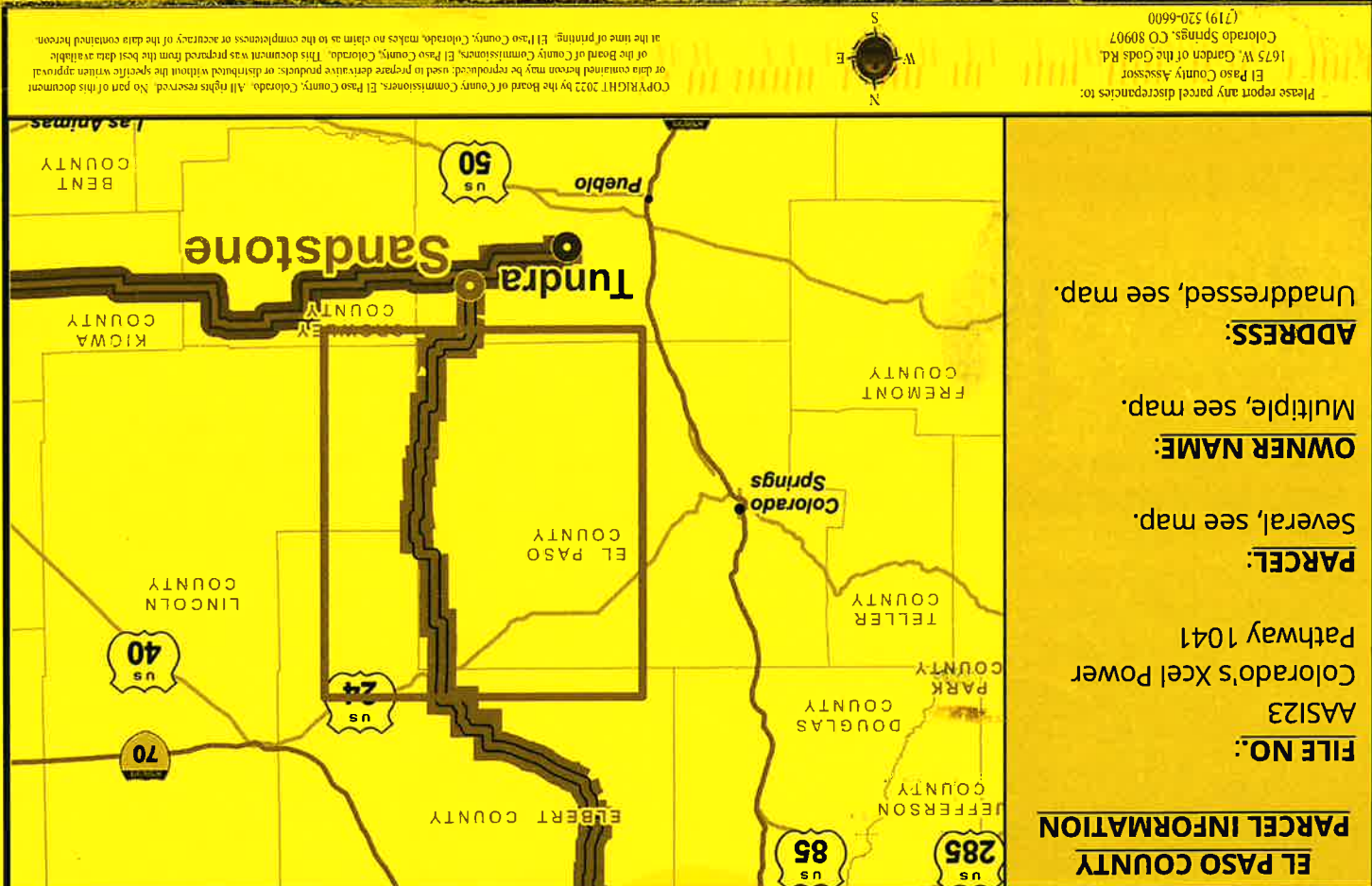



Planning and Community Development  
2880 International Cir. Suite 110  
Colorado Springs, CO 80910

DENVER CO 802

21 JUN 2025 PM 4:21

FIRST-CLASS



US POSTAGE PAID PITNEY BOWES

ZIP 80910  
02 7H  
0001332609

\$ 000.69<sup>0</sup>

JUN 20 2025



**NO SUCH  
STREET**

Carolyn Cummings  
10846 W. Berry Ave  
ENGLEWOOD, CO 80110

NSS

## NOTICE OF PUBLIC HEARING

80111-387246

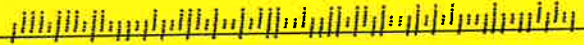

<p><small>COPYRIGHT 2022 by the Board of County Commissioners, El Paso County, Colorado. All rights reserved. No part of this document or data contained herein may be reproduced, used to prepare derivative products, or distributed without the specific written approval of the Board of County Commissioners, El Paso County, Colorado. This document was prepared from the best data available at the time of printing. El Paso County, Colorado, makes no claim as to the completeness or accuracy of the data contained herein.</small></p> <p>Las Animas</p>		<p>Please report any parcel discrepancies to: El Paso County Assessor 1675 W. Garden of the Gods Rd. Colorado Springs, CO 80907 (719) 520-6600</p>	
<p><b>EL PASO COUNTY</b></p>		<p><b>PARCEL INFORMATION</b></p>	
<p><b>FILE NO.:</b></p>		<p>AAS123</p>	
<p><b>OWNER NAME:</b></p>		<p>Colorado's Xcel Power</p>	
<p><b>PARCEL:</b></p>		<p>Pathway 1041</p>	
<p><b>ADDRESS:</b></p>		<p>Unaddressed, see map.</p>	