

SITE DEVELOPMENT PLAN THE ROCK COMMERCE CENTER

A PORTION OF THE SOUTHWEST QUARTER OF THE NORTHWEST QUARTER OF SECTION 11,
TOWNSHIP 11 SOUTH, RANGE 67 WEST OF THE SIXTH PRINCIPAL MERIDIAN,
COUNTY OF EL PASO, STATE OF COLORADO

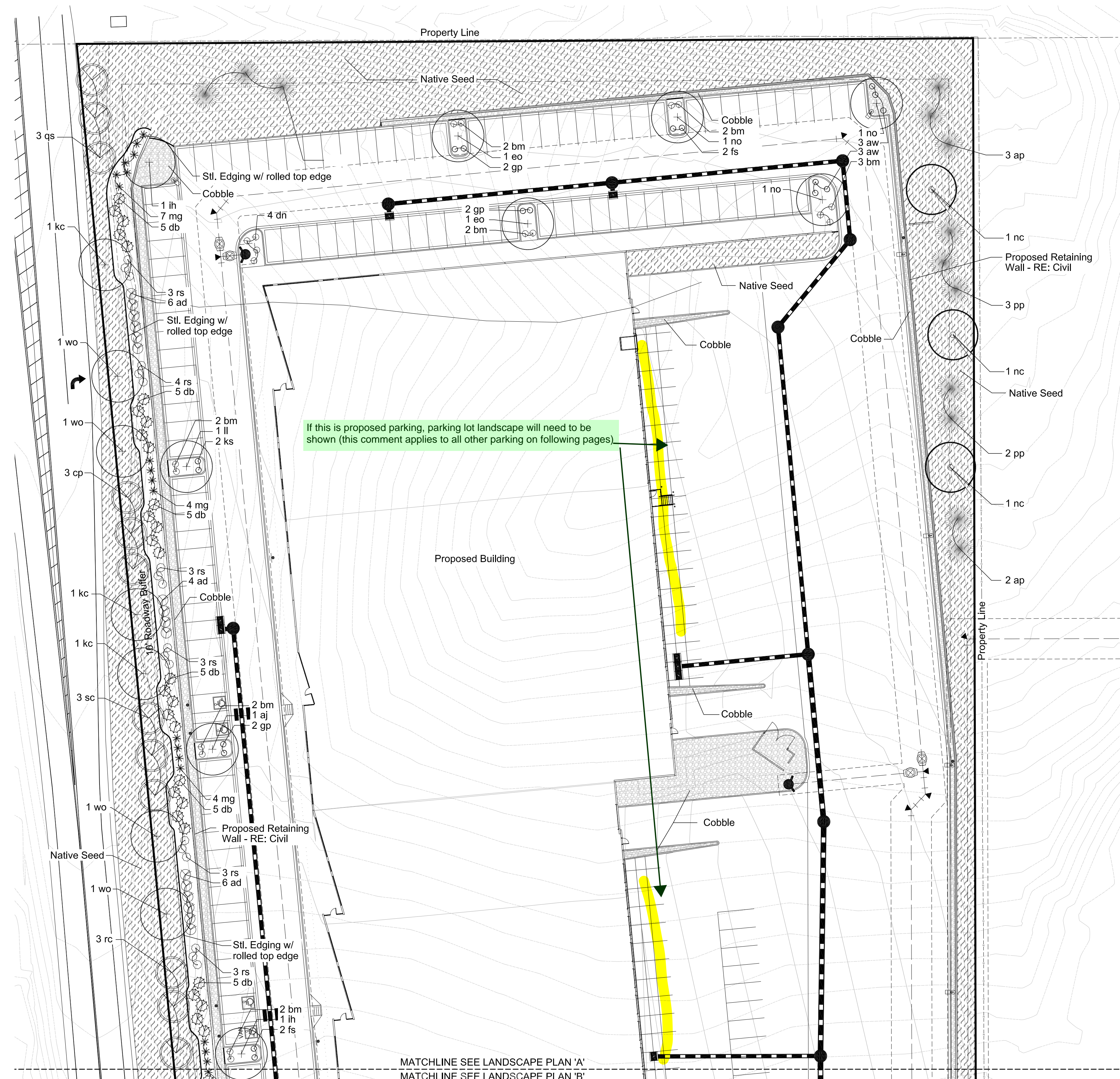

LANDSCAPE LEGEND:

- DECIDUOUS TREE
- ORNAMENTAL TREE
- EVERGREEN TREE
- SHRUB
- ORNAMENTAL GRASS / PERENNIAL

NATIVE SEED MIX NON-IRRIGATED		% OF TOTAL	PLS PER ACRE
COMMON NAME	SCIENTIFIC NAME	TOTAL	ACRE
BLUE GRAMA	BOUTELOUA GRACILIS	25%	1.8 LBS.
SAND DROPSEED	SPOROBOLUS CRYPTANDRUS	20%	0.20 LBS.
SIDEOATS GRAMA	BOUTELOUA CURTIPENDULA	20%	6.3 LBS.
WESTERN WHEATGRASS	PASCOPYRUM SMITHII	15%	8.2 LBS.
BUFFALO GRASS	BOUTELOUA DACTYLOIDES	10%	10.7 LBS.
INLAND SALTGRASS	DISTICHLIS SPICATA	1%	0.60 LBS.
PASTURE SAGE	ARTEMISIA FRIGIDA	1%	0.01 LBS.
BLANKET FLOWER	GAILLARDIA ARTISTATA	1%	0.5 LBS.
PRAIRIE CONEFLOWER	RATIBIDA COLUMNIFERA	1%	0.1 LBS.
PURPLE PRAIRIECLOVER	DALEA PURPUREA	1%	0.3 LBS.
BLUE FLAX	LINUM LEWISII	1%	0.4 LBS.

DETENTION SEED MIX		% OF TOTAL	PLS PER ACRE
COMMON NAME	SCIENTIFIC NAME	TOTAL	ACRE
BLUE GRAMA	BOUTELOUA GRACILIS	20%	1.5 LBS.
SAND DROPSEED	SPOROBOLUS CRYPTANDRUS	20%	0.20 LBS.
SWITCHGRASS	PANICUM VIRGATUM	20%	3.2 LBS.
SIDEOATS GRAMA	BOUTELOUA CURTIPENDULA	15%	4.7 LBS.
WESTERN WHEATGRASS	PASCOPYRUM SMITHII	10%	5.5 LBS.
GREEN NEEDLEGRASS	NASELLA VIRIDULA	10%	3.3 LBS.

- 4"-8" ROUND COBBLE OVER FILTER FABRIC
- NON-HATCH PLANTING AREAS
- 2"-4" ROUND COBBLE OVER FILTER FABRIC
- STEEL EDGING w/ ROLLED TOP EDGE
- RETAINING WALL - RE: CIVIL

LANDSCAPE PLAN 'A'

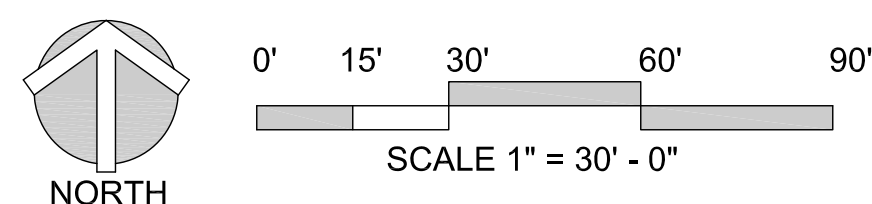

STACKlot
5639 SOUTH CURTICE STREET
LITTLETON, COLORADO 80120
phone. 303.808.4523

CITY FILE NO: #####

REVISIONS	DESCRIPTION
BY	DATE

DRAWN: sdw
CHECKED: jah
DESIGNED: sdw
FILENAME:

SITE DEVELOPMENT PLAN
THE ROCK COMMERCE CENTER
LANDSCAPE PLAN 'A'

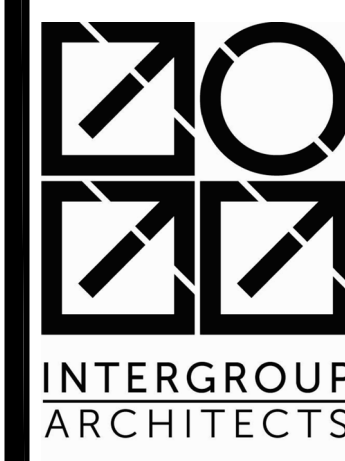

architecture
planning
interiors
2000 West Littleton Blvd
Littleton, Colorado 80120
P: 303.758.8877 F: 303.758.2294
www.igarch.com

JOB NO.
SCALE: AS SHOWN
DATE: 07/28/2023
SHEETS: 24 SHEET: 13

SITE DEVELOPMENT PLAN THE ROCK COMMERCE CENTER

A PORTION OF THE SOUTHWEST QUARTER OF THE NORTHWEST QUARTER OF SECTION 11,
TOWNSHIP 11 SOUTH, RANGE 67 WEST OF THE SIXTH PRINCIPAL MERIDIAN,
COUNTY OF EL PASO, STATE OF COLORADO

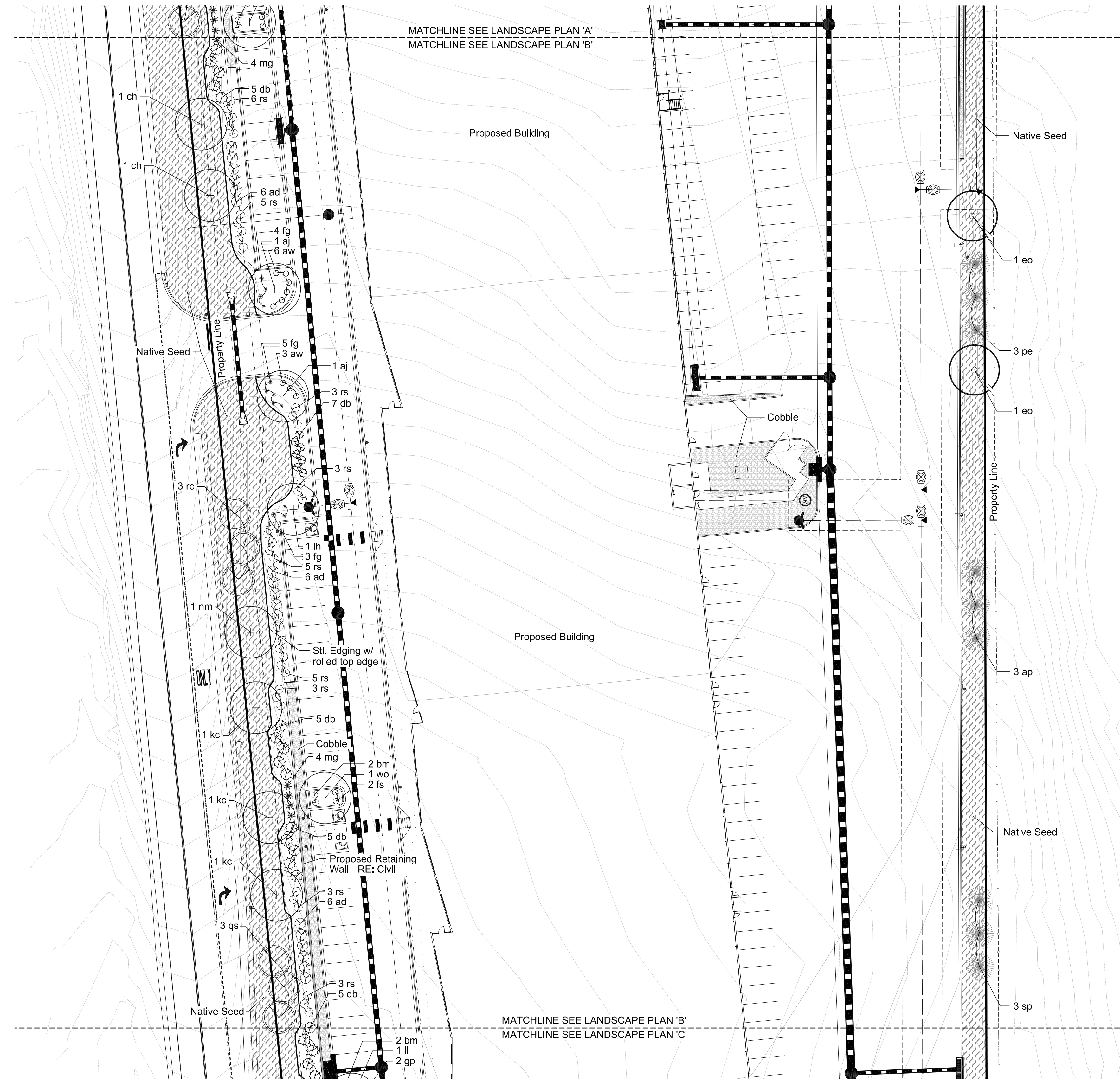

LANDSCAPE LEGEND:

- DECIDUOUS TREE
- ORNAMENTAL TREE
- EVERGREEN TREE
- SHRUB
- ORNAMENTAL GRASS / PERENNIAL

NATIVE SEED MIX NON-IRRIGATED		% OF TOTAL	PLS PER ACRE
COMMON NAME	SCIENTIFIC NAME		
BLUE GRAMA	BOUTELOUA GRACILIS	25%	1.8 LBS.
SAND DROPSEED	SPOROBOLUS CURTIPENDULA	20%	0.20 LBS.
SIDEOATS GRAMA	BOUTELOUA CURTIPENDULA	20%	6.3 LBS.
WESTERN WHEATGRASS	PASCOPYRUM SMITHII	15%	8.2 LBS.
BUFFALO GRASS	BOUTELOUA DACTYLOIDES	10%	10.7 LBS.
INLAND SALTGRASS	DISTICHLIS SPICATA	1%	0.60 LBS.
PASTURE SAGE	ARTEMISIA FRIGIDA	1%	0.01 LBS.
BLANKET FLOWER	GAILLARDIA ARTISTATA	1%	0.5 LBS.
PRAIRIE CONEFLOWER	RATIBIDA COLUMNIFERA	1%	0.1 LBS.
PURPLE PRAIRIECLOVER	DALEA PURPUREA	1%	0.3 LBS.
BLUE FLAX	LINUM LEWISII	1%	0.4 LBS.

DETENTION SEED MIX		% OF TOTAL	PLS PER ACRE
COMMON NAME	SCIENTIFIC NAME		
BLUE GRAMA	BOUTELOUA GRACILIS	20%	1.5 LBS.
SAND DROPSEED	SPOROBOLUS CURTIPENDULA	20%	0.20 LBS.
SWITCHGRASS	PANICUM VIRGATUM	20%	3.2 LBS.
SIDEOATS GRAMA	BOUTELOUA CURTIPENDULA	15%	4.7 LBS.
WESTERN WHEATGRASS	PASCOPYRUM SMITHII	10%	5.5 LBS.
GREEN NEEDLEGRASS	NASELLA VIRIDULA	10%	3.3 LBS.

- 4"-8" ROUND COBBLE OVER FILTER FABRIC
- NON-HATCH PLANTING AREAS
- 2"-4" ROUND COBBLE OVER FILTER FABRIC
- STEEL EDGING w/ ROLLED TOP EDGE
- RETAINING WALL - RE: CIVIL

LANDSCAPE PLAN 'A'

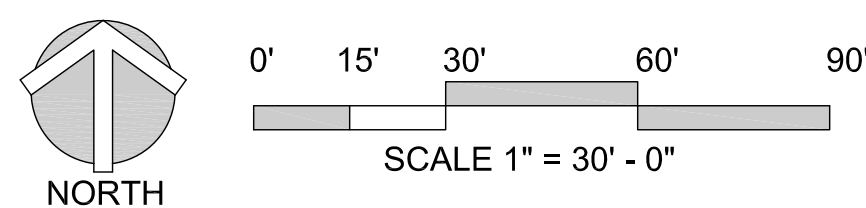

STACKlot
5639 SOUTH CURTICE STREET
LITTLETON, COLORADO 80120
phone. 303.808.4523

CITY FILE NO: #####

REVISIONS	DESCRIPTION
BY	DATE

DRAWN
sdw
CHECKED
jah
DESIGNED
sdw
FILENAME

SITE DEVELOPMENT PLAN
 THE ROCK COMMERCE CENTER
 LANDSCAPE PLAN 'B'

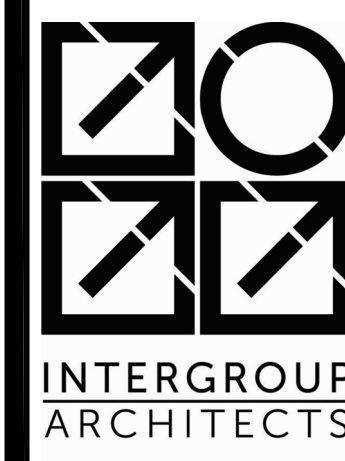

architecture
planning
interiors
2000 West Littleton Blvd
Littleton, Colorado 80120
P: 303.758.8877 F: 303.758.2294
www.igarch.com

JOB NO.
SCALE AS SHOWN
DATE 07/28/2023
SHEETS SHEET
24 14

SITE DEVELOPMENT PLAN THE ROCK COMMERCE CENTER

A PORTION OF THE SOUTHWEST QUARTER OF THE NORTHWEST QUARTER OF SECTION 11,
TOWNSHIP 11 SOUTH, RANGE 67 WEST OF THE SIXTH PRINCIPAL MERIDIAN,
COUNTY OF EL PASO, STATE OF COLORADO

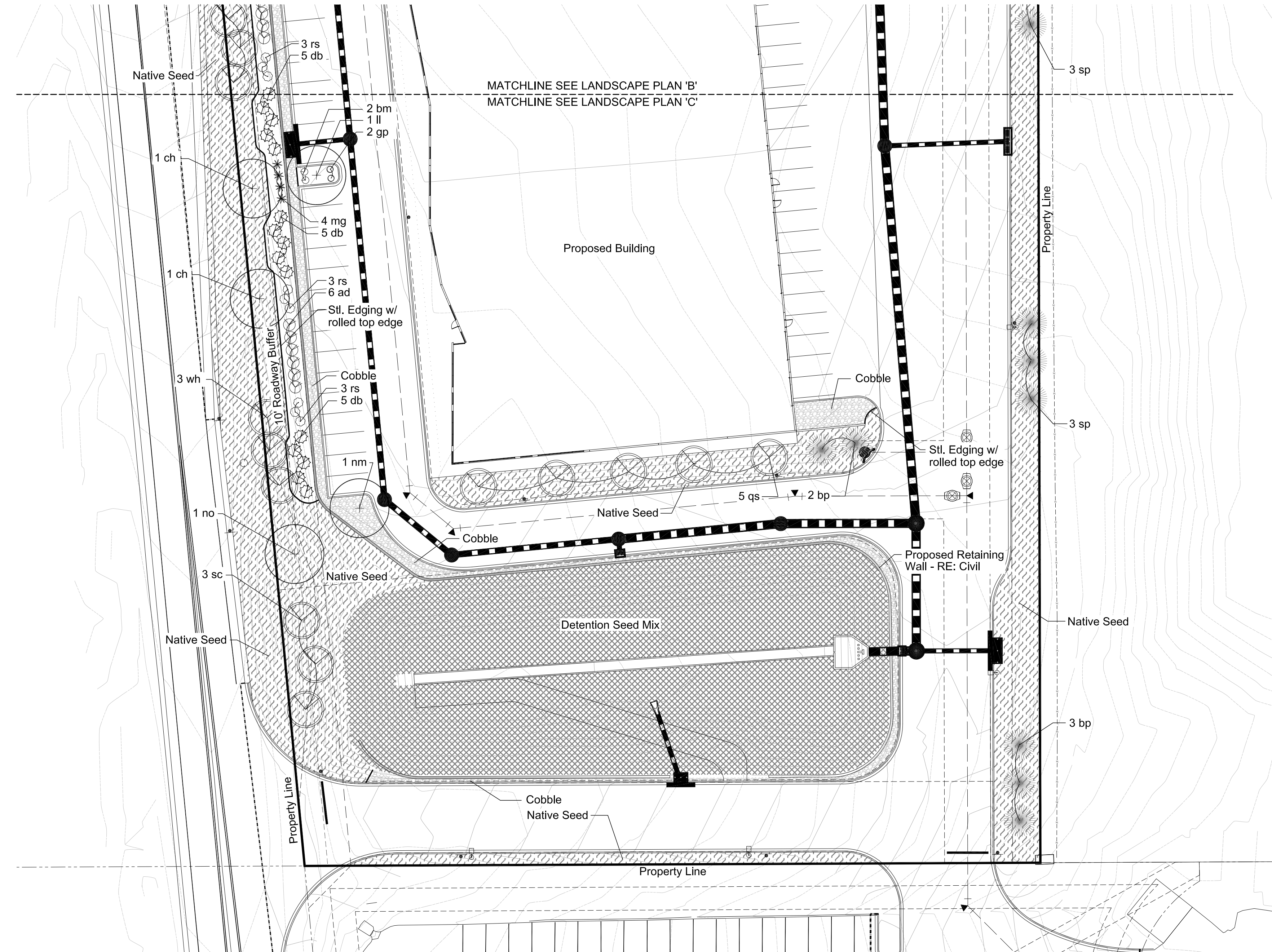

LANDSCAPE LEGEND:

- DECIDUOUS TREE
- ORNAMENTAL TREE
- EVERGREEN TREE
- SHRUB
- ORNAMENTAL GRASS / PERENNIAL

NATIVE SEED MIX NON-IRRIGATED		% OF TOTAL	PLS PER ACRE
BLUE GRAMA	BOUTELOUA GRACILIS	25%	1.8 LBS.
SAND DROPSEED	SPOROBOLUS CRYPTANDRUS	20%	0.20 LBS.
SIDEOATS GRAMA	BOUTELOUA CURTIPENDULA	20%	6.3 LBS.
WESTERN WHEATGRASS	PASCOPYRUM SMITHII	15%	8.2 LBS.
BUFFALO GRASS	BOUTELOUA DACTYLOIDES	10%	10.7 LBS.
INLAND SALTGRASS	DISTICHLIS SPICATA	1%	0.60 LBS.
PASTURE SAGE	ARTEMISIA FRIGIDA	1%	0.01 LBS.
BLANKET FLOWER	GAILLARDIA ARTISTATA	1%	0.5 LBS.
PRAIRIE CONEFLOWER	RATIBIDA COLUMNIFERA	1%	0.1 LBS.
PURPLE PRAIRIECLOVER	DALEA PURPUREA	1%	0.3 LBS.
BLUE FLAX	LINUM LEWISII	1%	0.4 LBS.

DETENTION SEED MIX		% OF TOTAL	PLS PER ACRE
BLUE GRAMA	BOUTELOUA GRACILIS	20%	1.5 LBS.
SAND DROPSEED	SPOROBOLUS CYRPTANDRUS	20%	0.20 LBL.
SWITCHGRASS	PANICUM VIRGATUM	20%	3.2 LBS.
SIDEOATS GRAMA	BOUTELOUA CURIPENDULA	15%	4.7 LBS.
WESTERN WHEATGRASS	PASCOPYRUM SMITHII	10%	5.5 LBS.
GREEN NEEDLEGRASS	NASELLA VIRIDULA	10%	3.3 LBS.

- 4"-8" ROUND COBBLE OVER FILTER FABRIC
- NON-HATCH PLANTING AREAS
- 2"-4" ROUND COBBLE OVER FILTER FABRIC
- STEEL EDGING w/ ROLLED TOP EDGE
- RETAINING WALL - RE: CIVIL

LANDSCAPE PLAN 'A'

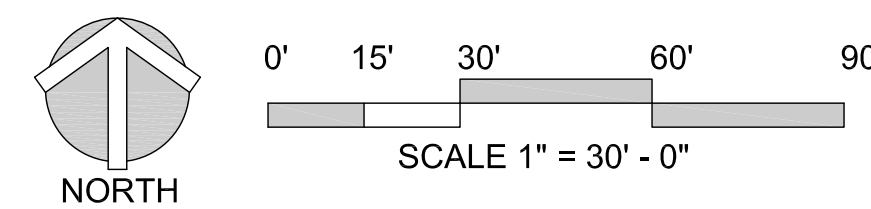

REVISIONS	DESCRIPTION
BY	DATE

DRAWN
sdw

CHECKED
jah

DESIGNED
sdw

FILENAME

SITE DEVELOPMENT PLAN
THE ROCK COMMERCE CENTER
LANDSCAPE PLAN 'C'



architecture
planning
interiors

2000 West Littleton Blvd
Littleton, Colorado 80120
P: 303.758.8877 F: 303.758.2294
www.igarch.com

STACKlot

5639 SOUTH CURTICE STREET
LITTLETON, COLORADO 80120
phone. 303.808.4523

CITY FILE NO: #####

JOB NO.	XX-XXXX
SCALE	AS SHOWN
DATE	07/28/2023
SHEETS	SHEET
24	15

SITE DEVELOPMENT PLAN THE ROCK COMMERCE CENTER

A PORTION OF THE SOUTHWEST QUARTER OF THE NORTHWEST QUARTER OF SECTION 11,
TOWNSHIP 11 SOUTH, RANGE 67 WEST OF THE SIXTH PRINCIPAL MERIDIAN,
COUNTY OF EL PASO, STATE OF COLORADO

GENERAL PLANTING NOTES:

- PRIOR TO BEGINNING ANY WORK ON THE SITE THE LANDSCAPE CONTRACTOR SHALL CONTACT THE OFFICE OF THE GENERAL CONTRACTOR AND LANDSCAPE ARCHITECT FOR SPECIFIC INSTRUCTIONS RELEVANT TO THE SEQUENCING OF WORK.
- LANDSCAPE CONTRACTOR SHALL PROVIDE ALL LABOR, MATERIALS AND SERVICE NECESSARY TO FURNISH AND INSTALL PLANTINGS AND MATERIALS AS SPECIFIED HEREIN AND AS SHOWN ON PLANS.
- NO MATERIAL SUBSTITUTIONS SHALL BE MADE WITHOUT THE LANDSCAPE ARCHITECTS APPROVAL IN WRITING. ALTERNATE MATERIALS OF SIMILAR SIZE AND CHARACTER MAY BE CONSIDERED IF SPECIFIED PLANT MATERIALS CANNOT BE OBTAINED.
- LANDSCAPE ARCHITECT RESERVES THE RIGHT TO REVISE PLANT MATERIAL LIST AS DEEMED NECESSARY.
- ALL PLANT LOCATIONS ARE APPROXIMATE. ADJUST AS NECESSARY TO AVOID CONFLICTS.
- QUANTITIES OF MATERIALS SHOWN ON THE PLANTING PLAN TAKE PRECEDENCE OVER QUANTITIES SHOWN ON THE PLANT MATERIAL SCHEDULE. THE LANDSCAPE CONTRACTOR SHALL BE RESPONSIBLE FOR VERIFY ALL QUANTITIES ON THE PLANTING PLAN(S).
- LANDSCAPE CONTRACTOR SHALL LOCATE ALL UTILITIES BEFORE COMMENCEMENT OF WORK. VERIFY EXACT LOCATION OF ALL UTILITIES BY CONTACTING APPROPRIATE UTILITY COMPANIES. LANDSCAPE CONTRACTOR IS RESPONSIBLE FOR THE REPAIR / REPLACEMENT FOR ANY DAMAGE CAUSED TO UTILITIES.
- FINISH GRADE SHALL BE ADJUSTED FOR TURF THICKNESS.
- ALL PLANT MATERIALS SHALL HAVE BACKFILL, CAREFULLY PLACED AROUND BASE AND IDES OF BALL TO TWO-THIRDS (2/3) DEPTH OF BALL THEN THOROUGHLY SOAKED WITH WATER TO ALLOW SETTLEMENT. ALL WIRE, BURLAP FASTENERS, TOP ONE-THIRD (1/3) SHALL BE REMOVED AT THIS TIME THE REMAINDER OF THE PIT SHALL THEN BE BACKFILLED, ALLOWING FOR THE DEPTH OF THE MULCH SAUCER AND SETTLEMENT OF BACKFILL. BACKFILL SHALL THEN BE THOROUGHLY WATERED ONCE AGAIN.
- AFTER PLANTING IS COMPLETED REPAIR INJURIES TO ALL PLANTS AS REQUIRED. LIMIT AMOUNT OF PRUNING TO A MINIMUM NECESSARY TO REMOVE DEAD OR INJURED TWIGS AND BRANCHES. PRUNE IN SUCH A MANNER AS NOT TO CHANGE THE NATURAL GROWING HABIT OR SHAPE OF THE PLANT. MAKE ALL CUTS FLUSH, LEAVING NO STUBS. CENTRAL LEADERS SHALL NOT BE REMOVED. IF THE CENTRAL LEADER OF A PLANT IS DEAD THE PLANT SHALL BE REPLACED.
- PLANT SPECIFIED GROUND COVERS WITHIN ONE FOOT OF TRUNK OF TREES AND SHRUBS PLANTED WITHIN THE AREA. PLANTING ARRANGEMENTS SHALL BE TRIANGULAR WITH PROPER SPACING BETWEEN PLANTS.
- COMMERCIAL GRADE 3/8 INCH BY 4" POWDER COATED STEEL EDGING SHALL BE USED TO SEPARATE ALL TURF AREAS FROM PLANTING BEDS. PLACE EDGING FLUSH WITH GRADE AND STAKE TO GROUND PER MANUFACTURES RECOMMENDATIONS.
- LANDSCAPE CONTRACTOR TO PROVIDE THE LANDSCAPE CONTRACTOR A SAMPLE OF PROPOSED STEEL EDGING FOR REVIEW AND APPROVAL PRIOR TO INSTALLATION.
- USE SHREDDED CEDAR MULCH IN ALL PLANTING BEDS AND TREE SAUCERS. LANDSCAPE CONTRACTOR SHALL PROVIDE A 1 CUBIC FOOT SAMPLE OF PROPOSED MULCH TO LANDSCAPE ARCHITECT FOR REVIEW AND APPROVAL.
- PLACE FOUR INCHES OF MULCH IN ALL SHRUB BEDS, PLACE FOUR INCHES OF MULCH IN ALL GROUND COVER, PERENNIAL BEDS AND PLACE 4 INCHES OF MULCH AT ALL TREE SAUCERS.
- PLANTING BEDS RECEIVING MULCH MULCH ARE TO BE FREE OF WEEDS AND GRASS. TREAT BEDS WITH A PRE-EMERGENT HERBICIDE PRIOR TO PLANTING AND MULCH PLACEMENT. DO NOT APPLY HERBICIDE IN PERENNIAL OR ANNUAL BEDS.
- LANDSCAPE CONTRACTOR TO REMOVE TREE STAKES AND ALL DEAD WOOD ON TREES AND SHRUBS ONE YEAR AFTER SUBSTANTIAL COMPLETION IS GRANTED ON THE COMPLETE PROJECT.
- REPORT ANY DISCREPANCIES IN THE PLANTING PLAN TO THE LANDSCAPE ARCHITECT PRIOR TO STARTING CONSTRUCTION.
- ALL LANDSCAPE AREAS SHALL BE IRRIGATED BY AN UNDERGROUND AUTOMATIC UNDERGROUND IRRIGATION SYSTEM. WITH SEPARATE ZONES FOR TURF AND SHRUBS / TREES / GROUND COVER.
- IF TRANSFORMERS, GROUND MOUNTED HVAC EQUIPMENT, UTILITY PEDESTALS, ETC. ARE NOT SHOWN ON THE SITE IMPROVEMENT PLAN, ADDITIONAL LANDSCAPE/SCREENING MAY BE REQUIRED BASED UPON FIELD CONDITIONS DISCOVERED VIA THE SITE INSPECTION BY STAFF, MADE PRIOR TO THE ISSUANCE OF CERTIFICATE OF OCCUPANCY, OR FINAL INSPECTION AS APPLICABLE.

SOIL ANALYSIS CONTRACTOR REQUIREMENT

"THE REQUIRED SOIL ANALYSIS REPORT IS REQUIRED TO BE SUBMITTED AND APPROVED WITH THE IRRIGATION PLAN SUBMITTAL AND BEFORE ANY LANDSCAPE CONSTRUCTION. THIS WOULD INCLUDE COMPLETING THE SOIL SAMPLING AND SUBMITTING THE SAMPLES TO A SOILS LAB FOR TESTING. A SEPARATE LAB TEST REPORT AND SOIL PREPARATION RECOMMENDATIONS (AMENDMENT/FERTILIZER AMOUNTS AND APPLICATION RATES) FOR EACH TYPE OF PROPOSED LANDSCAPING (SHRUB BEDS/SOD/NATIVE SEED) WILL NEED TO BE PROVIDED TO CITY STAFF FOR REVIEW AND APPROVAL."

SOIL AMENDMENTS

PRIOR TO PLANTING, ALL SITES FOR PLANTINGS SHALL INCORPORATE SOIL AMENDMENTS AT A RATE OF 3 CUBIC YARDS PER 1000 SQUARE FEET TO A MINIMUM DEPTH OF 6". A LESSER AMOUNT SHALL BE ALLOWED IF A SOIL TEST SHOWS THAT 3 CUBIC YARDS PER 1000 SQUARE FEET IS NOT NECESSARY FOR WATER RETENTION AND DEEP ROOTING OF PLANT MATERIALS. IF THE SPECIFIED PLANT MATERIAL REQUIRES LESS FERTILE SOIL, THOSE AREAS MAY HAVE LESS SOIL AMENDMENTS INSTALLED IF APPROVED BY THE COMMUNITY DEVELOPMENT DIRECTOR. THESE AREAS SHALL BE IDENTIFIED ON THE LANDSCAPE PLAN. EXISTING TOPSOIL SHALL BE SALVAGED AND STOCKPILED FOR USE AS SOIL AMENDMENTS OR TOPSOIL. NO TOPSOIL SHALL BE REMOVED FROM THE SITE UNLESS THE CITY APPROVES THE TRANSFER OF TOPSOIL TO A CITY-OWNED PARK OR OPEN SPACE AREA. A NOTE SHALL BE PLACED ON THE LANDSCAPE PLAN REFLECTING THE ABOVE REQUIREMENTS REGARDING SOIL AMENDMENTS AND TOPSOIL. EXAMPLES OF ACCEPTABLE SOIL AMENDMENTS INCLUDE COMPOST AND AGED MANURE. MOUNTAIN PEAT AND INORGANIC MATERIALS SUCH AS SAND, GYPSUM AND LIME ARE PROHIBITED SOIL AMENDMENTS. ALL SITES ARE SUBJECT TO INSPECTION BY THE CITY FOR COMPLIANCE WITH SOIL AMENDMENT REQUIREMENTS.

PLANT MATERIAL SCHEDULE:

SYMBOL	QTY.	I.D.	COMMON NAME	BOTANICAL NAME	SIZE	COND.
SHADE TREES						
	2	nm	NORWAY MAPLE	ACER PLATANOIDES	1 1/2" CAL.	B & B
	3	aj	AUTUMN BLAZE MAPLE	ACER X FREEMANII 'JEFFERSRED'	1 1/2" CAL.	B & B
	4	ch	COMMON HACKBERRY	CELTIS OCCIDENTALIS	1 1/2" CAL.	B & B
	3	ih	IMPERIAL HONEY LOCUST	GLEDITSIA TRIACANTHOS INERMIS 'IMPERIAL'	1 1/2" CAL.	B & B
	6	kc	KENTUCKY COFFEE TREE	GYMNOCLADUS DIOICUS	1 1/2" CAL.	B & B
	3	nc	NARROWLEAF COTTONWOOD	NARROWLEAF COTTONWOOD	1 1/2" CAL.	B & B
	5	wo	SWAMP WHITE OAK	QUERCUS BICOLOR	1 1/2" CAL.	B & B
	4	no	NORTHERN RED OAK	QUERCUS RUBRA	1 1/2" CAL.	B & B
	2	ll	LITTLELEAF LINDEN	TILIA CORDATA	1 1/2" CAL.	B & B
	4	eo	ENGLISH OAK	QUERCUS ROBUR	1 1/2" CAL.	B & B
ORNAMENTAL TREES						
	3	wh	WASHINGTON HAWTHORN	CRATAEGUS PHAENOPYRUM	1" CAL.	B & B
	6	rc	RADIANT CRABAPPLE	MALAU 'RADIANT'	1" CAL.	B & B
	6	sc	SPRING SNOW CRABAPPLE	MALUS 'SPRING SNOW'	1" CAL.	B & B
	3	cp	CHANTICLEER PEAR	PYRUS CALLERYANA	1" CAL.	B & B
	11	qs	CRIMSON SPIRE OAK	QUERCUS X BIMUNDORUM 'CRIMSCHMIDT'	1" CAL.	B & B
	EVERGREEN TREES					
	3	pe	PINON PINE	PINUS EDULIS	6' HT.	B & B
	11	ap	AUSTRIAN PINE	PINUS NIGRA	6' HT.	B & B
	5	pp	PONDEROSA PINE	PINUS PONDEROSA	6' HT.	B & B
	6	sp	SOUTHWESTERN WHITE PINE	PINUS STROBIFORMIS	6' HT.	B & B
	5	bp	BOSNIA PINE	PINUS HELDREICHII	6' HT.	B & B
	SHRUBS					
	2	ks	DARK KNIGHT SPIREA	CARYOPTERIS X CLANDONENSIS 'DARK KNIGHT'	5 GAL.	CONT.
	15	aw	ANOTHONY WATERER SPIREA	SPIREA JAPONICA 'ANTHONY WATER'	5 GAL.	CONT.
	6	fs	GOLD FLAME SPIREA	SPIREA JAPONICA 'GOLDFLAME'	5 GAL.	CONT.
	8	gp	GOLD DROP POTENTILLA	POTENTILLA FRUITICOSA 'GOLD DROP'	5 GAL.	CONT.
	19	bm	BLUE MIST SPIREA	CARYOPTERIS X CLANDONENSIS	5 GAL.	CONT.
	67	db	DWARF BURNING BUSH	EOUNYMUS ALATA 'DWARF NANA'	5 GAL.	CONT.
	61	rs	RUSSIAN SAGE	PEROVSKIA ATRIPLICIFOLIA	5 GAL.	CONT.
	40	ad	ARCTIC FIRE DOGWOOD	CORNUS STOLONIFERA 'FARROW'	5 GAL.	CONT.
	4	dn	DWARF NINEBARK	PHYSOCARPUS 'OPULIFOLIUS 'NANUS'	5 GAL.	CONT.
	ORNAMENTAL GRASSES					
	27	mg	MAIDEN GRASS	MISCANTHUS SINENSIS 'GRACILLIMUS'	1 GAL.	CONT.
	12	fg	MEXICAN FEATHER GRASS	NESSELLA TENUISSIMA	1 GAL.	CONT.

Roadway Buffer

MONUMENT HILL ROAD NON-ARTERIAL	REQUIRED ROADWAY BUFFER	PROVIDED ROADWAY BUFFER	REQUIRED TREES 1 TREE / 30 LN.FT.	PROVIDED TREES
1,175 LN.FT.	10 FEET	10 FEET	40	40

Internal Landscaping

SITE AREA	INTERNAL LANDSCAPE AREA REQUIRED - (%)	INTERNAL LANDSCAPE AREA PROVIDED	REQUIRED TREES 1 TREE / 500 SF	PROVIDED TREES
505,679 SF.	25,284 SF.	105,300 SF.	51	55



5639 SOUTH CURTICE STREET
LITTLETON, COLORADO 80120
phone. 303.808.4523

CITY FILE NO: #####

REVISIONS	DESCRIPTION	DATE	BY

DRAWN	sdw
CHECKED	jah
DESIGNED	sdw
FILENAME	

SITE DEVELOPMENT PLAN
 THE ROCK COMMERCE CENTER
 LANDSCAPE NOTES



architecture
planning
interiors
2000 West Littleton Blvd
Littleton, Colorado 80120
P: 303.758.8877 F: 303.758.2294
www.igarch.com

JOB NO.	XX-XXXX
SCALE	AS SHOWN
DATE	07/28/2023
SHEETS	24
SHEET	16

SITE DEVELOPMENT PLAN THE ROCK COMMERCE CENTER

A PORTION OF THE SOUTHWEST QUARTER OF THE NORTHWEST QUARTER OF SECTION 11,
TOWNSHIP 11 SOUTH, RANGE 67 WEST OF THE SIXTH PRINCIPAL MERIDIAN,
COUNTY OF EL PASO, STATE OF COLORADO

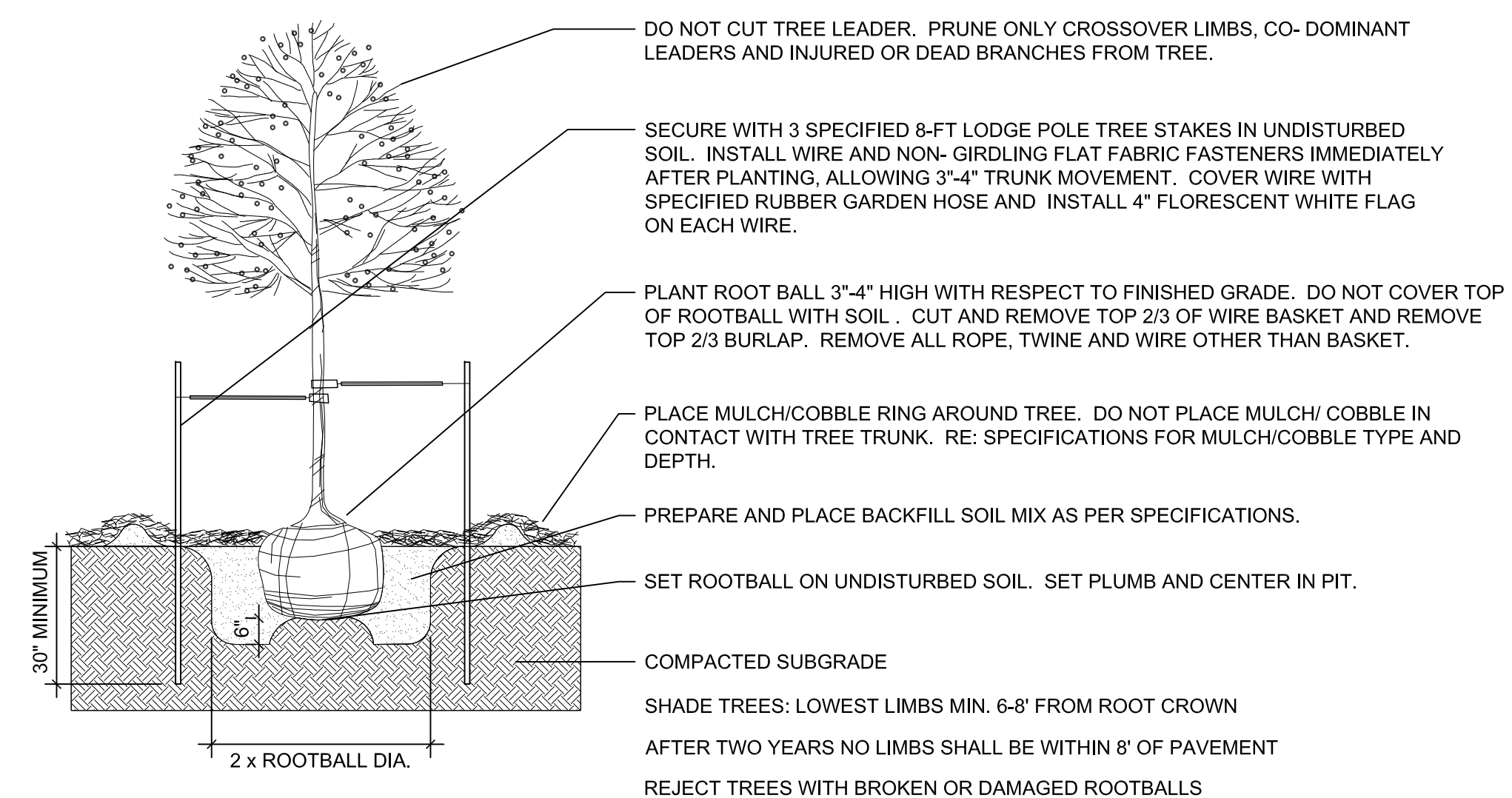

1 DECIDUOUS TREE
NOT TO SCALE

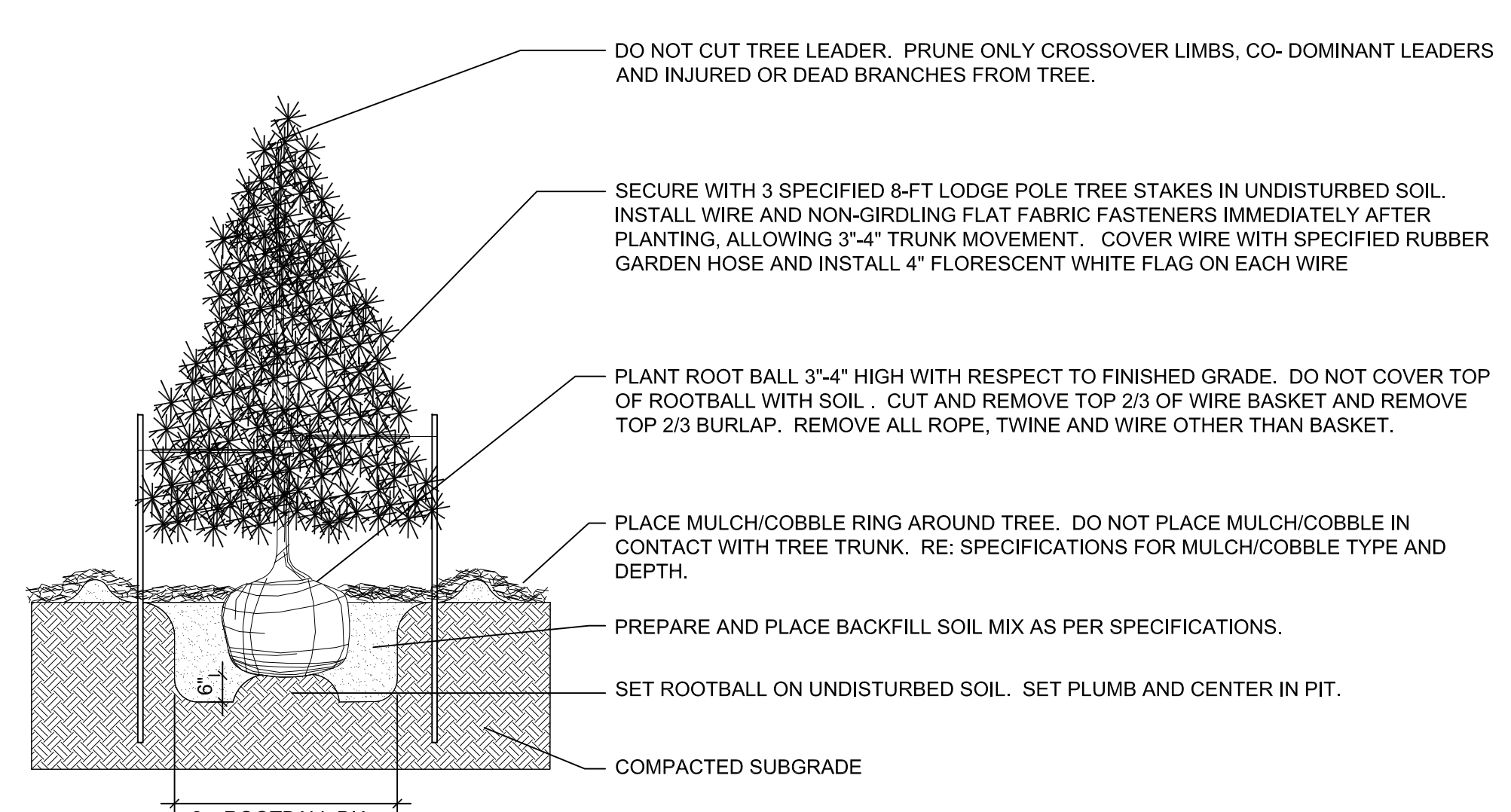

2 EVERGREEN TREE PLANTING
NOT TO SCALE

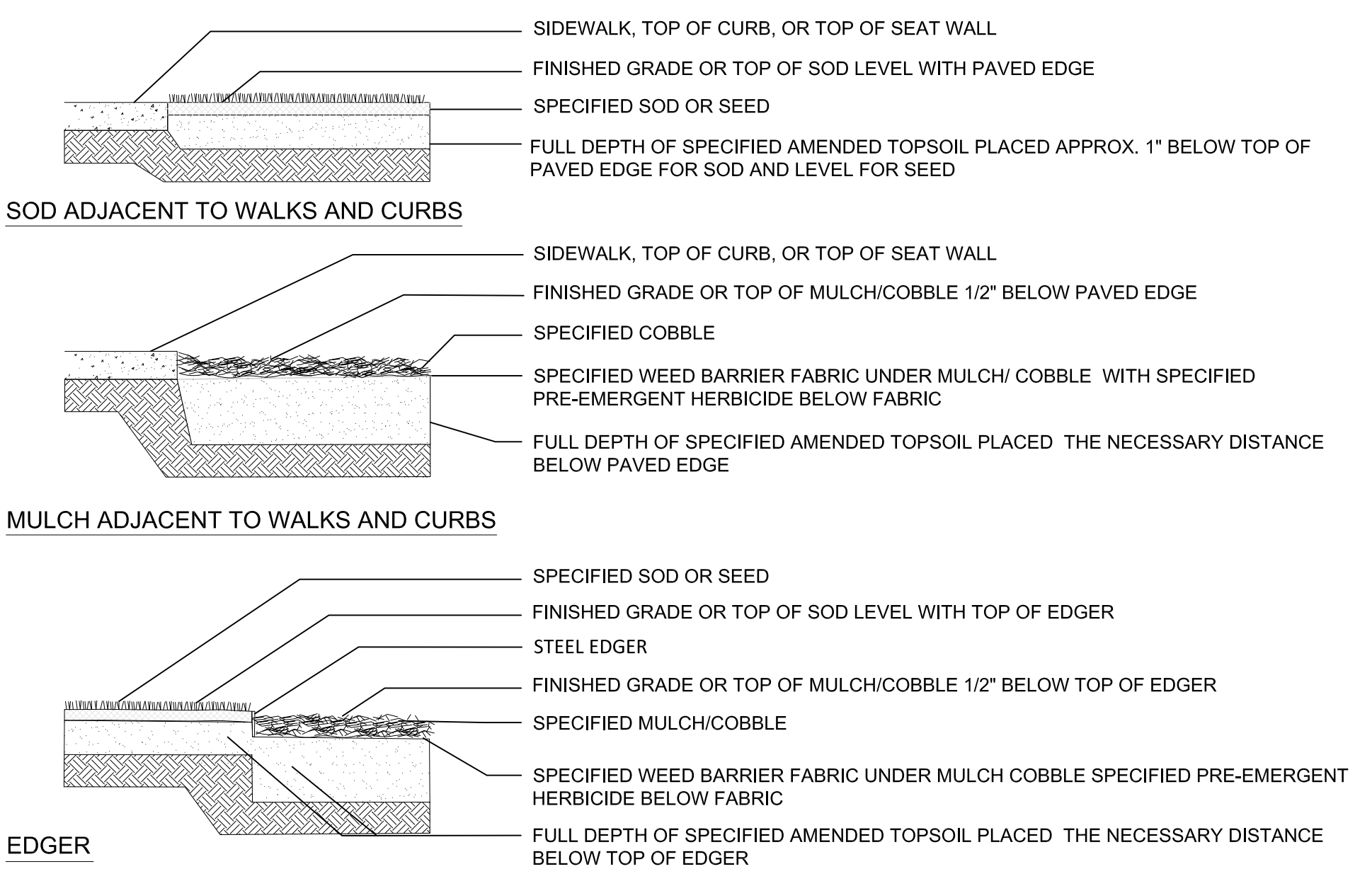

3 EDGE TREATMENT
NOT TO SCALE

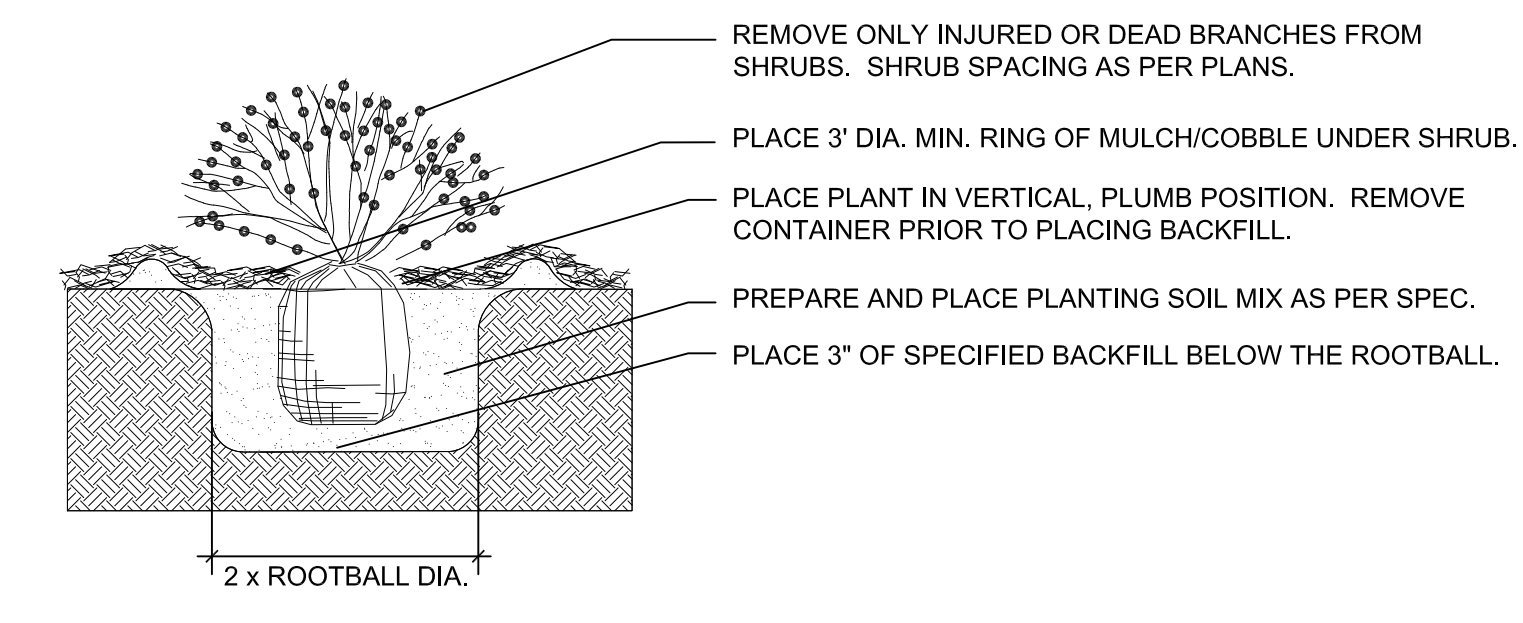

4 SHRUB PLANTING
NOT TO SCALE

REVISIONS	DESCRIPTION
BY	DATE

DRAWN: sdw
CHECKED: jah
DESIGNED: sdw
FILENAME:

SITE DEVELOPMENT PLAN
THE ROCK COMMERCE CENTER
LANDSCAPE DETAILS



architecture
planning
interiors
2000 West Littleton Blvd
Littleton, Colorado 80120
P: 303.758.8877 F: 303.758.2294
www.igarch.com

STACKlot
5639 SOUTH CURTICE STREET
LITTLETON, COLORADO 80120
phone. 303.808.4523

JOB NO. XX-XXXX
SCALE AS SHOWN
DATE 07/28/2023
SHEETS 24 SHEET 17
CITY FILE NO: #####