

ENG-SF21033-R4-FDR.pdf Markup Summary

6 (2)

Drawings alternatives for the drainage basin system and call- out is recommended the existing 50" CMP be replaced with a 60" RCP. In call- out is recommended.

Subject: Callout
Page Index: 6
Date: 1/4/2023 1:51:29 PM
Author: CDurham
Color: ■
Layer:
Space:
Page Label: 6

State "construction" of improvements will be completed with Filing 3 but design of improvements have been provided in appendix.

and the required utility improvements will be provided. The utility and the required utility improvements will be provided. The utility and the required utility improvements will be provided.

Subject: Text Box
Page Index: 6
Date: 1/4/2023 2:27:03 PM
Author: CDurham
Color: ■
Layer:
Space:
Page Label: 6

Include discussion of assume channel lining/material. Indicate if banks are stable, what is average & max/min slope, velocity, depth, bottom width etc. State what velocity is allowed. What is being done for areas where permissible velocity is exceeded. What is being done to protect channel where Fr # is in excess of 0.9? Is additional bank protection required around bend of channel? Provide calculations to show either way and include discussion in report. Indicate if there is a low flow channel present.

10 (2)

Drawings alternatives for the drainage basin system and call- out is recommended the existing 50" CMP be replaced with a 60" RCP. In call- out is recommended.

Subject: Callout
Page Index: 10
Date: 1/6/2023 4:13:45 PM
Author: dsdrice
Color: ■
Layer:
Space:
Page Label: 10

Provide a natural channel attributes table to include all criteria checked including velocities, Froude Nos., shear stresses, etc. and modeled results. Reference City Table 12-3 or UDFCD for example.

Stream Name	Velocity	Froude No.	Shear Stress
Stream 1	1.5	0.8	1.2
Stream 2	2.0	1.0	1.5

Subject: Snapshot
Page Index: 10
Date: 1/9/2023 8:09:43 AM
Author: dsdrice
Color: ■
Layer:
Space:
Page Label: 10

Remove or revise this portion if channel improvements are not being built until Filing 3.

12 (1)

Drawings alternatives for the drainage basin system and call- out is recommended the existing 50" CMP be replaced with a 60" RCP. In call- out is recommended.

Subject: Callout
Page Index: 12
Date: 1/9/2023 8:12:23 AM
Author: CDurham
Color: ■
Layer:
Space:
Page Label: 12

20 (1)

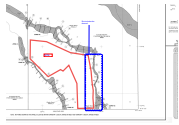

Subject: Cloud+
Page Index: 20
Date: 1/6/2023 4:17:30 PM
Author: dsdrice
Color: ■
Layer:
Space:
Page Label: 20

Site includes the channel

59 (2)

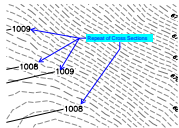

Subject: Callout
Page Index: 59
Date: 1/4/2023 1:59:53 PM
Author: CDurham
Color: ■
Layer:
Space:
Page Label: 59

Repeat of Cross Sections

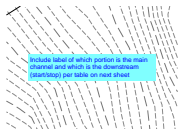

Subject: Text Box
Page Index: 59
Date: 1/4/2023 2:12:50 PM
Author: CDurham
Color: ■
Layer:
Space:
Page Label: 59

Include label of which portion is the main channel and which is the downstream (start/stop) per table on next sheet

60 (17)

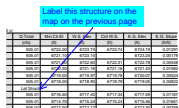

Subject: Callout
Page Index: 60
Date: 1/4/2023 2:02:25 PM
Author: CDurham
Color: ■
Layer:
Space:
Page Label: 60

Label this structure on the map on the previous page

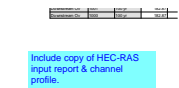

Subject: Text Box
Page Index: 60
Date: 1/4/2023 2:13:13 PM
Author: CDurham
Color: ■
Layer:
Space:
Page Label: 60

Include copy of HEC-RAS input report & channel profile.

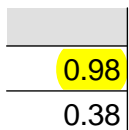

Subject: Highlight
Page Index: 60
Date: 1/4/2023 2:09:17 PM
Author: CDurham
Color: ■
Layer:
Space:
Page Label: 60

0.98

0.64	Subject: Highlight	0.99
0.99	Page Index: 60	
0.59	Date: 1/4/2023 2:09:19 PM	
	Author: CDurham	
	Color: 	
	Layer:	
	Space:	
	Page Label: 60	

0.85	Subject: Highlight	1.00
1.00	Page Index: 60	
0.69	Date: 1/4/2023 2:09:22 PM	
	Author: CDurham	
	Color: 	
	Layer:	
	Space:	
	Page Label: 60	

0.69	Subject: Highlight	1.00
1.00	Page Index: 60	
0.41	Date: 1/4/2023 2:09:24 PM	
	Author: CDurham	
	Color: 	
	Layer:	
	Space:	
	Page Label: 60	

0.41	Subject: Highlight	0.99
0.99	Page Index: 60	
0.79	Date: 1/4/2023 2:09:27 PM	
	Author: CDurham	
	Color: 	
	Layer:	
	Space:	
	Page Label: 60	

0.69	Subject: Highlight	1.02
1.02	Page Index: 60	
0.08	Date: 1/4/2023 2:09:29 PM	
	Author: CDurham	
	Color: 	
	Layer:	
	Space:	
	Page Label: 60	

0.65	Subject: Highlight	1.00
1.00	Page Index: 60	
0.85	Date: 1/4/2023 2:09:32 PM	
	Author: CDurham	
	Color: 	
	Layer:	
	Space:	
	Page Label: 60	

0.85
0.97
0.77

Subject: Highlight
Page Index: 60
Date: 1/4/2023 2:09:34 PM
Author: CDurham
Color: ■
Layer:
Space:
Page Label: 60

0.97

0.77
1.03
0.64

Subject: Highlight
Page Index: 60
Date: 1/4/2023 2:09:36 PM
Author: CDurham
Color: ■
Layer:
Space:
Page Label: 60

1.03

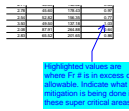

Subject: Callout
Page Index: 60
Date: 1/4/2023 2:11:23 PM
Author: CDurham
Color: ■
Layer:
Space:
Page Label: 60

Highlighted values are where Fr # is in excess of allowable. Indicate what mitigation is being done in these super critical areas.

(ft/s)
5.41
2.32

Subject: Highlight
Page Index: 60
Date: 1/4/2023 2:11:28 PM
Author: CDurham
Color: ■
Layer:
Space:
Page Label: 60

5.41

2.19
5.80
5.15

Subject: Highlight
Page Index: 60
Date: 1/4/2023 2:11:31 PM
Author: CDurham
Color: ■
Layer:
Space:
Page Label: 60

5.80

5.80
5.15
4.07

Subject: Highlight
Page Index: 60
Date: 1/4/2023 2:11:33 PM
Author: CDurham
Color: ■
Layer:
Space:
Page Label: 60

5.15

4.19
5.51
0.06

Subject: Highlight
Page Index: 60
Date: 1/4/2023 2:11:35 PM
Author: CDurham
Color: 
Layer:
Space:
Page Label: 60

5.51

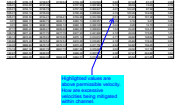

Subject: Callout
Page Index: 60
Date: 1/4/2023 2:12:11 PM
Author: CDurham
Color: 
Layer:
Space:
Page Label: 60

Highlighted values are above permissible velocity. How are excessive velocities being mitigated within channel.

63 (1)

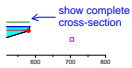

Subject: Callout
Page Index: 63
Date: 1/6/2023 4:33:31 PM
Author: dsdrice
Color: 
Layer:
Space:
Page Label: 63

show complete cross-section

65 (1)

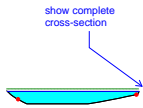

Subject: Callout
Page Index: 65
Date: 1/6/2023 4:34:20 PM
Author: dsdrice
Color: 
Layer:
Space:
Page Label: 65

show complete cross-section

68 (1)

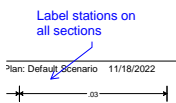

Subject: Callout
Page Index: 68
Date: 1/6/2023 4:35:12 PM
Author: dsdrice
Color: 
Layer:
Space:
Page Label: 68

Label stations on all sections

69 (1)

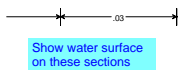

Subject: Text Box
Page Index: 69
Date: 1/4/2023 2:03:38 PM
Author: CDurham
Color: 
Layer:
Space:
Page Label: 69

Show water surface on these sections