

SFD19949
 PLAT 13640
 PUD

APPROVED
Plan Review
 07/22/2019 3:18:33 PM
 dsdarchuleta
 EPC Planning & Community
 Development Department

APPROVED
BESQCP
 07/22/2019 3:18:41 PM
 dsdarchuleta
 EPC Planning & Community
 Development Department



ANY APPROVAL GIVEN BY
 EL PASO COUNTY
 DOES NOT OBTAIN THE NEED
 TO COMPLY WITH APPLICABLE
 FEDERAL, STATE, OR LOCAL
 LAWS AND/OR REGULATION

Planning & Community Development Department
 approval is contingent upon compliance with all
 applicable notes on the recorded plat.

An access permit must be granted by the
 Planning & Community Development Department
 prior to the establishment of any driveway onto a
 County road.

Diversion of blockage of any drainage way
 is not permitted without approval of the
 Planning & Community Development Department

Released for Permit
 07/22/2019 2:31:22 PM
 brent
 ENUMERATION

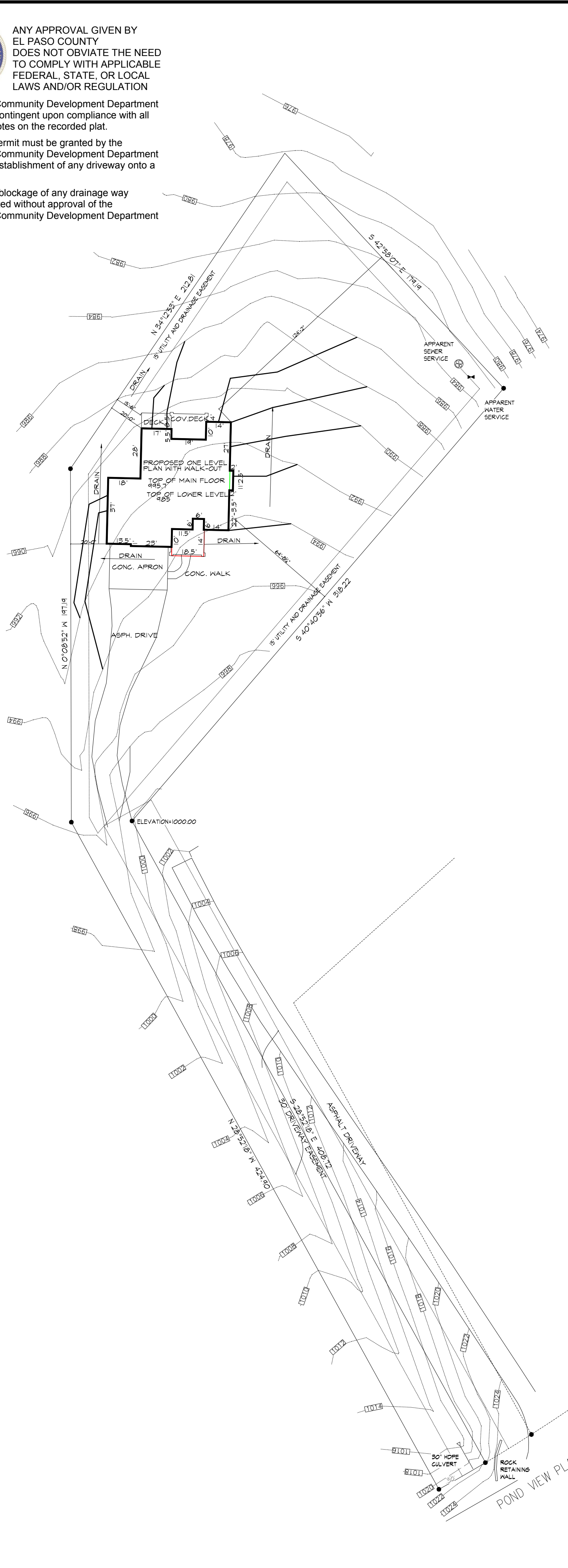
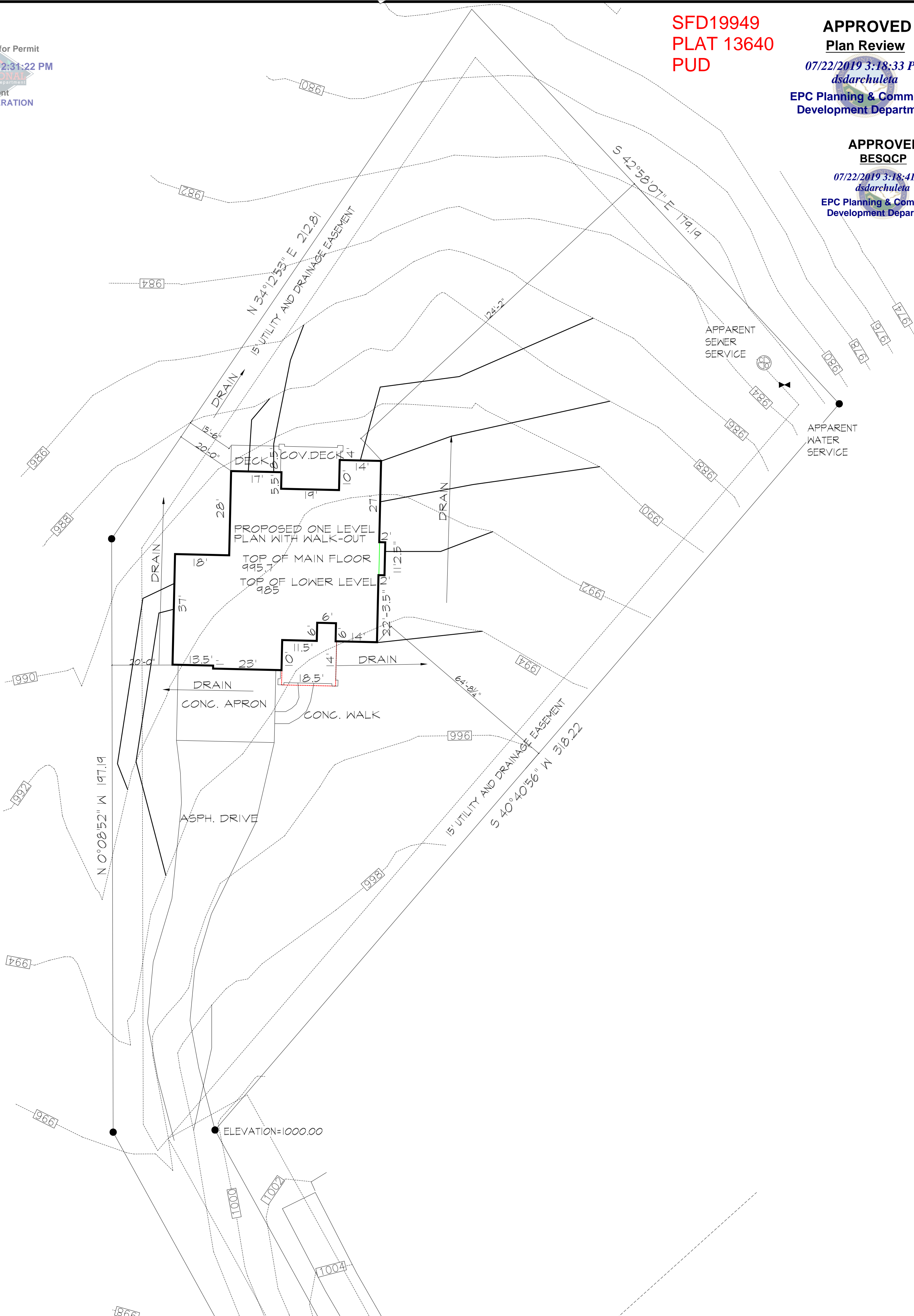

SITE PLAN
 0 20/40 40/80
 SCALE: 1" = 20'-0"/140'-0"
LEGAL DESCRIPTION:
 LOT 17, WALDEN PRESERVE FII, NO 1
 EL PASO COUNTY, COLORADO
ADDRESS:
 17414 POND VIEW PLACE
 COLORADO SPRINGS, CO
TAX SCH#
 6123001040
LOT SIZE:
 1.35 ACRES
 --- EXISTING GRADE AT 2'-0"
 --- PROPOSED GRADE AT 2'-0"
 SAVE TREES AND EXISTING VEGETATION
 WHERE POSSIBLE
 RESEED ALL DISTURBED AREAS

DATE:	REV.	BY:
7-22-19	ADD DIM.	DJA

DAVID WOODY and CO.
 CUSTOM HOME DESIGN AND DRAFTING
 PO BOX 2391 MONUMENT, CO 80132
 (719)531-9018

MASTER 18611
GARAGE LEFT
 17414 POND VIEW PLACE
 COLORADO SPRINGS, COLORADO

HAMMER HOMES INC.
 CUSTOM HOME BUILDER
 220 COYOTE WILLOW
 COLO. SPRINGS CO 80921
 (719)322-3578

DATE: 7-15-19
 DRAWN BY: DJA

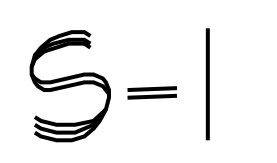

SITE



2017 PPRBC

Address: 17414 POND VIEW PL, COLORADO SPRINGS

Parcel: 6123001040
Map #: 285G

Plan Track #: 119021  Received: 19-Jul-2019 (AMY)

Description:

RESIDENCE

Type of Unit:

Garage	1133	
Main Level	2469	
	3602	Total Square Feet

Required PPRBD Departments (2)

Enumeration APPROVED AMY 7/19/2019 8:44:10 AM	Floodplain (N/A) RBD GIS
--	---

Required Outside Departments (1)

County Zoning APPROVED <u>Plan Review</u> <i>07/22/2019 3:19:31 PM</i> <i>dsdarchuleta</i> EPC Planning & Community Development Department
--

Release of this plan does not preclude compliance with all applicable codes, ordinances and other pertinent regulations. This plan set must be present on the job site for every inspection.