

SITE DEVELOPER/APPLICANT:

7113 SPACE VILLAGE AVE
COLORADO SPRINGS, CO 80929
(EL PASO COUNTY)

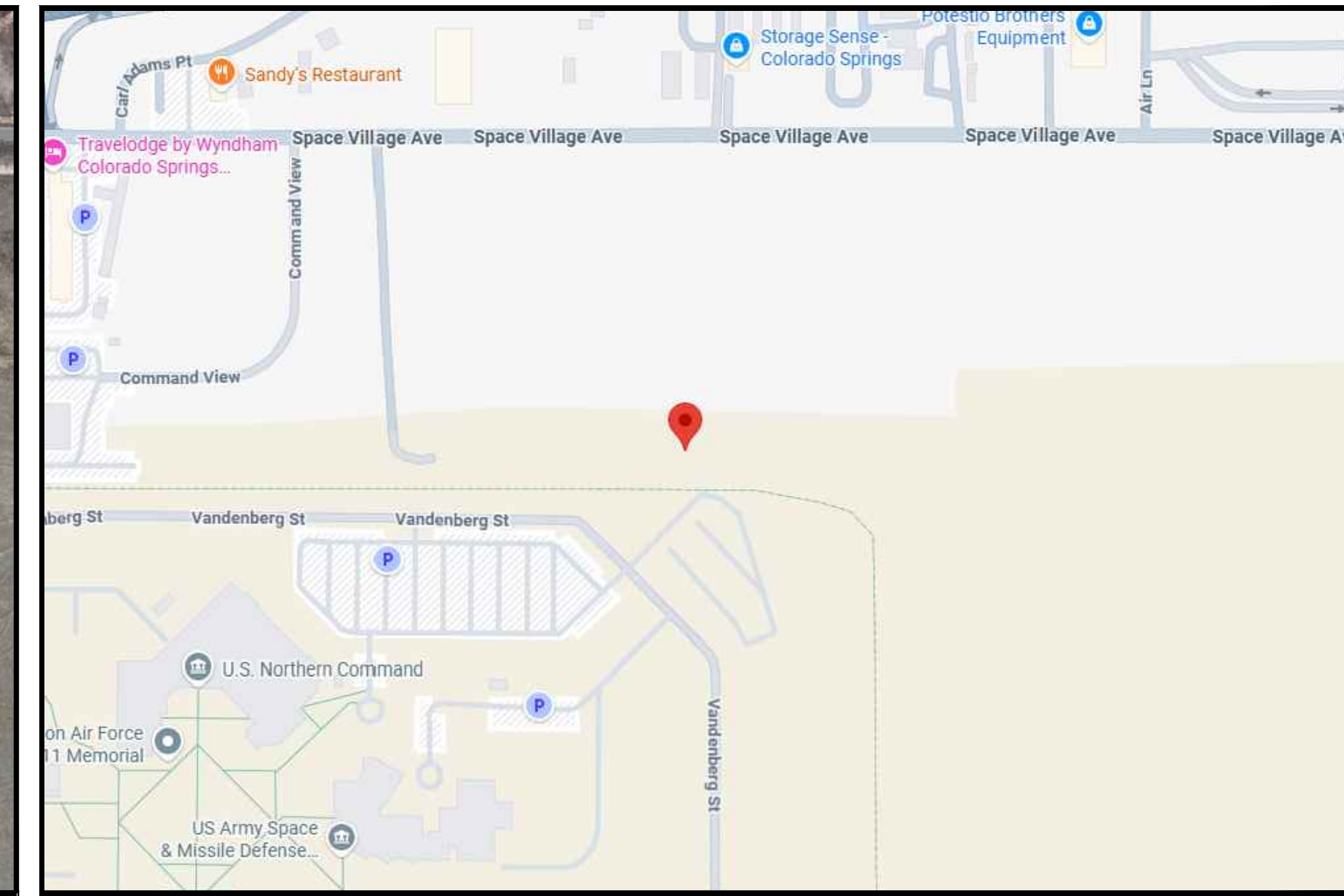

VICINITY MAP



LOCATION MAP

SITE NAME:	COLORADO SPRINGS, CO - 100KM	SITE ADDRESS:	7113 SPACE VILLAGE AVE COLORADO SPRINGS, CO 80929 (EL PASO COUNTY)
PROJECT DESCRIPTION:	NEW LEASE AREA	APN:	5417001012
		JURISDICTION:	EL PASO COUNTY
		ZONE:	INDUSTRIAL (I-3)

ALL WORK SHALL BE PERFORMED AND MATERIALS INSTALLED IN ACCORDANCE WITH THE CURRENT EDITIONS OF THE FOLLOWING CODES AS ADOPTED BY THE LOCAL GOVERNING AUTHORITIES. NOTHING IN THESE PLANS IS TO BE CONSTRUED TO PERMIT WORK NOT CONFORMING TO THESE CODES:

EASEMENTS
GC IS TO FOLLOW ALL ACCESS AND UTILITY EASEMENTS AS DEFINED BY APPLICANT LEASE AGREEMENT

CODE TYPE	CODE
BUILDING	2024 IBC, 2024 IRC, 2021 IECG, 2017 COLORADO ACCESSIBILITY, 2021 COLORADO ENERGY CODE, 2017 ICC A117.1, 2024 IFC
MECHANICAL	2021 IMC
ELECTRICAL	2023 NEC, 2021 ISEP, CODE OF ORDINANCES
STRUCTURAL	EIA/TIA-H-222

THE SCOPE OF WORK INCLUDES INSTALLATION OF A PROPOSED 98'-5"x196'-10" FENCED GRAVEL COMPOUND WITH SMALL SATELLITE EARTH STATION ANTENNAS (40 ANTENNAS AND 1 HEAD END EQUIPMENT RACK) IN EXISTING GRASS AREA. POWER TO BE PROVIDED FROM EXISTING UTILITY POLE COMING FROM SPACE VILLAGE AVE. FIBER TO BE PROVIDED FROM NEW FIBER DEMARK WITHIN RIGHT OF WAY.

SITE INFORMATION

CODE COMPLIANCE

PROJECT SCOPE OF WORK

*LATITUDE 38° 50' 13.0848"N (38.836968°)
*LONGITUDE 104° 41' 38.3812"W (-104.693717°)
*GROUND ELEV. (AMSL) = 6289' ±
* INFORMATION TAKEN FROM GOOGLE EARTH

POWER COMPANY: COLORADO SPRINGS UTILITIES
FIBER COMPANY: ZAYO

GENERAL NOTES:

- ALL REFERENCES TO OWNER IN THESE DOCUMENTS SHALL BE CONSIDERED THE CUSTOMER, OR ITS DESIGNATED REPRESENTATIVE.
- ALL WORK PRESENTED ON THESE DRAWINGS MUST BE COMPLETED BY THE CONTRACTOR UNLESS NOTED OTHERWISE. THE CONTRACTOR MUST HAVE CONSIDERABLE EXPERIENCE IN PERFORMANCE OF WORK SIMILAR TO THAT DESCRIBED HEREIN. BY ACCEPTANCE OF THIS ASSIGNMENT, THE CONTRACTOR IS ATTESTING THAT HE DOES HAVE SUFFICIENT EXPERIENCE AND ABILITY, THAT HE IS KNOWLEDGABLE OF THE WORK TO BE PERFORMED AND THAT HE IS PROPERLY LICENSED AND PROPERLY REGISTERED TO DO THIS WORK IN THE STATE OF COLORADO.
- STRUCTURE IS DESIGNED IN ACCORDANCE WITH ANSI/TIA-222-I, FOR A 105 MPH 3-SECOND GUST WIND LOAD. THIS CONFORMS TO THE REQUIREMENTS OF THE INTERNATIONAL BUILDING CODE, 2024 EDITION.
- WORK SHALL BE COMPLETED IN ACCORDANCE WITH THE 2024 INTERNATIONAL BUILDING CODE AS ADOPTED BY CITY OF COLORADO SPRINGS.
- UNLESS SHOWN OR NOTED OTHERWISE ON THE CONTRACT DRAWINGS, OR IN THE SPECIFICATIONS, THE FOLLOWING NOTES SHALL APPLY TO THE MATERIALS LISTED HEREIN, AND TO THE PROCEDURES TO BE USED ON THIS PROJECT.
- ALL HARDWARE ASSEMBLY MANUFACTURER'S INSTRUCTIONS SHALL BE FOLLOWED EXACTLY AND SHALL SUPERCEDE ANY CONFLICTING NOTES ENCLOSED HEREIN.
- IT IS THE CONTRACTOR'S SOLE RESPONSIBILITY TO DETERMINE ERECTION PROCEDURE AND SEQUENCE TO INSURE THE SAFETY OF THE STRUCTURE AND ITS COMPONENT PARTS DURING ERECTION AND/OR FIELD MODIFICATIONS. THIS INCLUDES, BUT IS NOT LIMITED TO, THE ADDITION OF TEMPORARY BRACING, GUYS OR TIE DOWNS THAT MAY BE NECESSARY. SUCH MATERIAL SHALL BE REMOVED AND SHALL REMAIN THE PROPERTY OF THE CONTRACTOR AFTER THE COMPLETION OF THE PROJECT.
- ALL DIMENSIONS, ELEVATIONS, AND EXISTING CONDITIONS SHOWN ON THE DRAWINGS SHALL BE FIELD VERIFIED BY THE CONTRACTOR PRIOR TO BEGINNING ANY MATERIALS ORDERING, FABRICATION OR CONSTRUCTION WORK ON THIS PROJECT. CONTRACTOR SHALL NOT SCALE CONTRACT DRAWINGS IN LIEU OF FIELD VERIFICATIONS. ANY DISCREPANCIES SHALL BE IMMEDIATELY BROUGHT TO THE ATTENTION OF THE OWNER AND THE OWNER'S ENGINEER. THE DISCREPANCIES MUST BE RESOLVED BEFORE THE CONTRACTOR IS TO PROCEED WITH THE WORK. THE CONTRACT DOCUMENTS DO NOT INDICATE THE METHOD OF CONSTRUCTION, THE CONTRACTOR SHALL SUPERVISE AND DIRECT THE WORK AND SHALL BE SOLELY RESPONSIBLE FOR ALL CONSTRUCTION MEANS, METHODS, TECHNIQUES, SEQUENCES, AND PROCEDURES. OBSERVATION VISITS TO THE SITE BY THE OWNER AND/OR THE ENGINEER SHALL NOT INCLUDE INSPECTION OF THE PROTECTIVE MEASURES OR THE PROCEDURES.
- ALL MATERIALS AND EQUIPMENT FURNISHED SHALL BE NEW AND OF GOOD QUALITY, FREE FROM FAULTS AND DEFECTS AND IN CONFORMANCE WITH THE CONTRACT DOCUMENTS. ANY AND ALL SUBSTITUTIONS MUST BE PROPERLY APPROVED AND AUTHORIZED IN WRITING BY THE OWNER AND ENGINEER PRIOR TO INSTALLATION. THE CONTRACTOR SHALL FURNISH SATISFACTORY EVIDENCE AS TO THE KIND AND QUALITY OF THE MATERIALS AND EQUIPMENT BEING SUBSTITUTED.
- THE CONTRACTOR SHALL BE RESPONSIBLE FOR INITIATING, MAINTAINING, AND SUPERVISING ALL SAFETY PRECAUTIONS AND PROGRAMS IN CONNECTION WITH THE WORK. THE CONTRACTOR IS RESPONSIBLE FOR INSURING THAT THIS PROJECT AND RELATED WORK COMPLIES WITH ALL APPLICABLE LOCAL, STATE, AND FEDERAL SAFETY CODES AND REGULATIONS GOVERNING CONSTRUCTION.
- ACCESS TO THE PROPOSED WORK SITE MAY BE RESTRICTED. THE CONTRACTOR SHALL COORDINATE INTENDED CONSTRUCTION ACTIVITY, INCLUDING WORK SCHEDULE AND MATERIALS ACCESS, WITH THE RESIDENT LEASING AGENT FOR APPROVAL.
- BILL OF MATERIALS AND PART NUMBERS LISTED ON CONSTRUCTION DRAWINGS ARE INTENDED TO AID CONTRACTOR. CONTRACTOR SHALL VERIFY PARTS AND QUANTITIES WITH MANUFACTURER PRIOR TO BIDDING AND/OR ORDERING MATERIALS.
- ALL PERMITS THAT MUST BE OBTAINED ARE THE RESPONSIBILITY OF THE CONTRACTOR. THE CONTRACTOR WILL BE RESPONSIBLE FOR ABIDING BY ALL CONDITIONS AND REQUIREMENTS OF THE PERMITS.
- 24 HOURS PRIOR TO THE BEGINNING OF ANY CONSTRUCTION, THE CONTRACTOR MUST NOTIFY THE APPLICABLE JURISDICTIONAL (STATE, COUNTY OR CITY) ENGINEER.
- THE CONTRACTOR SHALL REWORK (DRY, SCARIFY, ETC.) ALL MATERIAL NOT SUITABLE FOR SUBGRADE IN ITS PRESENT STATE. AFTER REWORKING, IF THE MATERIAL REMAINS UNSUITABLE, THE CONTRACTOR SHALL UNDERCUT THIS MATERIAL AND REPLACE WITH APPROVED MATERIAL. ALL SUBGRADES SHALL BE PROOFROLLED WITH A FULLY LOADED TANDEM AXLE DUMP TRUCK PRIOR TO PAVING. ANY SOFTER MATERIAL SHALL BE REWORKED OR REPLACED.
- THE CONTRACTOR IS REQUIRED TO MAINTAIN ALL PIPES, DITCHES, AND OTHER DRAINAGE STRUCTURES FREE FROM OBSTRUCTION.

17. ALL TOWER DIMENSIONS SHALL BE VERIFIED WITH THE PLANS (LATEST REVISION) PRIOR TO COMMENCING CONSTRUCTION. NOTIFY THE ENGINEER IMMEDIATELY IF ANY DISCREPANCIES ARE DISCOVERED. THE OWNER SHALL HAVE A SET OF APPROVED PLANS AVAILABLE AT THE SITE AT ALL TIMES WHILE WORK IS BEING PERFORMED. A DESIGNATED RESPONSIBLE EMPLOYEE SHALL BE AVAILABLE FOR CONTACT BY GOVERNING AGENCY INSPECTORS.

18. THE PROJECT DEPICTED IN THESE PLANS QUALIFIES AS AN ELIGIBLE FACILITIES REQUEST ENTITLED TO EXPEDITED REVIEW UNDER 47 U.S.C. § 1455(A) AS A MODIFICATION OF AN EXISTING WIRELESS TOWER THAT INVOLVES THE COLLOCATION, REMOVAL, AND/OR REPLACEMENT OF TRANSMISSION EQUIPMENT THAT IS NOT A SUBSTANTIAL CHANGE UNDER CFR § 1.61000 (B)(7).

STRUCTURAL STEEL NOTES:

- THE FABRICATION AND ERECTION OF STRUCTURAL STEEL SHALL CONFORM TO THE AISC SPECIFICATION FOR MANUAL OF STEEL CONSTRUCTION, AISC, 15TH EDITION.
- UNLESS OTHERWISE NOTED, ALL STRUCTURAL ELEMENTS SHALL CONFORM TO THE FOLLOWING REQUIREMENTS:
A. STRUCTURAL STEEL, ASTM DESIGNATION A36.
B. ALL BOLTS, ASTM A325 TYPE I GALVANIZED HIGH STRENGTH BOLTS.
C. ALL NUTS, ASTM A563 CARBON AND ALLOY STEEL NUTS.
D. ALL WASHERS, ASTM F436 HARDENED STEEL WASHERS.
- ALL CONNECTIONS NOT FULLY DETAILED ON THESE PLANS SHALL BE DETAILED BY THE STEEL FABRICATOR IN ACCORDANCE WITH AISC SPECIFICATION FOR MANUAL OF STEEL CONSTRUCTION, AISC, 15TH EDITION.
- HOLES SHALL NOT BE FLAME CUT THROUGH STEEL UNLESS APPROVED BY THE ENGINEER.
- HOT-DIP GALVANIZE ALL ITEMS UNLESS OTHERWISE NOTED, AFTER FABRICATION WHERE PRACTICABLE. GALVANIZING: ASTM A123, ASTM, A153/A153M OR ASTM A653/A653M, G90, AS APPLICABLE.
- REPAIR DAMAGED SURFACES WITH GALVANIZING REPAIR METHOD AND PAINT CONFORMING TO ASTM A780 OR BY APPLICATION OF STICK OR THICK PASTE MATERIAL SPECIFICALLY DESIGNED FOR REPAIR OF GALVANIZING. CLEAN AREAS TO BE REPAIRED AND REMOVE SLAG FROM WELDS. HEAT SURFACES TO WHICH STICK OR PASTE MATERIAL IS APPLIED, WITH A TORCH TO A TEMPERATURE SUFFICIENT TO MELT THE METALLICS IN STICK OR PASTE; SPREAD MOLTEN MATERIAL UNIFORMLY OVER SURFACES TO BE COATED AND WIPE OFF EXCESS MATERIAL.
- A NUT LOCKING DEVICE SHALL BE INSTALLED ON ALL PROPOSED AND/OR REPLACED BOLTS.
- ALL PROPOSED AND/OR REPLACED BOLTS SHALL BE OF SUFFICIENT LENGTH TO EXCLUDE THE THREADS FROM THE SHEAR PLANE.
- ALL PROPOSED AND/OR REPLACED BOLTS SHALL BE OF SUFFICIENT LENGTH SUCH THAT THE END OF THE BOLT BE AT LEAST FLUSH WITH THE FACE OF THE NUT. IT IS NOT PERMITTED FOR THE BOLT END TO BE BELOW THE FACE OF THE NUT AFTER TIGHTENING IS COMPLETED.
- ALL ASSEMBLY AND ANCHOR BOLTS ARE TO BE TIGHTENED TO A "SNUG TIGHT" CONDITION AS DEFINED IN SECTION 8.1 OF THE AISC, "SPECIFICATION FOR STRUCTURAL JOINTS USING ASTM A325 OR A490 BOLTS", DATED JUNE 30, 2004.
- FLAT WASHERS ARE TO BE INSTALLED WITH BOLTS OVER SLOTTED HOLES.
- DO NOT OVER TORQUE ASSEMBLY BOLTS. GALVANIZING ON BOLTS, NUTS, AND STEEL PARTS MAY ACT AS A LUBRICANT, THUS OVER TIGHTENING MAY OCCUR AND MAY CAUSE BOLTS TO CRACK AND SNAP OFF.
- PAL NUTS ARE TO BE INSTALLED AFTER NUTS ARE TIGHT AND WITH EDGE LIP OUT. PAL NUTS ARE NOT REQUIRED WHEN SELF-LOCKING NUTS ARE PROVIDED.
- GALVANIZED ASTM A325 BOLTS SHALL NOT BE REUSED.
- WELDING SHALL BE PERFORMED IN ACCORDANCE WITH AMERICAN WELDING SOCIETY (AWS) D1.1-2020 STRUCTURAL WELDING CODE - STEEL.

SITE COORDINATES

UTILITY INFORMATION

UTILITY COORDINATION FIRM:
NAME: TEP OpCo, LLC
ADDRESS: 960 INDUSTRY DR
CITY STATE ZIP: TUKWILA, WA 98188
CONTACT: AARON WILSON
EMAIL: AWILSON@TEPGROUP.NET
PHONE: (480) 678-5559

APPLICANT CONTACT
NAME: TEP OpCo, LLC
ADDRESS: 3 MONROE PKWY, STE P #405
CITY STATE ZIP: LAKE OSWEGO, OR 97035
CONTACT: ALISON CANTOR
EMAIL: ACANTOR@TEPGROUP.NET
PHONE: (616) 821-7353

PROPERTY OWNER:
NAME: HAMSTRA NORTH RIDGE CENTER LLC & LAKE COUNTY TRUST CO TRUST#3841
ADDRESS: 12028 N 200 W
CITY STATE ZIP: WHEATFIELD, IN 46392
CONTACT: UNKNOWN

PLANNING & PERMIT SPECIALIST CONTACT:
NAME: TEP OpCo, LLC
ADDRESS: 3 MONROE PKWY, STE P #405
CITY STATE ZIP: LAKE OSWEGO, OR 97035
CONTACT: VICTORIA SCOTT
EMAIL: VSCOTT@TEPGROUP.NET
PHONE: (714) 837-8761

SHEET:	DESCRIPTION:	REV
T-1	TITLE SHEET & GENERAL NOTES	2
-	SURVEY BOUNDARY	-
-	SURVEY DETAIL	-
C-1.1	EXISTING SITE PLAN	2
C-1.2	PROPOSED SITE PLAN	2
C-2.1	COMPOUND LAYOUT	1
C-3.1	PROPOSED COMPOUND ELEVATION	1
C-4.1	EROSION CONTROL PLAN	1
C-4.2	SILT FENCE DETAILS	1
C-5.1	STRUCTURAL DETAILS I	1
C-5.2	STRUCTURAL DETAILS II	1
C-5.3	STRUCTURAL DETAILS III	1
E-1.1	ELECTRICAL DETAILS I	1
E-1.2	UTILITY ROUTING	1

CONTACT INFORMATION

SHEET INDEX

GENERAL NOTES

326 TRYON ROAD
RALEIGH, NC 27603-3530
OFFICE: (919) 861-6351
FAX: (919) 861-6880

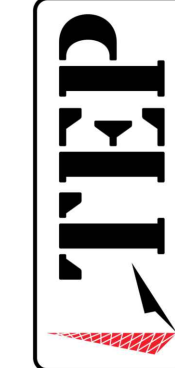

PLANS PREPARED BY:

2	06-04-26	CONSTRUCTION	CHECKED BY: JFJ
1	05-15-26	CONSTRUCTION	
0	04-01-26	CONSTRUCTION	
B	03-30-26	PRELIMINARY	
A	03-25-26	PRELIMINARY	
REV	DATE	ISSUED FOR:	

SITE NAME:
COLORADO SPRINGS,
CO - 100KM

7113 SPACE VILLAGE AVE,
COLORADO SPRINGS, CO 80929
(EL PASO COUNTY)

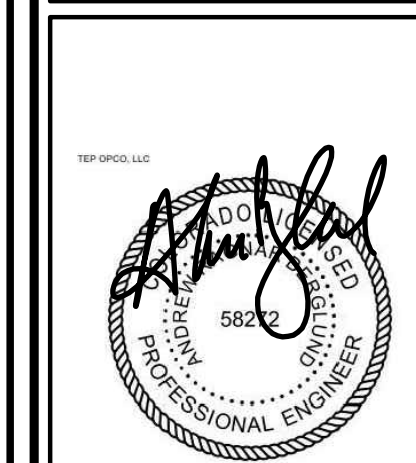

SHEET TITLE:
TITLE SHEET & GENERAL NOTES

SHEET NUMBER:
T-1

REVISION:
2

TEP # 353465-4993264

TEP IS A FAMILY OF COMPANIES LICENSED TO PROVIDE DIFFERENT SERVICES IN DIFFERENT JURISDICTIONS. PROFESSIONAL ENGINEERING AND LAND SURVEYING SERVICES ARE PROVIDED BY TEP OP CO LLC, A DELAWARE LIMITED LIABILITY COMPANY. TEP ENGINEERING, LLC, A NORTH CAROLINA PROFESSIONAL LIMITED LIABILITY COMPANY, OR W&H ENGINEERING, LLC, A NEW YORK PROFESSIONAL LIMITED LIABILITY COMPANY. GENERAL CONTRACTOR SERVICES ARE PROVIDED BY TEP OP CO LLC, A DELAWARE LIMITED LIABILITY COMPANY. WE ACQUIRE THE REQUISITE LICENSES IN EACH STATE. ADDITIONAL INFORMATION CAN BE OBTAINED FROM THE COMPANY.

NOTES:

1. THE BASIS OF THE MERIDIANS AND THE COORDINATES FOR THIS PLAT IS THE COLORADO STATE PLAN COORDINATE SYSTEM, NORTH AMERICAN DATUM (NAD 83/2011), BASED ON DIFFERENTIAL GPS OBSERVATIONS PERFORMED ON 04/02/2026 BY RLF CONSULTING.
2. VERTICAL INFORMATION SHOWN, BASED ON THE NORTH AMERICAN VERTICAL DATUM OF 1988 (NAVD '88) IN FEET
3. THE LEASE AREA IS LOCATED IN ZONE "X" DETERMINED TO BE OUTSIDE THE 0.2% ANNUAL CHANCE FLOOD HAZARD, ACCORDING TO FEMA COMMUNITY PANEL #08041C0754G, DATED 12/07/2018.
4. ALL DISTANCES ARE GROUND UNLESS OTHERWISE NOTED.

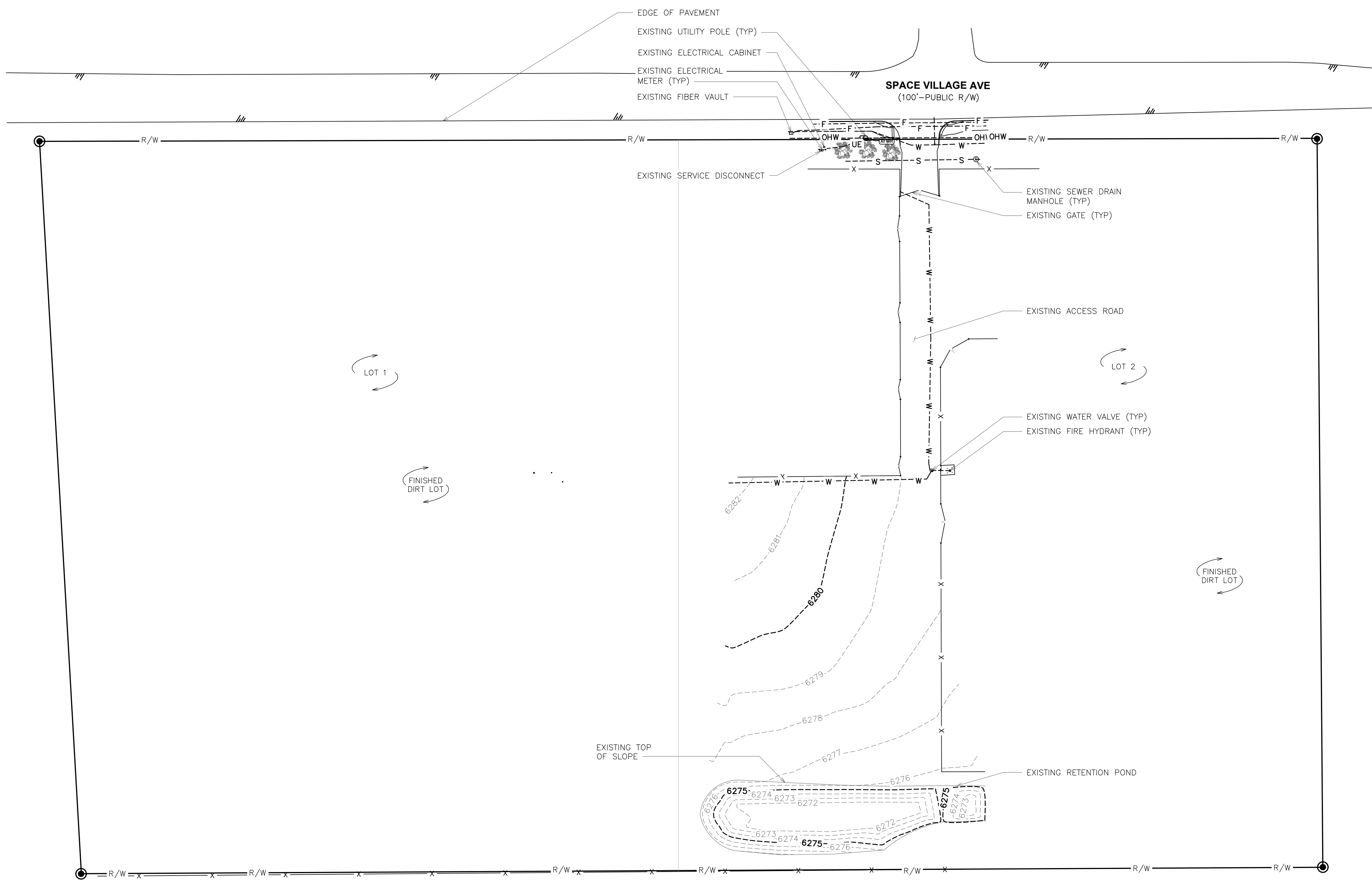
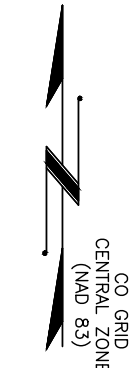

LEGEND	
	PROPOSED EASEMENT
	EXIST. PROPERTY LINE
	ADJ. PROPERTY LINE
	EXIST. UTILITY POLE
	EXIST. TELCO PEDESTAL
	EXIST. FIRE HYDRANT
	EXIST. TRANSFORMER
	EXIST. SEWER DRAIN MAN HOLE
	EXIST. WATER VALVE
	PROPERTY CORNER
	LEASE/EASE. CORNER
	EXIST. CONTOUR LINE
	EDGE OF PAVEMENT
	OVERHEAD WIRE
	RIGHT-OF-WAY
	CHAIN LINK FENCE
	EXISTING TREE LINE
	EXISTING WATER LINE
	EXISTING FIBER LINE
	EXISTING STORM DRAIN LINE
	EXISTING UNDERGROUND ELECTRICAL LINE
	EXISTING UTILITY EASEMENT

EXISTING SITE PLAN
SCALE: 1" = 60'

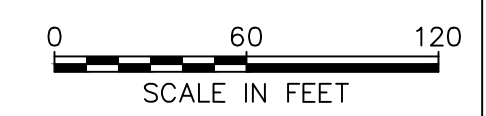

PLANS PREPARED BY:

REV	DATE	ISSUED FOR:	CHECKED BY:
2	06-04-26	CONSTRUCTION	JFJ
1	05-15-26	CONSTRUCTION	
0	04-01-26	CONSTRUCTION	
B	03-30-26	PRELIMINARY	
A	03-25-26	PRELIMINARY	
REV	DATE	ISSUED FOR:	CHECKED BY:

PROJECT INFORMATION:
SITE NAME:
COLORADO SPRINGS, CO - 100KM
 7113 SPACE VILLAGE AVE.
 COLORADO SPRINGS, CO 80929
 (EL PASO COUNTY)

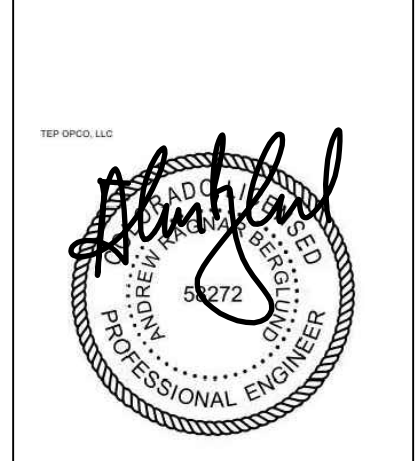

SEAL: 06-04-26

EXISTING SITE PLAN	
SHEET NUMBER:	C-1.1
REVISION:	2
TEP #:	353465-498368

326 TRYON ROAD
 RALEIGH, NC 27603-3330
 OFFICE (919) 861-6351
 FAX (919) 861-6880

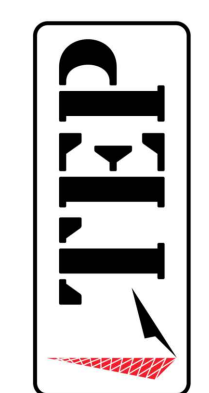

TEP IS A FAMILY OF COMPANIES LICENSED TO PROVIDE DIFFERENT SERVICES IN DIFFERENT JURISDICTIONS. DEPENDING ON THE JURISDICTION, PROFESSIONAL ENGINEERING AND LAND SURVEYING SERVICES ARE PROVIDED BY TEP OFCO LLC, A DELAWARE LIMITED LIABILITY COMPANY, TEP ENGINEERING, LLC, A NORTH CAROLINA PROFESSIONAL LIMITED LIABILITY COMPANY, OR M&H ENGINEERING, LLC, A NEW YORK PROFESSIONAL LIMITED LIABILITY COMPANY. GENERAL CONTRACTOR SERVICES ARE PROVIDED BY TEP OFCO LLC, A DELAWARE LIMITED LIABILITY COMPANY. WE ACQUIRE THE REQUISITE LICENSES IN EACH STATE. ADDITIONAL INFORMATION CAN BE OBTAINED FROM THE COMPANY.

NOTES:

1. THE BASIS OF THE MERIDIANS AND THE COORDINATES FOR THIS PLAT IS THE COLORADO STATE PLAN COORDINATE SYSTEM, NORTH AMERICAN DATUM (NAD 83/2011), BASED ON DIFFERENTIAL GPS OBSERVATIONS PERFORMED ON 04/02/2026 BY RLF CONSULTING.
2. VERTICAL INFORMATION SHOWN, BASED ON THE NORTH AMERICAN VERTICAL DATUM OF 1988 (NAVD '88) IN FEET
3. THE LEASE AREA IS LOCATED IN ZONE "X" DETERMINED TO BE OUTSIDE THE 0.2% ANNUAL CHANCE FLOOD HAZARD, ACCORDING TO FEMA COMMUNITY PANEL #08041C0754G, DATED 12/07/2018.
4. ALL DISTANCES ARE GROUND UNLESS OTHERWISE NOTED.

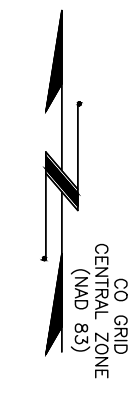

326 TRYON ROAD
RALEIGH, NC 27603-3330
OFFICE (919) 861-6351
FAX (919) 861-6350

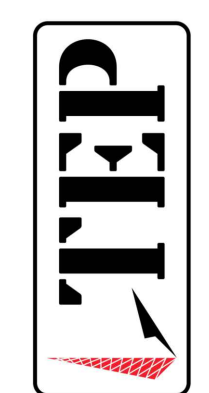

PLANS PREPARED BY:

2	06-04-26	CONSTRUCTION	CHECKED BY: JFJ
1	05-15-26	CONSTRUCTION	
0	04-01-26	CONSTRUCTION	
B	03-30-26	PRELIMINARY	
A	03-25-26	PRELIMINARY	
REV	DATE	ISSUED FOR:	
DRAWN BY: OJK			

PROJECT INFORMATION:
SITE NAME:
**COLORADO SPRINGS,
CO - 100KM**
7113 SPACE VILLAGE AVE.
COLORADO SPRINGS, CO 80929
(EL PASO COUNTY)

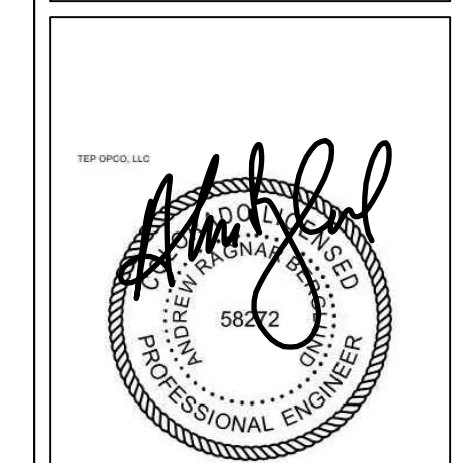

SEAL: **PROPOSED SITE PLAN**
REVISION: **2**
SHEET NUMBER: **C-1.2**
TEP # 353465-490365

TEP IS A FAMILY OF COMPANIES LICENSED TO PROVIDE DIFFERENT SERVICES IN DIFFERENT JURISDICTIONS. DEPENDING ON THE JURISDICTION, PROFESSIONAL ENGINEERING AND LAND SURVEYING SERVICES ARE PROVIDED BY TEP OFCO LLC, A DELAWARE LIMITED LIABILITY COMPANY, TEP ENGINEERING, LLC, A NORTH CAROLINA PROFESSIONAL LIMITED LIABILITY COMPANY, OR M&H ENGINEERING, LLC, A NEW YORK PROFESSIONAL LIMITED LIABILITY COMPANY. GENERAL CONTRACTOR SERVICES ARE PROVIDED BY TEP OFCO LLC, A DELAWARE LIMITED LIABILITY COMPANY. WE ACQUIRE THE REQUISITE LICENSES IN EACH STATE. ADDITIONAL INFORMATION CAN BE OBTAINED FROM THE COMPANY.

LEGEND	
---	PROPOSED EASEMENT
---	EXIST. PROPERTY LINE
---	ADJ. PROPERTY LINE
⊕	EXIST. UTILITY POLE
⊕	EXIST. TELCO PEDESTAL
⊕	EXIST. FIRE HYDRANT
⊕	EXIST. TRANSFORMER
⊕	EXIST. SEWER DRAIN MAN HOLE
⊕	EXIST. WATER VALVE
⊕	PROPERTY CORNER
●	LEASE/EASE. CORNER
---	EXIST. CONTOUR LINE
---	EDGE OF PAVEMENT
---	OVERHEAD WIRE
---	RIGHT-OF-WAY
X	CHAIN LINK FENCE
---	EXISTING TREE LINE
---	EXISTING WATER LINE
---	EXISTING FIBER LINE
---	EXISTING STORM DRAIN LINE
---	EXISTING UNDERGROUND ELECTRICAL LINE
---	EXISTING UTILITY EASEMENT

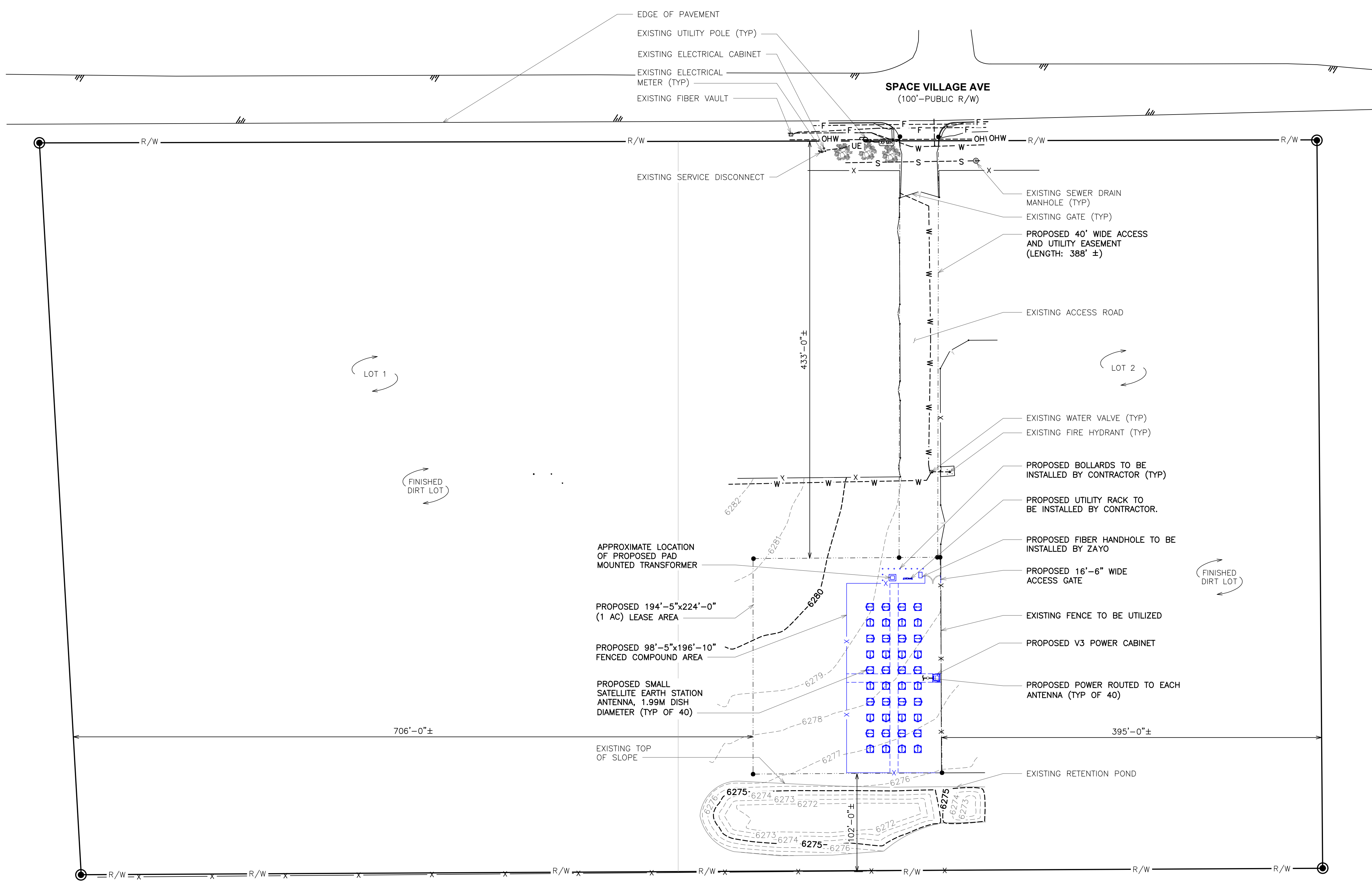

PROPOSED SITE PLAN
SCALE: 1" = 60'

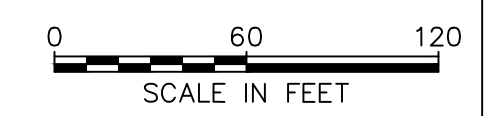

NOTES:

1. THE BASIS OF THE MERIDIANS AND THE COORDINATES FOR THIS PLAT IS THE COLORADO STATE PLAN COORDINATE SYSTEM, NORTH AMERICAN DATUM (NAD 83/2011), BASED ON DIFFERENTIAL GPS OBSERVATIONS PERFORMED ON 04/02/2026 BY RLF CONSULTING.
2. VERTICAL INFORMATION, SHOWN, BASED ON THE NORTH AMERICAN VERTICAL DATUM OF 1988 (NAVD '88) IN FEET
3. THE LEASE AREA IS LOCATED IN ZONE "X" DETERMINED TO BE OUTSIDE THE 0.2% ANNUAL CHANCE FLOOD HAZARD, ACCORDING TO FEMA COMMUNITY PANEL #08041C0754G, DATED 12/07/2018.
4. ALL DISTANCES ARE GROUND UNLESS OTHERWISE NOTED.

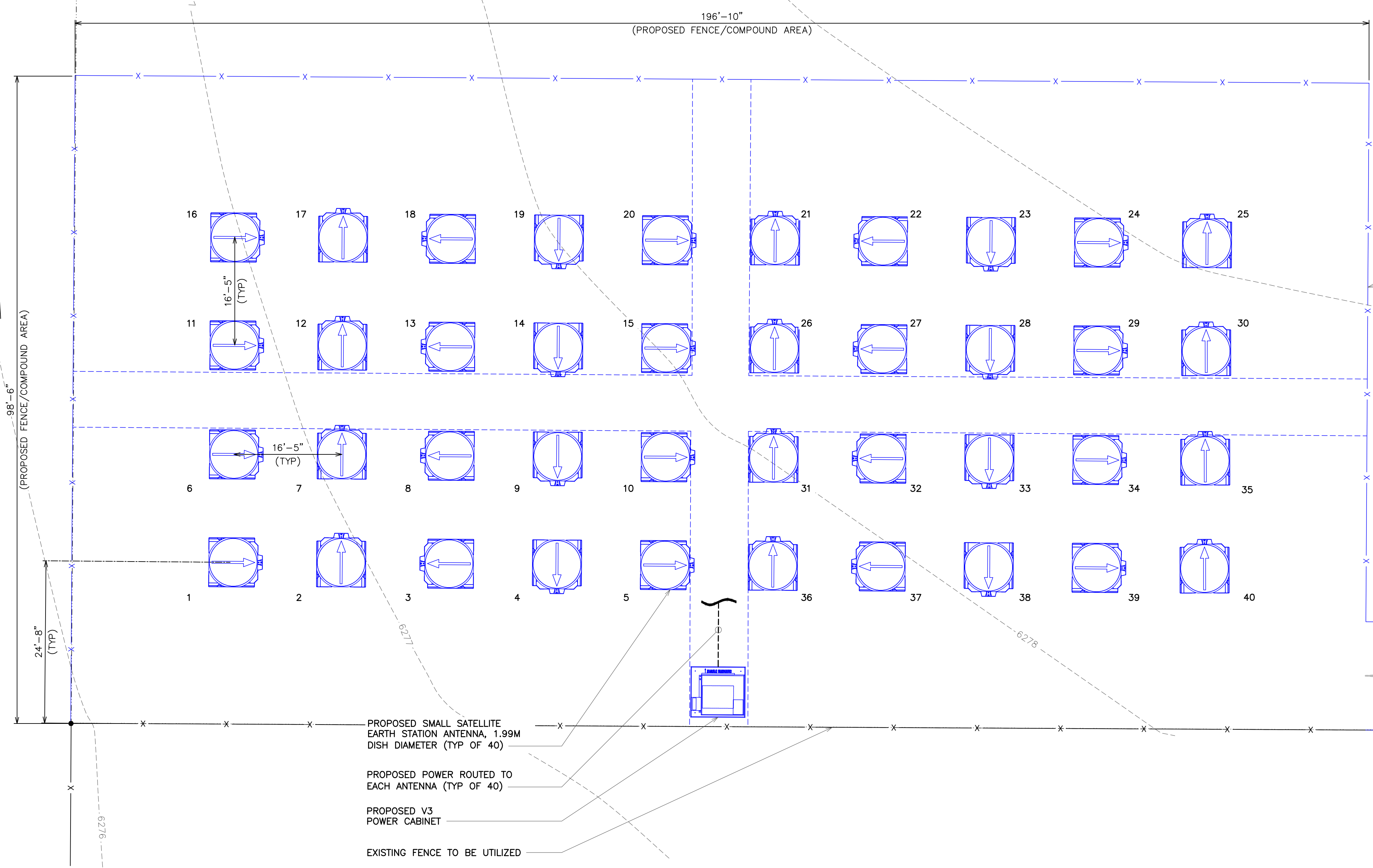

PROPOSED 194'-5"x224'-0"
(1 AC) LEASE AREA

PROPOSED 98'-5"x196'-10"
FENCED COMPOUND AREA

APPROXIMATE LOCATION
OF PROPOSED PAD
MOUNTED TRANSFORMER

PROPOSED BOLLARDS
TO BE INSTALLED BY
THE CONTRACTOR (TYP)

PROPOSED UTILITY RACK TO BE
INSTALLED BY CONTRACTOR.

PROPOSED FIBER HANDHOLE TO
BE INSTALLED BY ZAYO

PROPOSED 16'-6" WIDE
ACCESS GATE

PROPOSED SMALL SATELLITE
EARTH STATION ANTENNA, 1.99M
DISH DIAMETER (TYP OF 40)

PROPOSED POWER ROUTED TO
EACH ANTENNA (TYP OF 40)

PROPOSED V3
POWER CABINET

EXISTING FENCE TO BE UTILIZED

PLANS PREPARED BY:

CONSTRUCTION	05-15-26	DATE	05-25-26	ISSUED FOR:	PRELIMINARY
CONSTRUCTION	04-01-26	DATE	03-30-26	ISSUED FOR:	PRELIMINARY
CONSTRUCTION	03-30-26	DATE	03-25-26	ISSUED FOR:	PRELIMINARY
CONSTRUCTION	03-25-26	DATE	03-25-26	ISSUED FOR:	PRELIMINARY

DRAWN BY: OJK
CHECKED BY: JFJ

SITE NAME:
**COLORADO SPRINGS,
CO - 100KM**

7113 SPACE VILLAGE AVE.
COLORADO SPRINGS, CO 80929
(EL PASO COUNTY)

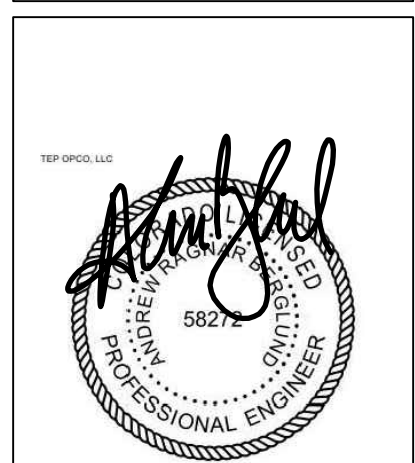

SEAL: 05-15-26

**PROPOSED
COMPOUND LAYOUT**

SHEET NUMBER: **C-2.1**

REVISION: 1

TEP # 353465-490368

PROPOSED COMPOUND LAYOUT

SCALE: 1" = 10'

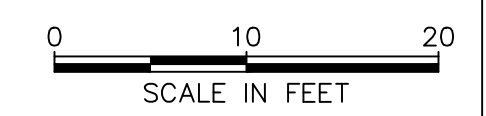

TEP IS A FAMILY OF COMPANIES LICENSED TO PROVIDE DIFFERENT SERVICES IN DIFFERENT JURISDICTIONS. DEPENDING ON THE JURISDICTION, PROFESSIONAL ENGINEERING AND LAND SURVEYING SERVICES ARE PROVIDED BY TEP OFCO LLC, A DELAWARE LIMITED LIABILITY COMPANY, TEP ENGINEERING, LLC, A NORTH CAROLINA PROFESSIONAL LIMITED LIABILITY COMPANY, OR M&H ENGINEERING, LLC, A NEW YORK PROFESSIONAL LIMITED LIABILITY COMPANY. GENERAL CONTRACTOR SERVICES ARE PROVIDED BY TEP OFCO LLC, A DELAWARE LIMITED LIABILITY COMPANY. WE ACQUIRE THE REQUISITE LICENSES IN EACH STATE. ADDITIONAL INFORMATION CAN BE OBTAINED FROM THE COMPANY.

NOTES:

1. CONTRACTOR TO ENSURE POSITIVE DRAINAGE ACROSS COMPOUND.
2. CONTRACTOR SHALL MAINTAIN A MAXIMUM OF 5% SLOPE ACROSS THE COMPOUND.
3. CONTRACTOR SHALL MAINTAIN A MAXIMUM OF 18% SLOPE ACROSS THE ACCESS DRIVE.
4. FIBER AND POWER NOT DOWN FOR CLARITY.
5. EQUIPMENT NOT SHOWN FOR CLARITY.

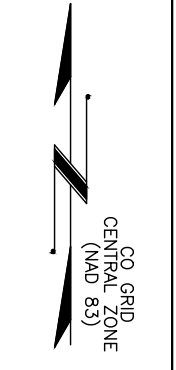
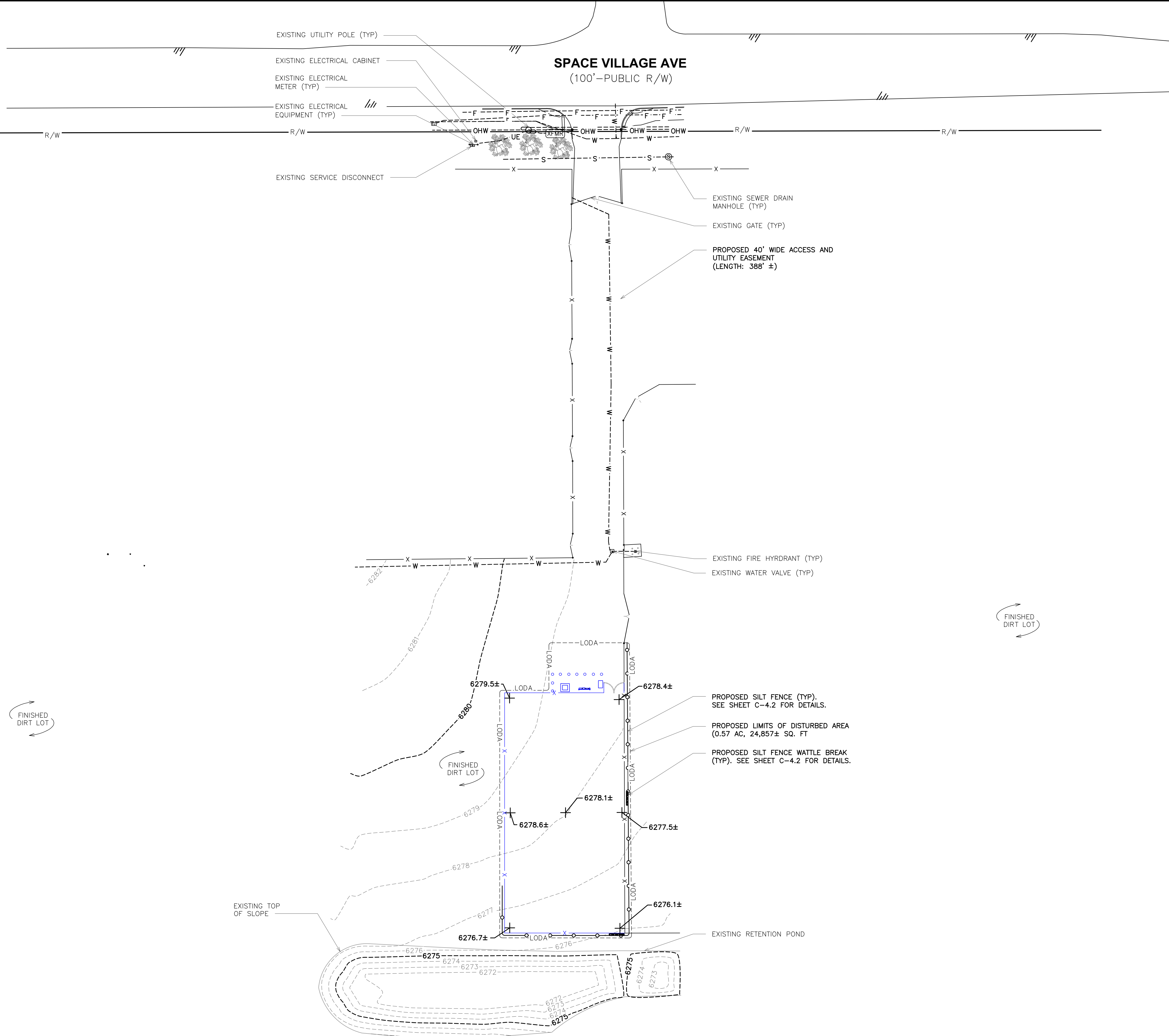

EROSION CONTROL PLAN

SCALE: 1" = 40'



PLANS PREPARED BY:

1	05-15-26	CONSTRUCTION	
0	04-01-26	CONSTRUCTION	
B	03-30-26	PRELIMINARY	
A	03-25-26	PRELIMINARY	
REV	DATE	ISSUED FOR:	
DRAWN BY: OJK		CHECKED BY: JFJ	

PROJECT INFORMATION:
SITE NAME:
COLORADO SPRINGS, CO - 100KM
 7113 SPACE VILLAGE AVE.
 COLORADO SPRINGS, CO 80929
 (EL PASO COUNTY)

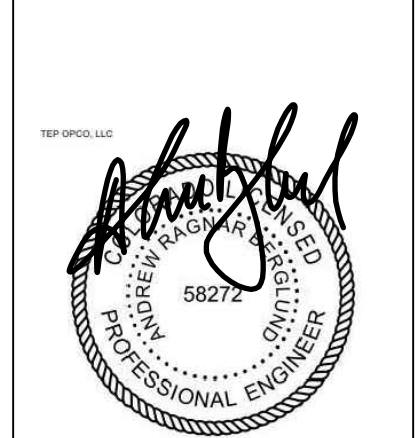

SEAL: 05-15-26

SHEET TITLE:
EROSION CONTROL PLAN
C-4.1
 SHEET NUMBER: 1
 REVISION: 1
 TEP # 353465-498368

TEP IS A FAMILY OF COMPANIES LICENSED TO PROVIDE DIFFERENT SERVICES IN DIFFERENT JURISDICTIONS. DEPENDING ON THE JURISDICTION, PROFESSIONAL ENGINEERING AND LAND SURVEYING SERVICES ARE PROVIDED BY TEP OFCO LLC, A DELAWARE LIMITED LIABILITY COMPANY, TEP ENGINEERING, LLC, A NORTH CAROLINA PROFESSIONAL LIMITED LIABILITY COMPANY, OR M&H ENGINEERING, LLC, A NEW YORK PROFESSIONAL LIMITED LIABILITY COMPANY. GENERAL CONTRACTOR SERVICES ARE PROVIDED BY TEP OFCO LLC, A DELAWARE LIMITED LIABILITY COMPANY. WE ACQUIRE THE REQUISITE LICENSES IN EACH STATE. ADDITIONAL INFORMATION CAN BE OBTAINED FROM THE COMPANY.

NOTES:

1. FILTER FABRIC SHALL CONFORM TO THE REQUIREMENTS LISTED IN ASTM D 6461.
2. ENDS OF INDIVIDUAL FILTER FABRIC SHALL BE SECURELY FASTENED AT A SUPPORT POST WITH 4 FEET MINIMUM OVERLAP TO THE NEXT POST.
3. PLACE 10 INCHES OF FABRIC ALONG THE BOTTOM AND SIDE OF THE TRENCH.
4. INSPECT SEDIMENT FENCE(S) AT LEAST ONCE A WEEK AND AFTER EACH RAINFALL.
5. REMOVE SEDIMENT DEPOSITS AS NECESSARY TO PROVIDE ADEQUATE STORAGE VOLUME FOR THE NEXT RAIN AND TO REDUCE PRESSURE ON THE FENCE.
6. AFTER CONSTRUCTION IS COMPLETE, THE CONTRACTOR SHALL REMOVE ALL FENCING MATERIALS AND UNSTABLE SEDIMENT DEPOSITS, BRING THE AREA TO GRADE AND PROPERLY STABILIZE THE SITE.

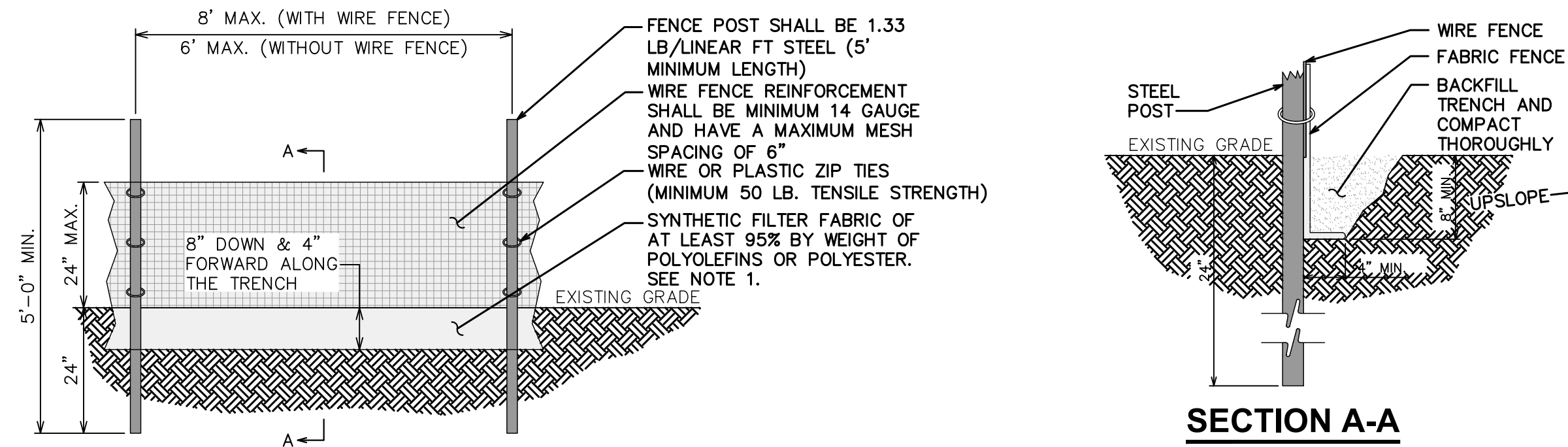

SILT FENCE DETAIL

SCALE: N.T.S.

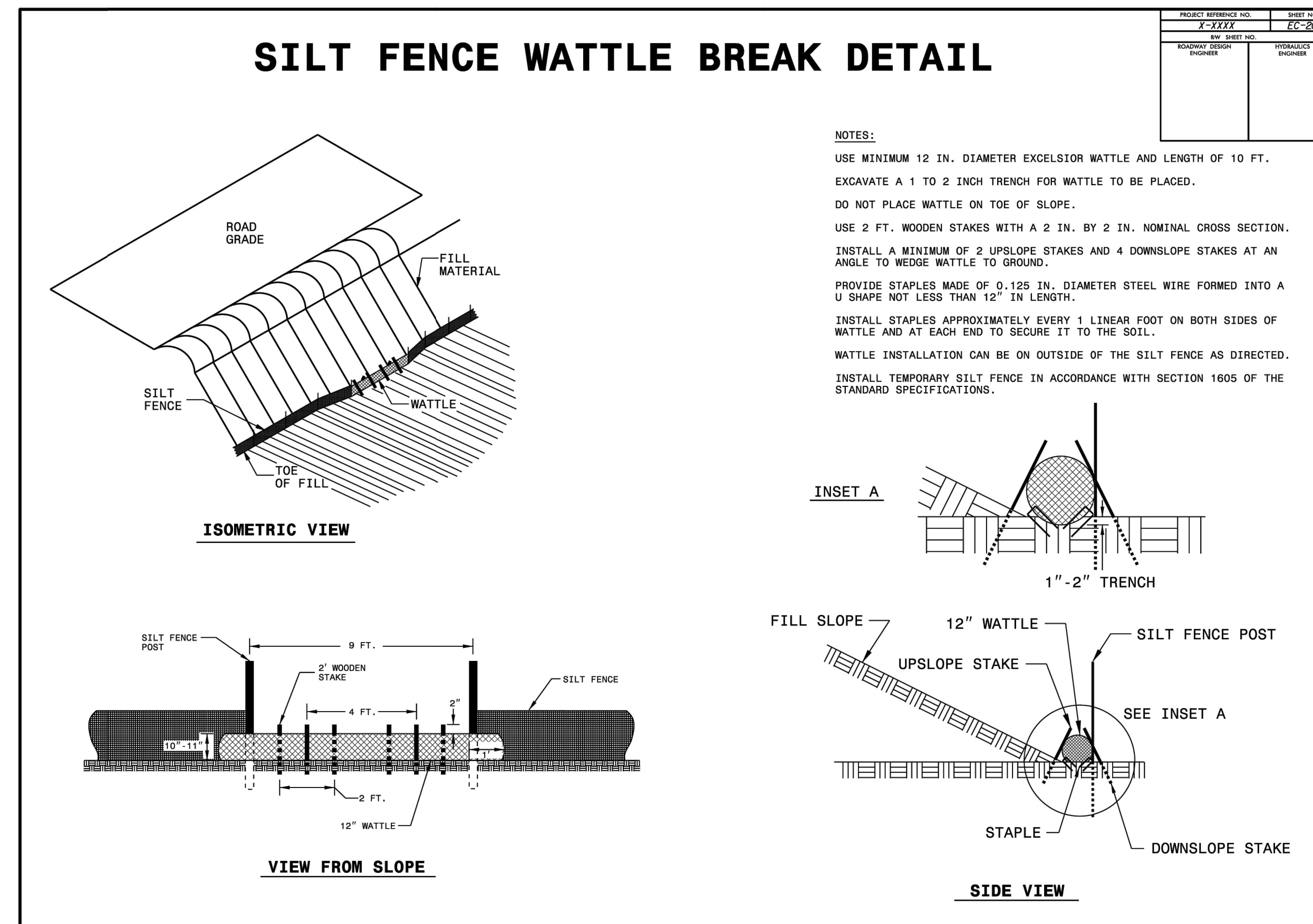

SILT FENCE WATTLE BREAK DETAIL

SCALE: N.T.S.

326 TRYON ROAD
 RALEIGH, NC 27603-3330
 OFFICE (919) 861-6351
 FAX (919) 861-6360



PLANS PREPARED BY:

1	05-15-26	CONSTRUCTION	
0	04-01-26	CONSTRUCTION	
B	03-30-26	PRELIMINARY	
A	03-25-26	PRELIMINARY	
REV	DATE	ISSUED FOR:	
		DRAWN BY: OJK	CHECKED BY: JFJ

PROJECT INFORMATION:
SITE NAME:
**COLORADO SPRINGS,
 CO - 100KM**
 7113 SPAGE VILLAGE AVE.
 COLORADO SPRINGS, CO 80929
 (EL PASO COUNTY)

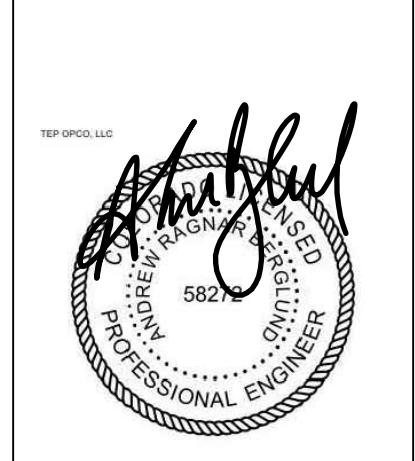

SCALE: 05-15-26

SILT FENCE DETAILS

SHEET NUMBER: **C-4.2**

REVISION: 1

TEP # 3353465-499365

TEP IS A FAMILY OF COMPANIES LICENSED TO PROVIDE DIFFERENT SERVICES IN DIFFERENT JURISDICTIONS. DEPENDING ON THE JURISDICTION, PROFESSIONAL ENGINEERING AND LAND SURVEYING SERVICES ARE PROVIDED BY TEP OFCO LLC, A DELAWARE LIMITED LIABILITY COMPANY, TEP ENGINEERING, LLC, A NORTH CAROLINA PROFESSIONAL LIMITED LIABILITY COMPANY, OR M&H ENGINEERING, LLC, A NEW YORK PROFESSIONAL LIMITED LIABILITY COMPANY. GENERAL CONTRACTOR SERVICES ARE PROVIDED BY TEP OFCO LLC, A DELAWARE LIMITED LIABILITY COMPANY. WE ACQUIRE THE REQUISITE LICENSES IN EACH STATE. ADDITIONAL INFORMATION CAN BE OBTAINED FROM THE COMPANY.

NOTES:

1. ALL STUB-UP CONDUITS INSIDE PULL BOXES WILL BE 6" FROM TOP OF BOX AND HAVE PULL STRING AND CAPS.
2. CONTRACTOR TO DETERMINE SIZE OF PULL BOX BASED ON FIELD CONDITIONS, NUMBER OF CONDUITS REQUIRED & NEC REQUIREMENTS.

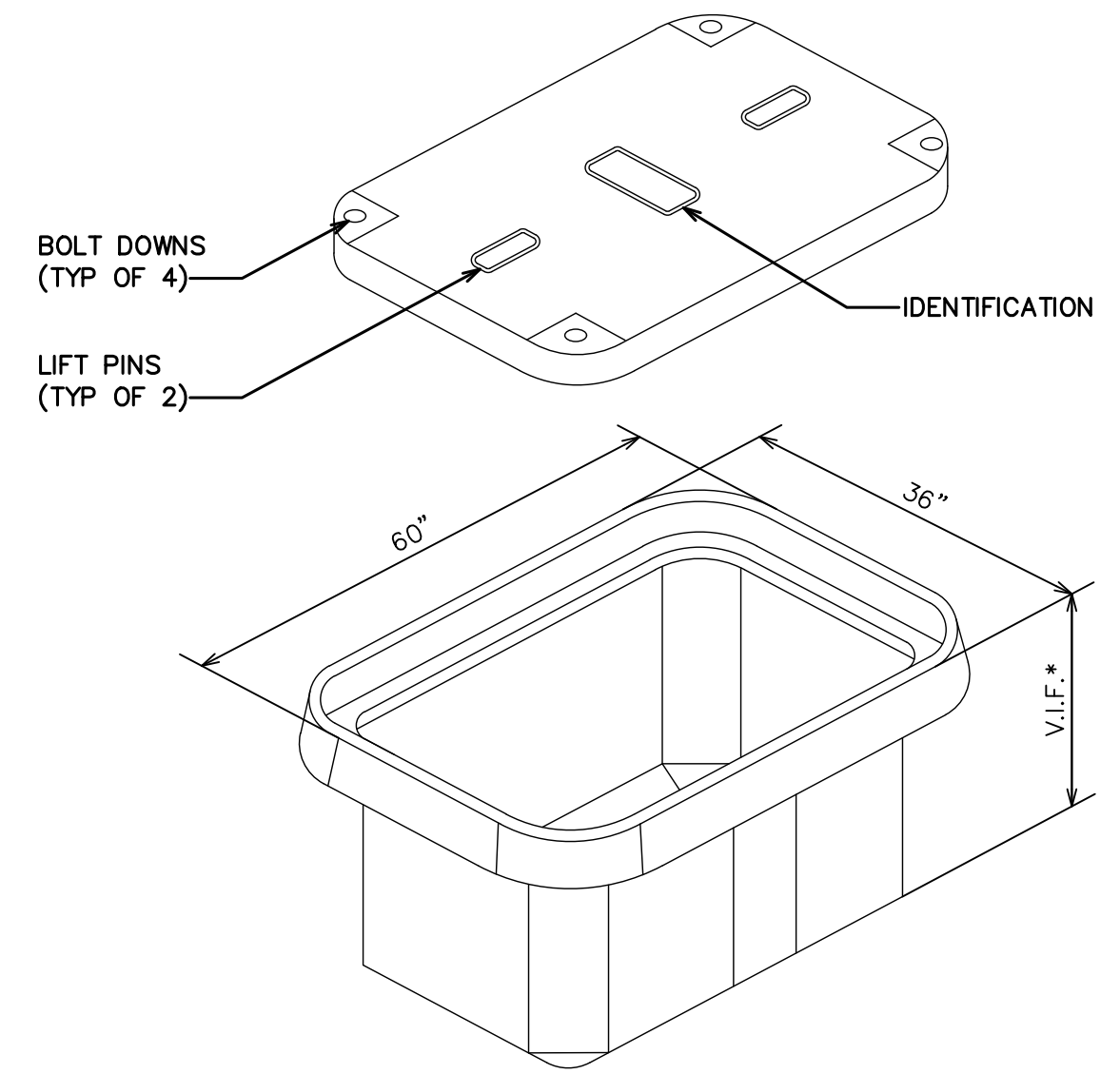

HAND HOLE/PULL BOX DETAIL

SCALE: N.T.S

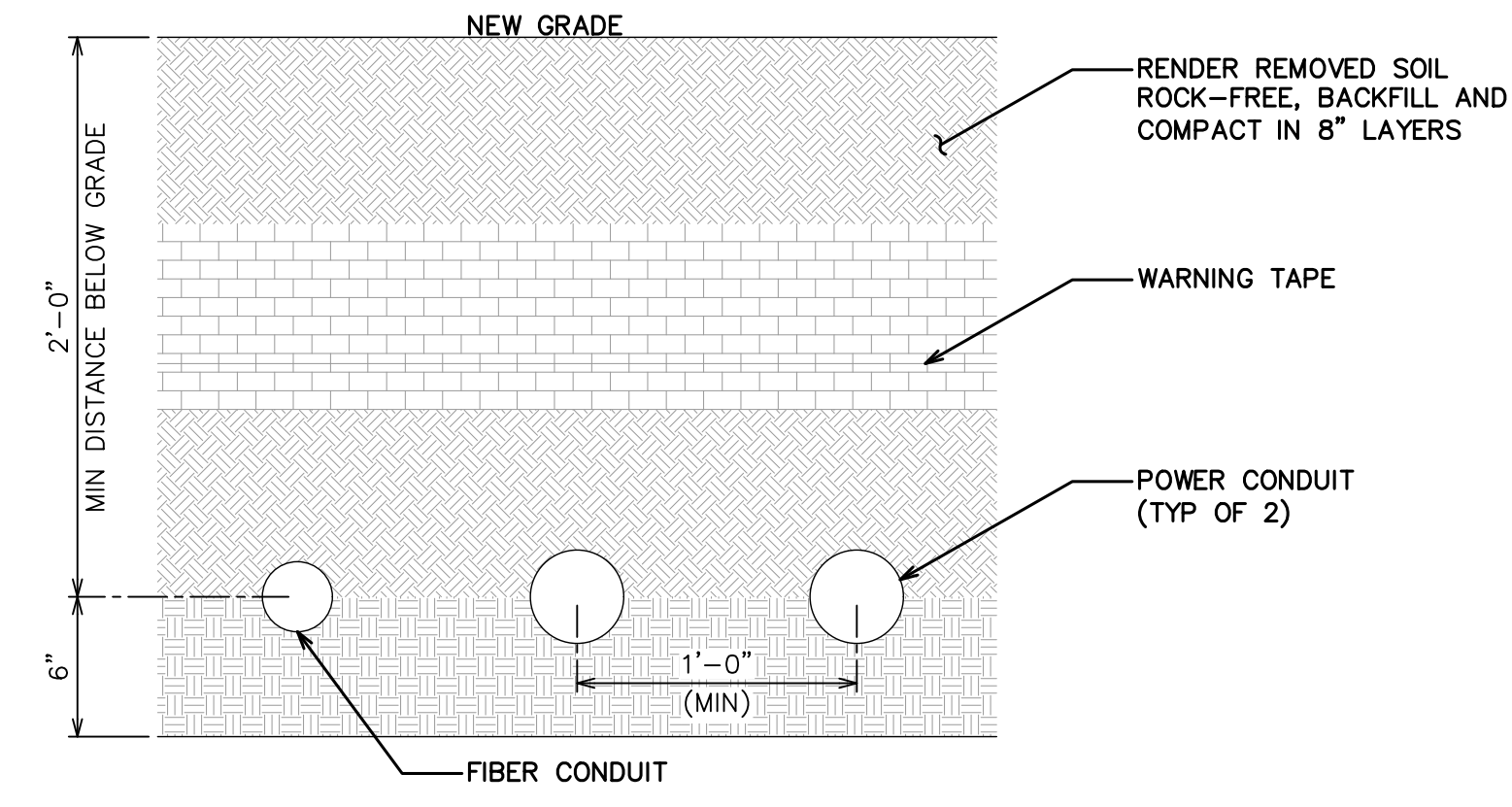

TRENCH DETAIL

SCALE: N.T.S

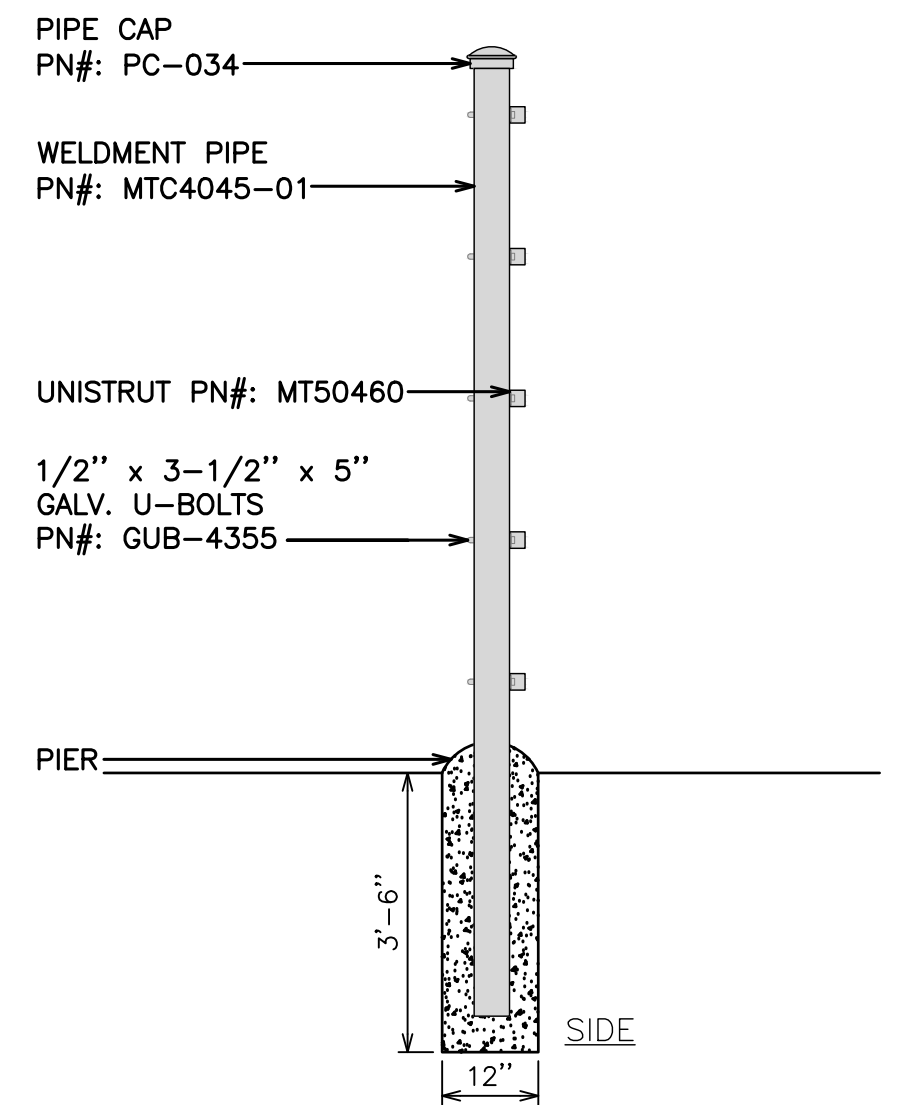

UNISTRUT CONNECTION DETAIL

SCALE: N.T.S

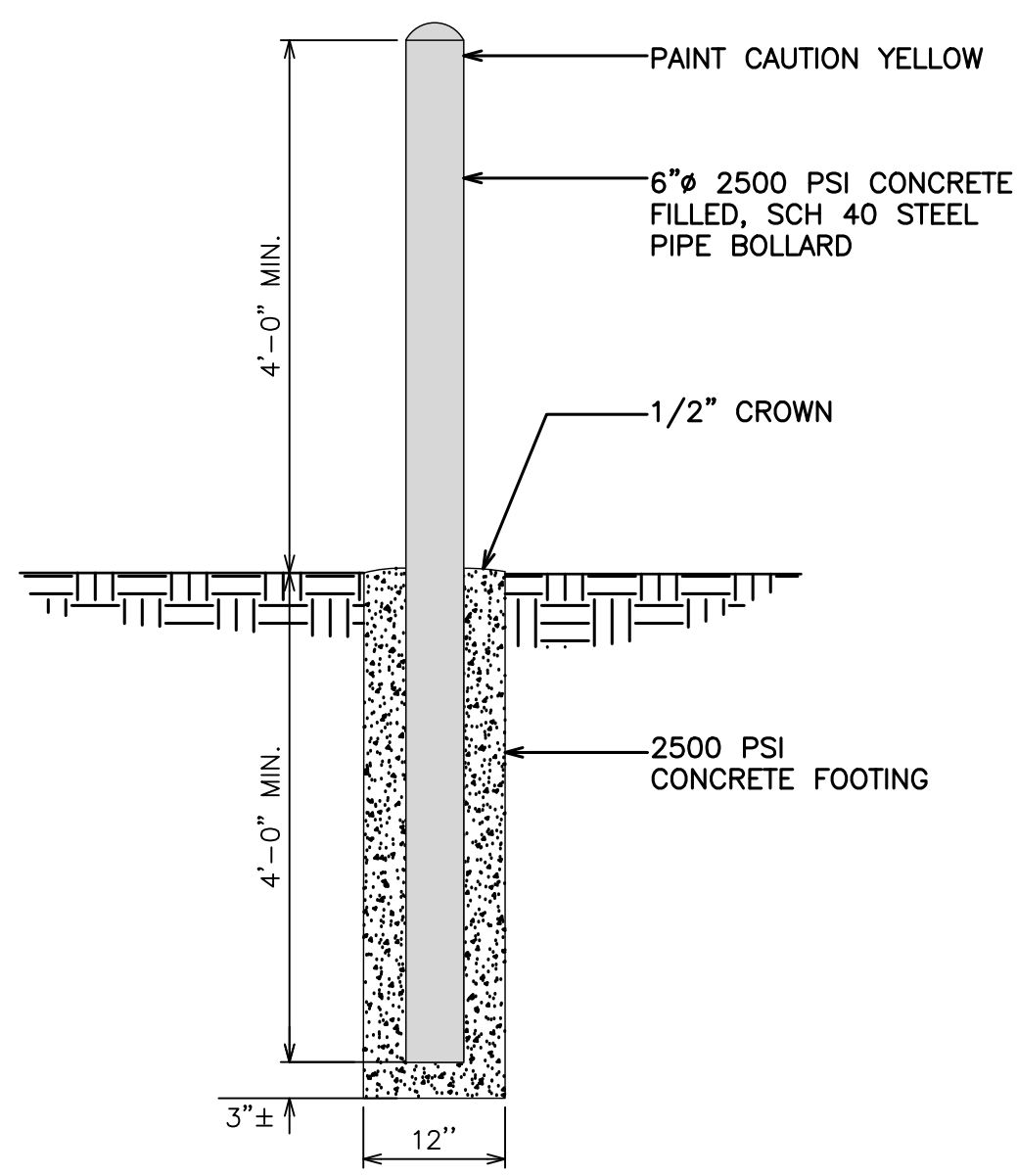

STANDARD BOLLARD DETAIL

SCALE: N.T.S

NOTES:

1. FENCE RATED TO 110 MPH WIND SPEED. REDUCE SPACING BY 0.3 M PER 10 MPH TO INCREASE RATING CMU FENCE REQUIRED ABOVE 150 MPH RATING.
2. POST DESIGN BASED ON 1,500 PSF SOIL BEARING CAPACITY.
3. ALL BACKFILL SHALL BE THOROUGHLY COMPACTED TO A MINIMUM OF 95% DENSITY USING THE MODIFIED PROCTOR METHOD.
4. ALL CONCRETE WORK SHALL BE PERFORMED IN ACCORDANCE WITH ACI-318-14.

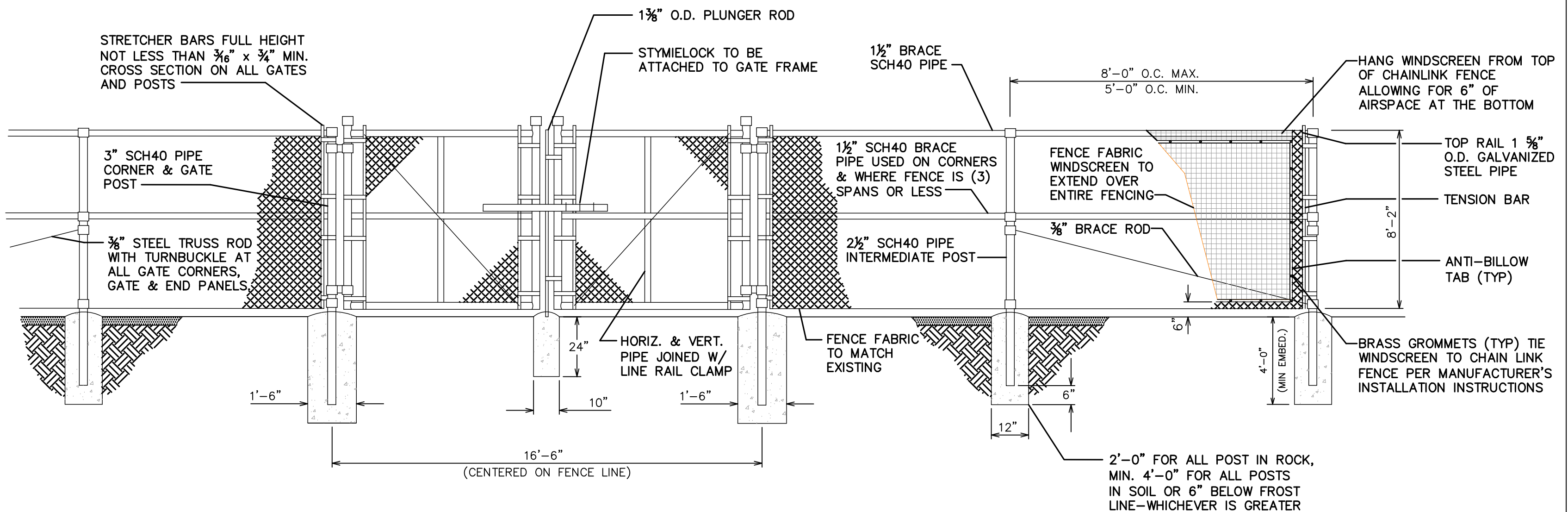

FENCE AND ACCESS GATE

SCALE: N.T.S.

NOTES:

1. SIGNS SHALL BE MADE OF ALUMINUM WITH 1/8" HOLES 1/2" FROM EACH CORNER TO HANG SIGNS ON FENCE.
2. SIGNS SHALL BE INSTALLED ON GATE
3. SIGNS SHALL BE INSTALLED WITH CENTER AT 5' ABOVE FINISHED GRADE.



SIZE = 12"x18" ALUMINUM SIGN
THICKNESS = 0.05" (1/16") OR CLOSEST STANDARD THICKNESS
QUANTITY = 1

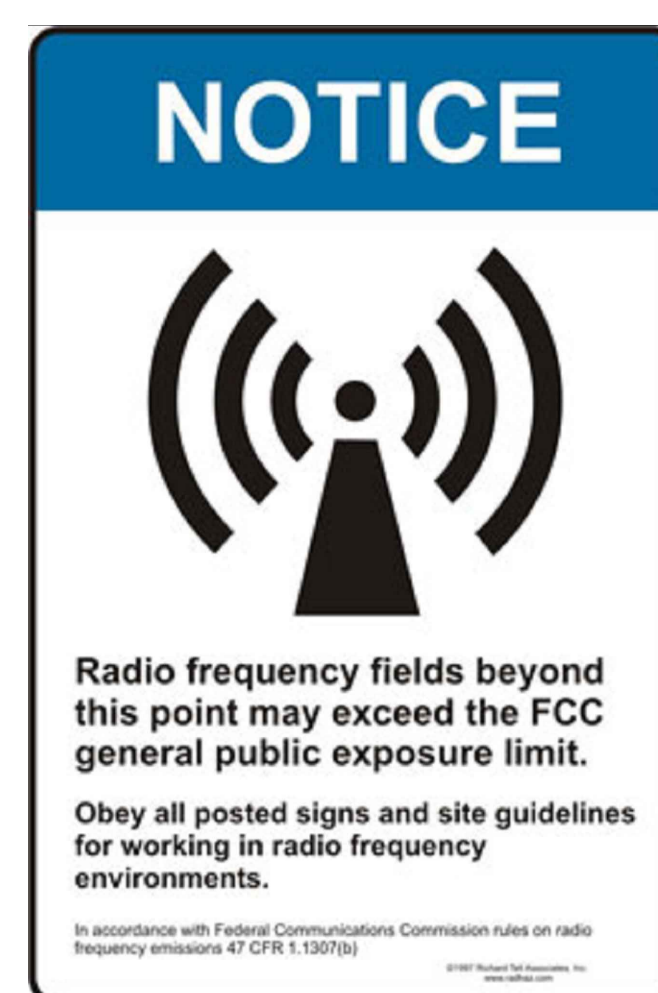

SIZE = 12"x18" ALUMINUM SIGN
THICKNESS = 0.05" (1/16") OR CLOSEST STANDARD THICKNESS
QUANTITY = 1

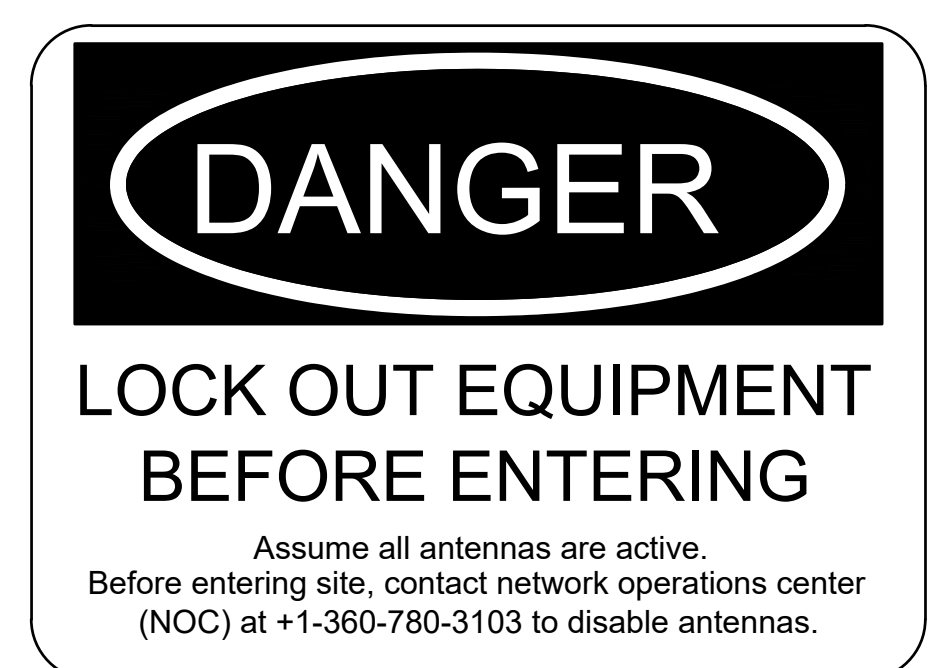

SIZE = 12"x16" ALUMINUM SIGN
THICKNESS = 0.05" (1/16") OR CLOSEST STANDARD THICKNESS
QUANTITY = 1

SIGNS & SPECIFICATIONS

SCALE: N.T.S

326 TRYON ROAD
RALEIGH, NC 27603-3330
OFFICE: (919) 861-6351
FAX: (919) 861-6880



PLANS PREPARED BY:

1	05-15-26	CONSTRUCTION	DATE	CHECKED BY: JFJ
0	04-01-26	CONSTRUCTION	DATE	
B	03-30-26	PRELIMINARY	DATE	
A	03-25-26	PRELIMINARY	DATE	
REV		ISSUED FOR:		

PROJECT INFORMATION:

SITE NAME:
COLORADO SPRINGS,
CO - 100KM
7113 SEAPE VILLAGE AVE.
COLORADO SPRINGS, CO 80929
(EL PASO COUNTY)

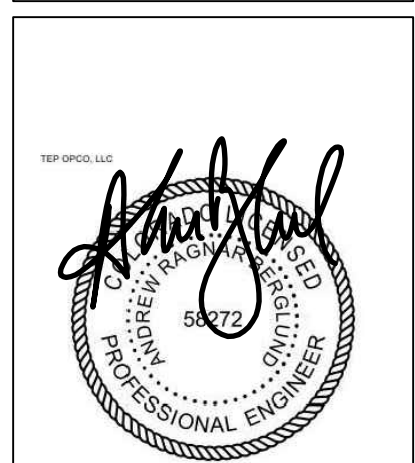

SCALE:

STRUCTURAL DETAILS I	REVISION:	1
	SHEET NUMBER:	C-5.1

TEP IS A FAMILY OF COMPANIES LICENSED TO PROVIDE DIFFERENT SERVICES IN DIFFERENT JURISDICTIONS. DEPENDING ON THE JURISDICTION, PROFESSIONAL ENGINEERING AND LAND SURVEYING SERVICES ARE PROVIDED BY TEP OFCO LLC, A DELAWARE LIMITED LIABILITY COMPANY, TEP ENGINEERING, LLC, A NORTH CAROLINA PROFESSIONAL LIMITED LIABILITY COMPANY, OR M&H ENGINEERING, LLC, A NEW YORK PROFESSIONAL LIMITED LIABILITY COMPANY. GENERAL CONTRACTOR SERVICES ARE PROVIDED BY TEP OFCO LLC, A DELAWARE LIMITED LIABILITY COMPANY. WE ACQUIRE THE REQUISITE LICENSES IN EACH STATE. ADDITIONAL INFORMATION CAN BE OBTAINED FROM THE COMPANY.

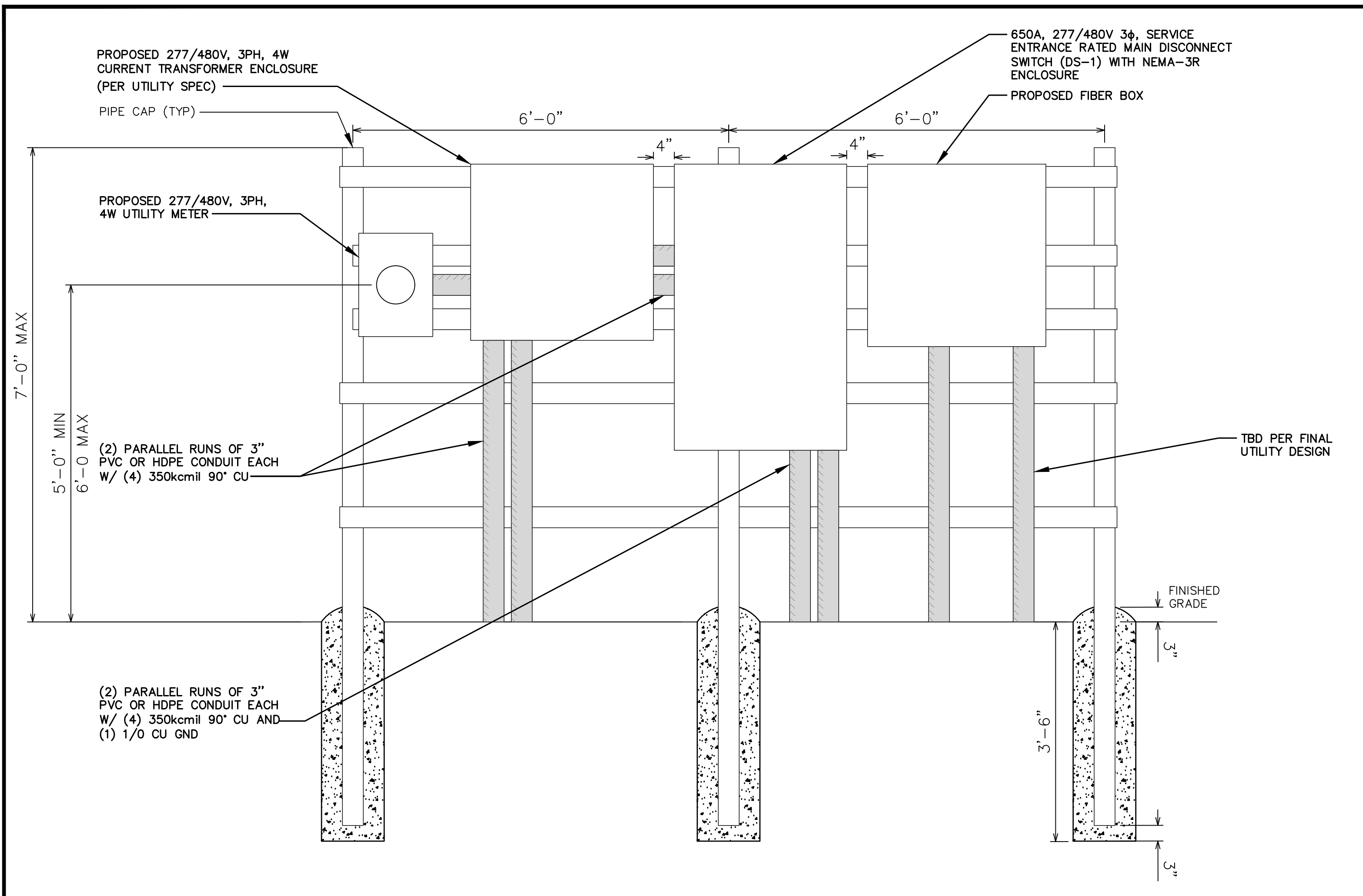

UTILITY RACK MOUNTING DETAIL

SCALE: N.T.S

NOTES:

- UNIT MASS:
ANTENNA: 2180 LBS
CONCRETE BASE: 2990 LBS
COMPLETE ASSEMBLY: 5170 LBS
BASE LOADING: 152 PSF
- POWER REQUIREMENT: 340V TO 530V THREE PHASE AC 43HZ TO 67 HZ MAXIMUM CURRENT DRAW: 18A
- POWER CABLE:
LENGTH: 40M
CONNECTION: NEMA 16-30 LOCKING PLUG
- FIBER CABLE:
LENGTH: 40M
CONNECTION: DUPLEX LC-LC AND MP016-MPO-16 CABLE: SINGLE 7MM OD, UV RESISTANT PE JACKET CONTAINING BOTH (1) 2S OS2 SINGLE MODE FIBER AND (2) 16X OM4 MULTIMODE FIBER.
- MAXIMUM WIND RATING: 170 MPH

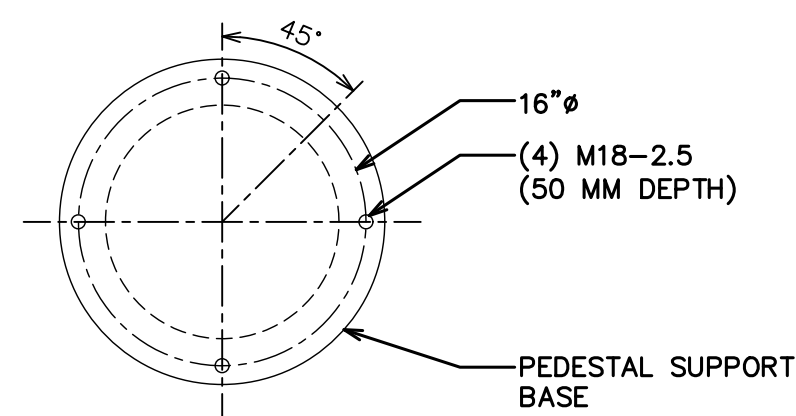

BOLT PATTERN

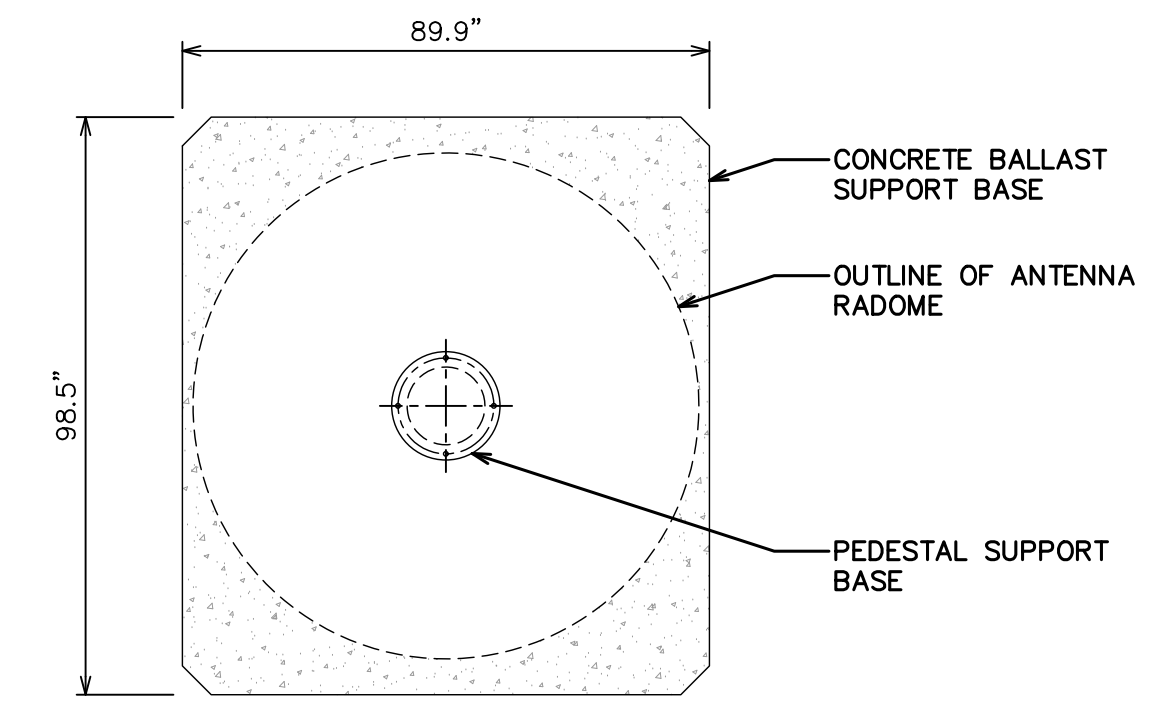

PLAN VIEW

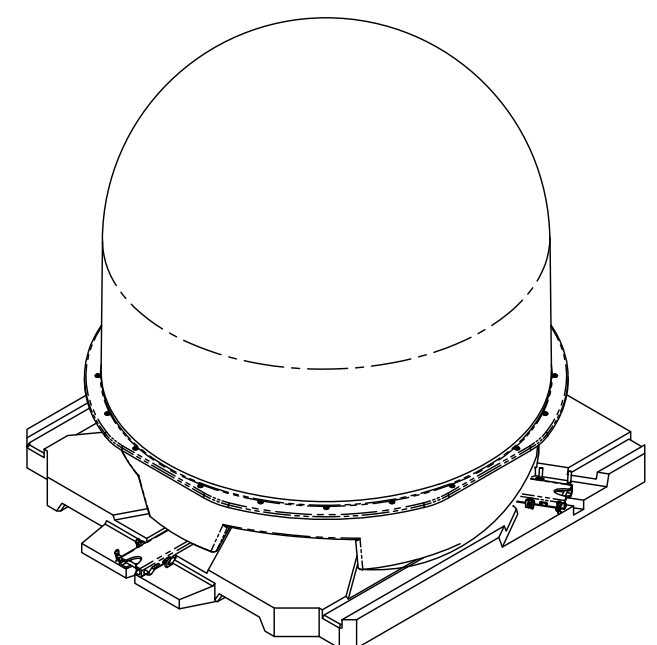

ISOMETRIC VIEW

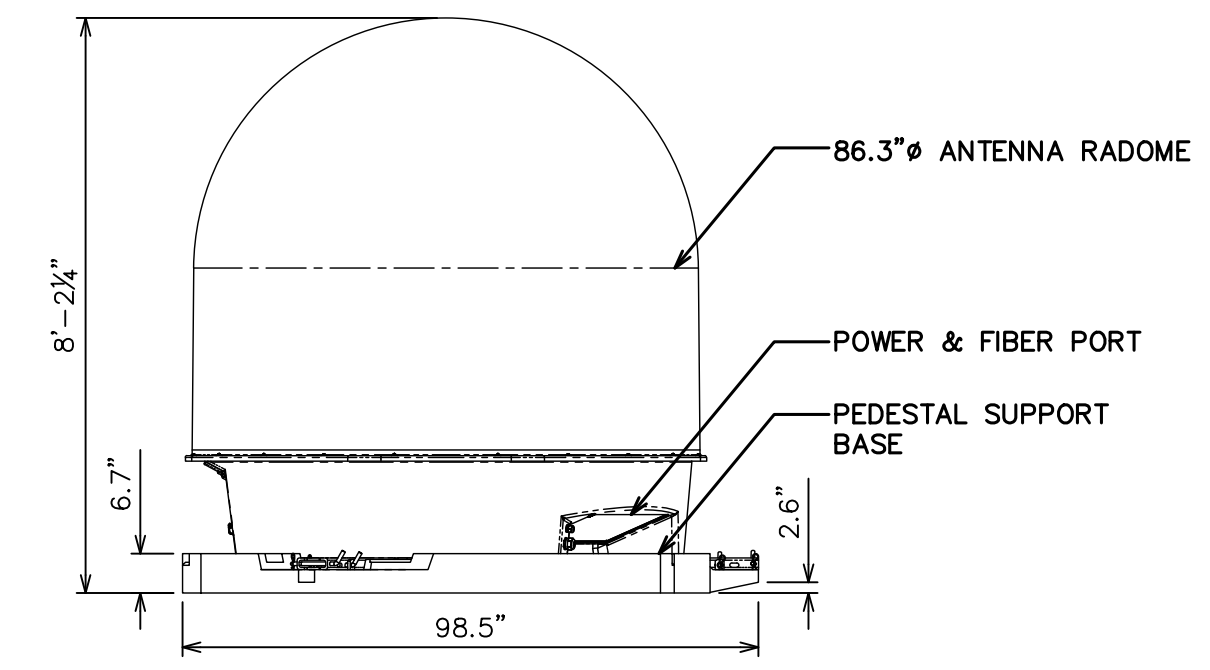

SIDE VIEW

GATEWAY V5 ANTENNA DETAIL

SCALE: N.T.S

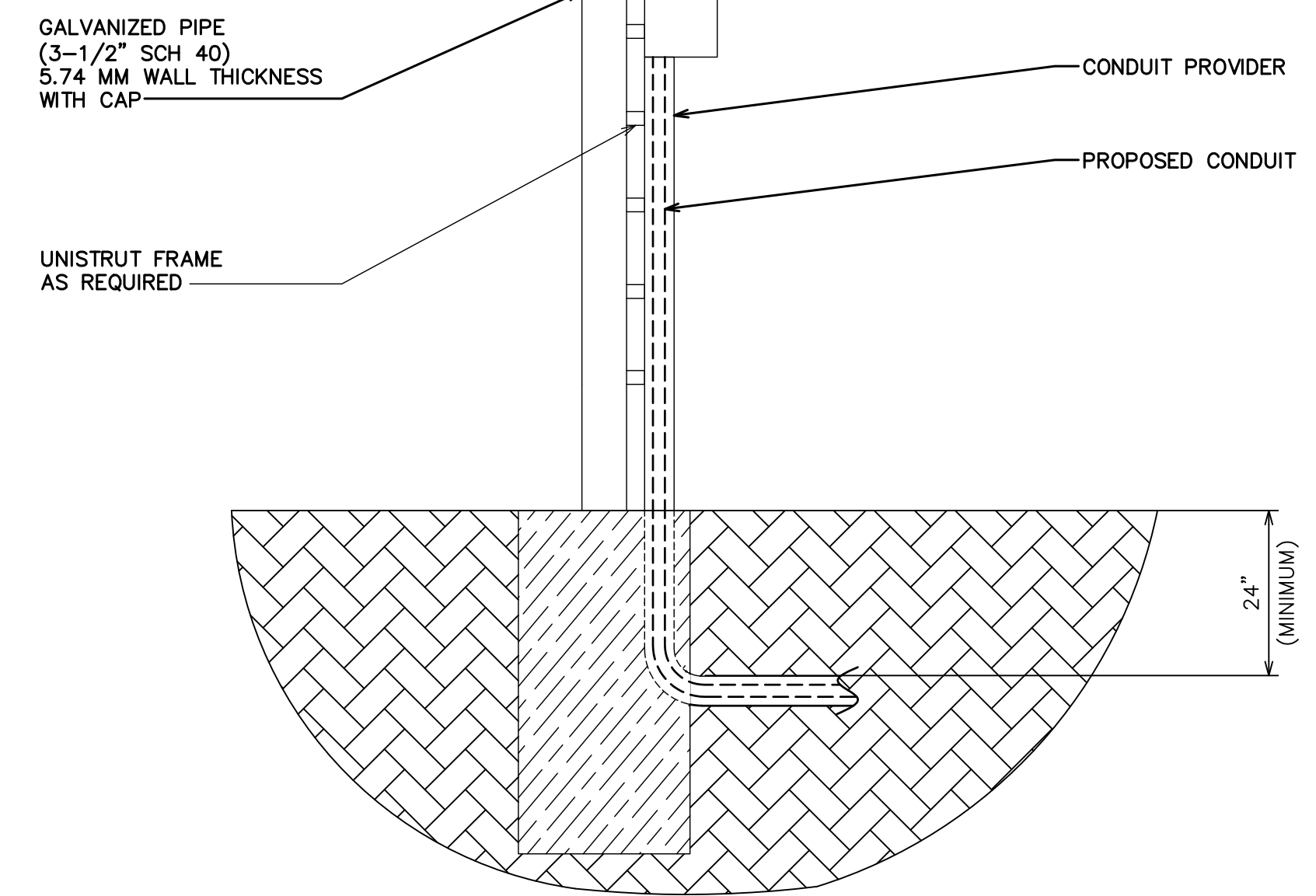

CONDUIT PROFILE DETAIL

SCALE: N.T.S

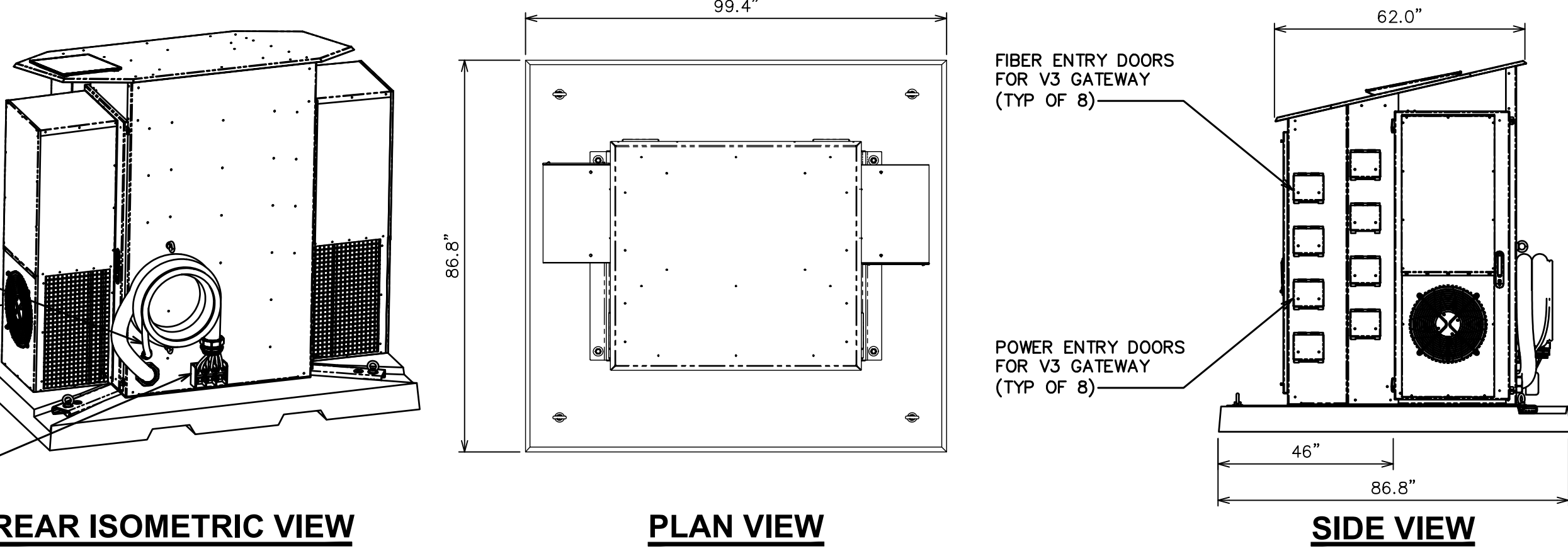
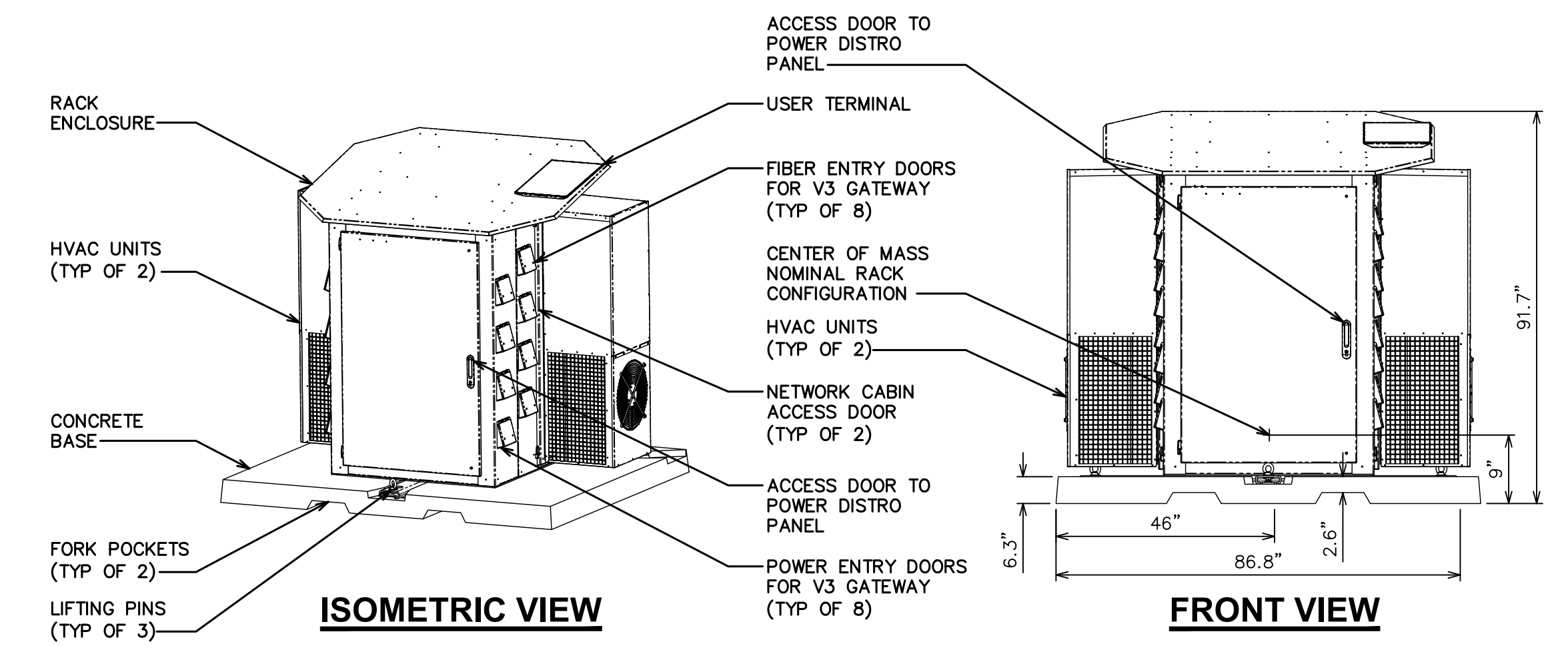

GATEWAY V3 HEAD END RACK DETAILS

SCALE: N.T.S

326 TRYON ROAD
RALEIGH, NC 27603-3330
OFFICE (919) 861-6351
FAX (919) 861-6880



PLANS PREPARED BY:

		CONSTRUCTION	
		CONSTRUCTION	
		PRELIMINARY	
		PRELIMINARY	
		ISSUED FOR:	
		CHECKED BY:	JFJ

PROJECT INFORMATION:
SITE NAME:
**COLORADO SPRINGS,
CO - 100KM**
7113 SPACE VILLAGE AVE.
COLORADO SPRINGS, CO 80929
(EL PASO COUNTY)



SCALE:

STRUCTURAL DETAILS II	REVISION: 1	TEP # 353465-490368
SHEET NUMBER:	C-5.2	

TEP IS A FAMILY OF COMPANIES LICENSED TO PROVIDE DIFFERENT SERVICES IN DIFFERENT JURISDICTIONS. DEPENDING ON THE JURISDICTION, PROFESSIONAL ENGINEERING AND LAND SURVEYING SERVICES ARE PROVIDED BY TEP OFCO LLC, A DELAWARE LIMITED LIABILITY COMPANY, TEP ENGINEERING, LLC, A NORTH CAROLINA PROFESSIONAL ENGINEERING, LLC, OR M&H ENGINEERING, LLC, A NEW YORK PROFESSIONAL LIMITED LIABILITY COMPANY. GENERAL CONTRACTOR SERVICES ARE PROVIDED BY TEP OFCO LLC, A DELAWARE LIMITED LIABILITY COMPANY. WE ACQUIRE THE REQUISITE LICENSES IN EACH STATE. ADDITIONAL INFORMATION CAN BE OBTAINED FROM THE COMPANY.

NOTES:

- ELECTRICAL DESIGN HAS A MAXIMUM VOLTAGE DROP OF 5% PER C405.10 OF THE 2021 IECC.
- A FINAL COMMISSIONING REPORT SHALL BE DELIVERED TO THE COMPOUND OWNER PER SECTION C408.2.5 OF THE 2021 IECC.
- ALL UTILITY SOURCE INFORMATION, INCLUDING FINAL TRANSFORMER LOCATION, SERVICE ROUTING, AND AVAILABLE FAULT CURRENT, IS PENDING FINAL UTILITY COORDINATION WITH COLORADO SPRINGS UTILITIES.
- FINAL METER SOCKET TYPE & METERING CONDUCTORS TO BE VERIFIED WITH COLORADO SPRINGS UTILITIES FIELD ENGINEER PRIOR TO INSTALLATION.

V3 VOLTAGE DROP CALCS		
SOURCE VOLTAGE*	480	VOLTS
CABINET VOLTAGE**	477	VOLTS
ALLOWABLE ANTENNA VOLTAGE	340-530	VOLTS

*CONTRACTOR TO CONFIRM SOURCE VOLTAGE PRIOR TO CONSTRUCTION
 **ALLOWABLE CABINET VOLTAGE RANGE: 340-530V

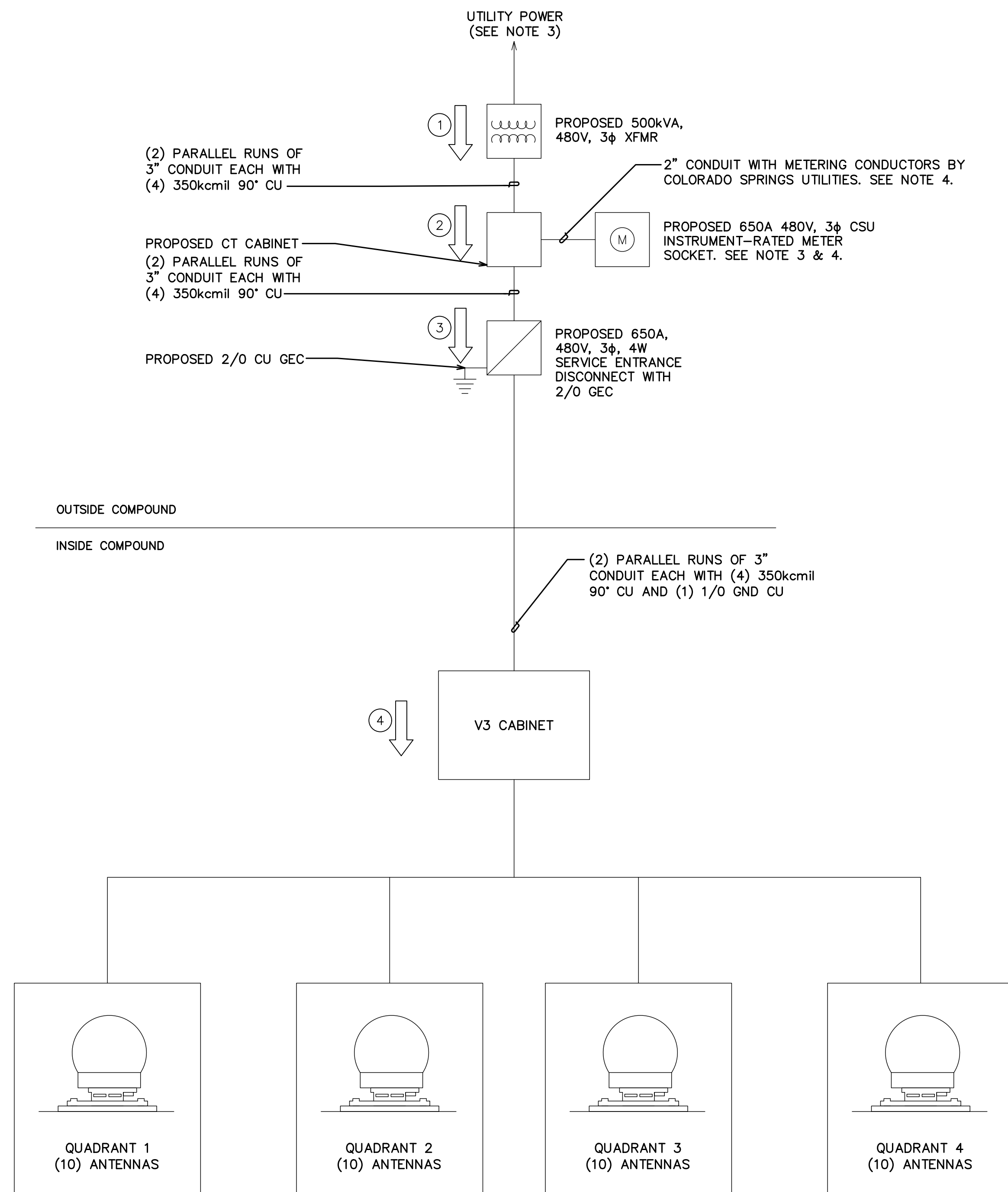

FAULT CURRENT AT EQUIPMENT			
#	EQUIPMENT	FAULT CURRENT	AIC RATING
1	UTILITY TRANSFORMER	43,000A	N/A
2	650A UTILITY METER	36,733A	MIN. 65k AIC
3	650A DISCONNECT	35,560A	MIN. 65k AIC
4	PROPOSED V3 CABINET	15,260A	MIN. 65k AIC

ONE-LINE DIAGRAM

SCALE: N.T.S.

NOTES:

- THE PANELBOARD SHALL HAVE A MINIMUM AMPERE INTERRUPTING CAPACITY (AIC) RATING OF 65,000 AMPS.
- LOAD INFORMATION FOR THIS PANEL IS BASED ON TYPICAL LOAD ITEMS ASSOCIATED WITH THIS CLASS/SIZE OF METERED MAIN BREAKER PANEL AS SUBMITTED TO THE UTILITY.

480V, 3φ WYE, V3 POWER RACK AC DISTRIBUTION PANEL SCHEDULE												
LOAD SERVED	VOLT AMPERES (WATTS)			TRIP	CKT #	TRIP	VOLT AMPERES (WATTS)			LOAD SERVED		
	L1	L2	L3				L1	L2	L3			
UPS #1	4711	4711	4711	30A	1	2	30A	3533	3533	3533	HVAC #1	
UPS #2	4711	4711	4711	30A	3	4	30A	3533	3533	3533	HVAC #2	
ANTENNA 1	3020	3020	3020	30A	5	6	30A	3020	3020	3020	ANTENNA 2	
ANTENNA 3	3020	3020	3020	30A	7	8	30A	3020	3020	3020	ANTENNA 4	
ANTENNA 5	3020	3020	3020	30A	9	10	30A	3020	3020	3020	ANTENNA 6	
ANTENNA 7	3020	3020	3020	30A	11	12	30A	3020	3020	3020	ANTENNA 8	
ANTENNA 9	3020	3020	3020	30A	13	14	30A	3020	3020	3020	ANTENNA 10	
ANTENNA 11	3020	3020	3020	30A	15	16	30A	3020	3020	3020	ANTENNA 12	
ANTENNA 13	3020	3020	3020	30A	17	18	30A	3020	3020	3020	ANTENNA 14	
ANTENNA 15	3020	3020	3020	30A	19	20	30A	3020	3020	3020	ANTENNA 16	
ANTENNA 17	3020	3020	3020	30A	21	22	30A	3020	3020	3020	ANTENNA 18	
ANTENNA 19	3020	3020	3020	30A	23	24	30A	3020	3020	3020	ANTENNA 20	
ANTENNA 21	3020	3020	3020	30A	25	26	30A	3020	3020	3020	ANTENNA 22	
ANTENNA 23	3020	3020	3020	30A	27	28	30A	3020	3020	3020	ANTENNA 24	
ANTENNA 25	3020	3020	3020	30A	29	30	30A	3020	3020	3020	ANTENNA 26	
ANTENNA 27	3020	3020	3020	30A	31	32	30A	3020	3020	3020	ANTENNA 28	
ANTENNA 29	3020	3020	3020	30A	33	34	30A	3020	3020	3020	ANTENNA 30	
ANTENNA 31	3020	3020	3020	30A	35	36	30A	3020	3020	3020	ANTENNA 32	
ANTENNA 33	3020	3020	3020	30A	37	38	30A	3020	3020	3020	ANTENNA 34	
ANTENNA 35	3020	3020	3020	30A	39	40	30A	3020	3020	3020	ANTENNA 36	
ANTENNA 37	3020	3020	3020	30A	41	42	30A	3020	3020	3020	ANTENNA 38	
ANTENNA 39	3020	3020	3020	30A	43	44	30A	3020	3020	3020	ANTENNA 40	
VOLT AMPS	69822	69822	69822					67466	67466	67466	VOLT AMPS	
L1 VOLT AMPERES				L1	L2	L3	L2, L3 VOLT AMPERES					
				137288	137288	137288	MAX VOLT AMPERES					
				137288			MAX AMPS					
				495.6			MAX 3PH KVA					
				411.9								

*INSTALL PER MARKET STANDARDS
 **ANTENNAS SHOWN AT MAXIMUM LOADING. POWER USAGE PROVIDED BY THE CUSTOMER

PANEL SCHEDULE

SCALE: N.T.S.

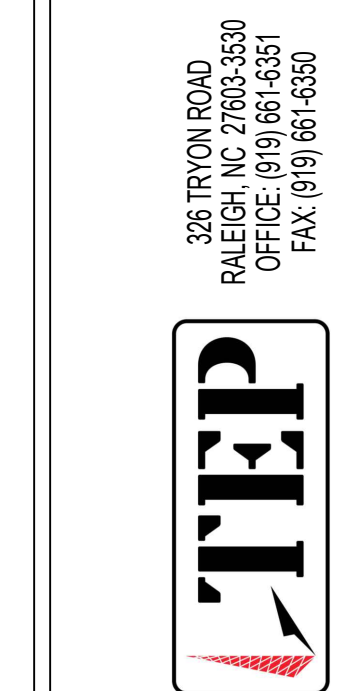

PLANS PREPARED BY:

CONSTRUCTION	05-15-26	DATE	ISSUED FOR:	CHECKED BY:
CONSTRUCTION	04-01-26	DATE	ISSUED FOR:	CHECKED BY:
PRELIMINARY	03-30-26	DATE	ISSUED FOR:	CHECKED BY:
PRELIMINARY	03-25-26	DATE	ISSUED FOR:	CHECKED BY:
REV	DATE	DATE	ISSUED FOR:	CHECKED BY:
				JFJ

PROJECT INFORMATION:
SITE NAME: COLORADO SPRINGS, CO - 100KM
 7113 SPAGE VILLAGE AVE.
 COLORADO SPRINGS, CO 80929
 (EL PASO COUNTY)

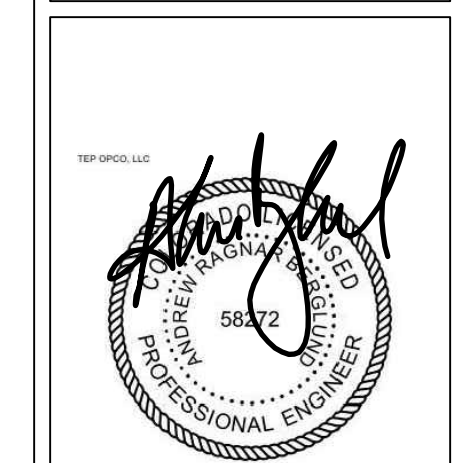

SEAL: **ELECTRICAL DETAILS**
 SHEET NUMBER: **E-1.1**
 REVISION: 1
 TEP # 353465-490368
 05-15-26

TEP IS A FAMILY OF COMPANIES LICENSED TO PROVIDE DIFFERENT SERVICES IN DIFFERENT JURISDICTIONS. DEPENDING ON THE JURISDICTION, PROFESSIONAL ENGINEERING AND LAND SURVEYING SERVICES ARE PROVIDED BY TEP OFCO LLC, A DELAWARE LIMITED LIABILITY COMPANY, TEP ENGINEERING, LLC, A NORTH CAROLINA PROFESSIONAL LIMITED LIABILITY COMPANY, OR M&H ENGINEERING, LLC, A NEW YORK PROFESSIONAL LIMITED LIABILITY COMPANY. GENERAL CONTRACTOR SERVICES ARE PROVIDED BY TEP OFCO LLC, A DELAWARE LIMITED LIABILITY COMPANY. WE ACQUIRE THE REQUISITE LICENSES IN EACH STATE. ADDITIONAL INFORMATION CAN BE OBTAINED FROM THE COMPANY.

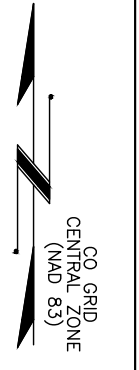
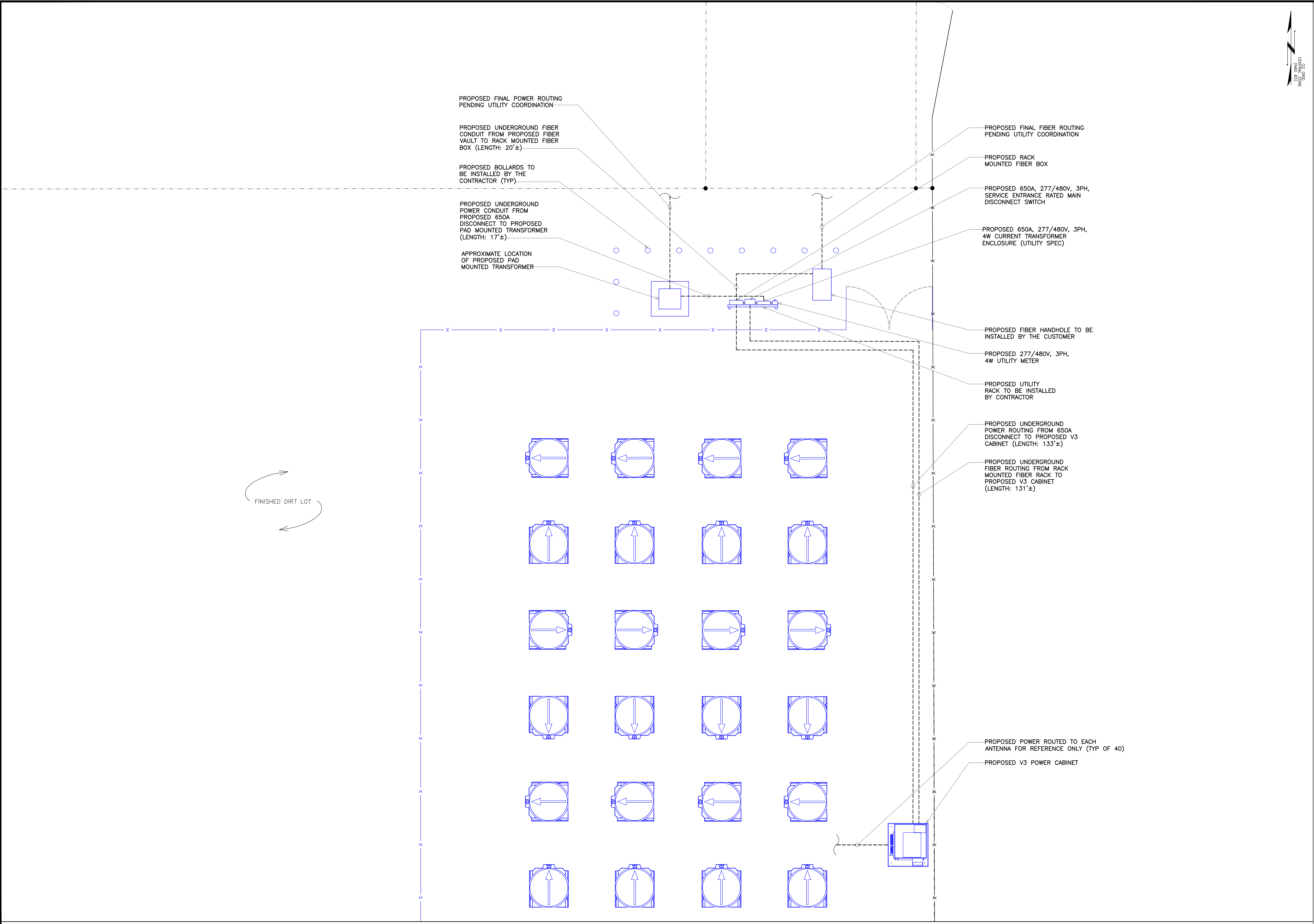

PLANS PREPARED BY:

326 TRYON ROAD
RALEIGH, NC 27603-3530
OFFICE (919) 861-6351
FAX (919) 861-6350

CONSTRUCTION	05-15-26	ISSUED FOR:	JFJ
CONSTRUCTION	04-01-26	DATE	OJK
PRELIMINARY	03-30-26	REV	A
PRELIMINARY	03-25-26	REV	B

PROJECT INFORMATION:

SITE NAME:
**COLORADO SPRINGS,
CO - 100KM**

7113 SPACE VILLAGE AVE.
COLORADO SPRINGS, CO 80929
(EL PASO COUNTY)

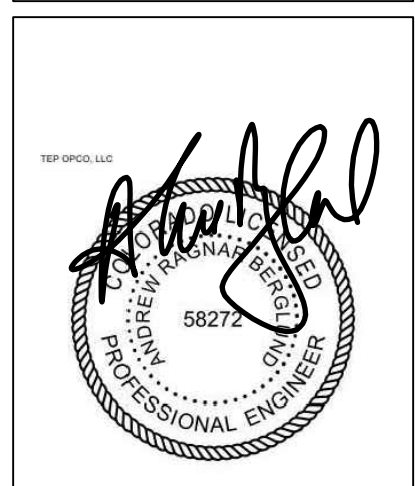

SEAL: 05-15-26

UTILITY ROUTING

SHEET NUMBER: **E-1.2**

REVISION: 1

TEP # 353465-499365

UTILITY ROUTING

SCALE: 1/8" = 1'-0"

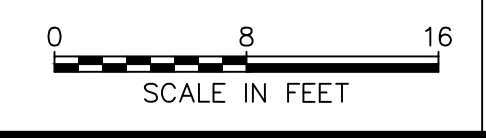

TEP IS A FAMILY OF COMPANIES LICENSED TO PROVIDE DIFFERENT SERVICES IN DIFFERENT JURISDICTIONS. DEPENDING ON THE JURISDICTION, PROFESSIONAL ENGINEERING AND LAND SURVEYING SERVICES ARE PROVIDED BY TEP OFCO LLC, A DELAWARE LIMITED LIABILITY COMPANY, TEP ENGINEERING, LLC, A NORTH CAROLINA PROFESSIONAL LIMITED LIABILITY COMPANY, OR M&H ENGINEERING, LLC, A NEW YORK PROFESSIONAL LIMITED LIABILITY COMPANY. GENERAL CONTRACTOR SERVICES ARE PROVIDED BY TEP OFCO LLC, A DELAWARE LIMITED LIABILITY COMPANY. WE ACQUIRE THE REQUISITE LICENSES IN EACH STATE. ADDITIONAL INFORMATION CAN BE OBTAINED FROM THE COMPANY.