

LEGEND

- EX WATER LINE UNDERGROUND
- EX WATER VALVE
- EX ELECTRIC MH
- EX ELECTRIC MKR
- EX ELECTRIC TRANSFORMER
- EX ELECTRIC UNDERGROUND
- EX LIGHT POLE
- EX FIBER OPTIC UNDERGROUND
- EX CABLE TV UNDERGROUND
- EX GAS LINE UNDERGROUND
- EX EDGE CONCRETE
- EX BUILDING
- EX. ELECTRICAL POLE LOCATION
- PR CHECK DAM
- PR GRAVEL ROADWAY

See checklist for standard items

where is the property line for the overall tract?

Where is pump house to be removed? Provide an inset or second page to show where this pump house and to be removed is in comparison to overall 13 ac tract. Identify setback lines and dimensions from tract prop lines to bldg.

Increase text (highlighted in yellow) for legibility

Remove the curb return and revise to a standard driveway. See ECM Appendix F detail SD_2-24.

Apron concrete? Asphalt?

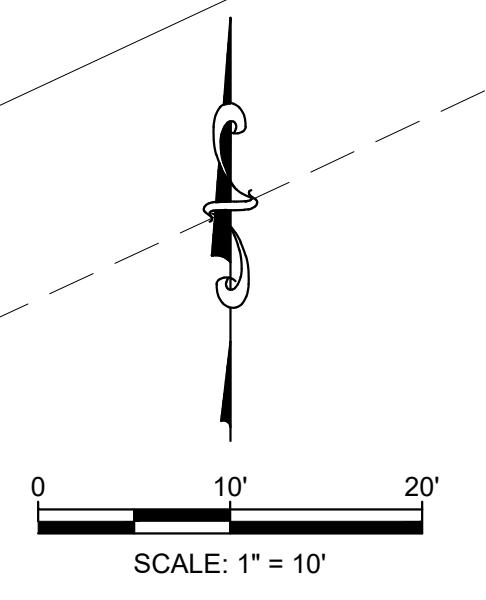

48 hours before you dig, CALL UTILITY NOTIFICATION CENTER OF COLORADO (UNCC) **811**
 Gas, Electric, Telephone, Cable, and
 Penetration Eastern Pipeline Locations
SCALE VERIFICATION
 BAR IS ONE INCH ON ORIGINAL DRAWING
 IF NOT ONE INCH ON THIS SHEET
 SCALE ACCORDINGLY

NO.	REVISIONS DESCRIPTION	DATE	BY

IRG AND ASSOCIATES, LLC
 4885 Ward Road, Suite 100 - Wheat Ridge, CO 80033
 Del Norte • Gypsum • Wheat Ridge
 303-293-8307 • www.irgengineers.com

PAINT BRUSH HILLS PUMP HOUSE
 SITE AND UTILITY PLAN
 prepared for
PAINT BRUSH HILLS METROPOLITAN DISTRICT

DRAWN BY:	DESIGNED BY:
JOB NUMBER: 1070.0010	DATE: MARCH, 2019
SCALE: 1"=10'	DRAWING NAME:
SHEET NO: 4	of 8

Markup Summary

dsdlaforce (8)

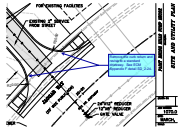

Subject: Callout
Page Label: [1] site and utility plan 1
Author: dsdlaforce
Date: 5/6/2019 11:18:38 AM
Color: ■

Remove the curb return and revise to a standard driveway. See ECM Appendix F detail SD_2-24.



Subject: Callout
Page Label: [1] site and utility plan 1
Author: dsdlaforce
Date: 5/6/2019 11:22:42 AM
Color: ■

Increase text (highlighted in yellow) for legibility

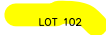

Subject: Highlight
Page Label: [1] site and utility plan 1
Author: dsdlaforce
Date: 5/6/2019 11:22:47 AM
Color: ■



Subject: Highlight
Page Label: [1] site and utility plan 1
Author: dsdlaforce
Date: 5/6/2019 11:22:49 AM
Color: ■

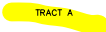

Subject: Highlight
Page Label: [1] site and utility plan 1
Author: dsdlaforce
Date: 5/6/2019 11:22:52 AM
Color: ■

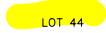

Subject: Highlight
Page Label: [1] site and utility plan 1
Author: dsdlaforce
Date: 5/6/2019 11:22:54 AM
Color: ■



Subject: Highlight
Page Label: [1] site and utility plan 1
Author: dsdlaforce
Date: 5/6/2019 11:23:13 AM
Color: ■



Subject: Highlight
Page Label: [1] site and utility plan 1
Author: dsdlaforce
Date: 5/6/2019 11:23:15 AM
Color: ■

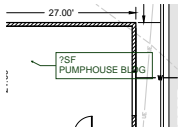

Subject: Callout
Page Label: [1] site and utility plan 1
Author: dsdparsons
Date: 5/13/2019 8:14:38 AM
Color: ■

?SF
PUMPHOUSE BLDG



Subject: Callout
Page Label: [1] site and utility plan 1
Author: dsdparsons
Date: 5/13/2019 8:16:11 AM
Color: ■

Where is pumphouse to be removed? Provide an inset or second page to show where this pumphouse and to be removed is in comparison to overall 13 ac tract. Identify setback lines and dimensions from tract prop lines to bldg.

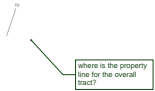

Subject: Callout
Page Label: [1] site and utility plan 1
Author: dsdparsons
Date: 5/13/2019 8:17:07 AM
Color: ■

where is the property line for the overall tract?

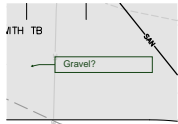

Subject: Callout
Page Label: [1] site and utility plan 1
Author: dsdparsons
Date: 5/13/2019 8:17:35 AM
Color: ■

Gravel?

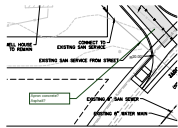

Subject: Callout
Page Label: [1] site and utility plan 1
Author: dsdparsons
Date: 5/13/2019 8:17:47 AM
Color: ■

Apron concrete? Asphalt?



Subject: Callout
Page Label: [1] site and utility plan 1
Author: dsdparsons
Date: 5/13/2019 8:20:49 AM
Color: ■

See checklist for standard items