

VICINITY MAP
NOT TO SCALE

BENCHMARK

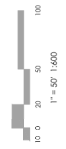
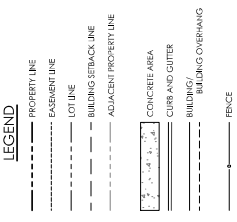

MVE, INC.
ENGINEERS, SURVEYORS
1903 Wilkey Street, Suite 300 Colorado Springs CO 80909 719.635.7336

REVISIONS

DESIGNED BY _____
 DRAWN BY _____
 CHECKED BY _____
 AS-BUILTS BY _____
 CHECKED BY _____

6275 LAKE SHORE
COURT
SITE PLAN

APRIL 6, 2020
SHEET 1 OF 1

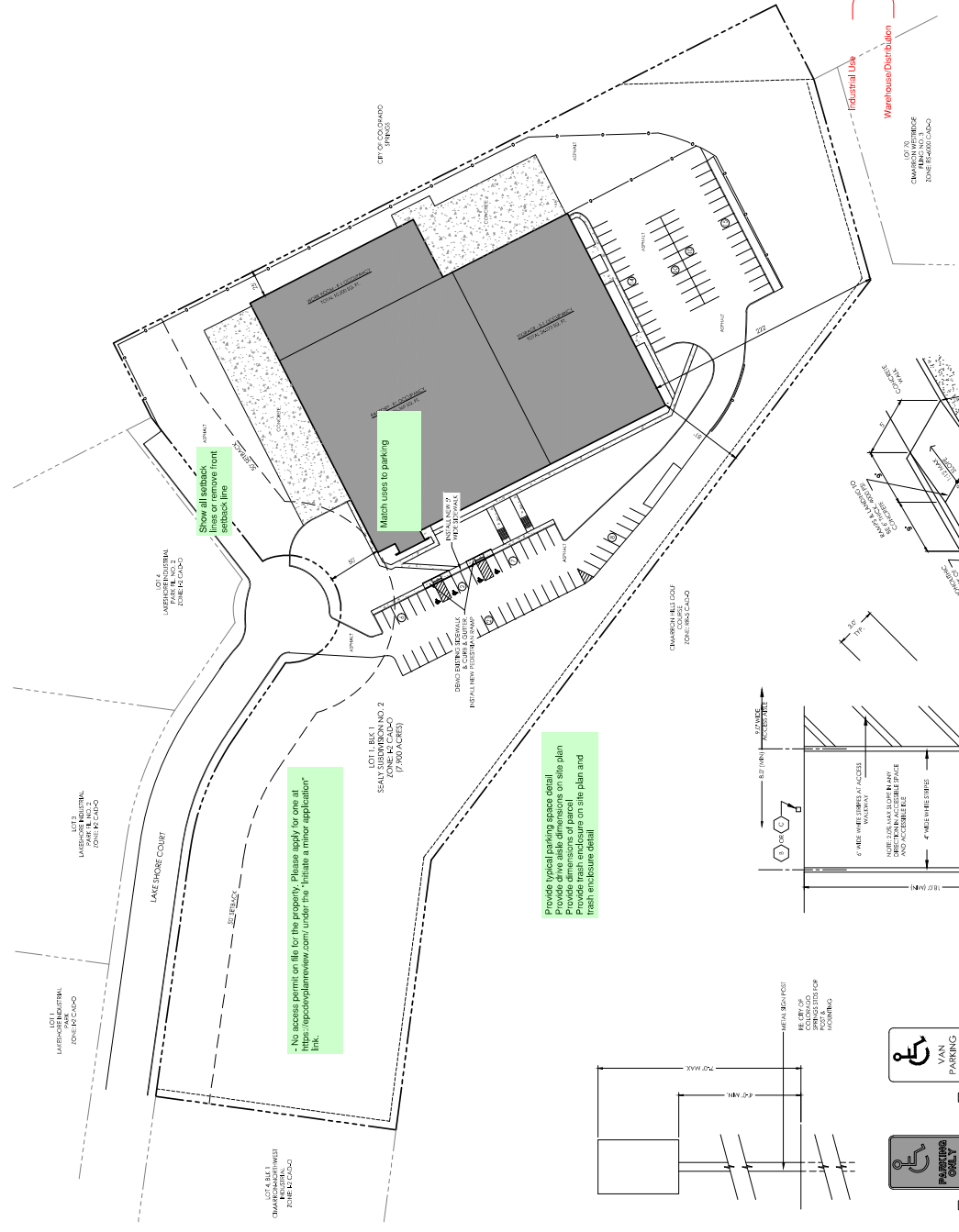

The following note should be added to all site development plans or non-residential site plans, as applicable, prior to PCD approval:

The parties responsible for this plan have familiarized themselves with all current accessibility criteria and specifications and the proposed plan reflects all site elements required by the applicable ADA design standards and guidelines as published by the United States Department of Justice. Approval of this plan by El Paso County does not assure compliance with the ADA or any regulations or guidelines enacted or promulgated under or with respect to such laws.

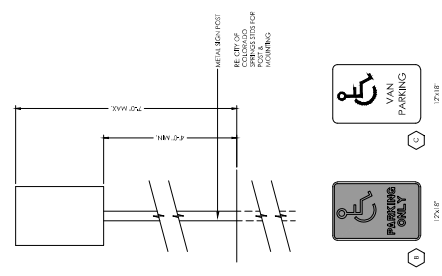
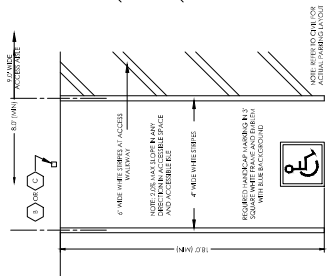
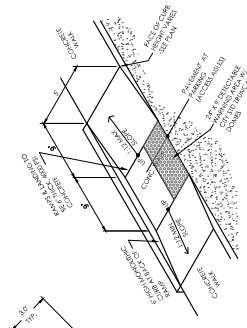

1. TYPOGRAPHY TO BE HELVETICA, MEDIUM.
2. NOTE: REFER TO SITE PLAN FOR LOCATIONS.
3. REMOVE EXISTING SIGNS AND REUSE WHERE APPLICABLE (NOT SHOWN).
4. STOP SIGNS WILL BE INSTALLED BY THE DEVELOPER AT THE LOCATIONS SHOWN ON THE DEVELOPMENT PLAN TO MEET MUTCD STANDARDS AND THE CITY OF COLORADO SPECS.

TYPICAL HANDICAP PARKING SPACE
SCALE 1" = 4.0'

SITE SIGNAGE
SCALE 1" = 10'