

# THE SHOP'S AT MERIDIAN RANCH

FILING NO. 1, LOT 4

PHOTOMETRIC PLAN

EL PASO COUNTY, COLORADO.

FALCON, COLORADO

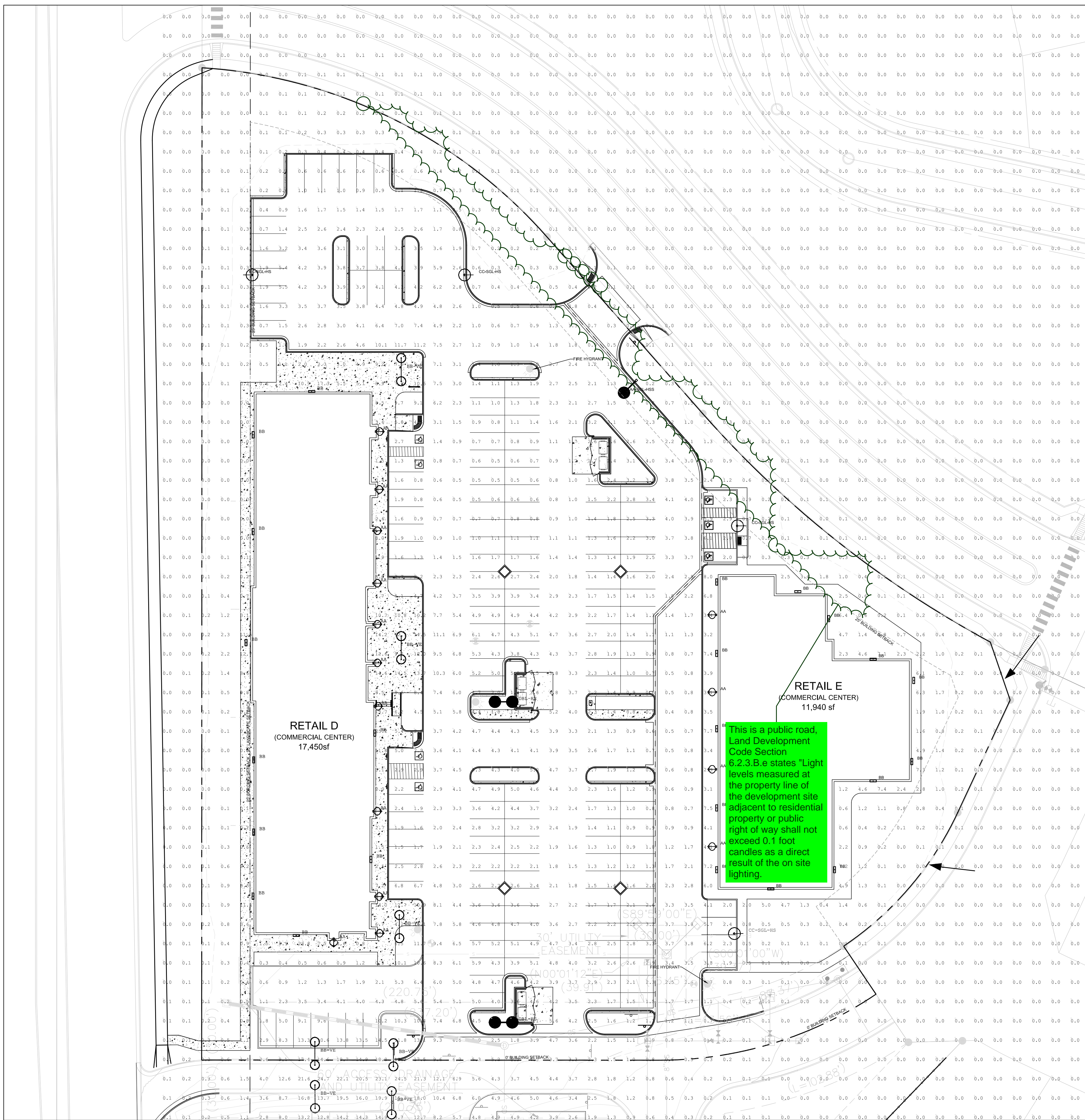

**HM LIGHTING** 25" Arm

Job Name: Meridian Ranch  
Type: AA-DBL

Job Number: 18-115

Job Title: Site Development Plan

Job Location: 115 S. Weber, Colorado Springs, Colorado

Job Date: 10/4/2018

Job Status: Final

Job Owner: Yow Architects PC

Job Designer: [Name]

Job Checker: [Name]

Job Approver: [Name]

Job Notes: [Notes]

Job Features: [Features]

Job Specifications: [Specifications]

Job Ordering Code: [Ordering Code]

**HM LIGHTING** 25" Arm

Job Name: Meridian Ranch  
Type: AA-DBL

Job Number: 18-115

Job Title: Site Development Plan

Job Location: 115 S. Weber, Colorado Springs, Colorado

Job Date: 10/4/2018

Job Status: Final

Job Owner: Yow Architects PC

Job Designer: [Name]

Job Checker: [Name]

Job Approver: [Name]

Job Notes: [Notes]

Job Features: [Features]

Job Specifications: [Specifications]

Job Ordering Code: [Ordering Code]

**ROUND NON-TAPERED STEEL DS340**

Job Name: Meridian Ranch  
Type: AA-DBL

Job Number: 18-115

Job Title: Site Development Plan

Job Location: 115 S. Weber, Colorado Springs, Colorado

Job Date: 10/4/2018

Job Status: Final

Job Owner: Yow Architects PC

Job Designer: [Name]

Job Checker: [Name]

Job Approver: [Name]

Job Notes: [Notes]

Job Features: [Features]

Job Specifications: [Specifications]

Job Ordering Code: [Ordering Code]

**PR4 - Aluminum Pole**

Job Name: Meridian Ranch  
Type: AA-DBL

Job Number: 18-115

Job Title: Site Development Plan

Job Location: 115 S. Weber, Colorado Springs, Colorado

Job Date: 10/4/2018

Job Status: Final

Job Owner: Yow Architects PC

Job Designer: [Name]

Job Checker: [Name]

Job Approver: [Name]

Job Notes: [Notes]

Job Features: [Features]

Job Specifications: [Specifications]

Job Ordering Code: [Ordering Code]

**UCS - Universal Small Housing Scale**

Job Name: Meridian Ranch  
Type: AA-DBL

Job Number: 18-115

Job Title: Site Development Plan

Job Location: 115 S. Weber, Colorado Springs, Colorado

Job Date: 10/4/2018

Job Status: Final

Job Owner: Yow Architects PC

Job Designer: [Name]

Job Checker: [Name]

Job Approver: [Name]

Job Notes: [Notes]

Job Features: [Features]

Job Specifications: [Specifications]

Job Ordering Code: [Ordering Code]

**VOLTAIRE ARCHITECTURAL WALL PACK**

Job Name: Meridian Ranch  
Type: AA-DBL

Job Number: 18-115

Job Title: Site Development Plan

Job Location: 115 S. Weber, Colorado Springs, Colorado

Job Date: 10/4/2018

Job Status: Final

Job Owner: Yow Architects PC

Job Designer: [Name]

Job Checker: [Name]

Job Approver: [Name]

Job Notes: [Notes]

Job Features: [Features]

Job Specifications: [Specifications]

Job Ordering Code: [Ordering Code]

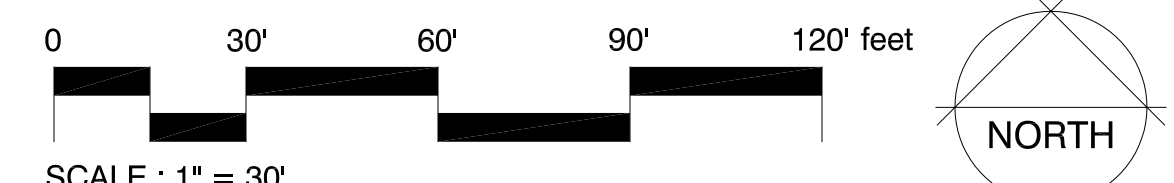

Luminaire Schedule	Qty	Label	Arrangement	Total Lamp Lumens	LLF	Description	Lum. Watts	Total Watts
AA	15	AA	SINGLE	0.900	N.A.	UCS-STR-12LED-NW	26.9	265.9
BB	23	BB	SINGLE	0.900	N.A.	VWPH4-30-730-T3-SDGL-OPT-EDD-UNV	35.7	357
AA-DBL	2	AA-DBL	BACK-BACK	0.900	N.A.	2B/CC253P70-96L4K	216.9	1735.2
AA-SGL	1	AA-SGL	SINGLE	0.900	N.A.	1A/CC253P70-96L4K	216.9	650.7
BB-VE	7	BB-VE	BACK-BACK	0.900	N.A.	2-UCM-ANG-T3-32LED-4K-700-AWT	71.3	998.2001

**OWNER INFO**

company name: SHOPS AT MERIDIAN RANCH LLC

address: P.O. BOX 80036

city/state: SAN DIEGO CA 91238

phone no:



**YOW ARCHITECTS PC**  
ARCHITECTURE & PLANNING  
115 S. Weber Colorado Springs, Colorado 475-8133

Structural: [ ]  
Electrical: [ ]  
Mechanical: [ ]  
Plumbing: [ ]

**Shop's @ Meridian Ranch**  
Site Development Plan  
Meridian Road  
Falcon, CO

Job No: 18-115  
Drawing: Planning  
File: Site Development plan 10-1-18  
Drawn By: DBN  
Date: 6/22/2018  
Revised: 10/4/2018

DRAWING NO. **4**  
PHOTOMETRIC PLAN



# Markup Summary

dskendall (1)

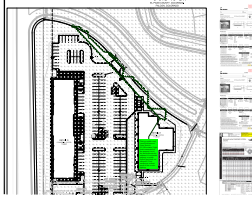

**Subject:** Cloud+  
**Page Label:** 1  
**Lock:** Locked  
**Author:** dskendall  
**Date:** 11/13/2018 3:04:37 PM  
**Color:** ■

This is a public road, Land Development Code Section 6.2.3.B.e states "Light levels measured at the property line of the development site adjacent to residential property or public right of way shall not exceed 0.1 foot candles as a direct result of the on site lighting."