

EL PASO

COMMISSIONERS:
DARRYL GLENN (PRESIDENT)
MARK WALLER (PRESIDENT PRO TEMPORE)



COUNTY

STAN VÄNDERWERF
LONGINOS GONZALEZ
PEGGY LITTLETON

PLANNING AND COMMUNITY DEVELOPMENT DEPARTMENT
CRAIG DOSSEY, EXECUTIVE DIRECTOR

October 11, 2017

RE: Cathedral Pines Filing 3, Lot 38

File: VR-17-011

Parcel ID: 6202001050

To Whom It May Concern:

This letter is to inform property owners adjacent to 4220 Fox Chase Way that they have requested a vacation replat to remove a portion of the no-build area within the Cathedral Pines Planned Unit Development (PUD) zoning district. The Planning and Community Development Director may make a formal decision regarding the request on October 25, 2017. Any comments or questions may be forwarded to me prior to that decision. At the discretion of the Planning and Community Development Director, the approval process may be elevated to the Board of County Commissioners for consideration. Administrative approval by the Planning and Community Development Director is subject to the appeal provisions of the Land Development Code.

You may view the application documents online at www.epcdevplanreview.com. Please feel free to contact me with any questions, comments, or concerns you may have prior to the decision.

Respectfully,

Nina Ruiz, Project Manager/Planner II
El Paso County Planning and Community Development
719-520-6313
ninaruiz@elpasoco.com

2880 INTERNATIONAL CIRCLE, SUITE 110
PHONE: (719) 520-6300



COLORADO SPRINGS, CO 80910-3127
FAX: (719) 520-6695

www.ELPASOCO.com

*mailed
10/12/17*

El Paso County Parcel Information

File Name: VR-17-011

PARCEL	NAME
6202001050	ASHBY BRENT

Zone Map No.: --

ADDRESS	CITY	STATE
9753 SUMMIT ASH CT	COLORADO SPRINGS	CO

ZIP	ZIPPLUS
80920	

Date: October 12, 2017

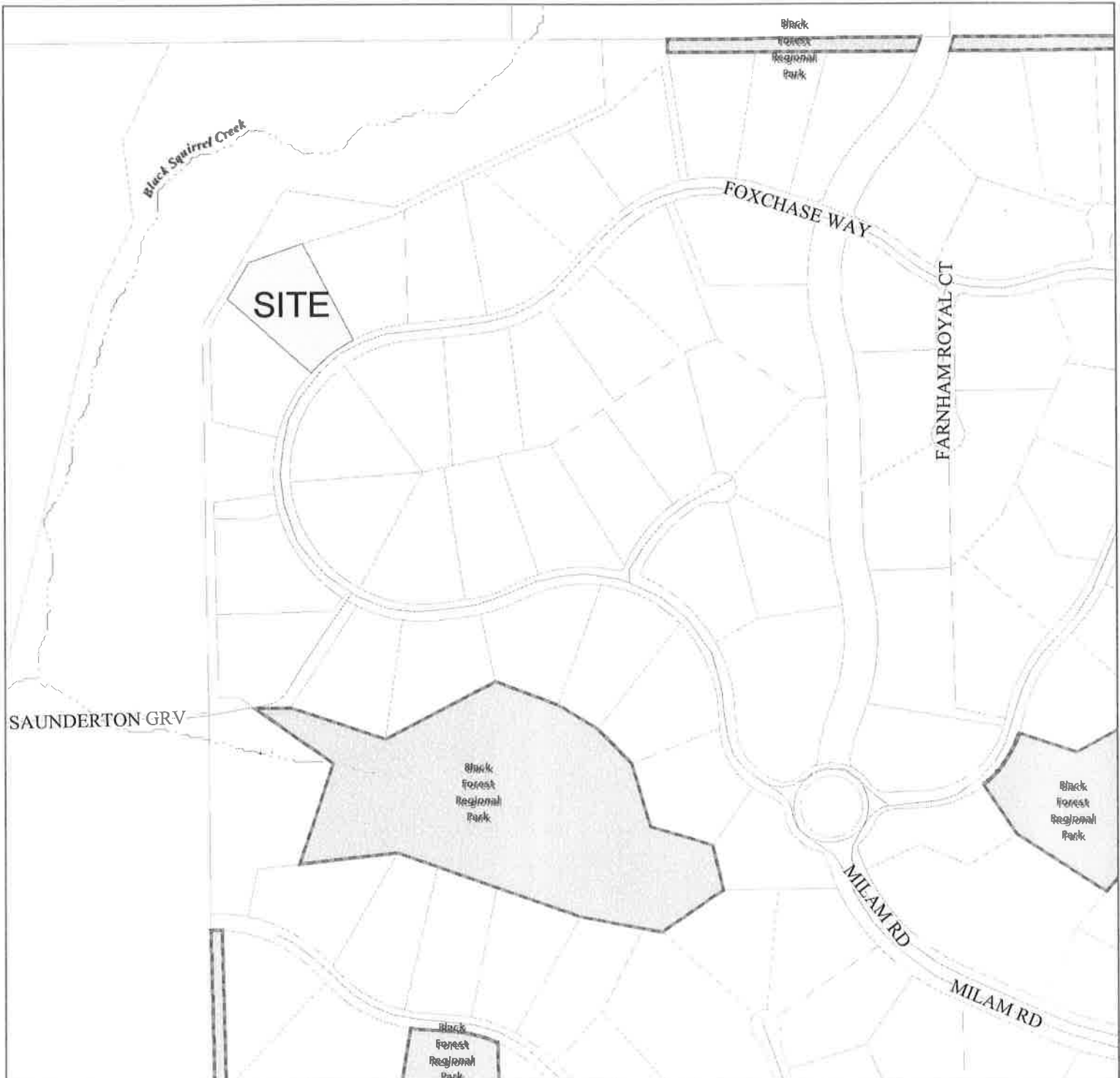

Please report any parcel discrepancies to:
El Paso County Assessor
1675 W. Garden of the Gods Rd.
Colorado Springs, CO 80907
(719) 520-6600



COPYRIGHT 2017 by the Board of County Commissioners, El Paso County, Colorado. All rights reserved. No part of this document or data contained hereon may be reproduced; used to prepare derivative products; or distributed without the specific written approval of the Board of County Commissioners, El Paso County, Colorado. This document was prepared from the best data available at the time of printing. El Paso County, Colorado, makes no claim as to the completeness or accuracy of the data contained hereon.

6202001058
CATHEDRAL PINES METROPOLITAN DIST
2790 N ACADEMY BLVD STE 350
COLORADO SPRINGS, CO 80917

6200000397
RED HORSE HILL LLC
3235 TEMPLETON GAP RD
COLORADO SPRINGS, CO 80907

6202001034
RATNAKANT SANJAY
4175 FOXCHASE WAY
COLORADO SPRINGS, CO 80908

6202001051
DOMBAUGH BRADLEY D
4180 FOXCHASE WAY
COLORADO SPRINGS, CO 80908

6202001049
HURLEY FAMILY LIVING TRUST
4260 FOXCHASE WAY
COLORADO SPRINGS, CO 80908

6202001050
ASHBY BRENT
9753 SUMMIT ASH CT
COLORADO SPRINGS, CO 80920

6202001035
RUSNAK ROBERT C
15620 TIMBERSIDE CT
COLORADO SPRINGS, CO 80921