

CALL UTILITY NOTIFICATION  
CENTER OF COLORADO  
1-800-922-1987  
CALL 2-BUSINESS DAYS IN ADVANCE  
BEFORE YOU DIG, GRADE, OR EXCAVATE  
FOR THE MARKING OF UNDERGROUND  
MEMBER UTILITIES.

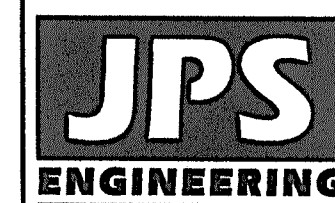

19 E. Willamette Ave.  
Colorado Springs, CO  
80903  
PH: 719-477-9429  
FAX: 719-471-0766  
www.jpsegr.com

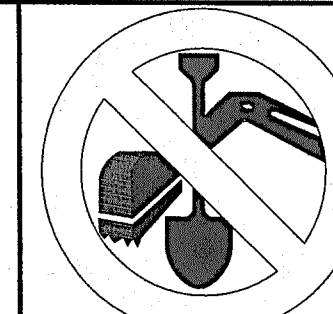
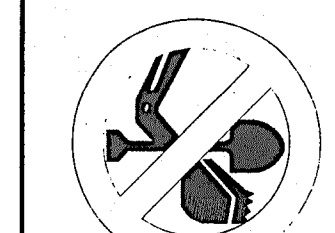

CALL UTILITY NOTIFICATION  
CENTER OF COLORADO  
1-800-922-1987  
CALL 2-BUSINESS DAYS IN ADVANCE  
BEFORE YOU DIG, GRADE, OR EXCAVATE  
FOR THE MARKING OF UNDERGROUND  
MEMBER UTILITIES.

SETTLERS RANCH FILING NO. 3

TITLE SHEET

HORIZ. SCALE: 1"=50'	DRAWN: RMD
VERT. SCALE: 1"=5'	DESIGNED: JPS
SURVEYED: RAMPART	CHECKED: JPS
CREATED: 4/05/18	LAST MODIFIED: 7/22/24
PROJECT NO: 030501	MODIFIED BY: MSP
SHEET:	

PCD FILE NO. SF-249

G1-F3

# SETTLERS RANCH

## Filing No. 3

# Construction Drawings

## El Paso County, Colorado

PREPARED FOR:

Hodgen Settlers Ranch, LLC  
P.O. Box 1488  
Monument, CO 80132

PREPARED BY:

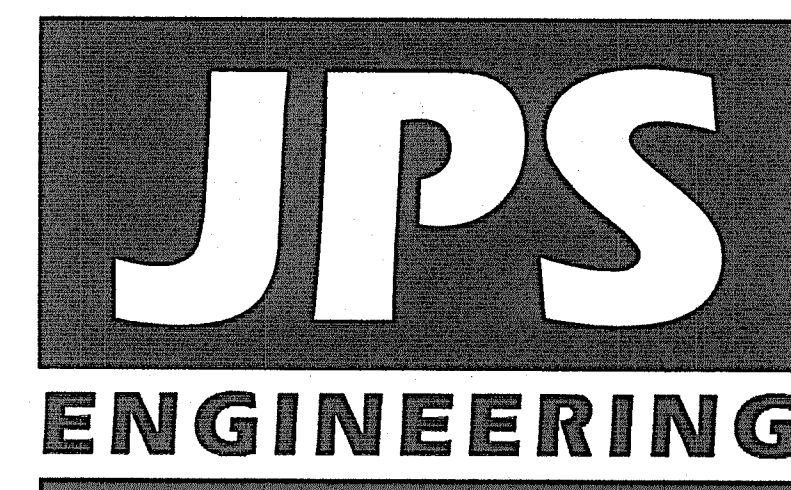

19 East Willamette Avenue  
Colorado Springs, Colorado 80903  
JULY 2024



### SHEET INDEX

G1-F3	TITLE SHEET
G2-F3	GENERAL NOTES
TY1-F3	TYPICAL SECTION & DETAILS
PP4-F3	SETTLERS RANCH RD. PLAN & PROFILE STA: 50+06 TO 68+00
PP5-F3	SETTLERS RANCH RD. PLAN & PROFILE STA: 68+00 TO 70+00
PP6-F3	SETTLERS RANCH RD. PLAN & PROFILE STA: 70+00 TO 73+00
PP7-F3	BOUNDARY BASIN CT. PLAN & PROFILE STA: 10+00 TO 23+00
SD1-F3	CULVERT PROFILES
LS1-F3	PLANTING DETAILS

ENGINEER:

DESIGN ENGINEER'S STATEMENT:

THESE DETAILED PLANS AND SPECIFICATIONS WERE PREPARED UNDER MY DIRECTION AND SUPERVISION. SAID PLANS AND SPECIFICATIONS HAVE BEEN PREPARED ACCORDING TO THE CRITERIA ESTABLISHED BY THE COUNTY FOR DETAILED ROADWAY, DRAINAGE, GRADING AND EROSION CONTROL PLANS AND SPECIFICATIONS, AND SAID PLANS AND SPECIFICATIONS ARE IN CONFORMITY WITH APPLICABLE MASTER DRAINAGE PLANS AND MASTER TRANSPORTATION PLANS. SAID PLANS AND SPECIFICATIONS MEET THE PURPOSES FOR WHICH THE PARTICULAR ROADWAY AND DRAINAGE FACILITIES ARE DESIGNED AND ARE CORRECT TO THE BEST OF MY KNOWLEDGE AND BELIEF. I ACCEPT RESPONSIBILITY FOR LIABILITY CAUSED BY NEGLIGENT ACTS, ERRORS OR OMISSIONS ON MY PART IN PREPARATION OF THESE DETAILED PLANS AND SPECIFICATIONS.

John P. Schwab  
JOHN P. SCHWAB, P.E. #29891  
7/23/24  
DATE

OWNER/DEVELOPER'S STATEMENT:

I, THE OWNER/DEVELOPER HAVE READ AND WILL COMPLY WITH ALL OF THE REQUIREMENTS SPECIFIED IN THESE DETAILED PLANS AND SPECIFICATIONS.

HODGEN SETTLERS RANCH, LLC  
P.O. BOX 1488  
MONUMENT, COLORADO 80132  
7/2/24  
DATE

EL PASO COUNTY:

COUNTY PLAN REVIEW IS PROVIDED ONLY FOR GENERAL CONFORMANCE WITH COUNTY DESIGN CRITERIA. THE COUNTY IS NOT RESPONSIBLE FOR THE ACCURACY AND ADEQUACY OF THE DESIGN, DIMENSIONS, AND/OR ELEVATIONS WHICH SHALL BE CONFIRMED AT THE JOB SITE. THE COUNTY THROUGH THE APPROVAL OF THIS DOCUMENT ASSUMES NO RESPONSIBILITY FOR COMPLETENESS AND/OR ACCURACY OF THIS DOCUMENT.

FILED IN ACCORDANCE WITH THE REQUIREMENTS OF THE EL PASO COUNTY LAND DEVELOPMENT CODE, DRAINAGE CRITERIA MANUAL, VOLUMES 1 AND 2, AND ENGINEERING CRITERIA MANUAL AS AMENDED.

IN ACCORDANCE WITH ECM SECTION 1.12, THESE CONSTRUCTION DOCUMENTS WILL BE VALID FOR CONSTRUCTION FOR A PERIOD OF 2 YEARS. IF CONSTRUCTION HAS NOT STARTED WITHIN THOSE 2 YEARS, THEY WILL NEED TO BE RESUBMITTED FOR APPROVAL, INCLUDING PAYMENT OF REVIEW FEES AT THE PLANNING AND COMMUNITY DEVELOPMENT DIRECTOR'S DISCRETION.

JOSHUA PALMER, P.E.  
COUNTY ENGINEER / ECM ADMINISTRATOR  
DATE

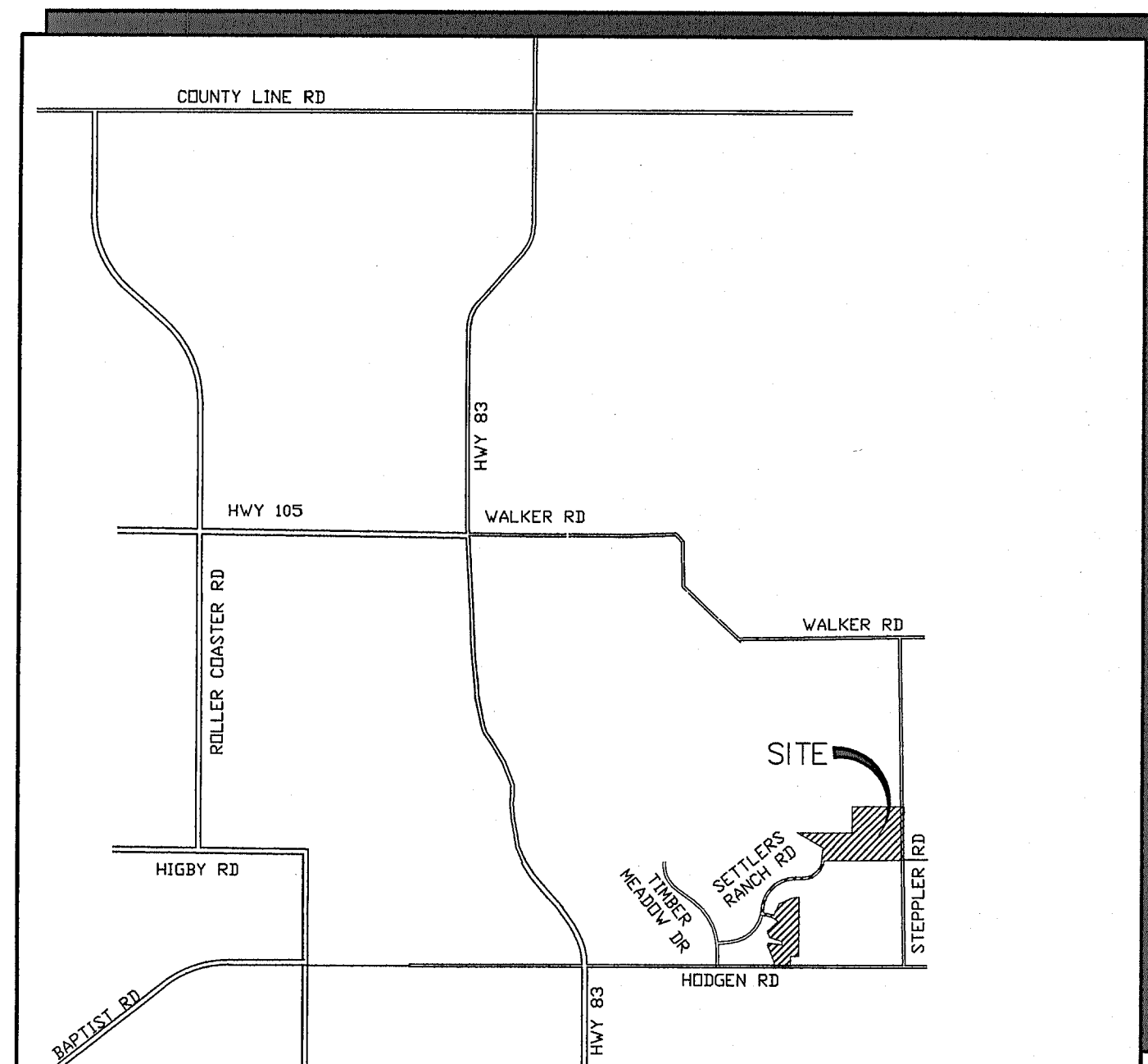

VICINITY MAP  
NOT TO SCALE

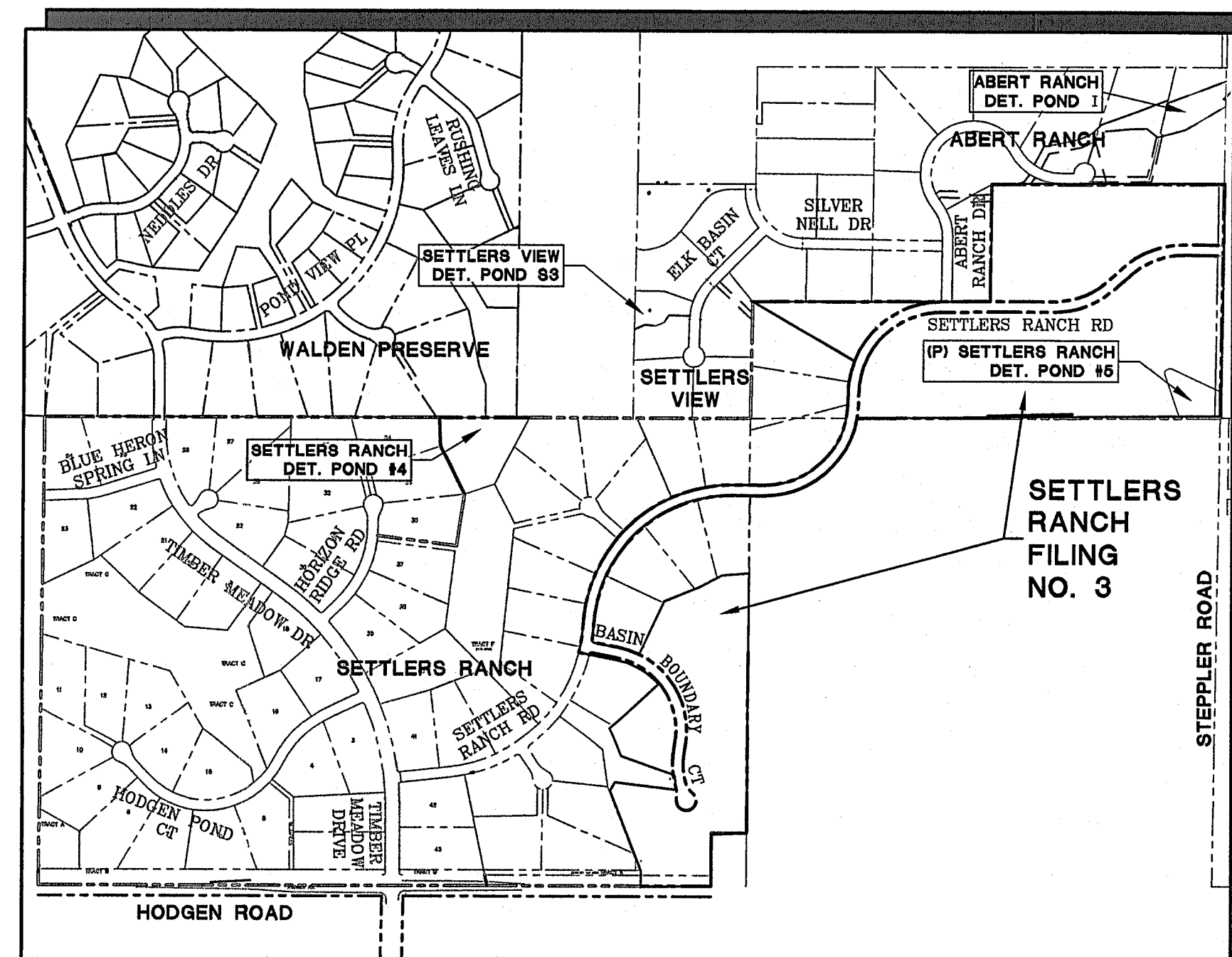

SITE MAP  
NOT TO SCALE

NOTE: NOT WITHSTANDING ANYTHING DEPICTED IN THESE PLANS IN WORDS OR GRAPHIC REPRESENTATION, ALL DESIGN AND CONSTRUCTION RELATED TO ROADS, STORM DRAINAGE AND EROSION CONTROL SHALL CONFORM TO THE STANDARDS AND REQUIREMENTS OF THE MOST RECENT VERSION OF THE RELEVANT ADOPTED EL PASO COUNTY STANDARDS, INCLUDING THE LAND DEVELOPMENT CODE, THE ENGINEERING CRITERIA MANUAL, THE DRAINAGE CRITERIA MANUAL, AND THE DRAINAGE CRITERIA MANUAL VOLUME 2. ANY DEVIATIONS FROM REGULATIONS AND STANDARDS MUST BE REQUESTED AND APPROVED IN WRITING TO BE ACCEPTABLE.

BASIS OF BEARING:  
ALL BEARINGS USED ON THIS PLAT ARE BASED ON AN ASSUMED BEARING OF N90°00'00"E BETWEEN A 3" GALVANIZED STEEL CAP (ILLEGIBLE) AT THE SOUTHWEST CORNER OF SECTION 23, TOWNSHIP 11 SOUTH, RANGE 66 WEST OF THE 6TH P.M.; AND A 3" GALVANIZED STEEL CAP (ILLEGIBLE) AT THE SOUTHEAST CORNER OF SAID SECTION 23.

BENCHMARK:  
TEMPORARY BENCHMARK, PANEL POINT #109 FROM AERIAL TOPOGRAPHY SURVEY PROVIDED BY MVE. ELEV.=7577.66 (SEE SHEET C1)

### AGENCIES/CONTACTS

DEVELOPER:	HODGEN SETTLERS RANCH, LLC P.O. BOX 1488 MONUMENT, CO 80132 MR. MARK DAVIS (719)338-3116	GAS DEPARTMENT:	BLACK HILLS ENERGY (719)393-6625
CIVIL ENGINEER:	JPS ENGINEERING, INC. 19 E. WILLAMETTE AVENUE COLORADO SPRINGS, CO 80903 MR. JOHN P. SCHWAB, P.E. (719)477-9429	ELECTRIC DEPARTMENT:	MOUNTAIN VIEW ELECTRIC ASSOCIATION 11140 E. WOODMEN ROAD COLORADO SPRINGS, CO 80908 (719)495-2283
LOCAL ROADS & DRAINAGE	EL PASO COUNTY DSD 2880 INTERNATIONAL CIRCLE COLORADO SPRINGS, CO 80910 (719) 477-9429	TELEPHONE COMPANY:	QWEST COMMUNICATIONS (LOCATORS) (800)922-1987  A.T. & T. (LOCATORS) (719)635-3674
STATE HIGHWAY	COLORADO DEPARTMENT OF TRANSPORTATION REGION 2 905 N. ERIE AVE. PUEBLO, CO 81002 (719)546-5707	FIRE DEPARTMENT:	TRI-LAKES MONUMENT FIRE RESCUE AUTHORITY (719)266-3382



COUNTY GENERAL NOTES:

1. ALL DRAINAGE AND ROADWAY CONSTRUCTION SHALL MEET THE STANDARDS AND SPECIFICATIONS OF THE CITY OF COLORADO SPRINGS/EL PASO COUNTY DRAINAGE CRITERIA MANUAL, VOLUMES 1 AND 2, AND THE EL PASO COUNTY ENGINEERING CRITERIA MANUAL.
2. CONTRACTOR SHALL BE RESPONSIBLE FOR THE NOTIFICATION AND FIELD NOTIFICATION OF ALL EXISTING UTILITIES, WHETHER SHOWN ON THE PLANS OR NOT, BEFORE BEGINNING CONSTRUCTION. LOCATION OF EXISTING UTILITIES SHALL BE VERIFIED BY THE CONTRACTOR PRIOR TO CONSTRUCTION. CALL 811 TO CONTACT THE UTILITY NOTIFICATION CENTER OF COLORADO (UNCC).
3. CONTRACTOR SHALL KEEP A COPY OF THESE APPROVED PLANS, THE GRADING AND EROSION CONTROL PLAN, THE STORMWATER MANAGEMENT PLAN (SWMP), THE SOILS AND GEOTECHNICAL REPORT, AND THE APPROPRIATE DESIGN AND CONSTRUCTION STANDARDS AND SPECIFICATIONS AT THE JOB SITE AT ALL TIMES, INCLUDING THE FOLLOWING:

A. EL PASO COUNTY ENGINEERING CRITERIA MANUAL (ECM)

B. CITY OF COLORADO SPRINGS/EL PASO COUNTY DRAINAGE CRITERIA MANUAL, VOLUMES 1 AND 2

C. COLORADO DEPARTMENT OF TRANSPORTATION (CDOT) STANDARD SPECIFICATIONS FOR ROAD AND BRIDGE CONSTRUCTION

D. CDOT M & S STANDARDS
4. NOTWITHSTANDING ANYTHING DEPICTED IN THESE PLANS IN WORDS OR GRAPHIC REPRESENTATION, ALL DESIGN AND CONSTRUCTION RELATED TO ROADS, STORM DRAINAGE AND EROSION CONTROL SHALL CONFORM TO THE STANDARDS AND REQUIREMENTS OF THE MOST RECENT VERSION OF THE RELEVANT ADOPTED EL PASO COUNTY STANDARDS, INCLUDING THE LAND DEVELOPMENT CODE, THE DRAINAGE CRITERIA MANUAL, AND THE DRAINAGE CRITERIA MANUAL VOLUME 2. ANY DEVIATIONS FROM REGULATIONS AND STANDARDS MUST BE REQUESTED, AND APPROVED, IN WRITING. ANY MODIFICATIONS NECESSARY TO MEET CRITERIA AFTER-THE-FACT WILL BE ENTIRELY THE DEVELOPER’S RESPONSIBILITY TO RECTIFY.
5. IT IS THE DESIGN ENGINEER’S RESPONSIBILITY TO ACCURATELY SHOW EXISTING CONDITIONS, BOTH ONSITE AND OFFSITE, ON THE CONSTRUCTION PLANS. ANY MODIFICATIONS NECESSARY DUE TO CONFLICTS, OMISSIONS, OR CHANGED CONDITIONS WILL BE ENTIRELY THE DEVELOPER’S RESPONSIBILITY TO RECTIFY.
6. CONTRACTOR SHALL SCHEDULE A PRE-CONSTRUCTION MEETING WITH EL PASO COUNTY DEVELOPMENT SERVICES DEPARTMENT (DSD) – INSPECTIONS, PRIOR TO STARTING CONSTRUCTION.
7. IT IS THE CONTRACTOR’S RESPONSIBILITY TO UNDERSTAND THE REQUIREMENTS OF ALL JURISDICTIONAL AGENCIES AND TO OBTAIN ALL REQUIRED PERMITS, INCLUDING BUT NOT LIMITED TO EL PASO COUNTY EROSION AND STORMWATER QUALITY CONTROL PERMIT (ESQCP), REGIONAL BUILDING FLOODPLAIN DEVELOPMENT PERMIT, U.S. ARMY CORPS OF ENGINEERS-ISSUED 401 AND/OR 404 PERMITS, AND COUNTY AND STATE FUGITIVE DUST PERMITS.
8. CONTRACTOR SHALL NOT DEViate FROM THE PLANS WITHOUT FIRST OBTAINING WRITTEN APPROVAL FROM THE DESIGN ENGINEER AND DSD. CONTRACTOR SHALL NOTIFY THE DESIGN ENGINEER IMMEDIATELY UPON DISCOVERY OF ANY ERRORS OR INCONSISTENCIES.
9. ALL STORM DRAIN PIPE SHALL BE CLASS III RCP WITH CLASS B BEDDING UNLESS OTHERWISE NOTED AND APPROVED BY DSD.
10. CONTRACTOR SHALL COORDINATE GEOTECHNICAL TESTING PER ECM STANDARDS. PAVEMENT DESIGN SHALL BE APPROVED BY EL PASO COUNTY DSD PRIOR TO PLACEMENT OF CURB AND GUTTER AND PAVEMENT.
11. ALL CONSTRUCTION TRAFFIC MUST ENTER/EXIT THE SITE AT APPROVED CONSTRUCTION ACCESS POINTS.
12. SIGHT VISIBILITY TRIANGLES AS IDENTIFIED IN THE PLANS SHALL BE PROVIDED AT ALL INTERSECTIONS. OBSTRUCTIONS GREATER THAN 18 INCHES ABOVE FLOWLINE ARE NOT ALLOWED WITHIN SIGHT TRIANGLES.
13. SIGNING AND STRIPING SHALL COMPLY WITH EL PASO COUNTY DOT AND MUTCD CRITERIA.
14. CONTRACTOR SHALL OBTAIN ANY PERMITS REQUIRED BY EL PASO COUNTY DOT, INCLUDING WORK WITHIN THE RIGHT-OF-WAY AND SPECIAL TRANSPORT PERMITS.
15. THE LIMITS OF CONSTRUCTION SHALL REMAIN WITHIN THE PROPERTY LINE UNLESS OTHERWISE NOTED. THE OWNER/DEVELOPER SHALL OBTAIN WRITTEN PERMISSION AND EASEMENTS, WHERE REQUIRED, FROM ADJOINING PROPERTY OWNER(S) PRIOR TO ANY OFF-SITE DISTURBANCE, GRADING, OR CONSTRUCTION.

PROJECT GENERAL NOTES:

1. EXISTING CONTOUR DATA CONSISTS OF AERIAL TOPOGRAPHIC SURVEY DATA PROVIDED BY OWNER’S SURVEYOR. JPS ENGINEERING TAKES NO RESPONSIBILITY FOR THE ACCURACY OF EXISTING TOPOGRAPHIC MAPPING.
2. STATIONING IS AT CENTERLINE UNLESS OTHERWISE NOTED. ALL ELEVATIONS ARE AT EDGE OF ASPHALT (EOA) UNLESS OTHERWISE NOTED. ALL DIMENSIONS ARE FROM EDGE OF ASPHALT TO EDGE OF ASPHALT UNLESS OTHERWISE NOTED.
3. PROPOSED CONTOURS SHOWN ARE TO FINISHED GRADE.
4. LENGTHS SHOWN FOR STORM SEWER PIPES ARE TO CENTER OF MANHOLE.
5. CONTRACTOR SHALL REMOVE AND DISPOSE OF ALL EXISTING STRUCTURES, DEBRIS, WASTE AND OTHER UNSUITABLE FILL MATERIAL FOUND WITHIN THE LIMITS OF EXCAVATION.
6. MATCH INTO EXISTING GRADES AT 3:1 MAX CUT AND FILL SLOPES.
7. REVEGETATION OF ALL DISTURBED AREAS SHALL BE DONE WITH SPECIFIED SEED MIX WITHIN 60 DAYS AFTER FINE GRADING IS COMPLETE.
8. EROSION CONTROL SHALL CONSIST OF SILT FENCE AND CONTROL MEASURES AS SHOWN ON THE DRAWING, AND TOPSOIL WITH GRASS SEED, WHICH WILL BE WATERED UNTIL VEGETATION HAS BEEN REESTABLISHED.
9. THE EROSION CONTROL MEASURES OUTLINED ON THIS PLAN ARE THE RESPONSIBILITY OF THE DEVELOPER TO MONITOR AND REPLACE, REGRADE, AND REBUILD AS NECESSARY UNTIL VEGETATION IS REESTABLISHED.
10. EROSION CONTROL MEASURES SHALL BE IMPLEMENTED IN A MANNER THAT WILL PROTECT ADJACENT PROPERTIES AND PUBLIC FACILITIES FROM THE ADVERSE EFFECTS OF EROSION AND SEDIMENTATION AS A RESULT OF CONSTRUCTION AND EARTHWORK ACTIVITIES WITHIN THE PROJECT SITE.
11. ADDITIONAL EROSION CONTROL MEASURES MAY BE REQUIRED AS DETERMINED BY SITE CONDITIONS.
12. THE CONTRACTOR WILL TAKE THE NECESSARY PRECAUTIONS TO PROTECT EXISTING UTILITIES FROM DAMAGE DUE TO THIS OPERATION. ANY DAMAGE TO THE UTILITIES WILL BE REPAIRED AT THE CONTRACTOR’S EXPENSE, AND ANY SERVICE DISRUPTION WILL BE SETTLED BY THE CONTRACTOR.
13. ALL BACKFILL, SUB-BASE, AND/OR BASE COURSE MATERIAL SHALL BE COMPACTED PER EL PASO COUNTY AND CDOT STANDARDS AND SPECIFICATIONS.
14. ALL FINISHED GRADES SHALL HAVE A MINIMUM 1.0% SLOPE TO PROVIDE POSITIVE DRAINAGE.
15. WHERE PROPOSED SLOPES CONFLICT WITH PROPOSED SPOT ELEVATIONS, SPOT ELEVATIONS SHALL GOVERN.
16. CONTRACTOR SHALL OBTAIN ALL REQUIRED PERMITS PRIOR TO BEGINNING WORK.
17. THERE ARE NO ANTICIPATED DEDICATED ASPHALT/CONCRETE BATCH PLANTS.

DESIGN DATA

ROAD CLASSIFICATION:	RURAL LOCAL RESIDENTIAL
DESIGN SPEED:	30 MPH
POSTED SPEED:	30 MPH
ROADWAY WIDTH:	28’ EOA-EOA
MIN. HORIZONTAL RADIUS:	300’
MIN. GRADE:	1.0%
MAX. GRADE:	8.0%
MIN. K-VALUE (CREST):	19
MIN. K-VALUE (SAG):	37

GENERAL DRAINAGE NOTES:

1. INDIVIDUAL BUILDERS SHALL PROVIDE POSITIVE DRAINAGE AWAY FROM STRUCTURES AND ACCOUNT FOR POTENTIAL CROSS-LOT DRAINAGE IMPACTS WITHIN EACH LOT.
2. BUILDERS AND PROPERTY OWNERS SHALL IMPLEMENT & MAINTAIN EROSION CONTROL BEST MANAGEMENT PRACTICES FOR PROTECTION OF DOWNSTREAM PROPERTIES AND FACILITIES INCLUDING PROTECTION OF EXISTING GRASS BUFFER STRIPS ALONG THE DOWNSTREAM PROPERTY BOUNDARIES.

COUNTY SIGNING AND STRIPING NOTES:

1. ALL SIGNS AND PAVEMENT MARKINGS SHALL BE IN COMPLIANCE WITH THE CURRENT MANUAL ON UNIFORM TRAFFIC CONTROL DEVICES (MUTCD).
2. REMOVAL OF EXISTING PAVEMENT MARKINGS SHALL BE ACCOMPLISHED BY A METHOD THAT DOES NOT MATERIALLY DAMAGE THE PAVEMENT. THE PAVEMENT MARKINGS SHALL BE REMOVED TO THE EXTENT THAT THEY WILL NOT BE VISIBLE UNDER DAY OR NIGHT CONDITIONS. AT NO TIME WILL IT BE ACCEPTABLE TO PAINT OVER EXISTING PAVEMENT MARKINGS.
3. ANY DEVIATION FROM THE STRIPING AND SIGNING PLAN SHALL BE APPROVED BY EL PASO COUNTY DEVELOPMENT SERVICES.
4. ALL SIGNS SHOWN ON THE SIGNING AND STRIPING PLAN SHALL BE NEW SIGNS. EXISTING SIGNS MAY REMAIN OR BE REUSED IF THEY MEET CURRENT EL PASO COUNTY AND MUTCD STANDARDS.
5. STREET NAME AND REGULATORY STOP SIGNS SHALL BE ON THE SAME POST AT INTERSECTIONS.
6. ALL REMOVED SIGNS SHALL BE DISPOSED OF IN A PROPER MANNER BY THE CONTRACTOR.
7. ALL STREET NAME SIGNS SHALL HAVE “C” SERIES LETTERS, WITH LOCAL ROADWAY SIGNS BEING 4” UPPER-LOWER CASE LETTERING ON 8” BLANK AND COLLECTOR ROADWAY SIGNS BEING 6” LETTERING, UPPER-LOWER CASE ON 12” BLANK, WITH ½” WHITE BORDER THAT IS NOT RECESSED.
8. ALL TRAFFIC SIGNS SHALL HAVE A MINIMUM HIGH INTENSITY PRISMATIC GRADE SHEETING.
9. ALL LOCAL RESIDENTIAL STREET SIGNS SHALL BE MOUNTED ON A 1.75” X 1.75” SQUARE TUBE SIGN POST AND STUB POST BASE. FOR OTHER APPLICATIONS, REFER TO THE CDOT STANDARD S-614-8 REGARDING USE OF THE P2 TUBULAR STEEL POST SLIPBASE DESIGN.
10. ALL SIGNS SHALL BE SINGLE SHEET ALUMINUM WITH 0.100” MINIMUM THICKNESS.
11. ALL LIMIT LINES/STOP LINES, CROSSWALK LINES, PAVEMENT LEGENDS, AND ARROWS SHALL BE A MINIMUM 125 MIL THICKNESS PREFORMED THERMOPLASTIC PAVEMENT MARKINGS WITH TAPERED LEADING EDGES PER CDOT STANDARD S-627-1. WORD AND SYMBOL MARKINGS SHALL BE THE NARROW TYPE. STOP BARS SHALL BE 24” IN WIDTH. CROSSWALKS LINES SHALL BE 12” WIDE AND 8’ LONG PER CDOT S-627-1.
12. ALL LONGITUDINAL LINES SHALL BE A MINIMUM 15MIL THICKNESS EPOXY PAINT. ALL NON-LOCAL RESIDENTIAL ROADWAYS SHALL INCLUDE BOTH RIGHT AND LEFT EDGE LINE STRIPING AND ANY ADDITIONAL STRIPING AS REQUIRED BY CDOT S-627-1.
13. THE CONTRACTOR SHALL NOTIFY EL PASO COUNTY DEVELOPMENT SERVICES (719) 520-6819 PRIOR TO AND UPON COMPLETION OF SIGNING AND STRIPING.
14. THE CONTRACTOR SHALL OBTAIN A WORK IN THE RIGHT OF WAY PERMIT FROM THE EL PASO COUNTY DEPARTMENT OF TRANSPORTATION PRIOR TO ANY SIGNAGE OR STRIPING WORK WITHIN AN EXISTING EL PASO COUNTY ROADWAY.



LEGEND:

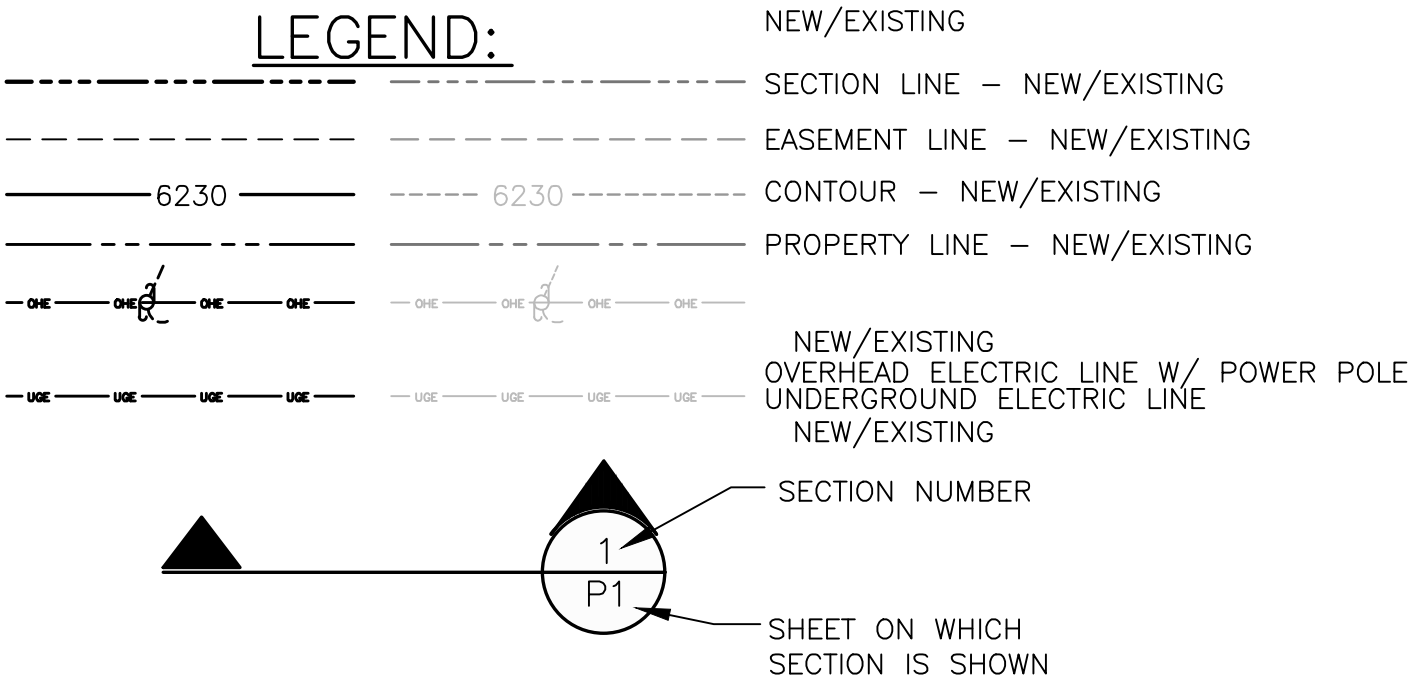



C:\Users\Michael\Dropbox\jpsprojects\030501.settlers\F3\dwg\Civil\F3\TY1.dwg Jul 17, 2024 - 4:46pm

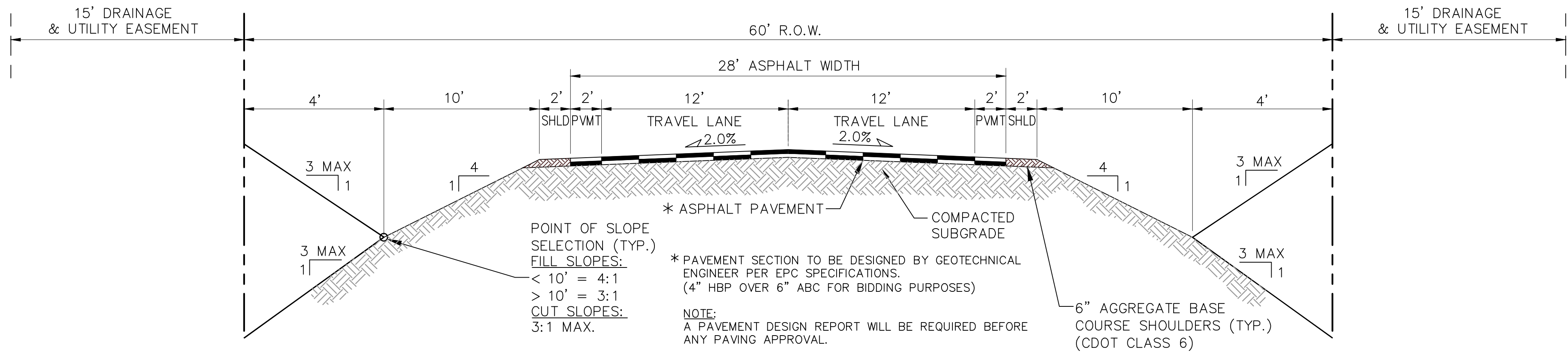

**RURAL LOCAL-PAVED ROAD (PUBLIC)**  
**SETTLERS RANCH RD/BOUNDARY BASIN CT**  
**TYPICAL SECTION (A)**  
N.T.S.

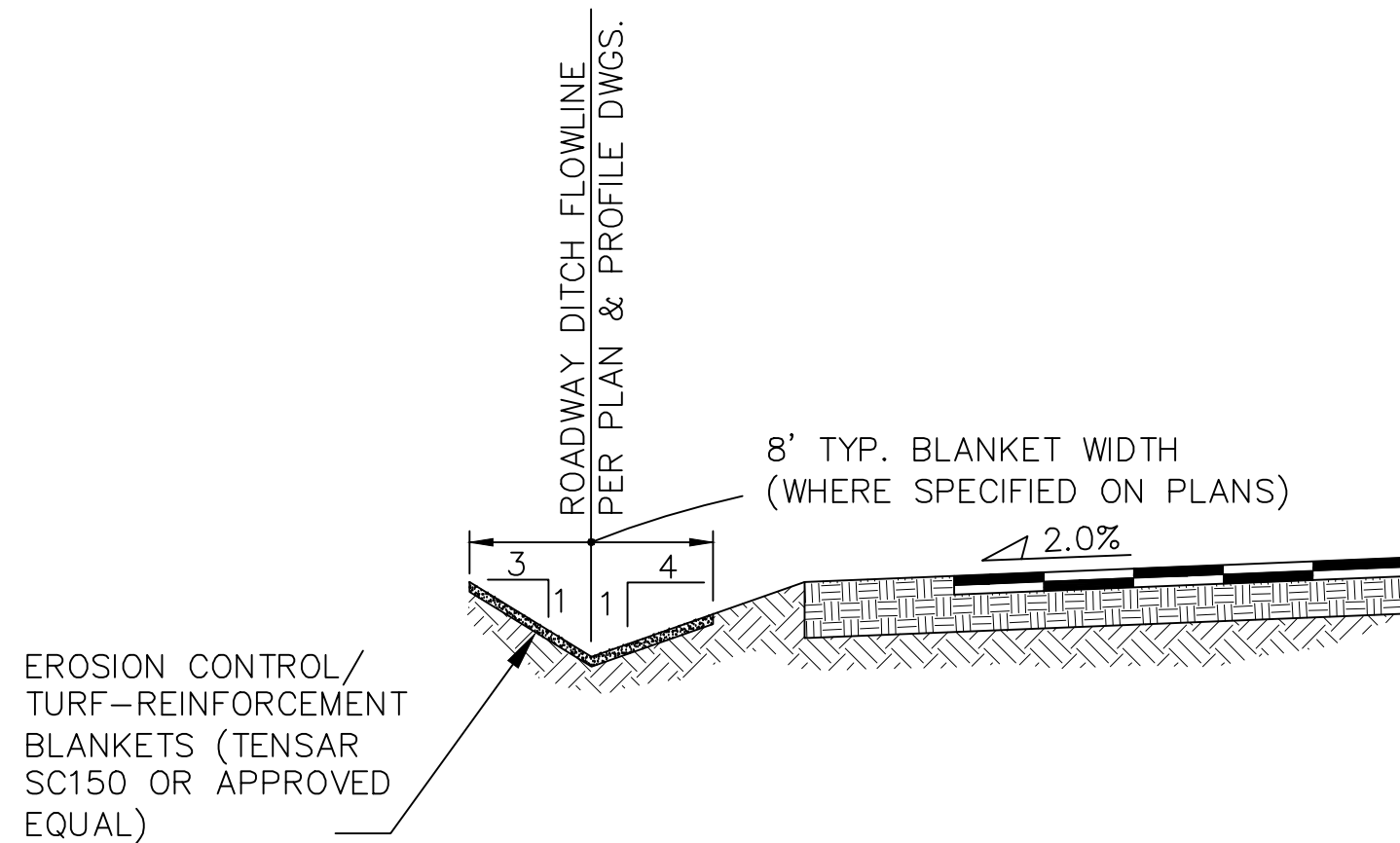

**TYPICAL DITCH SECTION WITH EROSION CONTROL BLANKETS**  
SCALE : NTS

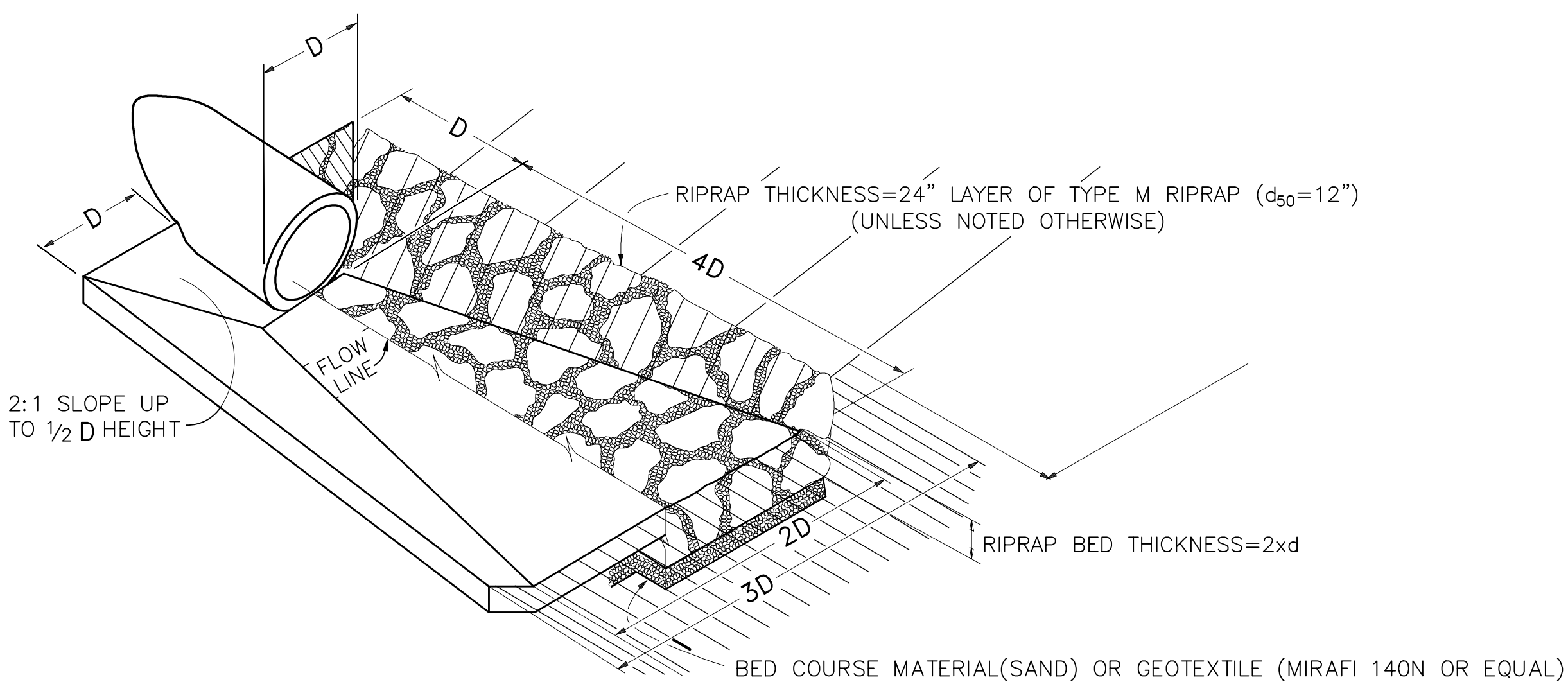

**TYPICAL RIPRAP APRON/CULVERT OUTLET PAVING**  
NOT TO SCALE



PCD FILE NO. SF-249

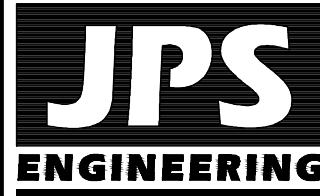

19 E. Willamette Ave.  
Colorado Springs, CO  
80903  
PH: 719-477-9429  
FAX: 719-471-0766  
www.jpsengr.com

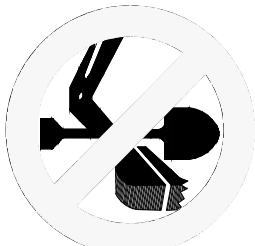

CALL UTILITY NOTIFICATION  
CENTER OF COLORADO  
1-800-922-1987  
CALL 2-BUSINESS DAYS IN ADVANCE  
BEFORE YOU DIG, GRADE, OR EXCAVATE  
FOR THE MARKING OF UNDERGROUND  
MEMBER UTILITIES.

No.	REVISION	BY	DATE

**TYPICAL SECTION  
AND DETAILS**

HORIZ. SCALE:	AS SHOWN	DRAWN:	BJJ
VERT. SCALE:	AS SHOWN	DESIGNED:	JPS
SURVEYED:	RAMPART	CHECKED:	JPS
CREATED:	11/23/16	LAST MODIFIED:	7/17/24
PROJECT NO:	111603	MODIFIED BY:	MSP

SHEET:

**TY1-F3**



C:\Users\Michael\Dropbox\jpsprojects\030501.settlers F3\dwg\Civil\F3\PP4.dwg Jul 22, 2024 -- 10:26pm

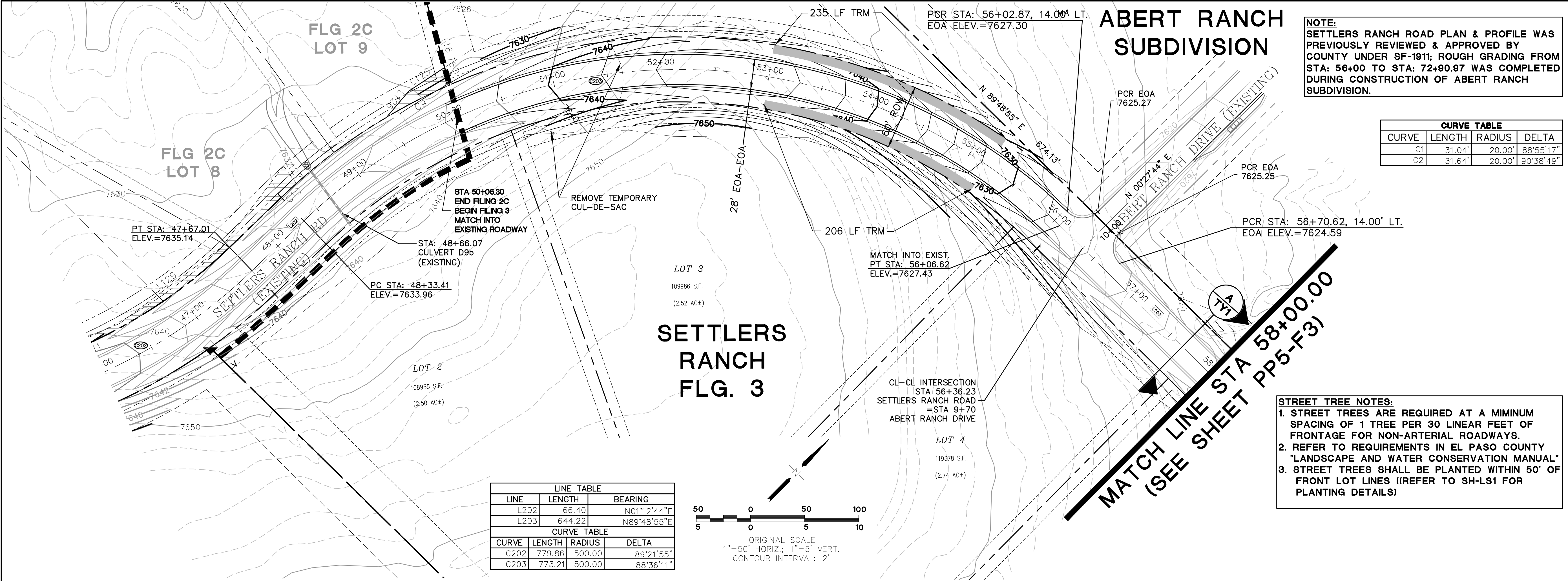







C:\Users\Michael\Dropbox\projects\030501.settlrs F3\dwg\Civil\F3\PP6.dwg Jul 22, 2024 -- 8:37pm

LINE TABLE			
LINE	LENGTH	BEARING	
L205	235.03	S89°10'03"E	
CURVE TABLE			
CURVE	LENGTH	RADIUS	DELTA
C223	39.24	25.00	89°56'28.6"
C224	39.30	25.00	90°03'31.3"

MATCH LINE STA 70+00.00  
(SEE SHEET PP5-F3)

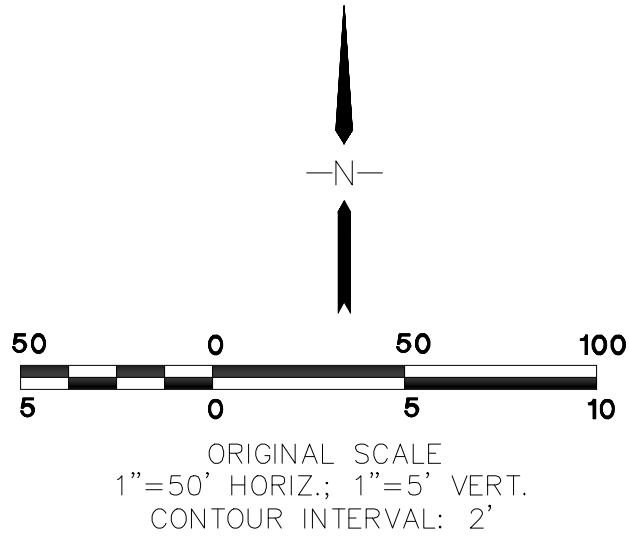
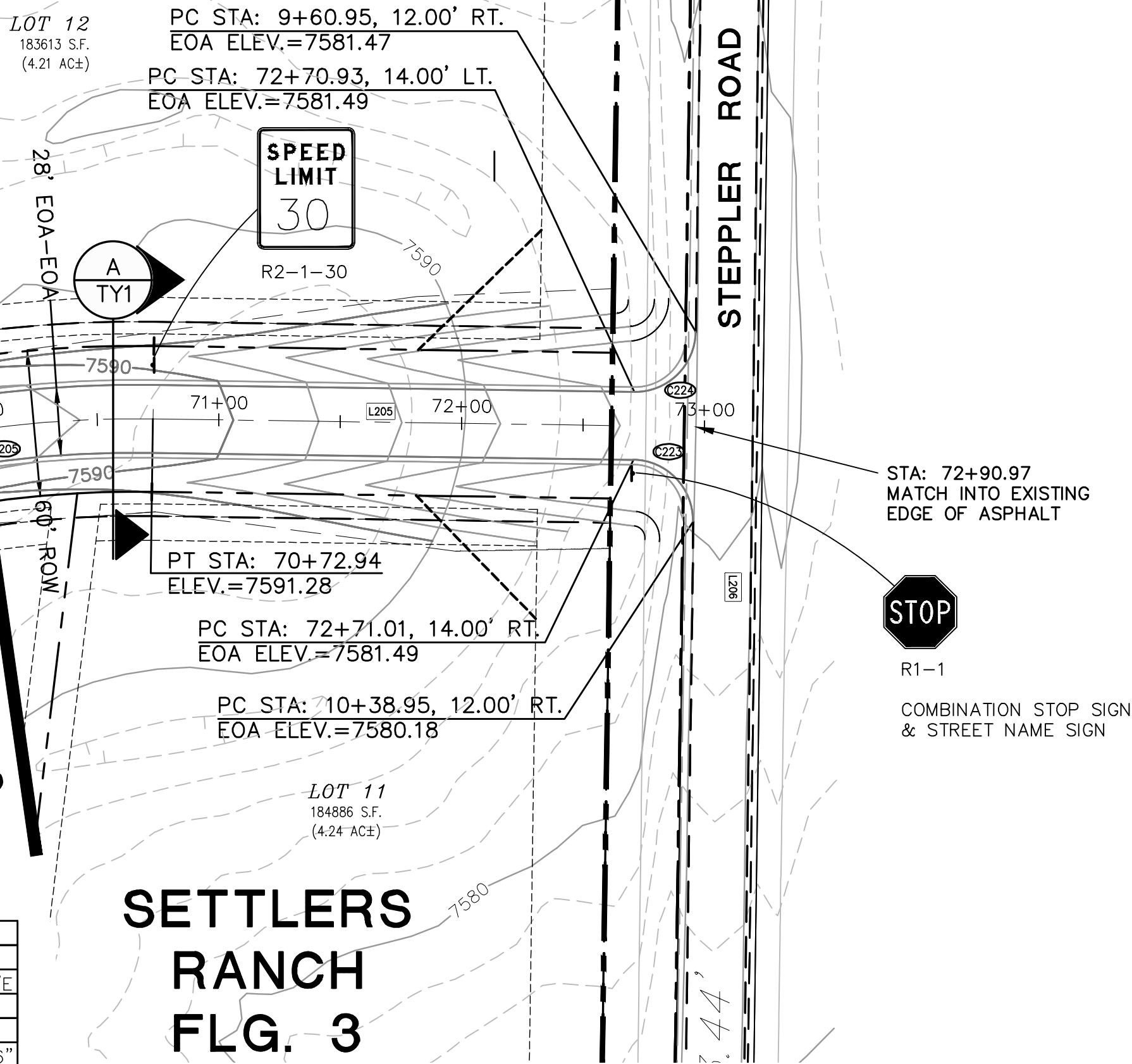

NOTE:  
SETTLERS RANCH ROAD PLAN & PROFILE WAS  
PREVIOUSLY REVIEWED & APPROVED BY  
COUNTY UNDER SF-1911; ROUGH GRADING FROM  
STA: 56+00 TO STA: 72+90.97 WAS COMPLETED  
DURING CONSTRUCTION OF ABERT RANCH  
SUBDIVISION.

- STREET TREE NOTES:
1. STREET TREES ARE REQUIRED AT A MINIMUM  
SPACING OF 1 TREE PER 30 LINEAR FEET OF  
FRONTAGE FOR NON-ARTERIAL ROADWAYS.
  2. REFER TO REQUIREMENTS IN EL PASO COUNTY  
"LANDSCAPE AND WATER CONSERVATION MANUAL"
  3. STREET TREES SHALL BE PLANTED WITHIN 50' OF  
FRONT LOT LINES ((REFER TO SH-LS1 FOR  
PLANTING DETAILS))

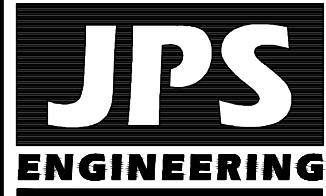

19 E. Willamette Ave.  
Colorado Springs, CO  
80903

PH: 719-477-9429  
FAX: 719-471-0766  
www.jpsengr.com

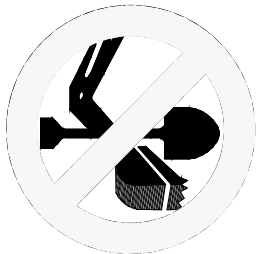

CALL UTILITY NOTIFICATION  
CENTER OF COLORADO  
1-800-922-1987  
CALL 2-BUSINESS DAYS IN ADVANCE  
BEFORE YOU DIG, GRADE, OR EXCAVATE  
FOR THE MARKING OF UNDERGROUND  
MEMBER UTILITIES.

## SETTLERS RANCH FILING NO 3

SETTLERS RANCH RD.  
PLAN & PROFILE  
(STA: 70+00 TO STA: 73+00)

HORIZ. SCALE: 1"=50'	DRAWN: RMD
VERT. SCALE: 1"=5'	DESIGNED: JPS
SURVEYED: RAMPART	CHECKED: JPS
CREATED: 4/05/18	LAST MODIFIED: 7/22/24
PROJECT NO: 030501	MODIFIED BY: MSP
SHEET:	



PCD FILE NO. SF-249

PP6-F3

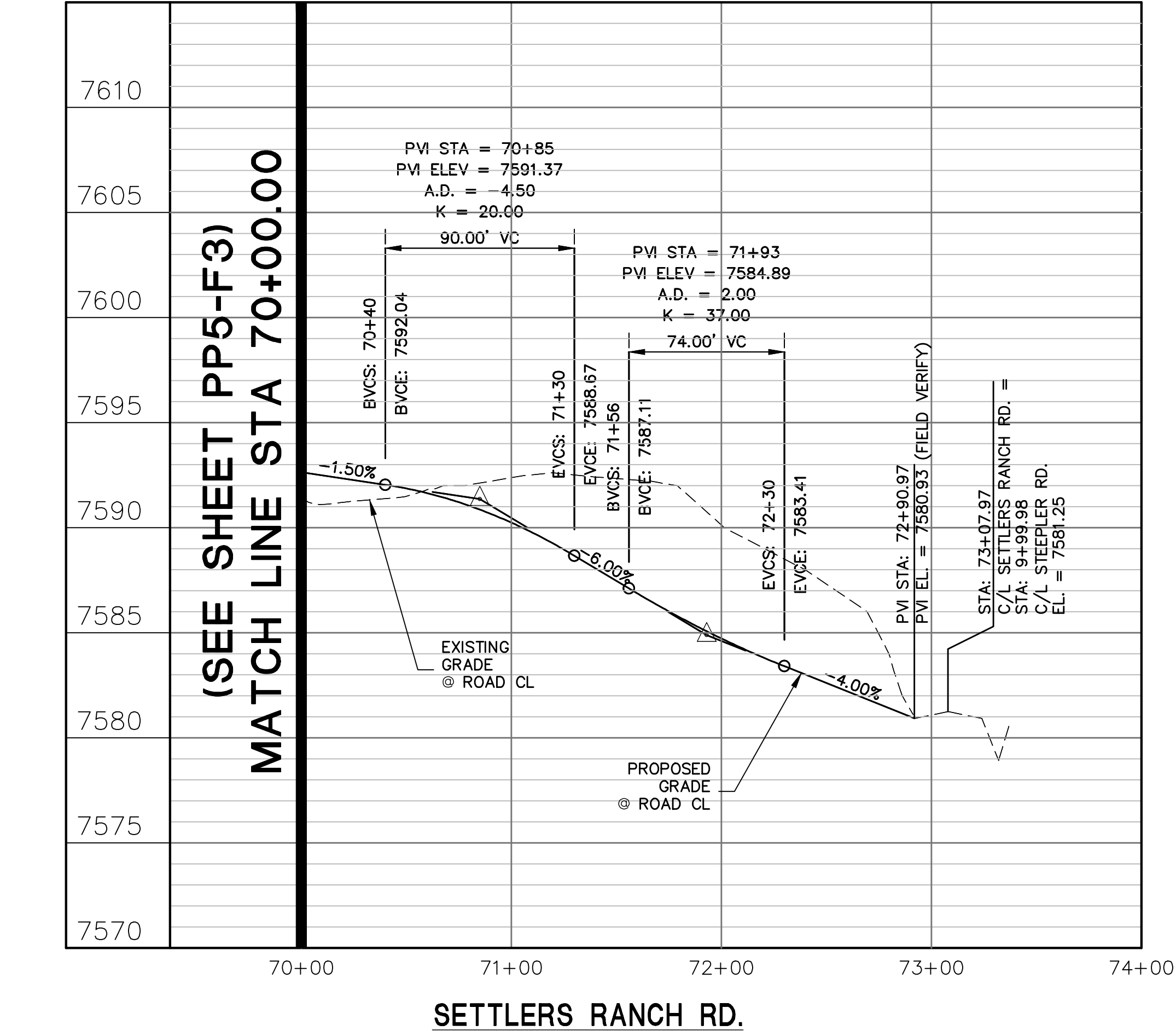

BENCHMARK: MONUMENT AT SW CORNER OF ABERT RANCH SUBDIVISION  
BM EL (SETTLERS RANCH DATUM) = 7642.52 (DATUM UNKNOWN)  
BM EL (ABERT RANCH DATUM) = 7650.04 (DATUM NAVD 88)  
BM CONVERSION = 7.52 FT







C:\Users\Michael\Dropbox\jpsprojects\030501.settlers F3\dwg\Civil\F3\SD1-F3.dwg Jul 18, 2024 - 12:31pm

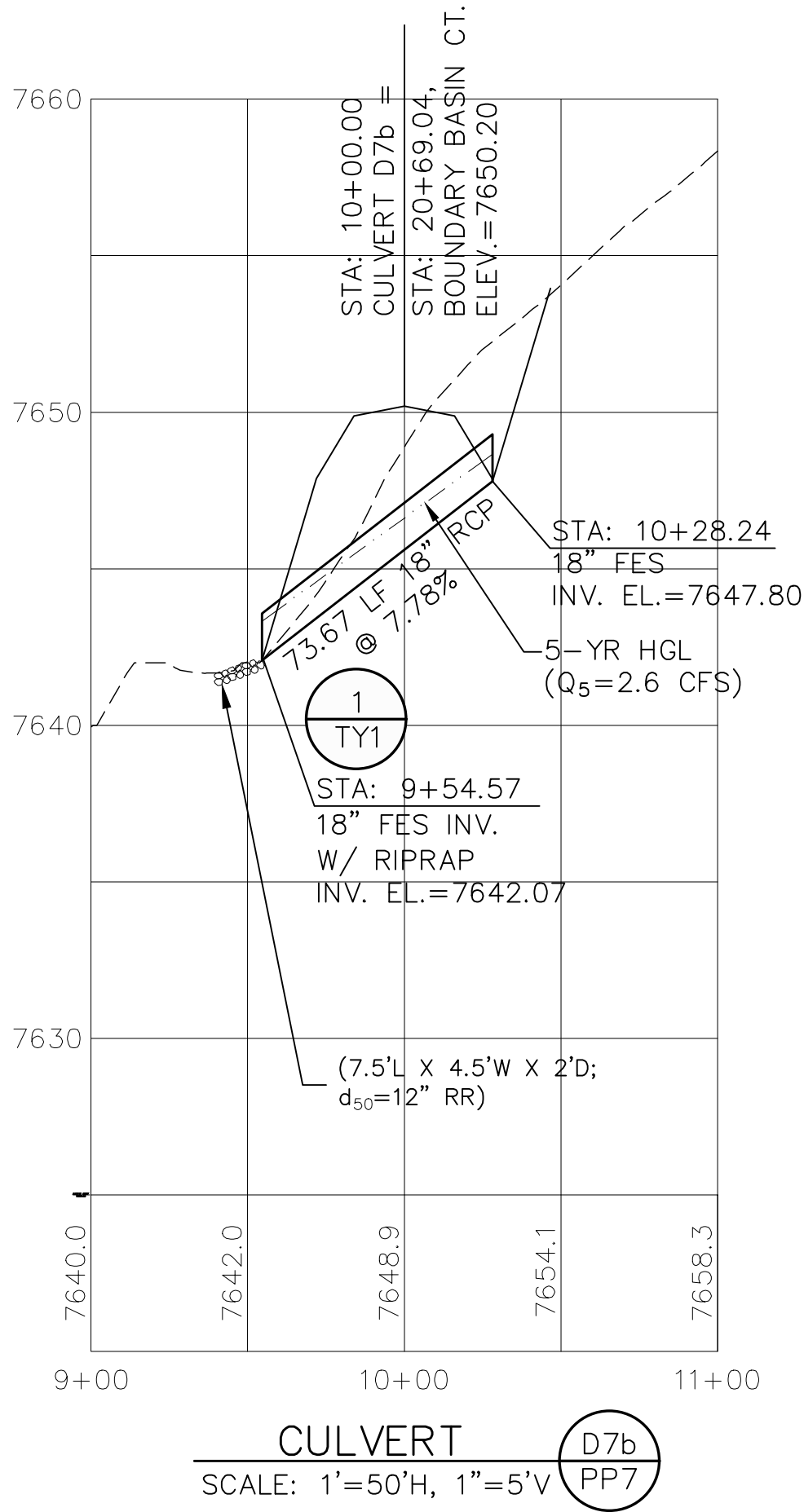

PCD FILE NO. SF-249

SETTLERS RANCH FILING NO. 3

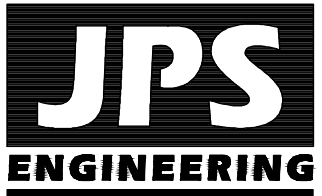

19 E. Willamette Ave.  
Colorado Springs, CO  
80903  
PH: 719-477-9429  
FAX: 719-471-0766  
www.jpsengr.com



CALL UTILITY NOTIFICATION  
CENTER OF COLORADO  
1-800-922-1987  
CALL 2-BUSINESS DAYS IN ADVANCE  
BEFORE YOU DIG, GRADE, OR EXCAVATE  
FOR THE MARKING OF UNDERGROUND  
MEMBER UTILITIES.

No.	REVISION	BY	DATE

CULVERT PROFILES

HORZ. SCALE: 1"=50'	DRAWN: RMD
VERT. SCALE: 1"=5'	DESIGNED: JPS
SURVEYED: RAMPART	CHECKED: JPS
CREATED: 4/05/18	LAST MODIFIED: 7/17/24
PROJECT NO: 030501	MODIFIED BY: MSP

SHEET:

SD1-F3



C:\Users\Michael\Dropbox\paprojects\030501 settlers\F3\dwg\Civil\F3\LS1-F3.dwg    Jul. 22, 2024    - 9:16pm

- NOTES:
1. MARK THE NORTH SIDE OF TREE IN THE NURSERY, AND ROTATE TREE TO FACE NORTH AT THE SITE WHENEVER POSSIBLE.
  2. AT TIME OF PLANTING, DO NOT REMOVE OR CUT LEADER AND PRUNE ONLY DEAD OR BROKEN BRANCHES, CROSS OVER BRANCHES, AND WEAK OR NARROW CROTCHES. SOME INTERIOR TWIGS AND LATERAL BRANCHES MAY BE PRUNED. HOWEVER, DO NOT REMOVE THE TERMINAL BUDS OF BRANCHES THAT EXTEND TO THE EDGE OF THE CROWN.
  3. STRUCTURAL PRUNING SHOULD NOT BEGIN UNTIL AFTER ESTABLISHMENT PERIOD, USUALLY TWO GROWING SEASONS.
  4. KEEP PLANTS MOIST AND SHADED UNTIL PLANTING.
  5. DO NOT FERTILIZE FOR AT LEAST ONE GROWING SEASON.
  6. AMENDED BACKFILL SHALL BE 1/3 COMPOST (PREFERABLY CLASSIFIED) AND 2/3 NATIVE AND/OR IMPORTED TOPSOIL.
  7. IN WINTER WRAP TRUNK ON EXPOSED SITES AND SPECIES WITH THIN BARK WITH ELECTRICAL OR DUCT TAPE, NOT TWINE.
  8. COORDINATE WITH CITY FORESTRY FOR CURRENT INSECT AND DISEASE RECOMMENDATIONS PRIOR TO PLANTING.
  9. DEEP WATER ALL PLANTS AT TIME OF PLANTING.
  10. ALL TREES LOCATED IN ROCK/COBBLE BEDS SHALL HAVE A 36 INCH DIAMETER WOOD MULCH RING.

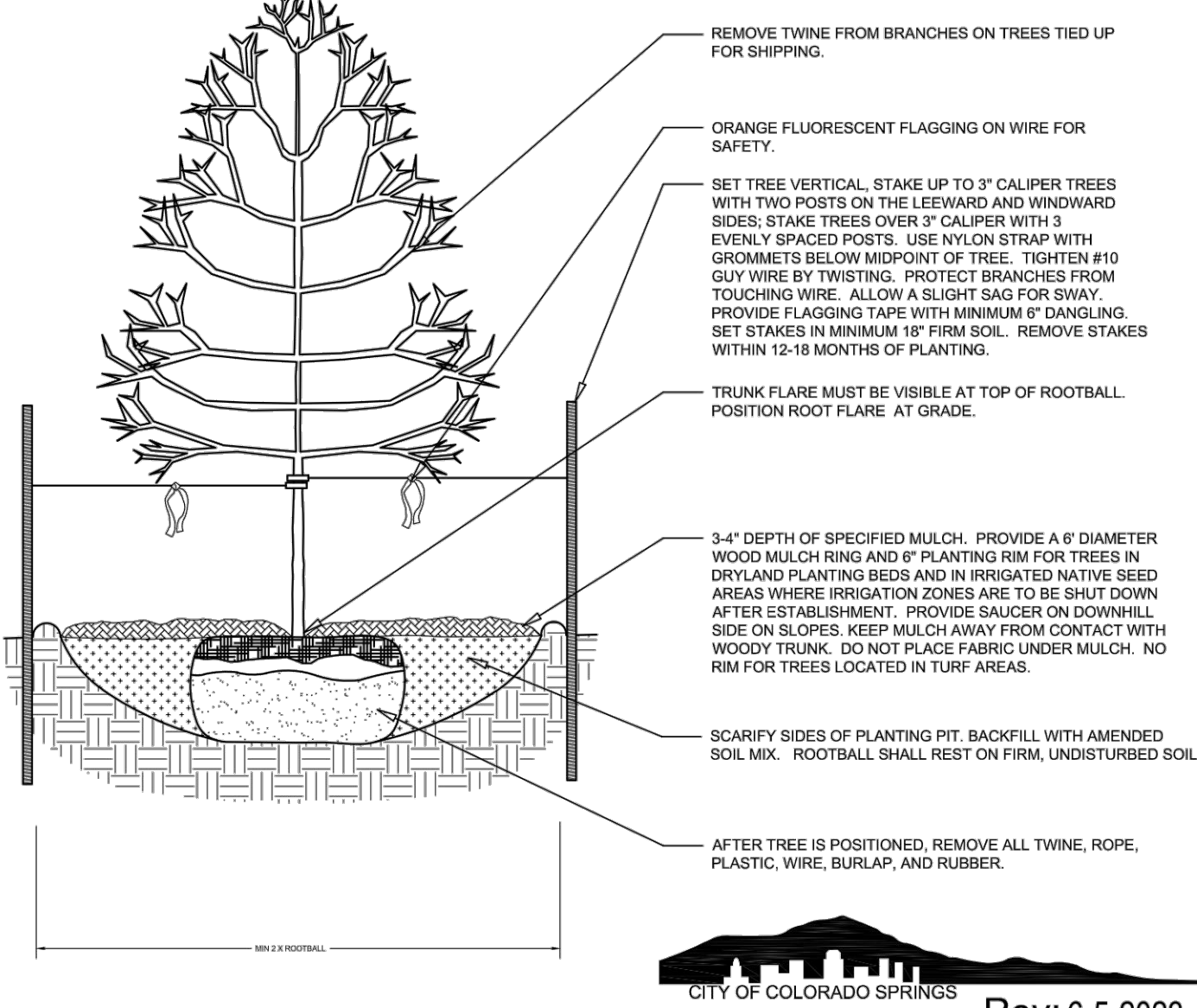

Rev: 6-5-2023

Disclaimer: These planting details are for City review and approval process only and shall not be used for construction or bidding purposes.

#### DECIDUOUS TREE PLANTING DETAIL

NOT TO SCALE

SECTION

- NOTES:
1. MARK THE NORTH SIDE OF TREE IN THE NURSERY, AND ROTATE TREE TO FACE NORTH AT THE SITE WHENEVER POSSIBLE.
  2. AT TIME OF PLANTING, DO NOT REMOVE OR CUT LEADER AND PRUNE ONLY DEAD OR BROKEN BRANCHES, CROSS OVER BRANCHES, AND WEAK OR NARROW CROTCHES. SOME INTERIOR TWIGS AND LATERAL BRANCHES MAY BE PRUNED. HOWEVER, DO NOT REMOVE THE TERMINAL BUDS OF BRANCHES THAT EXTEND TO THE EDGE OF THE CROWN.
  3. STRUCTURAL PRUNING SHOULD NOT BEGIN UNTIL AFTER ESTABLISHMENT PERIOD, USUALLY TWO GROWING SEASONS.
  4. KEEP PLANTS MOIST AND SHADED UNTIL PLANTING.
  5. DO NOT FERTILIZE FOR AT LEAST ONE GROWING SEASON.
  6. AMENDED BACKFILL SHALL BE 1/3 COMPOST (PREFERABLY CLASSIFIED) AND 2/3 NATIVE AND/OR IMPORTED TOPSOIL.
  7. WRAP TRUNK ON EXPOSED SITES AND SPECIES WITH THIN BARK. USE ELECTRICAL OR DUCT TAPE, NOT TWINE. OCTOBER 31 AND REMOVE MARCH 31 FOR THE PIKES PEAK REGION.
  8. COORDINATE WITH CITY FORESTRY FOR CURRENT INSECT AND DISEASE RECOMMENDATIONS PRIOR TO PLANTING.
  9. DEEP WATER ALL PLANTS AT TIME OF PLANTING.
  10. ALL TREES LOCATED IN ROCK/COBBLE BEDS SHALL HAVE A 36 INCH DIAMETER WOOD MULCH RING.

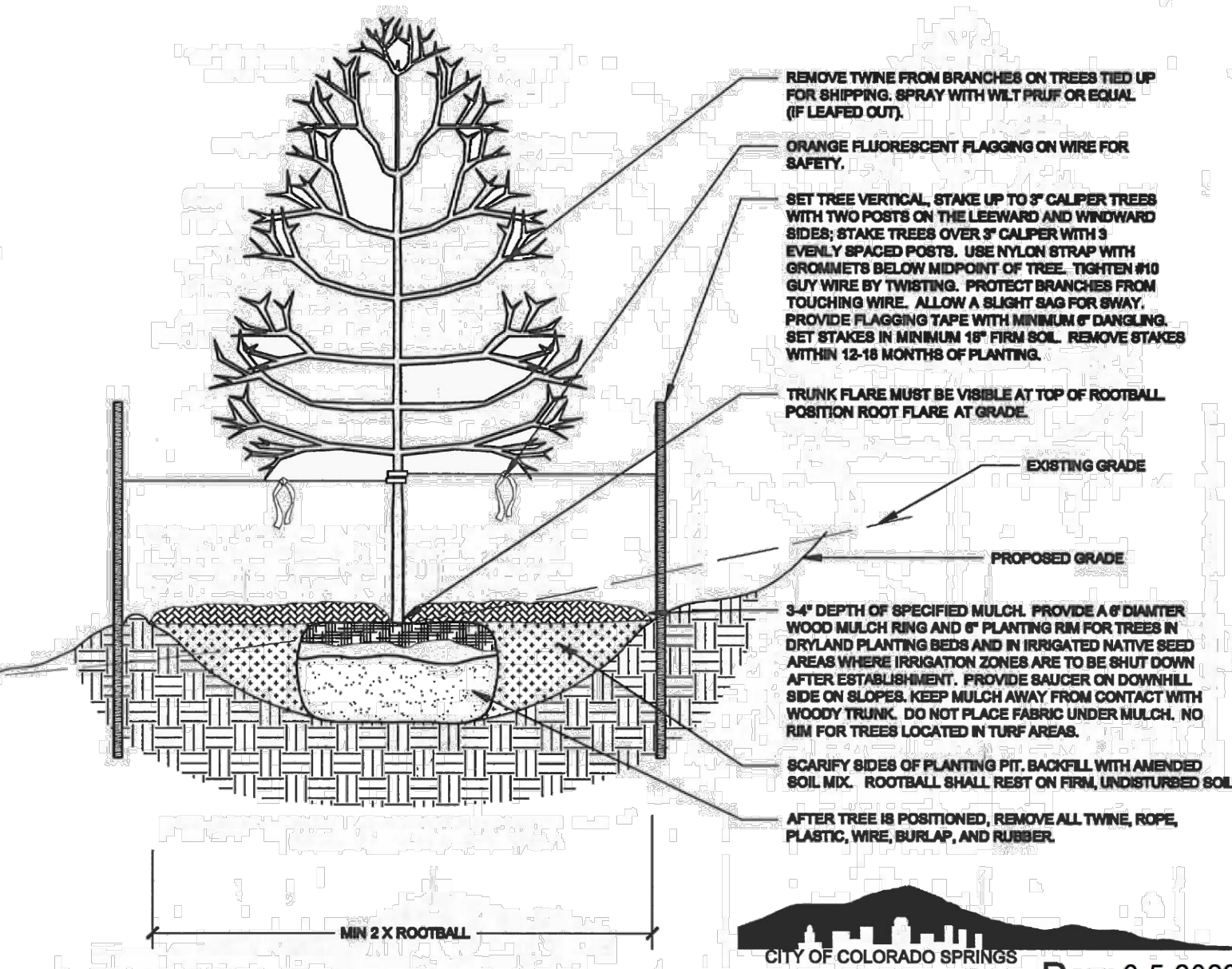

Rev: 6-5-2023

#### DECIDUOUS TREE PLANTING ON SLOPES DETAIL

NOT TO SCALE

SECTION

Disclaimer: These planting details are for City review and approval process only and shall not be used for construction or bidding purposes.

- NOTES:
1. DO NOT REMOVE OR CUT LEADER.
  2. PRUNE ONLY DEAD OR BROKEN BRANCHES IMMEDIATELY PRIOR TO PLANTING.
  3. DO NOT REMOVE ANY DOUBLE LEADER, UNLESS OTHERWISE DIRECTED BY OWNERS REPRESENTATIVE.
  4. KEEP PLANTS MOIST AND SHADED UNTIL PLANTING.
  5. AMENDED BACKFILL SHALL BE 1/3 COMPOST (PREFERABLY CLASSIFIED) AND 2/3 NATIVE AND/OR IMPORTED TOPSOIL.
  6. MARK THE NORTH SIDE OF TREE IN THE NURSERY, AND ROTATE TREE TO FACE NORTH AT THE SITE WHENEVER POSSIBLE.
  7. PINE AND SPRUCE TREES TO BE SPRAYED FOR IPS BARK BEETLE PRIOR TO PLANTING. COORDINATE WITH CITY FORESTRY FOR CURRENT INSECT AND DISEASE RECOMMENDATIONS PRIOR TO PLANTING.
  8. ALL TREES TO BE DEEP WATERED AT TIME OF PLANTING.
  9. ALL TREES LOCATED IN ROCK/COBBLE BEDS SHALL HAVE A 36 INCH DIAMETER WOOD MULCH RING.

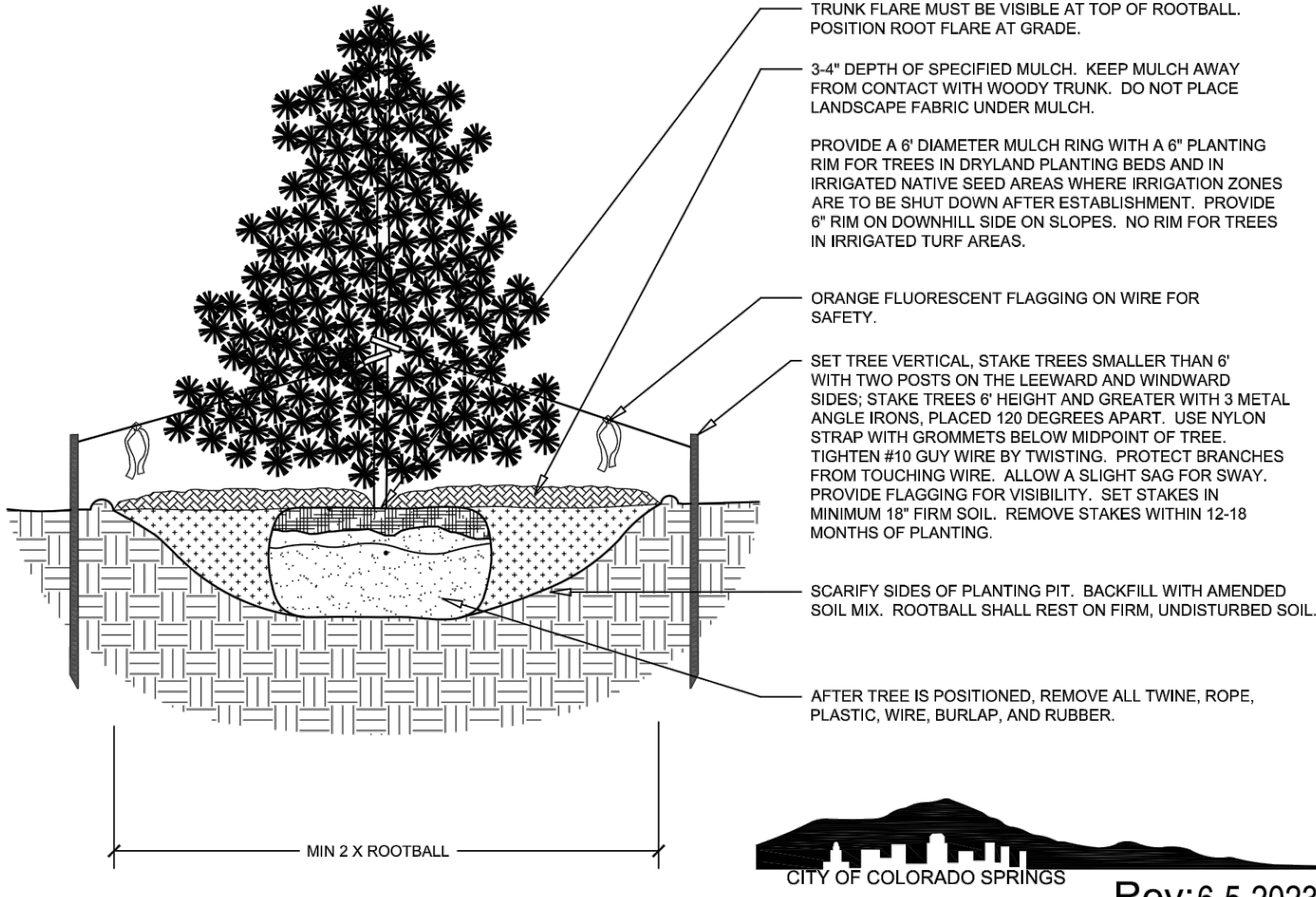

Rev: 6-5-2023

Disclaimer: These planting details are for City review and approval process only and shall not be used for construction or bidding purposes.

#### EVERGREEN TREE PLANTING DETAIL

NOT TO SCALE

SECTION

- NOTES:
1. DO NOT REMOVE OR CUT LEADER.
  2. PRUNE ONLY DEAD OR BROKEN BRANCHES IMMEDIATELY PRIOR TO PLANTING.
  3. DO NOT REMOVE ANY DOUBLE LEADER, UNLESS OTHERWISE DIRECTED BY OWNERS REPRESENTATIVE.
  4. KEEP PLANTS MOIST AND SHADED UNTIL PLANTING.
  5. AMENDED BACKFILL SHALL BE 1/3 COMPOST (PREFERABLY CLASSIFIED) AND 2/3 NATIVE AND/OR IMPORTED TOPSOIL.
  6. MARK THE NORTH SIDE OF TREE IN THE NURSERY, AND ROTATE TREE TO FACE NORTH AT THE SITE WHENEVER POSSIBLE.
  7. PINE AND SPRUCE TREES TO BE SPRAYED FOR IPS BARK BEETLE PRIOR TO PLANTING. COORDINATE WITH CITY FORESTRY FOR CURRENT INSECT AND DISEASE RECOMMENDATIONS PRIOR TO PLANTING.
  8. ALL TREES TO BE DEEP WATERED AT TIME OF PLANTING.
  9. ALL TREES LOCATED IN ROCK/COBBLE BEDS SHALL HAVE A 36 INCH DIAMETER WOOD MULCH RING.

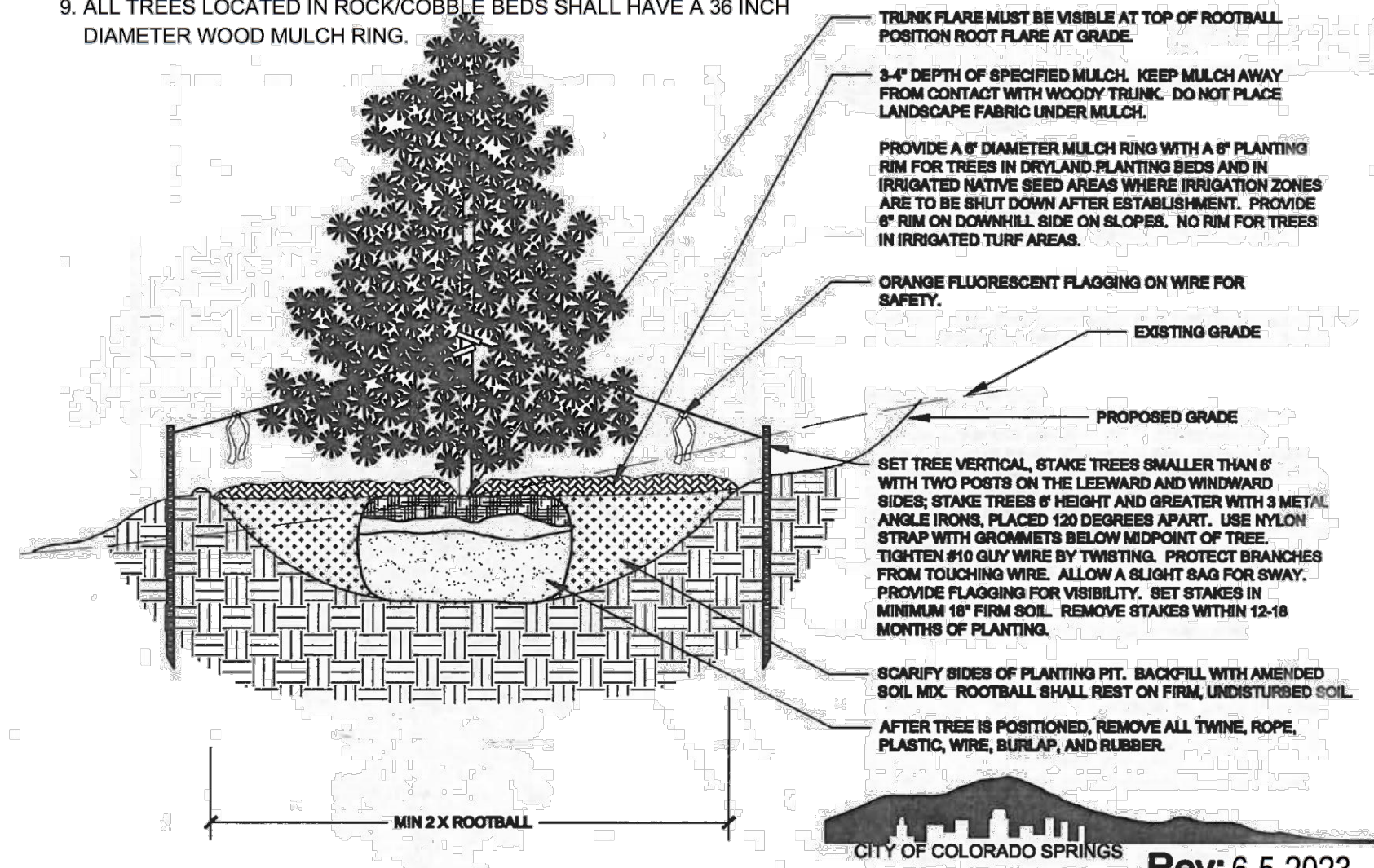

Rev: 6-5-2023

#### EVERGREEN TREE PLANTING ON SLOPES DETAIL

NOT TO SCALE

SECTION

Disclaimer: These planting details are for City review and approval process only and shall not be used for construction or bidding purposes.

- NOTES:
1. PRUNE ONLY DEAD OR BROKEN BRANCHES AND WEAK OR NARROW CROTCHES.
  2. KEEP PLANTS MOIST AND SHADED UNTIL PLANTING.
  3. DO NOT FERTILIZE FOR AT LEAST ONE GROWING SEASON.
  4. AMENDED BACKFILL SHALL BE 1/3 COMPOST (PREFERABLY CLASSIFIED) AND 2/3 NATIVE AND/OR IMPORTED TOPSOIL.
  5. ALL SHRUBS IN ROCK AREAS TO RECEIVE SHREDDED MULCH RINGS.
  6. DEEP WATER ALL PLANTS AT TIME OF PLANTING.
  7. ALL SHRUBS LOCATED IN ROCK/COBBLE BEDS SHALL HAVE A 18 INCH DIAMETER WOOD MULCH RING.

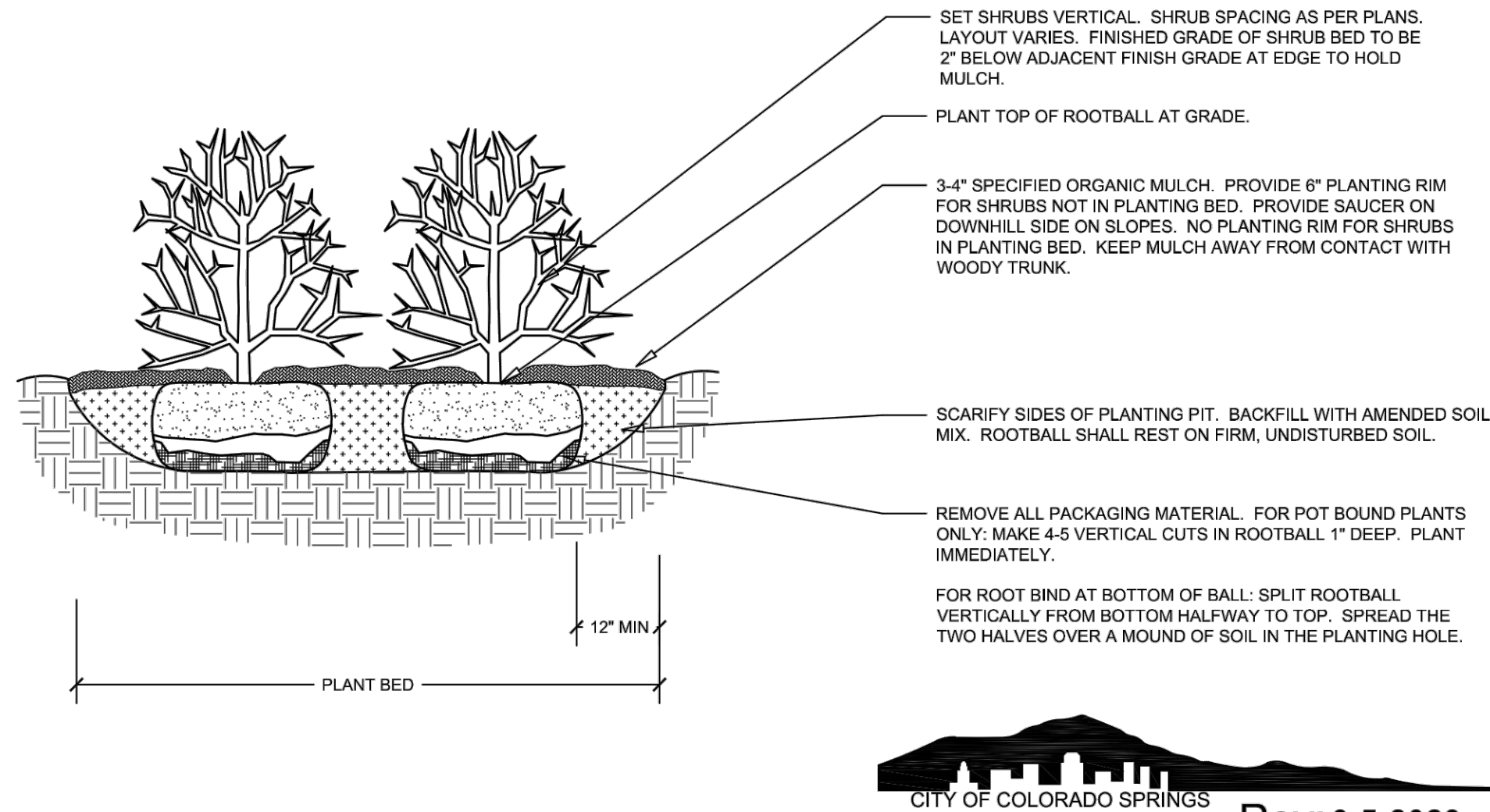

Rev: 6-5-2023

Disclaimer: These planting details are for City review and approval process only and shall not be used for construction or bidding purposes.

#### SHRUB PLANTING DETAIL

NOT TO SCALE

SECTION

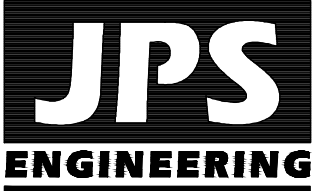

19 E. Willamette Ave.  
Colorado Springs, CO  
80903

PH: 719-477-9429  
FAX: 719-471-0766  
www.jpsengr.com



CALL UTILITY NOTIFICATION  
CENTER OF COLORADO  
1-800-922-1987  
CALL 2-BUSINESS DAYS IN ADVANCE  
BEFORE YOU DIG, GRADE OR EXCAVATE  
FOR THE MARKING OF UNDERGROUND  
MEMBER UTILITIES.

NO.	REVISION	BY	DATE

#### PLANTING DETAILS



HORZ. SCALE:	N/A	DRAWN:	MSP
VERT. SCALE:	N/A	DESIGNED:	JPS
SURVEYED:	RAMPART	CHECKED:	JPS
CREATED:	7/22/24	LAST MODIFIED:	7/22/24
PROJECT NO:	030501	MODIFIED BY:	MSP

SHEET:

LS1-F3

PCD FILE NO. SF-249