

EL PASO COUNTY HEALTH DEPARTMENT  
COLORADO SPRINGS, COLORADO

SEWAGE DISPOSAL INSPECTION FORM

2  
Permit No. 04948  
DATE 8/15/83  
ENVIRONMENTALIST J. K. Karris

APPROVAL:  
YES  NO

#4122000002

LOCATION (street number) 16888 Elbert Rd OCCUPANT W. E. Whitten

LEGAL DESCRIPTION A tract in SW 1/4 NW 1/4 NW 1/4 SW 1/4 S 22, T 11 S, R 64 W

TYPE OF CONSTRUCTION Frame NO. OF BEDROOMS 3

SYSTEM INSTALLED BY Carl Braun

COMMERCIAL MFG. Gordon SIZE 1500g

TYPE OF MATERIAL Cement NO. COMPARTMENTS 2

WIDTH 68" LENGTH 126" DEPTH (total) 68" LIQ. CAP. 1500g

DISPOSAL FIELD: BED OR TRENCH DEPTH 30" WIDTH 36" LENGTH 150' SQ. FT. 450

DISTANCE BETWEEN LINES 20' ROCK 1 1/2" Rm DEPTH 12" UNDER 6" OVER 2"

LEACHING FITS (NO.) LINING MATERIAL CAPACITY SQ. FT.

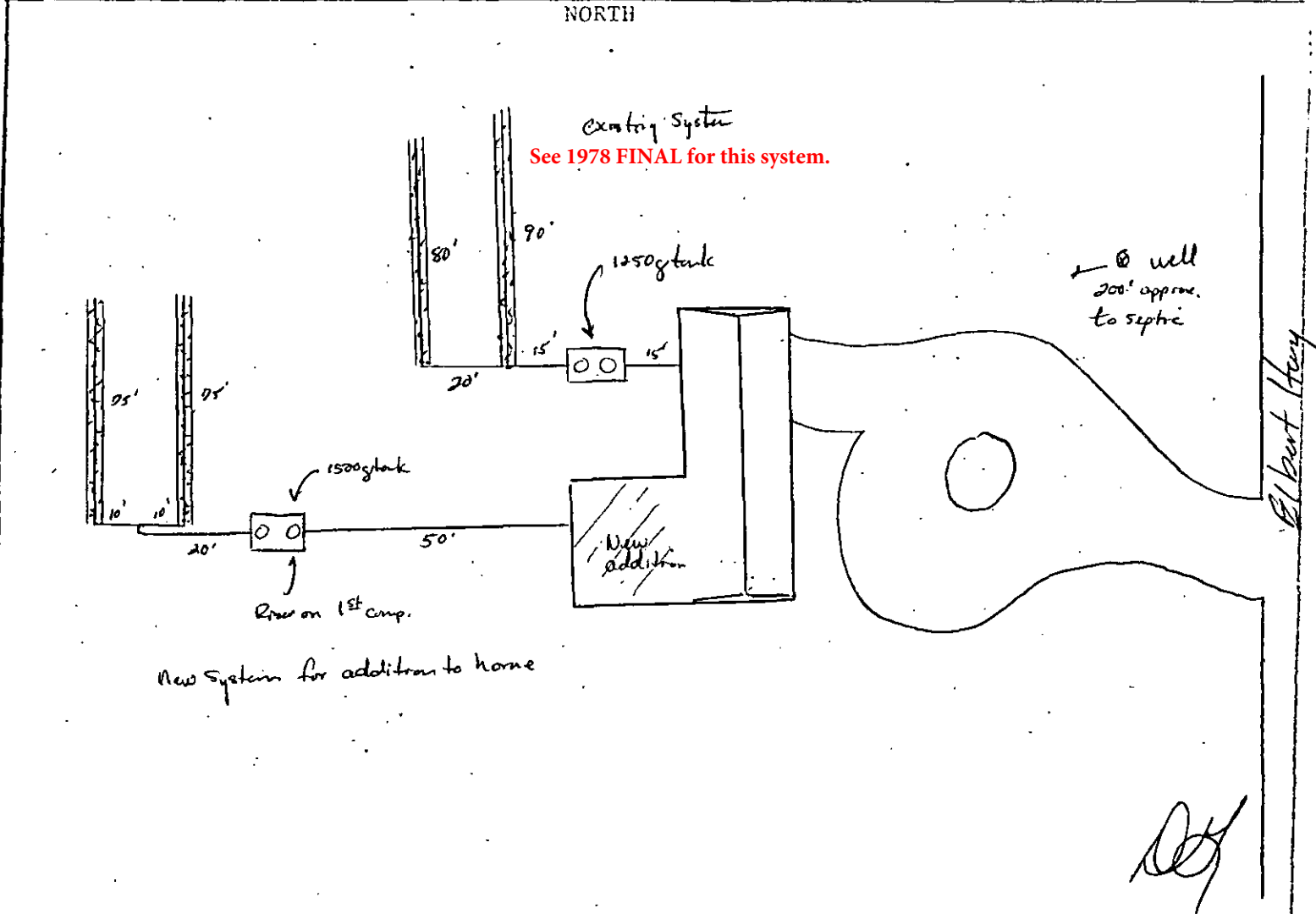

*[Handwritten signature]*

Acres 1.75

EL PASO COUNTY . CITY-COUNTY HEALTH DEPARTMENT  
501 North Foote Avenue . Colorado Springs, Colorado - 475-8240

04948

Water Supply Well

Receipt No. 2924

# PERMIT

TO CONSTRUCT, ALTER, REPAIR OR MODIFY AN INDIVIDUAL SEWAGE DISPOSAL SYSTEM

Issued To L. F. W. 1968

Date September 7, 1970

Address of Property Box 7, Box 331, Peyton, Colorado 80537

(Permit valid at this address only)

Builder - Contractor - Owner Address Same

Phone \_\_\_\_\_

Sewage-Disposal System work to be performed by Same

Phone \_\_\_\_\_

This Permit is issued in accordance with Regulation XII and Article 2 of Chapter 66, Colorado Revised Statutes 1963, as amended by the addition of a new Section 66-2-16. (H.B. 1205, 7-1-65). PERMIT EXPIRES upon completion-installation of sewage-disposal system or at the end of six (6) months from date of issue - whichever occurs first - (unless work is in progress).

- This Permit does not denote approval of zoning and acreage requirements. -

Permit Fee \$50.00

Charles H. Landing, Jr., D. O., M. P. S.

Director, City-County Health Department

February 7, 1970

Dale W. Brashers

Date of Expiration

Environmentalist

NOTE: LEAVE ENTIRE SEWAGE-DISPOSAL SYSTEM UNCOVERED FOR FINAL INSPECTION.

### 24-HOUR ADVANCE NOTICE REQUIRED

Septic tank	<u>1000</u> gals.	Field	<u>25</u>	Feet of trench	_____	inches wide
		OR- Field	<u>25</u>	Feet of trench	_____	inches wide
Seepage bed	_____ ft. long	_____ ft. wide.	Seepage pit	_____ sq. ft.	_____ diam.	_____ w/d

The Health Officer shall assume no responsibility in case of failure or inadequacy of a sewage-disposal system, beyond consulting in good faith with the property owner or representative. Free access to the property shall be authorized at reasonable times for the purpose of making such inspections as are necessary to determine compliance with requirements of this regulation.

Date July 9, 1983

EL PASO COUNTY HEALTH DEPARTMENT  
501 NORTH FOOTE AVENUE  
COLORADO SPRINGS, COLORADO  
636-0125

directly W. of side of address  
outside of fence  
cyclone fence  
St West  
Stucco w/ Black trim  
Back of Rd

TAX SCHEDULE # \_\_\_\_\_

Application for permit to construct, Remodel, or Install a Sewage Disposal System

Name of Owner W.E. or Lorine K. Whiffen Phone 749-2185

Address of Property 16888 Elbert Road, Peyton, Co. 80831 6 1/2 N 24

Legal Description of Property see attached

A tract of land in the Southwest quarter of the Northwest quarter and the Northwest quarter of the Southwest quarter of Section 22, Township 11 South, Range 64 West of the 6th P.M. described as follows:  
Commencing to the Northwest corner of said Section 22; thence S 0°31'30" E 1288.35 feet; thence N 89°27'15" E, 646.84 feet; thence S 17°27'16" E, 160 feet; thence S 84°51'16" E, 63.30 feet to a point on the West R.O.W. line of State Highway #217; thence S 19°13' E along said R.O.W., 939.83 feet to the point of beginning of the tract to be described; thence along said R.O.W., S 15°37'30" E, 197.8 feet; to a point of curve; thence along a curve to the right whose chord bears S 8°49'30" E, a chord distance of 440.46 feet, having a radius of 1860 feet and an arc distance of 441.4; thence continuing along said R.O.W S 3°48'30" E, 197.8 feet; thence along said R.O.W., S 0°05' W, 711.1 feet; thence S 87°21'30" W, 1021 feet; thence N 4°57' W 1539.95 feet; thence N 87°21', 1021 feet to the point of beginning.

NUMBER OF DEGREES OF TANK CAPACITY 100 GALLONS ABSORPTION AREA 47 Sq. Ft.

Remarks Site as a 3 bedroom Area looks okay location of perc holes ok sand with clay compacts when wet, but crumbles easily - not too much binder  
Need perc test results - clothes washer waste should go to septic tank + septic system

APPLICATION IS  APPROVED  DENIED  
ENVIRONMENTALIST Julie A. Schneider DATE 8/4 1983

PLOT PLAN WILL INCLUDE THE FOLLOWING

Plot plan may be drawn on the back of this sheet or on a separate sheet.

- Streams, Lakes, Ponds, Irrigation Ditches and other Water Courses
- North Direction
- Location of Property Line
- Buildings
- Wells
- Location of Proposed Septic System
- Location of percolation test
- Geographical features
- Other Information as required

149' of 3' trench  
224' of 2' trench  
Trenches to be 100' from well  
Tank to be 50' from well

Full bath + kitchen old system  
EHS - 6/9/76 - SEWAGE

Dry well for washer on N of p 41 E

groundwater contamination  
well contamination with detergents  
health letter

Existing in yard  
runs to North of N. side of house  
to accommodate Master bathroom + sink + commode in studies

16888. Elbert Rd  
 #4122000002

T-C EXCAVATING, INC.  
 Chester Hamacher  
 6430 Burrows Rd. Tel.: 495-2379  
 Colorado Springs. Colorado 80908

*Julie*

E.

SOIL PERCOLATION DATA SHEET

08-15-83

Date: July 26, 1983

Client: Edd Witten Address: \_\_\_\_\_  
 City: Peyton State: Colorado Zip Code: \_\_\_\_\_ Tele.: \_\_\_\_\_  
 County: El Paso Location of Test: 16888 Elbert Hwy The Edlo Ranch

No. Acres: 640 Water Supply: well

PERCOLATION RATE MEASUREMENT RESULTS

Drilled and prepared July 26, 1983 Reading taken July 27, 1983

	Hole Depth	DEPTH TO WATER				Last Drop	Min. per Inch
		Time: 3:15	Time: 3:45	Time: 4:15	Time: 4:45		
#1	32"	20 3/8	26 3/16 - 20 1/4	26 - 20 1/16	25 3/4	5 11/16	5.27
#2	32"	19 15/16	24 - 20 1/8	24 3/16 - 20	24	4	7.5
#3	32"	21 3/4	24 2/16 - 21 5/8	24 5/16 - 21 7/16	24:1/8'	2 11/16	11.16
						Avg.	8

PROFILE

#4	Depth	Soil Description	Ground Water:	Bedrock:	Grade of Site:
	0 - 4"	top soil	none	none	
	4" - 3'	sand with trace of clay			approx 2% to N
	3' - 8'	sandy clay			

N  
↑

REMARKS:

*Approved - Keep field 100' from well*  
*J. Hamacher*

