

	PROPERTY LINE
	EX. GAS LINE
	EX. SANITARY SEWER LINE
	EX. ELECTRIC LINE
	EX. WATER LINE
	EX. STORM SEWER
	PROPOSED MAJOR CONTOUR
	PROPOSED MINOR CONTOUR
	EXISTING MAJOR CONTOUR
	EXISTING MINOR CONTOUR
	PROPOSED LANDSCAPING
	EXISTING SIDEWALK
	FINISHED GRADE
	FLOWLINE
	MATCH EXISTING

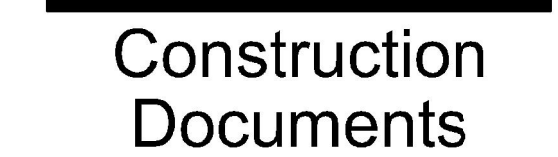

© Copyright 2022 The LKA Partners, Inc. This document and the information contained herein may not be reproduced or excerpted from without the express written permission of The LKA Partners, Inc. Unauthorized copying, disclosure or construction use are prohibited by copyright law.

445 Jersey Lane, Colorado Springs, CO 80911  
Widefield School District 3  
1820 Main Street  
Colorado Springs, CO. 80911



Drawn:	JAR
Checked:	EJG
Issued:	6 APRIL, 2022
Revised:	DECEMBER 13, 2022
CCD 048	January 25, 2023

C8.0

Project No.: PPR-22-009 21-003  
The LKA Partners Incorporated

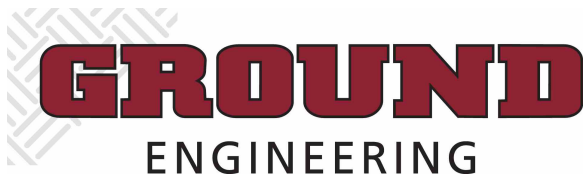

Client:

Dave Gish  
Widefield School District 3  
1820 Main Street  
Colorado Springs, CO 80911

## Webster Elementary School Addition & Alterations

Report Date: Apr 14, 2023

Work Order No.: 22-8500.Concrete.0052; ver: 1

Work Order Date: Apr 12, 2023

Reviewed by: Josiah Johnson

### Concrete

Concrete Contractor: Peak

Performed by: Reid Blackburn

Placement Method: Tailgated

Finish Method: Vibrated- Internally|Trowel Finished|Hand Finished

Total Quantity Placed: 8 yd<sup>3</sup>

Weather: Calm|Clear

Placement Location: West end of Trickle Channel

Comments: Steve Buellesbach observed and approved all test results and mix used

### On-site Notifications, Specification, and Mix Information

On-Site Notification(s)	Item / Structure Type	Test	Specified	Mix Design
Steve Buellesbach with Nunn Construction	General Concrete	Air Content (%)	-	-
		Slump (in)	-	-
	Mix Placed Holcim T3459211	Unit Weight (pcf)	-	-
		Comp. Strength (psi)	-	-

### Sampling (ASTM C172 / AASHTO R60 / CDOT CP61)

Sample No.	Location	Sampled From	Quantity (yd <sup>3</sup> )	Truck No.	Ticket No.	Batch Time	Test Time	Air Temp. (°F)	Water Added (gal)
51	See attached for test location 1	Point of Delivery	7.25	21	86505293	8:58 AM	9:38 AM	70	0

### Field Tests (ASTM C138, C143, C231, and C1064 / AASHTO T119, T121, and T152)

Sample No.	Concrete Temp. (°F)	Slump (in)	Air Cont. (%)	Meas. Vol. (ft <sup>3</sup> )	Empty Meas. (lb)	Full Meas. (lb)	Unit Wt. (pcf)	Lab Samples Cast
51	80	5.25	6.3	0.250	7.25	41.73	137.9	Yes

### Compressive Strength (ASTM C31 and C39 / AASHTO T22 and T23)

A set of compressive strength specimens were cast. Test results will be forwarded upon completion.

Results apply only to the specific items and locations referenced and at the time of testing, observations or special inspections. Unless noted otherwise, specimens were received in adequate condition. Compressive strength specimens, if tested, were capped in accordance with ASTM C1231 or ASTM C617, as applicable. This report should not be reproduced, except in full, without the written permission of GROUND Engineering Consultants, Inc.

7393 Dahlia Street, Commerce City, Colorado

www.groundeng.com

303-289-1989

Englewood | Commerce City | Loveland | Granby | Gypsum | Colorado Springs

Page 1 of 2



## Webster Elementary School Addition & Alterations

Report Date: Apr 14, 2023

Work Order No.: 22-8500.Concrete.0052; ver: 1

Work Order Date: Apr 12, 2023

Reviewed by: Josiah Johnson

### Concrete

#### Photos



Concrete being tailgated in form

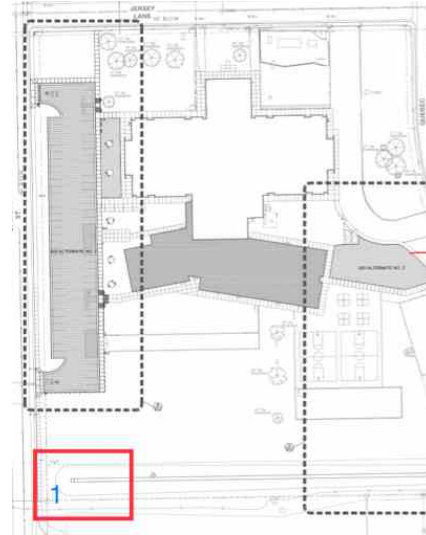

Red box indicates work area and blue numbers indicate test location

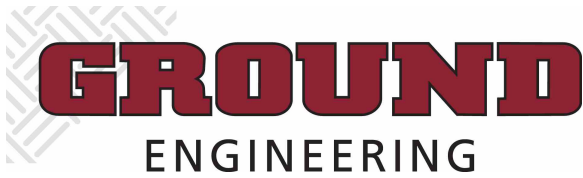

Client: Dave Gish  
Widefield School District 3  
1820 Main Street  
Colorado Springs, CO 80911

## Webster Elementary School Addition & Alterations

Report Date: Apr 13, 2023

Work Order No.: 22-8500.ReinforcingSteel.0028; ver: 1

Work Order Date: Apr 10, 2023

Reviewed by: Josiah Johnson

### Reinforcing Steel

General Contractor: Nunn construction

Performed by: Nick Davidson

Installation Contractor: Gonzalez Concrete

Documents Used: Structural Plans,

Placement Location: Forebays

### Placement Area

	Conforms	Does Not Conform	Not Applicable	Not Observed
Placement Condition:	<input checked="" type="checkbox"/>	<input type="checkbox"/>	<input type="checkbox"/>	<input type="checkbox"/>
Formwork, Falsework, and Void Forms:	<input checked="" type="checkbox"/>	<input type="checkbox"/>	<input type="checkbox"/>	<input type="checkbox"/>
Construction Joints:	<input checked="" type="checkbox"/>	<input type="checkbox"/>	<input type="checkbox"/>	<input type="checkbox"/>

### Reinforcement

Surface Condition:	<input checked="" type="checkbox"/>	<input type="checkbox"/>	<input type="checkbox"/>	<input type="checkbox"/>
Type, Grade, and Size:	<input checked="" type="checkbox"/>	<input type="checkbox"/>	<input type="checkbox"/>	<input type="checkbox"/>
Profile and Quantity:	<input checked="" type="checkbox"/>	<input type="checkbox"/>	<input type="checkbox"/>	<input type="checkbox"/>
Spacing and Clearances:	<input checked="" type="checkbox"/>	<input type="checkbox"/>	<input type="checkbox"/>	<input type="checkbox"/>
Bends, Hooks, Spirals, Stirrups, and Ties:	<input checked="" type="checkbox"/>	<input type="checkbox"/>	<input type="checkbox"/>	<input type="checkbox"/>

### Splices

Lap Splices:	<input checked="" type="checkbox"/>	<input type="checkbox"/>	<input type="checkbox"/>	<input type="checkbox"/>
Mechanical Splices:	<input type="checkbox"/>	<input type="checkbox"/>	<input checked="" type="checkbox"/>	<input type="checkbox"/>
Welded Splices:	<input type="checkbox"/>	<input type="checkbox"/>	<input checked="" type="checkbox"/>	<input type="checkbox"/>

### Connections

Dowels:	<input type="checkbox"/>	<input type="checkbox"/>	<input checked="" type="checkbox"/>	<input type="checkbox"/>
Embedded Items and Anchor Bolts:	<input checked="" type="checkbox"/>	<input type="checkbox"/>	<input type="checkbox"/>	<input type="checkbox"/>

### On-Site Notifications

Name	Company
Steve Buellesbach	Nunn Construction

Results apply only to the specific items and locations referenced and at the time of testing, observations or special inspections. This report should not be reproduced, except in full, without the written permission of GROUND Engineering Consultants, Inc.

41 Inverness Drive East, Englewood, Colorado

www.groundeng.com

303-289-1989

Englewood | Commerce City | Loveland | Granby | Gypsum | Colorado Springs

Page 1 of 2



## Webster Elementary School Addition & Alterations

Report Date: Apr 13, 2023

Work Order No.: 22-8500.ReinforcingSteel.0028; ver: 1

Work Order Date: Apr 10, 2023

Reviewed by: Josiah Johnson

### Reinforcing Steel

#### Photos



Fore bay

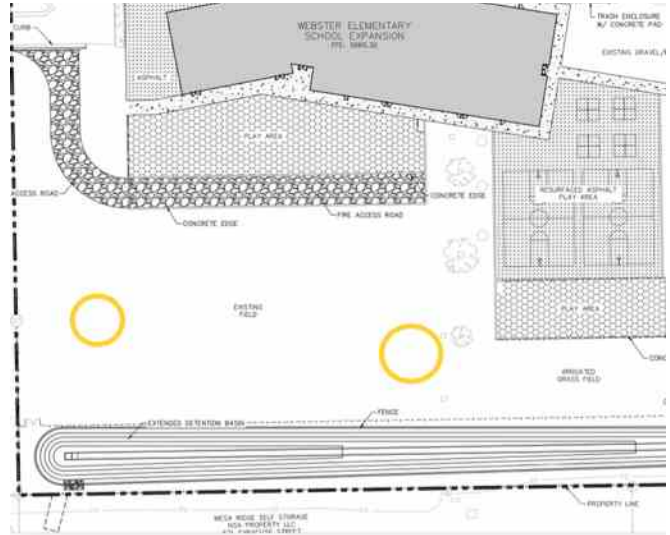

Yellow circles represent estimated location for forebays

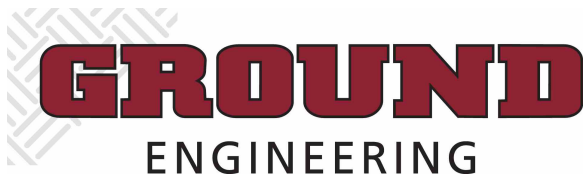

Client:

Dave Gish  
Widefield School District 3  
1820 Main Street  
Colorado Springs, CO 80911

## Webster Elementary School Addition & Alterations

Report Date: Apr 13, 2023

Work Order No.: 22-8500.Concrete.0051; ver: 1

Work Order Date: Apr 10, 2023

Reviewed by: Josiah Johnson

### Concrete

Concrete Contractor: Gonzalez Concrete

Performed by: Nick Davidson

Placement Method: Tailgated

Finish Method: Vibrated- Internally|Hand Finished|Trowel  
FinishedTotal Quantity Placed: 7.50 yd<sup>3</sup>

Weather: Sunny

Placement Location: Forebays and storm detention channel

Comments: No mix design provided. Air and slump specifications provided by Steve Buellesbach with Nunn Construction. Air 5-8%, Slump 2.5-5".

### On-site Notifications, Specification, and Mix Information

On-Site Notification(s)	Item / Structure Type	Test	Specified	Mix Design
Steve Buellesbach with Nunn Construction	General Concrete	Air Content (%)	-	-
		Slump (in)	-	-
	Mix Placed	Unit Weight (pcf)	-	-
	Transit Mix T34592110	Comp. Strength (psi)	-	-

### Sampling (ASTM C172 / AASHTO R60 / CDOT CP61)

Sample No.	Location	Sampled From	Quantity (yd <sup>3</sup> )	Truck No.	Ticket No.	Batch Time	Test Time	Air Temp. (°F)	Water Added (gal)
50	See attachment for test location 1	Point of Placement	7.50	33	86505162	8:40 AM	9:39 AM	50	0

### Field Tests (ASTM C138, C143, C231, and C1064 / AASHTO T119, T121, and T152)

Sample No.	Concrete Temp. (°F)	Slump (in)	Air Cont. (%)	Meas. Vol. (ft <sup>3</sup> )	Empty Meas. (lb)	Full Meas. (lb)	Unit Wt. (pcf)	Lab Samples Cast
50	80	3.5	6.4	.250	7.76	42.56	139.2	Yes

### Compressive Strength (ASTM C31 and C39 / AASHTO T22 and T23)

A set of compressive strength specimens were cast. Test results will be forwarded upon completion.

Results apply only to the specific items and locations referenced and at the time of testing, observations or special inspections. Unless noted otherwise, specimens were received in adequate condition. Compressive strength specimens, if tested, were capped in accordance with ASTM C1231 or ASTM C617, as applicable. This report should not be reproduced, except in full, without the written permission of GROUND Engineering Consultants, Inc.

**7393 Dahlia Street, Commerce City, Colorado****www.groundeng.com****303-289-1989**

Englewood | Commerce City | Loveland | Granby | Gypsum | Colorado Springs

Page 1 of 2

## Webster Elementary School Addition & Alterations

Report Date: Apr 13, 2023

Work Order No.: 22-8500.Concrete.0051; ver: 1

Work Order Date: Apr 10, 2023

Reviewed by: Josiah Johnson

### Concrete

#### Photos



Forebay and storm detention channel

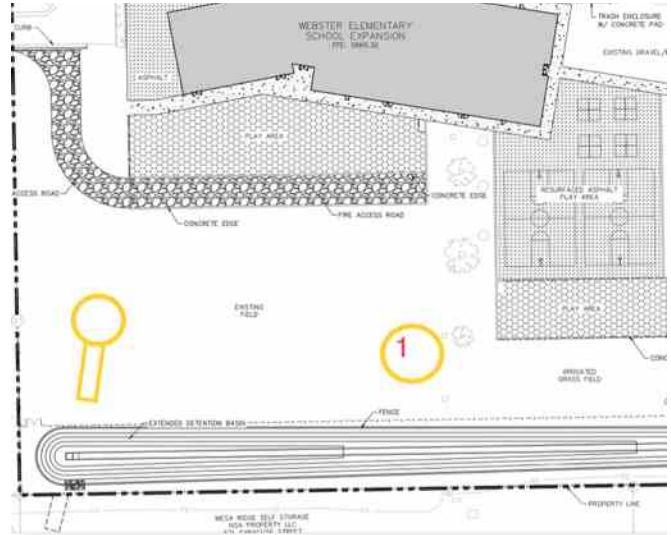

Yellow represents forebay and storm detention channel and red number represents test location



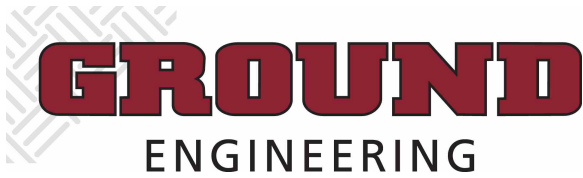

Client: Dave Gish  
Widefield School District 3  
1820 Main Street  
Colorado Springs, CO 80911

## Webster Elementary School Addition & Alterations

Report Date: Apr 13, 2023

Work Order No.: 22-8500.ReinforcingSteel.0028; ver: 1

Work Order Date: Apr 10, 2023

Reviewed by: Josiah Johnson

### Reinforcing Steel

General Contractor: Nunn construction

Performed by: Nick Davidson

Installation Contractor: Gonzalez Concrete

Documents Used: Structural Plans,

Placement Location: Forebays

### Placement Area

	Conforms	Does Not Conform	Not Applicable	Not Observed
Placement Condition:	<input checked="" type="checkbox"/>	<input type="checkbox"/>	<input type="checkbox"/>	<input type="checkbox"/>
Formwork, Falsework, and Void Forms:	<input checked="" type="checkbox"/>	<input type="checkbox"/>	<input type="checkbox"/>	<input type="checkbox"/>
Construction Joints:	<input checked="" type="checkbox"/>	<input type="checkbox"/>	<input type="checkbox"/>	<input type="checkbox"/>

### Reinforcement

Surface Condition:	<input checked="" type="checkbox"/>	<input type="checkbox"/>	<input type="checkbox"/>	<input type="checkbox"/>
Type, Grade, and Size:	<input checked="" type="checkbox"/>	<input type="checkbox"/>	<input type="checkbox"/>	<input type="checkbox"/>
Profile and Quantity:	<input checked="" type="checkbox"/>	<input type="checkbox"/>	<input type="checkbox"/>	<input type="checkbox"/>
Spacing and Clearances:	<input checked="" type="checkbox"/>	<input type="checkbox"/>	<input type="checkbox"/>	<input type="checkbox"/>
Bends, Hooks, Spirals, Stirrups, and Ties:	<input checked="" type="checkbox"/>	<input type="checkbox"/>	<input type="checkbox"/>	<input type="checkbox"/>

### Splices

Lap Splices:	<input checked="" type="checkbox"/>	<input type="checkbox"/>	<input type="checkbox"/>	<input type="checkbox"/>
Mechanical Splices:	<input type="checkbox"/>	<input type="checkbox"/>	<input checked="" type="checkbox"/>	<input type="checkbox"/>
Welded Splices:	<input type="checkbox"/>	<input type="checkbox"/>	<input checked="" type="checkbox"/>	<input type="checkbox"/>

### Connections

Dowels:	<input type="checkbox"/>	<input type="checkbox"/>	<input checked="" type="checkbox"/>	<input type="checkbox"/>
Embedded Items and Anchor Bolts:	<input checked="" type="checkbox"/>	<input type="checkbox"/>	<input type="checkbox"/>	<input type="checkbox"/>

### On-Site Notifications

Name	Company
Steve Buellesbach	Nunn Construction

Results apply only to the specific items and locations referenced and at the time of testing, observations or special inspections. This report should not be reproduced, except in full, without the written permission of GROUND Engineering Consultants, Inc.

41 Inverness Drive East, Englewood, Colorado

www.groundeng.com

303-289-1989

Englewood | Commerce City | Loveland | Granby | Gypsum | Colorado Springs

Page 1 of 2

## Webster Elementary School Addition & Alterations

Report Date: Apr 13, 2023

Work Order No.: 22-8500.ReinforcingSteel.0028; ver: 1

Work Order Date: Apr 10, 2023

Reviewed by: Josiah Johnson

### Reinforcing Steel

#### Photos



Fore bay

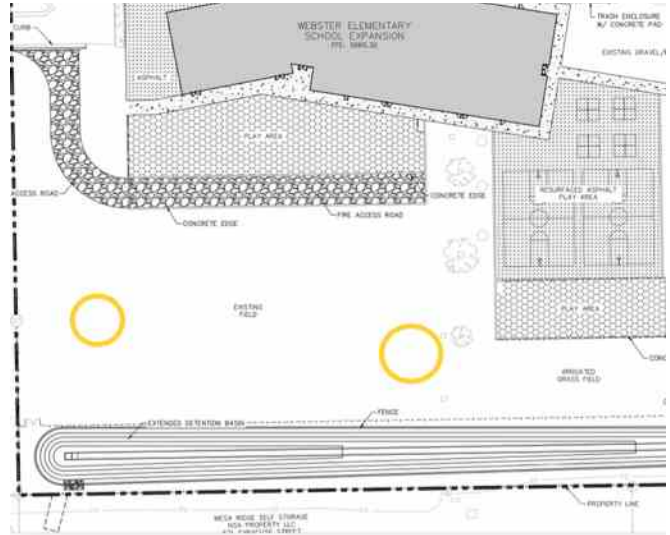

Yellow circles represent estimated location for forebays

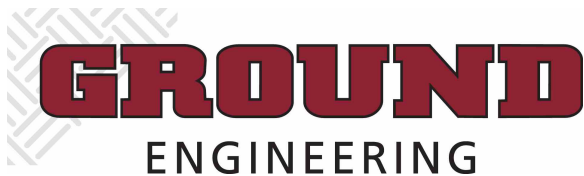

Client:

Dave Gish  
Widefield School District 3  
1820 Main Street  
Colorado Springs, CO 80911

## Webster Elementary School Addition & Alterations

Report Date: Apr 13, 2023

Work Order No.: 22-8500.Concrete.0051; ver: 1

Work Order Date: Apr 10, 2023

Reviewed by: Josiah Johnson

### Concrete

Concrete Contractor: Gonzalez Concrete

Performed by: Nick Davidson

Placement Method: Tailgated

Finish Method: Vibrated- Internally|Hand Finished|Trowel  
FinishedTotal Quantity Placed: 7.50 yd<sup>3</sup>

Weather: Sunny

Placement Location: Forebays and storm detention channel

Comments: No mix design provided. Air and slump specifications provided by Steve Buellesbach with Nunn Construction. Air 5-8%, Slump 2.5-5".

### On-site Notifications, Specification, and Mix Information

On-Site Notification(s)	Item / Structure Type	Test	Specified	Mix Design
Steve Buellesbach with Nunn Construction	General Concrete	Air Content (%)	-	-
		Slump (in)	-	-
	Mix Placed	Unit Weight (pcf)	-	-
	Transit Mix T34592110	Comp. Strength (psi)	-	-

### Sampling (ASTM C172 / AASHTO R60 / CDOT CP61)

Sample No.	Location	Sampled From	Quantity (yd <sup>3</sup> )	Truck No.	Ticket No.	Batch Time	Test Time	Air Temp. (°F)	Water Added (gal)
50	See attachment for test location 1	Point of Placement	7.50	33	86505162	8:40 AM	9:39 AM	50	0

### Field Tests (ASTM C138, C143, C231, and C1064 / AASHTO T119, T121, and T152)

Sample No.	Concrete Temp. (°F)	Slump (in)	Air Cont. (%)	Meas. Vol. (ft <sup>3</sup> )	Empty Meas. (lb)	Full Meas. (lb)	Unit Wt. (pcf)	Lab Samples Cast
50	80	3.5	6.4	.250	7.76	42.56	139.2	Yes

### Compressive Strength (ASTM C31 and C39 / AASHTO T22 and T23)

A set of compressive strength specimens were cast. Test results will be forwarded upon completion.

Results apply only to the specific items and locations referenced and at the time of testing, observations or special inspections. Unless noted otherwise, specimens were received in adequate condition. Compressive strength specimens, if tested, were capped in accordance with ASTM C1231 or ASTM C617, as applicable. This report should not be reproduced, except in full, without the written permission of GROUND Engineering Consultants, Inc.

7393 Dahlia Street, Commerce City, Colorado

www.groundeng.com

303-289-1989

Englewood | Commerce City | Loveland | Granby | Gypsum | Colorado Springs

Page 1 of 2



## Webster Elementary School Addition & Alterations

Report Date: Apr 13, 2023

Work Order No.: 22-8500.Concrete.0051; ver: 1

Work Order Date: Apr 10, 2023

Reviewed by: Josiah Johnson

### Concrete

#### Photos



Forebay and storm detention channel

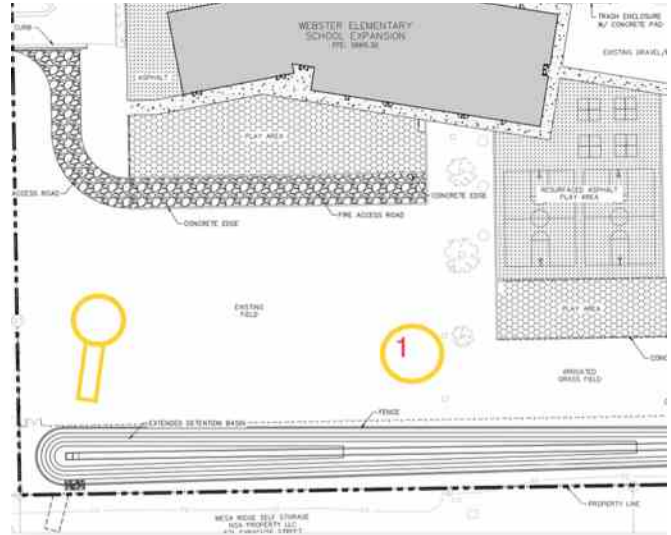

Yellow represents forebay and storm detention channel and red number represents test location



Weyerhaeuser  
EDGE GOLD





























































