

VENETUCCI FARMS

A PORTION OF THE SW $\frac{1}{4}$ OF THE SW $\frac{1}{4}$ AND THE SE $\frac{1}{4}$ OF SECTION 11 AND A PORTION OF THE NW $\frac{1}{4}$ OF SECTION 14, EL PASO COUNTY, COLORADO
SPECIAL USE PERMIT - BUSINESS EVENT CENTER



N.E.S. Inc.
619 N. Cascade Avenue, Suite 200
Colorado Springs, CO 80903
Tel. 719.471.0073
Fax 719.471.0267
www.nescolorado.com
© 2012. All Rights Reserved.

EXHIBIT A

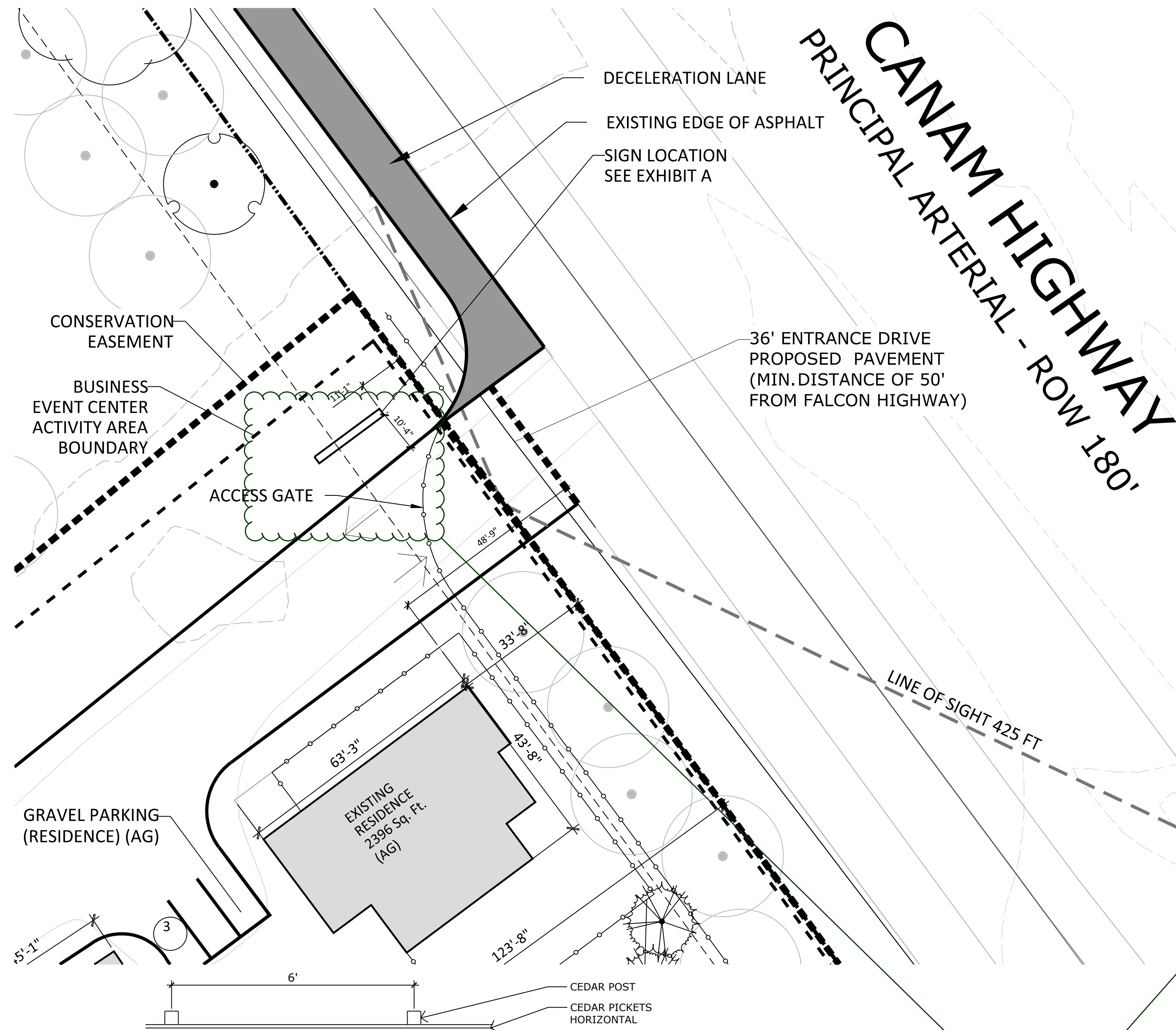
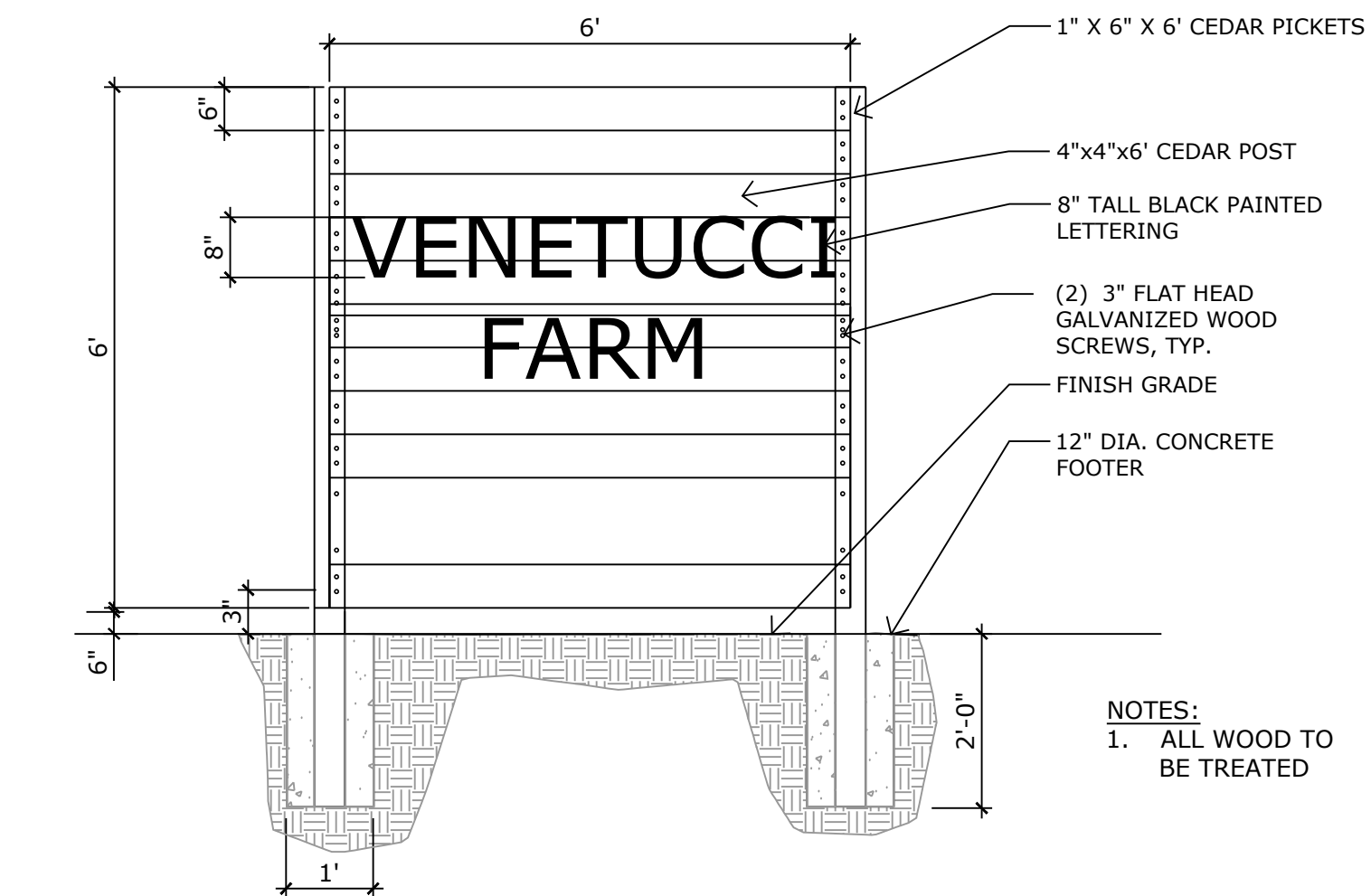
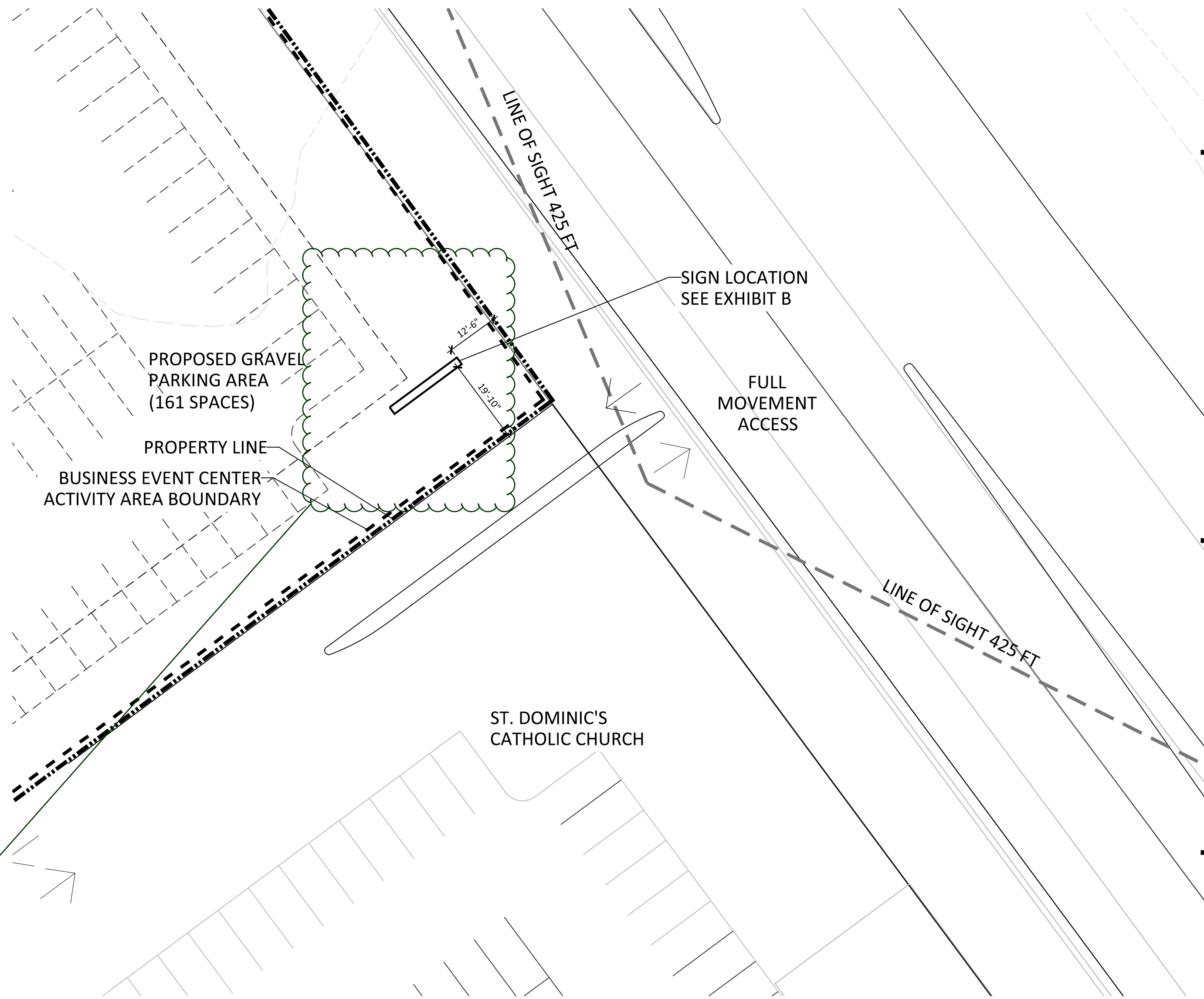
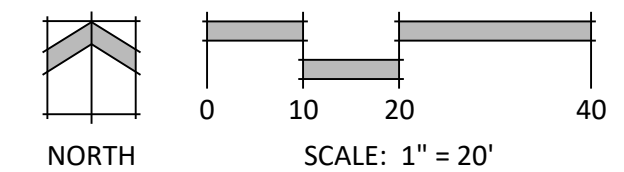

EXHIBIT B



Sign must comply with setback standards for the district. Please revise



VENETUCCI FARMS

Business Event Center
5202 S Highway 85-87

DATE: 09.27.21
PROJECT MGR: A. BARLOW
PREPARED BY: J. SHAGIN

SIGN PLAN

4

4 OF 9

EA 212