

24355 Palomino Pl, Calhan, CO 80808  
Lot 7 Blk 2 Equestrian Country  
Sch #2207001005

Owner:  
Harry Thomas  
24355 Palomino Pl  
Calhan, CO 80808



Property is zoned A-5 and its use is a residential single family home.

**ADD20618**

APPROVED  
BESQCP  
09/01/2020 3:23:40 PM  
Jdyounger  
EPC Planning & Community  
Development Department

APPROVED  
Plan Review  
09/01/2020 3:23:46 PM  
Jdyounger  
EPC Planning & Community  
Development Department

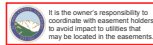

ANY APPROVAL GIVEN BY  
IS PRIMO COUNTY  
DOES NOT GUARANTEE THE NEED  
TO COMPLY WITH APPLICABLE  
FEDERAL, STATE OR LOCAL  
LAWS AND/OR REGULATION.  
Planning & Community Development Department  
approval is contingent upon compliance with all  
applicable rules on the recording plat.  
An access permit must be granted by the  
Planning & Community Development Department  
prior to the establishment of any driveway onto a  
County road.  
Division of blockage of any drainage way  
is not permitted without approval of the  
Planning & Community Development Department

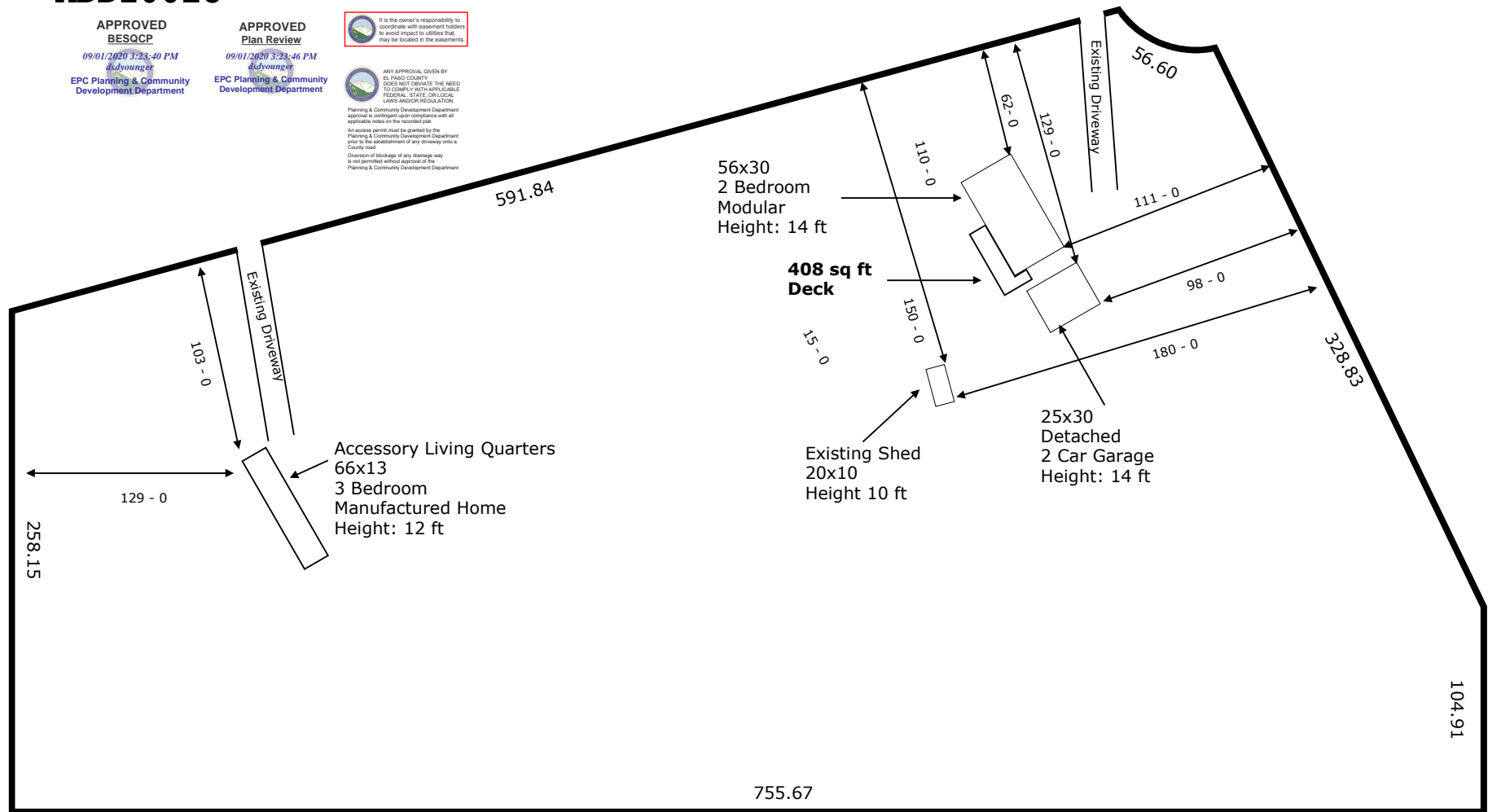

# RESIDENTIAL



2017 PPRBC

Parcel: 2207001005

Address: 24355 PALOMINO PL, CALHAN

Plan Track #: 133541

Received: 31-Aug-2020 (JANE)

## Description:

**DECK - NEW**

Contractor: HOMEOWNER

Type of Unit:

## Required PPRBD Departments (2)

Floodplain

(N/A) RBD GIS

Construction  
Released for Permit

09/01/2020 2:29:07 PM



CONSTRUCTION

## Required Outside Departments (1)

County Zoning  
**APPROVED**  
Plan Review

09/01/2020 3:24:15 PM

EPC Planning & Community  
Development Department

Release of this plan does not preclude compliance with all applicable codes, ordinances and other pertinent regulations. This plan set must be present on the job site for every inspection.