

El Paso County Parcel Information

Parcel Number: 5408001018

Parcel Address: 7185 E HIGHWAY 24

Parcel Owner: ARACHNID HOLDINGS LLC

File Name: AL-08-003

Zone Map No.: 542.08

Owner Mailing Address: PO BOX 75065, COLORADO SPRINGS, CO 80970

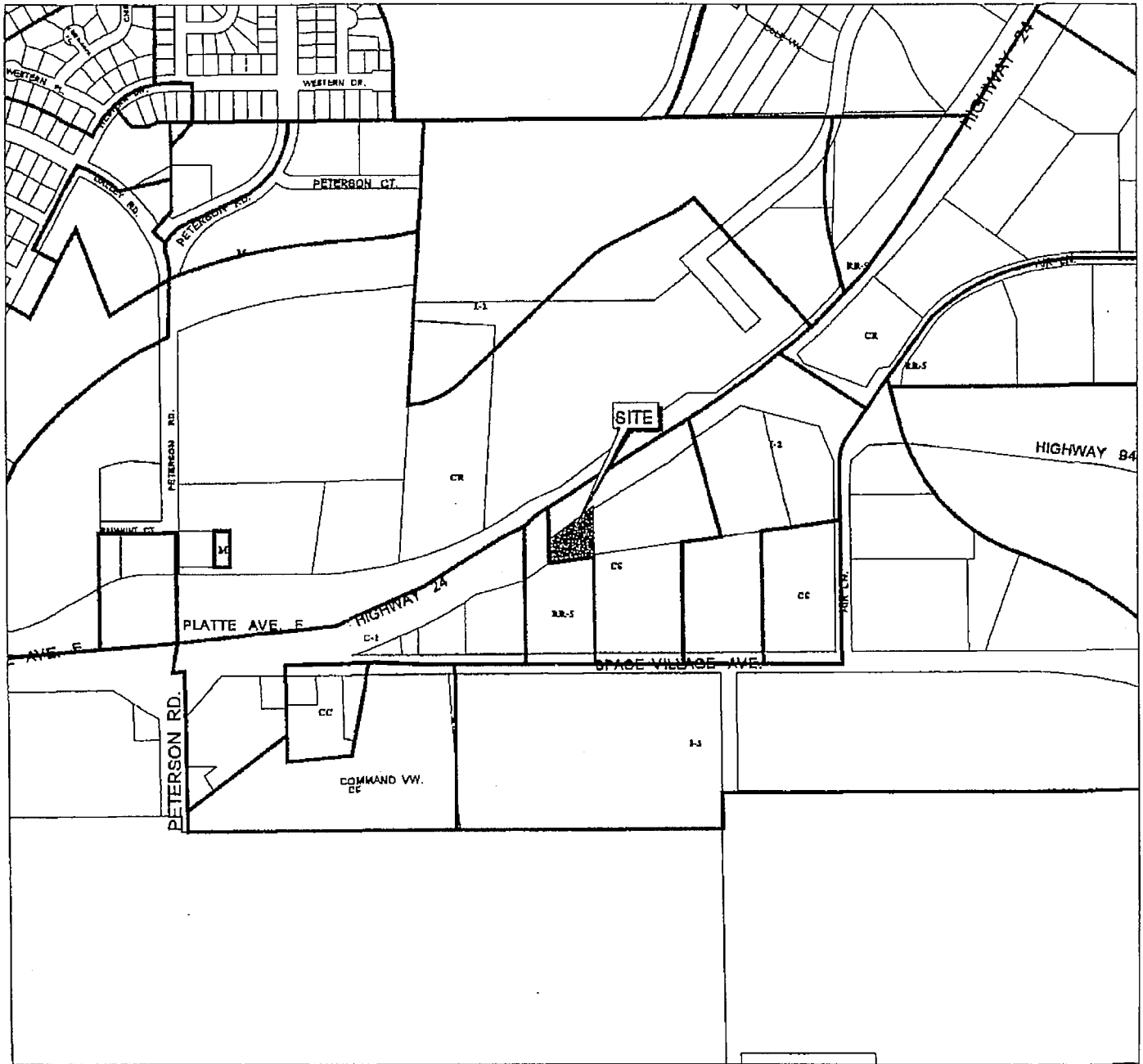

Please report any discrepancies to:
El Paso County GIS/Mapping
325 S. Cascade
Colorado Springs, CO 80903
(719)520-6523

COPYRIGHT 2003 by the Board of County Commissioners, El Paso County, Colorado.
All rights reserved. No part of this document or data contained herein may be reproduced, used to prepare derivative products, or distributed without the specific written approval of the Board of County Commissioners, El Paso County, Colorado. This document was prepared from the best data available at the time of plotting and is for internal use only. El Paso County, Colorado, makes no claim as to the completeness or accuracy of the data contained herein.

November 6, 2008



AL-08-005

Project Name: Lamar Advertising Billboard Expansion - Special Use (AL-08-003)

Applicant:

Consultant:

Arschid Holdings, LLC
P. O. Box 75065
Colorado Springs, CO 80970

Lamar Advertising - Brian O'Leary
P. O. Box 6010
Colorado Springs, CO 80934
719-473-4747

James Whidden

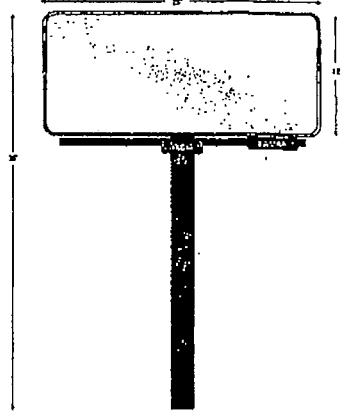

N

↑ Scale 1" = 150'

Leased area: 14' x 25'

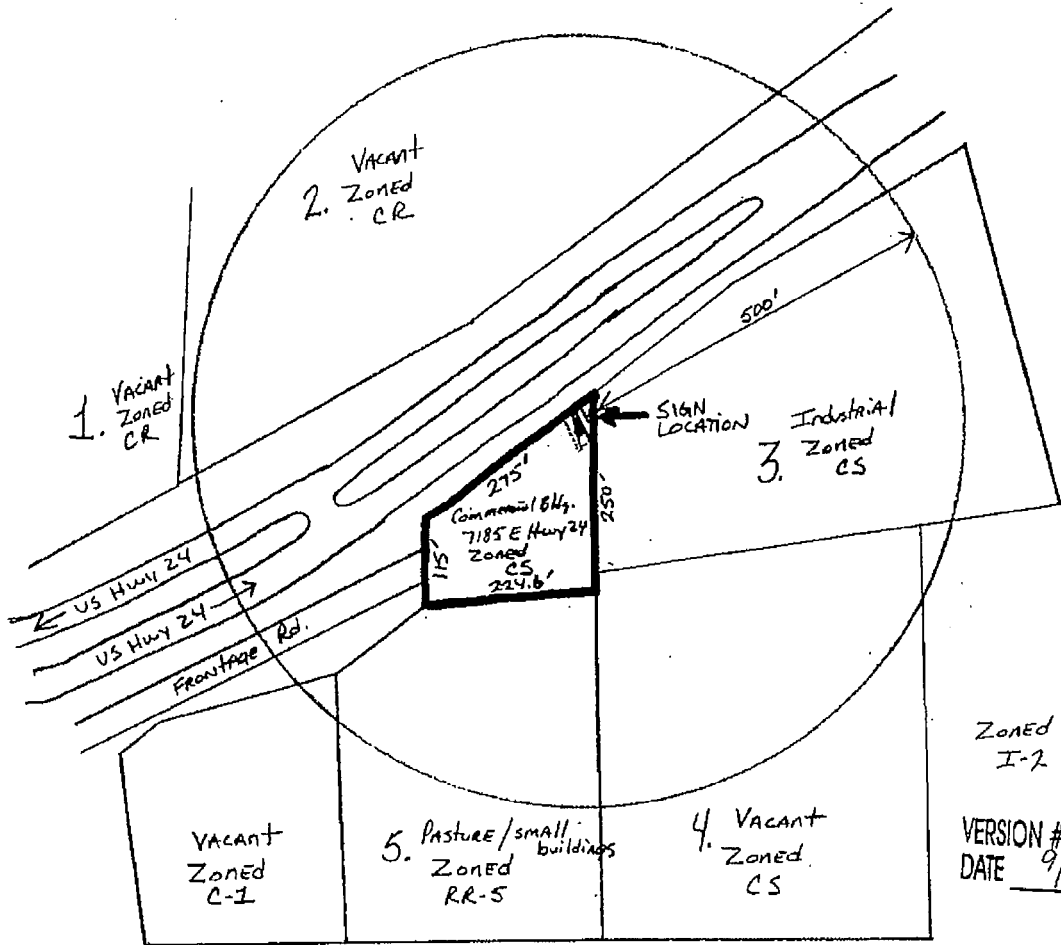

ZONED I-2

VERSION # 2
DATE 9/2/09

Adjacent Property Owners

1. 54850-80-038
Love In Action
213 N. Wabash Ave., Suite 301
Colorado Springs, CO 80903-3476
2. 54086-08-451
Love In Action
213 N. Wabash Ave., Suite 301
Colorado Springs, CO 80903-3476
3. 54880-81-826
Lara-Laja
5748 Edgar Court
Ft. Collins, CO 80511-8103
4. 54088-01-816
Space Village Properties, LLC
12639 Mount Shasta Drive
Kremet, CO 80164-8821
5. 54880-81-825
Lary A. Williams
Jonas L. Leuchs
Jodie L. Williams
3775 S. Duane Rd.
Colorado Springs, CO 80938-9517

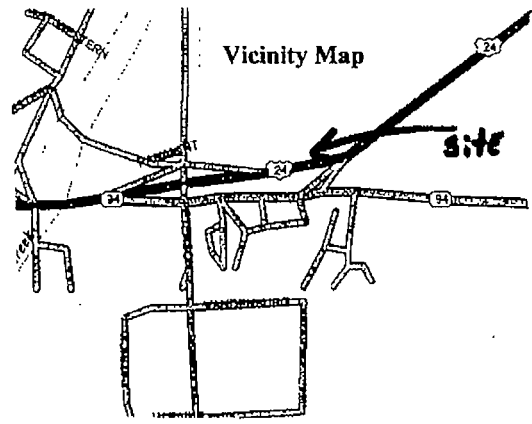

7185 E. Highway 24

Tax Schedule No. 54098-01-018

Legal Description:

TRACT IN RE45W4 OF SEC8-14-45 AS POLS, COM AT FT ON S LN OF SW4 THAT IS 265.4 FT E FROM SW COR THEREOF, TH N 8-13' E TO R/W LN OF US HWY 24 FOR 6'-0", S 8-13' W 250 FT, S 83-13' W 224.6 FT, N 8-13' E 115 FT TO R/W LN US HWY 24, TH N 54-01' E ON SD R/W LN 175 FT TO POB 14

CL 398 sq. ft.