

PROPOSED 16x24 SHED = 384 sq ft

OWNER: KRIS AONA

ADDRESS: 8460 SHOULDERS RD, PEYTON, CO., 80331

LEGAL DESCRIPTION: LOT 54 WOODMEN HILLS FIL No 4

ZONING: R PLAT: R09838

EXISTING HOUSE: 1,969 sq ft

ATTACHED GARAGE: 400 sq ft

EXISTING SHED: 10x12 = 120 sq ft

LOT SIZE: 1.25 ACRES = 54,450 sq ft

PROPOSED 16x24 SHED = 384 sq ft HEIGHT = 11'3"

PROPOSED LOT COVERAGE = .05

Work Shop Only, not Car storage

FILE - ADD24212
ZONING- RR-0.5
PLAT - 9838
APPROVED 384 SQ FT
DETACHED ACCESSORY
STRUCTURE

APPROVED
Plan Review
04/30/2024 3:34:15 PM
dsdmaes
EPC Planning & Community
Development Department

ANY APPROVAL GIVEN BY
EL PASO COUNTY
DOES NOT OVIATE THE NEED
TO COMPLY WITH APPLICABLE
FEDERAL, STATE OR LOCAL
LAWS AND/OR REGULATION
Planning & Community Development Department
approval is contingent upon compliance with all
applicable notes on the recorded plat.
An access permit must be granted by the
Planning & Community Development Department
prior to the establishment of any driveway onto a
County road.
Division of blockage of any drainage way
is not permitted without approval of the
Planning & Community Development Department

Not Required
BESQCP
04/30/2024 3:34:32 PM
dsdmaes
EPC Planning & Community
Development Department

It is the owner's responsibility to
coordinate with easement holders
to avoid impact to utilities that
may be located in the easements.

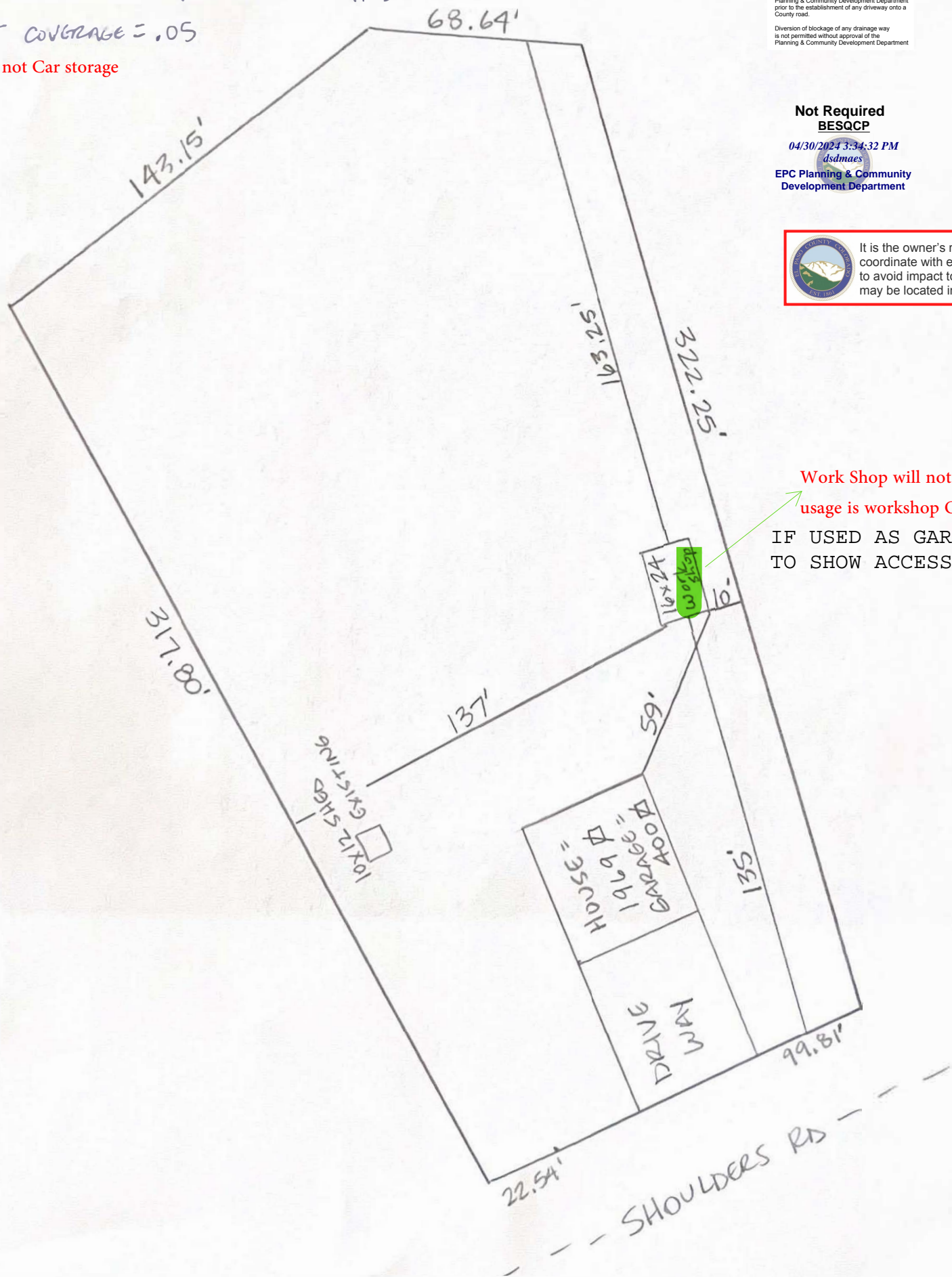

Work Shop will not provide Car Storage
usage is workshop Only.

IF USED AS GARAGE. WILL NEED
TO SHOW ACCESS.

RESIDENTIAL



2023 PPRBC
IECC: N/A

Address: 8460 SHOULDERS RD, PEYTON

Parcel: 5301004011

Plan Track #: 188948 

Received: 24-Apr-2024 (BRIANNAM)

Description:

DETACHED ACCESSORY STRUCTURE

Contractor: TUFF SHED INC

Type of Unit:

Required PPRBD Departments (2)

Floodplain

(N/A) RBD GIS

Construction

Released for Permit
04/29/2024 1:00:00 PM



CONSTRUCTION

Required Outside Departments (1)

County Zoning

APPROVED
Plan Review

04/30/2024 3:35:13 PM
dsdmaes

EPC Planning & Community
Development Department

Release of this plan does not preclude compliance with all applicable codes, ordinances and other pertinent regulations. This plan set must be present on the job site for every inspection.