

EL PASO COUNTY LANDSCAPE CODE COMPLIANCE

ROADWAY: 10' SETBACK REQUIRED/PROVIDED
 EASTONVILLE ROAD: PROPOSE 1 TREE/30 LF, 13 REQUIRED/13 PROVIDED (LS)
 FALCON MARKET PLACE: PROPOSE 1 TREE/30 LF, 60 REQUIRED/60 PROVIDED (LS)

WOODMEN BLVD. (EXPRESSWAY) - FRONTAGE-1,053 LF/20 = TREES REQUIRED/PROVIDED: 53/53 (LS)

MERIDIAN ROAD (EXPRESSWAY) - FRONTAGE - 1,029 LF/20 = TREES REQUIRED/PROVIDED: 51/51 (LS)

WEST BUFFER - 803 LF/15 = TREES REQUIRED/PROVIDED ALONG FENCE LINE: 53/33
 WAIVER OF 20 TREES IS REQUESTED ALONG WEST BOUNDARY DUE TO GRADING AT NORTHWEST END (LB)

BUFFER AT NORTH BOUNDARY: 250' WIDE SUB-REGIONAL DETENTION POND SHOWN

ALL TREES USED ARE APPROVED DROUGHT RESISTANT FROM APPENDIX 'A': SKYLINE HONEYLOCUST, PONDEROSA PINE, COCKSPUR HAWTHORN, SPRING SNOW CRAB APPLE AND CRIMSON SPIRE OAK.

SHRUBS, ORNAMENTAL GRASS, AND PERENNIALS ARE TO BE DETERMINED

ADDITIONAL LANDSCAPE REQUIREMENTS NOT LIMITED TO PARKING, INTERNAL WILL BE PROVIDED AT THE TIME OF INDIVIDUAL SITE DEVELOPMENT PLANS.

LANDSCAPE GUIDELINES

ALL PLANT MATERIAL SHALL BE SELECTED FROM FALCON MARKETPLACE PLANT PALETTE. PLANT QUANTITIES SHALL BE PER EL PASO COUNTY CODE REQUIREMENTS

ROCK MULCHES SHALL BE: 3/4", 1.5" OR 2-4" DIAMETER ARKANSAS TAN AND/OR DENVER GRANITE. NO WOOD MULCH ALLOWED

ACCENT BOULDERS SHALL BE: ARKANSAS TAN AND/OR BROADMOOR, TWO SIZES-18" X 24", 24" X 36" DIAMETER, INSTALLED 1/3 BELOW GRADE

MOTOR VEHICLE PARKING SCREENING SHALL BE PER EL PASO COUNTY CODE

LANDSCAPE BUFFERS SHALL BE PER EL PASO COUNTY CODE

ALL OTHER GUIDELINES NOT SPECIFICALLY NOTED HERE SHALL BE PER EL PASO COUNTY CODE.

IRRIGATION SYSTEM SHALL BE PROVIDED FOR PLANT ESTABLISHMENT AND MAINTAIN PLANT HEALTH

PLANT PALETTE

Symbol	Abbr.	Botanical Name	Common Name
EVERGREEN TREES:			
	PE	Pinus edulis	Pinyon Pine
	PN	Pinus nigra	Austrian Pine
	PP	Pinus ponderosa	Ponderosa Pine
	PS	Pinus sylvestris	Scotch Pine
DECIDUOUS TREES:			
	ACT	Acer tataricum	Tatarian Maple
	AL	Acer platanoides	Norway Maple (European)
	GT	Gleditsia triacanthos	Skyline Honeylocust
	MIM	Malus 'Indian Magic'	Indian Summer Crab
	MP	Malus 'Profusion'	Profusion Crabapple
	MPF	Malus 'Prairie Fire'	Prairie Fire Crabapple
	MS	Malus 'Spring Snow'	Spring Snow Crabapple
	PCN	Prunus cerasifolia 'Newport'	Newport Plum
	QB	Quercus bicolor	Swamp White Oak
	TA	Tilia americana 'Boulevard'	Boulevard Linden
EVERGREEN SHRUBS:			
	HJ	Juniperus horizontalis 'Hughes'	Hughes Juniper
	JC	Juniperus scopulorum 'Cologreen'	Cologreen Juniper
	JH	Juniperus horizontalis	Blue Chip Juniper
	JL	Juniperus sabinna	Buffalo Juniper
	JR	Juniperus horizontalis 'Wiltoni'	Blue Rug Juniper
	TJ	Juniperus sabinna tamariocifolia	Tamarix Juniper
DECIDUOUS SHRUBS:			
	AA	Amelanchier alnifolia	Western Serviceberry
	AM	Aronia melanocarpa elata	Black Chokeberry
	BT	Berberis thunbergii 'Atropurpurea'	Redleaf Barberry
	EAC	Euonymus alatus 'Compactus'	Dwarf Burning Bush
	GP	Ligustrum x vasyi	Golden Privet
	HP	Hesperaloe parviflora	Red Yucca
	PB	Prunus besseyi	Western Sand Cherry
	PC	Prunus x cistena	Purple Leaf Plum
	PFG	Potentilla fruticosa 'Gold Finger'	Gold Finger Potentilla
	PFS	Potentilla fruticosa 'Sutter's Gold'	Sutter's Gold
	PFW	Potentilla fruticosa 'McKay's White'	McKay's White
	RT	Rhus typhina	Slaghorn Sumac
	RTT	Rhus trilobata	Three-leaf Sumac
	SF	Spiraea x bumalda 'Froebelii'	Froebel Spirea
	SP	Syringa meyeri patula	Miss Kim Lilac
	SV	Spiraea vanhoutte	Vanhoutte Spirea
	VO	Viburnum opulus 'Compactum'	European Compact Viburnum
	VTS	Viburnum trilobum 'Spring Green'	Spring Green Compact Viburnum
ORNAMENTAL GRASSES:			
	CA	Calamagrostis acutiflora 'Karl Foerster'	Feather Reed Grass
	PE	Schizachyrium scoparium 'Blaze'	Little Bluestem Grass 'Blaze'
PERENNIALS: EL PASO COUNTY APPROVED VARIETIES			

Provide area where these are to be shown. You can use clouds or leaders for a general location. Is this list your master list which future site dev plans will incorporate? If so, please state.

ROADWAY & BUFFER NORTH & WEST LANDSCAPE PLAN

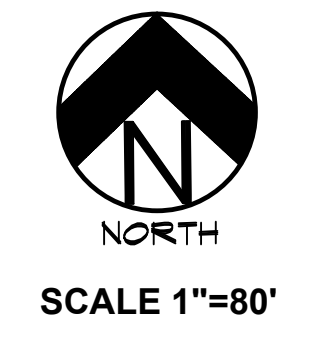

DOCUMENT NOTE

IRRESPECTIVE OF ANY OTHER TERM IN THIS DOCUMENT, LANDSCAPE ARCHITECT SHALL NOT CONTROL, OR BE RESPONSIBLE FOR CONSTRUCTION MEANS, METHODS, TECHNIQUES, SCHEDULES, SEQUENCES OR PROCEDURES, OR FOR CONSTRUCTION SAFETY OR ANY OTHER RELATED PROGRAMS, OR FOR ANY OTHER RELATED PARTIES' ERRORS OR OMISSIONS OR FOR ANOTHER PARTIES FAILURE TO COMPLETE THEIR WORK OR SERVICES IN ACCORDANCE WITH LANDSCAPE ARCHITECT'S DOCUMENTS.

HIGHER GROUND DESIGNS, INC.
 LANDSCAPE ARCHITECTURE, PLANNING & IRRIGATION DESIGN

5350 NORTH ACADEMY BLVD., STE. 207
 COLORADO SPRINGS, CO 80918
 Phone 719-477-1646
 Fax 719-268-1122



FALCON MARKETPLACE
 FILING NO. 1
 FALCON, CO - EL PASO COUNTY, CO

PREPARED FOR:
 DREXEL, BARRELL & CO.

THESE DRAWINGS ARE THE PROPERTY OF HIGHER GROUND DESIGNS, INC. AND SHALL NOT BE USED FOR ANY OTHER PROJECT WITHOUT WRITTEN AUTHORIZATION BY HIGHER GROUND DESIGNS, INC. THESE DRAWINGS ARE FOR APPROVAL ONLY.

FOR APPROVAL ONLY

JOB NUMBER: 688-17

REVISIONS	PER	COMMENTS
7-2-18	PER	COMMENTS
8-3-18	PER	COMMENTS

ORIGINAL DATE: 5-22-17

DRAWN BY: JIM

DESCRIPTION:
 ROADWAY & BUFFER NORTH/WEST LANDSCAPE

SHEET NO.: LP-01

NOT FOR CONSTRUCTION

HOMEOWNERS ASSN

Place 6" wall detail here please. Please leave it on preliminary plan sheets.

7' HT. PRECAST CONCRETE SCREEN WALL. REFER TO SITE PLAN FOR DETAILS.

REFER TO SHEET LP-03

GROUND COVER LEGEND	
SYMBOL	DESCRIPTION
	Arkansas Tan Rock: 1.5" Diameter (with weed barrier)
	Arkansas Tan Cobble: 2-4" Diameter (with weed barrier)
	Non-Irrigated Native Seed

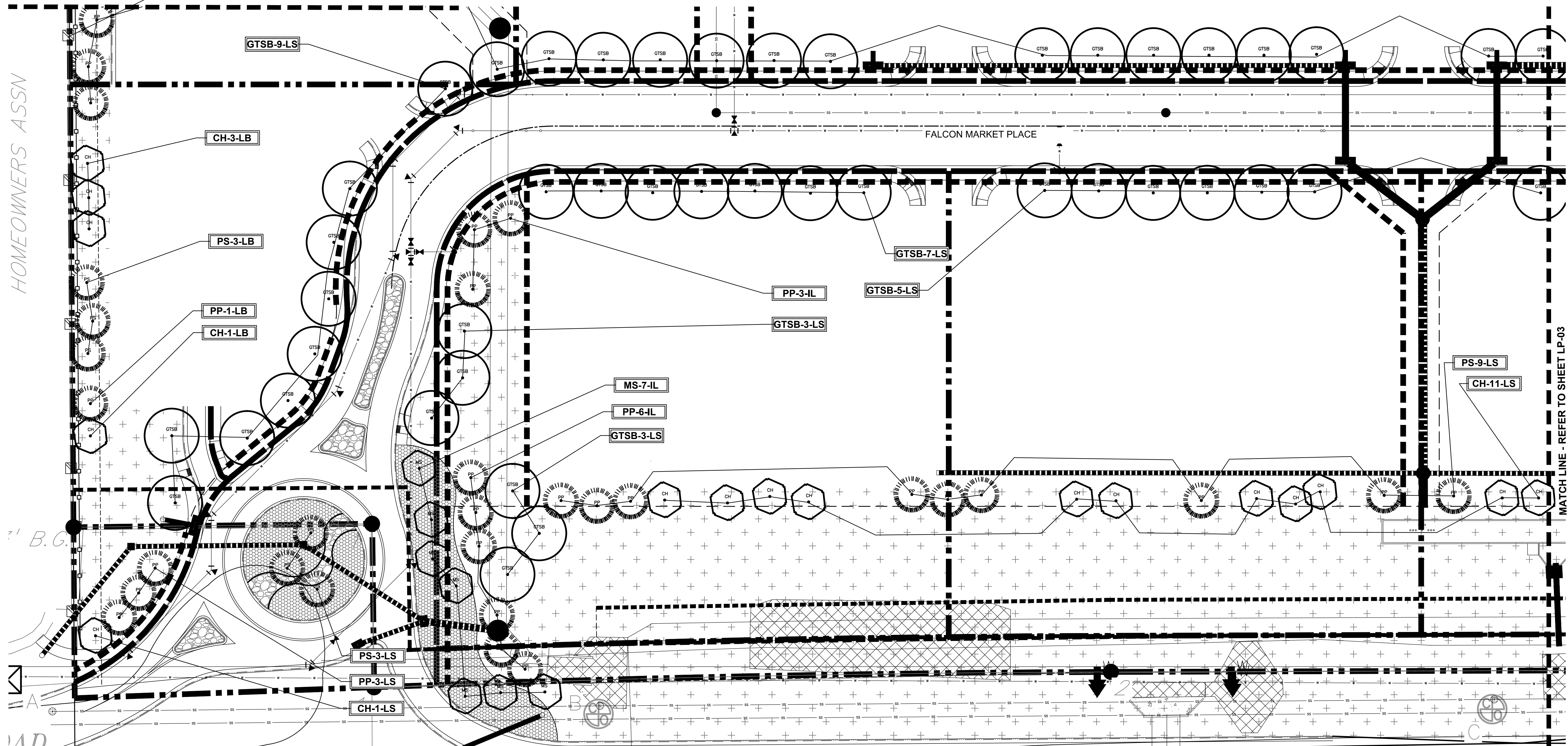

LANDSCAPE PLAN - AREA 'A'

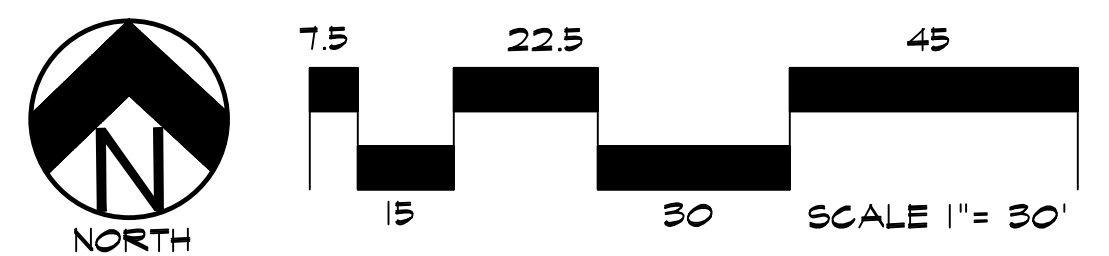

DOCUMENT NOTE

IRRESPECTIVE OF ANY OTHER TERM IN THIS DOCUMENT, LANDSCAPE ARCHITECT SHALL NOT CONTROL, OR BE RESPONSIBLE FOR CONSTRUCTION MEANS, METHODS, TECHNIQUES, SCHEDULES, SEQUENCES OR PROCEDURES, OR FOR CONSTRUCTION SAFETY OR ANY OTHER RELATED PROGRAMS, OR FOR ANOTHER PARTIES' ERRORS OR OMISSIONS OR FOR ANOTHER PARTIES FAILURE TO COMPLETE THEIR WORK OR SERVICES IN ACCORDANCE WITH LANDSCAPE ARCHITECT'S DOCUMENTS.

HIGHER GROUND DESIGNS, INC.
 LANDSCAPE ARCHITECTURE, PLANNING & IRRIGATION DESIGN
 5350 NORTH ACADEMY BLVD., STE. 207
 COLORADO SPRINGS, CO 80918
 Phone 719-477-1646
 Fax 719-588-1122



FALCON MARKETPLACE

FILING NO. 1
FALCON, CO - EL PASO COUNTY, CO

PREPARED FOR:
DREXEL, BARRELL & CO.

FOR APPROVAL ONLY

NOT FOR CONSTRUCTION	JOB NUMBER	688-17
	REVISIONS	
	7-2-18	PER COMMENTS
	8-3-18	PER COMMENTS
ORIGINAL DATE	5-22-17	
DRAWN BY:	JJM	
DESCRIPTION:	AREA 'A' LANDSCAPE PLAN	
SHEET NO.	LP-02	

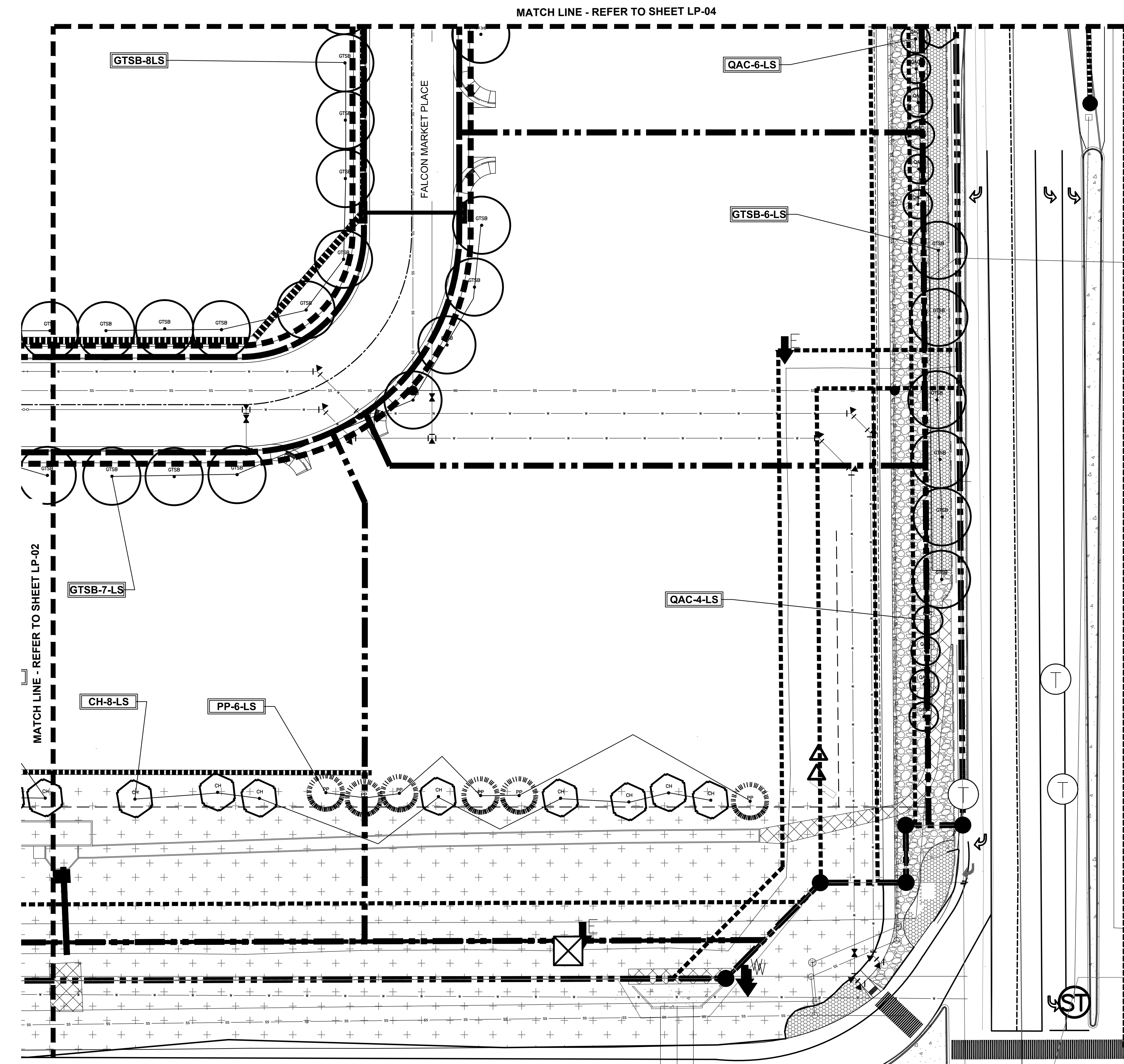

LANDSCAPE PLAN - AREA 'B'

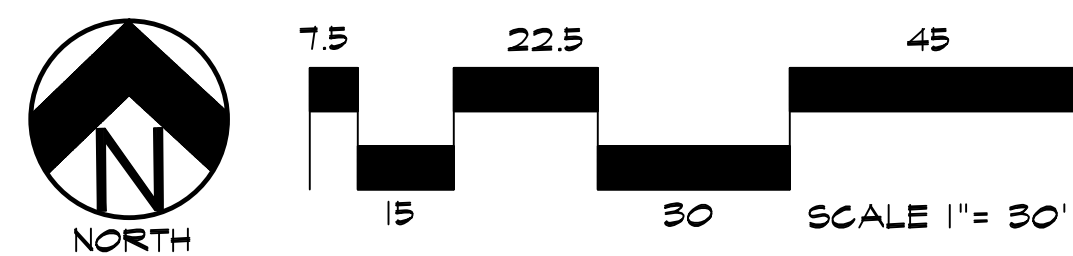

GROUND COVER LEGEND

SYMBOL	DESCRIPTION
	Arkansas Tan Rock: 1.5" Diameter (with weed barrier)
	Arkansas Tan Cobble: 2-4" Diameter (with weed barrier)
	Non-Irrigated Native Seed

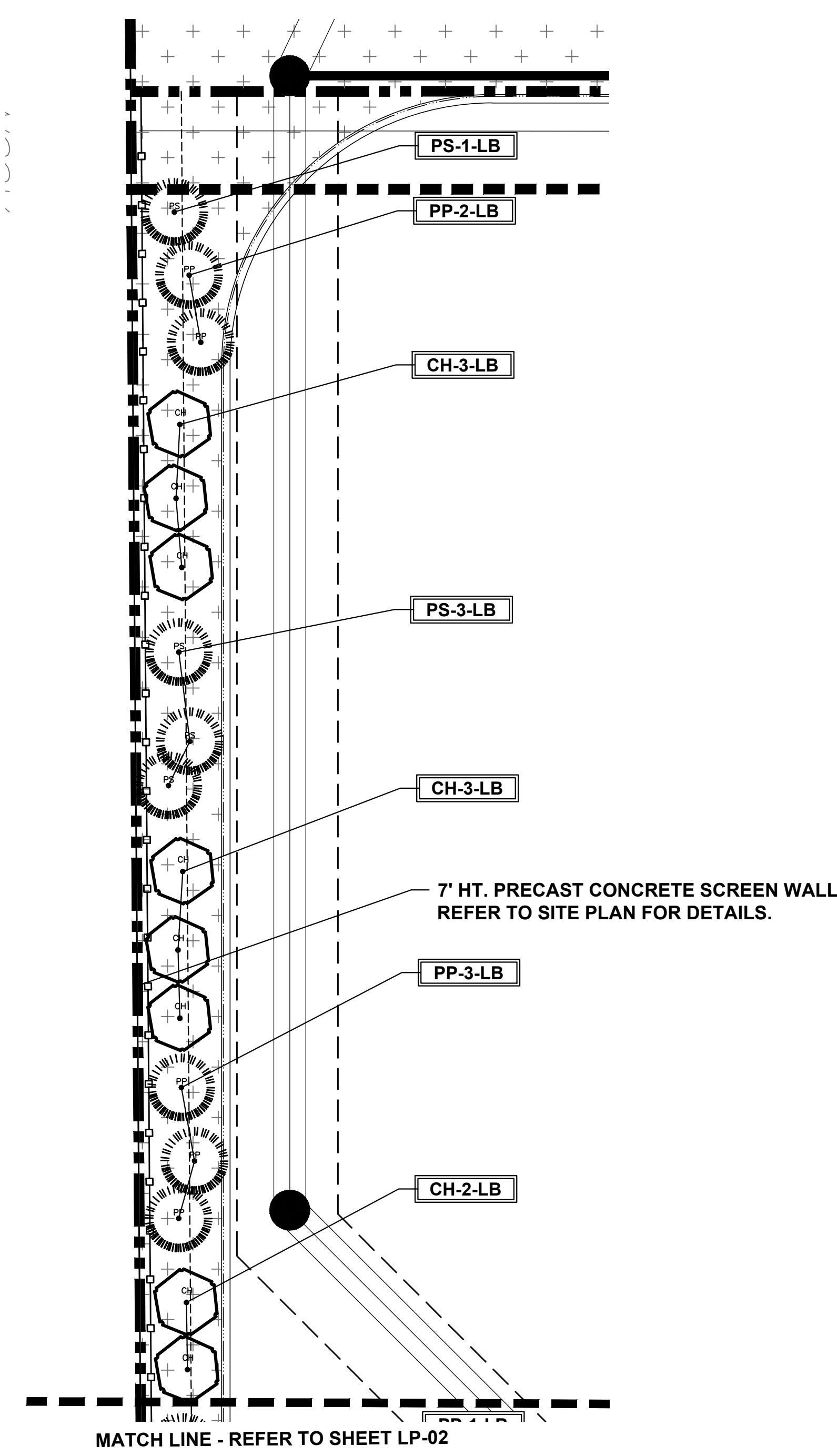

LANDSCAPE PLAN - AREA 'E'

DOCUMENT NOTE
 IRRESPECTIVE OF ANY OTHER TERM IN THIS DOCUMENT, LANDSCAPE ARCHITECT SHALL NOT CONTROL OR BE RESPONSIBLE FOR CONSTRUCTION MEANS, METHODS, TECHNIQUES, SCHEDULES, SEQUENCES OR PROCEDURES, OR FOR CONSTRUCTION SAFETY OR ANY OTHER RELATED PROGRAMS, OR FOR ANOTHER PARTIES' ERRORS OR OMISSIONS OR FOR ANOTHER PARTIES' FAILURE TO COMPLETE THEIR WORK OR SERVICES IN ACCORDANCE WITH LANDSCAPE ARCHITECT'S DOCUMENTS.

NOT FOR CONSTRUCTION

JOB NUMBER	688-17
REVISIONS	
7-2-18	PER COMMENTS
8-3-18	PER COMMENTS
ORIGINAL DATE	5-22-17
DRAWN BY:	JVM
DESCRIPTION:	AREA 'B' & 'E' LANDSCAPE PLAN
SHEET NO.	LP-03

FOR APPROVAL ONLY

FALCON MARKETPLACE
 FILING NO. 1
 FALCON, CO - EL PASO COUNTY, CO

PREPARED FOR:
 DREXEL, BARRELL & CO.

THESE DRAWINGS ARE THE PROPERTY OF HIGHER GROUND DESIGNS, INC. AND SHALL NOT BE USED FOR ANY OTHER PROJECT WITHOUT WRITTEN AUTHORIZATION BY HIGHER GROUND DESIGNS, INC. THESE DRAWINGS ARE FOR APPROVAL ONLY.



HIGHER GROUND DESIGNS, INC.
 LANDSCAPE ARCHITECTURE, PLANNING & IRRIGATION DESIGN
 5350 NORTH ACADEMY BLVD., STE. 207
 COLORADO SPRINGS, CO 80918
 Phone 719-577-1646
 Fax 719-588-1122

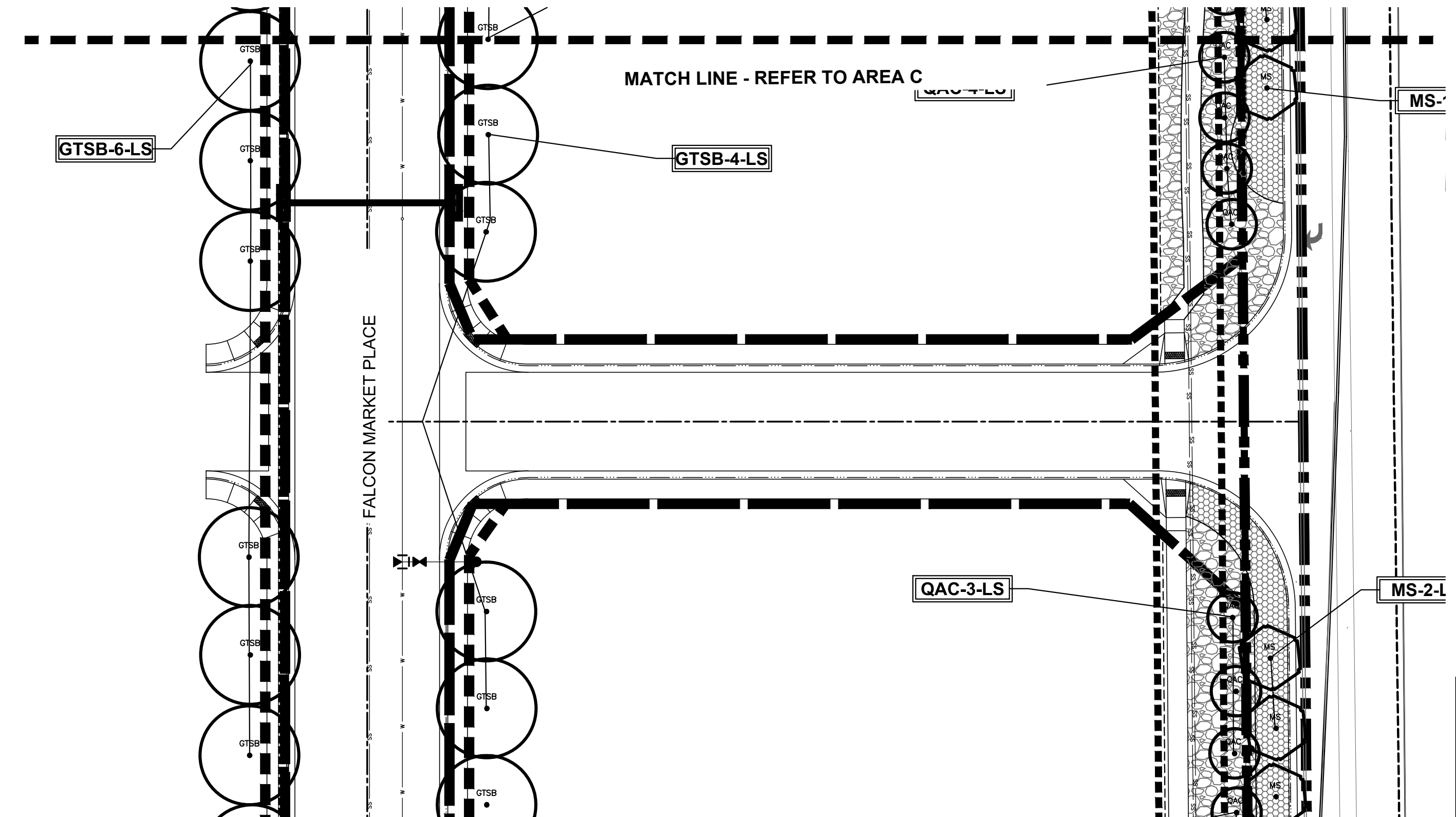
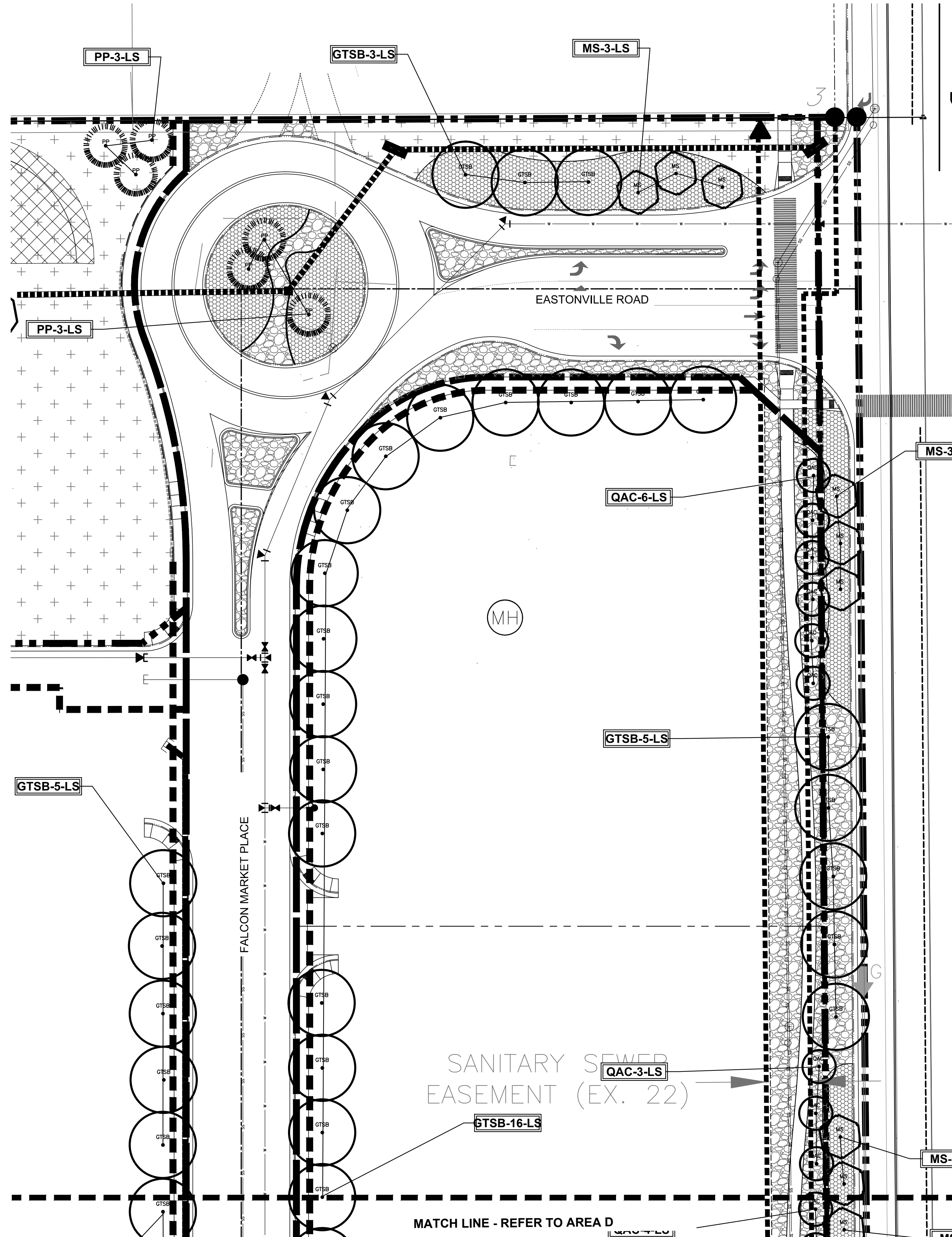

GROUND COVER LEGEND	
SYMBOL	DESCRIPTION
	Arkansas Tan Rock: 1.5" Diameter (with weed barrier)
	Arkansas Tan Cobble: 2-4" Diameter (with weed barrier)
	Non-Irrigated Native Seed

LANDSCAPE PLAN - AREA 'C'

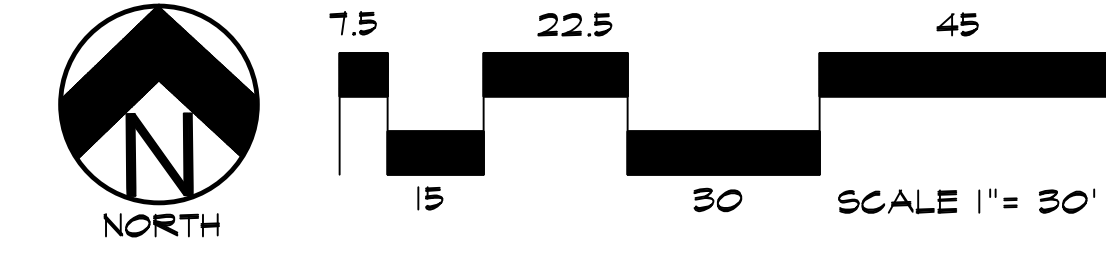

LANDSCAPE PLAN - AREA 'D'

DOCUMENT NOTE
 IRRESPECTIVE OF ANY OTHER TERM IN THIS DOCUMENT, LANDSCAPE ARCHITECT SHALL NOT CONTROL, OR BE RESPONSIBLE FOR CONSTRUCTION MEANS, METHODS, TECHNIQUES, SCHEDULES, SEQUENCES OR PROCEDURES, OR FOR CONSTRUCTION SAFETY OR ANY OTHER RELATED PROGRAMS, OR FOR ANOTHER PARTIES' ERRORS OR OMISSIONS OR FOR ANOTHER PARTIES FAILURE TO COMPLETE THEIR WORK OR SERVICES IN ACCORDANCE WITH LANDSCAPE ARCHITECT'S DOCUMENTS.

HIGHER GROUND DESIGNS, INC.
 LANDSCAPE ARCHITECTURE, PLANNING & IRRIGATION DESIGN
 5350 NORTH ACADEMY BLVD., STE. 207
 COLORADO SPRINGS, CO 80918
 Phone 719-577-1646
 Fax 719-588-1122



FALCON MARKETPLACE

FILING NO. 1
 FALCON, CO - EL PASO COUNTY, CO

THESE DRAWINGS ARE THE PROPERTY OF HIGHER GROUND DESIGNS, INC. AND SHALL NOT BE USED FOR ANY OTHER PROJECT WITHOUT THE AUTHORIZATION BY HIGHER GROUND DESIGNS, INC. THESE DRAWINGS ARE FOR APPROVAL ONLY.

PREPARED FOR:
 DREXEL, BARRELL & CO.

FOR APPROVAL ONLY

NOT FOR CONSTRUCTION	JOB NUMBER	688-17
	REVISIONS	
	7-2-18	PER COMMENTS
	8-3-18	PER COMMENTS
ORIGINAL DATE	5-22-17	
DRAWN BY:	JM	
DESCRIPTION:	AREA 'C' & 'D' LANDSCAPE PLAN	
SHEET NO.	LP-04	

Markup Summary

dsdparsons (5)

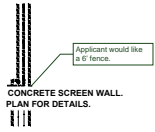

Subject: Callout
Page Label: 1
Author: dsdparsons
Date: 8/27/2018 4:12:35 PM
Color: ■

Applicant would like a 6' fence.

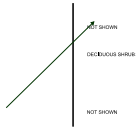

Subject: Arrow
Page Label: 1
Author: dsdparsons
Date: 8/28/2018 7:41:47 AM
Color: ■

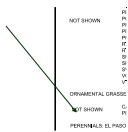

Subject: Arrow
Page Label: 1
Author: dsdparsons
Date: 8/28/2018 7:41:52 AM
Color: ■

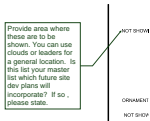

Subject: Callout
Page Label: 1
Author: dsdparsons
Date: 8/28/2018 7:44:41 AM
Color: ■

Provide area where these are to be shown. You can use clouds or leaders for a general location. In this list your master list which future site dev plans will incorporate? If so, please state.

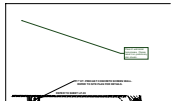

Subject: Callout
Page Label: 2
Author: dsdparsons
Date: 8/28/2018 7:46:23 AM
Color: ■

Place 6' wall detail here please. Please leave it on preliminary plan sheets.