

SAFeway AT FALCON TOWN CENTER

SITE DEVELOPMENT PLAN

TOWN OF FALCON AND COUNTY OF EL PASO
STATE OF COLORADO
LOCATED AT US HIGHWAY 24 AND WOODMEN ROAD

REGIONAL DETENTION POND 10.7 ACRES

- NOTE 1
PAD SITE CONFIGURATION IS CONCEPTUAL ONLY AND WILL BE DOCUMENTED IN A SEPARATE DEVELOPMENT PLAN.
- NOTE 2
RETAIL BUILDING CONFIGURATION IS APPROXIMATE AND WILL BE DOCUMENTED IN A SEPARATE DEVELOPMENT PLAN.
- NOTE 3
FOR PURPOSES OF ALLOWABLE BUILDING AREA, THE RETAIL BUILDINGS A & B AND SAFEWAY ARE CONSIDERED AS ONE BUILDING STRUCTURE, FULLY FIRE SPRINKLED.
- NOTE 4
ALL PAD SITES ARE REQUIRED TO SELF PARK WITHIN THEIR LOTS.
- NOTE 5
A RECIPROCAL PARKING AGREEMENT WILL BE USED FOR THIS SITE.

LEGEND	
	BUILDING ENTRANCE/EXIT
	TRASH ENCLOSURES
	SITE LIGHT POLE-DOUBLE HEAD
	SITE LIGHT POLE-SINGLE HEAD
	FIRE HYDRANT
	ACCESSIBLE PARKING STALL
	CART CORRAL

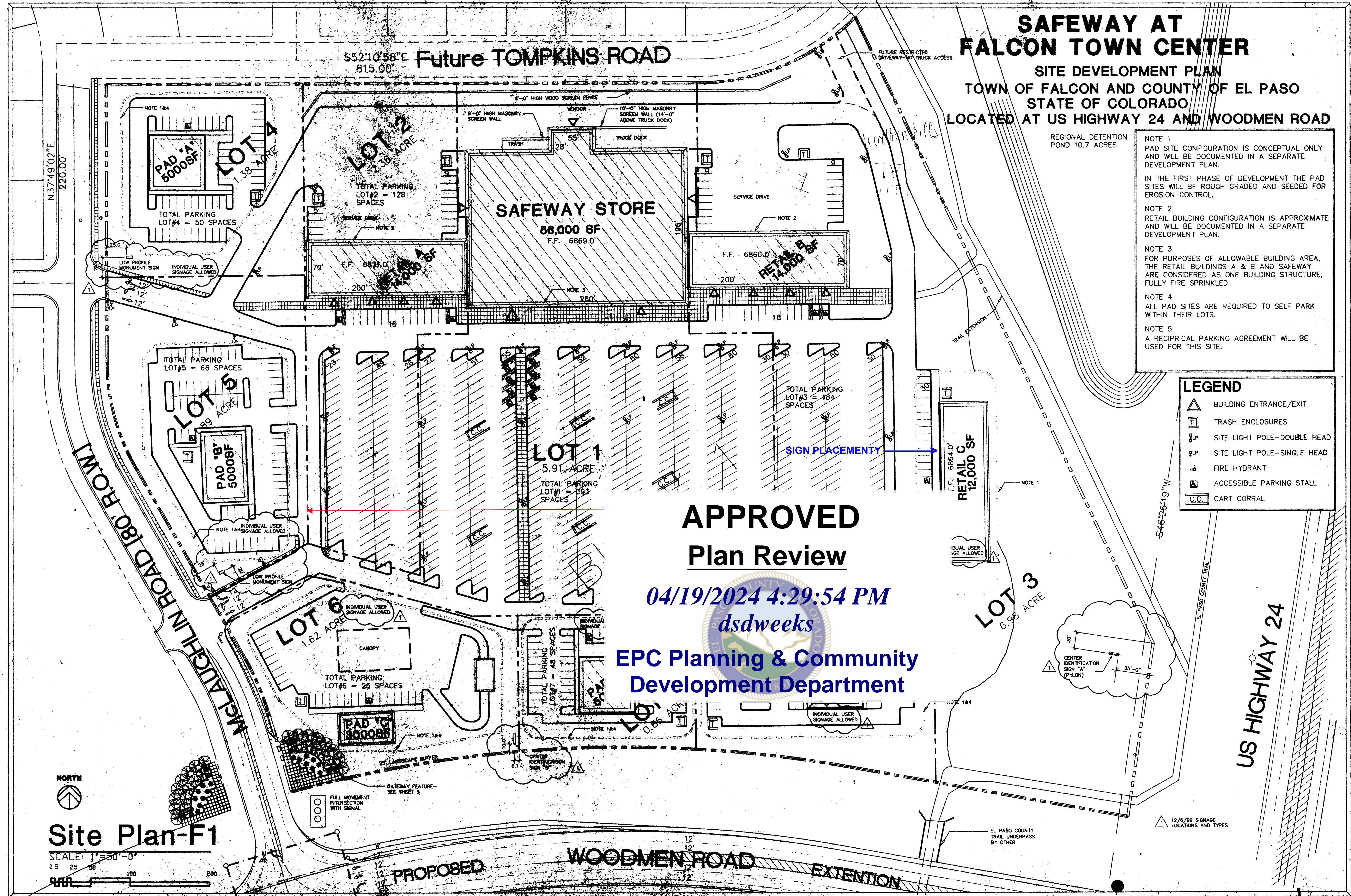

APPROVED
Plan Review

04/19/2024 4:29:54 PM
dsdweeks

EPC Planning & Community
Development Department

Site Plan-F1

SCALE: 1"=50'-0"
0 5 25 50 100 200