

SITE PLAN EXHIBIT
16975 FALCON HIGHWAY, PEYTON, CO

SITUATED IN THE NORTHWEST QUARTER OF SECTION 13, TOWNSHIP 13 SOUTH, RANGE 64 WEST OF THE
6TH P.M., CITY OF PEYTON, COUNTY OF EL PASO, STATE OF COLORADO

LEGEND

-
- GRAVEL ROAD
- ASPHALT ROAD
- FLOODPLAIN
- SEASONALLY WET AREAS*
(NO BUILD AREAS)
- PROPERTY BOUNDARY
- LOT LINE
- PROPERTY SETBACK
- FEMA 100YR FLOODPLAIN
- NO BUILD AND NO STORAGE EASEMENT LINE
- ACCESS AND UTILITY EASEMENTS
- EXISTING GRAVEL ROAD TO BE REMOVED
- BFE: XXXX— BASE FLOOD ELEVATION

*NOTE: SEE FIG. 11 FROM RMG ARCHITECTS AND ENGINEERS SOILS AND GEOLOGY REPORT. JOB NO.:180213 FOR FURTHER INFORMATION.

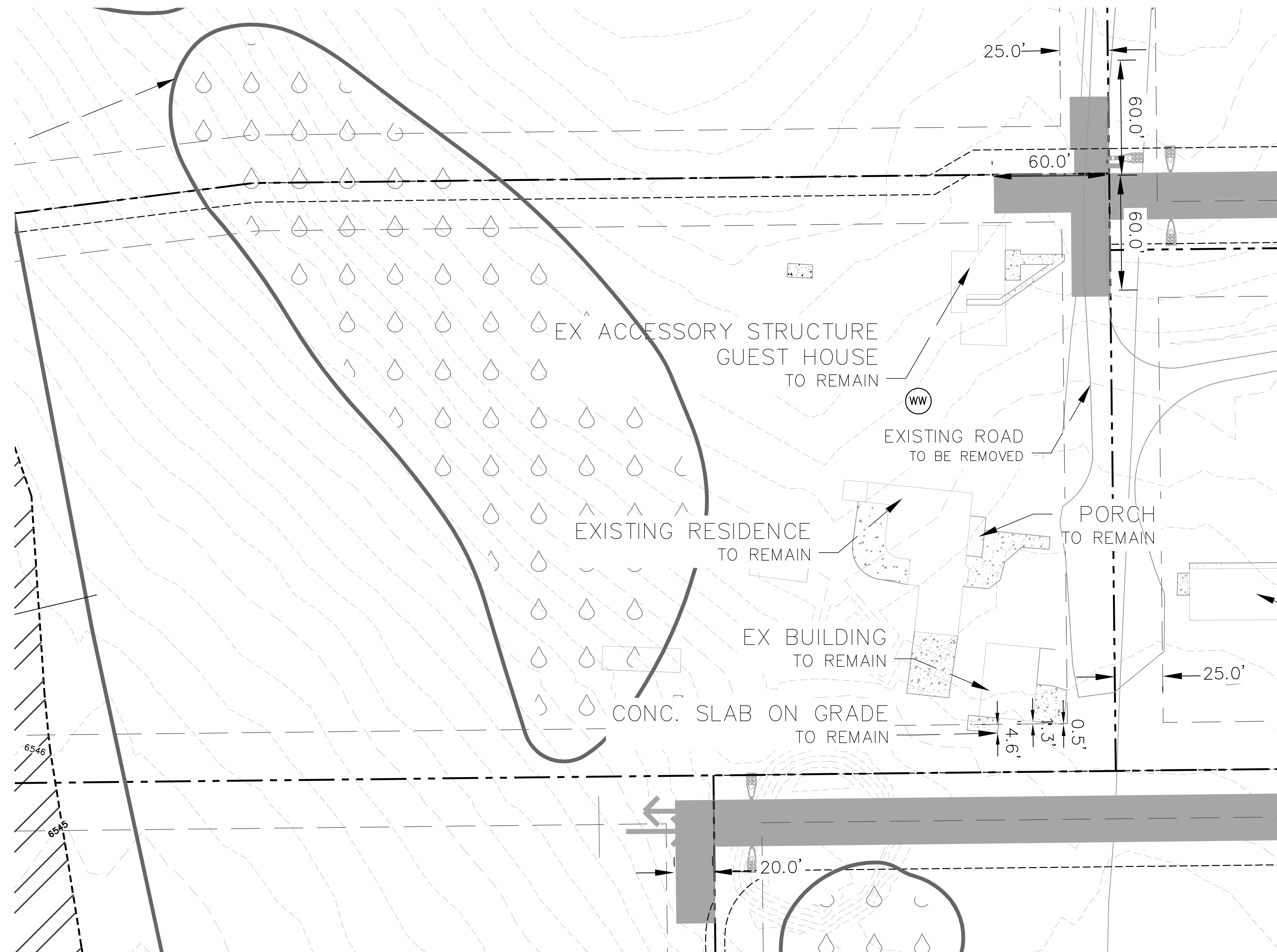

K:\COS LA\196114000 - Peerless Farms\CADD\PlanSheets\196114000-PP.dwg Jan 08, 2024 10:40am



© 2023 KIMLEY-HORN AND ASSOCIATES, INC.
2 NORTH NEVADA AVENUE, SUITE 900
COLORADO SPRINGS, COLORADO 80903 (719) 453-0180

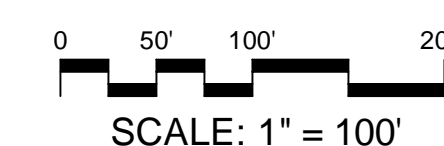

SITE PLAN EXHIBIT
SHEET 1 OF 1

PEERLESS FARMS PRELIMINARY PLAN - COUNTY FILE NO. SP217