

A PARCEL OF LAND IN THE SOUTHEAST 1/4 OF SECTION 13, TOWNSHIP 11 SOUTH, RANGE 67 WEST OF THE SIXTH PRINCIPAL MERIDIAN COUNTY OF EL PASO, STATE OF COLORADO

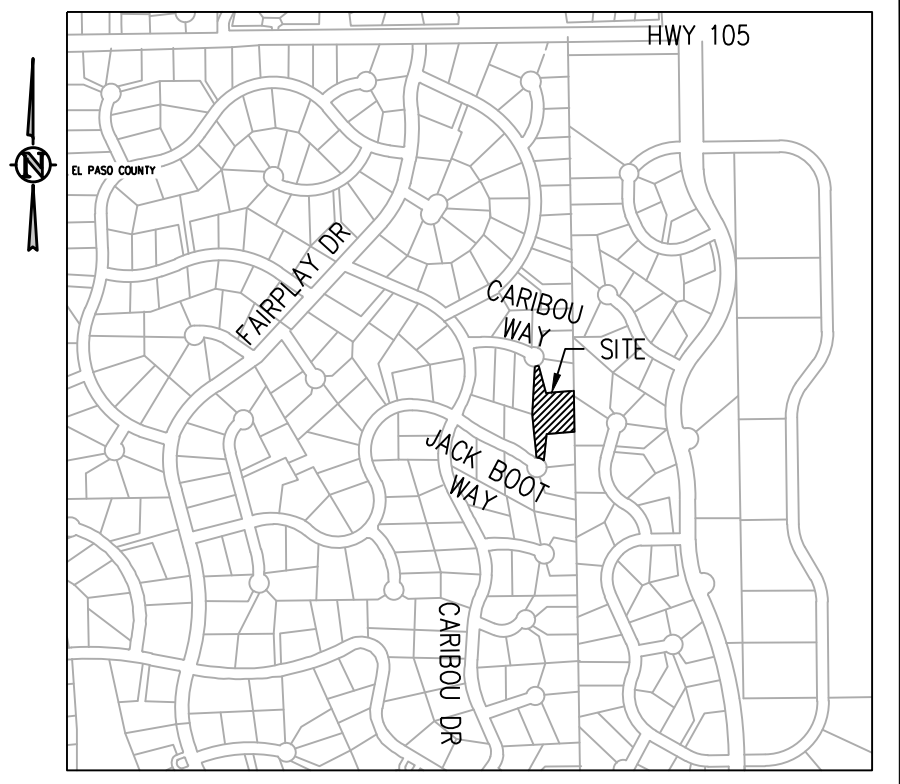

Please provide additional landscaping between tower and residential area per landscape code as screening and buffer between new tank and residential.

MULCHING AND SEEDING NOTES FOR EL PASO COUNTY

- ALL DISTURBED AREAS MUST BE MULCHED WITHIN 21 DAYS AFTER FINAL GRADE AND SEEDED AREAS ARE TO BE MULCHED WITH 24 HOURS AFTER SEEDING.
- MATERIAL USED FOR MULCH CAN BE CERTIFIED CLEAN, WEED- AND SEED-FREE LONG STEMMED FIELD OR MARSH HAY, OR STRAW OF OATS, BARLEY, WHEAT, RYE OR TRITICALE CERTIFIED BY THE COLORADO DEPARTMENT OF AGRICULTURE WEED FEE FORAGE CERTIFICATION PROGRAM.
- HYDRAULIC MULCHING MATERIAL SHALL CONSIST OF VIRGIN WOOD FIBER MANUFACTURED FORM CLEAN WHOLE WOOD CHIPS. WOOD CHIPS CANNOT CONTAIN ANY GROWTH OR GERMINATION INHIBITORS OR BE PRODUCED FROM RECYCLED MATER. GRAVEL CAN ALSO BE USED.
- MULCH IS TO BE APPLIED EVENLY AT THE RATE OF 2 TONS PER ACRE.
- MULCH TO BE ANCHORED EITHER BY CRIMPING (TUCKING MULCH FIBERS 4 INCHES INTO THE SOIL), USING NETTING (USED IN SMALL AREAS WITH STEEP SLOPES), OR WITH TACKIFIER.
- HYDRAULIC MULCHING AND TACKIFIERS ARE NOT TO BE USED IN THE PRESENCE OF FREE SURFACE WATER.

EL PASO COUNTY CONSERVATION DISTRICT SHOTGUN MIX

COMMON NAME	RECOMMENDED VARIETY	% OF SEED MIX	PLS/ACRE
BLUESTEM, BIG	KAW, BISON, CHAMP	20	1.08
LITTLE BLUESTEM	SCHIZACHYRIUM SCOPARIUM	10	0.12
GREEN NEEDLEGRASS	L0D0RM	10	0.48
WHEATGRASS, WESTERN	ARRIBA, BARTON	20	1.60
GRAMA, SIDEOATS	VAUGHN, BUTTE, EL RENO, NINER	10	0.46
SWITCHGRASS	BLACKWELL, GREENVILLE	10	0.20
PRAIRIE SANDREED	GOSHEN, PRONGHORN	10	0.32
YELLOW INDIANGRASS	CHEYENNE, HOLT, LLANO	10	0.51

ALTERNATIVE LANDSCAPE PLAN NOTES:

EXISTING SITE LANDSCAPING IS NATIVE AND FENCING IS NOT ALLOWED PER HOA BYLAWS. LANDSCAPING APPROACH IS TO PRESERVE NATIVE VEGETATION AND TREES WHERE APPLICABLE AND TO RESEED DISTURBED AREAS WITH THE SEED MIX IN THE TABLE ABOVE.

LANDSCAPING IS INTENDED TO BE MINIMAL EXCEPT FOR PREVENTING EROSION. DUE TO THE NATURE OF THE FACILITY, TREES AND SHRUBS ARE KNOWN TO INTERFERE WITH OPERATION. ROOTS AND MAINTENANCE NEEDS CREATE ISSUES FOR OPERATIONS EFFORTS, PIPING, AND INFRASTRUCTURE, THEREFORE THE DISTRICT PREFERS TO KEEP ALL VEGETATION TO A MINIMUM.

LEGEND:

MULCHED AND SEEDED AREA

PROPERTY INFORMATION:

ADDRESS: CARIBOU WAY (NO DESIGNATED STREET NO.)
 USE: EXEMPT NON RESIDENTIAL LAND
 TAX SCHEDULE: 7113401040-EXEMPT
 CURRENT ZONING: RS-2000
 LOT/PARCEL: R07669 **RS-20000**

OWNER CONTACT:

JESSIE SHAFFER, DISTRICT MANAGER
 WOODMOOR WATER AND SANITATION DISTRICT
 BOX 1407, MONUMENT, CO 80132
 719-488-2525 EXT. 14
 JESSIE@WOODMOORWATER.COM

APPLICANT:

RICHARD HOOD, PROJECT MANAGER
 JVA, INCORPORATED
 1675 LARIMER STREET, SUITE 550
 DENVER, CO 80202

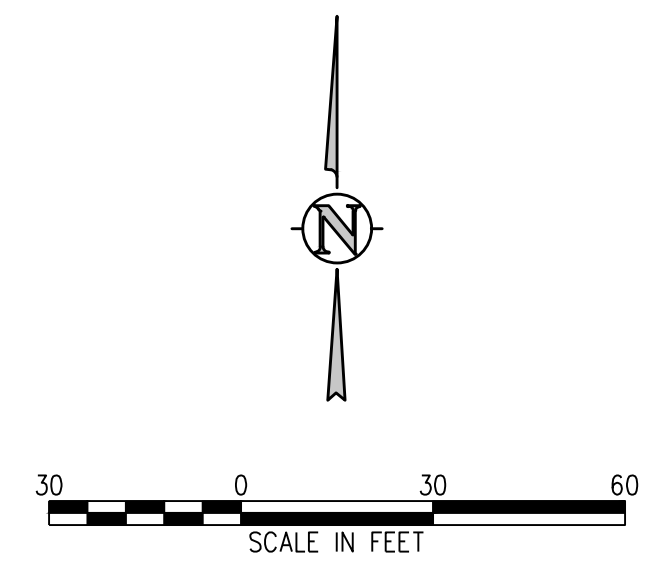

REVISION DESCRIPTION

NO. DATE DESD DWN

DESIGNED BY: RLK/KCT
 DRAWN BY: JGJ
 CHECKED BY: JJM/RAH
 JOB #: 240504.ENV
 DATE: SEPTEMBER 6, 2024
 © JVA, INC.

WOODMOOR WSD NO. 1
 SOUTH TANK PROJECT
 EL PASO COUNTY, CO

ALTERNATE LANDSCAPE PLAN

SHEET NO.
FIG-2

PCD File No. ???