

APPROVED
Plan Review
05/20/2026 3:17:58 PM
dsdyounger
EPC Planning & Community
Development Department

Not Required
BESQCP

05/20/2026 3:17:29 PM
dsdyounger

EPC Planning & Community
Development Department

ADD26282

ANY APPROVAL GIVEN BY
EL PASO COUNTY
DOES NOT OBLIVATE THE NEED
TO COMPLY WITH APPLICABLE
FEDERAL, STATE, OR LOCAL
LAWS AND/OR REGULATION

Planning & Community Development Department
approval is contingent upon compliance with all
applicable notes on the recorded plat.

An access permit must be granted by the
Planning & Community Development Department
prior to the establishment of any driveway onto a
County road.

Division of blockage of any drainage way
is not permitted without approval of the
Planning & Community Development Department

It is the owner's responsibility to
coordinate with easement holders
to avoid impact to utilities that
may be located in the easements.

****Carport is detached
from principal structure
and is only to be used
as vehicle shelter.**

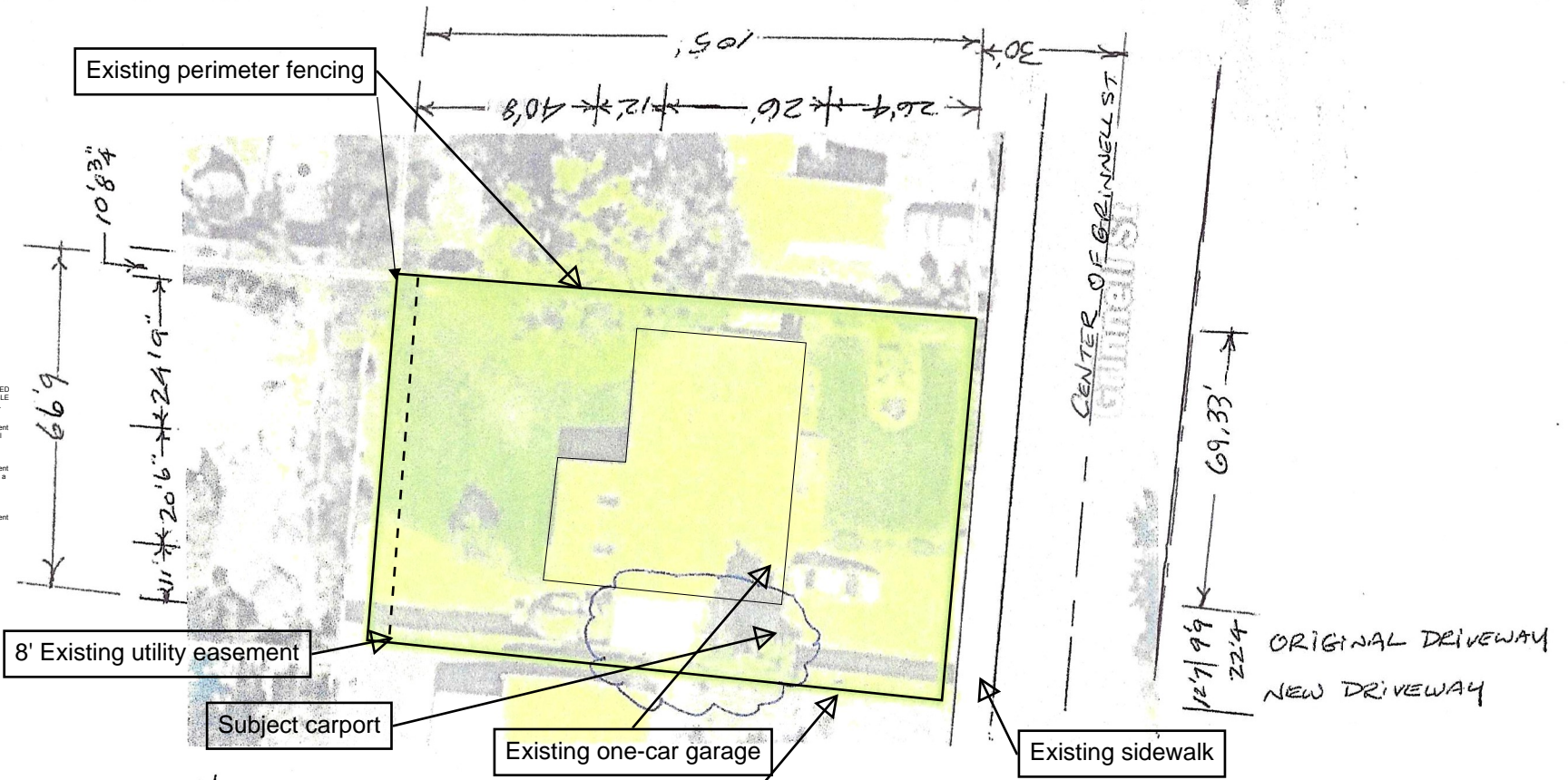

5519205008
108
GRINNELL
ST

Zoning:
RS-5000 CAD-O

Plat No:
R02081

Legal Description:
LOT 21 BLK 16 WIDFIELD
HOMES NO 7

LOT SIZE 7143 SQFT
TOTAL LIVING
AREA 1794 SQFT

25.12% lot coverage

OWNER: MICHAEL HUME
719-244-6221
HUME6972@AOL.COM

Existing perimeter fencing

FIRST GENERAL SERVICES (LIC. #10955)
SCOTT D. SMITH
W-719-635-3056
DC-719-499-4353
SCOTT@FCSFRONT RANGE.COM

RESIDENTIAL



2023 PPRBC
IECC: N/A

Address: 106 GRINNELL ST, COLORADO SPRINGS

Parcel: 5519205008

Plan Track #: 202203 

Received: 04-May-2026 (MELISSAF)

Description:

CARPORT AND STRUCTURAL REPAIR

Contractor: FIRST GENERAL SERVICES FRONT RANGE

Type of Unit:

Required PPRBD Departments (2)

Floodplain

(N/A) RBD GIS

Construction

Required Outside Departments (1)

County Zoning

APPROVED
Plan Review
05/20/2026 3:18:47 PM
dsdyounger
EPC Planning & Community
Development Department

Release of this plan does not preclude compliance with all applicable codes, ordinances and other pertinent regulations. This plan set must be present on the job site for every inspection.