

DO NOT REPRODUCE  
This document contains confidential information, and is an instrument of service and property of the architect. It shall not be used on other projects or for the extension of this project without the Architect's written approval.



**STARBUCKS SHELL BUILDING**  
**OWL PLACE CO**  
7885 MERIDIAN PARK DR.  
PEYTON, CO 80831

Revisions:		
#	Description	Date
1	CITY COMMENTS	11/25/2024

Issue Date: 11/25/2024  
Designer: M. FERUGSON  
Drawn By: M. FERUGSON  
Check By: A. HERNANDEZ  
Project No: Q-511220002  
Package: 100% CD SET

Title:  
ELECTRICAL  
PHOTOMETRICS

Sheet No.  
**E302**

**POLE MOUNTING NOTES**  
POLE LIGHT FIXTURES DESIGNED FOR USE WITH HUBBELL SSS-H-40-A POLE, NO GREATER THAN 18'-0" TALL.  
THESE ARE DESIGNED AROUND AN ESTIMATED 140 MPH WIND SPEED PER THE AASHTO WIND MAP DATA AND LOCALLY AMENDED IBC INSTRUCTIONS.

**UNRESOLVED FROM REVIEW 1:** Please include a graphical depiction of the lighting devices. This may include manufacturers specifications and catalog cuts sheets, and drawings

**PHOTOMETRIC NOTES**  
ALL FIXTURE HEIGHTS ASSUME A BASELINE ELEVATION OF 0" A.F.F. AT THE CONSTRUCTED BUILDING'S FINISHED FLOOR SLAB. FIXTURE HEIGHTS GIVEN WHEN MOUNTED TO THE BUILDING ARE FOR THE CENTERLINE MOUNTING HEIGHT. FIXTURE HEIGHTS GIVEN WHERE POLE MOUNTED OR RECESSED ARE GIVEN FOR THE BOTTOM OF THE LENS OF THE LUMINAIRE AND DO NOT REFLECT THE HEIGHT OF THE POLE, BASE OR THE FIXTURE ITSELF.  
LIGHTING SHOWN IS DESIGNED BASED ON THE WRITTEN LANDLORD'S CONTRACTOR LETTER TO DETERMINE FIXTURE OUTPUTS AND DISTRIBUTION AS TO MEET THE WRITTEN FOOT-CANDLE LEVELS REQUIRED. FIXTURES PER THE SCHEDULE MUST BE SEPARATELY APPROVED BY THE LANDLORD'S CONTRACTOR AND TENANT PRIOR TO PURCHASE AND INSTALLATION. ALTERNATIVE FIXTURES SHALL BE PROVIDED AS A SUBMITTAL TO THE ENGINEER FOR REVIEW. SUBMITTAL FOR THEIR PROPOSED ALTERNATIVE FIXTURE SHALL INCLUDE A PRODUCT DATA SHEET AND PHOTOMETRIC STUDY FOR COMPARISON TO THE PHOTOMETRIC STUDY PROVIDED HERE IN AS THE BASIS OF DESIGN.  
PHOTOMETRIC CALCULATIONS AS DRAWN FACTOR THE SHELL CONSTRUCTION ONLY AND ASSUME NO TOPIARY, FOLIAGE, TREES OR OTHER BOUNDARIES, BARRIERS OR OBSTRUCTIONS THAT MAY BE PRESENT. LIGHT LEVELS SHOWN DO NOT REFLECT ADDITIONAL BOUNDARIES, OBSTRUCTIONS, TENANT CONSTRUCTION, ELEVATION CHANGES, OR EXISTING FIXTURES OR LIGHTING PROVIDED AWAY FROM THE SITE, AND MAY NOT FULLY REFLECT FINAL CONDITIONS OR CONSTRUCTION.

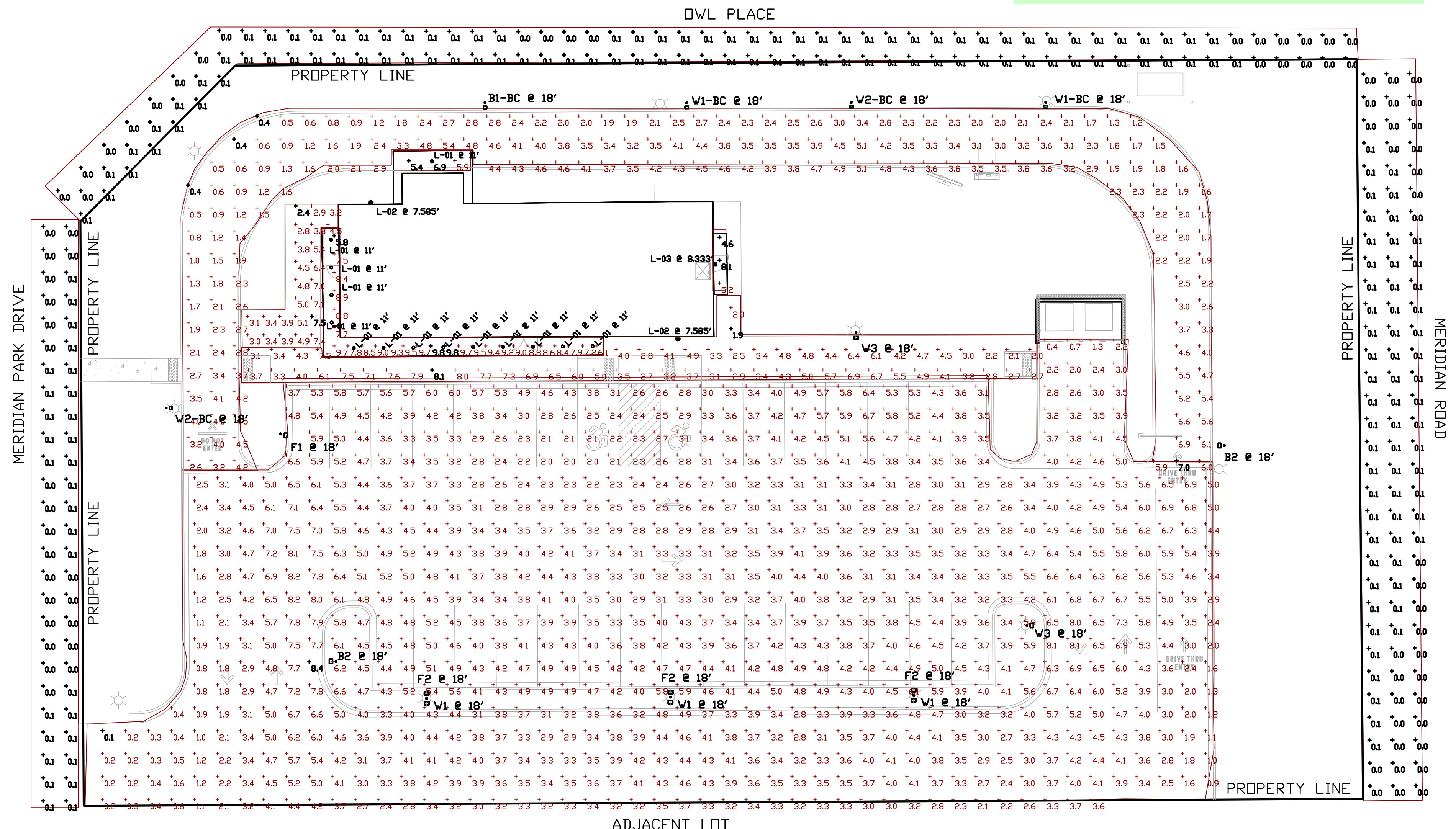

Schedule							
Symbol	Label	Quantity	Catalog Number	Description	Number Lamps	Lumens Per Lamp	Wattage
	L-02	2	258377-1 MDD#11251/CP133537	LED WALL CYLINDER	1	574	14.7
	L-03	1	WDGE2 LED P1 30K 80CRI VF	WDGE2 LED WITH P1 - PERFORMANCE PACKAGE, 2700K, 80CRI, VISUAL COMFORT FORWARD OPTIC	1	1166	9.81
	L-01	14	JSF 71N 10LM 40K 90CRI MVDLT 2T VH	JSF Round Edgellit (SlimForm) Surface Mount, 4000K, 90CRI, MV	1	1135	12.8
	F2	3	ALTI-28L-85-3k9-4	ALTITUDE 2.0	1	9170	86
	W3	2	ALTI-54L-120-3k9-3	ALTITUDE 2.0	1	13661	122
	W1	3	ALTI-28L-60-3k9-3	ALTITUDE 2.0	1	6939	60
	B2	1	ALTI-28L-85-3k9-2	ALTITUDE 2.0	1	9048	86
	F1	1	ALTI-28L-60-3k9-4	ALTITUDE 2.0	1	6946	60
	W1-BC	2	ALTI-28L-60-3k9-3	ALTITUDE 2.0	1	4200	60
	W2-BC	2	ALTI-28L-85-3k9-3	ALTITUDE 2.0	1	5545	86
	B1-BC	1	ALTI-28L-60-3k9-2	ALTITUDE 2.0	1	4182	60
	B2	1	ALTI-28L-85-3k9-2	ALTITUDE 2.0	1	9048	86

Statistics						
Description	Symbol	Avg	Max	Min	Max/Min	Avg/Min
DT Lane	+	2.9 fc	7.0 fc	0.4 fc	17.5:1	7.3:1
Front Canopy	+	8.6 fc	9.8 fc	5.8 fc	1.7:1	1.5:1
Parking Area	+	3.9 fc	8.4 fc	0.1 fc	84.0:1	39.0:1
Patio Area	+	4.6 fc	7.5 fc	2.4 fc	3.1:1	1.9:1
Property Line (Meridian Park Dr.)		0.1 fc	0.1 fc	0.0 fc	N/A	N/A
Property Line (Meridian Rd)	+	0.1 fc	0.1 fc	0.0 fc	N/A	N/A
Property Line (Dwl PL)	+	0.1 fc	0.1 fc	0.0 fc	N/A	N/A
Rear Canopy	+	6.0 fc	8.1 fc	4.6 fc	1.8:1	1.3:1
Storefront Sidewalk	+	4.6 fc	8.1 fc	1.9 fc	4.3:1	2.4:1
DT Canopy	+	6.1 fc	6.9 fc	5.4 fc	1.3:1	1.1:1