



Colorado Springs Utilities

It's how we're all connected

May 09, 2024

El Paso County, Planning and Community Development Department
2880 International Circle, Suite 110
Colorado Spring, CO 80910

RE: Letter of Intent

To Whom It May Concern:

As part of the Marksheffel Connector Gas Main Project, Colorado Springs Utilities ("Utilities"), an enterprise of the City of Colorado Springs, and Miller Pipeline, LLC ("the Contractor") intend to construct a 16" steel natural gas main ("the Project") from existing infrastructure at Barnes Road continuing along Marksheffel Road, turning down Tamlin Road, then tying into existing infrastructure at Dublin Boulevard.

Construction for this project includes installation of new 16" natural gas main infrastructure to be conducted within easements, to include all appurtenances and associated infrastructure to ensure a complete and efficient installation. This construction project will specifically include installation of approximately 16,000 LF of 16" steel pipe by excavation, installing of new pipe, and associated infrastructures, backfill, and restoration with seeding and mulching as final stabilization. A depiction of the project area is attached to this letter as Attachment A.

Utilities anticipates that the New Gas Main - which will not exceed a hoop stress of 20% or more at its specified minimum yield strength - would start at the Barnes Road Gate Station on the property identified by TSN 5320400007. From this location, the New Gas Main would proceed east and run north along the edge of Marksheffel Road to Tamlin Road and then continue northeast to the property identified by TSN 5300000760 where it will continue north through the following easements; TSN 5315320001, TSN 5315202002, and TSN 5315202001. The legal description for the two El Paso County properties associated with this project are as follows: North East Quarter of South West Quarter of Section 21, Township 13 South, Range 65 West, El Paso County, Colorado, Sixth Principal Meridian; and South West Quarter of South West Quarter of Section 15, Township 13 South, Range 65 West, El Paso County, Colorado, Sixth Principal Meridian. The new gas main will end at Dublin Boulevard after connecting through these easements. This project is a linear underground utility installation within easement and no traffic impact will be produced from the project. There will be no increase in traffic volume or alteration to the existing traffic patterns in the area. A drainage report isn't necessary due to the post construction contours matching the existing contours. There will be no change to the existing drainage pattern, and no negative impact on the downstream drainage system due to the construction of this new gas main.

A depiction of the proposed New Gas Main is attached to this Letter as Exhibit B, and the names and qualifications of the persons associated with the Project are attached to this Letter as Exhibit C. Please do not hesitate to contact us if you have any questions or require additional documentation.

Sincerely,

Randy Hiett, Project Manager
Miller Pipeline LLC
421 E. Industrial Blvd.
Pueblo West, CO 81007
randy.hiett@millerpipeline.com

121 South Tejon Street, Fourth Floor
P.O. Box 1103, Mail Code 940
Colorado Springs, CO 80903-2187

Phone 719-668-8426
Fax 719-668-8666
<http://www.csu.org>



MILLER PIPELINE

AN ARTERA COMPANY



Attachment A



Colorado Springs Utilities

It's how we're all connected



MILLER PIPELINE

AN ARTERA COMPANY



Vicinity Map

Additional maps can be found in GEC Plan submitted with this letter.

SITE MAP: not to scale

MARKSHEFFEL CONNECTOR

PROJECT SITE



LOCATION
MAP

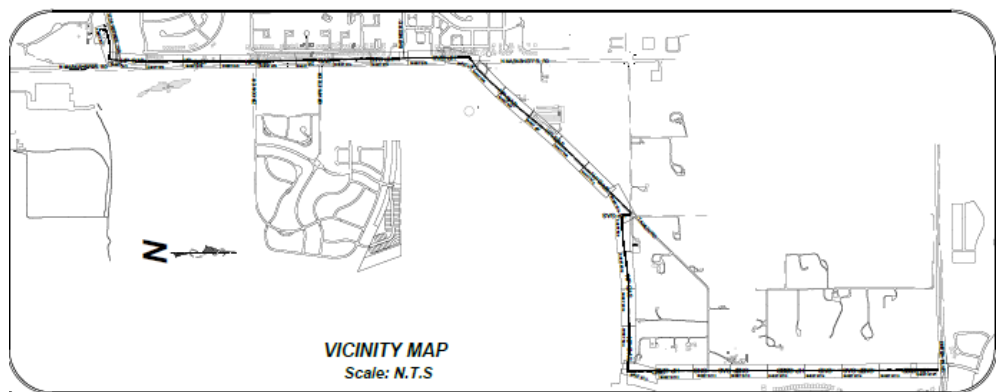
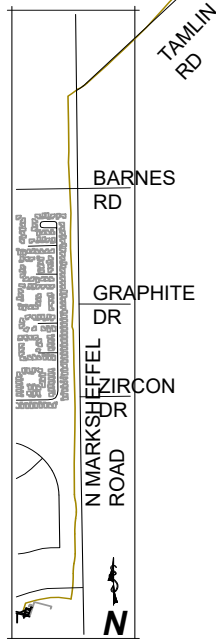

121 South Tejon Street, Fourth Floor
P.O. Box 1103, Mail Code 940
Colorado Springs, CO 80903-2187

Phone 719-668-8426
Fax 719-668-8666
<http://www.csu.org>

Attachment B

MARKSHEFFEL CONNECTOR 16IN HIGH PRESSURE GAS MAIN

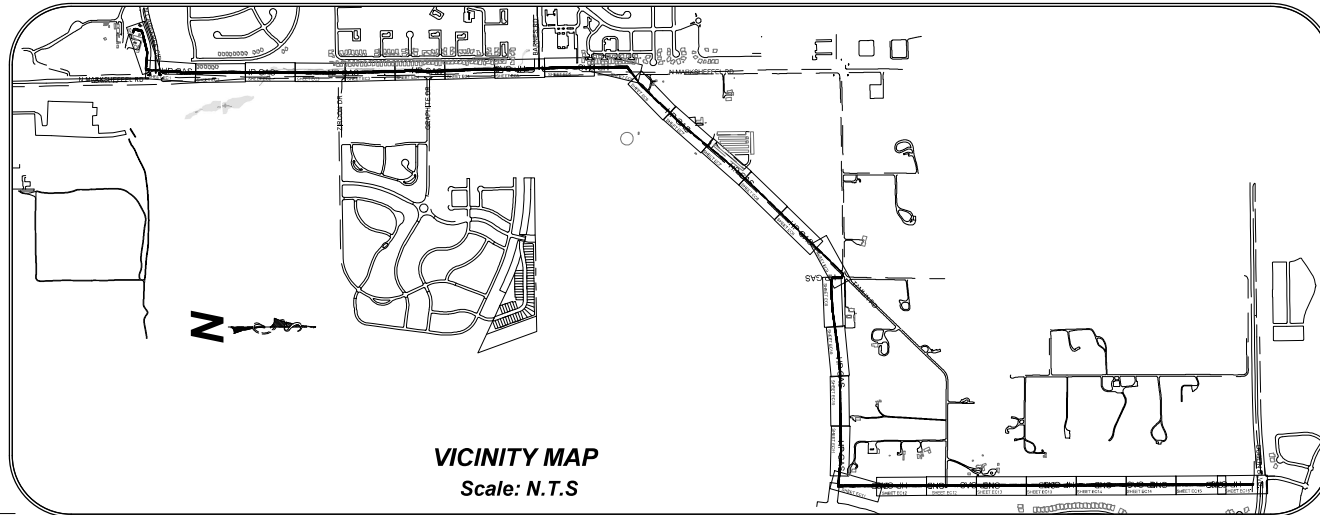

CITY OF COLORADO SPRINGS GRADING AND EROSION CONTROL REVIEW: THIS GRADING AND EROSION CONTROL PLAN IS FILED IN ACCORDANCE WITH CITY CODE. THIS PLAN IS REVIEWED IN ACCORDANCE WITH THE STORMWATER CONSTRUCTION MANUAL, LATEST REVISIONS.

SIGNATURE _____ DATE _____

CSU PROJECT MANAGER'S STATEMENT: I HEREBY CERTIFY THAT THE DRAINAGE, GRADING, AND EROSION CONTROL FOR CSU MARKSHEFFEL CONNECTOR SHALL BE CONSTRUCTED ACCORDING TO THE DESIGN PRESENTED IN THIS GRADING AND EROSION CONTROL PLAN. I FURTHER UNDERSTAND THAT FIELD CHANGES MUST BE REVIEWED BY THE SWIFT REVIEW ENGINEER TO ENSURE CONFORMANCE WITH THE ORIGINAL DESIGN INTENT. I AM EMPLOYED BY AND PERFORM ENGINEERING SERVICES SOLELY FOR COLORADO SPRINGS UTILITIES, AN ENTERPRISE OF THE CITY OF COLORADO SPRINGS, AND THEREFORE AM EXEMPT FROM COLORADO REVISED STATUTE TITLE 12, ARTICLE 26, PART 1, ACCORDING TO 8-12-25-103(1), C.R.S.

NAME OF CSU PROJECT MANAGER: Mark Muñoz
 SIGNATURE: Mark Muñoz DATE: 04/16/2024
 TITLE: Project Manager
 PHONE NUMBER: 719-668-2862
 EMAIL ADDRESS: mmunoz@csu.org

CONTRACTOR'S STATEMENT: I WILL COMPLY WITH THE REQUIREMENTS OF THE GRADING AND EROSION CONTROL PLAN INCLUDING CONSTRUCTION CONTROL MEASURE INSPECTION REQUIREMENTS AND FINAL STABILIZATION REQUIREMENTS. I ACKNOWLEDGE THE RESPONSIBILITY TO DETERMINE WHETHER THE CONSTRUCTION ACTIVITIES ON THESE PLANS REQUIRE COLORADO DISCHARGE PERMIT SYSTEM (CDPS) PERMITTING FOR STORMWATER DISCHARGES ASSOCIATED WITH CONSTRUCTION ACTIVITY.

NAME OF CONTRACTOR: Miller Pipeline, LLC
 AUTHORIZED SIGNATURE: Randy Hiett DATE: 04/15/2024
 TITLE: General Manager
 EMAIL ADDRESS: Randy.Hiett@millerpipeline.com
 PHONE NUMBER: 719-325-9984 ADDRESS: 3170 Capital Drive-Colo. Spgs, CO 80939

ENGINEER'S STATEMENT: THIS GRADING AND EROSION CONTROL PLAN WAS PREPARED UNDER MY DIRECTION AND SUPERVISION AND IS CORRECT TO THE BEST OF MY KNOWLEDGE AND BELIEF. IF SUCH WORK IS PERFORMED IN ACCORDANCE WITH THE GRADING AND EROSION CONTROL PLAN, THE WORK WILL NOT BECOME A HAZARD TO LIFE AND LIMB, ENDANGER PROPERTY, OR ADVERSELY AFFECT THE SAFETY, USE, OR STABILITY OF A PUBLIC WAY, DRAINAGE CHANNEL, OR OTHER PROPERTY.

SIGNATURE: [Signature] DATE: 04/05/24
 PRINTED NAME: RAYMOND F. PEREZ SEAL: [Seal]

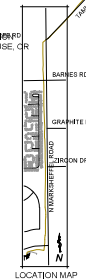

SITE MAP
Scale: N.T.S.



| SHEET INDEX | |
|-------------|-------------------------|
| T81 | COVERSHEET |
| GN1 | GENERAL NOTES |
| EC1-EC15 | EROSION CONTROL PLANS |
| DT1-DT2 | EROSION CONTROL DETAILS |

| (PROJECT RELATED INFORMATION) | |
|-------------------------------|---------|
| PARENT WORK ORDER NUMBER: | 3988813 |
| PROJECT NUMBER: | |
| FIMS MAP: | |
| SHEET NO.: | 1 OF 19 |
| REVISIONS: | |

Colorado Springs Utilities
It's how we're all connected

| | |
|--------------------|----------------|
| DESIGN BY: REP | DATE: 04/05/24 |
| APPROVED BY: | DATE: -- |
| SERVED BY: | DATE: -- |
| FIELD ENGINEER: | |
| WORK TYPE: CAPITAL | |
| ACTIVITY CODE: | |

GRADING, EROSION, AND SEDIMENT CONTROL
MARKSHEFFEL CONNECTOR
16IN HIGH PRESSURE MAIN

[INSERT TASK]

GENERAL NOTES

1. ANY LAND DISTURBANCE BY ANY OWNER, DEVELOPER, BALDWIN CONTRACTOR OR OTHER PERSON SHALL COMPLY WITH THE BASIC GRADING, EROSION AND STORMWATER QUALITY CONTROL, REQUIREMENTS AND GENERAL PROHIBITIONS NOTED IN THE DRAINAGE DISTRICT MANUAL, VOLUME 1.

2. NO CLEARING, GRADING, EXCAVATION, FILLING OR OTHER LAND DISTURBING ACTIVITIES SHALL BE PERMITTED UNTIL BIDDING AND ACCEPTANCE OF THE GRADING PLAN AND EROSION AND STORMWATER QUALITY CONTROL PLAN IS RECEIVED FROM CITY ENGINEER.

3. THE INSTALLATION OF ANY EARTH DISTURBANCE OPERATIONS TAKING PLACE, CALL CITY STORMWATER INSPECTIONS, 355-5980, 48 HOURS PRIOR TO CONSTRUCTION.

4. SEDIMENT (MUD AND DRILT) TRANSPORTED ONTO A PUBLIC ROAD, REGARDLESS OF THE SIZE OF THE SITE, SHALL BE CLEANED IMMEDIATELY.

5. CONCRETE WASH WATER SHALL NOT BE DISCHARGED OR ALLOWED TO RUNOFF TO STATE WATERS INCLUDING ANY SURFACE OR SUBSURFACE STORM DRAINAGE SYSTEM OR FACILITIES.

6. SOIL EROSION CONTROL MEASURES FOR ALL SLOPES, CHANNELS, DITCHES, OR ANY DISTURBED LAND AREA SHALL BE COMPLETED WITHIN TWENTY (20) CALENDAR DAYS AFTER FINAL GRADING OR FINAL EARTH COVERING IS COMPLETED. MEASURES SHALL ALSO BE MAINTAINED WITHIN 21 DAYS AFTER INTERIM GRADING, AN AREA THAT IS GOING TO REMAIN IN AN INTERIM STATE FOR MORE THAN 60 DAYS SHALL ALSO BE SEEDED. ALL TEMPORARY SOIL EROSION CONTROL MEASURES AND BMP'S SHALL BE MAINTAINED UNTIL PERMANENT SOIL EROSION CONTROL MEASURES ARE IMPLEMENTED.

7. THE GRADING AND EROSION CONTROL PLAN WILL BE SUBJECT TO RE-REVIEW AND RE-ACCEPTANCE BY THE CITY OF COLORADO. THE GRADING AND EROSION CONTROL PLAN SHALL BE SUBJECT TO RE-REVIEW AND RE-ACCEPTANCE BY THE CITY OF COLORADO WITHIN 10 MONTHS OF THE CITY ENGINEER'S ACCEPTANCE OF THE PLAN. A CHANGE IN PROPERTY OWNERSHIP PROPOSED DEVELOPMENT CHANGES OR PROPOSED GRADING REVISIONS.

8. THE APPLICANT SHALL NOT CHANGE THE BERTH'S COVER, OR ACCESS TO UTILITY (WATER, GAS, ETC.) AS A RESULT OF THIS PLAN. ANY CHANGES MUST BE OBTAINED FROM THE APPROPRIATE UTILITY COMPANY. IT IS NOT PERMISSIBLE FOR ANY PERSON TO MODIFY THE GRADE OF THE EARTH OR ANY CONCRETE OR METAL STRUCTURES OR UTILITIES EXISTING ON OR ADJACENT TO THE PROPERTY WITHOUT THE WRITTEN APPROVAL OF THE CITY ENGINEER. THE PLAN MUST BE APPROVED BY THE AFFECTED UTILITY OWNER PRIOR TO IMPLEMENTING THE PLAN. THE COST TO RELOCATE OR PROTECT EXISTING UTILITIES OR TO PROVIDE INTERIM ACCESS IS THE APPLICANT'S RESPONSIBILITY.

9. ACCORDING TO FEMA FLOOD INSURANCE RATE MAP 080410077F AND 080410251F EFFECTIVE MARCH 11, 1997, THERE IS NO FLOODPLAIN WITHIN THE PROJECT LIMITS.

10. STOCKPILE AND TEMPORARY DISPOSAL AREA LOCATIONS WILL BE DETERMINED BY CONTRACTOR.

11. STABILIZED STAGING AREA TO BE OFF-SITE.

12. PROPOSED TOPOGRAPHY IS EQUAL TO EXISTING TOPOGRAPHY.

13. ANTICIPATED STARTING AND COMPLETION TIME PERIOD OF SITE GRADING.

DATE: 05/20/23
END: 05/20/23

EXPECTED DATE ON WHICH THE FINAL STABILIZATION WILL BE COMPLETE

TOTAL AREA OF THE SITE TO BE CLEARED, EXCAVATED OR GRADED

TOTAL AREA TO BE DISTURBED: 20 ACRES

NAME OF RECEIVING WATERS:

SOILS INFORMATION:

TRUCKTON SANDY LOAM 3 TO 9 PERCENT SLOPES

HYDROLOGIC SOIL GROUP A

BLACKLAND LOAMY SAND, 1 TO 3 PERCENT SLOPES

HYDROLOGIC SOIL GROUP A

BLEON SANDY LOAM 0 TO 3 PERCENT SLOPES

HYDROLOGIC SOIL GROUP B

ALL UTILITIES ARE WITHIN PUBLIC RIGHT-OF-WAY

14. ADJACENT PROPERTIES ARE NOT ANTICIPATED TO BE AFFECTED BY THIS CONSTRUCTION.

15. NO GEOLOGIC-HAZARD STUDY REVIEW WAS COMPLETED TO DETERMINE THERE ARE NO AREAS IDENTIFIED AS "NO-BUILD AREAS".

STANDARD GEC PLAN NOTES

1. NO CLEARING, GRADING, EXCAVATION OR OTHER LAND DISTURBING ACTIVITIES SHALL BE ALLOWED (EXCEPT FOR WORK DIRECTLY RELATED TO THE INSTALLATION OF INITIAL CONTROL MEASURES) UNTIL A CITY GEC PERMIT HAS BEEN ISSUED.

2. ALL LAND DISTURBING ACTIVITIES MUST BE PERFORMED IN ACCORDANCE WITH AND THE APPROVED GEC PLAN AND INITIAL SITE INSPECTION MEASURES SHALL BE INSTALLED AND INSPECTED PRIOR TO ANY LAND DISTURBING ACTIVITIES TAKING PLACE. AN INITIAL SITE INSPECTION WILL NOT BE SCHEDULED UNTIL A CITY GEC PERMIT HAS BEEN CONDITIONALLY APPROVED. CALL CITY STORMWATER INSPECTIONS, 355-5980, AT LEAST 48 HOURS PRIOR TO CONSTRUCTION TO SCHEDULE AN INITIAL INSPECTION AND OBTAIN A CITY GEC PERMIT.

3. CONCRETE WASH WATER SHALL NOT BE DISCHARGED TO OR ALLOWED TO RUNOFF TO STATE WATERS OR ANY SURFACE OR SUBSURFACE STORM DRAINAGE SYSTEM OR FACILITIES.

4. BUILDING, CONSTRUCTION, EXCAVATION, OR OTHER WASTE MATERIALS SHALL NOT BE TEMPORARILY PLACED OR STORED IN THE INTERIM STATE FOR MORE THAN 60 DAYS. ALL AREAS SHALL ALSO BE SEEDED. ALL TEMPORARY SOIL EROSION CONTROL MEASURES AND BMP'S SHALL BE MAINTAINED UNTIL PERMANENT SOIL EROSION CONTROL MEASURES ARE IMPLEMENTED.

5. ALL WASTES COMPOSED OF BUILDING MATERIALS MUST BE REMOVED FROM THE CONSTRUCTION SITE FOR DISPOSAL IN AN INTERIM STATE FOR MORE THAN 60 DAYS SHALL ALSO BE SEEDED. ALL TEMPORARY SOIL EROSION CONTROL MEASURES AND BMP'S SHALL BE MAINTAINED UNTIL PERMANENT SOIL EROSION CONTROL MEASURES ARE IMPLEMENTED.

6. THE PERMITTEE SHALL BE RESPONSIBLE FOR THE REMOVAL OF ALL CONSTRUCTION DEBRIS, DIRT, TRASH, ROCK, SEWER, AND MATERIALS SHALL BE BURIED, DUMPED, OR DISCHARGED AT THE SITE.

7. THE PERMITTEE SHALL BE RESPONSIBLE FOR THE REMOVAL OF ALL CONSTRUCTION DEBRIS, DIRT, TRASH, ROCK, SEWER, AND MATERIALS SHALL BE BURIED, DUMPED, OR DISCHARGED AT THE SITE.

8. THE QUANTITY OF MATERIALS STORED ON THE PROJECT SITE SHALL BE LIMITED AS MUCH AS PRACTICAL, TO THAT QUANTITY NECESSARY FOR THE CONSTRUCTION OF THE PROJECT. ALL MATERIALS SHALL BE STORED IN A LOCATION WHERE THEY MAY BE CARRIED BY STORMWATER RUNOFF INTO THE STORM SEWER SYSTEM AT ANY TIME.

9. ALL PREVENTION AND CONTAINMENT MEASURES SHALL BE USED AT ALL STORAGE, EQUIPMENT FUELING, AND EQUIPMENT MAINTENANCE AREAS. ALL STORAGE, EQUIPMENT FUELING, AND EQUIPMENT MAINTENANCE AREAS SHALL BE PROTECTED BY CURBS, DITCHES, OR OTHER MEASURES TO PREVENT FUEL, OIL, AND OTHER CHEMICALS FROM ENTERING THE STORM DRAINAGE SYSTEM OR FACILITY. BULK STORAGE STRUCTURES FOR PETROLEUM PRODUCTS AND OTHER CHEMICALS SHALL HAVE SECONDARY CONTAINMENT OR EQUIVALENT ADEQUATE PROTECTION. ALL SPILLS SHALL BE CLEANED UP IMMEDIATELY. METHODS FOR SPILL CLEANUP SHALL BE FOLLOWED ALONG WITH PROPER DISPOSAL METHODS.

10. SEDIMENT (MUD AND DRILT) TRANSPORTED ONTO A PUBLIC ROAD, REGARDLESS OF THE SIZE OF THE SITE, SHALL BE CLEANED AS SOON AS POSSIBLE AFTER DISCOVERY.

11. NO CHEMICALS ARE TO BE ADDED TO THE DISCHARGE UNLESS PERMISSION FOR THE USE OF A SPECIFIC CHEMICAL IS GRANTED BY THE STATE IN GRANTING THE USE OF SUCH CHEMICALS. SPECIAL CONDITIONS AND MONITORING MAY BE REQUIRED.

12. MEASURES FOR ALL SUPPLIES, MATERIALS, DEVICES, OR ANY OTHER MATERIALS SHALL BE COVERED WITHIN FOURTEEN (14) CALENDAR DAYS AFTER FINAL GRADING OR FINAL LAND DISTURBANCE HAS BEEN COMPLETED. DISTURBED AREAS WHICH ARE NOT AT FINAL GRADE BUT WILL REMAIN CORRECT FOR LONGER THAN FOURTEEN (14) DAYS SHALL BE RESEEDING, MULCHED, OR COVERED WITHIN TWENTY (20) CALENDAR DAYS. ALL AREAS SHALL ALSO BE SEEDED, UNLESS AN ALTERNATIVE STABILIZATION MEASURE IS APPROVED BY THE CITY ENGINEER. THE COST TO RELOCATE OR PROTECT EXISTING UTILITIES OR TO PROVIDE INTERIM ACCESS SHALL BE AT THE APPLICANT'S EXPENSE.

13. THE GEC PLAN SHALL BE SUBJECT TO RE-REVIEW AND RE-ACCEPTANCE BY THE CITY ENGINEER. THE CONTRACTOR SHALL MARK THE LOCATION ON THE CONSTRUCTION SITE BEFORE COMMENCEMENT WITHIN TWELVE (12) MONTHS OF THE CITY'S ACCEPTANCE OF THE PLAN. THE CONTRACTOR SHALL BE RESPONSIBLE FOR THE RE-REVIEW AND RE-ACCEPTANCE OF THE PLAN. A CHANGE IN PROPERTY OWNERSHIP PROPOSED DEVELOPMENT CHANGES OR PROPOSED GRADING REVISIONS.

14. IT IS NOT PERMISSIBLE FOR ANY PERSON TO MODIFY THE GRADE OF THE EARTH OR ANY UTILITY EASEMENT OR UTILITY RIGHT-OF-WAY WITHOUT WRITTEN APPROVAL FROM THE UTILITY OWNER. CITY ACCEPTANCE OF THE GEC PLAN AND CSMP DOES NOT CONSTITUTE AN ENDORSEMENT OF THE PLAN OR A GUARANTEE OF THE ACCURACY OF THE PLAN. THE CITY ENGINEER SHALL NOT BE RESPONSIBLE FOR ANY DAMAGE TO EXISTING UTILITY FACILITIES TO ACCOMMODATE THE PLAN. THE PLAN MUST BE APPROVED BY THE AFFECTED UTILITY OWNER PRIOR TO IMPLEMENTING THE PLAN. THE COST TO RELOCATE OR PROTECT EXISTING UTILITIES OR TO PROVIDE INTERIM ACCESS SHALL BE AT THE APPLICANT'S EXPENSE.

15. ALL GEC PERMITTERS AND WARRANTS THAT THEY HAVE THE LEGAL AUTHORITY TO GRADE AND/OR CONSTRUCT ADJACENT PROPERTY. AN APPROVED GEC PERMIT DOES NOT PROVIDE APPROVAL FOR THE APPLICANT TO MODIFY ADJACENT PROPERTY.

16. THE CONTRACTOR SHALL BE RESPONSIBLE FOR OBTAINING ALL NECESSARY PERMITS AND SHALL BE RESPONSIBLE FOR THE COST OF ALL PERMITS. THE CONTRACTOR SHALL BE RESPONSIBLE FOR OBTAINING ALL NECESSARY PERMITS AND SHALL BE RESPONSIBLE FOR THE COST OF ALL PERMITS.

17. THE CONTRACTOR SHALL BE RESPONSIBLE FOR OBTAINING ALL NECESSARY PERMITS AND SHALL BE RESPONSIBLE FOR THE COST OF ALL PERMITS. THE CONTRACTOR SHALL BE RESPONSIBLE FOR OBTAINING ALL NECESSARY PERMITS AND SHALL BE RESPONSIBLE FOR THE COST OF ALL PERMITS.

18. THE CONTRACTOR SHALL BE RESPONSIBLE FOR OBTAINING ALL NECESSARY PERMITS AND SHALL BE RESPONSIBLE FOR THE COST OF ALL PERMITS. THE CONTRACTOR SHALL BE RESPONSIBLE FOR OBTAINING ALL NECESSARY PERMITS AND SHALL BE RESPONSIBLE FOR THE COST OF ALL PERMITS.

19. THE CONTRACTOR SHALL BE RESPONSIBLE FOR OBTAINING ALL NECESSARY PERMITS AND SHALL BE RESPONSIBLE FOR THE COST OF ALL PERMITS. THE CONTRACTOR SHALL BE RESPONSIBLE FOR OBTAINING ALL NECESSARY PERMITS AND SHALL BE RESPONSIBLE FOR THE COST OF ALL PERMITS.

QUANTITIES

| ITEM | UNIT | AMOUNT | REMARKS |
|----------------------|------|--------|--------------------------------------|
| ROOF SLOPE | EA | 50 | (ROOF SLOPES WILL BE RE-CURED DAILY) |
| SEEDING AND MULCHING | AC | 3.54 | |
| PAINT PROTECTION | EA | 1.0 | |

THIS PROJECT IS DEEMED FROM ASSURANCES.

LEGEND

- AS-BUILT TIP GAS MAIN
- AS-BUILT GAS MAIN
- EXISTING TIP GAS MAIN
- EXISTING GAS MAIN
- EXISTING GAS SERVICE
- GAS LINE TO BE ABANDONED
- GAS LIGHT
- GAS VALVE
- EXCESS FLOW VALVE
- RELIEF VALVE
- COUPLINGS
- BOND OVER
- TEST POINT
- INSULATOR
- REGULATOR STATION
- MONITORS
- ANCHOR
- SOCK
- METER SET ASSEMBLY
- BRANCH OFF LINE STOPPER
- PROPOSED TIP GAS MAIN
- PROPOSED GAS SERVICE
- PROPOSED CONCRETE GROUND
- EXISTING EASEMENT
- PROPOSED EASEMENT
- ROW LINE
- PROPERTY LINE
- STREET CENTERLINE
- EDGE OF PAVEMENT
- CONCRETE TRENCH
- CABLE LINE - UNDERGROUND
- ELECTRIC - OVERHEAD
- FIBER OPTIC - UNDERGROUND
- PHONE - OVERHEAD
- PHONE - UNDERGROUND
- RECLAIMED WATER
- SEWER
- STORMWATER
- PROPOSED STORMWATER
- WATER
- FENCE LINE
- UTILITY FEEDBACKS
- FIRE HYDRANT
- MANHOLE
- WATER VALVE
- SURVEY MONUMENT
- POWER POLE
- TRAFFIC SIGNAL
- GAS FLOW ARROW

AS-BUILT TIP GAS MAIN

AS-BUILT GAS MAIN

EXISTING TIP GAS MAIN

EXISTING GAS MAIN

EXISTING GAS SERVICE

GAS LINE TO BE ABANDONED

GAS LIGHT

GAS VALVE

EXCESS FLOW VALVE

RELIEF VALVE

COUPLINGS

BOND OVER

TEST POINT

INSULATOR

REGULATOR STATION

MONITORS

ANCHOR

SOCK

METER SET ASSEMBLY

BRANCH OFF LINE STOPPER

PROPOSED TIP GAS MAIN

PROPOSED GAS SERVICE

PROPOSED CONCRETE GROUND

EXISTING EASEMENT

PROPOSED EASEMENT

ROW LINE

PROPERTY LINE

STREET CENTERLINE

EDGE OF PAVEMENT

CONCRETE TRENCH

CABLE LINE - UNDERGROUND

ELECTRIC - OVERHEAD

FIBER OPTIC - UNDERGROUND

PHONE - OVERHEAD

PHONE - UNDERGROUND

RECLAIMED WATER

SEWER

STORMWATER

PROPOSED STORMWATER

WATER

FENCE LINE

UTILITY FEEDBACKS

FIRE HYDRANT

MANHOLE

WATER VALVE

SURVEY MONUMENT

POWER POLE

TRAFFIC SIGNAL

GAS FLOW ARROW

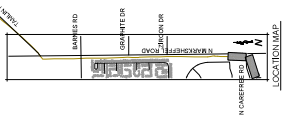
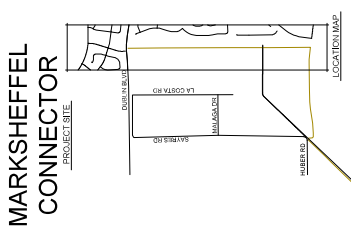
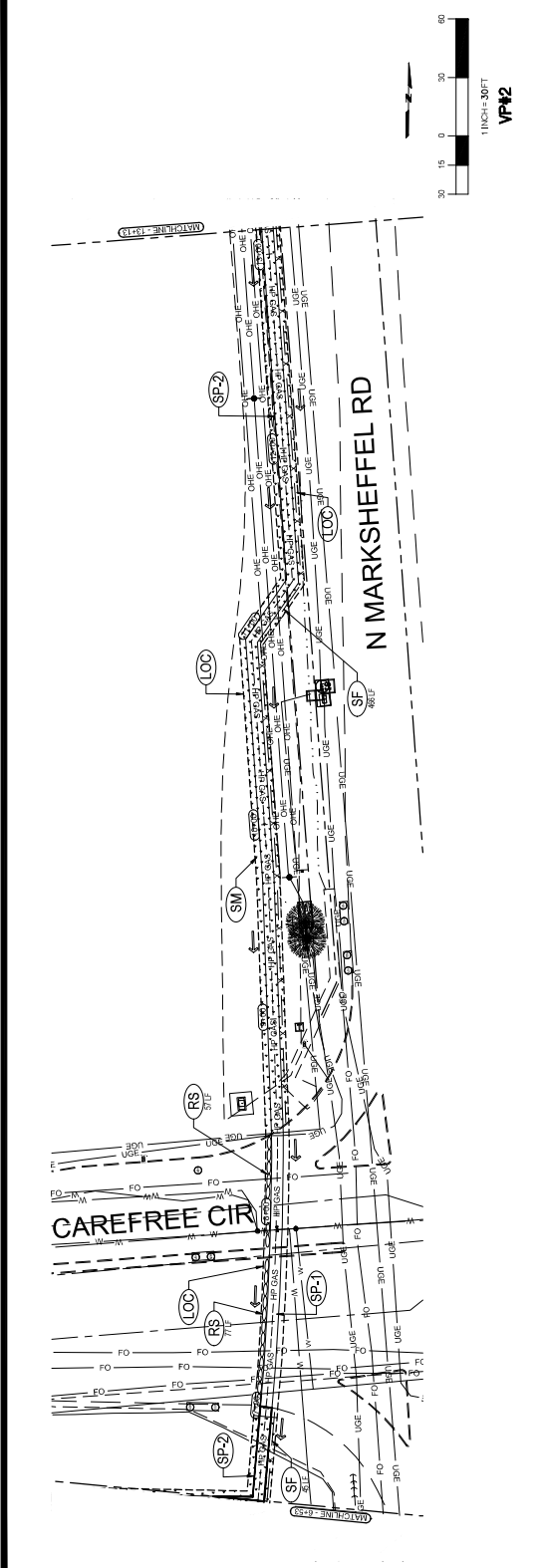
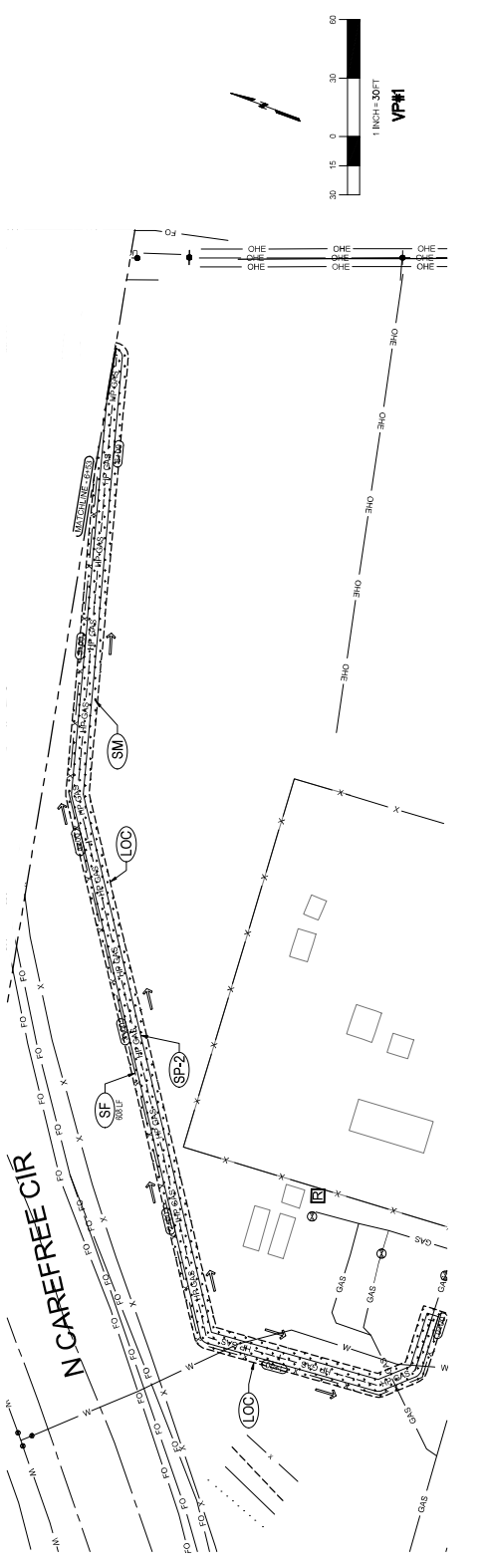

LEGEND

| | | | |
|-----|--|-----|-------------------------|
| --- | EXISTING ROW/PROPERTY LINE | --- | EXISTING SANITARY SEWER |
| --- | EXISTING CURB LINE | --- | EXISTING WATER |
| --- | SEEDING AND MULCHING | --- | SILT FENCE |
| --- | MATERIALS STAGING | --- | SOIL DISTURBANCE AREA |
| --- | ROCK SOCK | --- | EXISTING FLOW DIRECTION |
| --- | LIMITS OF CONSTRUCTION/LIMITS OF DISTURBANCE | --- | |
| --- | INLET PROTECTION | --- | |

(PROJECT RELATED INFORMATION)

| |
|----------------------------------|
| PARENT WORK ORDER NUMBER: 398813 |
| PROJECT NUMBER: |
| DATE: 03/27/24 |
| DESIGN BY: REP |
| CHECKED BY: --- |
| DATE: --- |
| SKETCHED BY: --- |
| DATE: --- |
| FIELD ENGINEER: --- |
| DATE: --- |
| WORK TYPE: CAPITAL |
| ACTIVITY CODE: --- |

REVISIONS:

| | |
|-----|-------------|
| NO. | DESCRIPTION |
| | |
| | |

Colorado Springs Utilities
It's how we do it

GRADING, EROSION, AND SEDIMENT CONTROL
 MARKSHEFFEL CONNECTOR
 16IN HIGH PRESSURE MAIN

INSERT TASKI

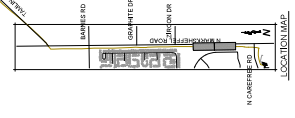
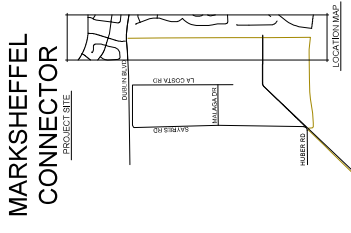
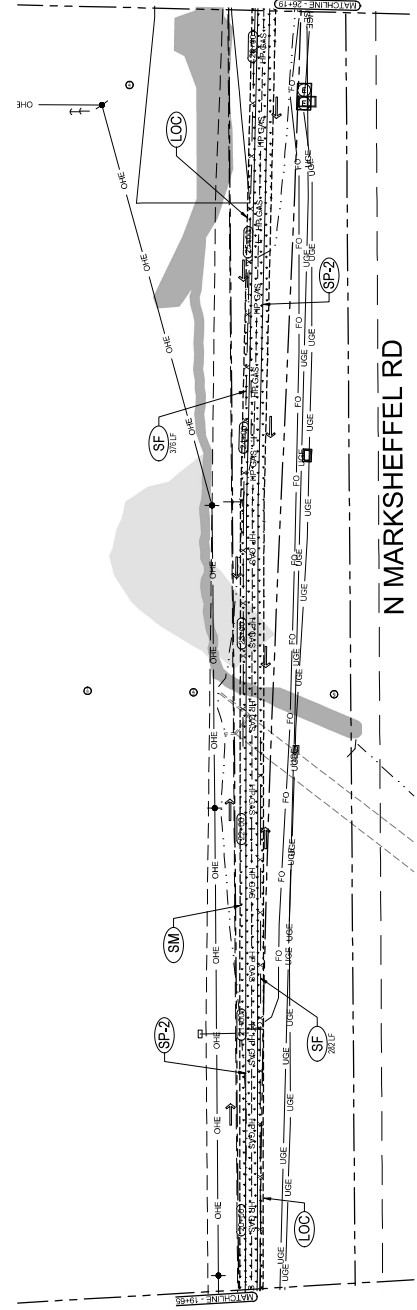
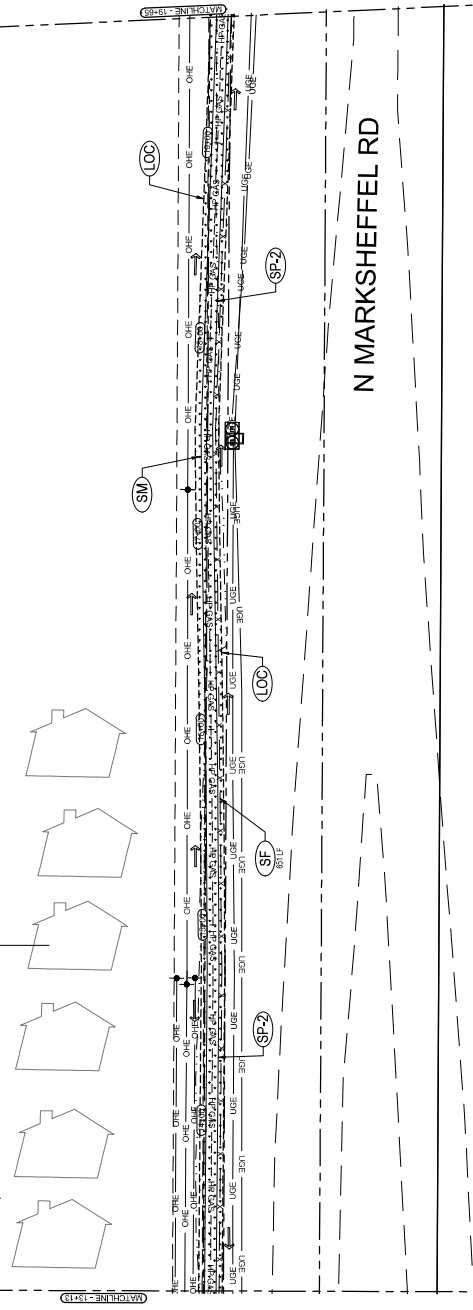

LEGEND

| | | | |
|-----|--|-----|-------------------------|
| --- | EXISTING ROW/PROPERTY LINE | --- | EXISTING SANITARY SEWER |
| --- | EXISTING CURB LINE | --- | EXISTING WATER |
| --- | SEEDING AND MULCHING | --- | SILT FENCE |
| --- | MATERIALS STAGING | --- | SOIL DISTURBANCE AREA |
| --- | ROCK SOCK | --- | EXISTING FLOW DIRECTION |
| --- | LIMITS OF CONSTRUCTION/LIMITS OF DISTURBANCE | --- | |
| --- | INLET PROTECTION | | |

(PROJECT RELATED INFORMATION)

| |
|----------------------------------|
| PARENT WORK ORDER NUMBER: 398813 |
| PROJECT NUMBER: |
| FINIS MAP: |
| SHEET NO. 4 OF 19 |

REVISIONS:

| | |
|--------------------|----------------|
| DESIGN BY: REP | DATE: 03/27/24 |
| SKETCHED BY: | DATE: -- |
| FIELD ENGINEER: | DATE: -- |
| WORK TYPE: CAPITAL | |
| ACTIVITY CODE: | |

Colorado Springs Utilities
It's how we're all connected

GRADING, EROSION, AND SEDIMENT CONTROL
MARKSHEFFEL CONNECTOR
16IN HIGH PRESSURE MAIN

INSERT TASKI

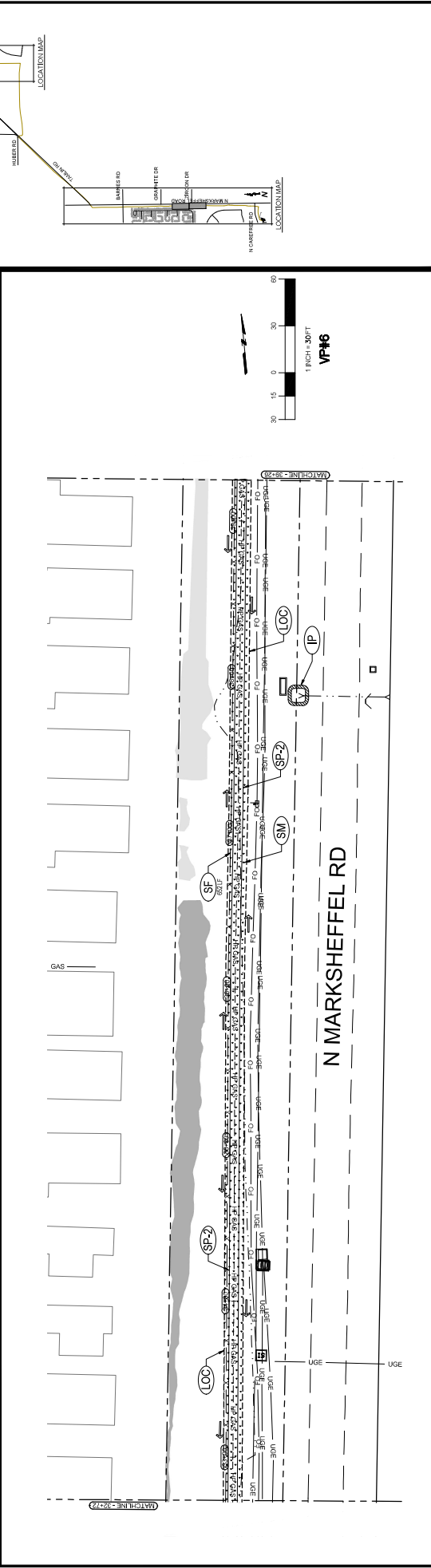
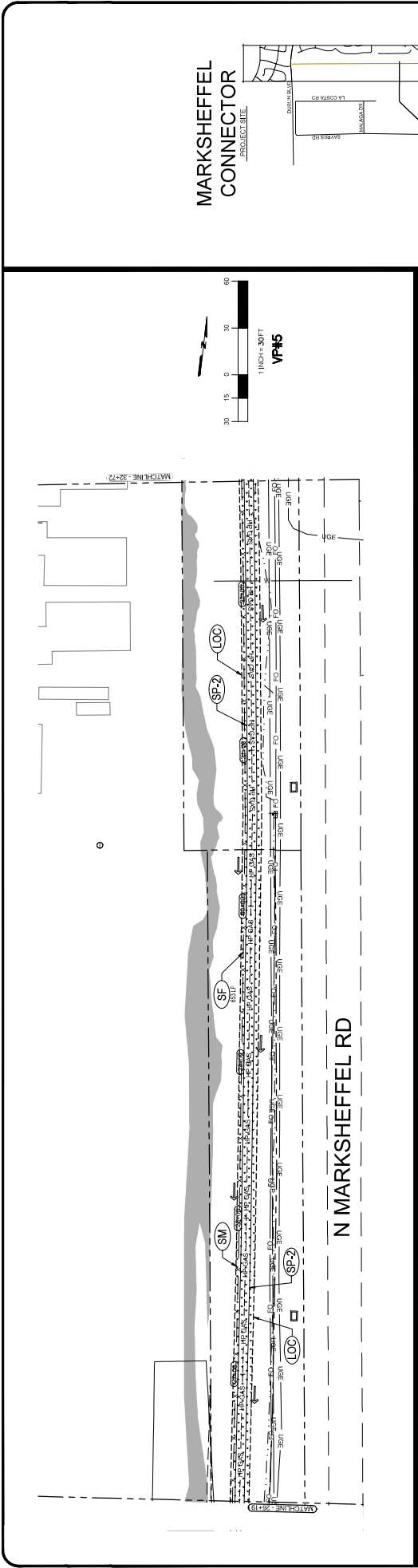

DESIGN BY: REP
 CHECKED BY: [blank]
 DRAWN BY: [blank]
 DATE: 03/27/24
 SHEET NO. 5 OF 19
 WORK TYPE: CAPITAL
 ACTIVITY CODE: [blank]

GRADING, EROSION, AND SEDIMENT CONTROL
MARKSHEFFEL CONNECTOR
16IN HIGH PRESSURE MAIN

INSERT TASKI

LEGEND

- EXISTING ROW/PROPERTY LINE
- EXISTING CURB LINE
- SEEDING AND MULCHING
- MATERIALS STAGING
- ROCK SOCK
- LIMITS OF CONSTRUCTION/LIMITS OF DISTURBANCE
- INLET PROTECTION
- EXISTING SANITARY SEWER
- EXISTING WATER
- EXISTING SILT FENCE
- SOIL DISTURBANCE AREA
- EXISTING FLOW DIRECTION

(PROJECT RELATED INFORMATION)

PARENT WORK ORDER NUMBER: 3988813
 PROJECT NUMBER:
 PINS MAP:
 SHEET NO. 5 OF 19

REVISIONS:

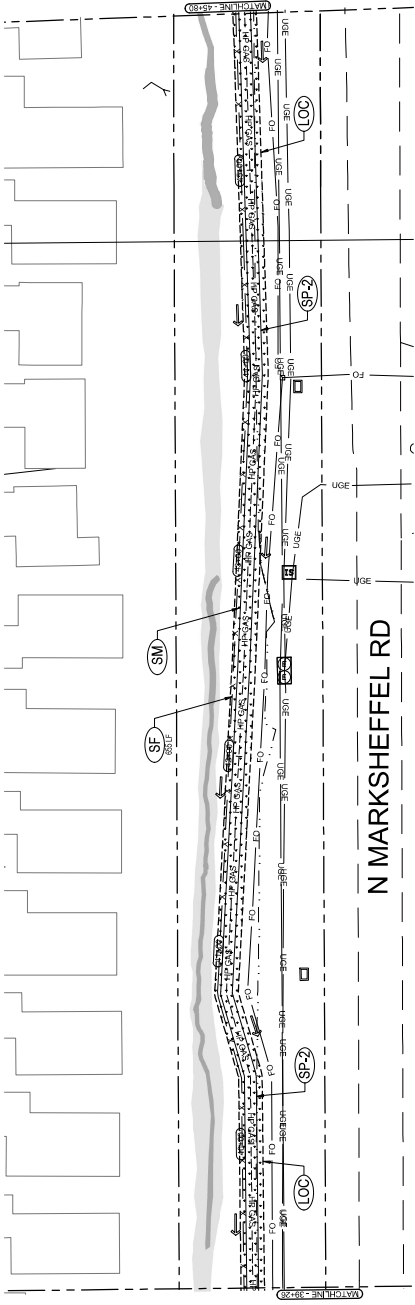

MARKSHEFFEL CONNECTOR PROJECT SITE

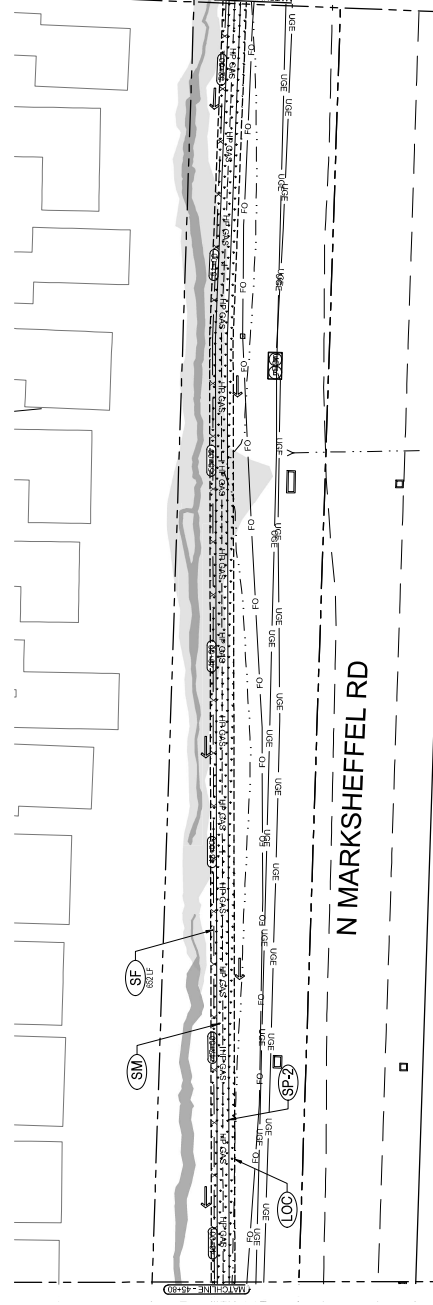
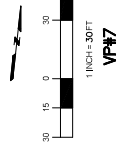
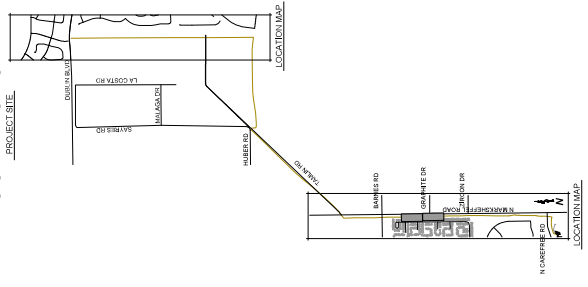

LEGEND

| | | | |
|--|--|--|-------------------------|
| | EXISTING ROW/PROPERTY LINE | | EXISTING SANITARY SEWER |
| | EXISTING CURB LINE | | EXISTING WATER |
| | SEEDING AND MULCHING | | SOIL DISTURBANCE AREA |
| | MATERIALS STAGING | | EXISTING FLOW DIRECTION |
| | ROCK SOCK | | |
| | LIMITS OF CONSTRUCTION/LIMITS OF DISTURBANCE | | |
| | INLET PROTECTION | | |

LEGEND

| | |
|--|-------------------------|
| | EXISTING SANITARY SEWER |
| | EXISTING WATER |
| | SOIL DISTURBANCE AREA |
| | EXISTING FLOW DIRECTION |

(PROJECT RELATED INFORMATION)

| |
|-----------------------------------|
| PARENT WORK ORDER NUMBER: 3988813 |
| PROJECT NUMBER: |
| FINIS MAP: |
| SHEET NO. 6 OF 19 |

Colorado Springs Utilities
It's how we're all connected!

| | |
|--------------------|----------------|
| DESIGN BY: REP | DATE: 03/27/24 |
| SKETCHED BY: | DATE: -- |
| FIELD ENGINEER: | DATE: -- |
| WORK TYPE: CAPITAL | |
| ACTIVITY CODE: | |

**GRADING, EROSION, AND SEDIMENT CONTROL
MARKSHEFFEL CONNECTOR
16IN HIGH PRESSURE MAIN**

INSERT TASK!

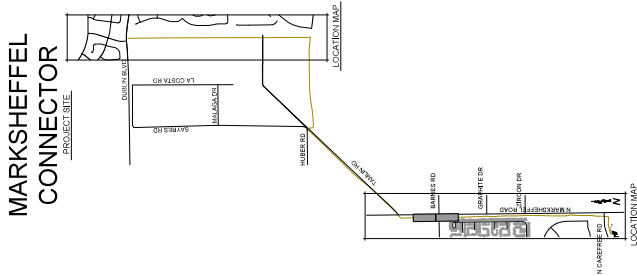
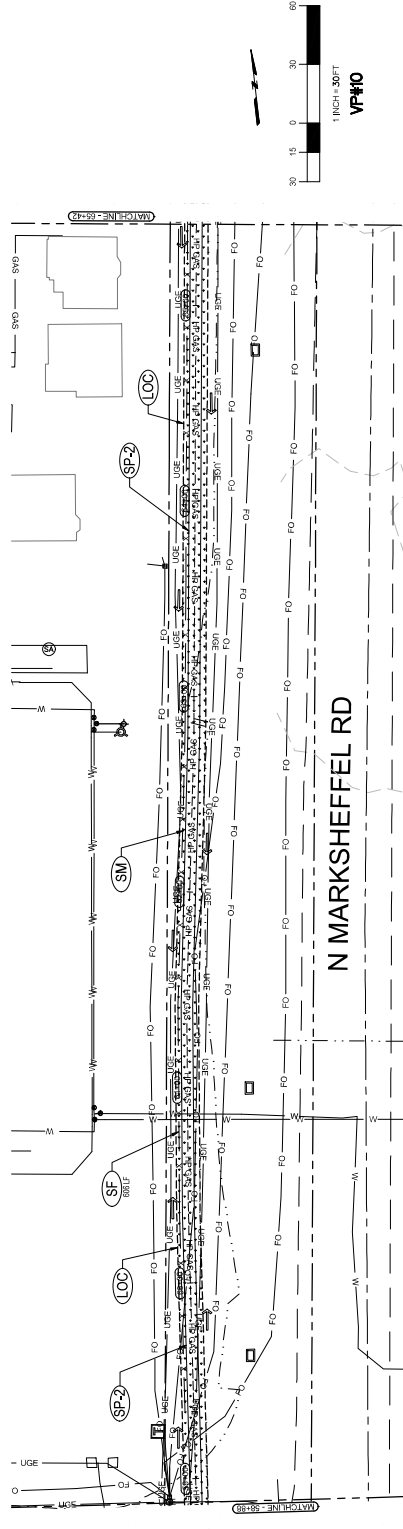
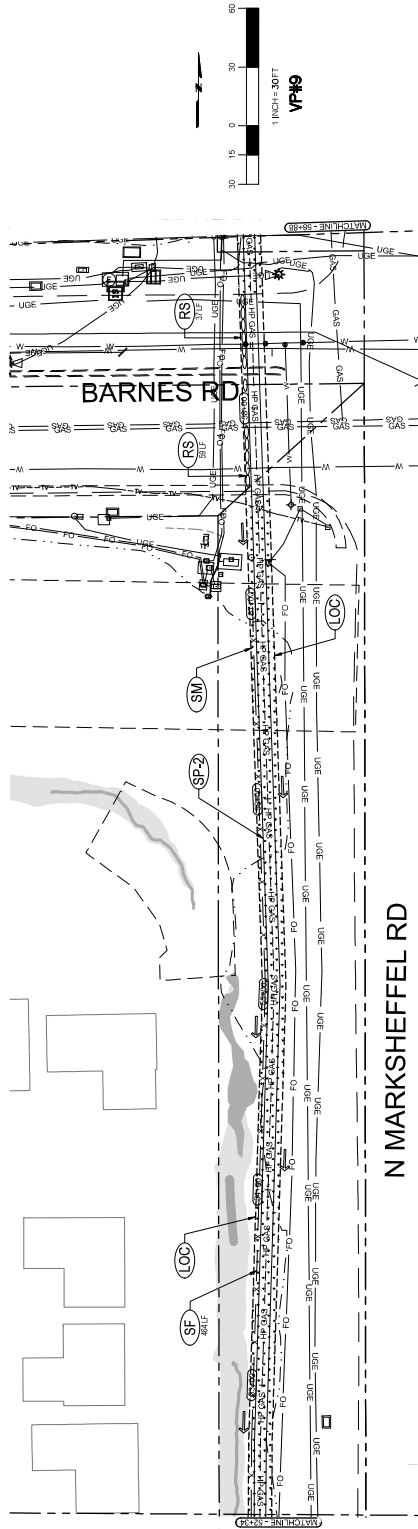

LEGEND

| | | | |
|-----|--|---|-------------------------|
| --- | EXISTING ROW/PROPERTY LINE | ⊙ | EXISTING SANITARY SEWER |
| --- | EXISTING CURB LINE | ⊙ | EXISTING WATER |
| --- | SEEDING AND MULCHING | ⊙ | SILT FENCE |
| --- | MATERIALS STAGING | ⊙ | SOIL DISTURBANCE AREA |
| --- | ROCK SOCK | ⊙ | EXISTING FLOW DIRECTION |
| --- | LIMITS OF CONSTRUCTION/LIMITS OF DISTURBANCE | ⊙ | |
| --- | INLET PROTECTION | ⊙ | |

(PROJECT RELATED INFORMATION)

| |
|----------------------------------|
| PARENT WORK ORDER NUMBER: 398813 |
| PROJECT NUMBER: |
| FINIS MAP: |
| SHEET NO. 7 OF 19 |

DESIGN BY: REP
 DRAWN BY: S
 CHECKED BY: S
 FIELD ENGINEER: S
 WORK TYPE: CAPITAL
 AGENCY CODE:

Colorado Springs Utilities
It's how we're all connected!

DATE: 03/27/24

GRADING, EROSION, AND SEDIMENT CONTROL
MARKSHEFFEL CONNECTOR
16IN HIGH PRESSURE MAIN

INSERT TASK!

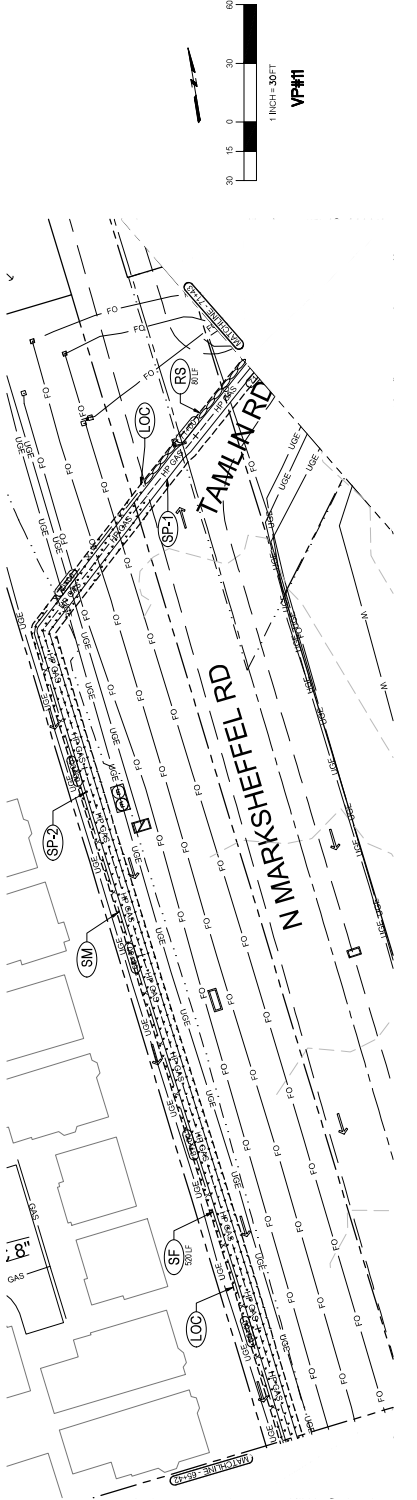

MARKSHEFFEL CONNECTOR PROJECT SITE

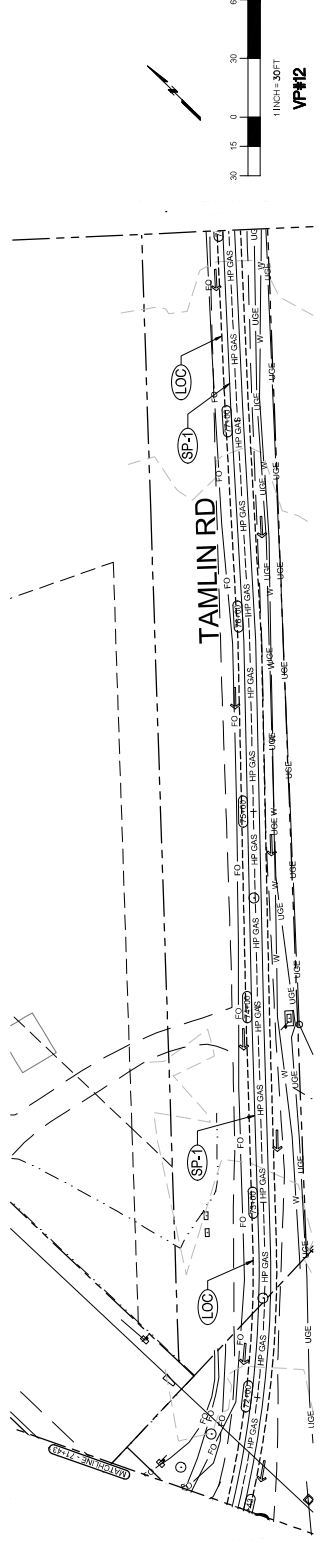
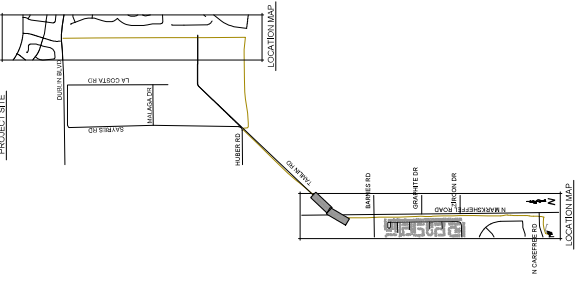

LEGEND

| | | | |
|-----|--|-----|-------------------------|
| --- | EXISTING ROW/PROPERTY LINE | --- | EXISTING SANITARY SEWER |
| --- | EXISTING CURB LINE | --- | EXISTING WATER |
| --- | SEEDING AND MULCHING | --- | SILT FENCE |
| --- | MATERIALS STAGING | --- | SOIL DISTURBANCE AREA |
| --- | ROCK SOCK | --- | EXISTING FLOW DIRECTION |
| --- | LIMITS OF CONSTRUCTION/LIMITS OF DISTURBANCE | | |
| --- | INLET PROTECTION | | |

(PROJECT RELATED INFORMATION)

| |
|----------------------------------|
| PARENT WORK ORDER NUMBER: 398813 |
| PROJECT NUMBER: |
| FINIS MAP: |
| SHEET NO. 8 OF 19 |
| DESIGN BY: REP |
| DRAWN BY: [REDACTED] |
| CHECKED BY: [REDACTED] |
| DATE: 03/27/24 |
| DATE: --- |
| DATE: --- |
| FIELD ENGINEER: |
| WORK TYPE: CAPITAL |
| ACTIVITY CODE: |
| REVISIONS: |

Colorado Springs Utilities
It's how we're all connected!

GRADING, EROSION, AND SEDIMENT CONTROL
MARKSHEFFEL CONNECTOR
16IN HIGH PRESSURE MAIN

INSERT TASK!

MARKSHEFFEL CONNECTOR

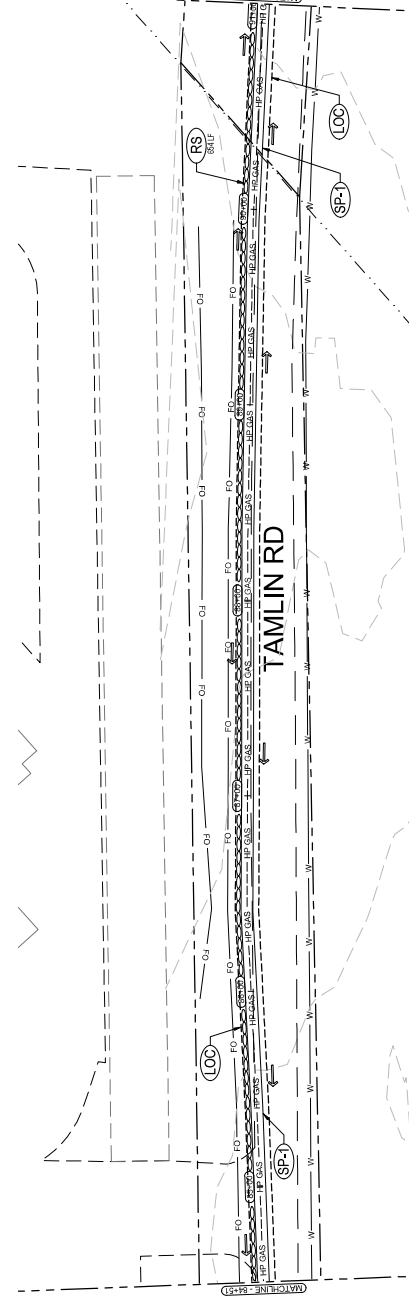
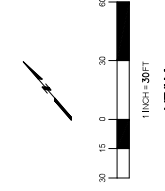
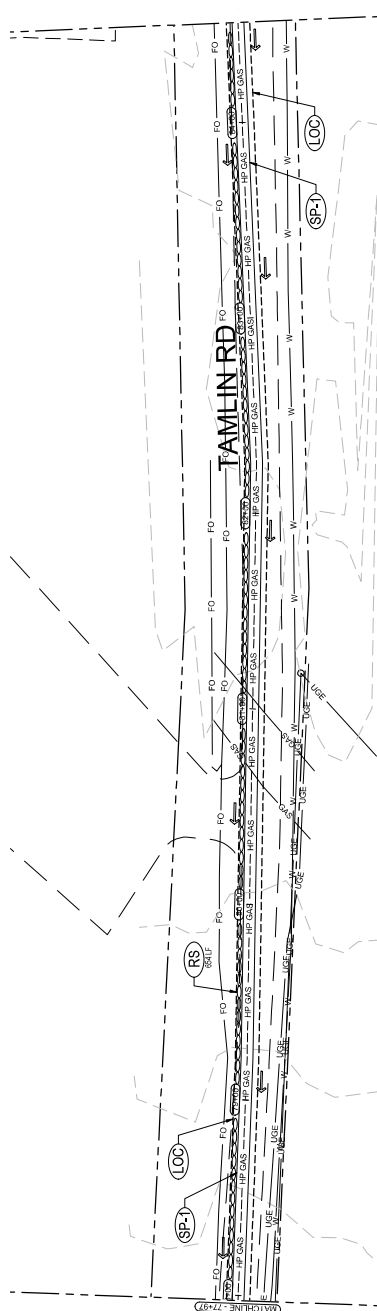
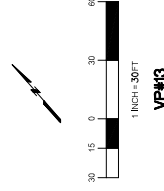
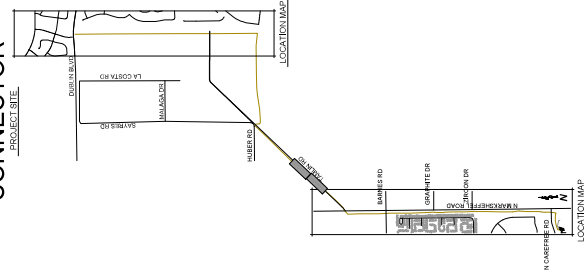

LEGEND

| | | | |
|-----|--|-----|-------------------------|
| --- | EXISTING ROW/PROPERTY LINE | --- | EXISTING SANITARY SEWER |
| --- | EXISTING CURB LINE | --- | EXISTING WATER |
| --- | SEEDING AND MULCHING | --- | EXISTING FLOW DIRECTION |
| --- | MATERIALS STAGING | --- | SOIL DISTURBANCE AREA |
| --- | ROCK SOCK | --- | EXISTING FLOW DIRECTION |
| --- | LIMITS OF CONSTRUCTION/LIMITS OF DISTURBANCE | --- | |
| --- | INLET PROTECTION | --- | |

REVISIONS:

| | |
|-----|-------------|
| NO. | DESCRIPTION |
| | |
| | |

(PROJECT RELATED INFORMATION)

| | |
|---------------------------|---------|
| PARENT WORK ORDER NUMBER: | 398813 |
| PROJECT NUMBER: | |
| FINIS MAP: | |
| SHEET NO. | 9 OF 19 |

Colorado Springs Utilities
It's how we're all connected

DESIGN BY: REP
CHECKED BY: [Signature]
DATE: 03/27/24

FIELD ENGINEER: [Signature]
WORK TYPE: CAPITAL
ACTIVITY CODE: []

GRADING, EROSION, AND SEDIMENT CONTROL
MARKSHEFFEL CONNECTOR
16IN HIGH PRESSURE MAIN

INSERT TASKI

MARKSHEFFEL CONNECTOR

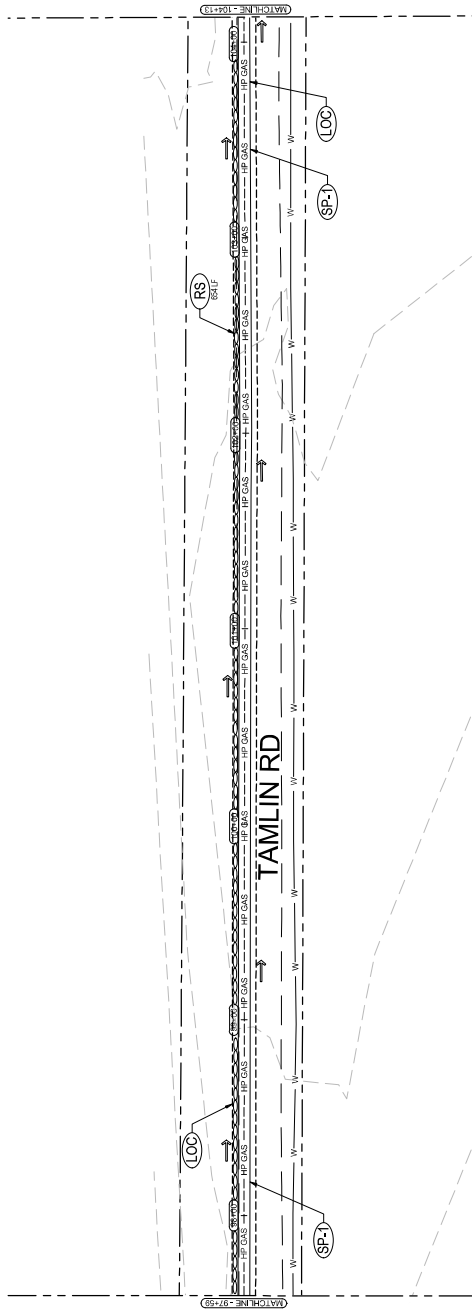
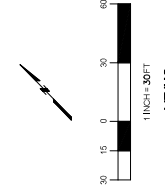
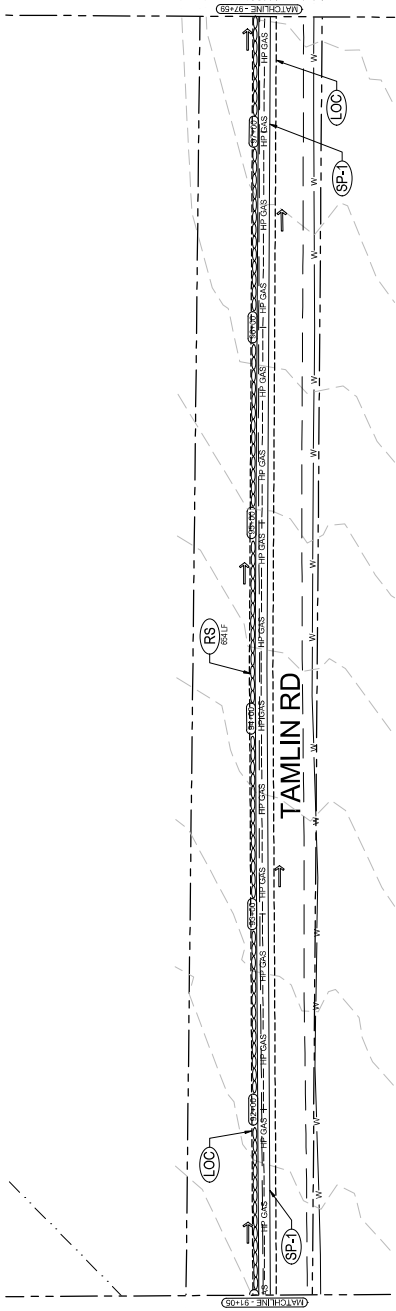
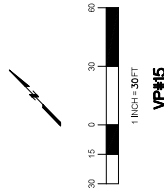
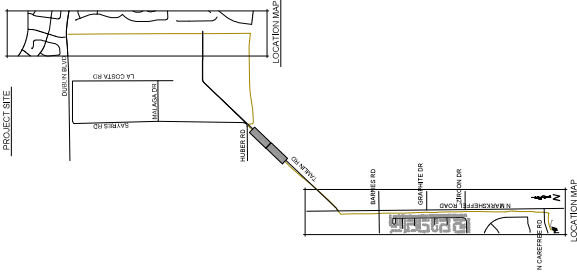

| | | |
|----------------------------|--|-------------------|
| DESIGN BY: REP | | DATE: 03/27/24 |
| DRAWN BY: [Redacted] | | DATE: -- |
| CHECKED BY: [Redacted] | | DATE: -- |
| FIELD ENGINEER: [Redacted] | | DATE: -- |
| WORK TYPE: CAPITAL | | ACTIVITY CODE: -- |

| | |
|----------------------------------|--------------------|
| (PROJECT RELATED INFORMATION) | |
| PARENT WORK ORDER NUMBER: 398813 | PROJECT NUMBER: |
| FINIS MAP: | SHEET NO. 10 OF 19 |
| REVISIONS: | |

| | |
|--|-------------------------|
| EXISTING ROW/PROPERTY LINE | EXISTING SANITARY SEWER |
| EXISTING CURB LINE | EXISTING WATER |
| SEEDING AND MULCHING | EXISTING SILT FENCE |
| MATERIALS STAGING | SOIL DISTURBANCE AREA |
| ROCK SOCK | EXISTING FLOW DIRECTION |
| LIMITS OF CONSTRUCTION/LIMITS OF DISTURBANCE | |
| INLET PROTECTION | |

GRADING, EROSION, AND SEDIMENT CONTROL
MARKSHEFFEL CONNECTOR
16IN HIGH PRESSURE MAIN

Colorado Springs Utilities
It's how we're all connected

PRC
 ENGINEERING

INSERT TASKI

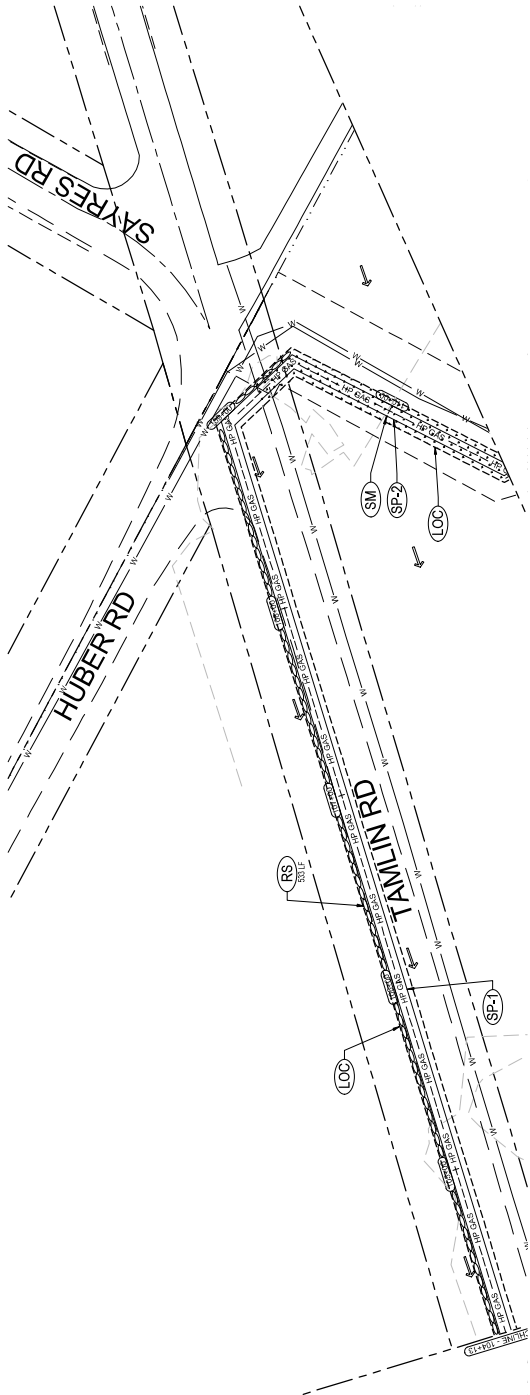

MARKSHEFFEL CONNECTOR
PROJECT SITE

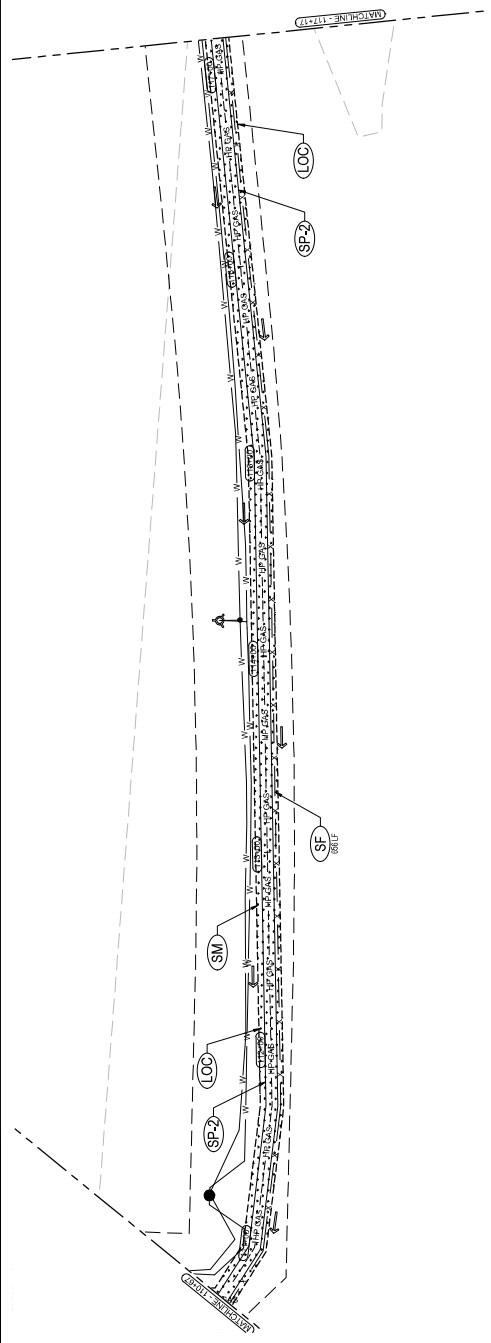
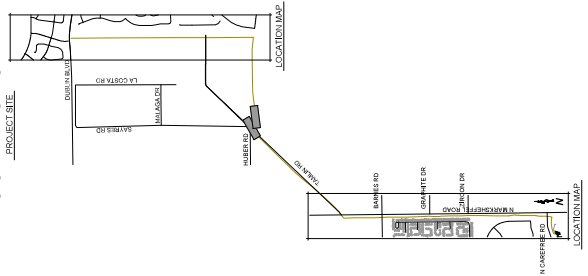

LEGEND

| | | | |
|-----|--|-----|-------------------------|
| --- | EXISTING ROW/PROPERTY LINE | --- | EXISTING SANITARY SEWER |
| --- | EXISTING CURB LINE | --- | EXISTING WATER |
| --- | SEEDING AND MULCHING | --- | SILT FENCE |
| --- | MATERIALS STAGING | --- | SOIL DISTURBANCE AREA |
| --- | ROCK SOCK | --- | EXISTING FLOW DIRECTION |
| --- | LIMITS OF CONSTRUCTION/LIMITS OF DISTURBANCE | --- | |
| --- | INLET PROTECTION | | |

(PROJECT RELATED INFORMATION)

| |
|----------------------------------|
| PARENT WORK ORDER NUMBER: 398813 |
| PROJECT NUMBER: |
| FINIS MAP: |
| SHEET NO. 11 OF 19 |

DESIGN BY: REP
 DRAWN BY: [REDACTED]
 CHECKED BY: [REDACTED]
 FIELD ENGINEER: [REDACTED]
 WORK TYPE: CAPITAL
 ACTIVITY CODE:

Colorado Springs Utilities
It's how we're all connected

GRADING, EROSION, AND SEDIMENT CONTROL
MARKSHEFFEL CONNECTOR
16IN HIGH PRESSURE MAIN

INSERT TASKI

MARKSHEFFEL CONNECTOR

PROJECT SITE

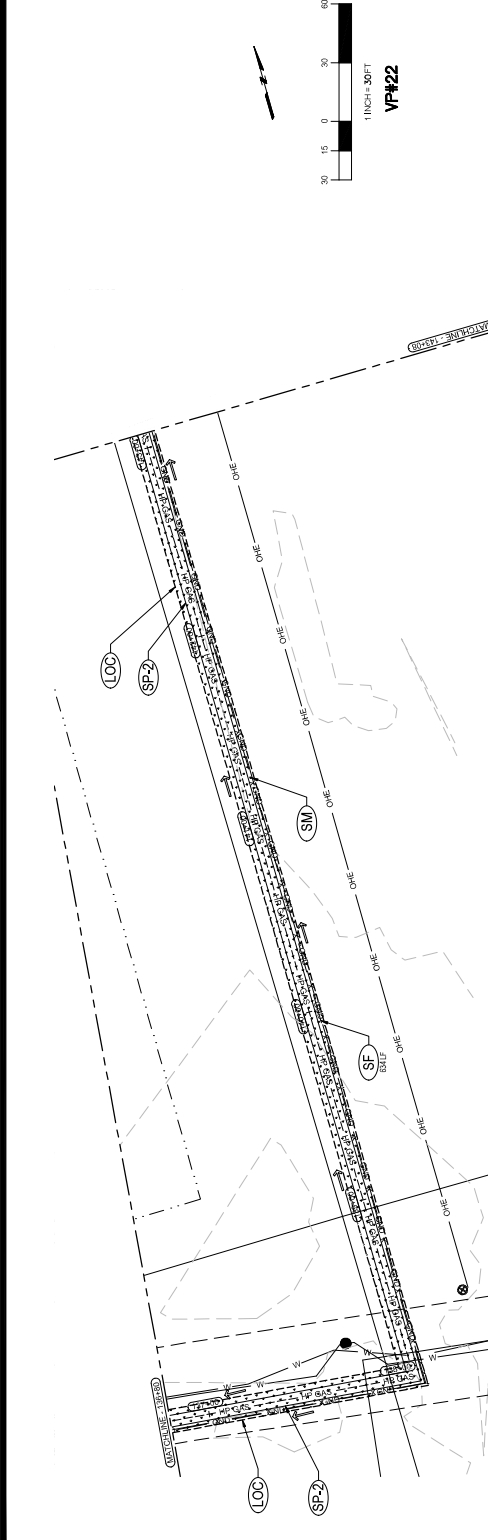
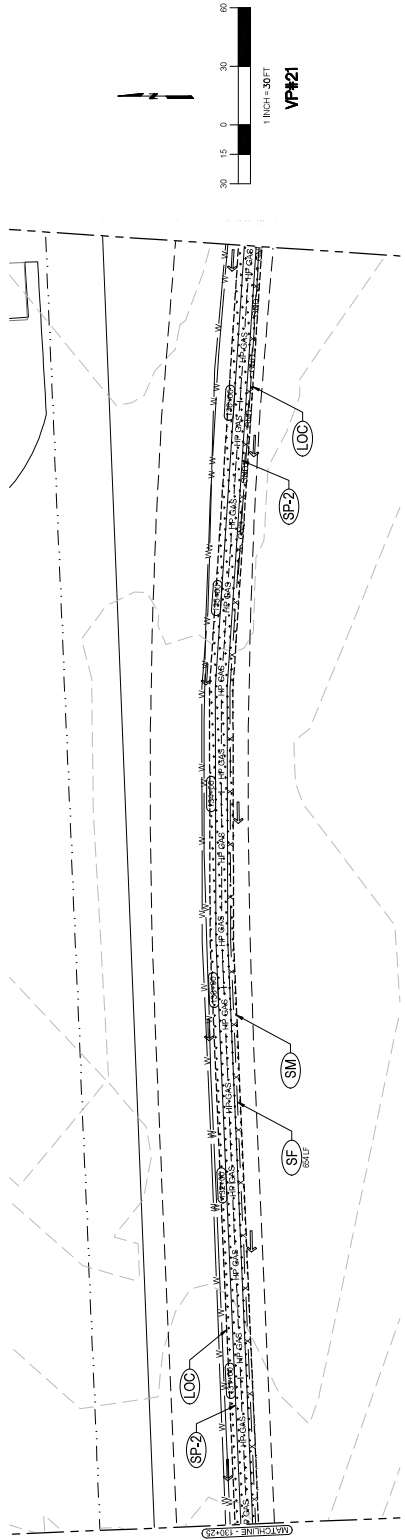
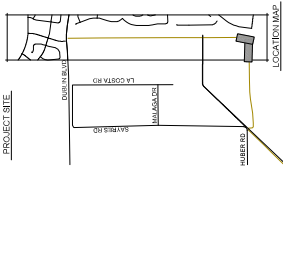

GRADING, EROSION, AND SEDIMENT CONTROL
MARKSHEFFEL CONNECTOR
16IN HIGH PRESSURE MAIN

(PROJECT RELATED INFORMATION)

| | |
|---------------------------|----------|
| PARENT WORK ORDER NUMBER: | 398813 |
| PROJECT NUMBER: | |
| FINIS. MAP: | |
| SHEET NO.: | 13 OF 19 |
| DESIGN BY: | REP |
| CHECKED BY: | |
| DATE: | 03/27/24 |
| FIELD ENGINEER: | |
| WORK TYPE: | UTILITY |
| ACTIVITY CODE: | |

REVISIONS:

| | |
|-----|-------------|
| NO. | DESCRIPTION |
| | |
| | |

LEGEND

| | | | |
|-----|--|---|-------------------------|
| --- | EXISTING ROW/PROPERTY LINE | ⊙ | EXISTING SANITARY SEWER |
| --- | EXISTING CURB LINE | ⊙ | EXISTING WATER |
| ⊙ | SEEDING AND MULCHING | x | SILT FENCE |
| ⊙ | MATERIALS STAGING | ⊙ | SOIL DISTURBANCE AREA |
| ⊙ | ROCK SOCK | → | EXISTING FLOW DIRECTION |
| ⊙ | LIMITS OF CONSTRUCTION/LIMITS OF DISTURBANCE | | |
| ⊙ | INLET PROTECTION | | |

INSERT TASK!



MARKSHEFFEL CONNECTOR

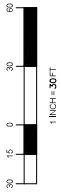
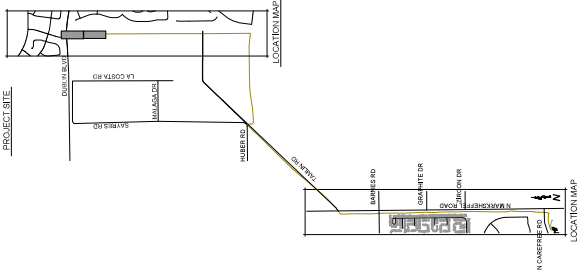

VPI#29

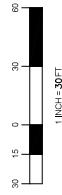
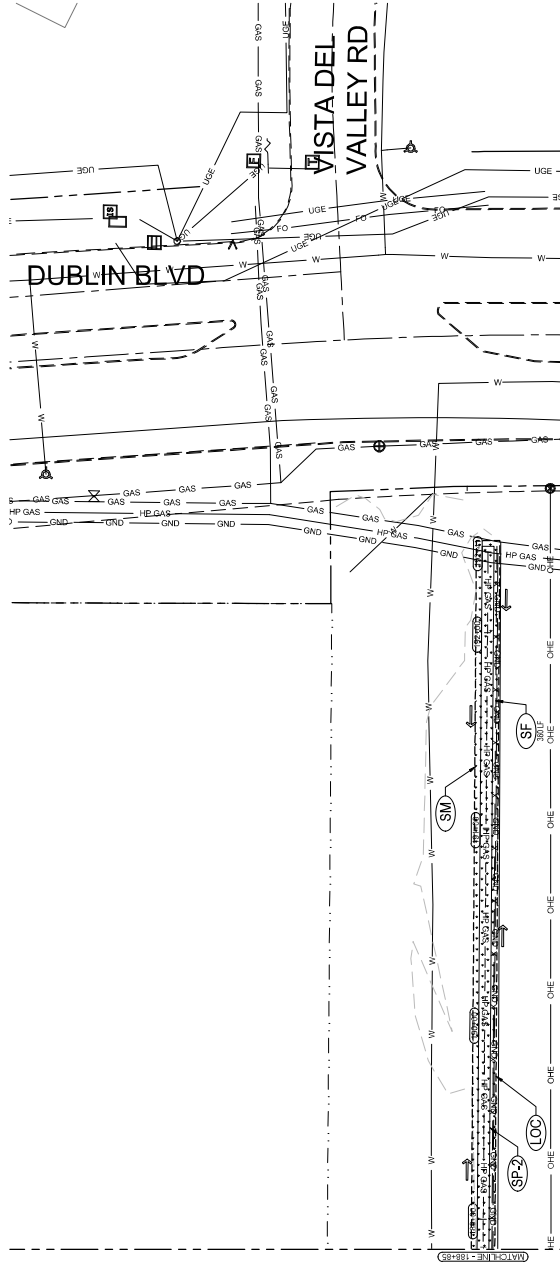
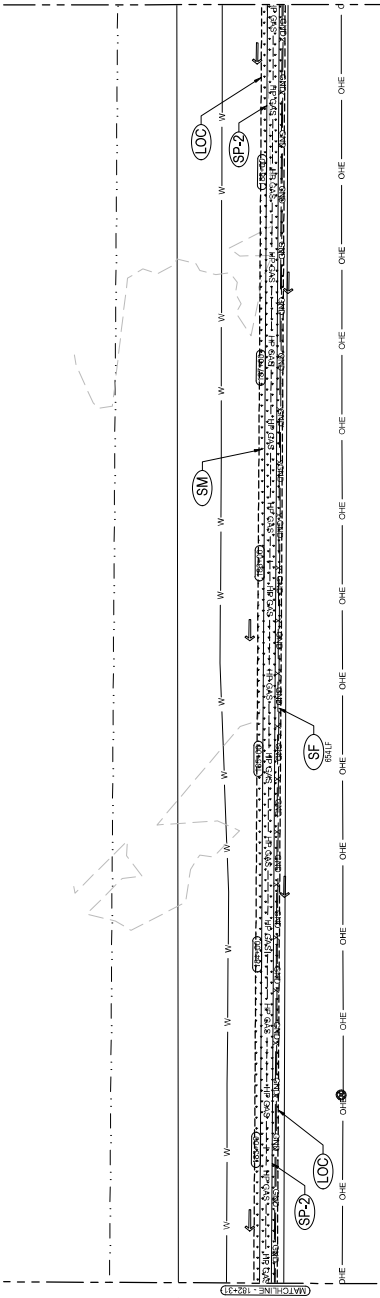

VPI#30

GRADING, EROSION, AND SEDIMENT CONTROL
MARKSHEFFEL CONNECTOR
16IN HIGH PRESSURE MAIN

Colorado Springs Utilities
It's how we're all connected

DESIGN BY: REP
CHECKED BY: S
SCALE: DATE: 03/27/24
FIELD ENGINEER: DATE: ---
WORK TYPE: CAPITAL
ACTIVITY CODE: ---

(PROJECT RELATED INFORMATION)

| | |
|---------------------------|----------|
| PARENT WORK ORDER NUMBER: | 398813 |
| PROJECT NUMBER: | |
| FINIS MAP: | |
| SHEET NO.: | 17 OF 19 |

REVISIONS:

LEGEND

EXISTING ROW/PROPERTY LINE
EXISTING CURB LINE
EXISTING CUBING AND WILCHING
SEEDING AND WILCHING (SM)
MATERIALS STAGING (SP-1, SP-2)
ROCK SOCK (RS)
LIMITS OF CONSTRUCTION/LIMITS OF DISTURBANCE (LOC)
INLET PROTECTION (IP)

EXISTING SANITARY SEWER (S)
EXISTING WATER (W)
SILT FENCE (SF)
SOIL DISTURBANCE AREA (X)
EXISTING FLOW DIRECTION (→)

COLORADO 811
WITH YOUR SERVICE, WE'VE GOT YOU COVERED

PRC
ENGINEERING

INSERT TASKI

| | |
|-----------------|--|
| CONTRACTOR: | |
| INSPECTOR: | |
| FOREMAN: | |
| DATE COMPLETED: | |
| DATE STARTED: | |

GRADING, EROSION, AND SEDIMENT CONTROL
MARKSHEFFEL CONNECTOR
16IN HIGH PRESSURE MAIN

| | |
|------------------------------|----------|
| PROJECT NUMBER: | 3988813 |
| SHEET NO.: | 18 OF 19 |
| FORMS MAP: | |
| PROJECT RELATED INFORMATION: | |
| REVISIONS: | |

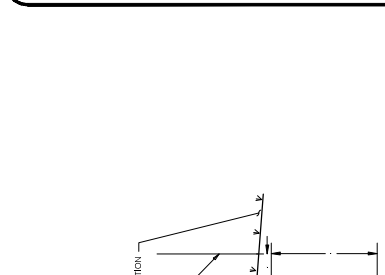

SC-1 Silt Fence (SF)

November 2010 Urban Drainage and Flood Control District Urban Storm Drainage Criteria Manual Volume 3

SECTION A

SILT FENCE

ROCK SOCK SHALL BE INSTALLED AS SHOWN WITH 10\"/>

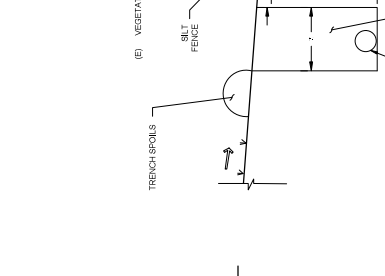

SC-5 Rock Sock (RS)

November 2010 Urban Drainage and Flood Control District Urban Storm Drainage Criteria Manual Volume 3

ROCK SOCK PERIMETER CONTROL

MATERIALS STAGING IN ROADWAY NOTES:

- INSPECT BMP EACH WORKDAY AND MAINTAIN THEM IN EFFECTIVE CONDITION. REMOVE ALL MATERIALS FROM THE ROADWAY WITHIN 24 HOURS FOLLOWING A STORM THAT CAUSES SURFACE EROSION, AND PERFORM NECESSARY MAINTENANCE.
- FREQUENT OBSERVATIONS AND MAINTENANCE ARE NECESSARY TO PREVENT EROSION AND SEDIMENTATION. CORRECTIVE MEASURES SHOULD BE DOCUMENTED THOROUGHLY.
- WHERE BMPs HAVE FAILED, REPAIR OR REPLACEMENT SHOULD BE INITIATED UPON DISCOVERY OF THE FAILURE.
- INSPECT PFC PIPE ALONG CURB LINE FOR CLOGGING AND DEBRIS. REMOVE OBSTRUCTIONS PROMPTLY.
- CLEAN MATERIAL FROM PAVED SURFACES BY SWEEPING OR VACUUMING.

NOTE: MANY JURISDICTIONS HAVE BMP DETAILS THAT VARY FROM USDC STANDARD DETAILS. CONSULT LOCAL JURISDICTIONS AS TO WHICH DETAIL SHOULD BE USED WHEN DIFFERENCES ARE NOTED.

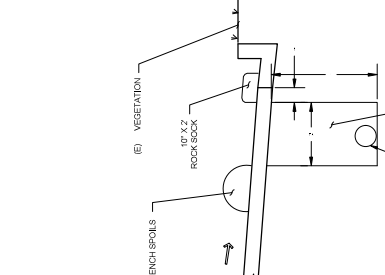

MM-2 Stockpile Management (SM)

November 2010 Urban Drainage and Flood Control District Urban Storm Drainage Criteria Manual Volume 3

STOCKPILE PROTECTION

MATERIALS STAGING IN ROADWAY NOTES:

- INSPECT BMP EACH WORKDAY AND MAINTAIN THEM IN EFFECTIVE CONDITION. REMOVE ALL MATERIALS FROM THE ROADWAY WITHIN 24 HOURS FOLLOWING A STORM THAT CAUSES SURFACE EROSION, AND PERFORM NECESSARY MAINTENANCE.
- FREQUENT OBSERVATIONS AND MAINTENANCE ARE NECESSARY TO PREVENT EROSION AND SEDIMENTATION. CORRECTIVE MEASURES SHOULD BE DOCUMENTED THOROUGHLY.
- WHERE BMPs HAVE FAILED, REPAIR OR REPLACEMENT SHOULD BE INITIATED UPON DISCOVERY OF THE FAILURE.
- INSPECT PFC PIPE ALONG CURB LINE FOR CLOGGING AND DEBRIS. REMOVE OBSTRUCTIONS PROMPTLY.
- CLEAN MATERIAL FROM PAVED SURFACES BY SWEEPING OR VACUUMING.

NOTE: MANY JURISDICTIONS HAVE BMP DETAILS THAT VARY FROM USDC STANDARD DETAILS. CONSULT LOCAL JURISDICTIONS AS TO WHICH DETAIL SHOULD BE USED WHEN DIFFERENCES ARE NOTED.

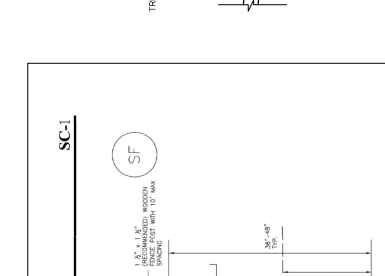

MM-1 Stockpile Management (SP)

November 2010 Urban Drainage and Flood Control District Urban Storm Drainage Criteria Manual Volume 3

STOCKPILE PROTECTION

MATERIALS STAGING IN ROADWAY NOTES:

- INSPECT BMP EACH WORKDAY AND MAINTAIN THEM IN EFFECTIVE CONDITION. REMOVE ALL MATERIALS FROM THE ROADWAY WITHIN 24 HOURS FOLLOWING A STORM THAT CAUSES SURFACE EROSION, AND PERFORM NECESSARY MAINTENANCE.
- FREQUENT OBSERVATIONS AND MAINTENANCE ARE NECESSARY TO PREVENT EROSION AND SEDIMENTATION. CORRECTIVE MEASURES SHOULD BE DOCUMENTED THOROUGHLY.
- WHERE BMPs HAVE FAILED, REPAIR OR REPLACEMENT SHOULD BE INITIATED UPON DISCOVERY OF THE FAILURE.
- INSPECT PFC PIPE ALONG CURB LINE FOR CLOGGING AND DEBRIS. REMOVE OBSTRUCTIONS PROMPTLY.
- CLEAN MATERIAL FROM PAVED SURFACES BY SWEEPING OR VACUUMING.

NOTE: MANY JURISDICTIONS HAVE BMP DETAILS THAT VARY FROM USDC STANDARD DETAILS. CONSULT LOCAL JURISDICTIONS AS TO WHICH DETAIL SHOULD BE USED WHEN DIFFERENCES ARE NOTED.

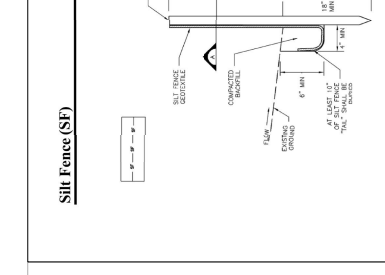

MM-2 Stockpile Management (SM)

November 2010 Urban Drainage and Flood Control District Urban Storm Drainage Criteria Manual Volume 3

STOCKPILE PROTECTION

MATERIALS STAGING IN ROADWAY NOTES:

- INSPECT BMP EACH WORKDAY AND MAINTAIN THEM IN EFFECTIVE CONDITION. REMOVE ALL MATERIALS FROM THE ROADWAY WITHIN 24 HOURS FOLLOWING A STORM THAT CAUSES SURFACE EROSION, AND PERFORM NECESSARY MAINTENANCE.
- FREQUENT OBSERVATIONS AND MAINTENANCE ARE NECESSARY TO PREVENT EROSION AND SEDIMENTATION. CORRECTIVE MEASURES SHOULD BE DOCUMENTED THOROUGHLY.
- WHERE BMPs HAVE FAILED, REPAIR OR REPLACEMENT SHOULD BE INITIATED UPON DISCOVERY OF THE FAILURE.
- INSPECT PFC PIPE ALONG CURB LINE FOR CLOGGING AND DEBRIS. REMOVE OBSTRUCTIONS PROMPTLY.
- CLEAN MATERIAL FROM PAVED SURFACES BY SWEEPING OR VACUUMING.

NOTE: MANY JURISDICTIONS HAVE BMP DETAILS THAT VARY FROM USDC STANDARD DETAILS. CONSULT LOCAL JURISDICTIONS AS TO WHICH DETAIL SHOULD BE USED WHEN DIFFERENCES ARE NOTED.

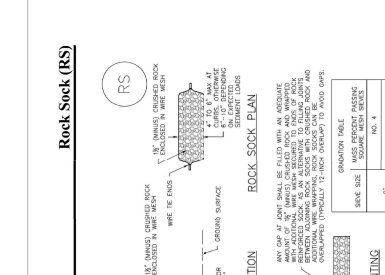

MM-1 Stockpile Management (SP)

November 2010 Urban Drainage and Flood Control District Urban Storm Drainage Criteria Manual Volume 3

STOCKPILE PROTECTION

MATERIALS STAGING IN ROADWAY NOTES:

- INSPECT BMP EACH WORKDAY AND MAINTAIN THEM IN EFFECTIVE CONDITION. REMOVE ALL MATERIALS FROM THE ROADWAY WITHIN 24 HOURS FOLLOWING A STORM THAT CAUSES SURFACE EROSION, AND PERFORM NECESSARY MAINTENANCE.
- FREQUENT OBSERVATIONS AND MAINTENANCE ARE NECESSARY TO PREVENT EROSION AND SEDIMENTATION. CORRECTIVE MEASURES SHOULD BE DOCUMENTED THOROUGHLY.
- WHERE BMPs HAVE FAILED, REPAIR OR REPLACEMENT SHOULD BE INITIATED UPON DISCOVERY OF THE FAILURE.
- INSPECT PFC PIPE ALONG CURB LINE FOR CLOGGING AND DEBRIS. REMOVE OBSTRUCTIONS PROMPTLY.
- CLEAN MATERIAL FROM PAVED SURFACES BY SWEEPING OR VACUUMING.

NOTE: MANY JURISDICTIONS HAVE BMP DETAILS THAT VARY FROM USDC STANDARD DETAILS. CONSULT LOCAL JURISDICTIONS AS TO WHICH DETAIL SHOULD BE USED WHEN DIFFERENCES ARE NOTED.

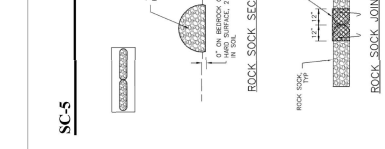

MM-2 Stockpile Management (SM)

November 2010 Urban Drainage and Flood Control District Urban Storm Drainage Criteria Manual Volume 3

STOCKPILE PROTECTION

MATERIALS STAGING IN ROADWAY NOTES:

- INSPECT BMP EACH WORKDAY AND MAINTAIN THEM IN EFFECTIVE CONDITION. REMOVE ALL MATERIALS FROM THE ROADWAY WITHIN 24 HOURS FOLLOWING A STORM THAT CAUSES SURFACE EROSION, AND PERFORM NECESSARY MAINTENANCE.
- FREQUENT OBSERVATIONS AND MAINTENANCE ARE NECESSARY TO PREVENT EROSION AND SEDIMENTATION. CORRECTIVE MEASURES SHOULD BE DOCUMENTED THOROUGHLY.
- WHERE BMPs HAVE FAILED, REPAIR OR REPLACEMENT SHOULD BE INITIATED UPON DISCOVERY OF THE FAILURE.
- INSPECT PFC PIPE ALONG CURB LINE FOR CLOGGING AND DEBRIS. REMOVE OBSTRUCTIONS PROMPTLY.
- CLEAN MATERIAL FROM PAVED SURFACES BY SWEEPING OR VACUUMING.

NOTE: MANY JURISDICTIONS HAVE BMP DETAILS THAT VARY FROM USDC STANDARD DETAILS. CONSULT LOCAL JURISDICTIONS AS TO WHICH DETAIL SHOULD BE USED WHEN DIFFERENCES ARE NOTED.

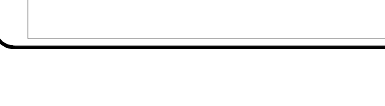

MM-1 Stockpile Management (SP)

November 2010 Urban Drainage and Flood Control District Urban Storm Drainage Criteria Manual Volume 3

STOCKPILE PROTECTION

MATERIALS STAGING IN ROADWAY NOTES:

- INSPECT BMP EACH WORKDAY AND MAINTAIN THEM IN EFFECTIVE CONDITION. REMOVE ALL MATERIALS FROM THE ROADWAY WITHIN 24 HOURS FOLLOWING A STORM THAT CAUSES SURFACE EROSION, AND PERFORM NECESSARY MAINTENANCE.
- FREQUENT OBSERVATIONS AND MAINTENANCE ARE NECESSARY TO PREVENT EROSION AND SEDIMENTATION. CORRECTIVE MEASURES SHOULD BE DOCUMENTED THOROUGHLY.
- WHERE BMPs HAVE FAILED, REPAIR OR REPLACEMENT SHOULD BE INITIATED UPON DISCOVERY OF THE FAILURE.
- INSPECT PFC PIPE ALONG CURB LINE FOR CLOGGING AND DEBRIS. REMOVE OBSTRUCTIONS PROMPTLY.
- CLEAN MATERIAL FROM PAVED SURFACES BY SWEEPING OR VACUUMING.

NOTE: MANY JURISDICTIONS HAVE BMP DETAILS THAT VARY FROM USDC STANDARD DETAILS. CONSULT LOCAL JURISDICTIONS AS TO WHICH DETAIL SHOULD BE USED WHEN DIFFERENCES ARE NOTED.

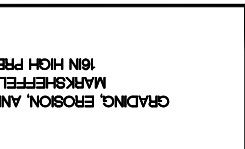

SP-2 Typical Trench Section

NOT TO SCALE

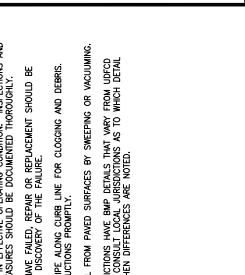

SP-2 Typical Trench Section

NOT TO SCALE

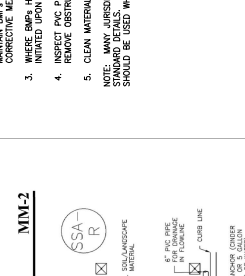

MM-2 Stockpile Management (SM)

NOT TO SCALE

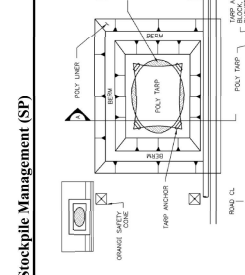

MM-1 Stockpile Management (SP)

NOT TO SCALE

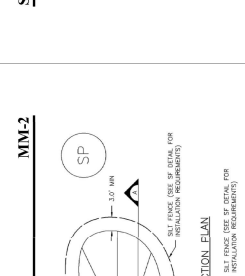

MM-2 Stockpile Management (SM)

NOT TO SCALE

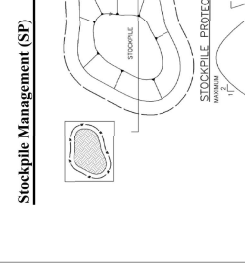

MM-1 Stockpile Management (SP)

NOT TO SCALE

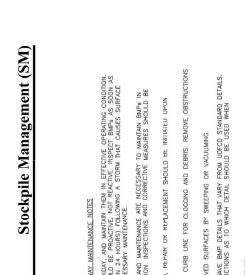

MM-2 Stockpile Management (SM)

NOT TO SCALE

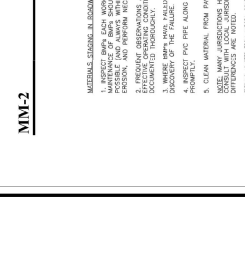

MM-1 Stockpile Management (SP)

NOT TO SCALE

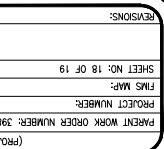

SP-2 Typical Trench Section

NOT TO SCALE



SP-2 Typical Trench Section

NOT TO SCALE

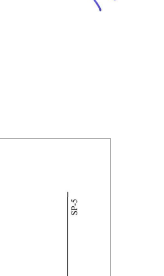

MM-2 Stockpile Management (SM)

NOT TO SCALE



MM-1 Stockpile Management (SP)

NOT TO SCALE

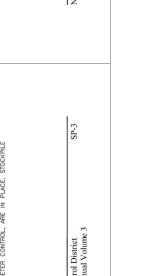

MM-2 Stockpile Management (SM)

NOT TO SCALE

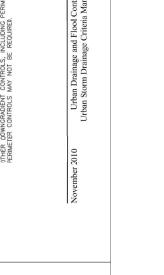

MM-1 Stockpile Management (SP)

NOT TO SCALE

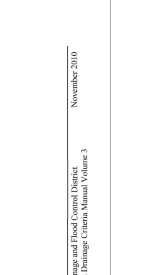

MM-2 Stockpile Management (SM)

NOT TO SCALE

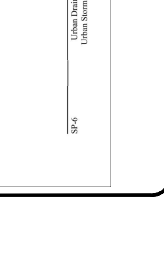

MM-1 Stockpile Management (SP)

NOT TO SCALE



Attachment C



Colorado Springs Utilities

It's how we're all connected



AN ARTERA COMPANY



Contacts:

Colorado Springs Utilities (Owner)

Mark Munoz
Project Manager
719-668-2862
mmunoz@csu.org

Miller Pipeline, LLC (Contractor/Operator)

Randy Hiett
General Manager
719-325-9984
randy.hiett@millerpipeline.com

Era Environmental, Inc. (Environmental Consultant)

Emily Chamberlain
President
719-924-0519
era@eraenvironmental.com

121 South Tejon Street, Fourth Floor
P.O. Box 1103, Mail Code 940
Colorado Springs, CO 80903-2187

Phone 719-668-8426
Fax 719-668-8666
<http://www.csu.org>