



Colorado Springs Utilities

It's how we're all connected

May 09, 2024

El Paso County, Planning and Community Development Department
2880 International Circle, Suite 110
Colorado Spring, CO 80910

RE: 1041 Exemption Request

To Whom It May Concern:

As part of the Marksheffel Connector Gas Main Project, Colorado Springs Utilities ("Utilities"), an enterprise of the City of Colorado Springs, and Miller Pipeline, LLC ("the Contractor") intend to construct a 16" steel natural gas main ("the Project") from existing infrastructure at Barnes Road continuing along Marksheffel Road, turning down Tamlin Road, then tying into existing infrastructure at Dublin Boulevard. Utilities does not know if the Project could meet any exemptions under the El Paso County's Guidelines and Regulations for Areas and Activities of State Interest (a.k.a. the "1041 Regulations"). Therefore, Utilities and the Contractor respectfully request El Paso County's guidance on how to navigate the 1041 Regulation process so that they can move forward with the Project.

Construction for this project includes installation of new 16" natural gas main infrastructure to be conducted within easements, to include all appurtenances and associated infrastructure to ensure a complete and efficient installation. This construction project will specifically include installation of approximately 16,000 LF of 16" steel pipe by excavation, installing of new pipe, and associated infrastructures, backfill, and restoration with seeding and mulching as final stabilization. A depiction of the project area is attached to this letter as Attachment A.

Utilities anticipates that the New Gas Main - which will not exceed a hoop stress of 20% or more at its specified minimum yield strength - would start at the Barnes Road Gate Station on the property identified by TSN 5320400007. From this location, the New Gas Main would proceed east and run north along the edge of Marksheffel Road to Tamlin Road and then continue northeast to the property identified by TSN 5300000760 where it will continue north through the following easements; TSN 5315320001, TSN 5315202002, and TSN 5315202001. The new gas main will end at Dublin Boulevard after connecting through these easements. A depiction of the proposed New Gas Main is attached to this Letter as Exhibit B, and the names and qualifications of the persons associated with the Project are attached to this Letter as Exhibit C. Based on the foregoing facts, Utilities and the Contractor would like El Paso County's guidance on how to proceed with the 1041 Regulation process. Please do not hesitate to contact us if you have any questions or require additional documentation.

Sincerely

Randy Hiett, Project Manager
Miller Pipeline LLC
421 E. Industrial Blvd.
Pueblo West, CO 81007
randy.hiett@millerpipeline.com



MILLER PIPELINE

AN ARTERA COMPANY



121 South Tejon Street, Fourth Floor
P.O. Box 1103, Mail Code 940
Colorado Springs, CO 80903-2187

Phone 719-668-8426
Fax 719-668-8666
<http://www.csu.org>

Attachment A



Colorado Springs Utilities
It's how we're all connected



MILLER PIPELINE

AN ARTERA COMPANY



Vicinity Map

Additional maps can be found in GEC Plan submitted with this letter.

SITE MAP: not to scale

MARKSHEFFEL CONNECTOR

PROJECT SITE

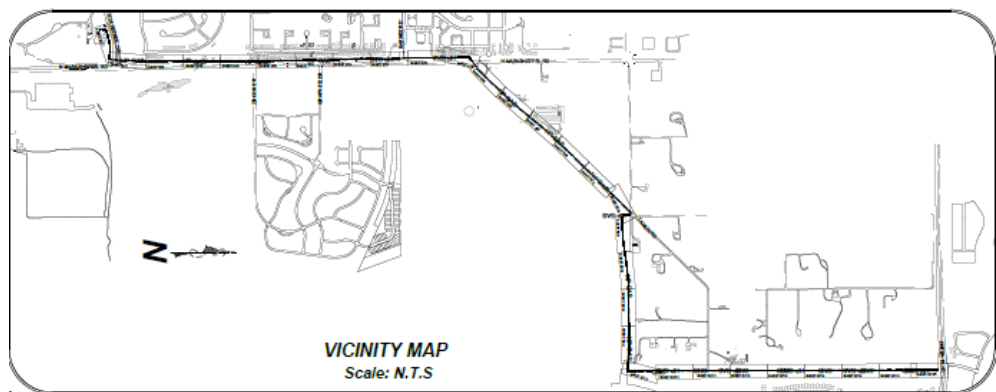
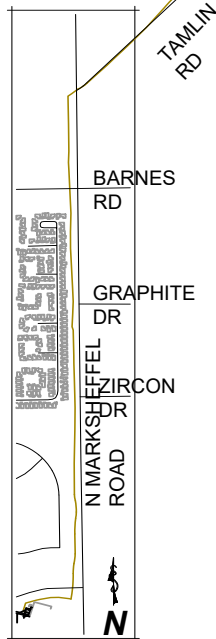

121 South Tejon Street, Fourth Floor
P.O. Box 1103, Mail Code 940
Colorado Springs, CO 80903-2187

Phone 719-668-8426
Fax 719-668-8666
<http://www.csu.org>

Attachment B

MARKSHEFFEL CONNECTOR 16IN HIGH PRESSURE GAS MAIN

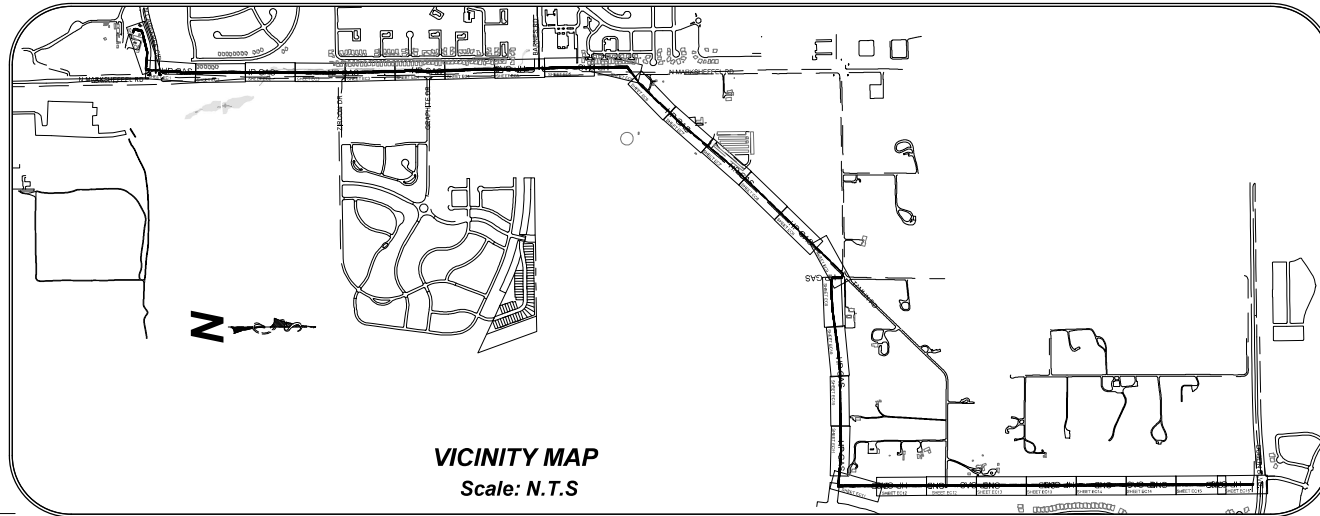

VICINITY MAP
Scale: N.T.S

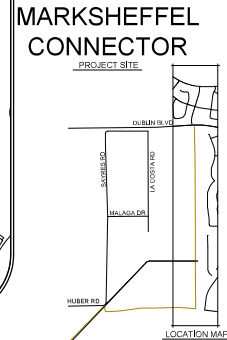

SITE MAP
Scale: N.T.S

CITY OF COLORADO SPRINGS GRADING AND EROSION CONTROL REVIEW: THIS GRADING AND EROSION CONTROL PLAN IS FILED IN ACCORDANCE WITH CITY CODE. THIS PLAN IS REVIEWED IN ACCORDANCE WITH THE STORMWATER CONSTRUCTION MANUAL, LATEST REVISIONS.

SIGNATURE _____ DATE _____

CSU PROJECT MANAGER'S STATEMENT: I HEREBY CERTIFY THAT THE DRAINAGE, GRADING, AND EROSION CONTROL FOR CSU MARKSHEFFEL CONNECTOR SHALL BE CONSTRUCTED ACCORDING TO THE DESIGN PRESENTED IN THIS GRADING AND EROSION CONTROL PLAN. I FURTHER UNDERSTAND THAT FIELD CHANGES MUST BE REVIEWED BY THE SWIFT REVIEW ENGINEER TO ENSURE CONFORMANCE WITH THE ORIGINAL DESIGN INTENT. I AM EMPLOYED BY AND PERFORM ENGINEERING SERVICES SOLELY FOR COLORADO SPRINGS UTILITIES, AN ENTERPRISE OF THE CITY OF COLORADO SPRINGS, AND THEREFORE AM EXEMPT FROM COLORADO REVISED STATUTE TITLE 12, ARTICLE 26, PART 1, ACCORDING TO 8-12-25-103(1), C.R.S.

NAME OF CSU PROJECT MANAGER: Mark Muñoz
 SIGNATURE: Mark Muñoz DATE: 04/16/2024
 TITLE: Project Manager
 PHONE NUMBER: 719-668-2862
 EMAIL ADDRESS: mmunoz@csu.org

CONTRACTOR'S STATEMENT: I WILL COMPLY WITH THE REQUIREMENTS OF THE GRADING AND EROSION CONTROL PLAN INCLUDING CONSTRUCTION CONTROL MEASURE INSPECTION REQUIREMENTS AND FINAL STABILIZATION REQUIREMENTS. I ACKNOWLEDGE THE RESPONSIBILITY TO DETERMINE WHETHER THE CONSTRUCTION ACTIVITIES ON THESE PLANS REQUIRE COLORADO DISCHARGE PERMIT SYSTEM (CDPS) PERMITTING FOR STORMWATER DISCHARGES ASSOCIATED WITH CONSTRUCTION ACTIVITY.

NAME OF CONTRACTOR: Miller Pipeline, LLC
 AUTHORIZED SIGNATURE: Randy Hiett DATE: 04/15/2024
 TITLE: General Manager
 EMAIL ADDRESS: Randy.Hiett@millerpipeline.com
 PHONE NUMBER: 719-325-9984 ADDRESS: 3170 Capital Drive-Colo. Spgs, CO 80939

ENGINEER'S STATEMENT: THIS GRADING AND EROSION CONTROL PLAN WAS PREPARED UNDER MY DIRECTION AND SUPERVISION AND IS CORRECT TO THE BEST OF MY KNOWLEDGE AND BELIEF. IF SUCH WORK IS PERFORMED IN ACCORDANCE WITH THE GRADING AND EROSION CONTROL PLAN, THE WORK WILL NOT BECOME A HAZARD TO LIFE AND LIMB, ENDANGER PROPERTY, OR ADVERSELY AFFECT THE SAFETY, USE, OR STABILITY OF A PUBLIC WAY, DRAINAGE CHANNEL, OR OTHER PROPERTY.

SIGNATURE: [Signature] DATE: 04/05/24
 PRINTED NAME: RAYMOND F. PEREZ SEAL: [Seal]

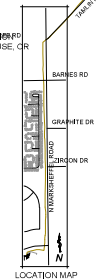

LOCATION MAP



SHEET INDEX	
TS1	COVERSHEET
GN1	GENERAL NOTES
EC1-EC15	EROSION CONTROL PLANS
DT1-DT2	EROSION CONTROL DETAILS

(PROJECT RELATED INFORMATION)	
PARENT WORK ORDER NUMBER:	3988813
PROJECT NUMBER:	
FIMS MAP:	
SHEET NO.:	1 OF 19
REVISIONS:	

Colorado Springs Utilities
It's how we're all connected

DESIGN BY: REP	DATE: 04/05/24
APPROVED BY:	DATE: --
SERVED BY:	DATE: --
FIELD ENGINEER:	
WORK TYPE: CAPITAL	
ACTIVITY CODE:	

GRADING, EROSION, AND SEDIMENT CONTROL
MARKSHEFFEL CONNECTOR
16IN HIGH PRESSURE MAIN

[INSERT TASK]

GENERAL NOTES

1. ANY LAND DISTURBANCE BY ANY OWNER, DEVELOPER, BALDWIN CONTRACTOR OR OTHER PERSON SHALL COMPLY WITH THE BASIC GRADING, EROSION AND STORMWATER QUALITY CONTROL, REQUIREMENTS AND GENERAL PROHIBITIONS NOTED IN THE DRAINAGE DISTRICT MANUAL, VOLUME 1.

2. NO CLEARING, GRADING, EXCAVATION, FILLING OR OTHER LAND DISTURBING ACTIVITIES SHALL BE PERMITTED UNTIL BIDDING AND ACCEPTANCE OF THE GRADING PLAN AND EROSION AND STORMWATER QUALITY CONTROL PLAN IS RECEIVED FROM CITY ENGINEER.

3. THE INSTALLATION OF ANY EARTH DISTURBANCE OPERATIONS TAKING PLACE, CALL CITY STORMWATER INSPECTIONS, 355-5980, 48 HOURS PRIOR TO CONSTRUCTION.

4. SEDIMENT (MUD AND DRILL) TRANSPORTED ONTO A PUBLIC ROAD, REGARDLESS OF THE SIZE OF THE SITE, SHALL BE CLEANED IMMEDIATELY.

5. CONCRETE WASH WATER SHALL NOT BE DISCHARGED OR ALLOWED TO RUNOFF TO STATE WATERS INCLUDING ANY SURFACE OR SUBSURFACE STORM DRAINAGE SYSTEM OR FACILITIES.

6. SOIL EROSION CONTROL MEASURES FOR ALL SLOPES, CHANNELS, DITCHES OR ANY DISTURBED LAND AREA SHALL BE COMPLETED WITHIN TWENTY (20) CALENDAR DAYS AFTER FINAL GRADING OR FINAL EARTH COVER IS PLACED. MEASURES MUST REMAIN FOR LONGER THAN 30 DAYS SHALL ALSO BE MAINTAINED WITHIN 21 DAYS AFTER INTERIM GRADING, AN AREA THAT IS GOING TO REMAIN AN INTERIM STATE FOR MORE THAN 60 DAYS SHALL ALSO BE SEEDED. ALL TEMPORARY SOIL EROSION CONTROL MEASURES AND BMP'S SHALL BE MAINTAINED UNTIL PERMANENT SOIL EROSION CONTROL MEASURES ARE IMPLEMENTED.

7. THE GRADING AND EROSION CONTROL PLAN WILL BE SUBJECT TO RE-REVIEW AND RE-ACCEPTANCE BY THE CITY OF COLORADO SPRINGS. THE GRADING AND EROSION CONTROL PLAN IS SUBJECT TO CHANGE IN PROPERTY OWNERSHIP, PROPOSED DEVELOPMENT CHANGES OR PROPOSED GRADING REVISIONS.

8. THE APPLICANT SHALL NOT CHANGE THE BERTH'S COVER OR ACCESS TO UTILITY (WAS, ACCEPTANCE OF THIS PLAN DOES NOT CONSTITUTE APPROVAL TO GRADE IN ANY UTILITY EASEMENT OR RIGHT-OF-WAY. APPROVALS TO GRADE WITHIN UTILITY EASEMENTS MUST BE OBTAINED FROM THE APPROPRIATE UTILITY COMPANY. IT IS NOT PERMISSIBLE FOR ANY PERSON TO MODIFY THE GRADE OF THE EARTH ON ANY COLORADO STREET OR PUBLIC HIGHWAY OR RIGHT-OF-WAY WITHOUT THE WRITTEN APPROVAL OF THE CITY ENGINEER. THE PLAN MUST BE APPROVED BY THE AFFECTED UTILITY OWNER PRIOR TO IMPLEMENTING THE PLAN, THE COST TO RELOCATE OR PROTECT EXISTING UTILITIES OR TO PROVIDE INTERIM ACCESS IS THE APPLICANT'S RESPONSIBILITY.

9. ACCORDING TO FEMA FLOOD INSURANCE RATE MAP 080410077F AND 080410251F EFFECTIVE MARCH 11, 1997, THERE IS NO FLOODPLAIN WITHIN THE PROJECT LIMITS.

10. STOCKPILE AND TEMPORARY DISPOSAL AREA LOCATIONS WILL BE DETERMINED BY CONTRACTOR.

11. STABILIZED STAGING AREA TO BE OFF-SITE

12. PROPOSED TOPOGRAPHY IS EQUAL TO EXISTING TOPOGRAPHY.

13. ANTICIPATED STARTING AND COMPLETION TIME PERIOD OF SITE GRADING

DATE: 05/20/23
END: 05/20/23

EXPECTED DATE ON WHICH THE FINAL STABILIZATION WILL BE COMPLETE

TOTAL AREA OF THE SITE TO BE CLEARED, EXCAVATED OR GRADED

TOTAL AREA TO BE DISTURBED: 20 ACRES

NAME OF RECEIVING WATERS: SAGECREEK/MULTIPLY OF COLORADO SPRINGS STORM SEWER SYSTEM

SOILS INFORMATION

TRUCKTON SANDY LOAM 3 TO 9 PERCENT SLOPES
HYDROLOGIC SOIL GROUP A

BLACKLAND LOAMY SAND, 1 TO 3 PERCENT SLOPES
HYDROLOGIC SOIL GROUP A

BLEON SANDY LOAM 0 TO 3 PERCENT SLOPES
HYDROLOGIC SOIL GROUP B

14. ALL UTILITIES ARE WITHIN PUBLIC RIGHT-OF-WAY

15. ADJACENT PROPERTIES ARE NOT ANTICIPATED TO BE AFFECTED BY THIS CONSTRUCTION.

16. NO GEOLOGIC-HAZARD STUDY REVIEW WAS COMPLETED TO DETERMINE THERE ARE NO AREAS IDENTIFIED AS "NO-BUILD AREAS".

STANDARD GEC PLAN NOTES

1. NO CLEARING, GRADING, EXCAVATION OR OTHER LAND DISTURBING ACTIVITIES SHALL BE ALLOWED (EXCEPT FOR WORK DIRECTLY RELATED TO THE INSTALLATION OF INITIAL CONTROL MEASURES) UNTIL A CITY GEC PERMIT HAS BEEN ISSUED.

2. ALL LAND DISTURBING ACTIVITIES MUST BE PERFORMED IN ACCORDANCE WITH AND THE APPROVED GEC PLAN AND INITIAL SITE INSPECTION WILL NOT BE SCHEDULED UNTIL A CITY GEC PERMIT HAS BEEN CONDITIONALLY APPROVED. CALL CITY STORMWATER INSPECTIONS, 355-5980, AT LEAST 48 HOURS PRIOR TO CONSTRUCTION TO SCHEDULE AN INITIAL INSPECTION AND OBTAIN A FULL PERMIT APPROVAL.

3. INITIAL CONTROL MEASURES SHALL BE INSTALLED AND INSPECTED PRIOR TO ANY LAND DISTURBING ACTIVITIES TAKING PLACE. AN INITIAL SITE INSPECTION WILL NOT BE SCHEDULED UNTIL A CITY GEC PERMIT HAS BEEN CONDITIONALLY APPROVED. CALL CITY STORMWATER INSPECTIONS, 355-5980, AT LEAST 48 HOURS PRIOR TO CONSTRUCTION TO SCHEDULE AN INITIAL INSPECTION AND OBTAIN A FULL PERMIT APPROVAL.

4. CLEAN WATER ACT (CWA) WITH THE CLEAN WATER ACT (CWA) CONTROL ACT, WITH E.P.A. ARTICLES 405 AND 402. IN ADDITION TO THE REQUIREMENTS INCLUDED IN THE CITY 9.981 PERMIT, STORMWATER CONSTRUCTION MANUAL, IN THE FEDERAL OR STATE AGENCIES, THE MORE RESTRICTIVE LAWS, RULES, OR REGULATIONS SHALL APPLY. REGULATIONS OF OTHER CONTAMINATION OR DEGRADATION OF STATE WATERS.

5. STORMWATER DISCHARGES FROM CONSTRUCTION SITES SHALL NOT CAUSE OR THREATEN TO CAUSE POLLUTION, CONTAMINATION, OR DEGRADATION OF STATE WATERS.

6. ALL CONSTRUCTION CONTROL MEASURES SHALL BE MAINTAINED UNTIL PERMANENT STABILIZATION MEASURES ARE IMPLEMENTED. TEMPORARY CONSTRUCTION CONTROL MEASURES MUST BE REMOVED PRIOR TO PERMIT CLOSURE. SUBSURFACE STORM DRAINAGE SYSTEM OR FACILITIES.

7. CONCRETE WASH WATER SHALL NOT BE DISCHARGED TO OR ALLOWED TO RUNOFF TO STATE WATERS OR ANY SURFACE OR SUBSURFACE STORM DRAINAGE SYSTEM OR FACILITIES.

8. BUILDING, CONSTRUCTION, EXCAVATION, OR OTHER WASTE MATERIALS SHALL NOT BE TEMPORARILY PLACED OR STORED IN THE INTERIM STATE FOR MORE THAN 60 DAYS SHALL ALSO BE MAINTAINED WITHIN 21 DAYS AFTER INTERIM GRADING, AN AREA THAT IS GOING TO REMAIN AN INTERIM STATE FOR MORE THAN 60 DAYS SHALL ALSO BE SEEDED. ALL TEMPORARY SOIL EROSION CONTROL MEASURES AND BMP'S SHALL BE MAINTAINED UNTIL PERMANENT SOIL EROSION CONTROL MEASURES ARE IMPLEMENTED.

9. ALL WASTES COMPOSED OF BUILDING MATERIALS MUST BE REMOVED FROM THE CONSTRUCTION SITE FOR DISPOSAL IN AN APPROPRIATE MANNER. ALL WASTES MUST BE REMOVED FROM THE CONSTRUCTION SITE FOR DISPOSAL IN AN APPROPRIATE MANNER. ALL WASTES MUST BE REMOVED FROM THE CONSTRUCTION SITE FOR DISPOSAL IN AN APPROPRIATE MANNER. ALL WASTES MUST BE REMOVED FROM THE CONSTRUCTION SITE FOR DISPOSAL IN AN APPROPRIATE MANNER.

10. THE PERMITTEE SHALL BE RESPONSIBLE FOR THE REMOVAL OF ALL CONSTRUCTION DEBRIS, DIRT, TRASH, ROCK, SEWER, AND MATERIALS SHALL BE BURIED, DUMPED, OR DISCHARGED AT THE SITE. NO BUILDING MATERIAL WASTES OR UNUSED BUILDING MATERIALS SHALL BE ACCUMULATED IN THE STORM SEWER OR OTHER DRAINAGE CONVEYANCE SYSTEM AS A RESULT OF CONSTRUCTION ACTIVITIES.

11. THE QUANTITY OF MATERIALS STORED ON THE PROJECT SITE SHALL BE LIMITED, AS MUCH AS PRACTICAL, TO THAT QUANTITY NECESSARY FOR THE CONSTRUCTION OF THE PROJECT. ALL MATERIALS SHALL BE STORED IN A MANNER THAT DOES NOT OBSTRUCT ACCESS TO THE PROJECT. ALL MATERIALS SHALL BE STORED IN A MANNER THAT DOES NOT OBSTRUCT ACCESS TO THE PROJECT.

12. ALL MATERIALS STORED ON THE PROJECT SITE SHALL BE LIMITED, AS MUCH AS PRACTICAL, TO THAT QUANTITY NECESSARY FOR THE CONSTRUCTION OF THE PROJECT. ALL MATERIALS SHALL BE STORED IN A MANNER THAT DOES NOT OBSTRUCT ACCESS TO THE PROJECT. ALL MATERIALS SHALL BE STORED IN A MANNER THAT DOES NOT OBSTRUCT ACCESS TO THE PROJECT.

13. ALL MATERIALS STORED ON THE PROJECT SITE SHALL BE LIMITED, AS MUCH AS PRACTICAL, TO THAT QUANTITY NECESSARY FOR THE CONSTRUCTION OF THE PROJECT. ALL MATERIALS SHALL BE STORED IN A MANNER THAT DOES NOT OBSTRUCT ACCESS TO THE PROJECT. ALL MATERIALS SHALL BE STORED IN A MANNER THAT DOES NOT OBSTRUCT ACCESS TO THE PROJECT.

14. NO CHEMICALS ARE TO BE ADDED TO THE DISCHARGE UNLESS PERMISSION FOR THE USE OF A SPECIFIC CHEMICAL IS GRANTED BY THE STATE IN GRANTING THE USE OF SUCH CHEMICALS. SPECIAL CONDITIONS AND MONITORING MAY BE REQUIRED.

15. MEASURES FOR ALL SLOPES, CHANNELS, DITCHES OR ANY DISTURBED LAND AREA SHALL BE COMPLETED WITHIN TWENTY (20) CALENDAR DAYS AFTER FINAL GRADING OR FINAL EARTH COVER IS PLACED. MEASURES MUST REMAIN FOR LONGER THAN 30 DAYS SHALL ALSO BE MAINTAINED WITHIN 21 DAYS AFTER INTERIM GRADING, AN AREA THAT IS GOING TO REMAIN AN INTERIM STATE FOR MORE THAN 60 DAYS SHALL ALSO BE SEEDED. ALL TEMPORARY SOIL EROSION CONTROL MEASURES AND BMP'S SHALL BE MAINTAINED UNTIL PERMANENT SOIL EROSION CONTROL MEASURES ARE IMPLEMENTED.

16. THE GEC PLAN SHALL BE SUBJECT TO RE-REVIEW AND RE-ACCEPTANCE BY THE CITY OF COLORADO SPRINGS. THE GRADING AND EROSION CONTROL PLAN IS SUBJECT TO CHANGE IN PROPERTY OWNERSHIP, PROPOSED DEVELOPMENT CHANGES OR PROPOSED GRADING REVISIONS.

17. IT IS NOT PERMISSIBLE FOR ANY PERSON TO MODIFY THE GRADE OF THE EARTH ON ANY UTILITY EASEMENT OR UTILITY RIGHT-OF-WAY WITHOUT WRITTEN APPROVAL FROM THE UTILITY OWNER. CITY ACCEPTANCE OF THE GEC PLAN AND CSMP DOES NOT CONSTITUTE APPROVAL TO GRADE IN ANY UTILITY EASEMENT OR RIGHT-OF-WAY. APPROVALS TO GRADE WITHIN UTILITY EASEMENTS MUST BE OBTAINED FROM THE APPROPRIATE UTILITY COMPANY. IT IS NOT PERMISSIBLE FOR ANY PERSON TO MODIFY THE GRADE OF THE EARTH ON ANY COLORADO STREET OR PUBLIC HIGHWAY OR RIGHT-OF-WAY WITHOUT THE WRITTEN APPROVAL OF THE CITY ENGINEER. THE PLAN MUST BE APPROVED BY THE AFFECTED UTILITY OWNER PRIOR TO IMPLEMENTING THE PLAN, THE COST TO RELOCATE OR PROTECT EXISTING UTILITIES OR TO PROVIDE INTERIM ACCESS SHALL BE AT THE APPLICANT'S EXPENSE.

18. ALL PERMITS, APPROVALS AND WARRANTIES THAT THEY HAVE THE LEGAL AUTHORITY TO GRADE AND/OR CONSTRUCT ADJACENT PROPERTY. AN APPROVED GEC PERMIT DOES NOT PROVIDE APPROVAL FOR THE APPLICANT TO MODIFY ADJACENT PROPERTY.

19. THE CONCRETE WASHOUT LOCATION WILL BE SELECTED BY THE CONTRACTOR. THE CONTRACTOR SHALL MARK THE LOCATION ON THE GEC PERMIT APPLICATION HAS BEEN APPROVED. A CITY GEC PERMIT MUST BE OBTAINED PRIOR TO THE START OF CONSTRUCTION. YOU WILL RECEIVE AN EMAIL WITH FURTHER INSTRUCTIONS. CONSTRUCTION ACTIVITIES SHALL NOT BEGIN UNTIL A GEC PERMIT HAS BEEN OBTAINED FOR ADDITIONAL INFORMATION, CALL (719) 355-5980.

20. NO CONCRETE OR INSTALLED BATCH PLANTS, MESSY WORK ARE PLANNED FOR THIS PROJECT. NONE ARE INTENDED TO BE MAINTAINED OR INSTALLED IN CONJUNCTION WITH THIS PROJECT.

21. NON-STRUCTURAL CONTROLS ARE SUCH MEASURES AS EDUCATION, SITE PLANNING, AND STORMWATER MANAGEMENT REGULATIONS IN ADDITION TO SEEDING AND GOOD HOUSEKEEPING.

QUANTITIES

ITEM	UNIT	AMOUNT	REMARKS
ROCK SOCK	EA	50	(ROCK SOCKS WILL BE USED DAILY)
SEEDING AND MULCHING	AC	2.54	
PAINT PROTECTION	EA	1.0	

THIS PROJECT IS DEEMED FROM ASSURANCES.

LEGEND

- AS-BUILT TIP GAS MAIN
- AS-BUILT GAS MAIN
- EXISTING TIP GAS MAIN
- EXISTING GAS MAIN
- EXISTING GAS SERVICE
- GAS LINE TO BE ABANDONED
- GAS LIGHT
- GAS VALVE
- EXCESS FLOW VALVE
- RELIEF VALVE
- COUPLINGS
- BOND OVER
- TEST POINT
- INSULATOR
- REGULATOR STATION
- MONITORS
- ANCHOR
- SOCK
- METER SET ASSEMBLY
- PLUG POINT
- BRANCH OFF LINE STOPPER
- PROPOSED TIP GAS MAIN
- PROPOSED GAS SERVICE
- PROPOSED CHIMNEY/POLE
- EXISTING EXHAUST
- PROPOSED DRAINAGE
- ROW LINE
- PROPERTY LINE
- STREET CENTERLINE
- EDGE OF PAVEMENT
- CONCRETE/SHALT
- CABLE LINE - UNDERGROUND
- ELECTRIC - OVERHEAD
- ELECTRIC - UNDERGROUND
- FIBER/OPTIC - UNDERGROUND
- PHONE - OVERHEAD
- PHONE - UNDERGROUND
- RECLAIMED WATER
- SEWER
- STORMWATER
- PROPOSED STORMWATER
- WATER
- FENCE LINE
- UTILITY FEEDBACKS
- FIRE HYDRANT
- MANHOLE
- WATER VALVE
- SURVEY MONUMENT
- POWER POLE
- TRAFFIC SIGNAL
- GAS FLOW ARROW

ABBREVIATIONS

SYMBOL	DESCRIPTION
AS-BUILT TIP GAS MAIN	AS-BUILT TIP GAS MAIN
AS-BUILT GAS MAIN	AS-BUILT GAS MAIN
EXISTING TIP GAS MAIN	EXISTING TIP GAS MAIN
EXISTING GAS MAIN	EXISTING GAS MAIN
EXISTING GAS SERVICE	EXISTING GAS SERVICE
GAS LINE TO BE ABANDONED	GAS LINE TO BE ABANDONED
GAS LIGHT	GAS LIGHT
GAS VALVE	GAS VALVE
EXCESS FLOW VALVE	EXCESS FLOW VALVE
RELIEF VALVE	RELIEF VALVE
COUPLINGS	COUPLINGS
BOND OVER	BOND OVER
TEST POINT	TEST POINT
INSULATOR	INSULATOR
REGULATOR STATION	REGULATOR STATION
MONITORS	MONITORS
ANCHOR	ANCHOR
SOCK	SOCK
METER SET ASSEMBLY	METER SET ASSEMBLY
PLUG POINT	PLUG POINT
BRANCH OFF LINE STOPPER	BRANCH OFF LINE STOPPER
PROPOSED TIP GAS MAIN	PROPOSED TIP GAS MAIN
PROPOSED GAS SERVICE	PROPOSED GAS SERVICE
PROPOSED CHIMNEY/POLE	PROPOSED CHIMNEY/POLE
EXISTING EXHAUST	EXISTING EXHAUST
PROPOSED DRAINAGE	PROPOSED DRAINAGE
ROW LINE	ROW LINE
PROPERTY LINE	PROPERTY LINE
STREET CENTERLINE	STREET CENTERLINE
EDGE OF PAVEMENT	EDGE OF PAVEMENT
CONCRETE/SHALT	CONCRETE/SHALT
CABLE LINE - UNDERGROUND	CABLE LINE - UNDERGROUND
ELECTRIC - OVERHEAD	ELECTRIC - OVERHEAD
ELECTRIC - UNDERGROUND	ELECTRIC - UNDERGROUND
FIBER/OPTIC - UNDERGROUND	FIBER/OPTIC - UNDERGROUND
PHONE - OVERHEAD	PHONE - OVERHEAD
PHONE - UNDERGROUND	PHONE - UNDERGROUND
RECLAIMED WATER	RECLAIMED WATER
SEWER	SEWER
STORMWATER	STORMWATER
PROPOSED STORMWATER	PROPOSED STORMWATER
WATER	WATER
FENCE LINE	FENCE LINE
UTILITY FEEDBACKS	UTILITY FEEDBACKS
FIRE HYDRANT	FIRE HYDRANT
MANHOLE	MANHOLE
WATER VALVE	WATER VALVE
SURVEY MONUMENT	SURVEY MONUMENT
POWER POLE	POWER POLE
TRAFFIC SIGNAL	TRAFFIC SIGNAL
GAS FLOW ARROW	GAS FLOW ARROW



PRC ENGINEERING
1835 W. UTAH STREET, SUITE 114
COLORADO SPRINGS, CO 80904
www.PRCEng.com (719) 251-9274



PRC ENGINEERING
1835 W. UTAH STREET, SUITE 114
COLORADO SPRINGS, CO 80904
www.PRCEng.com (719) 251-9274

REVISIONS:
SHEET NO. 2 OF 19
PROJECT NUMBER:
PROJECT MAP:
FAMILY NUMBER:
FAMILY ORDER NUMBER: 3988813
(PROJECT RELATED INFORMATION)

CONTRACTOR:
INSPECTOR:
FORWARD:
DATE COMPLETED:
DATE STARTED:
(AS BUILT INFORMATION)

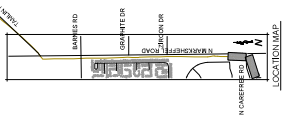
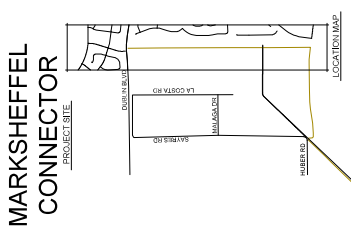
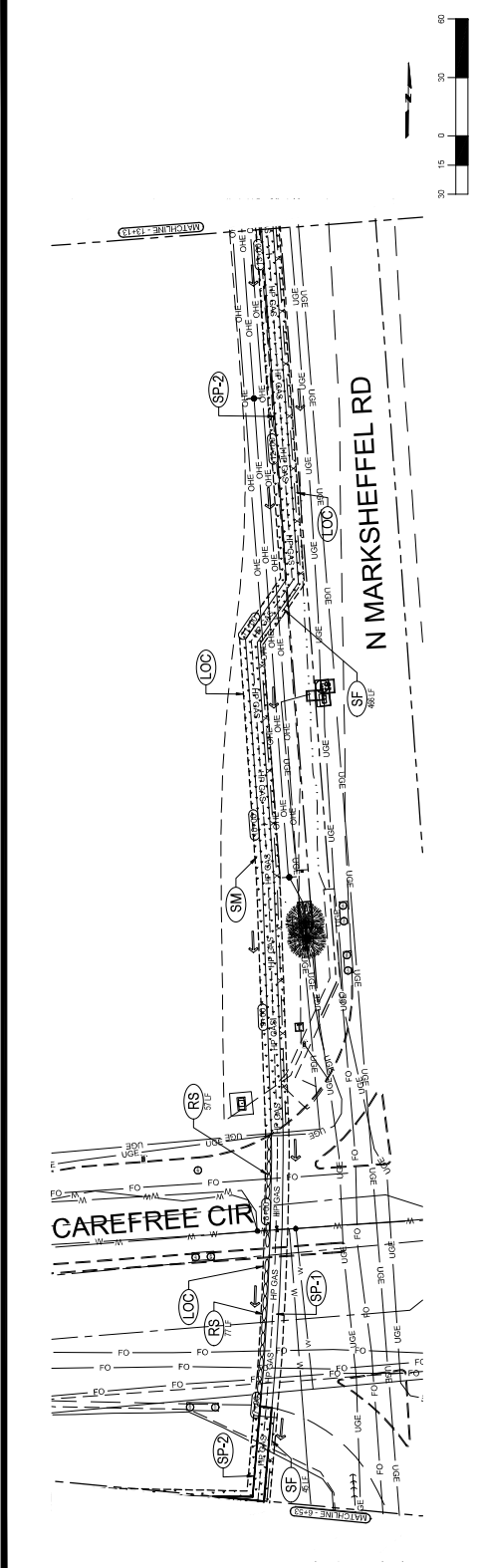
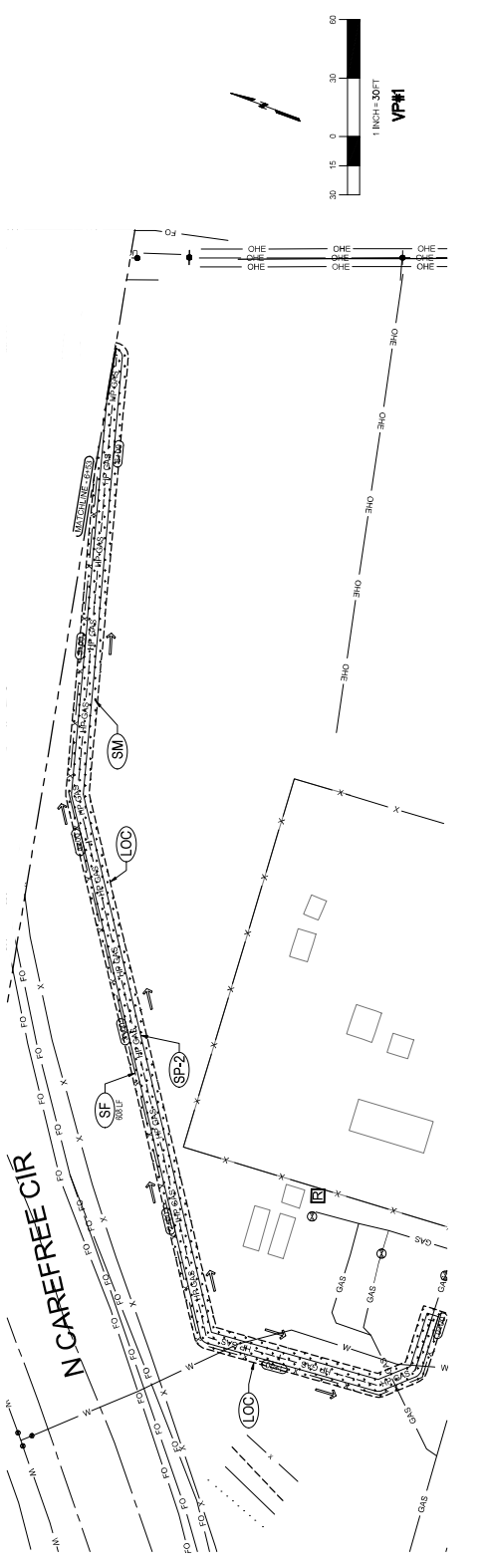

LEGEND

---	EXISTING ROW/PROPERTY LINE	⊙	EXISTING SANITARY SEWER
---	EXISTING CURB LINE	⊙	EXISTING WATER
⊙	SEEDING AND MULCHING	⊙	SILT FENCE
⊙	MATERIALS STAGING	⊙	SOIL DISTURBANCE AREA
⊙	ROCK SOCK	⊙	EXISTING FLOW DIRECTION
⊙	LIMITS OF CONSTRUCTION/LIMITS OF DISTURBANCE	⊙	
⊙	INLET PROTECTION		

(PROJECT RELATED INFORMATION)

PARENT WORK ORDER NUMBER: 398813
PROJECT NUMBER:
DATE: 03/27/24
DESIGN BY: REP
CHECKED BY: [Signature]
DATE: 03/27/24
FIELD ENGINEER:
WORK TYPE: CAPITAL
ACTIVITY CODE:

REVISIONS:

NO.	DATE	DESCRIPTION

GRADING, EROSION, AND SEDIMENT CONTROL
MARKSHEFFEL CONNECTOR
16IN HIGH PRESSURE MAIN

Colorado Springs Utilities
It's how we're all connected

INSERT TASK:

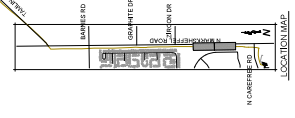
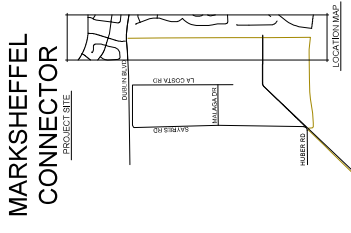
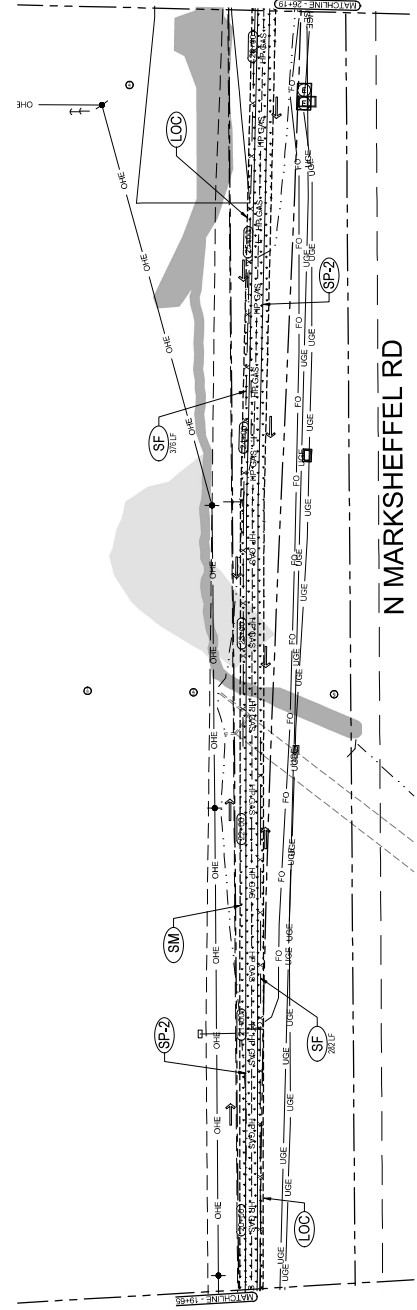
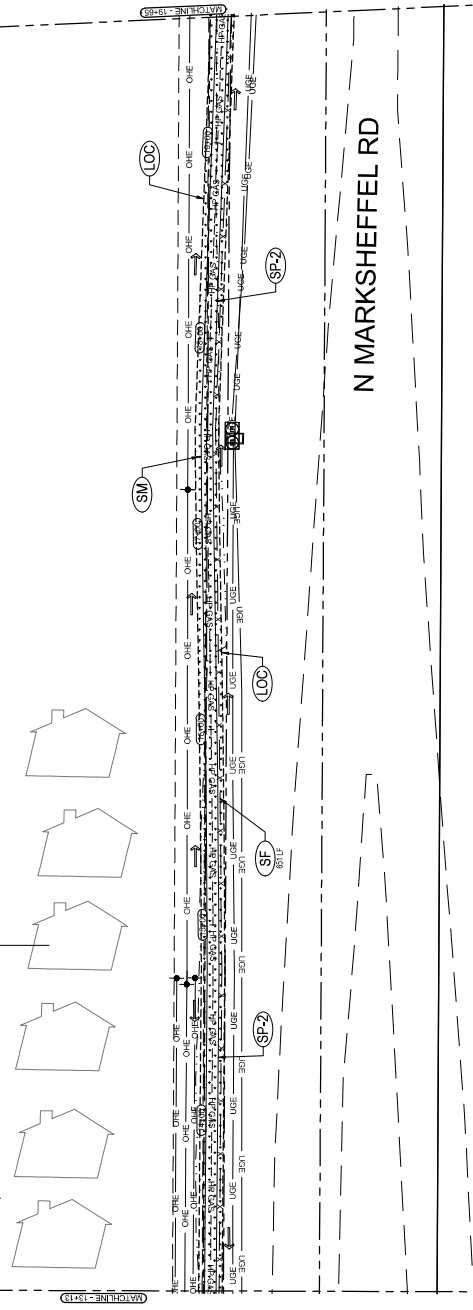

LEGEND

---	EXISTING ROW/PROPERTY LINE	---	EXISTING SANITARY SEWER
---	EXISTING CURB LINE	---	EXISTING WATER
---	SEEDING AND MULCHING	---	SILT FENCE
---	MATERIALS STAGING	---	SOIL DISTURBANCE AREA
---	ROCK SOCK	---	EXISTING FLOW DIRECTION
---	LIMITS OF CONSTRUCTION/LIMITS OF DISTURBANCE	---	
---	INLET PROTECTION	---	

(PROJECT RELATED INFORMATION)

PARENT WORK ORDER NUMBER: 398813
PROJECT NUMBER:
FINIS MAP:
SHEET NO. 4 OF 19

DESIGN BY: REP
 DRAWN BY: S
 CHECKED BY: S
 FIELD ENGINEER: S
 WORK TYPE: CAPITAL
 ACTIVITY CODE:

Colorado Springs Utilities
It's how we're all connected

DATE: 03/27/24
 SHEET: 4 OF 19

GRADING, EROSION, AND SEDIMENT CONTROL
MARKSHEFFEL CONNECTOR
16IN HIGH PRESSURE MAIN

INSERT TASKI

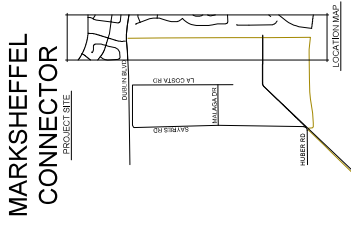
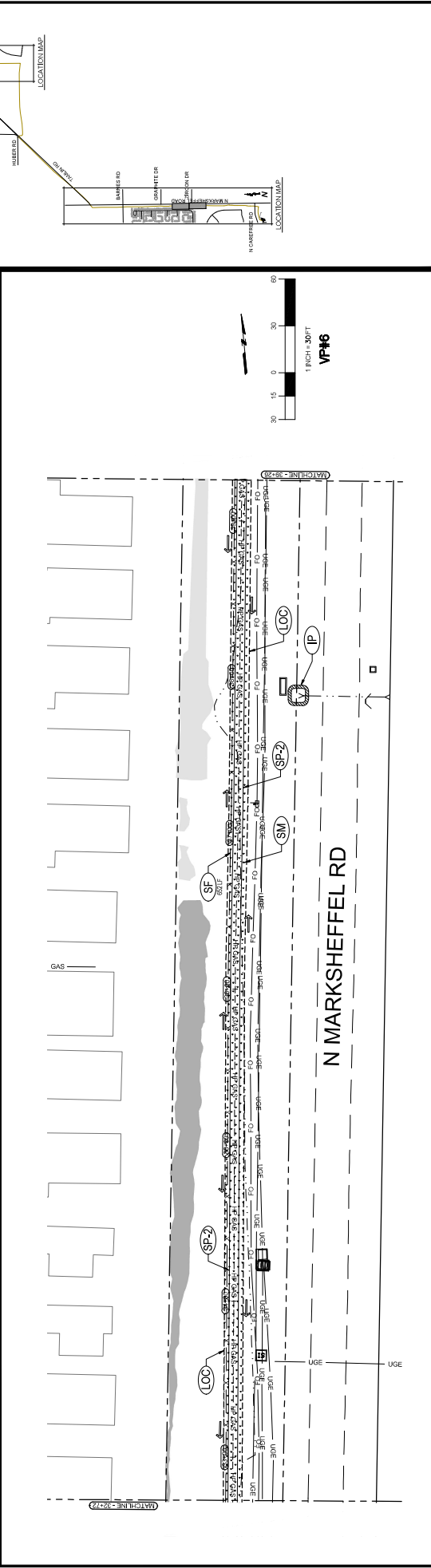
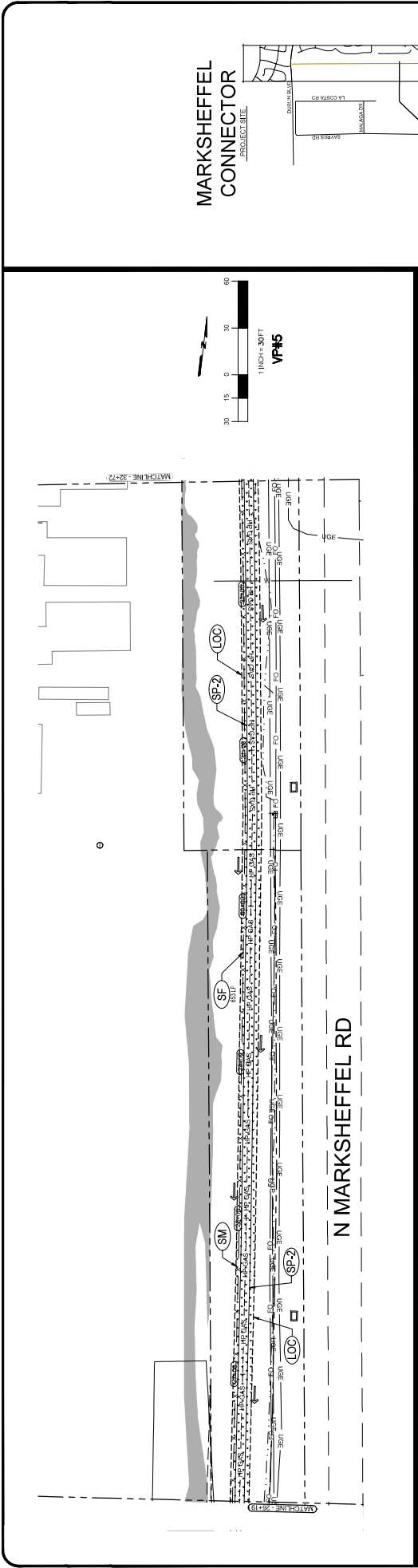

LEGEND

	EXISTING ROW/PROPERTY LINE
	EXISTING CURB LINE
	SEEDING AND MULCHING
	MATERIALS STAGING
	ROCK SOCK
	LIMITS OF CONSTRUCTION/LIMITS OF DISTURBANCE
	INLET PROTECTION
	EXISTING SANITARY SEWER
	EXISTING WATER
	SOIL DISTURBANCE AREA
	EXISTING FLOW DIRECTION

REVISIONS:

NO.	DATE	DESCRIPTION
1	03/27/24	ISSUE FOR PERMIT

(PROJECT RELATED INFORMATION)

PARENT WORK ORDER NUMBER:	3988813
PROJECT NUMBER:	
DATE:	03/27/24
SHEET NO.:	5 OF 19

Colorado Springs Utilities
It's how we're all connected!

DESIGN BY: REP
CHECKED BY: [blank]
DATE: 03/27/24

FIELD ENGINEER: [blank]
WORK TYPE: CAPITAL
ACTIVITY CODE: [blank]

GRADING, EROSION, AND SEDIMENT CONTROL
MARKSHEFFEL CONNECTOR
16IN HIGH PRESSURE MAIN

INSERT TASK!

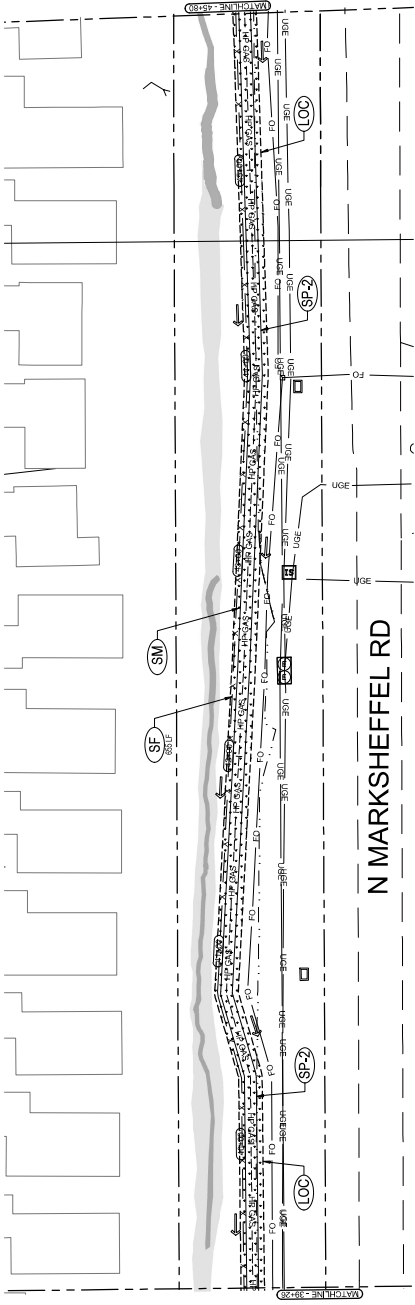

MARKSHEFFEL CONNECTOR PROJECT SITE

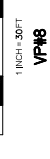
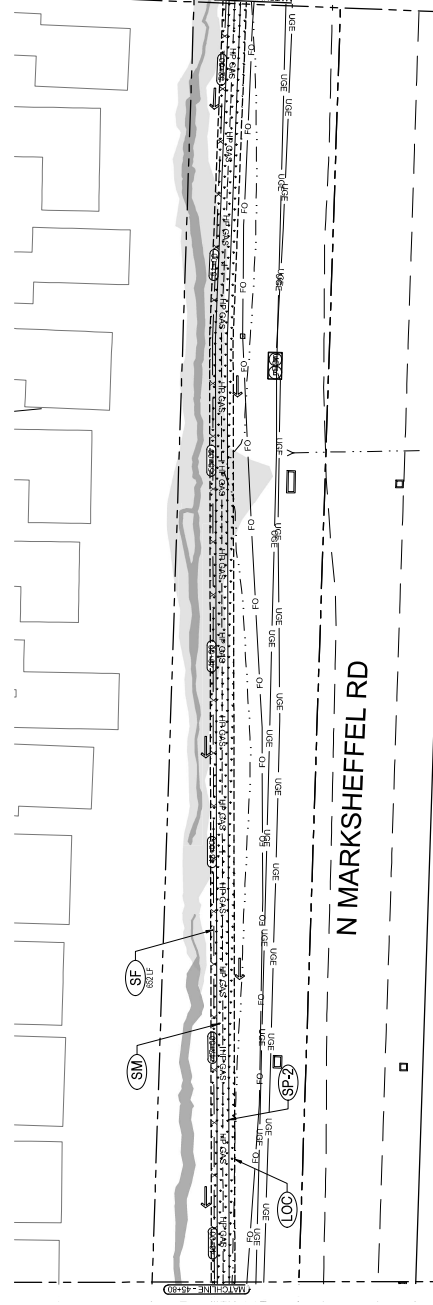
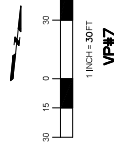
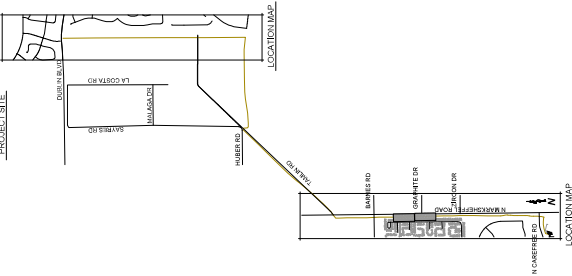

LEGEND

---	EXISTING ROW/PROPERTY LINE	---	EXISTING SANITARY SEWER
---	EXISTING CURB LINE	---	EXISTING WATER
---	SEEDING AND MULCHING	---	SILT FENCE
---	MATERIALS STAGING	---	SOIL DISTURBANCE AREA
---	ROCK SOCK	---	EXISTING FLOW DIRECTION
---	LIMITS OF CONSTRUCTION/LIMITS OF DISTURBANCE	---	
---	INLET PROTECTION		

(PROJECT RELATED INFORMATION)

PARENT WORK ORDER NUMBER: 3988813
PROJECT NUMBER:
FINIS MAP:
SHEET NO. 6 OF 19

REVISIONS:

DATE	BY	REVISION
03/27/24		1.1. Now works all connected

Colorado Springs Utilities
It's how we're all connected

DESIGN BY: REP
CHECKED BY:
DRAWN BY:
FIELD ENGINEER:
WORK TYPE: CAPITAL
ACTIVITY CODE:

**GRADING, EROSION, AND SEDIMENT CONTROL
MARKSHEFFEL CONNECTOR
16IN HIGH PRESSURE MAIN**

INSERT TASKI

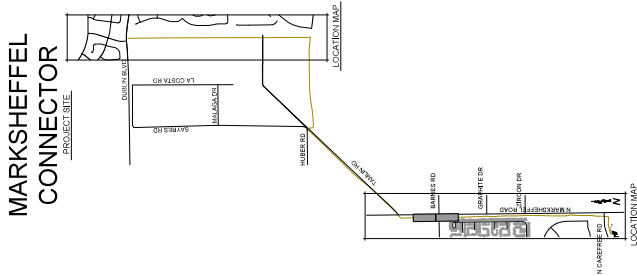
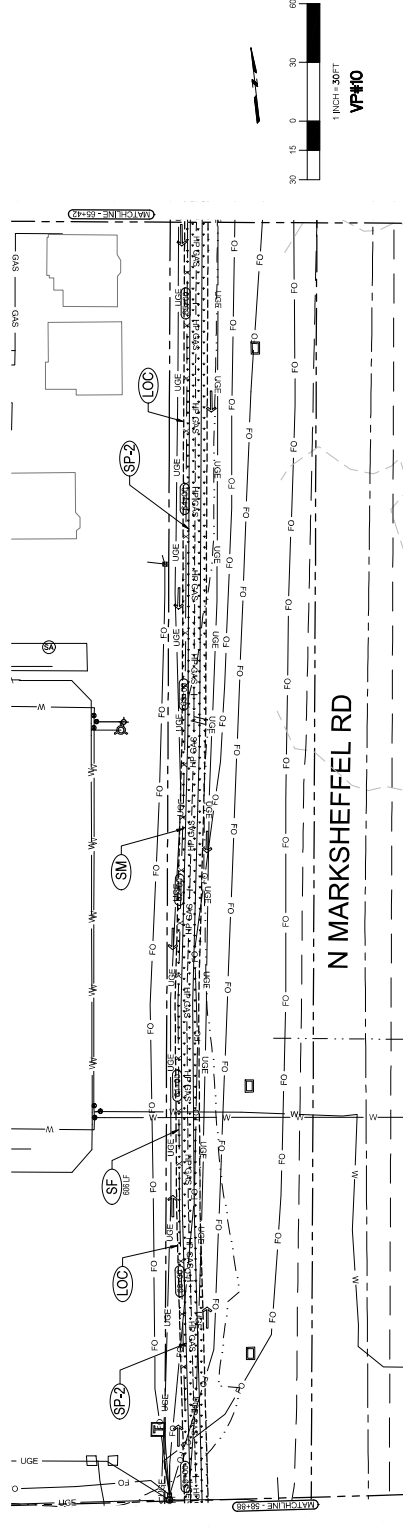
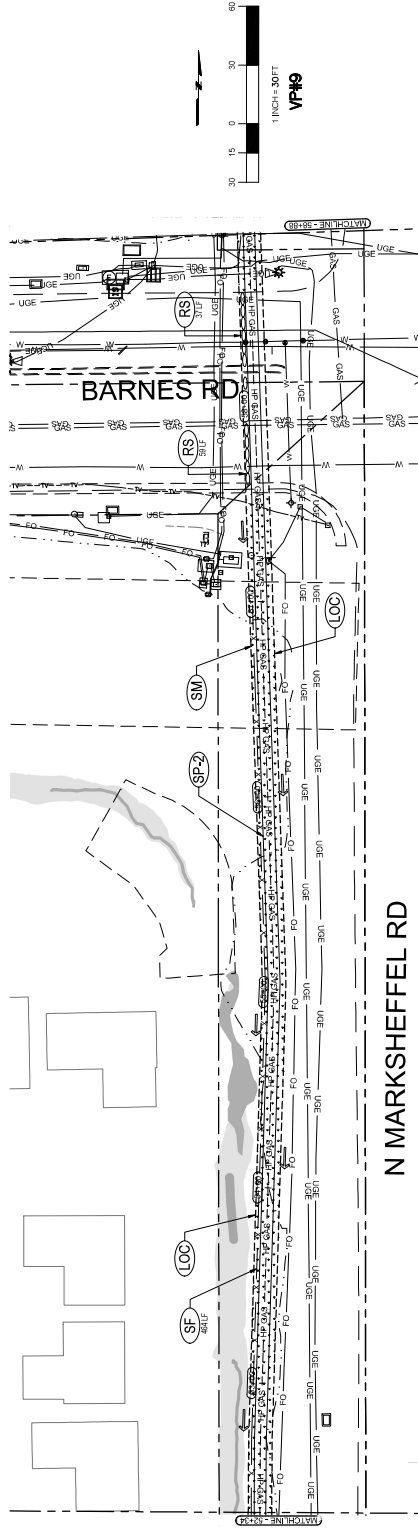

LEGEND

	EXISTING ROW/PROPERTY LINE		EXISTING SANITARY SEWER
	EXISTING CURB LINE		EXISTING WATER
	SEEDING AND MULCHING		ROCK SOCK
	MATERIALS STAGING		LIMITS OF CONSTRUCTION/LIMITS OF DISTURBANCE
	SOIL DISTURBANCE AREA		INLET PROTECTION
	EXISTING FLOW DIRECTION		

REVISIONS:

NO.	DATE	DESCRIPTION
1	07/27/24	DESIGN BY: REP
2		DESIGNED BY: SAKIBAD BY: FIELD ENGINEER
3		WORK TYPE: CAPITAL
4		ACTIVITY CODE:

(PROJECT RELATED INFORMATION)

PARENT WORK ORDER NUMBER: 398813
PROJECT NUMBER:
FINIS MAP:
SHEET NO. 7 OF 19

Colorado Springs Utilities
It's how we're all connected

GRADING, EROSION, AND SEDIMENT CONTROL
MARKSHEFFEL CONNECTOR
16IN HIGH PRESSURE MAIN

INSERT TASKI

MARKSHEFFEL CONNECTOR

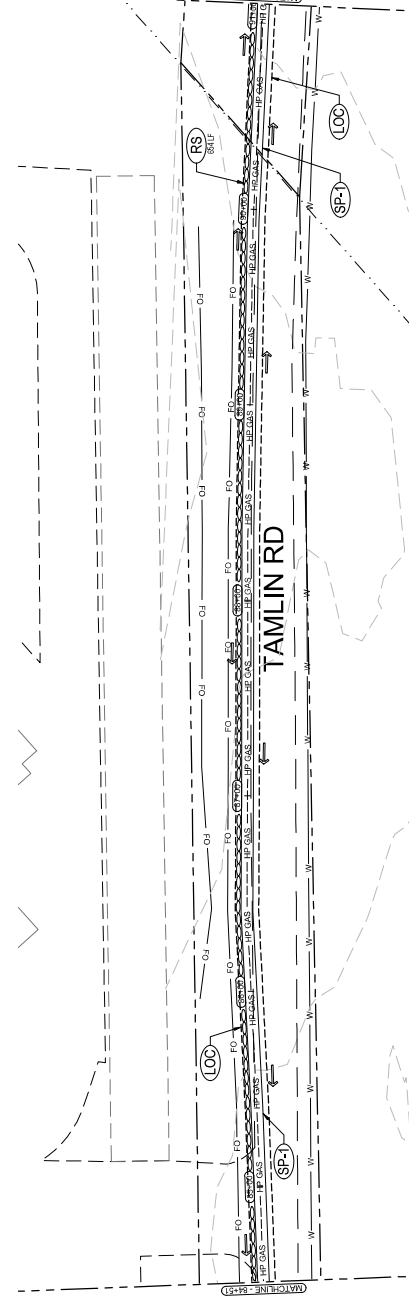
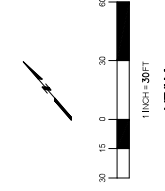
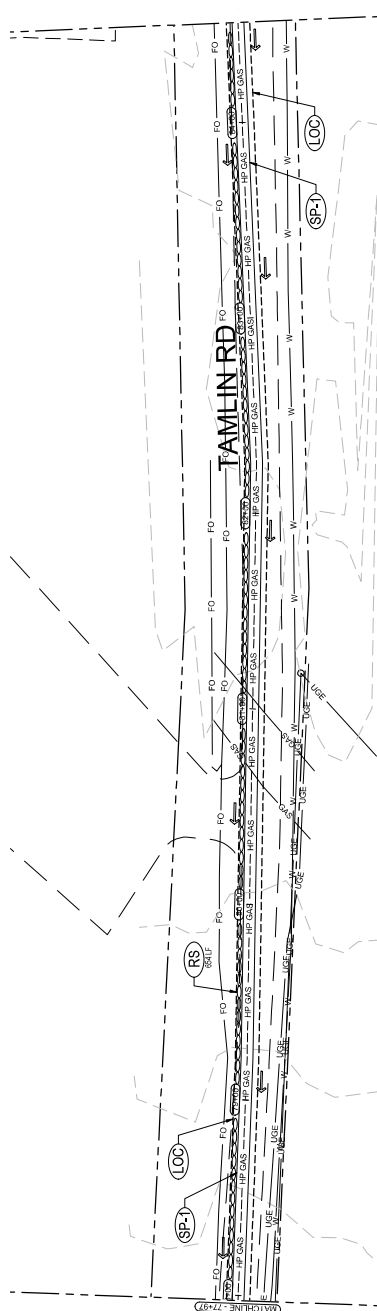
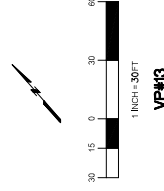
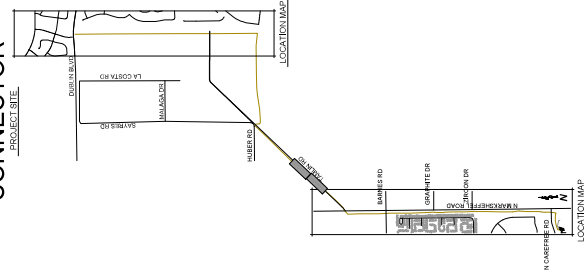

LEGEND

---	EXISTING ROW/PROPERTY LINE	---	EXISTING SANITARY SEWER
---	EXISTING CURB LINE	---	EXISTING WATER
---	SEEDING AND MULCHING	---	EXISTING FLOW DIRECTION
---	MATERIALS STAGING	---	SOIL DISTURBANCE AREA
---	ROCK SOCK	---	EXISTING FLOW DIRECTION
---	LIMITS OF CONSTRUCTION/LIMITS OF DISTURBANCE	---	
---	INLET PROTECTION	---	

REVISIONS:

NO.	DESCRIPTION

(PROJECT RELATED INFORMATION)

PARENT WORK ORDER NUMBER:	398813
PROJECT NUMBER:	
FINIS MAP:	
SHEET NO.:	9 OF 19

Colorado Springs Utilities
It's how we're all connected

DESIGN BY: REP
CHECKED BY: [Signature]
DATE: 03/27/24

FIELD ENGINEER: [Signature]
WORK TYPE: CAPITAL
ACTIVITY CODE: []

GRADING, EROSION, AND SEDIMENT CONTROL
MARKSHEFFEL CONNECTOR
16IN HIGH PRESSURE MAIN

INSERT TASKI

MARKSHEFFEL CONNECTOR

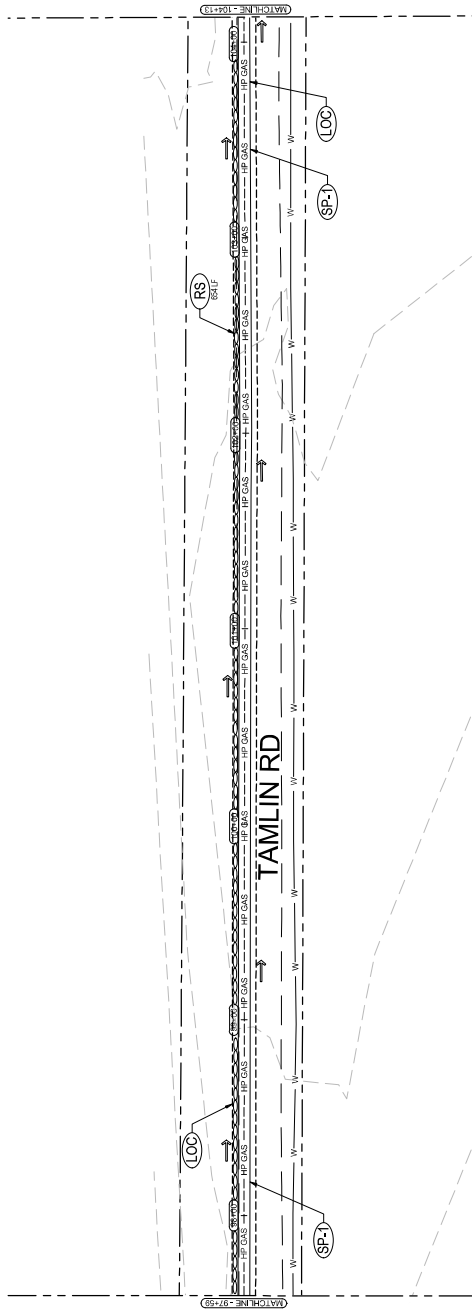
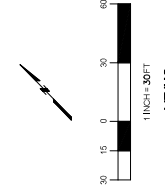
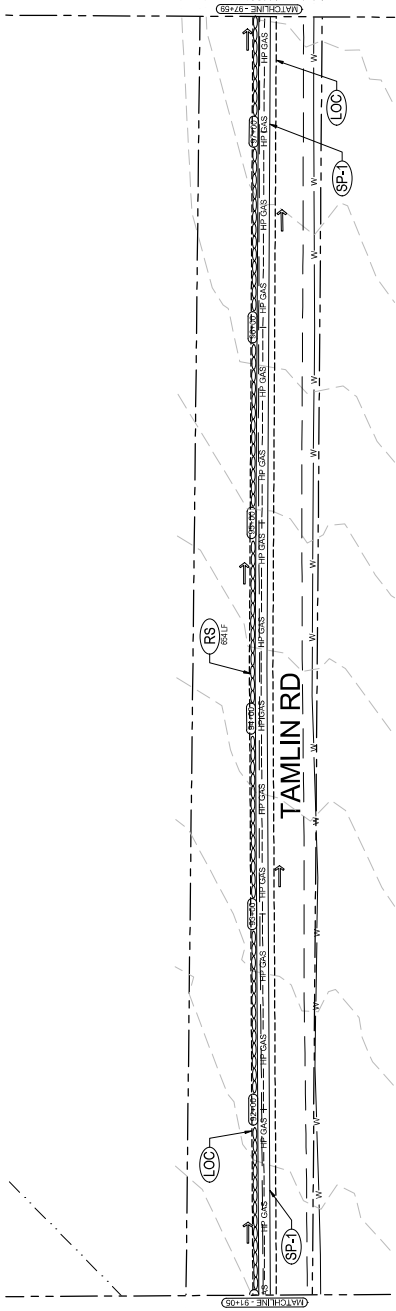
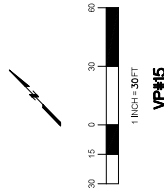
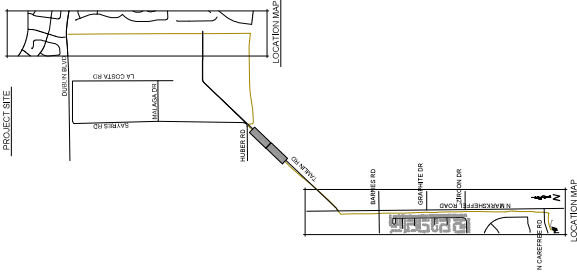

DESIGN BY: REP		DATE: 03/27/24
DRAWN BY: [Redacted]		DATE: --
CHECKED BY: [Redacted]		DATE: --
FIELD ENGINEER: [Redacted]		DATE: --
WORK TYPE: CAPITAL		
ACTIVITY CODE:		

(PROJECT RELATED INFORMATION)	
PARENT WORK ORDER NUMBER: 398813	
PROJECT NUMBER:	
PLANS MAP:	
SHEET NO. 10 OF 19	
REVISIONS:	

EXISTING ROW/PROPERTY LINE	---
EXISTING CURB LINE	---
SEEDING AND MULCHING	(SM)
MATERIALS STAGING	(SP-1) (SP-2)
ROCK SOCK	(RS)
LIMITS OF CONSTRUCTION/LIMITS OF DISTURBANCE	(LOC)
INLET PROTECTION	(IP)
EXISTING SANITARY SEWER	(W)
EXISTING WATER	(X)
SILT FENCE	(SF)
SOIL DISTURBANCE AREA	(S)
EXISTING FLOW DIRECTION	(→)

GRADING, EROSION, AND SEDIMENT CONTROL
MARKSHEFFEL CONNECTOR
16IN HIGH PRESSURE MAIN

INSERT TASKI

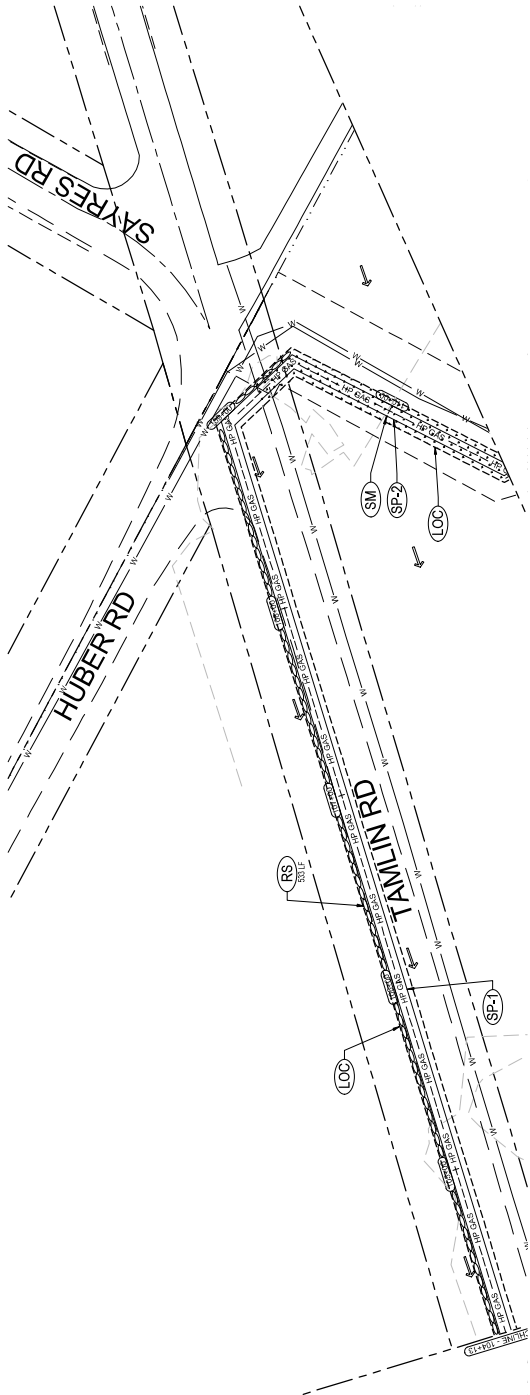

MARKSHEFFEL CONNECTOR
PROJECT SITE

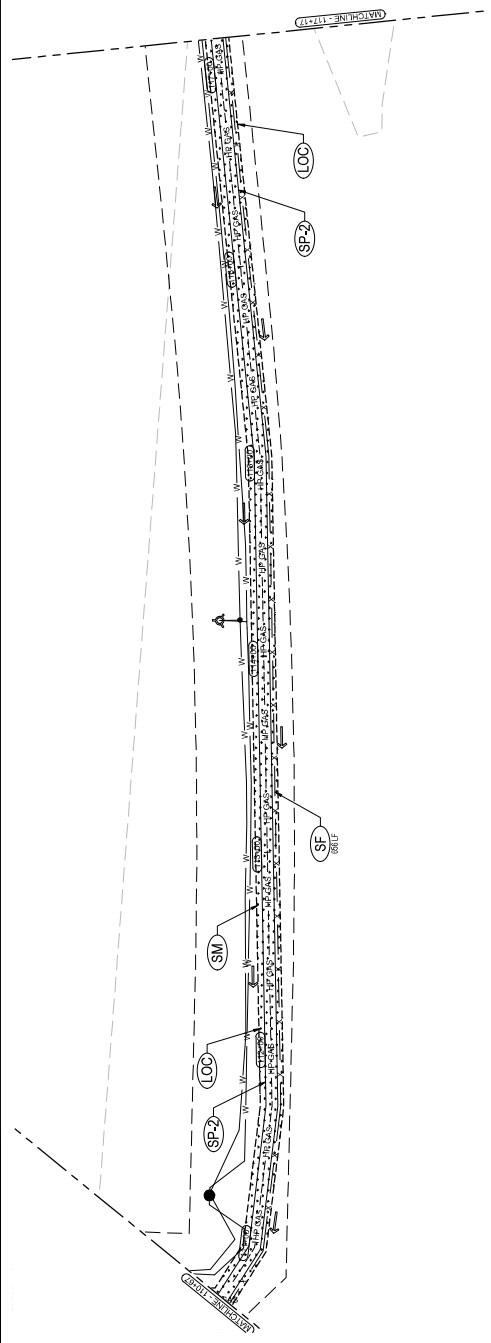
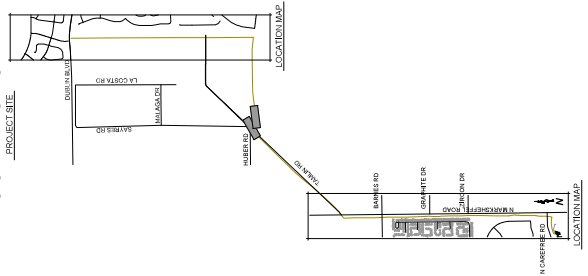

LEGEND

---	EXISTING ROW/PROPERTY LINE	---	EXISTING SANITARY SEWER
---	EXISTING CURB LINE	---	EXISTING WATER
---	SEEDING AND MULCHING	---	SILT FENCE
---	MATERIALS STAGING	---	SOIL DISTURBANCE AREA
---	ROCK SOCK	---	EXISTING FLOW DIRECTION
---	LIMITS OF CONSTRUCTION/LIMITS OF DISTURBANCE	---	
---	INLET PROTECTION	---	

(PROJECT RELATED INFORMATION)

PARENT WORK ORDER NUMBER: 398813
PROJECT NUMBER:
FINIS MAP:
SHEET NO. 11 OF 19

DESIGN BY: REP
 CHECKED BY: [REDACTED]
 DRAWN BY: [REDACTED]
 DATE: 03/27/24
 FIELD ENGINEER: [REDACTED]
 WORK TYPE: CAPITAL
 ACTIVITY CODE:

Colorado Springs Utilities
It's how we're all connected

GRADING, EROSION, AND SEDIMENT CONTROL
MARKSHEFFEL CONNECTOR
16IN HIGH PRESSURE MAIN

REVISIONS:

INSERT TASK!

MARKSHEFFEL CONNECTOR

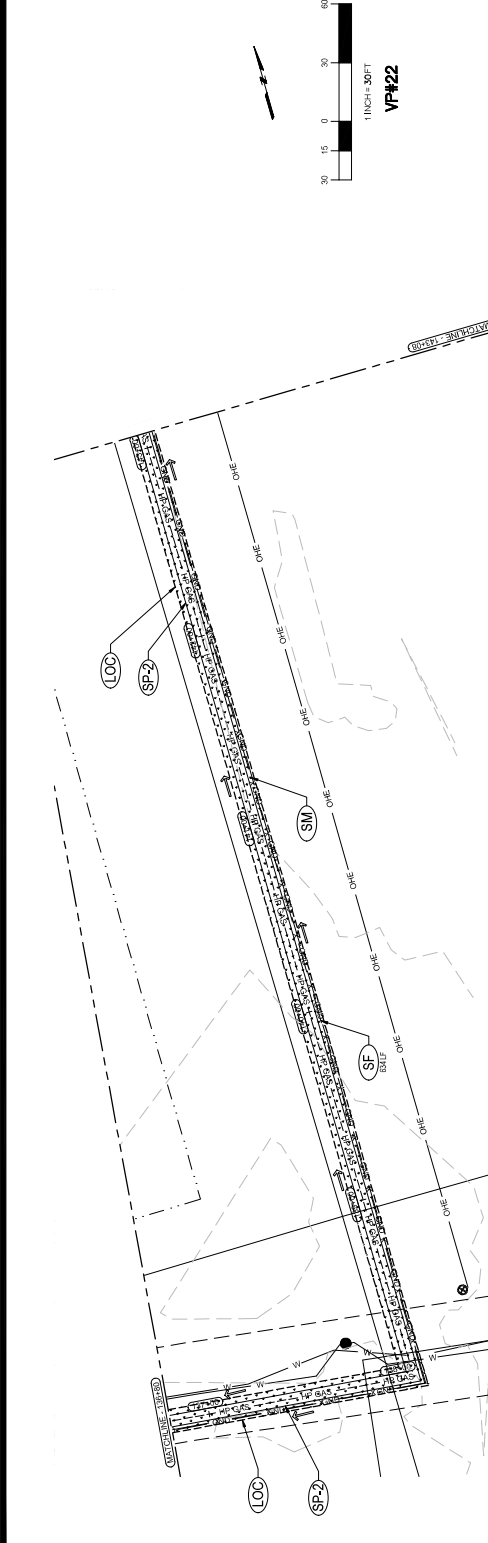
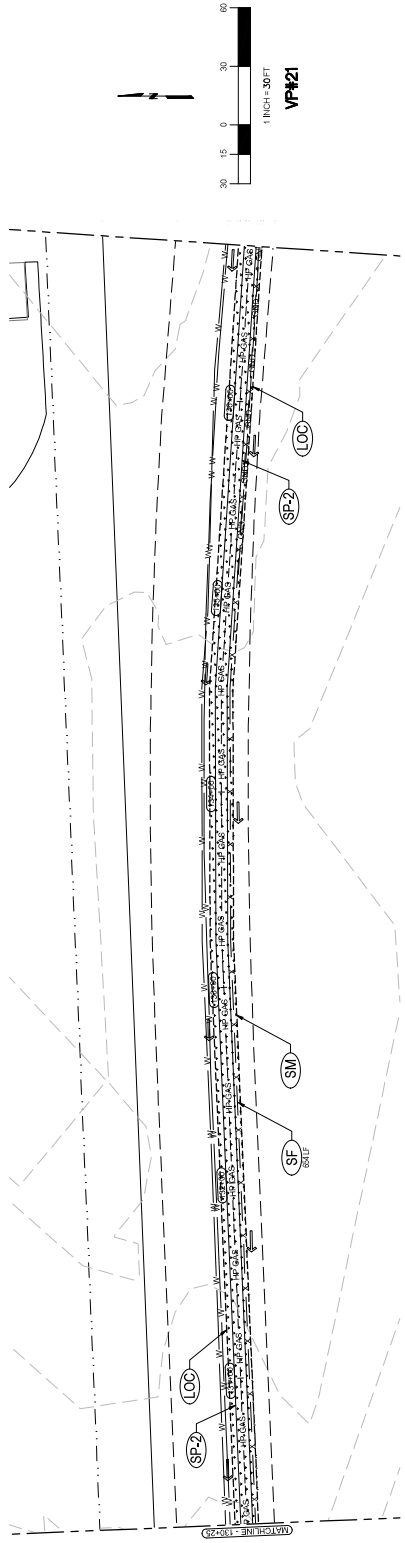
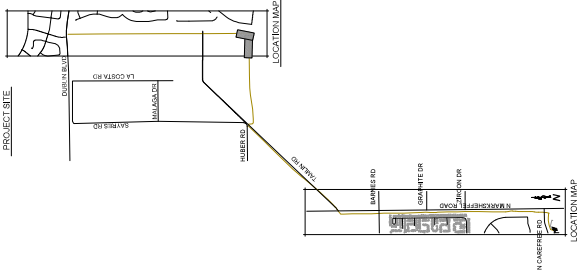

**GRADING, EROSION, AND SEDIMENT CONTROL
MARKSHEFFEL CONNECTOR
16IN HIGH PRESSURE MAIN**

(PROJECT RELATED INFORMATION)

PARENT WORK ORDER NUMBER: 3988813
PROJECT NUMBER:

FINIS MAP: 13 OF 19

SHEET NO. 13 OF 19

DESIGN BY: REP

DATE: 03/27/24

SKETCHED BY: [Redacted]

DATE: --

FIELD ENGINEER: [Redacted]

DATE: --

WORK TYPE: CAPITAL

ACTIVITY CODE:

REVISIONS:

LEGEND

- EXISTING ROW/PROPERTY LINE
- EXISTING CURB LINE
- EXISTING WATER
- SEEDING AND MULCHING
- MATERIALS STAGING
- ROCK SOCK
- LIMITS OF CONSTRUCTION/LIMITS OF DISTURBANCE
- INLET PROTECTION
- EXISTING SANITARY SEWER
- EXISTING WATER
- SILT FENCE
- SOIL DISTURBANCE AREA
- EXISTING FLOW DIRECTION

INSERT TASK:



MARKSHEFFEL CONNECTOR

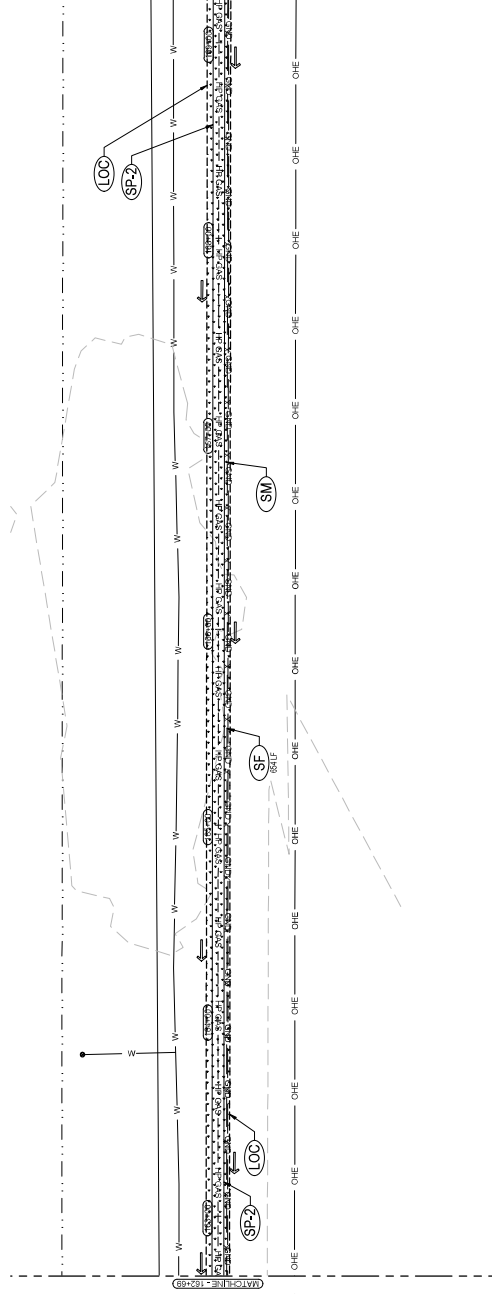
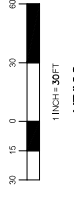
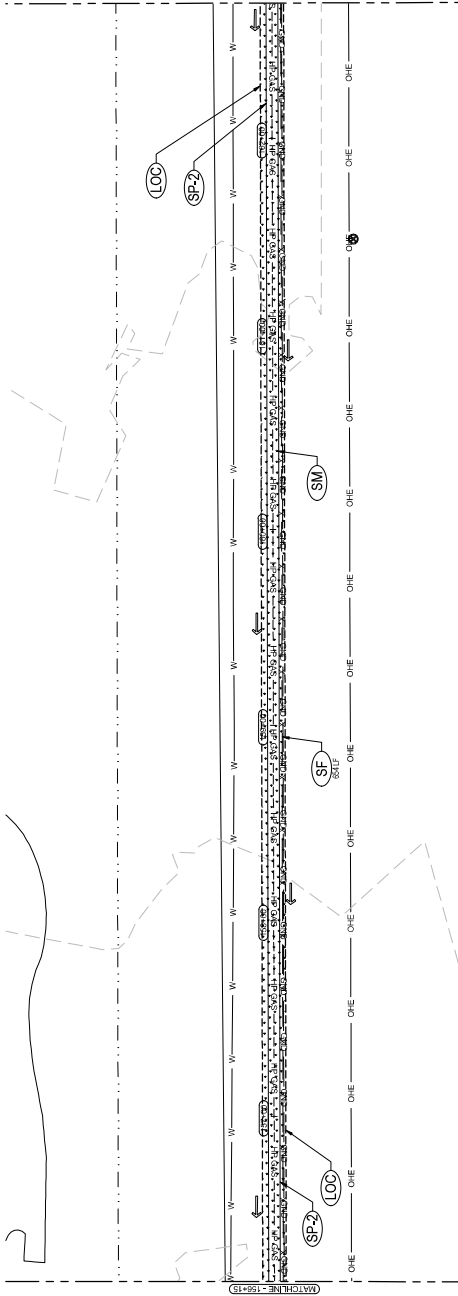
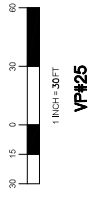
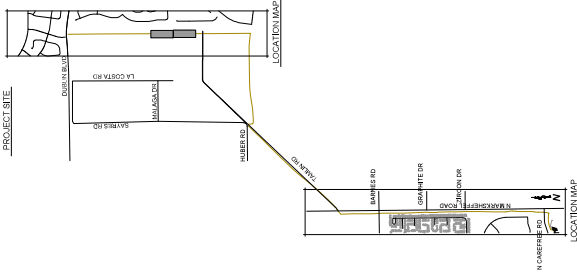

LEGEND

---	EXISTING ROW/PROPERTY LINE	⊙	EXISTING SANITARY SEWER
---	EXISTING CURB LINE	⊙	EXISTING WATER
---	SEEDING AND MULCHING	X	SILT FENCE
---	MATERIALS STAGING	→	SOIL DISTURBANCE AREA
---	ROCK SOCK	→	EXISTING FLOW DIRECTION
---	LIMITS OF CONSTRUCTION/LIMITS OF DISTURBANCE		
---	INLET PROTECTION		

(PROJECT RELATED INFORMATION)

PARENT WORK ORDER NUMBER: 398813
PROJECT NUMBER:
FINIS MAP: 15 OF 19
SHEET NO. 15 OF 19
DESIGN BY: REP
DRAWN BY: [Redacted]
CHECKED BY: [Redacted]
DATE: 03/27/24
FIELD ENGINEER:
WORK TYPE: CAPITAL
ACTIVITY CODE:

GRADING, EROSION, AND SEDIMENT CONTROL
MARKSHEFFEL CONNECTOR
16IN HIGH PRESSURE MAIN

Colorado Springs Utilities
It's how we're all connected

REVISIONS:

INSERT TASK:

MARKSHEFFEL CONNECTOR

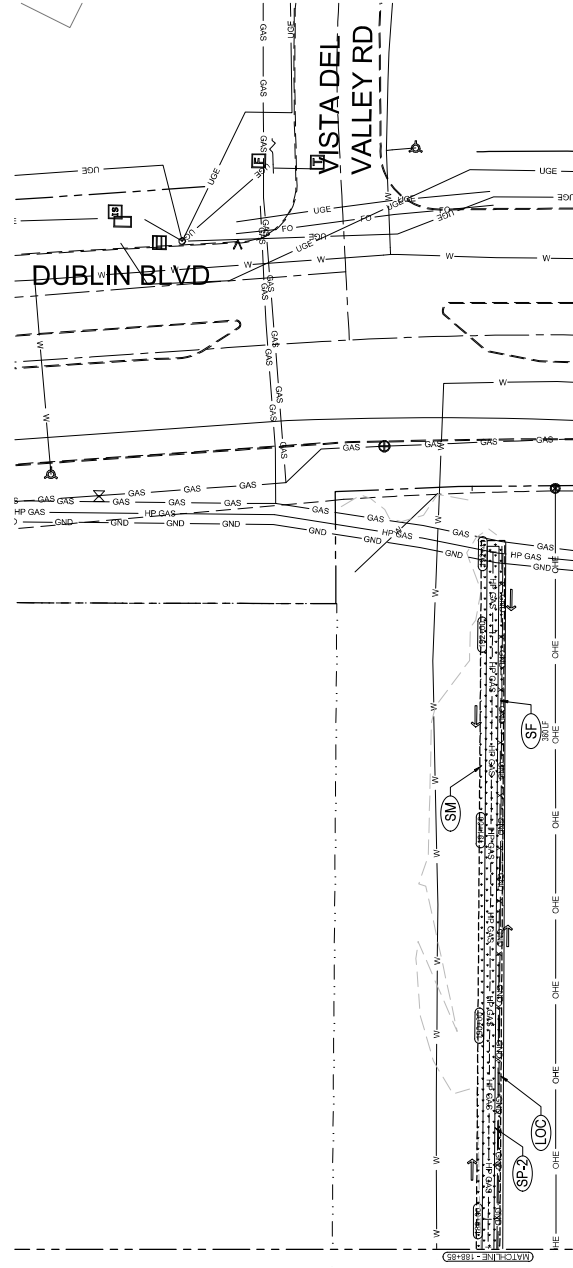
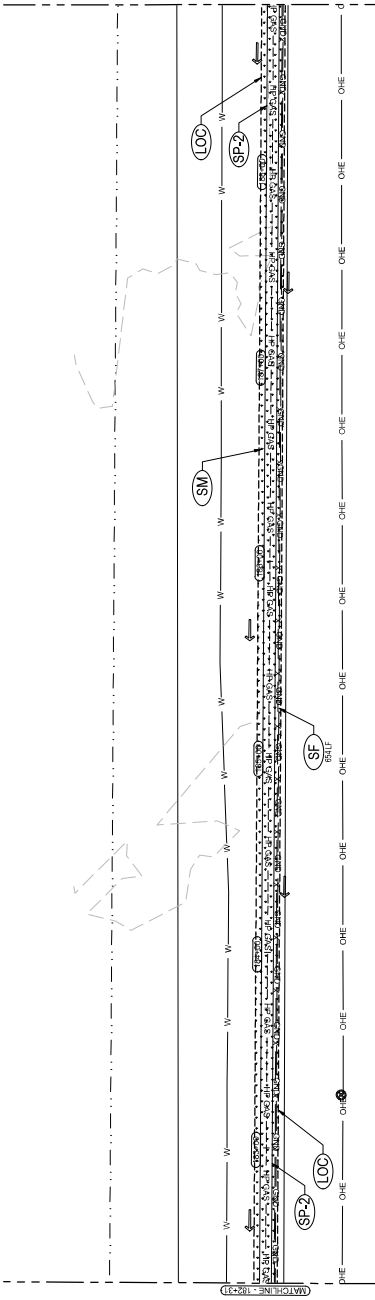
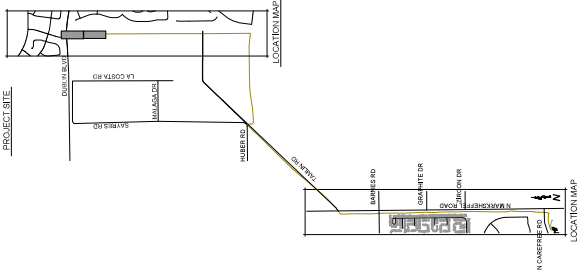

LEGEND

---	EXISTING ROW/PROPERTY LINE
---	EXISTING CURB LINE
---	EXISTING CURB AND WILCHING
---	SEEDING AND WILCHING
---	MATERIALS STAGING
---	ROCK SOCK
---	LIMITS OF CONSTRUCTION/LIMITS OF DISTURBANCE
---	INLET PROTECTION
---	EXISTING SANITARY SEWER
---	EXISTING WATER
---	SILT FENCE
---	SOIL DISTURBANCE AREA
---	EXISTING FLOW DIRECTION

(PROJECT RELATED INFORMATION)

PARENT WORK ORDER NUMBER:	398813
PROJECT NUMBER:	
FINIS MAP:	
SHEET NO.:	17 OF 19

DESIGN BY:	REP
CHECKED BY:	---
APPROVED BY:	---
DATE:	03/27/24
DATE:	---
DATE:	---
FIELD ENGINEER:	---
WORK TYPE:	UTILITY
ACTIVITY CODE:	---

GRADING, EROSION, AND SEDIMENT CONTROL

MARKSHEFFEL CONNECTOR

16IN HIGH PRESSURE MAIN

Colorado Springs Utilities
It's how we're all connected

INSERT TASK!

GRADING, EROSION, AND SEDIMENT CONTROL MARKSHEFFEL CONNECTOR
16IN HIGH PRESSURE MAN

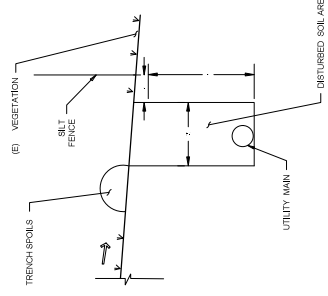

TYPICAL TRENCH SECTION
SP-2
NOT TO SCALE

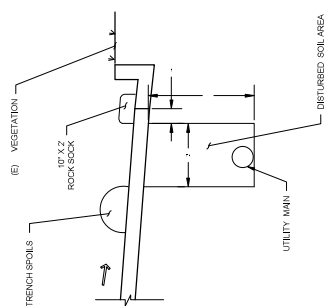

TYPICAL TRENCH SECTION
SP-3
NOT TO SCALE

- MATERIALS STAGING IN ROADWAY MAINTENANCE NOTES:**
- INSPECT BMP EACH WORKDAY, AND MAINTAIN THEM IN EFFECTIVE CONDITION. REMOVE ALL MATERIALS FROM THE ROADWAY. DO NOT RELOAD. INSPECT BMP AS SOON AS POSSIBLE (AND ALWAYS WITHIN 24 HOURS) FOLLOWING A STORM THAT CAUSES SURFACE EROSION, AND PERFORM NECESSARY MAINTENANCE.
 - FREQUENT OBSERVATIONS AND MAINTENANCE ARE NECESSARY TO PREVENT EROSION. RECORD ALL OBSERVATIONS AND CORRECTIVE MEASURES SHOULD BE DOCUMENTED THOROUGHLY.
 - WHERE BMPs HAVE FAILED, REPAIR OR REPLACEMENT SHOULD BE INITIATED UPON DISCOVERY OF THE FAILURE.
 - INSPECT PFC PIPE ALONG CURB LINE FOR CLOGGING AND DEBRIS. REMOVE OBSTRUCTIONS PROMPTLY.
 - CLEAN MATERIAL FROM PAVED SURFACES BY SWEEPING OR VACUUMING.
- NOTE: MANY JURISDICTIONS HAVE BMP DETAILS THAT VARY FROM USDC STANDARD DETAILS. CONSULT LOCAL JURISDICTIONS AS TO WHICH DETAIL SHOULD BE USED WHEN DIFFERENCES ARE NOTED.**



SC-1 Silt Fence (SF)

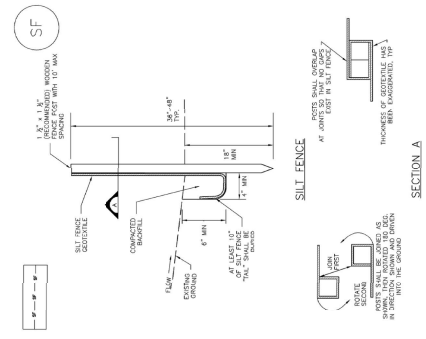

SECTION A
SF-1 SILT FENCE

November 2010 Urban Drainage and Flood Control District Urban Storm Drainage Criteria Manual Volume 3 SF-3

SC-5 Rock Sock (RS)

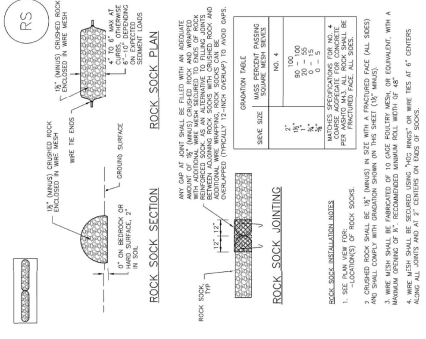

SECTION A
RS-1 ROCK SOCK PERIMETER CONTROL

November 2010 Urban Drainage and Flood Control District Urban Storm Drainage Criteria Manual Volume 3 RS-2

MM-2 Stockpile Management (SP)

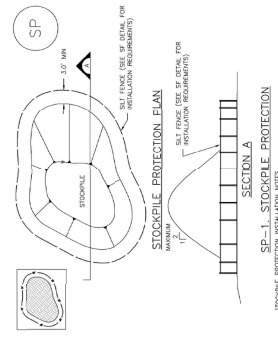

SECTION A
SP-1 STOCKPILE PROTECTION

November 2010 Urban Drainage and Flood Control District Urban Storm Drainage Criteria Manual Volume 3 SP-3

MM-2 Stockpile Management (SM)

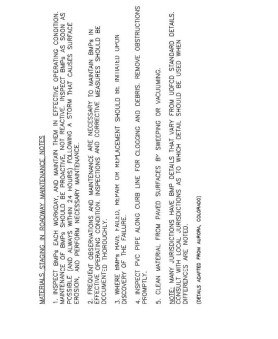

SECTION A
SM-1 STOCKPILE PERIMETER CONTROL

November 2010 Urban Drainage and Flood Control District Urban Storm Drainage Criteria Manual Volume 3 SM-2

GRADING, EROSION, AND SEDIMENT CONTROL MARKSHEFFEL CONNECTOR
16IN HIGH PRESSURE MAN

CONTRACTOR:
INSPECTOR:
FORWARD:
DATE COMPLETED:
DATE STARTED:

GRADING, EROSION AND SEDIMENT CONTROL MARKSHEFFEL CONNECTOR

(AS BUILT INFORMATION)

(PROJECT RELATED INFORMATION)

PARENT WORK ORDER NUMBER: 3988813
PROJECT NUMBER:
SHEET MAP:
SHEET NO: 19 OF 19
REVISIONS:



Inlet Protection (IP)

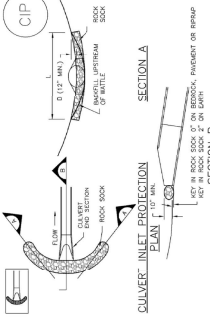

IP-1. CURB, GUTTER AND INLET PROTECTION

1. SEE SECTION 1.0 FOR GENERAL REQUIREMENTS AND JOINTING.

2. SEE SECTION 1.0 FOR CURB AND GUTTER REQUIREMENTS.

3. SEE SECTION 1.0 FOR ROCK SOCK REQUIREMENTS AND JOINTING.

4. SEE SECTION 1.0 FOR SILT FENCE REQUIREMENTS.

5. SEE SECTION 1.0 FOR SILT FENCE INSTALLATION.

6. SEE SECTION 1.0 FOR SILT FENCE MAINTENANCE.

7. SEE SECTION 1.0 FOR SILT FENCE REMOVAL.

8. SEE SECTION 1.0 FOR SILT FENCE REPAIR.

9. SEE SECTION 1.0 FOR SILT FENCE REPLACEMENT.

10. SEE SECTION 1.0 FOR SILT FENCE STORAGE.

11. SEE SECTION 1.0 FOR SILT FENCE DISPOSAL.

12. SEE SECTION 1.0 FOR SILT FENCE RECORDS.

August 2013 Urban Drainage and Flood Control District Urban Storm Drainage Criteria Manual Volume 3 IP-2

Inlet Protection (IP)

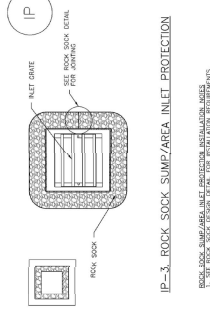

IP-3. ROCK SOCK SUMP/AREA INLET PROTECTION

1. SEE SECTION 1.0 FOR GENERAL REQUIREMENTS AND JOINTING.

2. SEE SECTION 1.0 FOR CURB AND GUTTER REQUIREMENTS.

3. SEE SECTION 1.0 FOR ROCK SOCK REQUIREMENTS AND JOINTING.

4. SEE SECTION 1.0 FOR SILT FENCE REQUIREMENTS.

5. SEE SECTION 1.0 FOR SILT FENCE INSTALLATION.

6. SEE SECTION 1.0 FOR SILT FENCE MAINTENANCE.

7. SEE SECTION 1.0 FOR SILT FENCE REMOVAL.

8. SEE SECTION 1.0 FOR SILT FENCE REPAIR.

9. SEE SECTION 1.0 FOR SILT FENCE REPLACEMENT.

10. SEE SECTION 1.0 FOR SILT FENCE STORAGE.

11. SEE SECTION 1.0 FOR SILT FENCE DISPOSAL.

12. SEE SECTION 1.0 FOR SILT FENCE RECORDS.

August 2013 Urban Drainage and Flood Control District Urban Storm Drainage Criteria Manual Volume 3 IP-3

SEEDING & MULCHING

1. ALL SEEDING, SOIL TREATMENT AND FERTILIZER DOCUMENTATION, AND SEED, FERTILIZER AND BAG TICKETS MUST BE KEPT IN THE COMPANY OFFICE.
2. SOIL PREPARATION SHALL BE DONE TO A DEPTH OF 6 INCHES.
3. SEEDING SHALL BE DONE TO A DEPTH OF 1/4 INCH.
4. MULCHING SHALL BE DONE TO A DEPTH OF 2 INCHES.
5. SEEDING SHALL BE DONE TO A DEPTH OF 1/4 INCH.
6. MULCHING SHALL BE DONE TO A DEPTH OF 2 INCHES.
7. SEEDING SHALL BE DONE TO A DEPTH OF 1/4 INCH.
8. MULCHING SHALL BE DONE TO A DEPTH OF 2 INCHES.
9. SEEDING SHALL BE DONE TO A DEPTH OF 1/4 INCH.
10. MULCHING SHALL BE DONE TO A DEPTH OF 2 INCHES.
11. SEEDING SHALL BE DONE TO A DEPTH OF 1/4 INCH.
12. MULCHING SHALL BE DONE TO A DEPTH OF 2 INCHES.

SEEDING & MULCHING

1. ALL SEEDING, SOIL TREATMENT AND FERTILIZER DOCUMENTATION, AND SEED, FERTILIZER AND BAG TICKETS MUST BE KEPT IN THE COMPANY OFFICE.

2. SOIL PREPARATION SHALL BE DONE TO A DEPTH OF 6 INCHES.

3. SEEDING SHALL BE DONE TO A DEPTH OF 1/4 INCH.

4. MULCHING SHALL BE DONE TO A DEPTH OF 2 INCHES.

5. SEEDING SHALL BE DONE TO A DEPTH OF 1/4 INCH.

6. MULCHING SHALL BE DONE TO A DEPTH OF 2 INCHES.

7. SEEDING SHALL BE DONE TO A DEPTH OF 1/4 INCH.

8. MULCHING SHALL BE DONE TO A DEPTH OF 2 INCHES.

9. SEEDING SHALL BE DONE TO A DEPTH OF 1/4 INCH.

10. MULCHING SHALL BE DONE TO A DEPTH OF 2 INCHES.

11. SEEDING SHALL BE DONE TO A DEPTH OF 1/4 INCH.

12. MULCHING SHALL BE DONE TO A DEPTH OF 2 INCHES.

August 2013 Urban Drainage and Flood Control District Urban Storm Drainage Criteria Manual Volume 3 IP-4

Block and Gravel Bag Curb Inlet Protection

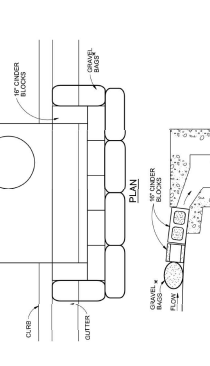

Block and Gravel Bag Curb Inlet Protection

1. SEE SECTION 1.0 FOR GENERAL REQUIREMENTS AND JOINTING.

2. SEE SECTION 1.0 FOR CURB AND GUTTER REQUIREMENTS.

3. SEE SECTION 1.0 FOR BLOCK AND GRAVEL BAG CURB REQUIREMENTS AND JOINTING.

4. SEE SECTION 1.0 FOR SILT FENCE REQUIREMENTS.

5. SEE SECTION 1.0 FOR SILT FENCE INSTALLATION.

6. SEE SECTION 1.0 FOR SILT FENCE MAINTENANCE.

7. SEE SECTION 1.0 FOR SILT FENCE REMOVAL.

8. SEE SECTION 1.0 FOR SILT FENCE REPAIR.

9. SEE SECTION 1.0 FOR SILT FENCE REPLACEMENT.

10. SEE SECTION 1.0 FOR SILT FENCE STORAGE.

11. SEE SECTION 1.0 FOR SILT FENCE DISPOSAL.

12. SEE SECTION 1.0 FOR SILT FENCE RECORDS.

August 2013 Urban Drainage and Flood Control District Urban Storm Drainage Criteria Manual Volume 3 IP-5

RECOMMENDED ANNUAL GRASSES

SPECIES (COMMON NAME)	SEASON	DATE	USDA ZONE	PLANTING DEPTH
1. BENT GRASS	WINTER	NOVEMBER 15 - FEBRUARY 15	USDA ZONE 4-9	1/2"
2. BLUEGRASS	WINTER	NOVEMBER 15 - FEBRUARY 15	USDA ZONE 4-9	1/2"
3. PERennial Ryegrass	WINTER	NOVEMBER 15 - FEBRUARY 15	USDA ZONE 4-9	1/2"
4. Fescue	WINTER	NOVEMBER 15 - FEBRUARY 15	USDA ZONE 4-9	1/2"
5. Tall Fescue	WINTER	NOVEMBER 15 - FEBRUARY 15	USDA ZONE 4-9	1/2"
6. Orchard Grass	WINTER	NOVEMBER 15 - FEBRUARY 15	USDA ZONE 4-9	1/2"
7. Kentucky Bluegrass	WINTER	NOVEMBER 15 - FEBRUARY 15	USDA ZONE 4-9	1/2"
8. Winter Wheat	WINTER	NOVEMBER 15 - FEBRUARY 15	USDA ZONE 4-9	1/2"
9. Annual Ryegrass	WINTER	NOVEMBER 15 - FEBRUARY 15	USDA ZONE 4-9	1/2"
10. Winter Rye	WINTER	NOVEMBER 15 - FEBRUARY 15	USDA ZONE 4-9	1/2"
11. Winter Triticale	WINTER	NOVEMBER 15 - FEBRUARY 15	USDA ZONE 4-9	1/2"
12. Winter Barley	WINTER	NOVEMBER 15 - FEBRUARY 15	USDA ZONE 4-9	1/2"

TABLE TS-1

TEMPORARY SEEDING NOTES

1. INSTALLATION REQUIREMENTS.
2. MAINTENANCE REQUIREMENTS.
3. SEEDING REQUIREMENTS.
4. MULCHING REQUIREMENTS.
5. SEEDING REQUIREMENTS.
6. MULCHING REQUIREMENTS.
7. SEEDING REQUIREMENTS.
8. MULCHING REQUIREMENTS.
9. SEEDING REQUIREMENTS.
10. MULCHING REQUIREMENTS.
11. SEEDING REQUIREMENTS.
12. MULCHING REQUIREMENTS.

August 2013 Urban Drainage and Flood Control District Urban Storm Drainage Criteria Manual Volume 3 IP-6

Curb Rock Socks Upstream of Inlet Protection

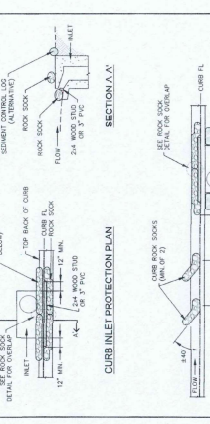

Curb Rock Socks Upstream of Inlet Protection

1. SEE SECTION 1.0 FOR GENERAL REQUIREMENTS AND JOINTING.

2. SEE SECTION 1.0 FOR CURB AND GUTTER REQUIREMENTS.

3. SEE SECTION 1.0 FOR ROCK SOCK REQUIREMENTS AND JOINTING.

4. SEE SECTION 1.0 FOR SILT FENCE REQUIREMENTS.

5. SEE SECTION 1.0 FOR SILT FENCE INSTALLATION.

6. SEE SECTION 1.0 FOR SILT FENCE MAINTENANCE.

7. SEE SECTION 1.0 FOR SILT FENCE REMOVAL.

8. SEE SECTION 1.0 FOR SILT FENCE REPAIR.

9. SEE SECTION 1.0 FOR SILT FENCE REPLACEMENT.

10. SEE SECTION 1.0 FOR SILT FENCE STORAGE.

11. SEE SECTION 1.0 FOR SILT FENCE DISPOSAL.

12. SEE SECTION 1.0 FOR SILT FENCE RECORDS.

August 2013 Urban Drainage and Flood Control District Urban Storm Drainage Criteria Manual Volume 3 IP-7

SEEDING & MULCHING

1. ALL SEEDING, SOIL TREATMENT AND FERTILIZER DOCUMENTATION, AND SEED, FERTILIZER AND BAG TICKETS MUST BE KEPT IN THE COMPANY OFFICE.
2. SOIL PREPARATION SHALL BE DONE TO A DEPTH OF 6 INCHES.
3. SEEDING SHALL BE DONE TO A DEPTH OF 1/4 INCH.
4. MULCHING SHALL BE DONE TO A DEPTH OF 2 INCHES.
5. SEEDING SHALL BE DONE TO A DEPTH OF 1/4 INCH.
6. MULCHING SHALL BE DONE TO A DEPTH OF 2 INCHES.
7. SEEDING SHALL BE DONE TO A DEPTH OF 1/4 INCH.
8. MULCHING SHALL BE DONE TO A DEPTH OF 2 INCHES.
9. SEEDING SHALL BE DONE TO A DEPTH OF 1/4 INCH.
10. MULCHING SHALL BE DONE TO A DEPTH OF 2 INCHES.
11. SEEDING SHALL BE DONE TO A DEPTH OF 1/4 INCH.
12. MULCHING SHALL BE DONE TO A DEPTH OF 2 INCHES.

SEEDING & MULCHING

1. ALL SEEDING, SOIL TREATMENT AND FERTILIZER DOCUMENTATION, AND SEED, FERTILIZER AND BAG TICKETS MUST BE KEPT IN THE COMPANY OFFICE.

2. SOIL PREPARATION SHALL BE DONE TO A DEPTH OF 6 INCHES.

3. SEEDING SHALL BE DONE TO A DEPTH OF 1/4 INCH.

4. MULCHING SHALL BE DONE TO A DEPTH OF 2 INCHES.

5. SEEDING SHALL BE DONE TO A DEPTH OF 1/4 INCH.

6. MULCHING SHALL BE DONE TO A DEPTH OF 2 INCHES.

7. SEEDING SHALL BE DONE TO A DEPTH OF 1/4 INCH.

8. MULCHING SHALL BE DONE TO A DEPTH OF 2 INCHES.

9. SEEDING SHALL BE DONE TO A DEPTH OF 1/4 INCH.

10. MULCHING SHALL BE DONE TO A DEPTH OF 2 INCHES.

11. SEEDING SHALL BE DONE TO A DEPTH OF 1/4 INCH.

12. MULCHING SHALL BE DONE TO A DEPTH OF 2 INCHES.

August 2013 Urban Drainage and Flood Control District Urban Storm Drainage Criteria Manual Volume 3 IP-8

Block and Gravel Bag Curb Inlet Protection

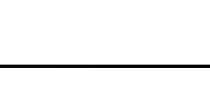

Block and Gravel Bag Curb Inlet Protection

1. SEE SECTION 1.0 FOR GENERAL REQUIREMENTS AND JOINTING.

2. SEE SECTION 1.0 FOR CURB AND GUTTER REQUIREMENTS.

3. SEE SECTION 1.0 FOR BLOCK AND GRAVEL BAG CURB REQUIREMENTS AND JOINTING.

4. SEE SECTION 1.0 FOR SILT FENCE REQUIREMENTS.

5. SEE SECTION 1.0 FOR SILT FENCE INSTALLATION.

6. SEE SECTION 1.0 FOR SILT FENCE MAINTENANCE.

7. SEE SECTION 1.0 FOR SILT FENCE REMOVAL.

8. SEE SECTION 1.0 FOR SILT FENCE REPAIR.

9. SEE SECTION 1.0 FOR SILT FENCE REPLACEMENT.

10. SEE SECTION 1.0 FOR SILT FENCE STORAGE.

11. SEE SECTION 1.0 FOR SILT FENCE DISPOSAL.

12. SEE SECTION 1.0 FOR SILT FENCE RECORDS.

August 2013 Urban Drainage and Flood Control District Urban Storm Drainage Criteria Manual Volume 3 IP-9

SEEDING & MULCHING

1. ALL SEEDING, SOIL TREATMENT AND FERTILIZER DOCUMENTATION, AND SEED, FERTILIZER AND BAG TICKETS MUST BE KEPT IN THE COMPANY OFFICE.
2. SOIL PREPARATION SHALL BE DONE TO A DEPTH OF 6 INCHES.
3. SEEDING SHALL BE DONE TO A DEPTH OF 1/4 INCH.
4. MULCHING SHALL BE DONE TO A DEPTH OF 2 INCHES.
5. SEEDING SHALL BE DONE TO A DEPTH OF 1/4 INCH.
6. MULCHING SHALL BE DONE TO A DEPTH OF 2 INCHES.
7. SEEDING SHALL BE DONE TO A DEPTH OF 1/4 INCH.
8. MULCHING SHALL BE DONE TO A DEPTH OF 2 INCHES.
9. SEEDING SHALL BE DONE TO A DEPTH OF 1/4 INCH.
10. MULCHING SHALL BE DONE TO A DEPTH OF 2 INCHES.
11. SEEDING SHALL BE DONE TO A DEPTH OF 1/4 INCH.
12. MULCHING SHALL BE DONE TO A DEPTH OF 2 INCHES.

SEEDING & MULCHING

1. ALL SEEDING, SOIL TREATMENT AND FERTILIZER DOCUMENTATION, AND SEED, FERTILIZER AND BAG TICKETS MUST BE KEPT IN THE COMPANY OFFICE.

2. SOIL PREPARATION SHALL BE DONE TO A DEPTH OF 6 INCHES.

3. SEEDING SHALL BE DONE TO A DEPTH OF 1/4 INCH.

4. MULCHING SHALL BE DONE TO A DEPTH OF 2 INCHES.

5. SEEDING SHALL BE DONE TO A DEPTH OF 1/4 INCH.

6. MULCHING SHALL BE DONE TO A DEPTH OF 2 INCHES.

7. SEEDING SHALL BE DONE TO A DEPTH OF 1/4 INCH.

8. MULCHING SHALL BE DONE TO A DEPTH OF 2 INCHES.

9. SEEDING SHALL BE DONE TO A DEPTH OF 1/4 INCH.

10. MULCHING SHALL BE DONE TO A DEPTH OF 2 INCHES.

11. SEEDING SHALL BE DONE TO A DEPTH OF 1/4 INCH.

12. MULCHING SHALL BE DONE TO A DEPTH OF 2 INCHES.

August 2013 Urban Drainage and Flood Control District Urban Storm Drainage Criteria Manual Volume 3 IP-10

Block and Gravel Bag Curb Inlet Protection



Block and Gravel Bag Curb Inlet Protection

1. SEE SECTION 1.0 FOR GENERAL REQUIREMENTS AND JOINTING.

2. SEE SECTION 1.0 FOR CURB AND GUTTER REQUIREMENTS.

3. SEE SECTION 1.0 FOR BLOCK AND GRAVEL BAG CURB REQUIREMENTS AND JOINTING.

4. SEE SECTION 1.0 FOR SILT FENCE REQUIREMENTS.

5. SEE SECTION 1.0 FOR SILT FENCE INSTALLATION.

6. SEE SECTION 1.0 FOR SILT FENCE MAINTENANCE.

7. SEE SECTION 1.0 FOR SILT FENCE REMOVAL.

8. SEE SECTION 1.0 FOR SILT FENCE REPAIR.

9. SEE SECTION 1.0 FOR SILT FENCE REPLACEMENT.

10. SEE SECTION 1.0 FOR SILT FENCE STORAGE.

11. SEE SECTION 1.0 FOR SILT FENCE DISPOSAL.

12. SEE SECTION 1.0 FOR SILT FENCE RECORDS.

August 2013 Urban Drainage and Flood Control District Urban Storm Drainage Criteria Manual Volume 3 IP-11

Attachment C



Colorado Springs Utilities

It's how we're all connected



AN ARTERA COMPANY



Contacts:

Colorado Springs Utilities (Owner)

Mark Munoz
Project Manager
719-668-2862
mmunoz@csu.org

Miller Pipeline, LLC (Contractor/Operator)

Randy Hiett
General Manager
719-325-9984
randy.hiett@millerpipeline.com

Era Environmental, Inc. (Environmental Consultant)

Emily Chamberlain
President
719-924-0519
era@eraenvironmental.com

121 South Tejon Street, Fourth Floor
P.O. Box 1103, Mail Code 940
Colorado Springs, CO 80903-2187

Phone 719-668-8426
Fax 719-668-8666
<http://www.csu.org>