

SITE INFORMATION

SITE NAME: CSP MARTELL SC
 PROJECT ID: MTN-P-009322
 DESIGN TYPE: SMALL CELL

JURISDICTION: PIKES PEAK REGIONAL BLDG. DEPT.
 COUNTY: EL PASO COUNTY
 STATE: STATE OF COLORADO

ZONING DESIGNATION: I-2
 OCCUPANCY: N/A (UNMANNED)
 CONSTRUCTION TYPE: TYPE V-B
 AREA OF CONSTR.: 49th SQ. FT.
 A.D.A. COMPLIANCE: THIS FACILITY IS UNMANNED & NOT FOR HABITATION

APPLICANT: VERIZON WIRELESS

POWER COMPANY: COLORADO SPRINGS POWER
 TELCO COMPANY: CENTURLINK

ALL WORK AND MATERIALS HAVE BEEN DESIGNED PER THE FOLLOWING GOVERNING CODES:
 2017 PIKES PEAK REGIONAL BUILDING CODE (PPRBC)
 2015 INTERNATIONAL BUILDING CODE (IBC)
 2014 NATIONAL ELECTRIC CODE (NEC)

VERIZON WIRELESS

**SITE NAME: CSP MARTELL SC
 SMALL CELL NEW BUILD**

**5929 OMAHA BLVD.
 COLORADO SPRINGS, CO 80915**

**EL PASO COUNTY
 STATE OF COLORADO**



SITE PHOTO - VIEWING SOUTH



PLANS PREPARED BY:

Z Y m R . S

mobile: 303.870.2276 AARON ZIMMER
 office: 303.363.8574 architect
 aZ@ZyMR.co

LIMITATION OF WARRANTY AND ARCHITECT'S WORK PRODUCT:

If any mistakes, omissions, and/or discrepancies are found to exist within the work product, the Architect shall be notified immediately. Failure to promptly notify the Architect of such conditions shall relieve the Architect from any responsibility for the consequences of such failure. Modifications or contradictions to the plans herein without the knowledge, consent, or recommendation of the Architect shall transfer all responsibility to the parties taking said actions.

COPYRIGHT © 2018 Studio Z Architecture, LLC

The use of all information herein is for the project and site for which said information was prepared and publication thereof is expressly limited to such use. Review, reproduction, or publication by any method, in whole or in part, is prohibited without the written consent of Studio Z Architecture.

NO.	DATE	DESCRIPTION	BY:
1	05/15/18	CD REVIEW SET	aZ
2	06/11/18	100% CD SET	aZ

ISSUE DATE:
JUN. 11. 2018

SITE INFORMATION:

CSP MARTELL SC

MTN-P-009322

5929 OMAHA BLVD.
 COLORADO SPRINGS, CO 80915
 PIKES PEAK REGIONAL BLDG. DEPT.

SEAL:

JUN. 11. 2018

SHEET TITLE:
TITLE SHEET

CITY POLE - R.O.W.

SHEET NUMBER:
T-1

CONTACT INFORMATION

VERIZON WIRELESS:

CONSTR. MNGR: VERIZON WIRELESS CONSTR. ENG.
 CONTACT: MARK WILSON
 PHONE: 303-5012348

RF ENGINEER: DESIGN ENGINEER
 CONTACT: JOE DAVIS
 PHONE:

REAL ESTATE COOR'D.: VZW SPECIALIST - SMALL CELL
 CONTACT: MAUREEN LOPEZ
 PHONE: 303-242-4330

SITE ACQ. AGENT FOR VZW: Q3 CONSULTING
 CONTACT: MARK PAIZ
 PHONE: 303-915-3428

ARCHITECT: STUDIO-Z ARCHITECTURE, LLC
 CONTACT: AARON ZIMMER
 PHONE: 303-870-2276

ELECTRICAL ENG.: FRONT RANGE ELEC. ENGINEERING
 CONTACT: CARL FRETWELL
 PHONE: 303-408-5988

SURVEYOR: PRECISION SURVEY & MAPPING
 CONTACT: CHRIS JULIANA
 PHONE: 303-753-9799

VICINITY MAP

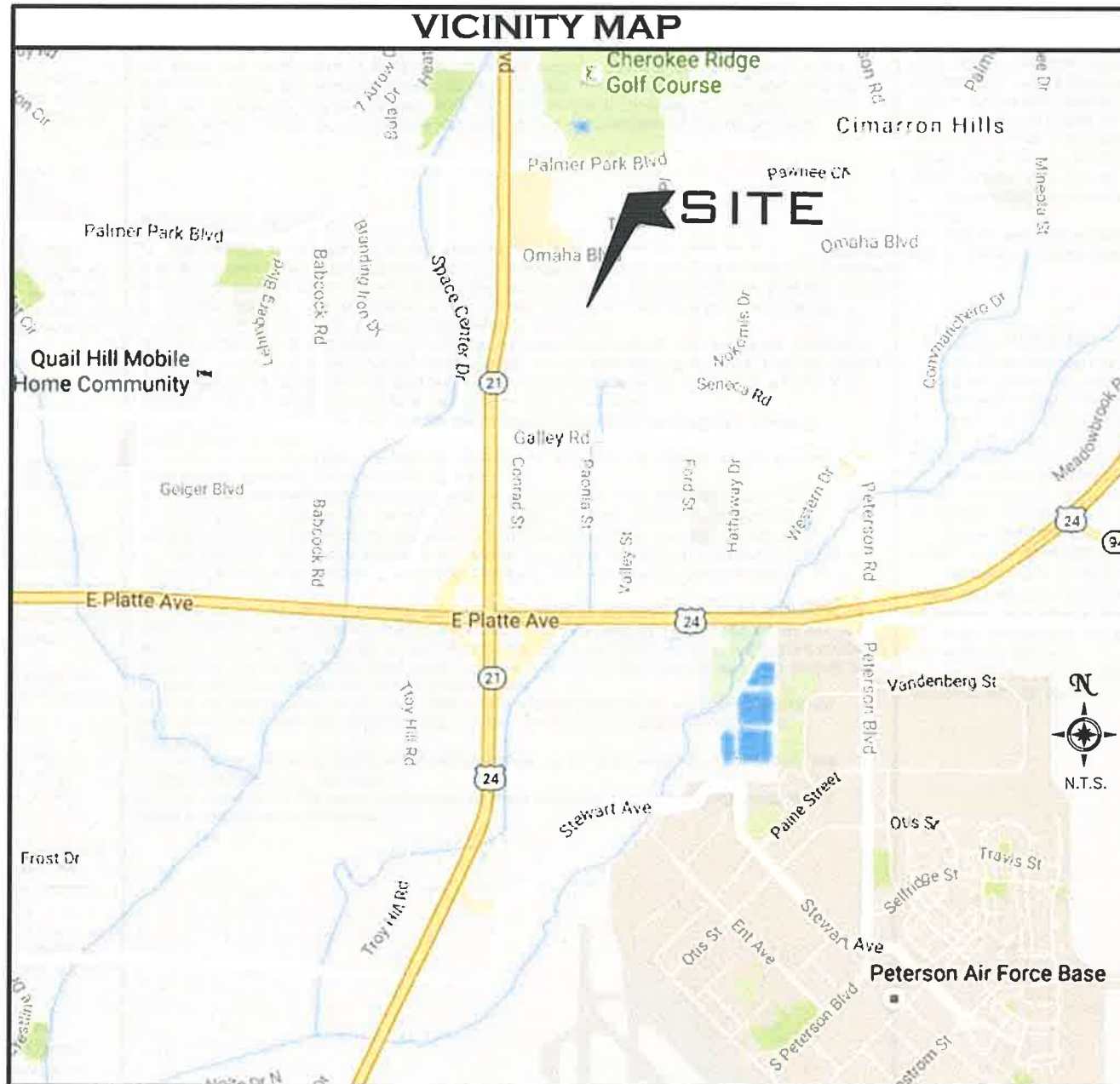

DRAWING INDEX

SHEET NO.	SHEET TITLE
T-1	TITLE SHEET
GN-1	GENERAL SITE AND UTILITY NOTES
GN-2	GENERAL SITE AND UTILITY NOTES
GN-3	GENERAL STRUCTURAL NOTES
GN-4	GENERAL ELECTRICAL AND GROUNDING NOTES
LS-1	LAND SURVEY
A-1	ARCHITECTURAL SITE PLAN
A-2	ENLARGED LEASE AREA PLAN
A-3	SITE ELEVATION
A-4	PLUMBING DIAGRAM & VAULT DETAILS
A-5	POLE ELEVATION & FOUNDATION DETAILS
A-6	DETAILS
E-1	ELECTRICAL DETAILS
E-2	ELECTRICAL DETAILS
G-1	GROUNDING DETAILS
G-2	GROUNDING DETAILS
S1-S5	POLE FOUNDATION STRUCTURAL DETAILS

PROJECT DESCRIPTION

SMALL CELL SITE IS LOCATED IN THE CITY RIGHT-OF-WAY.

INSTALLATION CONSISTS OF (1) SMALL CELL SITE LINKED TO A FIBER OPTIC NETWORK AND EXISTING POWER GRID. THE ABOVE-GRADE EQUIPMENT WILL INCLUDE: (1) NEW VERIZON CITY POLE WITH ANTENNA(S) MOUNTED ON THE TOP OF POLE; ALL EQUIPMENT WILL BE INSTALLED INSIDE THE BASE OF THE POLE; (1) POWER METER, PANEL, AND DISCONNECT WILL BE SURFACE-MOUNTED AT THE BASE OF THE POLE.

POWER AND FIBER WILL Routed UNDERGROUND TO THE SITE AS NECESSARY.

DO NOT SCALE DRAWINGS

CONTRACTOR SHALL VERIFY ALL PLANS, EXISTING DIMENSIONS, AND CONDITIONS ON THE JOB SITE, AND SHALL IMMEDIATELY NOTIFY THE ARCHITECT IN WRITING OF ANY DISCREPANCIES BEFORE PROCEEDING WITH THE WORK.



**Know what's below.
 Call before you dig.**

UTILITY NOTIFICATION CENTER
 TOLL FREE 1-800-227-2600

COMMERCIAL

Resubmittals: 1st _____ 2nd _____ 3rd _____

Address: **5929 OMAHA BLVD, COLORADO SPRINGS**

Plan Track #: 107767 

Received: 17-Sep-2019 (GITA)



2017 PPRBC

Parcel: 5407200037

Description:

NEW CELL POLE

Contractor: FRONT RANGE WIRELESS, INC.

Permit # _____ Zone: I-2 CAD-O EL PASO COUNTY

APPROVED FOR CONSTRUCTION

Date _____ By _____

Plan-check Fee: \$50.00 (1506871)

Code _____

Occupancy Class _____

Type of Construction _____

Floor or # of stories _____

Occupancy Load _____

Fire Sprinkled for:
() Area () Height () Bsmt
() 1-Hr Sub () Occ/Use () Other () N/A

Mixed Use: () Acc. () Separate () N/Separate
() N/A () Combined

Fire Wall () Yes () No Largest Area _____

Horizontal Assembly: () Structure () Drop Clg () N/A
Alt. Fire Hazm/HP

Fire: _____

Required PPRBD Departments (6)

Enumeration	App	Dis	N/A	By
Floodplain	[]	[]	[X]	RBD GIS
Construction	[]	[]	[]	
Electrical	[]	[]	[]	
Mechanical	[]	[]	[]	
Plumbing	[]	[]	[]	

Required Outside Departments (5)

County Zoning	[]	[]	[]	[X]	9/17/19 ^{AP}
Cimarron Hills Fire (CSFD)	[]	[]	[]	[]	
Hazmat	[]	[]	[]	[]	
Water Division	[]	[]	[]	[]	
Waste Water Div	[]	[]	[]	[]	

Release of this plan does not preclude compliance with all applicable codes, ordinances and other pertinent regulations. This plan set must be present on the job site for every inspection.

Nina Signed Original Plan Set on 6/13/18 PPRC-18-11

PPRBD accessibility review per ICC/ANSI A117.1 is limited to building elements and site arrival points within 5 feet of accessible building entrances, as applicable to the scope of work presented.

COMMERCIAL



2017 PPRBC
2011

Resubmittals: 1st _____ 2nd _____ 3rd _____

Address: 5929 OMAHA BLVD, COLORADO SPRINGS

Parcel: 5407200037

Plan Track #: 107767

Received: 12-Jun-2018 (MATTHEWM)

Description:

Required PPRBD Departments (6)

NEW CELL POLE

Contractor: _____
 Permit # _____ Cherokee Metro CITY
 Date _____ 719-597-5080 _____
 Plan-check Fee: _____
 Code _____
 Occupancy Class: _____ JONATHAN SMITH 10:30
 Type of Construc: _____
 Floor or # of stor: _____ 6250 PALMER PARK
 Occupancy Load: _____ 80915 BLVD.
 Fire Sprinkled for:
 () Area () Height () Bsmt
 () 1-Hr Sub () Occ/Use () Other () N/A
 Mixed Use: () Acc. () Separate () N/Separate
 () N/A () Combined
 Fire Wall () Yes () No Largest Area _____
 Horizontal Assembly: () Structure () Drop Clg () N/A
 Alt. Fire Hazm/HP _____
 Fire: _____

Enumeration	App	Dis	N/A	By		
Enumeration	<input checked="" type="checkbox"/>	<input type="checkbox"/>	<input type="checkbox"/>	<input type="checkbox"/>	AV	18
Floodplain	<input type="checkbox"/>	<input type="checkbox"/>	<input type="checkbox"/>	<input checked="" type="checkbox"/>	RBD GIS	
Construction	<input checked="" type="checkbox"/>	<input type="checkbox"/>	<input type="checkbox"/>	<input type="checkbox"/>	AV 6/12/18	
Electrical	<input type="checkbox"/>	<input type="checkbox"/>	<input checked="" type="checkbox"/>	<input type="checkbox"/>		SLEG/12/18
Mechanical	<input type="checkbox"/>	<input type="checkbox"/>	<input type="checkbox"/>	<input checked="" type="checkbox"/>	TCC	18
Plumbing	<input type="checkbox"/>	<input type="checkbox"/>	<input type="checkbox"/>	<input checked="" type="checkbox"/>	TCC	18

Required Outside Departments (5)

County Zoning	<input type="checkbox"/>	<input type="checkbox"/>	<input type="checkbox"/>	<input checked="" type="checkbox"/>	N/A 6/13/18
Cimarron Hills Fire	<input type="checkbox"/>	<input type="checkbox"/>	<input type="checkbox"/>	<input checked="" type="checkbox"/>	an 6/13/18
Hazmat	<input type="checkbox"/>	<input type="checkbox"/>	<input type="checkbox"/>	<input checked="" type="checkbox"/>	an 6/13/18
Water Division	<input type="checkbox"/>	<input type="checkbox"/>	<input type="checkbox"/>	<input checked="" type="checkbox"/>	JS 6/13/18
Waste Water Div	<input type="checkbox"/>	<input type="checkbox"/>	<input type="checkbox"/>	<input checked="" type="checkbox"/>	JS 6/13/18

Release of this plan does not preclude compliance with all applicable codes, ordinances and other pertinent regulations. This plan set must be present on the job site for every inspection.