



10186 MT. LINCOLN DR. PEYTON, CO 80831  
 INFO@CHIARTANEG.COM  
 719.257.2091

**ROLLING THUNDER CORE AND SHELL  
 10707 MALTESE POINT  
 COLORADO SPRINGS, CO**

NO.	REVISION	DATE

PROJECT NO: 24-0567  
 DRAWN BY: MPC  
 CHECKED BY: MPC  
 DATE: 03/29/2024

SHEET CONTENTS:

SITE PHOTOMETRIC PLAN

SHEET NUMBER:

E100A

PCD FILE #PPR2414

- GENERAL NOTES**
- A. DRAWINGS ARE BASED ON RECORD DRAWINGS (NOT GUARANTEED TO BE CURRENT AT TIME OF CONSTRUCTION) AND FIELD INVESTIGATION WITH DEMOLITION, EXAMINE PLANS AND VISIT THE SITE TO FIELD VERIFY ACTUAL CONDITIONS AND COORDINATE SAME WITH OTHER TRADES PRIOR TO STARTING WORK.
  - B. A LICENSED AND BONDED CONTRACTOR SHALL BE USED FOR INSTALLATION. ALL LOCAL CODES SHALL BE FOLLOWED DURING INSTALLATION.
  - C. ALL LIGHTING FIXTURES SHALL BE FULL CUT-OFF OR HAVE SHIELDING TO REDUCE OFF-SITE LIGHTING IMPACTS ON ADJACENT PROPERTIES AND ROADWAYS. ALL EXTERIOR LIGHTING SHALL BE ARRANGED TO MITIGATE LIGHT DIRECTED AWAY FROM ADJACENT PROPERTIES AND ANY PUBLIC RIGHT-OF-WAY. AN AMENDMENT TO THIS PLAN MAY BE REQUIRED IF THE LIGHTING TYPE IS CHANGED.
  - D. A FINAL COMMISSIONING REPORT SHALL BE DELIVERED TO THE BUILDING OWNER PER SECTION C408.2.5 OF THE 2021 IECC.

- KEYNOTES**
- 1 LIGHTING FOR THE WALKWAYS WILL BE PROVIDED BY WALL-MOUNTED DOWN CASTING FIXTURES LOCATED ON PROPOSED BUILDING. FINAL LOCATION TO BE DETERMINED DURING BUILDING DESIGN.
  - 2 EXTERIOR LIGHTING, EXCEPT SECURITY LIGHTING, WILL BE CONTROLLED BY A TIME CLOCK TO BE TURNED OFF DURING NON-OPERATING HOURS.
  - 3 LIGHT POLE IS EXISTING TO REMAIN.

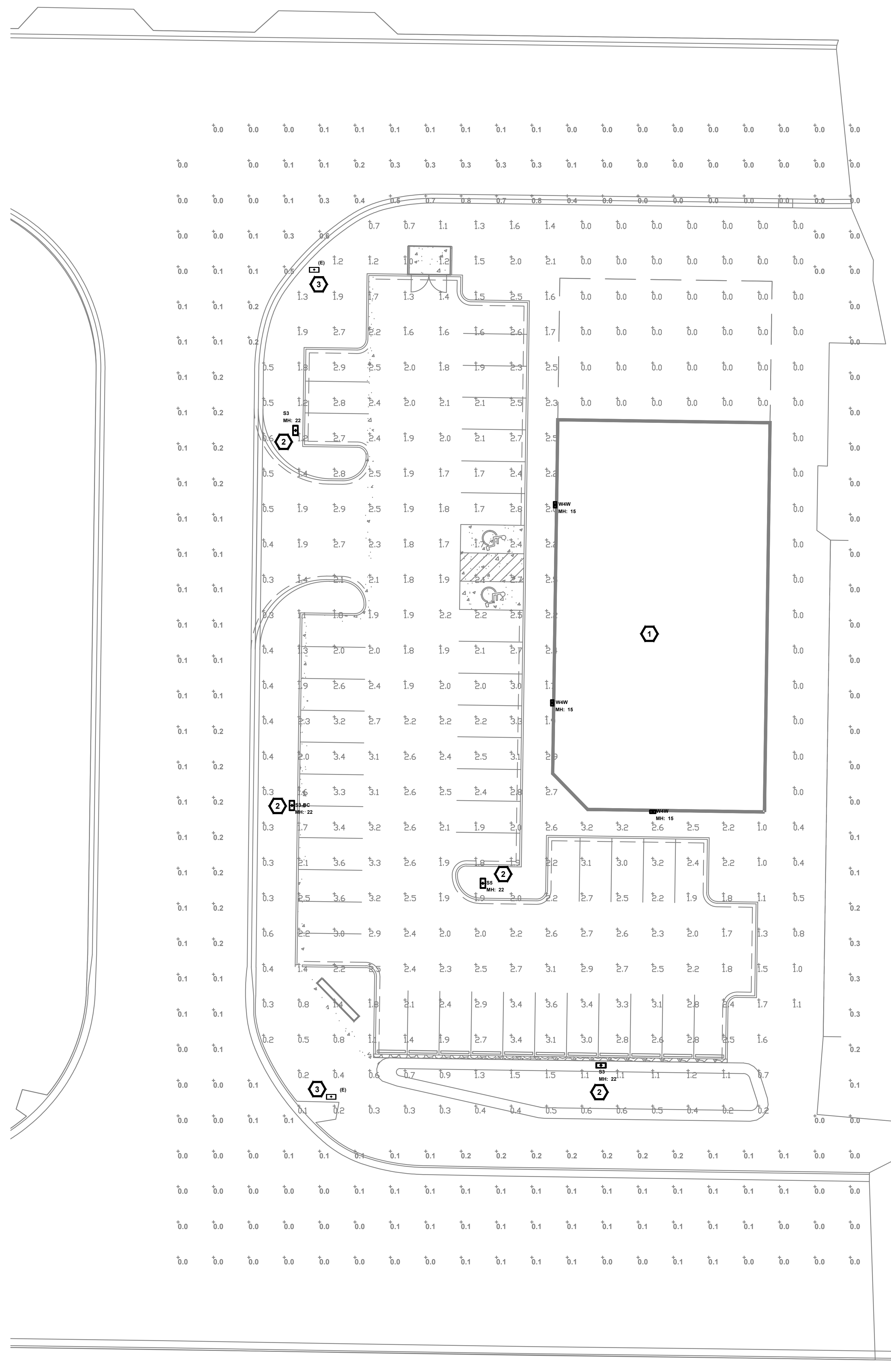
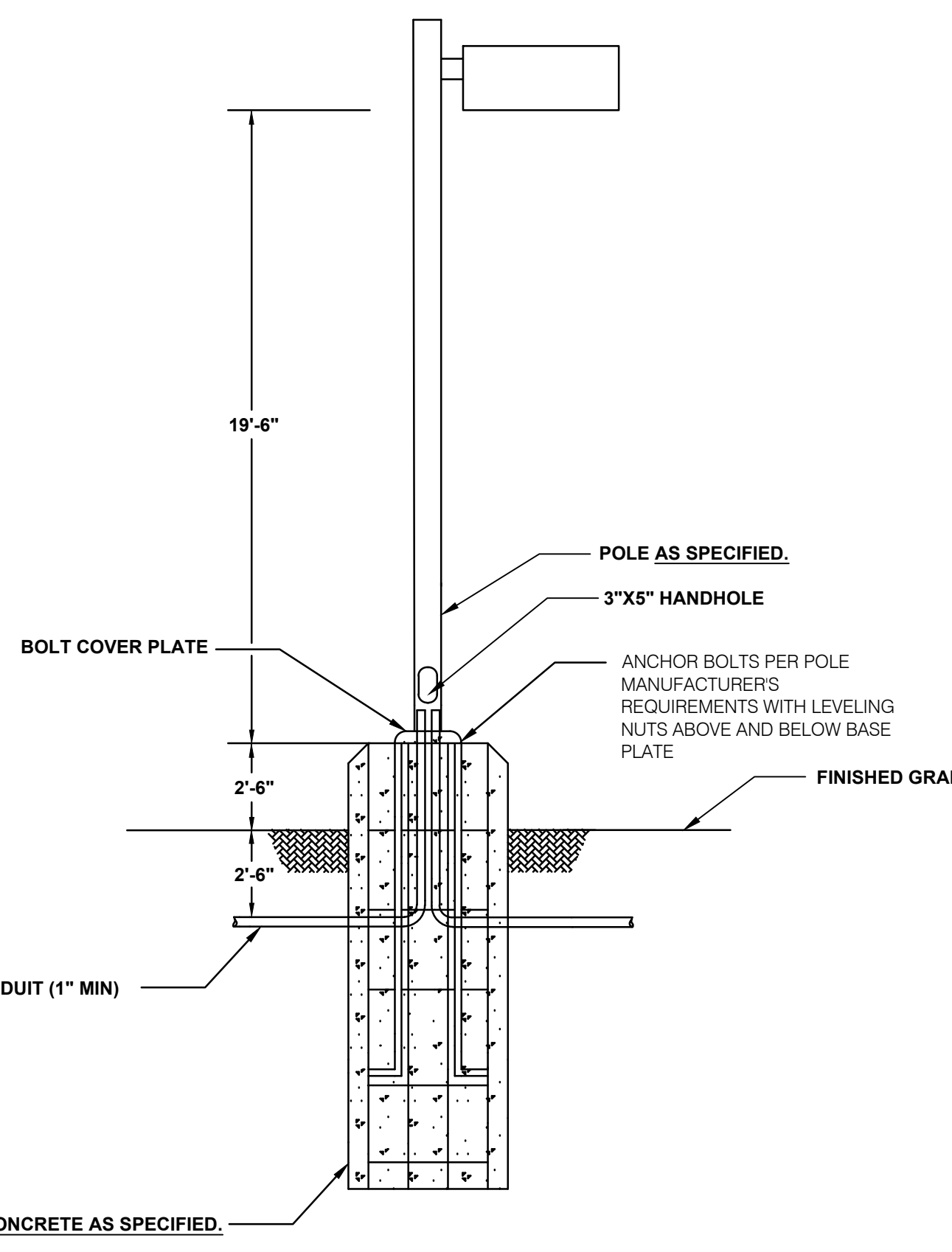

**Luminaire Schedule**

Symbol	Qty	Label	Description	LLF	Luminaire	Luminaire	Total
					Lumens	Watts	Watts
	4	W4W	RWL1-48L-45-4K7-4W-U	0.855	5704	46.5	186
	1	S5	ASL1-160L-100-4K7-50W-U	0.855	12071	87.6	87.6
	3	S3	ASL1-160L-100-4K7-3-U	0.855	12010	87.6	262.8
	1	S3-BC	ASL1-160L-100-4K7-3-U-BC	0.855	12010	87.6	262.8

**Calculation Summary**

Label	Units	Avg	Max	Min	Avg/Min	Max/Min
SITE	Fc	1.73	3.6	0.0	N.A.	N.A.
Trespass	Fc	0.10	0.8	0.0	N.A.	N.A.

**HUBBELL**  
**AIRO Micro Strike**  
 AREA/STREET LIGHTER

**FEATURES**

- Compact sleek design with multiple LED configurations and simple installation
- The slim profile is ideal for mounting on poles for pedestrian or street lighting
- Capable of replacing up to 100W+ HPS luminaires
- Micro Strike optical distribution of Type 2, 3, 4, 5, 6, 7, 8, 9, 10, 11, 12, 13, 14, 15, 16, 17, 18, 19, 20, 21, 22, 23, 24, 25, 26, 27, 28, 29, 30, 31, 32, 33, 34, 35, 36, 37, 38, 39, 40, 41, 42, 43, 44, 45, 46, 47, 48, 49, 50, 51, 52, 53, 54, 55, 56, 57, 58, 59, 60, 61, 62, 63, 64, 65, 66, 67, 68, 69, 70, 71, 72, 73, 74, 75, 76, 77, 78, 79, 80, 81, 82, 83, 84, 85, 86, 87, 88, 89, 90, 91, 92, 93, 94, 95, 96, 97, 98, 99, 100
- Tool-less entry option for easy installation and maintenance
- LED rated for high vibration applications including bridges and overpasses

**RELATED PRODUCTS**

- BALI Series
- BALZ Series
- Clearcast LED

**CONTROL TECHNOLOGY**

**SAFETY**

**INSTALLATION**

**WARRANTY**

**ACCESSORIES AND REPLACEMENT PARTS - MADE TO ORDER**

**HUBBELL**  
**AIRO Micro Strike**  
 AREA/STREET LIGHTER

**ORDERING GUIDE**

**ORDERING INFORMATION**

Label	Part No.	Description	Quantity	Notes
ASL1	ASL1-160L-100-4K7-3-U	ASL1-160L-100-4K7-3-U	3	
ASL1	ASL1-160L-100-4K7-3-U-BC	ASL1-160L-100-4K7-3-U-BC	1	

**CONTROLS (CONTINUED)**

**WARRANTY**

**ACCESSORIES AND REPLACEMENT PARTS - MADE TO ORDER**

**BEACON**  
**RATIO Wall**  
 WALL MOUNTED LIGHTING

**FEATURES**

- Low profile LED wall luminaire with a variety of LED distributions for lighting applications such as retail, commercial and industrial building mount
- Featuring Micro Strike optics which maximizes target zone illumination with minimal spill into the room while reducing light trespass issues
- Visual comfort standard
- Control options including photo control, occupancy sensing, NX Distributed Intelligence, Wireless and 2-Wire with integrated controls
- Battery Backup options available for emergency code compliance
- Quick-mount design allows easy installation/maintenance
- 34V and 48V versions for industrial applications and Canada

**RELATED PRODUCTS**

- BEACON RATIO Wall
- BEACON RATIO Wall

**CONTROL TECHNOLOGY**

**SAFETY**

**INSTALLATION**

**WARRANTY**

**ACCESSORIES AND REPLACEMENT PARTS - MADE TO ORDER**

**BEACON**  
**RATIO Wall**  
 WALL MOUNTED LIGHTING

**ORDERING GUIDE**

**ORDERING INFORMATION**

Label	Part No.	Description	Quantity	Notes
ASL1	ASL1-160L-100-4K7-3-U	ASL1-160L-100-4K7-3-U	3	
ASL1	ASL1-160L-100-4K7-3-U-BC	ASL1-160L-100-4K7-3-U-BC	1	

**CONTROLS (CONTINUED)**

**WARRANTY**

**ACCESSORIES AND REPLACEMENT PARTS - MADE TO ORDER**

ALL DRAWINGS AND SPECIFICATIONS ARE THE PROPERTY OF THE ENGINEER OF RECORD. THEY ARE ONLY TO BE USED FOR THIS PROJECT AND ARE NOT TO BE USED ON ANY OTHER PROJECT WITHOUT WRITTEN AGREEMENT AND APPROPRIATE COMPENSATION TO THE ENGINEER OF RECORD.