

EL PASO COUNTY



PLANNING AND COMMUNITY DEVELOPMENT DEPARTMENT
2880 INTERNATIONAL CIRCLE, SUITE 110
COLORADO SPRINGS, CO 80910

DENVER
CO 802
03 OCT '17



UNITED STATES POSTAGE
PITTSBURGH PA
02 1P \$0.00
0001977679 OCT
MAILED FROM ZIP CO

RECEIVED
OCT 11 2017
BY: *JG* 11:00

5206003006
BRUMMEL, JENNI
13765 ZUNI LN
COLORADO SPRING

NSS
80910314835

NIXIE 808 DC 1 0010/07/
RETURN TO SENDER
NO SUCH STREET
UNABLE TO FORWARD

BC: 80910314835 *2020-04608-03

EL PASO

COMMISSIONERS:
DARRYL GLENN (PRESIDENT)
MARK WALLER (PRESIDENT PRO TEMPORE)



COUNTY

STAN VANDERWERF
LONGINOS GONZALEZ
PEGGY LITTLETON

PLANNING AND COMMUNITY DEVELOPMENT DEPARTMENT
CRAIG DOSSEY, EXECUTIVE DIRECTOR

October 2, 2017

RE: Administrative Vacation Replat for the Apache Woods Filing Number 2
Subdivision

File: VR-17-006

Parcel ID: 5206003022, 5206003006, 5206003003

To Whom It May Concern:

This letter is to inform property owners adjacent to 13780 Black Forest Road, 13765 Zuni Lane, and 6675 Jicarilla Drive, Colorado Springs CO 80908 that they have requested a vacation replat to adjust the lot line between three platted parcels within the RR-5 (Residential Rural) zoning district. The Planning and Community Development Director may make a formal decision regarding the request on October 17, 2017 at 4:30 P.M. Any comments or questions may be forwarded to me prior to that decision. At the discretion of the Planning and Community Development Director, the approval process may be elevated to the Board of County Commissioners for consideration. Administrative approval by the Planning and Community Development Director is subject to the appeal provisions of the Land Development Code.

You may view the application documents online at www.epcdevplanreview.com. Please feel free to contact me with any questions, comments, or concerns you may have prior to the decision.

Respectfully,

Gabe Sevigny, Planner 1
El Paso County Planning and Community Development
719-520-7943
gabesevigny@elpasoco.com

2880 INTERNATIONAL CIRCLE, SUITE 110
PHONE: (719) 520-6300



COLORADO SPRINGS, CO 80910-3127
FAX: (719) 520-6695

www.ELPASOCO.com

El Paso County Parcel Information

File Name: VR-17-006

Zone Map No.: --

PARCEL	NAME
5206003022	BRUMMEL DOUGLAS J
5206003006	BRUMMEL JENNIFER N
5206003003	SCHMIDT ROBERT C II

Date: October 2, 2017

ADDRESS	CITY	STATE
13780 BLACK FOREST RD	COLORADO SPRINGS	CO
13765 ZUNI LN	COLORADO SPRINGS	CO
6675 JICARILLA DR	COLORADO SPRINGS	CO

ZIP	ZIPLUS
80908	2804
80908	
80908	3366

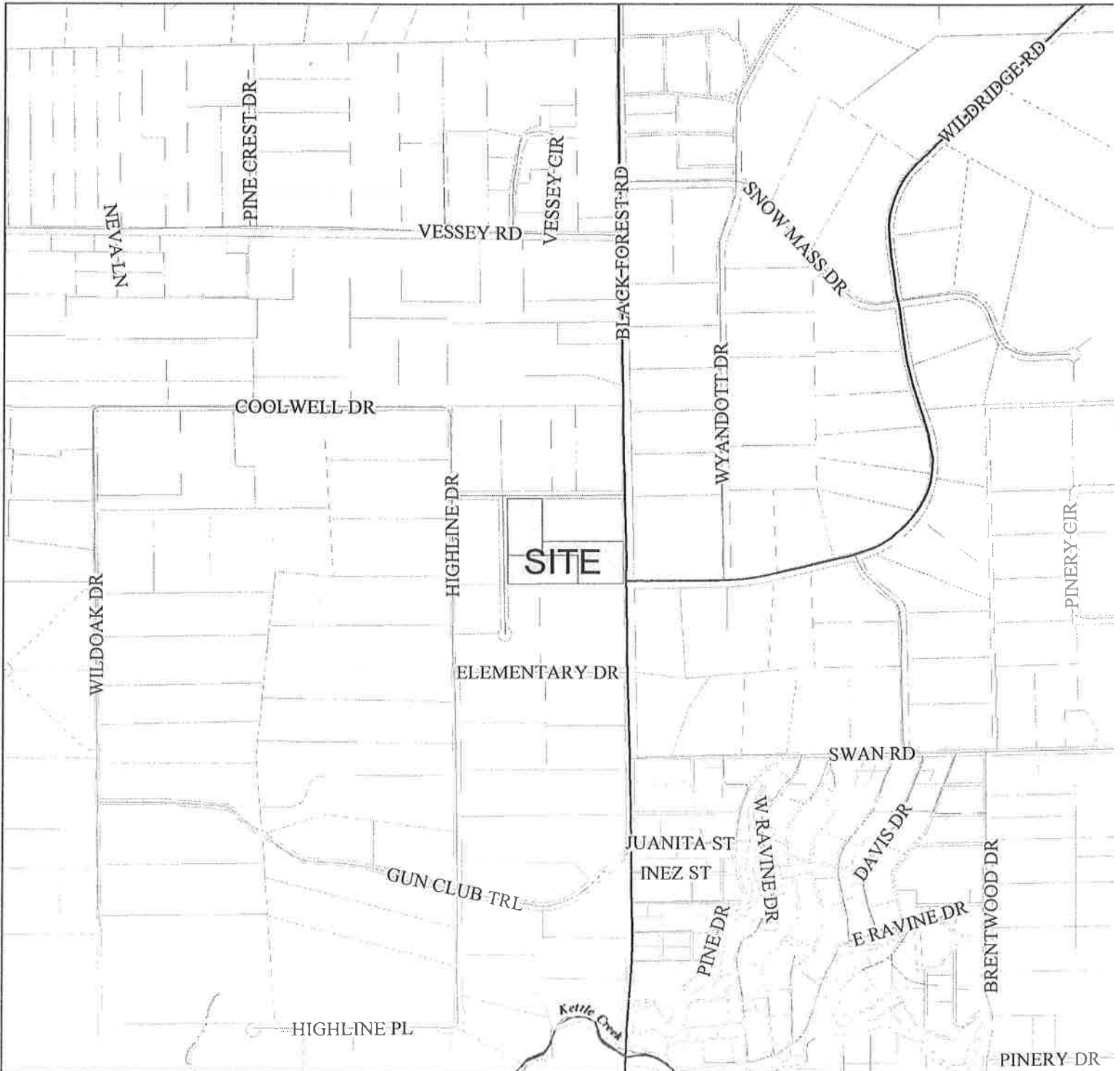

Please report any parcel discrepancies to:
 El Paso County Assessor
 1675 W. Garden of the Gods Rd
 Colorado Springs, CO 80907
 (719) 520-6600



COPYRIGHT 2017 by the Board of County Commissioners, El Paso County, Colorado. All rights reserved. No part of this document or data contained herein may be reproduced, used to prepare derivative products, or distributed without the specific written approval of the Board of County Commissioners, El Paso County, Colorado. This document was prepared from the best data available at the time of printing. El Paso County, Colorado, makes no claim as to the completeness or accuracy of the data contained herein.