

3011

RESOLUTION NO. 26-124

BOARD OF COUNTY COMMISSIONERS
 COUNTY OF EL PASO, STATE OF COLORADO

APPROVAL OF A FIVE (5) YEAR TIME EXTENSION FOR THE
 HIGH PLAINS RANCH SKETCH PLAN (SKP261)

WHEREAS, the El Paso County Board of County Commissioners previously approved the High Plains Ranch Sketch Plan on December 11, 2008 with an expiration date of December 11, 2013; and

WHEREAS, the Planning and Community Development Department Executive Director administratively approved an extension of time to record the first Final Plat for the High Plains Ranch Sketch Plan with an expiration date of December 31, 2018; and

WHEREAS, a Final Plat within the boundary of the High Plains Ranch Sketch Plan was not submitted for review and the Sketch Plan subsequently expired; and

WHEREAS, the El Paso County Board of County Commissioners adopted Resolution No. 21-221, approving a reconsideration of the expired High Plains Ranch Sketch Plan, including an extension of time to record the first Final Plat for the High Plains Ranch Sketch Plan with an expiration date of May 26, 2026; and

WHEREAS, the Applicant is now requesting a five-year extension to record the first Final Plat for the High Plains Ranch Sketch Plan with a proposed expiration date of May 26, 2031; and

NOW, THEREFORE, BE IT RESOLVED the Board of County Commissioners of El Paso County, Colorado, hereby approves the extension of time of five years in which to have the first Final Plat filing recorded for High Plains Ranch Sketch Plan request as submitted, for the unincorporated area of El Paso County as depicted in Exhibit A, which is attached hereto and incorporated by reference.

BE IT FURTHER RESOLVED that all conditions of approval associated with the original approval of the High Plains Ranch Sketch Plan and Resolution No. 21-221 shall remain valid and in full effect.

DONE THIS 9th day of April, 2026, at Colorado Springs, Colorado.

BOARD OF COUNTY COMMISSIONERS
 OF EL PASO COUNTY, COLORADO

ATTEST:

By:



County Clerk & Recorder

By: *[Handwritten Signature]*
 Chair

EXHIBIT A (Sketch Plan Drawings)

VERSION # 2
DATE 8/26/08

NEW DOC



HIGH PLAINS RANCH SKETCH PLAN

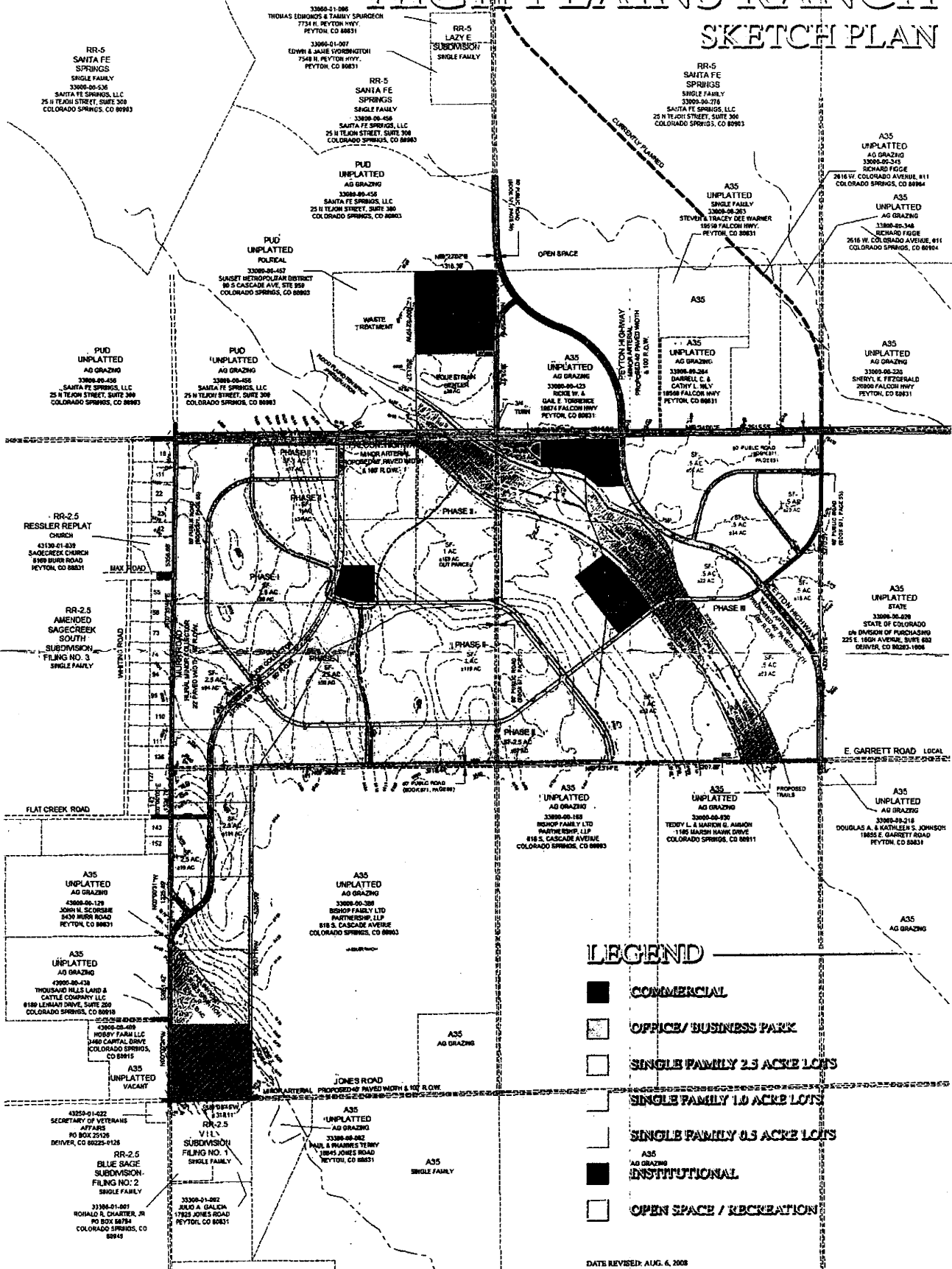

LEGEND

- COMMERCIAL
- OFFICE / BUSINESS PARK
- SINGLE FAMILY 2.5 ACRE LOTS
- SINGLE FAMILY 1.0 ACRE LOTS
- SINGLE FAMILY 0.5 ACRE LOTS
- A35 AG GRAZING
- INSTITUTIONAL
- OPEN SPACE / RECREATION

DATE REVISED: AUG. 6, 2008



RECEIVED

AUG 25 2008

EPC DEVELOPMENT SERVICES

MURR ROAD SKETCH PLAN

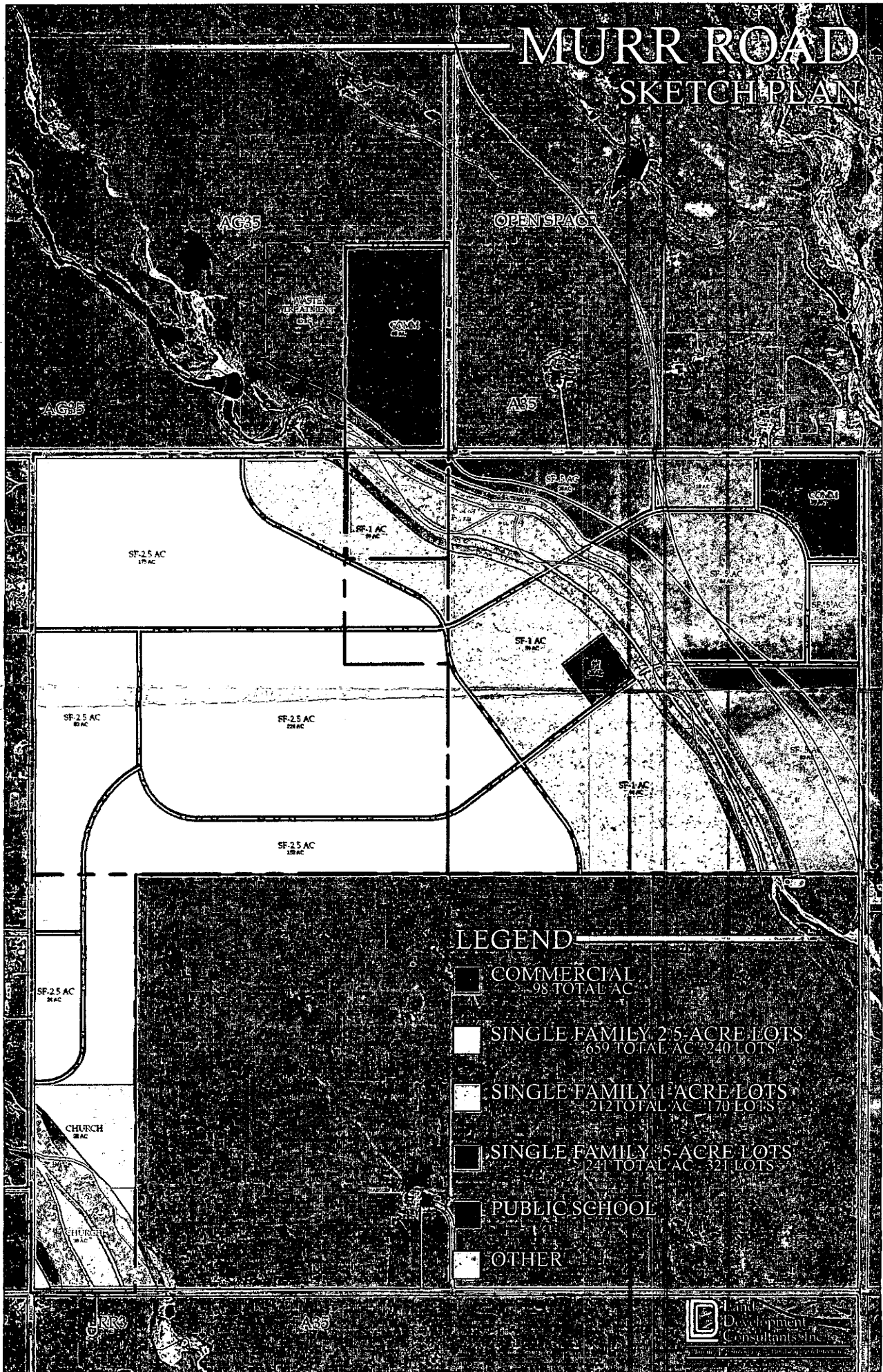

LEGEND

- COMMERCIAL**
 98 TOTAL AC
- SINGLE FAMILY 2.5-ACRE LOTS**
 659 TOTAL AC - 240 LOTS
- SINGLE FAMILY 1-ACRE LOTS**
 212 TOTAL AC - 170 LOTS
- SINGLE FAMILY 5-ACRE LOTS**
 241 TOTAL AC - 321 LOTS
- PUBLIC SCHOOL**
- OTHER**