



November 15, 2021

El Paso County
Planning and Community Development
2880 International Circle, Suite 110
Colorado Springs, CO 80910

Reference: Letter of Intent – MVEA Vollmer South
PCD File No. CDR2116

To Whom It May Concern:

Mountain View Electric Association, Inc. (MVEA) will be constructing a 12.5 kV underground electrical distribution feeder line running along the east side of Vollmer Road.

The underground installation will be approximately 1.75 miles in length and will begin at the intersection of Poco Road and Vollmer Road.

The installation will travel south along the east side Vollmer Road outside of the county right-of-way and will be done by open cut excavation within a 20' private easement. When the installation arrives at the proposed Briargate Parkway, installation will switch to directional bore for the road crossing. The installation will then travel along Briargate Parkway via open cut excavation, within another 20' private easement, until it arrives at the intersection of Briargate Parkway and Wheatland Drive. Here directional bore will be used again for the road crossings. Once the installation has crossed Wheatland Drive, it will be installed by open cut excavation along the southeast side of Wheatland Drive within a 20' private easement.

The majority of the site which will be disturbed currently consists of undeveloped land. The rest of the site consists mostly of bare earth that has been disturbed for residential development. The total area of land disturbance will be approximately 2.23 acres. Adjacent properties will not be affected.

Construction will primarily be completed within private easements. For the road crossings located within the county right-of-way, permit applications will be submitted to the El Paso County Department of Public Works.

Please contact me for any project related questions.

Regards,

Amy Carlsen

Amy Carlsen
Mountain View Electric Association
Direct: 719-494-2699
Mobile: 719-922-1116
Email: Amy.C@mvea.coop

This Association is an equal opportunity provider and employer.

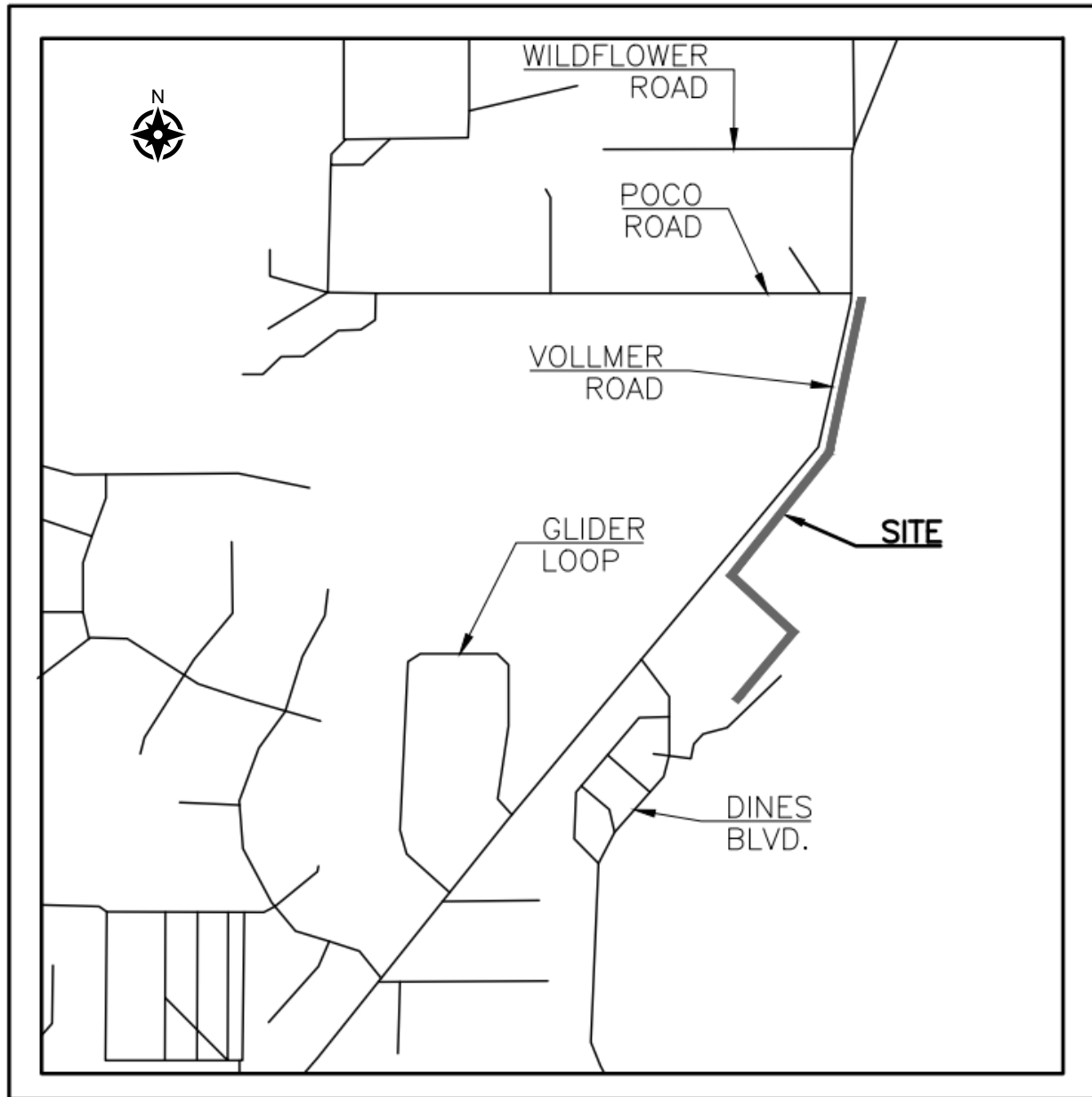

OVERVIEW MAP
*NOT DRAWN TO SCALE

This Association is an equal opportunity provider and employer.

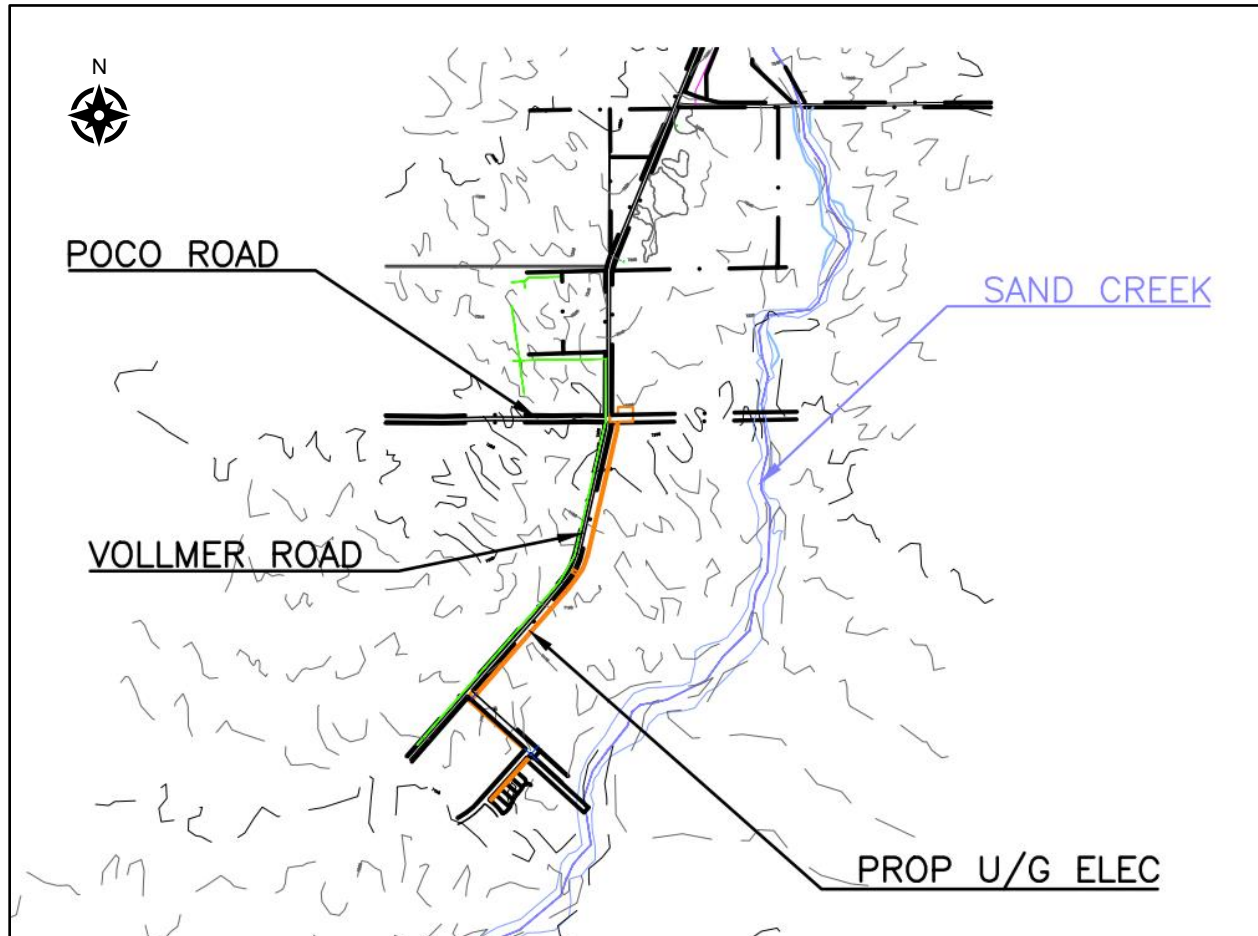

**VICINITY MAP OF NEW UNDERGROUND ELECTRICAL
DISTRIBUTION LINES**

**NOT DRAWN TO SCALE*

This Association is an equal opportunity provider and employer.