

COPPER CHASE AT STERLING RANCH

EL PASO COUNTY, COLORADO

A PORTION OF THE E 1/2 SE 1/4 OF SECTION 32 AND THE S 1/2 SW 1/4 OF SECTION 33, TOWNSHIP 12 SOUTH, RANGE 65 WEST, AND THE NE 1/4 OF NE 1/4 OF SECTION 5, TOWNSHIP 13 SOUTH, RANGE 65 WEST, BOTH OF THE 6TH P.M.

PUD DEVELOPMENT/PRELIMINARY PLAN

LANDSCAPE NOTES

- ALL PRESERVATION AREAS CONTAINING VEGETATION DESIGNATED TO BE PRESERVED, SHALL BE FENCED OFF DURING CONSTRUCTION TO MINIMIZE DISTURBANCE IN THESE AREAS. ALL FENCING SHALL BE INSTALLED AROUND PRESERVED VEGETATION PRIOR TO ANY GRADING ON THE PROPERTY. A 4-FOOT, ORANGE, CONSTRUCTION SAFETY FENCE SHALL BE USED IN THIS APPLICATION.
- SOIL AMENDMENT - INCORPORATE 3 CUBIC YARDS/1000 S.F. AREA OF CLASS 2 A1 ORGANICS PREMIUM ORGANIC COMPOST ON TALL FESCUE SOD AREAS. INCORPORATE 2 CUBIC YARDS/1000 S.F. AREA OF CLASS 3 COMPOSTED COW MANURE (AGED 1 YEAR) ORGANIC COMPOST TO ALL SEED AREAS. AMENDMENTS MAY CHANGE TO BE BASED ON SOIL ANALYSIS OF FINAL INFILL.
- FOR GRADES REFER TO CIVIL ENGINEERING DRAWINGS.
- CONTRACTOR TO UTILIZE STOCKPILED TOPSOIL FROM GRADING OPERATION AS AVAILABLE. TILL INTO TOP 6" OF SOIL. CONTRACTOR TO APPLY EROSION CONTROL BLANKET TO ALL AREAS WITH 3:1 SLOPES.
- ALL SOD SHALL BE TALL FESCUE BLEND.
- NO SOD SHALL BE PLANTED ON SLOPES IN EXCESS OF 6:1 GRADIENT.
- FOR ALL SEED AREAS REFER TO SEED MIXES SPECIFIED ON THIS SHEET.
- ALL NATIVE SEED AREAS SHALL HAVE A TEMPORARY ABOVE-GROUND SPRAY IRRIGATION SYSTEM UTILIZED UNTIL SEED IS ESTABLISHED, AND ALL TREES AND SHRUBS WITHIN NATIVE SEED AREAS SHALL HAVE A PERMANENT DRIP IRRIGATION SYSTEM.
- A FULLY AUTOMATED SPRINKLER IRRIGATION SYSTEM WILL DRIP IRRIGATE ALL TREE, SHRUB, AND GROUND COVER PLANTINGS, AND SPRAY ALL TALL FESCUE SOD AND LOW ALTERNATIVE TURF AREAS. AN IRRIGATION PLAN WILL BE PREPARED AT A LATER DATE AND WILL INCLUDE AN IRRIGATION SCHEDULE THAT NOTES APPLICATION RATES BASED ON TURF TYPE, RATES FOR NEWLY INSTALLED PLANTS VS. ESTABLISHED PLANTS, AND GENERAL RECOMMENDATIONS REGARDING SEASONAL ADJUSTMENTS.
- NO TREES AND NO PLANTS OVER 2 FEET TALL SHALL BE INSTALLED WITHIN 5 FEET OF ANY FIRE HYDRANTS.
- ALL PLANTS TO RECEIVE 3 INCH DEPTH OF GORILLA HAIR SHREDDED CEDAR WOOD MULCH UNLESS OTHERWISE SPECIFIED. FOLLOW PLANTING DETAILS FOR MULCH RING DIMENSIONS WITHIN ROCK, SOD, OR SEED AREAS.
- COBBLE: 2-3" CRIPPLE CREEK ORE, AT 3-4" DEPTH, AT ALL INTERSECTION CORNERS BETWEEN HANDICAP RAMPS. INSTALL GEOTEXTILE FABRIC UNDER ALL COBBLE AREAS.
- GRAVEL ROCK: 3/4" CIMARRON GRANITE, AT 3-4" DEPTH. INSTALL GEOTEXTILE FABRIC UNDER ALL ROCK AREAS.
- ALL SHRUB BEDS TO BE ENCLOSED BY SOLID STEEL EDGING, AS A SEPARATOR FROM SOD, SEED, AND ALTERNATIVE TURF. SEPARATION BETWEEN SOD AND SEED, AND BETWEEN ALTERNATIVE TURF AND SEED SHALL BE A MOWED STRIP, WITHOUT STEEL EDGING.
- SCHEDULE PLANTS SIZES IN TABLE ARE SUGGESTED. PLANTS TO BE CONSIDERED FOR FULFILLING COUNTY LANDSCAPE REQUIREMENTS SHALL HAVE A MINIMUM CALIPER SIZE (MEASURED SIX INCHES ABOVE GROUND) FOR DECIDUOUS SHADE TREES SHALL BE 1-1/2 INCHES AND FOR DECIDUOUS ORNAMENTAL TREES 1 INCH. EVERGREEN TREES SHALL BE A MINIMUM OF 6 FEET IN HEIGHT ABOVE GROUND. SHRUBS SHALL BE A MINIMUM OF 5 GALLON SIZE.
- ALL PLANTS SHOWN IN PRELIMINARY LANDSCAPE PLAN ARE FULFILLING A COUNTY LANDSCAPE REQUIREMENT. ADDITIONAL AND INTERIOR PLANTING WILL BE SHOWN IN FINAL LANDSCAPE PLAN.
- ANY FIELD CHANGES OR DEVIATIONS TO THESE PLANS WITHOUT PRIOR COUNTY APPROVAL OF AN AMENDED SITE DEVELOPMENT PLAN MAY RESULT IN A DELAY OF FINAL APPROVAL AND ISSUANCE OF A CERTIFICATE OF OCCUPANCY.
- THESE PLANS ARE FOR COUNTY APPROVALS ONLY AND ARE NOT TO BE UTILIZED FOR CONSTRUCTION.
- ANY OBJECT WITHIN THE SIGHT DISTANCE TRIANGLE OR EASEMENT MORE THAN 30 INCHES ABOVE THE FLOWLINE ELEVATION OF THE ADJACENT ROADWAY SHALL CONSTITUTE A SIGHT OBSTRUCTION, AND SHALL BE REMOVED OR LOWERED. THE OBJECTS MAY INCLUDE BUT ARE NOT LIMITED TO BERMS, BUILDINGS, PARKED VEHICLES ON PRIVATE PROPERTY, CUT SLOPES, HEDGES, TREES, BUSHES, UTILITY CABINETS OR TALL CROPS. TREES MAY BE PERMITTED AT THE DISCRETION OF THE ECM ADMINISTRATOR IF PRUNED TO AT LEAST 8 FEET ABOVE THE FLOWLINE ELEVATION OF THE ADJACENT ROADWAY.

GROUND COVER SCHEDULE

	COBBLE 2"-4" Cripple Creek Gold Ore	6,907 sf
	NATIVE GRASS Upland Native Seed Mix	89,355 sf
	ROCK MULCH 3/4" Cimarron Granite	10,717 sf
	TALL FESCUE SOD	49,033 sf

PLANT SCHEDULE

DECIDUOUS TREES	CODE	QTY	BOTANICAL / COMMON NAME	HEIGHT	WIDTH	SIZE	COND
	Agr	24	Acer grandidentatum / Bigtooth Maple	30'	30'	2" Cal.	B&B
	Coc	5	Celtis occidentalis / Common Hackberry	60'	50'	2" Cal.	B&B
	Ccr	1	Crataegus crus-galli / Cockspur Hawthorn	30'	30'	2" Cal.	B&B
	Mxr	13	Malus x 'Radiant' / Radiant Crabapple	25'	20'	2" Cal.	B&B
	Qma	4	Quercus macrocarpa / Burr Oak	60'	50'	3" Cal.	B&B
EVERGREEN TREES	CODE	QTY	BOTANICAL / COMMON NAME	HEIGHT	WIDTH	SIZE	COND
	Ped	30	Pinus edulis / Pinon Pine	30'	20'	6" HT	B&B
	Pfl	11	Pinus flexilis / Limber Pine	50'	30'	6" HT	B&B
	Ppo	2	Pinus ponderosa / Ponderosa Pine	80'	40'	6" HT	B&B
SHRUBS	CODE	QTY	BOTANICAL / COMMON NAME	HEIGHT	WIDTH	SIZE	COND
	Cxc	82	Caryopteris x clandonensis 'Blue Mist' / Blue Mist Shrub	4'	4'	5 GAL	CONT
	Cse	22	Cornus sericea / Redoiser Dogwood	8'	8'	5 GAL	CONT
	Je	14	Juniperus virginiana 'Globosa' / Globe Eastern Redcedar	3'			
	Pod	11	Physocarpus opulifolius 'Diablo' / Diablo Ninebark	8'	8'	5 GAL	CONT
	Pb	34	Pinus mugo 'Big Tuna' / Mountain Pine	5'	6'	5 GAL	CONT
	Pc	166	Pinus mugo 'Compacta' / Dwarf Mugo Pine	3'	3'	5 GAL	CONT
	Psy	11	Pinus sylvestris 'Hillside Creeper' / Hillside Creeper Scotch Pine	2'	6'	5 GAL	CONT
	Rkk	17	Rosa x 'Knockout' TM / Rose	3'	3'	5 GAL	CONT
DECIDUOUS SHRUBS	CODE	QTY	BOTANICAL / COMMON NAME	HEIGHT	WIDTH	SIZE	COND
	Fn	10	Forestiera neomexicana / New Mexico Privet	12'	12'	5 GAL	
GRASSES	CODE	QTY	BOTANICAL / COMMON NAME	HEIGHT	WIDTH	SIZE	COND
	Cxa	310	Calamagrostis x acutiflora 'Karl Foerster' / Feather Reed Grass	5'	2'	1 GAL	CONT
	Cl	44	Chasmanthium latifolium 'Little Ticker' / Little Ticker Northern Sea Oats	2'	2'	1 GAL	CONT

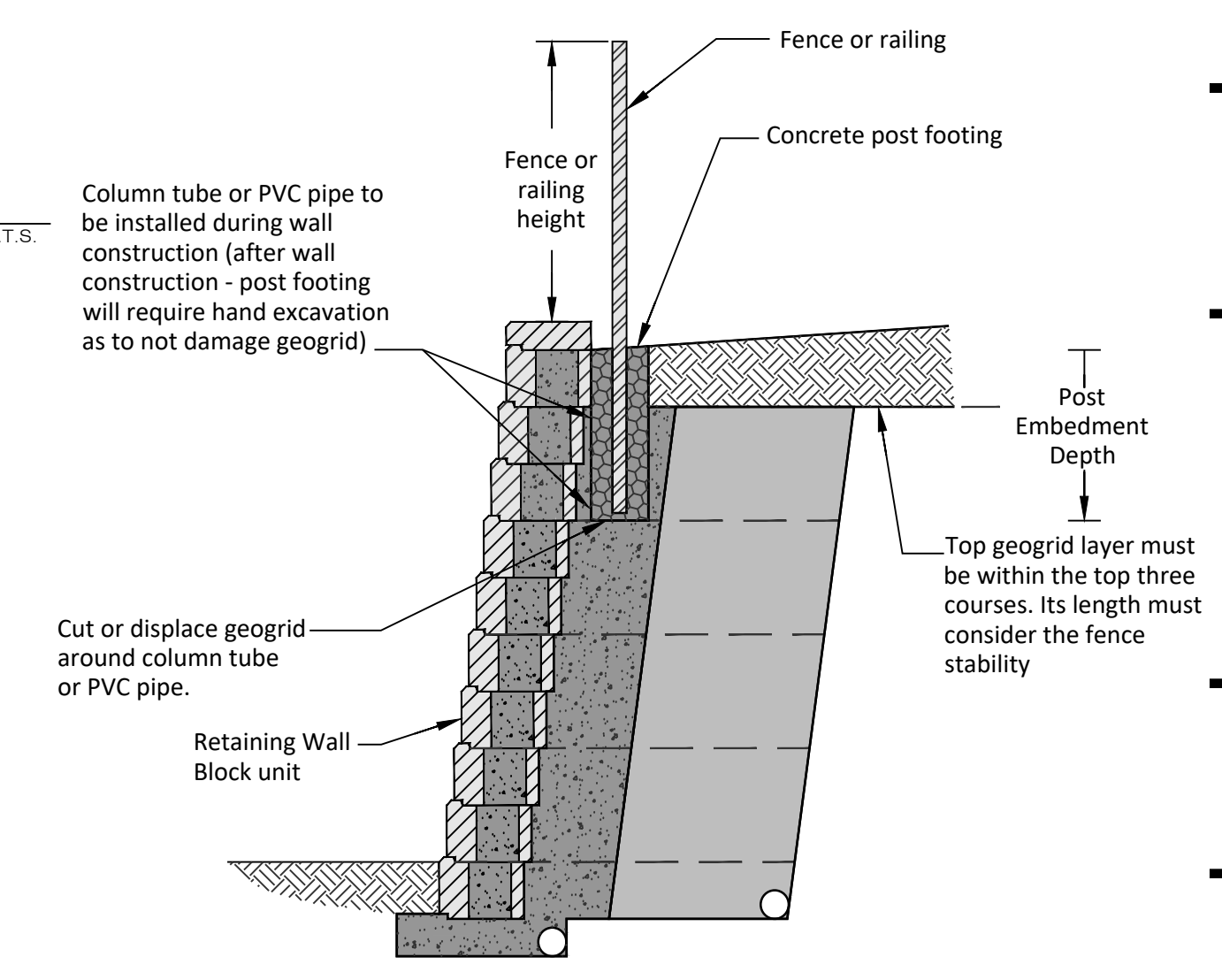
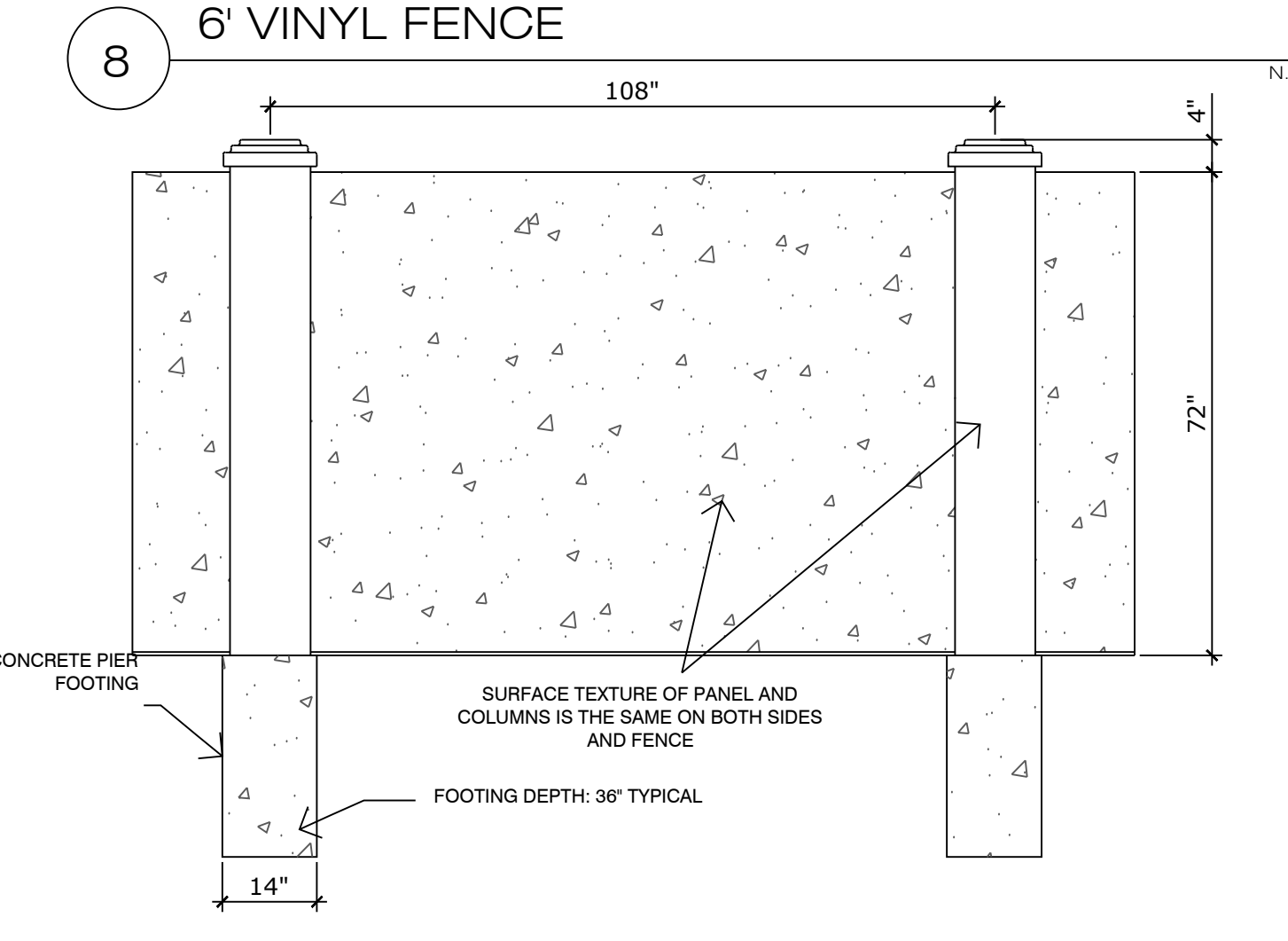
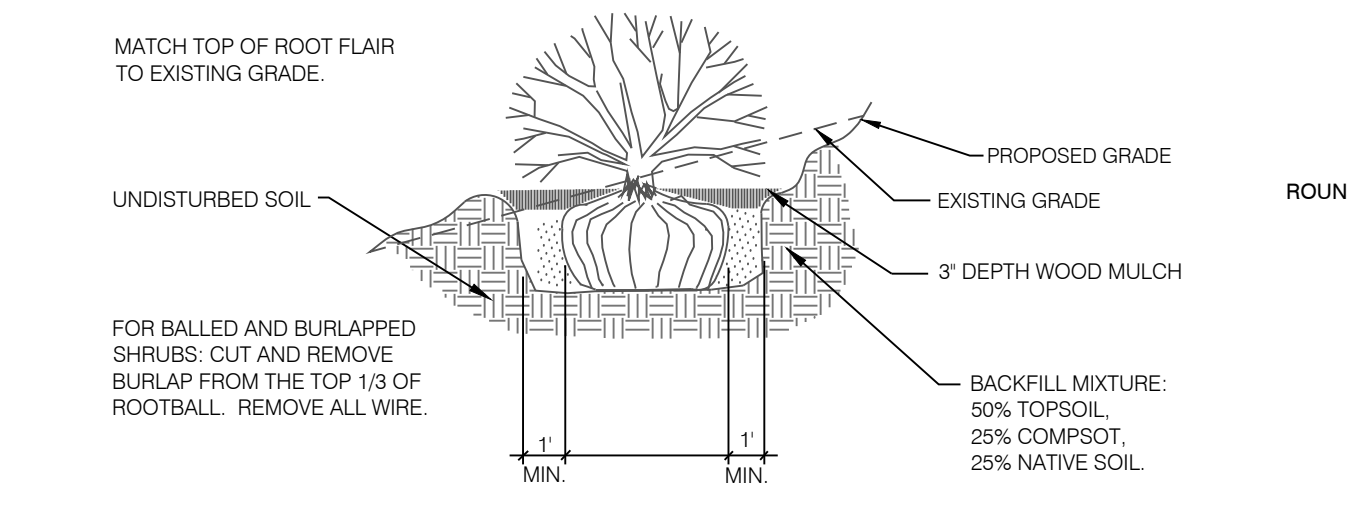
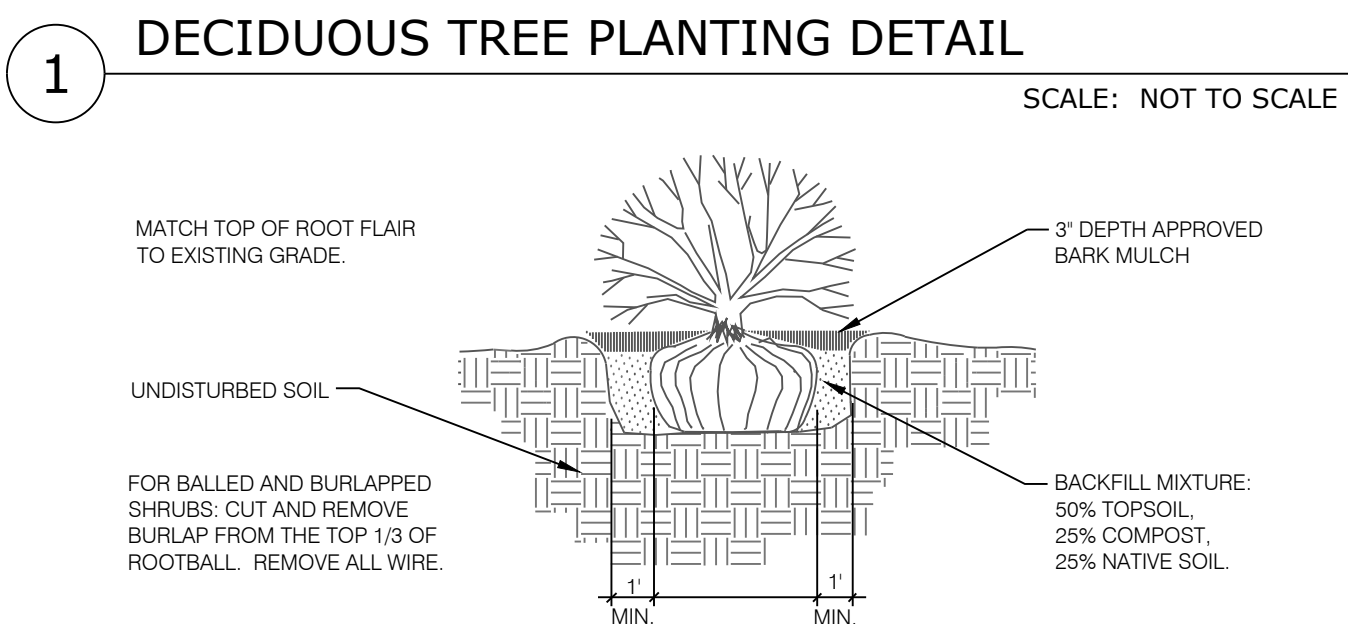
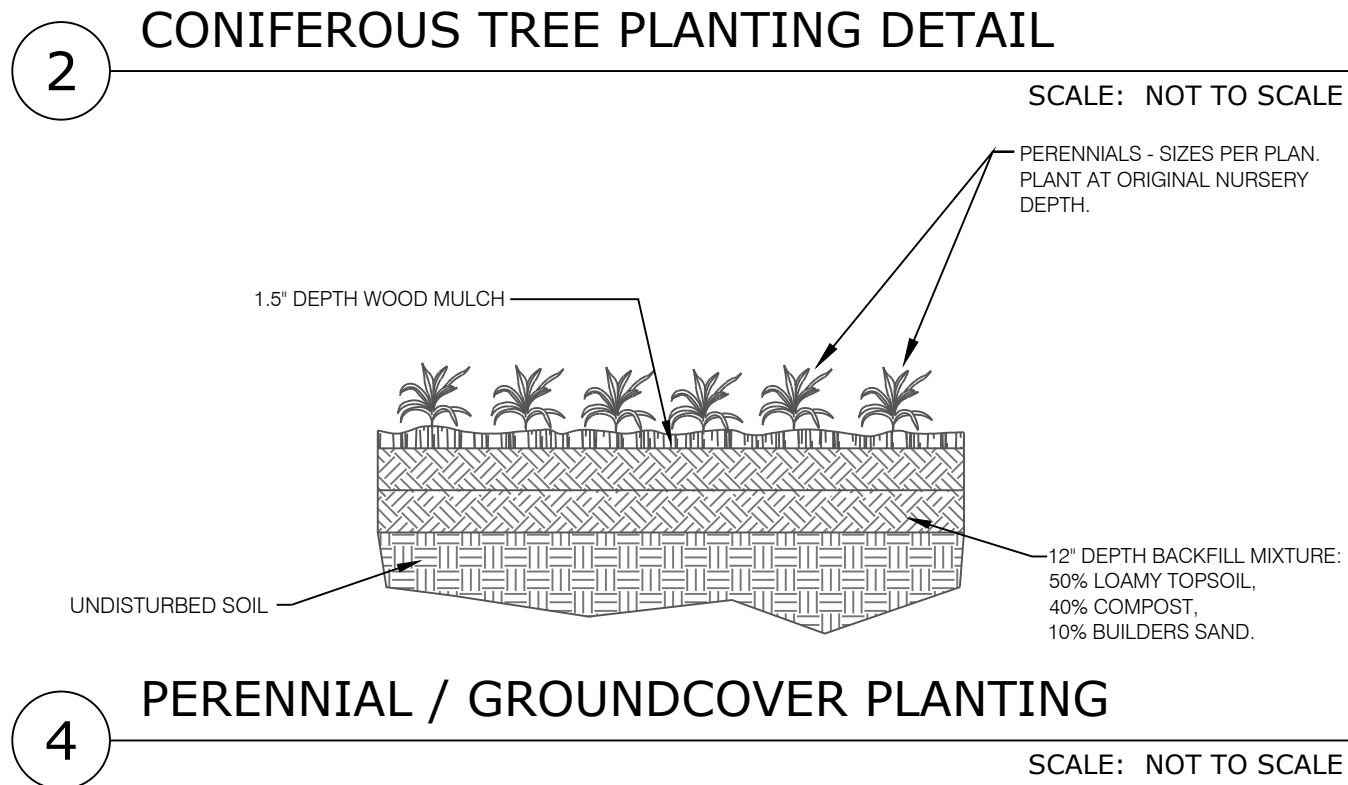
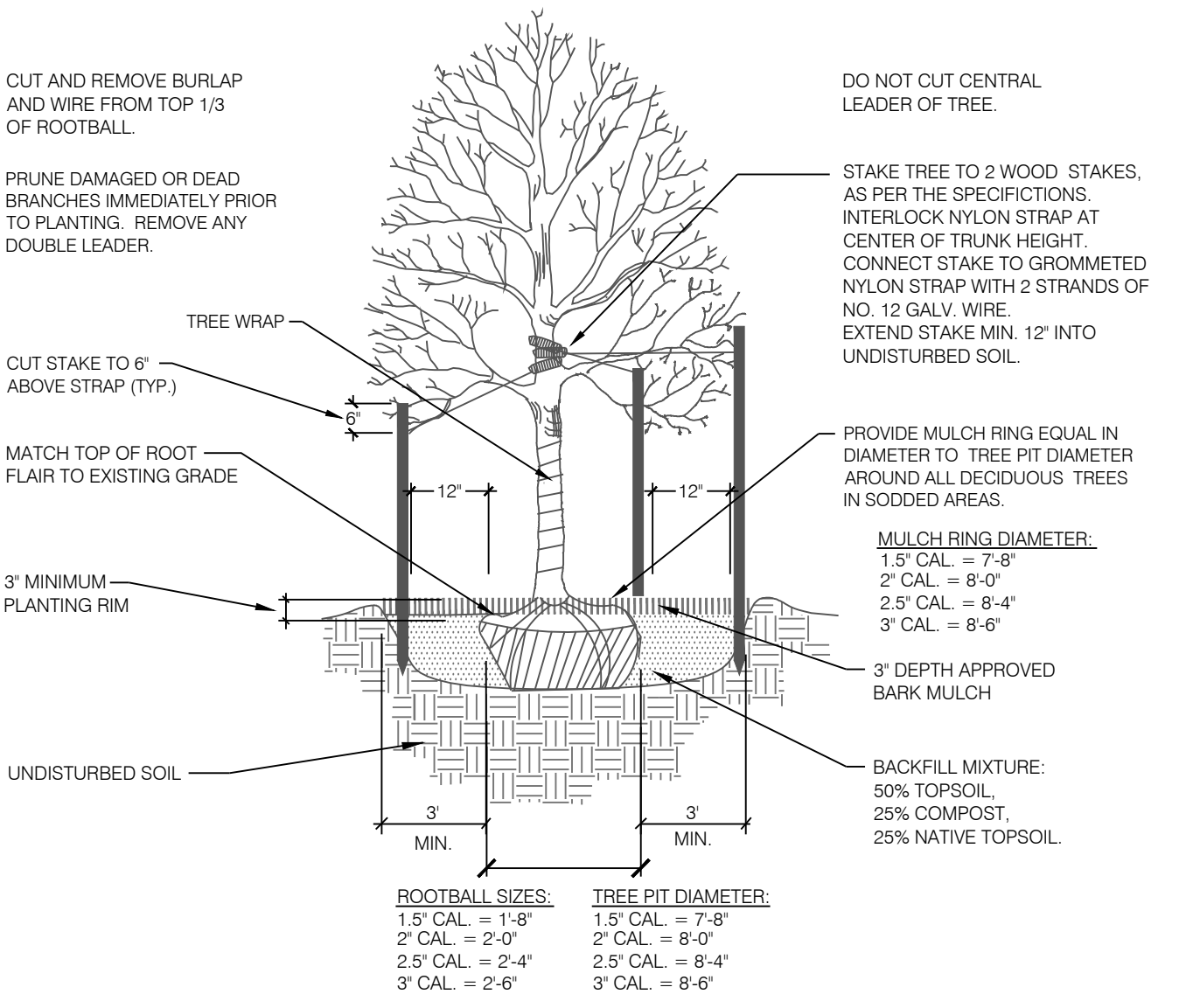
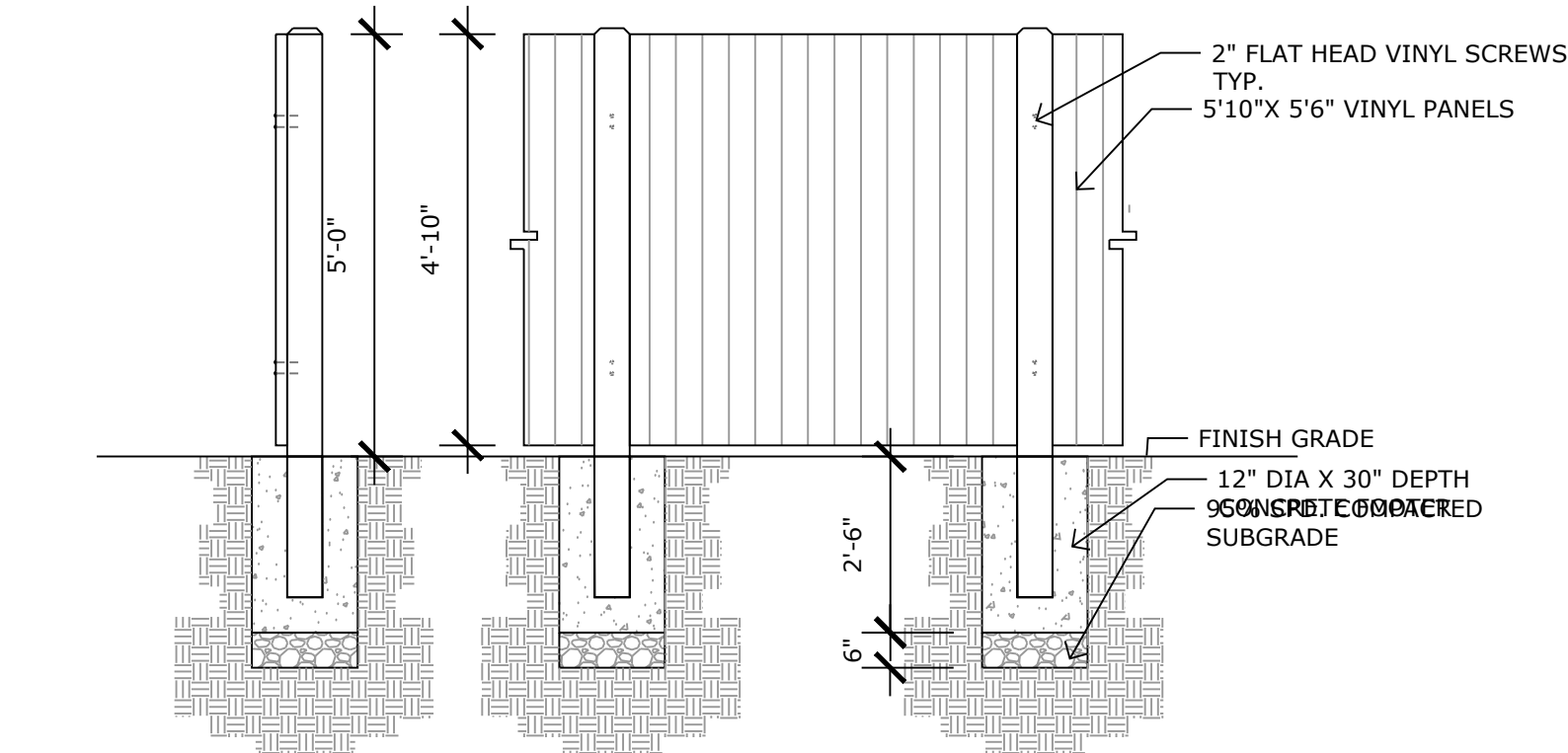
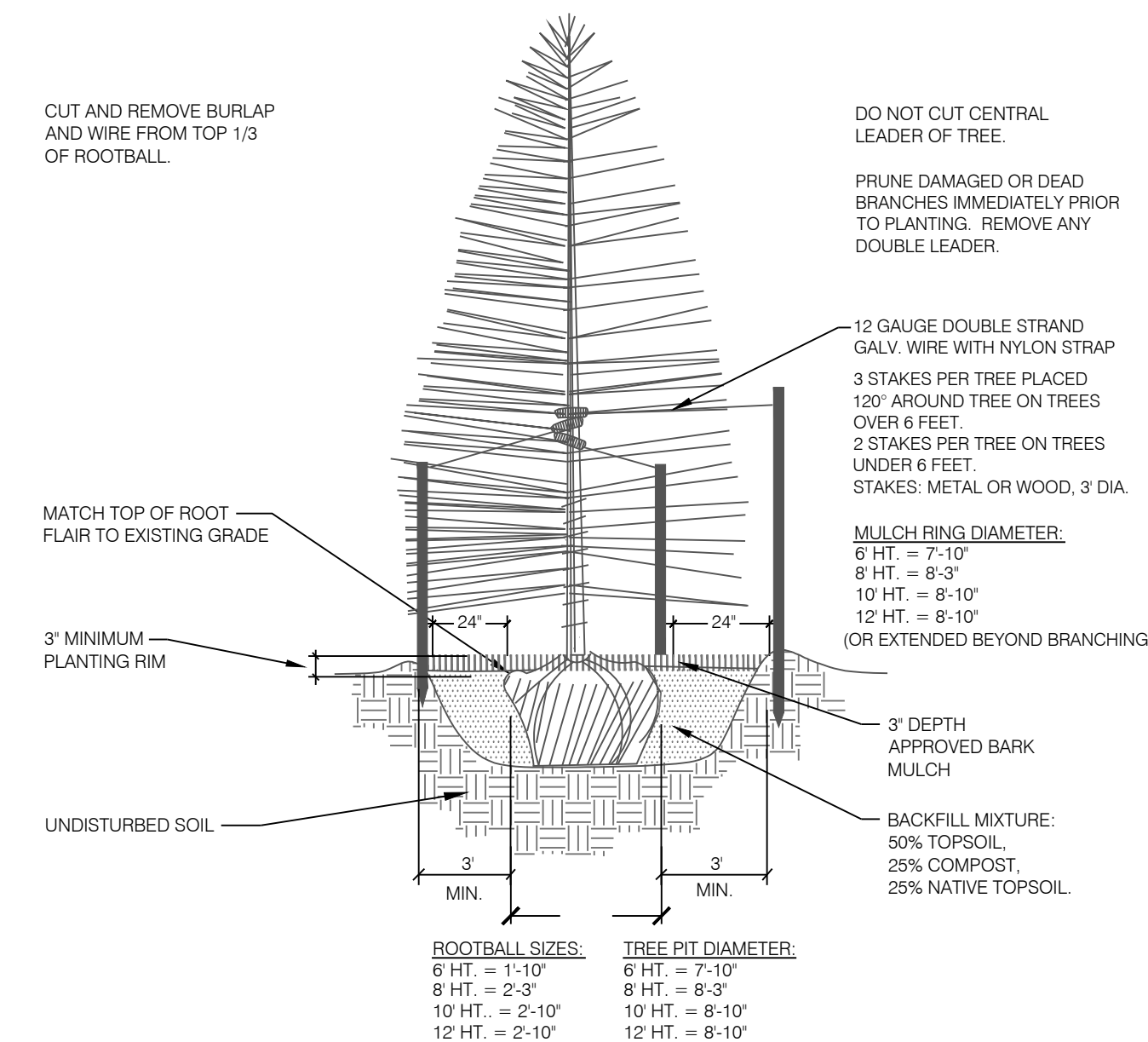

This drawing is for reference only to communicate design intent. Determination of the suitability and/or manner of use of any details contained in this document will be the sole responsibility of the structural engineer. Final project designs, including all construction details, shall be prepared by a licensed professional engineer using the actual conditions of the proposed site.



N.E.S. Inc.
619 N. Cascade Avenue, Suite 200
Colorado Springs, CO 80903
Tel. 719.471.0073
Fax 719.471.0267
www.nescolorado.com

© 2012. All Rights Reserved.

Copper Chase at Sterling Ranch

8335 Vollmer Road

DATE: 03.25.2022
PROJECT MGR: B. Swenson
PREPARED BY: J. Smith

Entitlement

DATE:	BY:	DESCRIPTION:
07.21.2022	B.H.	PER COUNTY COMMENT
05.12.2023	J.S./A.L.	PER COUNTY COMMENT

Landscape Notes & Details

6 OF 10
PUDSP 22-002

P:\Challenges\Copper Chase at Sterling Ranch\Drawings\Planting\Final\Area\Copper Chase ELP.dwg [LS-01] 5/15/2023 1:37:44 PM Jennifer Shapiro

COPPER CHASE AT STERLING RANCH

EL PASO COUNTY, COLORADO

A PORTION OF THE E 1/2 SE 1/4 OF SECTION 32 AND THE S 1/2 SW 1/4 OF SECTION 33, TOWNSHIP 12 SOUTH, RANGE 65 WEST,
AND THE NE 1/4 OF NE 1/4 OF SECTION 5, TOWNSHIP 13 SOUTH, RANGE 65 WEST, BOTH OF THE 6TH P.M.

PUD DEVELOPMENT/PRELIMINARY PLAN

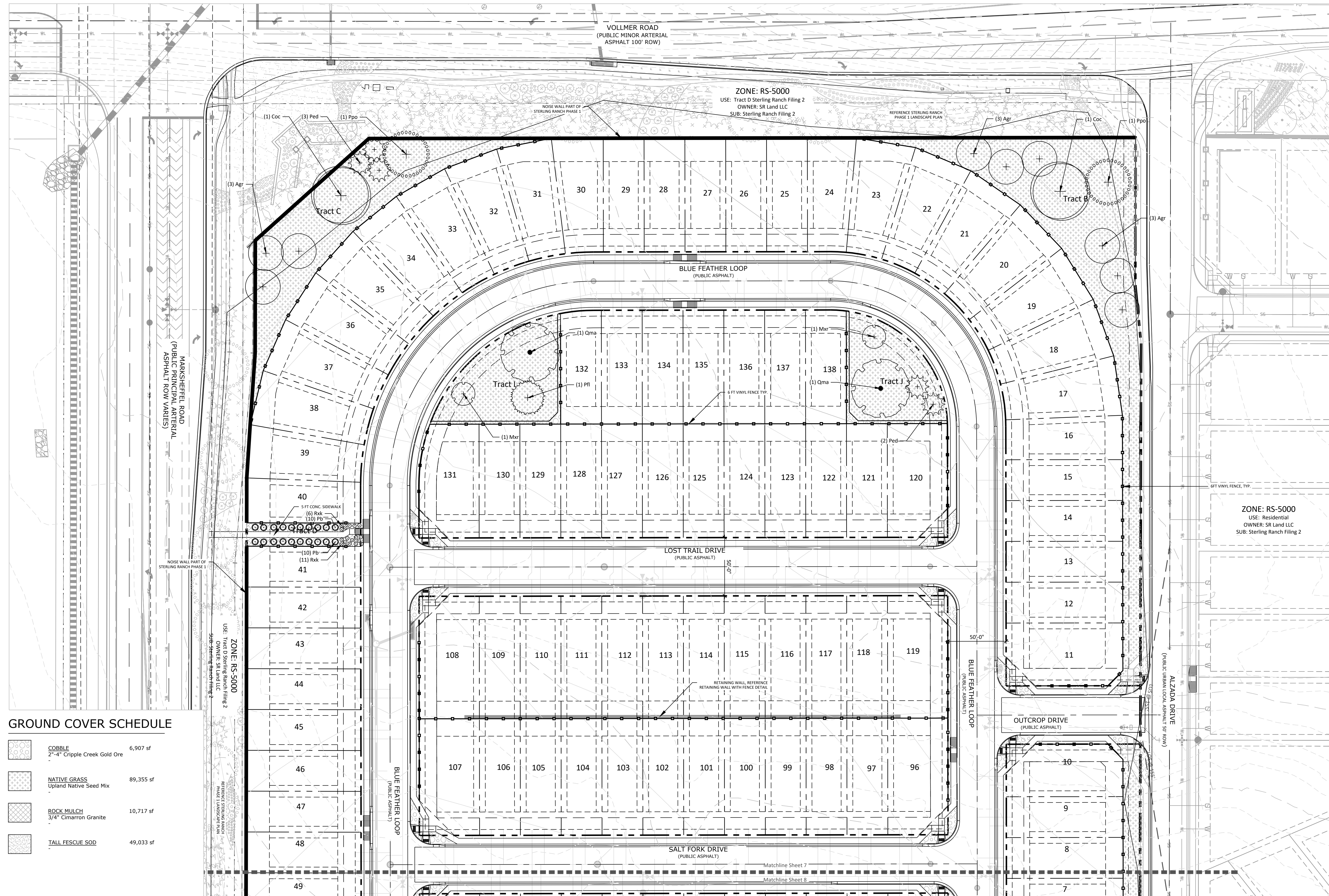

GROUND COVER SCHEDULE

	COBBLE 2"-4" Cripple Creek Gold Ore	6,907 sf
	NATIVE GRASS Upland Native Seed Mix	89,355 sf
	ROCK MULCH 3/4" Cimarron Granite	10,717 sf
	TALL FESCUE SOD	49,033 sf

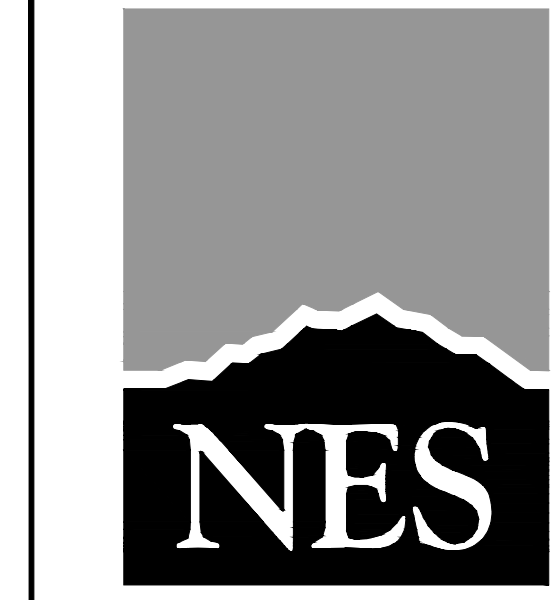

N.E.S. Inc.
619 N. Cascade Avenue, Suite 200
Colorado Springs, CO 80903

Tel. 719.471.0073
Fax 719.471.0267

www.nescolorado.com

© 2012. All Rights Reserved.

PLANNER / LANDSCAPE ARCHITECT

IN ASSOCIATION WITH

Copper Chase at Sterling Ranch

8335 Vollmer Road

DATE: 03.25.2022
PROJECT MGR: B. Swenson
PREPARED BY: J. Smith

STAMP

Entitlement

DATE: 07.21.2022 BY: B.H. DESCRIPTION: PER COUNTY COMMENT

05.12.2023 J.S./A.L. PER COUNTY COMMENT

ISSUE / REVISION

Landscape Plan

SHEET TITLE

7

7 OF 10

SHEET NUMBER

PUDSP 22-002

PLAN FILE #

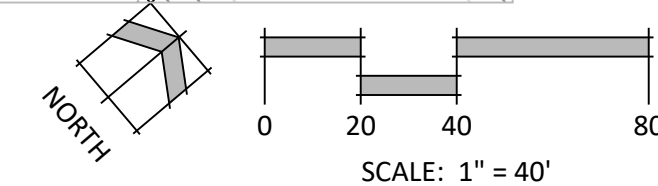

COPPER CHASE AT STERLING RANCH

EL PASO COUNTY, COLORADO A PORTION OF THE E 1/2 SE 1/4 OF SECTION 32 AND THE S 1/2 SW 1/4 OF SECTION 33, TOWNSHIP 12 SOUTH, RANGE 65 WEST, AND THE NE 1/4 OF NE 1/4 OF SECTION 5, TOWNSHIP 13 SOUTH, RANGE 65 WEST, BOTH OF THE 6TH P.M.

PUD DEVELOPMENT/PRELIMINARY PLAN

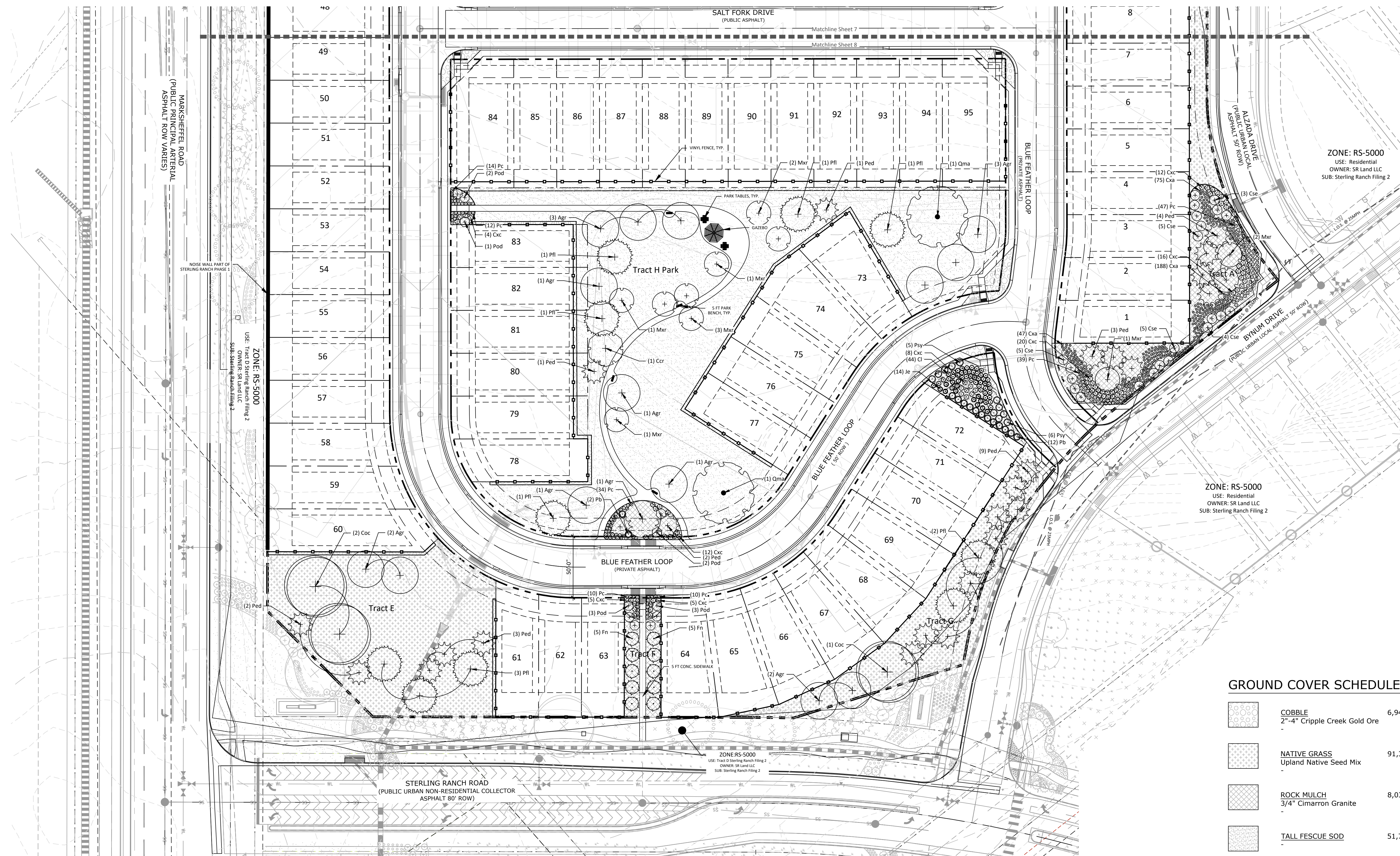

GROUND COVER SCHEDULE

	COBBLE 2"-4" Cripple Creek Gold Ore	6,943 sf
	NATIVE GRASS Upland Native Seed Mix	91,331 sf
	ROCK MULCH 3/4" Cimarron Granite	8,034 sf
	TALL FESCUE SOD	51,781 sf

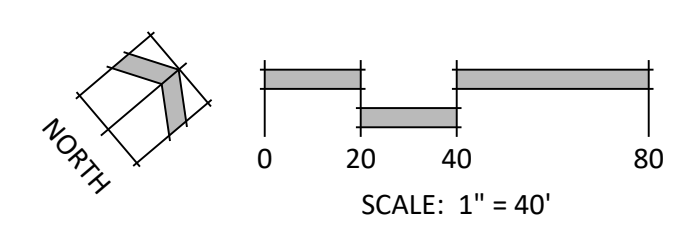

N.E.S. Inc.
619 N. Cascade Avenue, Suite 200
Colorado Springs, CO 80903
Tel. 719.471.0073
Fax 719.471.0267
www.nescolorado.com
© 2012. All Rights Reserved.

Copper Chase at Sterling Ranch

8335 Vollmer Road

DATE: 03.25.2022
PROJECT MGR: B. Swenson
PREPARED BY: J. Smith

Entitlement

DATE: 07.21.2022 BY: B.H. DESCRIPTION: PER COUNTY COMMENT
05.12.2023 J.S./A.L. PER COUNTY COMMENT

Landscape Plan

8

8 OF 10

PLAN FILE # PUDSP 22-002