



Released for Permit
07/30/2021 10:47:43 AM
REGIONAL
Building Department
Becky A
ENUMERATION



1588.3 B ELEVATION
AVERAGE FINISH GRADE = (AFG)
 $AFG = \frac{(71.1)(6)}{(6)} = 71.1$
BUILDING HEIGHT = 13.9 + (TF - AFG) =
BUILDING HEIGHT = 13.9 + (71.8 - 71.1) = 14.6

SFD211268

APPROVED
BESQCP
07/30/2021 3:56:11 PM
dsdyounger
EPC Planning & Community
Development Department

APPROVED
Plan Review
07/30/2021 3:56:14 PM
dsdyounger
EPC Planning & Community
Development Department

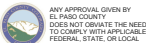
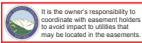

Planning & Community Development Department approval is contingent upon compliance with all applicable notes on the recorded plat.
An access permit must be obtained by the Planning & Community Development Department prior to the establishment of any driveway onto a County road.
Division of drainage of any drainage way is not permitted without approval of the Planning & Community Development Department.

LOT 71

LOT 69

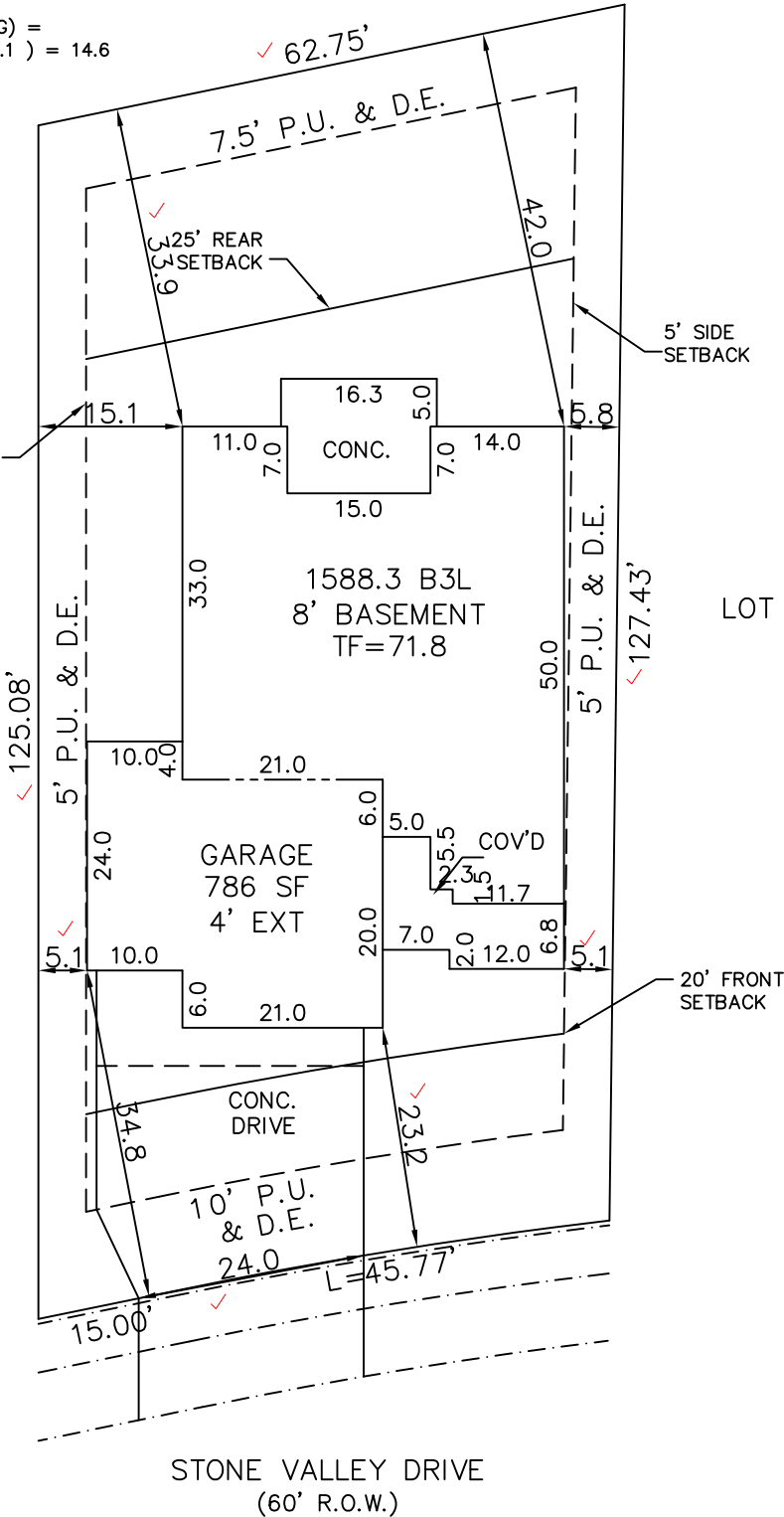

PUD
PLAT 14053

SCHEDULE No. 4229217009 ✓

SITE DATA

LOT SQ. FT.= 7619 ✓
HOUSE SQ. FT.= 2524 ✓
COVERAGE = 33.1% ✓
BLDG. HEIGHT = 14.6 ✓

SCALE: ...1"=20'

DRAWN BY: TAP

WARNING!

1. LOCATE UNDERGROUND UTILITIES PRIOR TO EXCAVATION.
2. THIS PLOT PLAN SHOWS IMPROVEMENTS AT GRADE ONLY. SEE FOUNDATION PLANS FOR STRUCTURAL INFORMATION

PLOT PLAN

LEGAL DESCRIPTION

LOT 70 ✓
STONEBRIDGE FILING NO. 3 AT MERIDIAN RANCH ✓
EL PASO COUNTY, COLORADO

ADDRESS

13028 STONE VALLEY DRIVE ✓

CAMPBELL HOMES
9230 GRAND CORDERA PARKWAY
COLORADO SPRINGS, COLORADO 80924
PHONE 719-266-9780

TITLE CO. FILE NO.

DRAWING NAME
S3-070

DATE

07-27-21

PROJECT NO.

Invoice

Woodmen Road Metropolitan District

c/o Walker Schooler District Managers
614 N. Tejon Street
Colorado Springs, CO 80903

PAID
07/29/2021

Date	Invoice #
7/29/2021	704

Bill To
Campbell Homes, LLC 4850 Austin Bluffs Pkwy. Colorado Springs, CO 80918

Due Date
7/29/2021

Description	Qty	Rate	Amount
LOT 70 - 13028 Stone Valley Dr. - Stonebridge Fil No 3 at Meridian Ranch	1	550.00	550.00
Total			\$550.00

Phone #	E-mail
(719) 447-1777	rebecca.h@wsdistricts.co

SITE



2017 PPRBC

Address: 13028 STONE VALLEY DR, PEYTON

Parcel: 4229217009

Plan Track #: 149428

Received: 30-Jul-2021 (BECKYA)

Description:

RESIDENCE

Type of Unit:

Garage	440	
Lower Level 2	3022	
Main Level	1588	
	5050	Total Square Feet

Required PPRBD Departments (2)

Enumeration

APPROVED

BECKYA

7/30/2021 10:58:00 AM

Floodplain

(N/A) RBD GIS

Required Outside Departments (1)

County Zoning

APPROVED

Plan Review

07/30/2021 3:56:00 PM

dsdyounger

EPC Planning & Community
Development Department

Release of this plan does not preclude compliance with all applicable codes, ordinances and other pertinent regulations. This plan set must be present on the job site for every inspection.