

### Notification Letter

This letter is being sent to you because the owners of 150 acres located at 10675 McClelland Road are proposing a land use project. This information is being provided to you prior to a submittal with the County.

Prior to any public hearing on this proposal a notification of the time and place of the public hearing will be sent to the adjacent property owners by the El Paso County Planning Department. At that time you will be given the El Paso County contact information, the file number and an opportunity to respond either for, against or expressing no opinion in writing or in person at the public hearing.

The applicant is requesting to expand the existing Special Use Permit for mining, which is currently for 17 acres, to an additional 52 acres on the 150 acre property. The additional area is needed to mine a grade the property efficiently.

The plan is to grade and remove approximately 5' to 10' of material from the permitted area and reclaim to grassland. No more than 10 acres will be disturbed at any one time. After material is removed, topsoil will be replaced and seeded to keep the open area to a minimum. All grading will be a least 200' from any property line. Typical construction equipment such as a road grader and front end loader will be used to grade the property and load trucks.

There are no existing facilities, structures or roads and none are proposed for the expanded area.

A vicinity map is attached showing the adjacent property owners.

There is a form enclosed called the "Notification of Adjacent Property Owners", please sign, write any comments and return in the envelope provided.

Please direct any questions on the proposal to Joe Kraig, PO Box 49681, Colorado Springs, Co. 80949, 719-598-7605, [cherrystoneway@msn.com](mailto:cherrystoneway@msn.com)

**Notification of Adjacent Property Owners**

Name and Address of Petitioner(s): S + K LLC  
PO Box 49681  
COLORADO SPRING CO 80949  
 Telephone #'s: 719-598-7605  
 Description of Proposal: INCREASE 12 ACRE SPECIAL USE PERMIT FOR MINING  
TO 68 ACRES.

A list of adjacent property owners may be acquired from the County Assessor's office. If adjacent property owners cannot be reached in person, the applicant must send an Adjacent Property Owner Notification letter by certified mail and provide, as part of the submittal, a copy of the letter sent and a copy of each receipt.

The undersigned, being an adjacent property owner, has read the above notification. I understand I may appear in person at the advertised public hearing to further express my comments.

Date	Owner (Yes or No)	Name (Signature) and Address	Comments

(For additional space, attach a separate sheet of paper)

Above are the signatures of the adjacent property owners who own the property described after their names or who are located as indicated (e.g. north of the subject property). I hereby acknowledge that the information provided within this notification is correct.

\_\_\_\_\_ date \_\_\_\_\_  
 (Signature of Petitioner or Owner)

\_\_\_\_\_ date \_\_\_\_\_  
 (Signature of Petitioner or Owner)

Help | Map Search | Database Search | Zoom to Region | Measure Tool | Print | AERIAL | ROAD <<

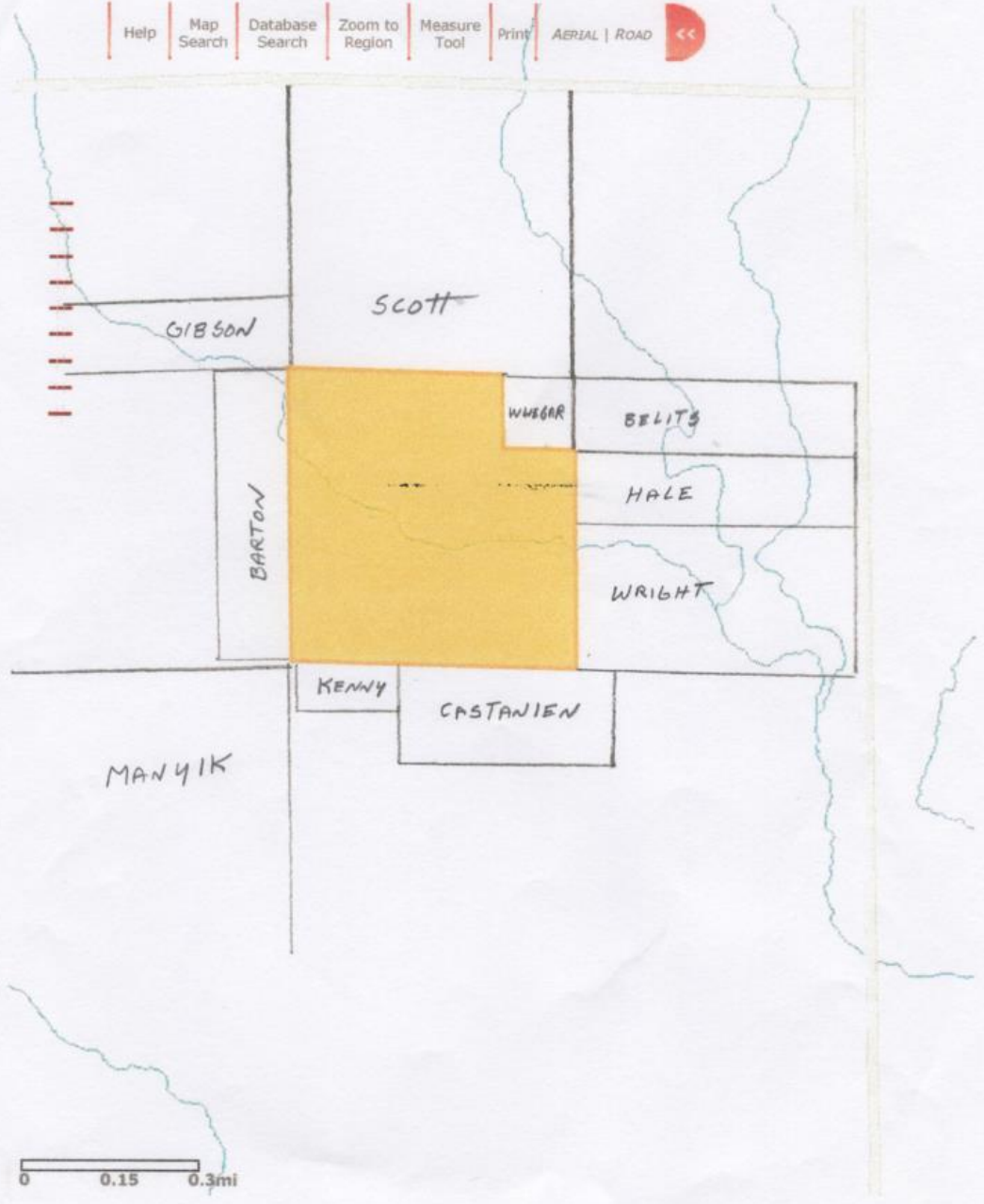

Dear Neighbor,

We own 150 acres at 10675 McClelland Road which is at the corner of McClelland and Spencer Road. The property currently has 17 acres permitted for mining through El Paso County. We have applied at the County to increase the acreage for mining to a total of 68 acres.

Before the application can be processed, the County requires that all adjacent property owners be notified.

We have attached a Notification Letter with the information and in the form required by the County. Please contact me if have any questions or concerns.

Your time is valuable and we all deal with enough red tape as it is, but your response will help us out and be appreciated.

Sincerely,

Joe Kraig

Manyik:

1. Return receipt-YES
2. Return letter-NO
3. Phone call-NO

Barton:

1. Return receipt-YES
2. Return letter-NO
3. Phone call-NO

Gibson:

1. Return receipt-YES
2. Return letter-NO
3. Phone call-NO

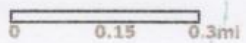
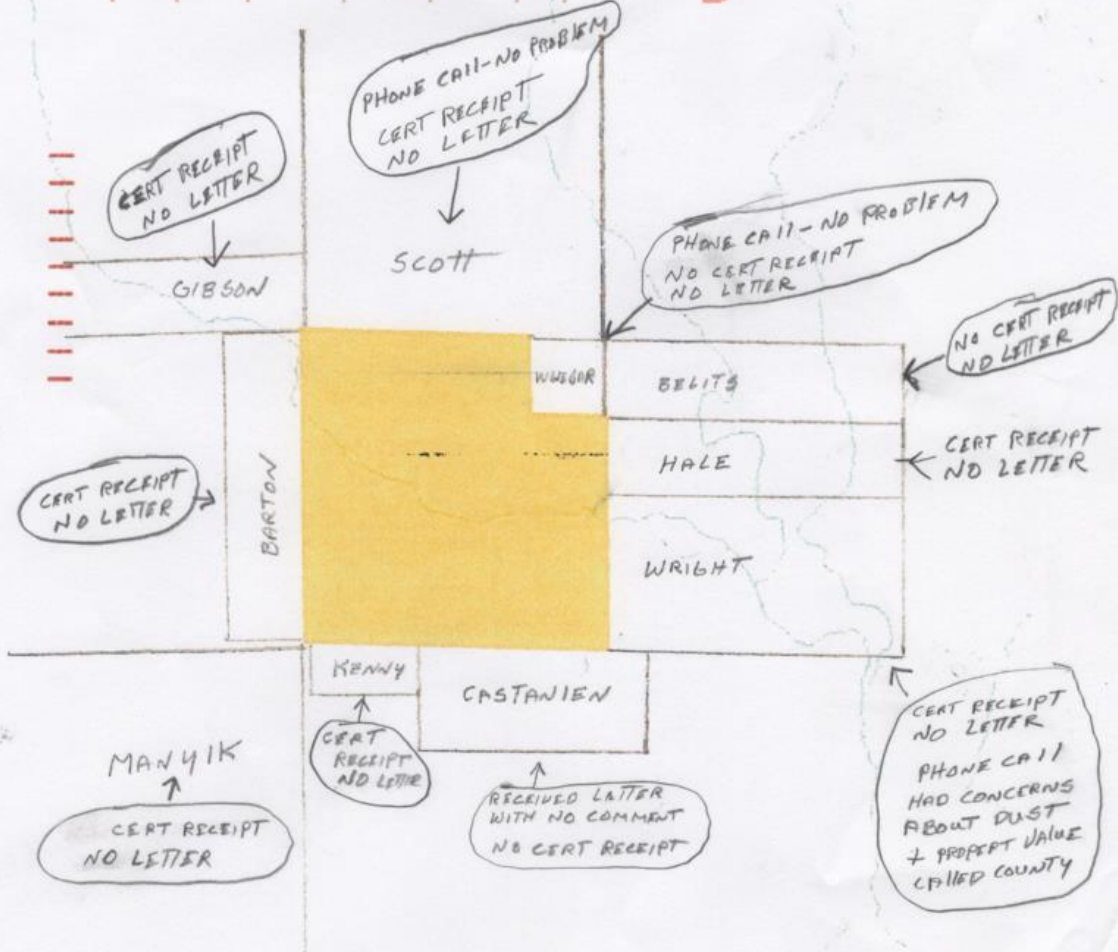

CASTANIER

**Notification of Adjacent Property Owners**

Name and Address of Petitioner(s): S+K LLC  
PO BOX 49681  
COLORADO SPRING CO 80949  
Telephone #'s: 719-598-7605  
Description of Proposal: INCREASE 12 ACRE SPECIAL USE PERMIT FOR MINING  
TO 68 ACRES.

A list of adjacent property owners may be acquired from the County Assessor's office. If adjacent property owners cannot be reached in person, the applicant must send an Adjacent Property Owner Notification letter by certified mail and provide, as part of the submittal, a copy of the letter sent and a copy of each receipt.

The undersigned, being an adjacent property owner, has read the above notification. I understand I may appear in person at the advertised public hearing to further express my comments.

Date	Owner (Yes or No)	Name (Signature) and Address	Comments
1/30/18	yes	Suzie Castanier 6554 N EVELOTT HWY COLORADO CO 80808	

(For additional space, attach a separate sheet of paper)

Above are the signatures of the adjacent property owners who own the property described after their names or who are located as indicated (e.g. north of the subject property). I hereby acknowledge that the information provided within this notification is correct.

Suzie Castanier date 1/20/18  
(Signature of Petitioner or Owner)

\_\_\_\_\_  
(Signature of Petitioner or Owner)

BARTON

**Notification of Adjacent Property Owners**

Name and Address of Petitioner(s): S+K LLC  
PO BOX 49681  
COLORADO SPRING CO 80949  
Telephone #'s: 719-598-7605  
Description of Proposal: INCREASE 12 ACRE SPECIAL USE PERMIT FOR MINING  
TO 68 ACRES.

A list of adjacent property owners may be acquired from the County Assessor's office. If adjacent property owners cannot be reached in person, the applicant must send an Adjacent Property Owner Notification letter by certified mail and provide, as part of the submittal, a copy of the letter sent and a copy of each receipt.

The undersigned, being an adjacent property owner, has read the above notification. I understand I may appear in person at the advertised public hearing to further express my comments.

Date	Owner (Yes or No)	Name (Signature) and Address	Comments
7/23/18	yes	Martin Barton 10554 Meekland Rd COLORADO CO. 80808	

(For additional space, attach a separate sheet of paper)

Above are the signatures of the adjacent property owners who own the property described after their names or who are located as indicated (e.g. north of the subject property). I hereby acknowledge that the information provided within this notification is correct.

\_\_\_\_\_  
date  
(Signature of Petitioner or Owner)

\_\_\_\_\_  
date  
(Signature of Petitioner or Owner)



Certified Mailings

Scott:

1. Return receipt-YES
2. Return letter-NO
3. Phone call-YES, no problem

Winegar:

1. Return receipt-NO
2. Return letter-NO
3. Phone call-YES, no problem.

Belits:

1. Return receipt-NO, mailing address was undeliverable.
2. Return letter-NO
3. Phone call-NO

Hale:

1. Return receipt-YES
2. Return letter-NO
3. Phone call-NO

Wright:

1. Return receipt-YES
2. Return letter-NO
3. Phone call-YES. She had concerns about possibility of dust and questioning if the operation might devalue her property. I explained the mining operation and that if dust was a problem it would be mitigated with watering. She wants more information as we go through the process. She had also called the County for information.

Castanien:

1. Return receipt-NO
2. Return letter-YES, no comment.
3. Phone call-NO

Kenny:

1. Return receipt-YES
2. Return letter-NO
3. Phone call-NO

**Notification of Adjacent Property Owners**

Name and Address of Petitioner(s): S + K LLC  
PO BOX 49681  
COLORADO SPRING CO 80949  
 Telephone #'s: 719-598-7605  
 Description of Proposal: INCREASE 12 ACRE SPECIAL USE PERMIT FARMING  
TO 68 ACRES.

A list of adjacent property owners may be acquired from the County Assessor's office. If adjacent property owners cannot be reached in person, the applicant must send an Adjacent Property Owner Notification letter by certified mail and provide, as part of the submittal, a copy of the letter sent and a copy of each receipt.

The undersigned, being an adjacent property owner, has read the above notification. I understand I may appear in person at the advertised public hearing to further express my comments.

Date	Owner (Yes or No)	Name (Signature) and Address	Comments
4/12	Yes	Rosale Scott 22692 Scott Rd	
4/11	Yes	Susan J Scott 22692 Scott Rd	
8/11	Yes	Martha Jean Scott 22692 Scott Rd	

(For additional space, attach a separate sheet of paper)

Above are the signatures of the adjacent property owners who own the property described after their names or who are located as indicated (e.g. north of the subject property). I hereby acknowledge that the information provided within this notification is correct.

Susan J Scott date 8/11  
 (Signature of Petitioner or Owner)

\_\_\_\_\_ date \_\_\_\_\_  
 (Signature of Petitioner or Owner)

7015 1730 0001 6246 6869

U.S. Postal Service™  
**CERTIFIED MAIL® RECEIPT**  
 Domestic Mail Only

For delivery information, visit our website at [www.usps.com](http://www.usps.com)®.

**LITTLETON, CO 80130**

**OFFICIAL USE**

Certified Mail Fee	\$3.45	
Extra Services & Fees (check box, add fee)	\$2.75	
<input type="checkbox"/> Return Receipt (hardcopy)	\$0.00	
<input type="checkbox"/> Return Receipt (electronic)	\$0.00	
<input type="checkbox"/> Certified Mail Restricted Delivery	\$0.00	
<input type="checkbox"/> Adult Signature Required	\$0.00	
<input type="checkbox"/> Adult Signature Restricted Delivery	\$0.00	
Postage	\$0.71	
Total Postage and Fees	\$6.91	

Sent To **BILITS**  
 Street and Apt. No., or PO Box No.  
 City, State, ZIP+4®

PS Form 3800, April 2015 PSN 7530-02-000-9047 See Reverse for Instructions



7018 0360 0001 5734 0957

U.S. Postal Service™  
**CERTIFIED MAIL® RECEIPT**  
 Domestic Mail Only

For delivery information, visit our website at [www.usps.com](http://www.usps.com)®.

**ELBERT, CO 80106**

**OFFICIAL USE**

Certified Mail Fee	\$3.45	
Extra Services & Fees (check box, add fee)	\$2.75	
<input type="checkbox"/> Return Receipt (hardcopy)	\$0.00	
<input type="checkbox"/> Return Receipt (electronic)	\$0.00	
<input type="checkbox"/> Certified Mail Restricted Delivery	\$0.00	
<input type="checkbox"/> Adult Signature Required	\$0.00	
<input type="checkbox"/> Adult Signature Restricted Delivery	\$0.00	
Postage	\$0.71	
Total Postage and Fees	\$6.91	

Sent To ~~STAY~~ **VINEGAR**  
 Street and Apt. No., or PO Box No.  
 City, State, ZIP+4®

PS Form 3800, April 2015 PSN 7530-02-000-9047 See Reverse for Instructions



7015 1730 0001 6246 6838

U.S. Postal Service™  
**CERTIFIED MAIL® RECEIPT**  
 Domestic Mail Only

For delivery information, visit our website at [www.usps.com](http://www.usps.com)®.

**CALHAN, CO 80808**

**OFFICIAL USE**

Certified Mail Fee	\$3.45	
Extra Services & Fees (check box, add fee)	\$2.75	
<input type="checkbox"/> Return Receipt (hardcopy)	\$0.00	
<input type="checkbox"/> Return Receipt (electronic)	\$0.00	
<input type="checkbox"/> Certified Mail Restricted Delivery	\$0.00	
<input type="checkbox"/> Adult Signature Required	\$0.00	
<input type="checkbox"/> Adult Signature Restricted Delivery	\$0.00	
Postage	\$0.71	
Total Postage and Fees	\$6.91	

Sent To **CASTANEDA**  
 Street and Apt. No., or PO Box No.  
 City, State, ZIP+4®

PS Form 3800, April 2015 PSN 7530-02-000-9047 See Reverse for Instructions



7015 1730 0001 6246 6845

U.S. Postal Service™  
**CERTIFIED MAIL® RECEIPT**  
 Domestic Mail Only

For delivery information, visit our website at [www.usps.com](http://www.usps.com)®.

**MERCER ISLAND, WA 98040**

**OFFICIAL USE**

Certified Mail Fee	\$3.45	
Extra Services & Fees (check box, add fee)	\$2.75	
<input type="checkbox"/> Return Receipt (hardcopy)	\$0.00	
<input type="checkbox"/> Return Receipt (electronic)	\$0.00	
<input type="checkbox"/> Certified Mail Restricted Delivery	\$0.00	
<input type="checkbox"/> Adult Signature Required	\$0.00	
<input type="checkbox"/> Adult Signature Restricted Delivery	\$0.00	
Postage	\$0.71	
Total Postage and Fees	\$6.91	

Sent To **WRIGHT**  
 Street and Apt. No., or PO Box No.  
 City, State, ZIP+4®

PS Form 3800, April 2015 PSN 7530-02-000-9047 See Reverse for Instructions



7015 1730 0001 6246 6890

U.S. Postal Service™  
**CERTIFIED MAIL® RECEIPT**  
 Domestic Mail Only

For delivery information, visit our website at [www.usps.com](http://www.usps.com)®.

**CALHAN, CO 80808**

**OFFICIAL USE**

Certified Mail Fee	\$3.45	
Extra Services & Fees (check box, add fee)	\$2.75	
<input type="checkbox"/> Return Receipt (hardcopy)	\$0.00	
<input type="checkbox"/> Return Receipt (electronic)	\$0.00	
<input type="checkbox"/> Certified Mail Restricted Delivery	\$0.00	
<input type="checkbox"/> Adult Signature Required	\$0.00	
<input type="checkbox"/> Adult Signature Restricted Delivery	\$0.00	
Postage	\$0.71	
Total Postage and Fees	\$6.91	

Sent To **BARTON**  
 Street and Apt. No., or PO Box No.  
 City, State, ZIP+4®

PS Form 3800, April 2015 PSN 7530-02-000-9047 See Reverse for Instructions



7018 0360 0001 5734 0940

U.S. Postal Service™  
**CERTIFIED MAIL® RECEIPT**  
 Domestic Mail Only

For delivery information, visit our website at [www.usps.com](http://www.usps.com)®.

**CALHAN, CO 80808**

**OFFICIAL USE**

Certified Mail Fee	\$3.45	
Extra Services & Fees (check box, add fee)	\$2.75	
<input type="checkbox"/> Return Receipt (hardcopy)	\$0.00	
<input type="checkbox"/> Return Receipt (electronic)	\$0.00	
<input type="checkbox"/> Certified Mail Restricted Delivery	\$0.00	
<input type="checkbox"/> Adult Signature Required	\$0.00	
<input type="checkbox"/> Adult Signature Restricted Delivery	\$0.00	
Postage	\$0.71	
Total Postage and Fees	\$6.91	

Sent To **MANYAK**  
 Street and Apt. No., or PO Box No.  
 City, State, ZIP+4®

PS Form 3800, April 2015 PSN 7530-02-000-9047 See Reverse for Instructions



7015 1730 0001 6246 6821

# U.S. Postal Service™ CERTIFIED MAIL® RECEIPT

Domestic Mail Only

For delivery information, visit our website at [www.usps.com](http://www.usps.com)®.  
ANTON, CO 80801

Certified Mail Fee	\$3.45
Extra Services & Fees (check box, add fee)	\$2.75
<input type="checkbox"/> Return Receipt (hardcopy)	\$0.00
<input type="checkbox"/> Return Receipt (electronic)	\$0.00
<input type="checkbox"/> Certified Mail Restricted Delivery	\$0.00
<input type="checkbox"/> Adult Signature Required	\$0.00
<input type="checkbox"/> Adult Signature Restricted Delivery	\$0.00
Postage	\$0.71
Total Postage and Fees	\$6.91

0619 13  
ROCKRIMMON STATION  
Postmark Here  
JUL 23 2018  
COLORADO SPRINGS, CO 80908  
07/23/2018

Sent To **KENNY**  
Street and Apt. No., or PO Box No.  
City, State, ZIP+4®

7015 1730 0001 6246 6876

# U.S. Postal Service™ CERTIFIED MAIL® RECEIPT

Domestic Mail Only

For delivery information, visit our website at [www.usps.com](http://www.usps.com)®.  
CALHAN, CO 80808

Certified Mail Fee	\$3.45
Extra Services & Fees (check box, add fee)	\$2.75
<input type="checkbox"/> Return Receipt (hardcopy)	\$0.00
<input type="checkbox"/> Return Receipt (electronic)	\$0.00
<input type="checkbox"/> Certified Mail Restricted Delivery	\$0.00
<input type="checkbox"/> Adult Signature Required	\$0.00
<input type="checkbox"/> Adult Signature Restricted Delivery	\$0.00
Postage	\$0.71
Total Postage and Fees	\$6.91

0619 13  
ROCKRIMMON STATION  
Postmark Here  
JUL 23 2018  
COLORADO SPRINGS, CO 80908  
07/23/2018

Sent To **SCOTT**  
Street and Apt. No., or PO Box No.  
City, State, ZIP+4®

7015 1730 0001 6246 6852

# U.S. Postal Service™ CERTIFIED MAIL® RECEIPT

Domestic Mail Only

For delivery information, visit our website at [www.usps.com](http://www.usps.com)®.  
CALHAN, CO 80808

Certified Mail Fee	\$3.45
Extra Services & Fees (check box, add fee)	\$2.75
<input type="checkbox"/> Return Receipt (hardcopy)	\$0.00
<input type="checkbox"/> Return Receipt (electronic)	\$0.00
<input type="checkbox"/> Certified Mail Restricted Delivery	\$0.00
<input type="checkbox"/> Adult Signature Required	\$0.00
<input type="checkbox"/> Adult Signature Restricted Delivery	\$0.00
Postage	\$0.71
Total Postage and Fees	\$6.91

0619 13  
ROCKRIMMON STATION  
Postmark Here  
JUL 23 2018  
COLORADO SPRINGS, CO 80908  
07/23/2018

Sent To **HALE**  
Street and Apt. No., or PO Box No.  
City, State, ZIP+4®

7015 1730 0001 6246 6888

# U.S. Postal Service™ CERTIFIED MAIL® RECEIPT

Domestic Mail Only

For delivery information, visit our website at [www.usps.com](http://www.usps.com)®.  
CALHAN, CO 80808

Certified Mail Fee	\$3.45
Extra Services & Fees (check box, add fee)	\$2.75
<input type="checkbox"/> Return Receipt (hardcopy)	\$0.00
<input type="checkbox"/> Return Receipt (electronic)	\$0.00
<input type="checkbox"/> Certified Mail Restricted Delivery	\$0.00
<input type="checkbox"/> Adult Signature Required	\$0.00
<input type="checkbox"/> Adult Signature Restricted Delivery	\$0.00
Postage	\$0.71
Total Postage and Fees	\$6.91

0619 13  
ROCKRIMMON STATION  
Postmark Here  
JUL 23 2018  
COLORADO SPRINGS, CO 80908  
07/23/2018

Sent To **GIBSON**  
Street and Apt. No., or PO Box No.  
City, State, ZIP+4®