

COMMENTS

A volume warrant was performed using traffic counts to show...
The intersection of North Carefree Circle and Antelope Ridge...
The existing traffic volume is 1000...
The proposed traffic volume is 1200...
The existing traffic volume is 1000...
The proposed traffic volume is 1200...
The existing traffic volume is 1000...
The proposed traffic volume is 1200...

Subject: Text Box
Page Index: 8
Date: 3/20/2019 10:58:22 AM
Author: dsdrice
Color: ■
Layer:
Space:
Page Label: 8

What would the queues be without the signal?



Subject: Text Box
Page Index: 8
Date: 3/20/2019 11:30:05 AM
Author: dsdrice
Color: ■
Layer:
Space:
Page Label: 8

Address the Marksheffel/North Carefree intersection. Is the impact from this development < B.4.1 requirements (would create impeded traffic flows and/or excessive congestion; when added project traffic is determined to create potential safety problems?)

A volume warrant was performed using traffic counts to show...
The intersection of North Carefree Circle and Antelope Ridge...
The existing traffic volume is 1000...
The proposed traffic volume is 1200...
The existing traffic volume is 1000...
The proposed traffic volume is 1200...

Subject: Cloud+
Page Index: 10
Date: 3/20/2019 11:31:06 AM
Author: dsdrice
Color: ■
Layer:
Space:
Page Label: 10

verify

A volume warrant was performed using traffic counts to show...
The intersection of North Carefree Circle and Antelope Ridge...
The existing traffic volume is 1000...
The proposed traffic volume is 1200...
The existing traffic volume is 1000...
The proposed traffic volume is 1200...

Subject: Cloud+
Page Index: 10
Date: 3/20/2019 11:32:20 AM
Author: dsdrice
Color: ■
Layer:
Space:
Page Label: 10

A deviation is not likely to be approved without this information.



Subject: Cloud+
Page Index: 10
Date: 3/20/2019 11:35:10 AM
Author: dsdrice
Color: ■
Layer:
Space:
Page Label: 10

The lanes will likely be required with Phase 1 if the access is approved.

A volume warrant was performed using traffic counts to show...
The intersection of North Carefree Circle and Antelope Ridge...
The existing traffic volume is 1000...
The proposed traffic volume is 1200...
The existing traffic volume is 1000...
The proposed traffic volume is 1200...

Subject: Callout
Page Index: 10
Date: 3/20/2019 11:36:46 AM
Author: dsdrice
Color: ■
Layer:
Space:
Page Label: 10

what about acceleration lane?



Subject: Text Box
Page Index: 18
Date: 3/20/2019 12:20:13 PM
Author: dsdrice
Color: ■
Layer:
Space:
Page Label: 18

Provide Marksheffel Link ADT.

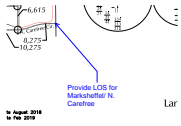

Subject: Callout
Page Index: 18
Date: 3/20/2019 12:21:46 PM
Author: dsdrice
Color: ■
Layer:
Space:
Page Label: 18

Provide LOS for Marksheffel/ N. Carefree

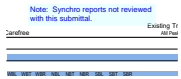

Subject: Text Box
Page Index: 50
Date: 3/20/2019 12:45:47 PM
Author: dsdrice
Color: ■
Layer:
Space:
Page Label: 50

Note: Synchro reports not reviewed with this submittal.