

General Utility Report

Updated June 30, 2022
November 30, 2021

MESA RIDGE ODP Amendment #5

Utility providers and proximity

Sanitary Sewer Service

Mesa Ridge is served by Fountain Sanitation District. The East/SE portion will access the existing line adjacent to Marksheffel Road highlighted in Green on the attached exhibit. The Southern connection will require an offsite extension previously discussed with the district engineer.

Water Service

Water is provided by the Widefield Water and Sanitation District. The existing stubs are shown in blue on the attached exhibit. Discussion with the district engineer has occurred concerning future development needs.

Electric Service

Electric service is provided by City of Fountain Electric, facilities exist on Cross Creek Ave. and C&S Road. Future extension is planned for the Marksheffel Road corridor.

Natural Gas

Natural Gas is provided by Black Hills Energy and currently exists within and adjacent to the project.

MESA RIDGE

UTILITY SERVICE

OVERALL DEVELOPMENT PLAN AMENDMENT #5 CITY OF FOUNTAIN, COLORADO

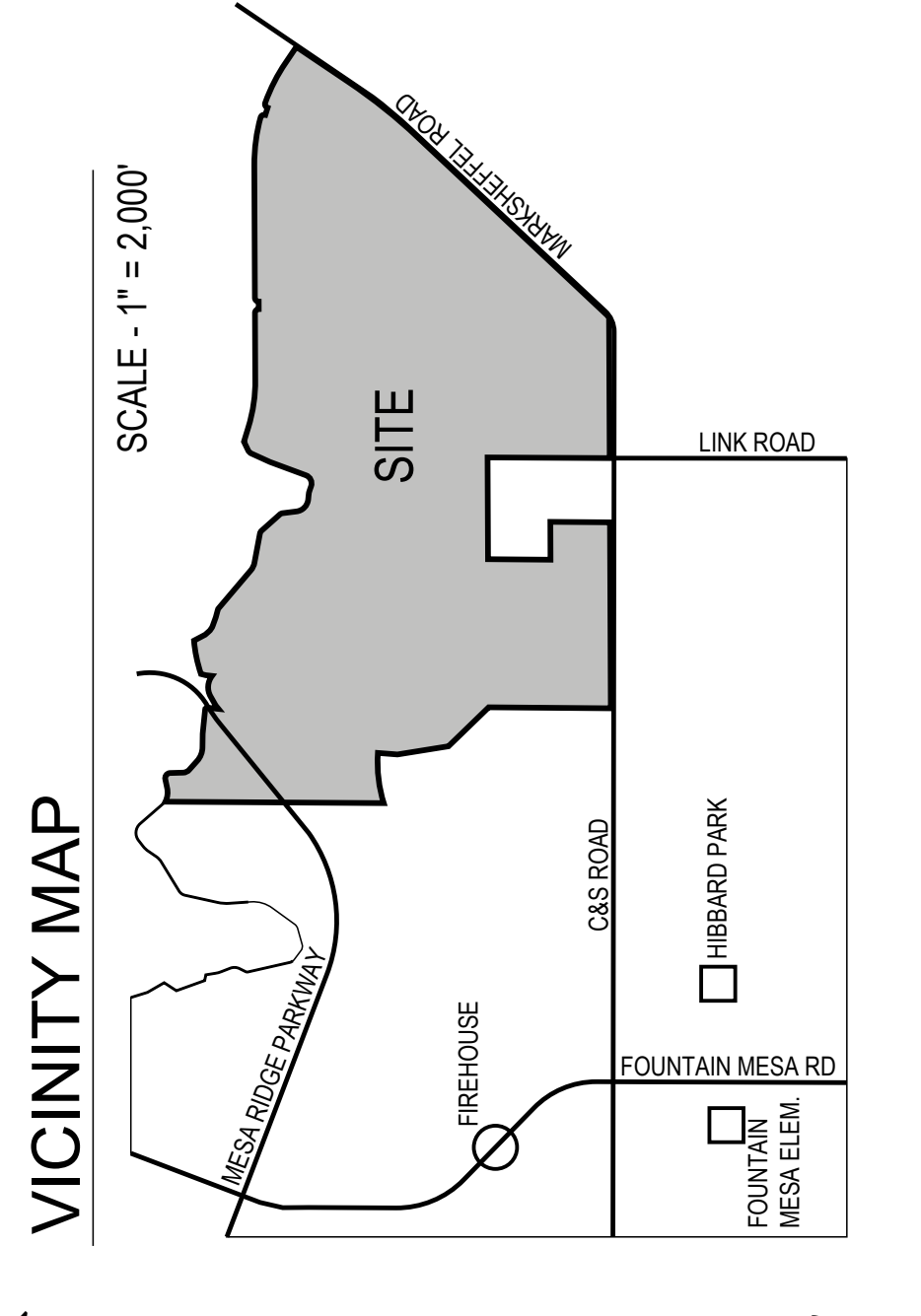
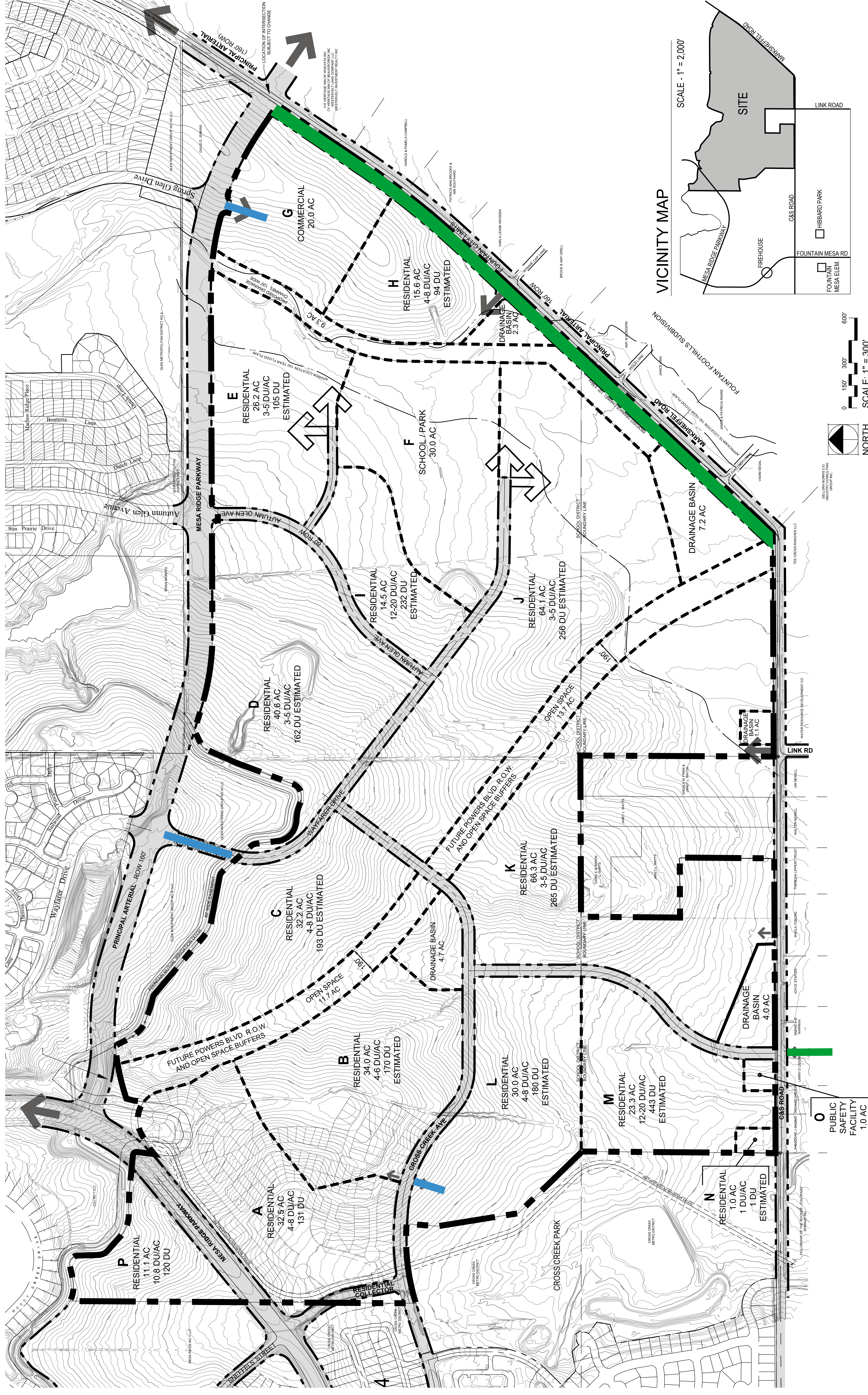

NDA
NASS DESIGN ASSOCIATES
LAND PLANNING - LANDSCAPE ARCHITECTURE
PO Box 6038, Colorado Springs, CO 80934
(719) 475-2405

REVISIONS	DATE

MESA RIDGE
OVERALL DEVELOPMENT PLAN
FOUNTAIN, COLORADO
AMENDMENT NO. 5 (MAJOR AMENDMENT)