

Memorandum

To: Jeff Rice, EPC Planning and Community Development

From: Rich Wray, Kiowa Engineering,

Subject: Bull Hill, Rolling Meadows and Lorson Ranch
Partial Basin Closing Request
City/County Drainage Board
Jimmy Camp Creek Drainage Basin
El Paso County, Colorado

Date: **January 8, 2024**

On behalf of Landhuis Development it is requested that an agenda item be added to the next available City/County Drainage Board meeting in regard to the above referenced subject. Representatives of Landhuis have prepared cost analyses showing the feasibility of removing acreage from the Jimmy Camp Creek watershed that would be subject to drainage fee assessment. Specifically, 1,698 acres of land associated with the proposed Bull Hill and Rolling Meadows developments, as well as the remaining undeveloped portions of the Lorson Ranch development. The fee analysis has shown that there would be minimal impact upon the drainage fee from present day conditions associated with the “closed” condition addressed in this memorandum. Included with this memorandum are the following documents:

Table 1: Comparative Fee Calculations that show the impact upon the present day drainage fee with the exclusion of Bull Hill, Rolling Meadows and Lorson Ranch. Costs for the drainageway construction have been developed using the unit costs shown in the 2015 DBPS brought forward to present day, the 60 percent design cost estimate for the East Fork Jimmy Camp Creek drainageway through Bull Hill and Rolling Meadows prepared by Matrix Engineering, and construction costs for the East Fork Jimmy Camp Creek watershed completed within Lorson Ranch.

Figure 1: Jimmy Camp Creek watershed with East Fork Jimmy Camp Creek sub-watershed highlighted.

Figure 2: Location of Bull Hill, Rolling Meadows and Lorson Ranch parcels subject to removal from fee assessment.

Figure 3: Platable Acreage, Figure VII-2, Jimmy Camp Creek Drainage Basin Planning Study, Kiowa Engineering Corporation, March 2015, edited to show location of Wild Horse Ranch Open Space.

60 percent design plans and profiles, East Fork Jimmy Camp Creek, prepared by Matrix Engineering, Bull Hill and Rolling Meadows.

Attachment 1: Memorandum to Jeff Mark, Landhuis Development, February 23, 2023, providing background information regarding the history of the current drainage and surety fees for the Jimmy Camp Creek watershed, and presenting initial calculations related to the closing of the Bull Hill, Rolling Meadows and Lorson Ranch to fee assessment.

Attachment 2: Memorandum to Jeff Mark, Landhuis Development, July 16, 2023, summarizing findings and conclusions of closing analysis, and requesting action by El Paso County Planning on the request to close Bull Hill, Rolling Meadows and Lorson Ranch to

drainage fee assessment. A key finding summarized in Attachment 2 is that the present fee does not have a strong technical relationship to the actual improvements that were shown in the 2015 DBPS. Therefore the assessment of the current fee and surety has no technical basis. El Paso County has halted the assessment of the surety fee.

A bridge fee is currently assessed on platted land. The bridge fee is presently assessed at \$989 per acre. There now exists substantial credits for bridges already built in the Jimmy Camp Creek watershed that will not be covered by bridge fees assessed on land that will be developed in the future. The present bridge fee would have to be raised a significant amount just to cover these credits. In reviewing the undeveloped portion of the County that lies within the watershed, there does not appear to be any further bridges that would be built on the major roadways. Additionally, with the revision to the hydrology that is being put forth in the draft update to the Jimmy Camp Creek DBPS all of the 100-year discharges for the major and sub tributary drainageways fall below the 1,600 cubic feet per second that has been established in the Drainage Criteria used to determine if a roadway crossing can be classified as a bridge. Whether or not a bridge fee needs to be revised or dropped altogether for the Jimmy Camp Creek watershed will have to be determined by the County's consultant as the updated DBPS proceeds through the approval and adoption process. As such there has been no attempt to assess the impact of a partial closing of the basin upon a future bridge fee.

The closing of a property to fee assessment has typically been done when a single major property owner exists within a watershed and will be responsible for constructing the majority of the proposed drainageway improvements. In return for not paying drainage fees, the property owner agrees to install the public drainageway improvements without reimbursement and without garnering drainage credits to offset drainage fees upon recordation of a plat. In this case, Landhuis controls approximately 1,698 acres of land within the watershed, the single largest holding of any propriety owner within the Jimmy Camp Creek watershed that lies within El Paso County. Within the Landhuis properties, 13,000 lineal feet of the East Fork Jimmy Camp Creek drainageway and 2,000 lineal feet of sub-tributary drainageway exist that will require stabilization as part of the development of the Rolling Meadows and Bull Hill parcels.

Generally for a property to be closed from drainage fee assessment, negative impacts to the plattable land that remains subject to drainage fee assessment have to be minimized. Negative impact in the case of a basin closing request means that the drainage fees for those properties that will remain in the fee system is not increased. In this closing request, the impact to drainage fees caused by removing the Landhuis properties and the associated drainageway improvement costs, while slightly higher than the "present day" drainage fee shown on Table 1, has minimal affect upon the overall basin drainage fee. The calculations shown on Table 1 support this conclusion. It should be noted that the calculations presented on Table 1 reflect the removal of the acreage associated with the proposed Wild Horse Ranch Open Space, assuming that the Open Space would not be subject to future drainage fee assessment. Accordingly, the major and sub-tributary drainageways associated with the Open Space shown in the 2015 DBPS have been removed from the capital costs presented on Table 1. Fee calculations summarized on Attachment 1 included the approximate 1,010 acres attributable to the Open Space.

There is presently an ongoing update to the 2015 DBPS being conducted for the El Paso County portion of the Jimmy Camp Creek watershed, This update has only progressed into the alternative development phase of the study. Drainage fees will be recalculated as part of the update, but there is no definitive time schedule as too when the study will be completed or when the update will be presented to the City/County Drainage Board for review and the eventual adoption. In light of this, Landhuis Development, who anticipates beginning platting

within the Rolling Meadows parcel in 2024, requests action on the closing request prior to completion of the updated DBPS.

Table 1: Comparative Drainage Fee Calculations Jimmy Camp Creek

Plattable Acreage: Presently undeveloped land determined to be subject to future development/redevelopment. Wild Horse Ranch Open Space removed from estimates of major and sub-tributary drainageway costs.

2015 DBPS estimated unplatted land; Jimmy Camp Creek watershed	14,018 acres
Platted since 2015	(1,923 acres)
Undevelopable per 2015 DBPS	<u>(4,477 acres)</u>
Net plattable and developable acreage	7,618 acres
Adjustments to plattable acreage	
Wild Horse Ranch Open Space	(1,010 acres)
Net plattable and developable acreage	6,608 acres
Bull Hill and Rolling Meadows	(1,521 acres)
Net plattable and developable acreage	5,087 acres
Remaining Lorson Ranch undeveloped	(177 acres)
Net plattable and developable acreage	4,910 acres

Present day drainage fee estimate

Major drainageways	\$91,600,000
Sub-tributary drainageways	<u>\$43,500,000</u>
Total drainageways	\$135,100,000

Present day drainage fee calculation:

\$135,100,000 / 6,608 acres	\$20,445 per acre
-----------------------------	--------------------------

Drainage fee estimate with closing of Bull Hill and Rolling Meadows to fee assessment

Major drainageways	\$63,900,000
Sub-tributary drainageways	<u>\$42,300,000</u>
Total drainageways	\$106,200,000

Fee calculation:

\$106,700,000 / 5,087 acres	\$20,975 per acre
-----------------------------	--------------------------

Drainage fee estimate with closing of the balance of Lorson Ranch to fee assessment

Major drainageways	\$63,900,000
Sub-tributary drainageways	<u>\$42,300,000</u>
Total drainageways	\$106,200,000

Fee calculation:

\$106,700,000 / 4,910 acres	\$21,731 per acre
-----------------------------	--------------------------

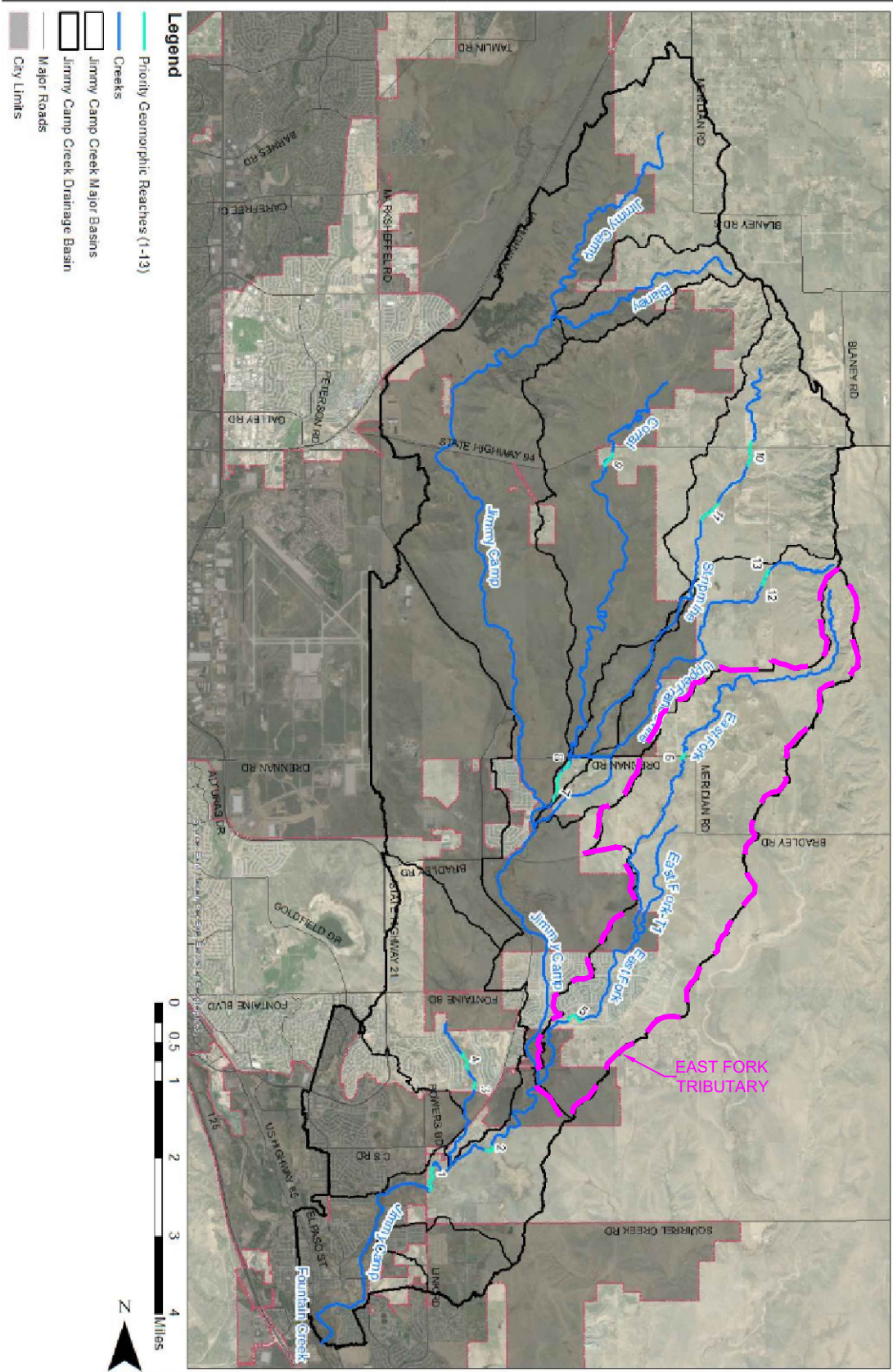

JIMMY CAMP CREEK DRAINAGE BASIN

SCALE:
NTS

DATE:
DECEMBER 12, 2023

FIGURE NO.
1

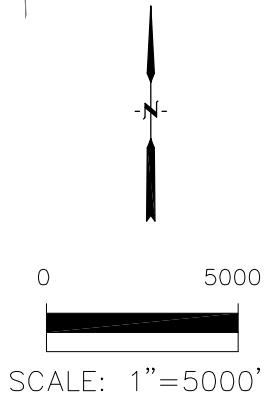
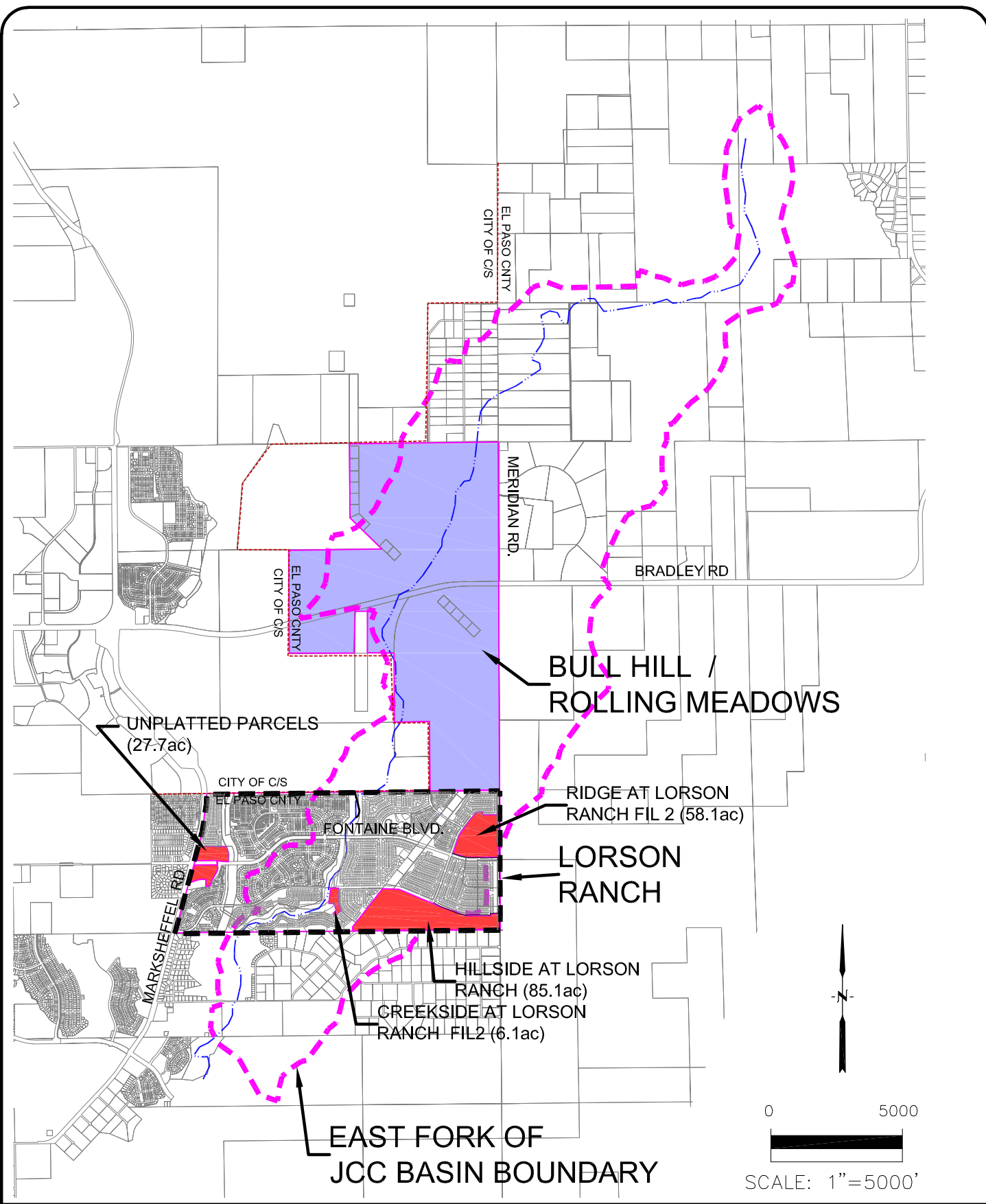

PROPERTIES TO BE REMOVED FROM JCC BASIN FEES



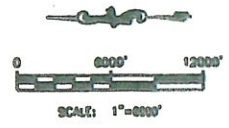

SCALE: NTS	DATE: JANUARY 9, 2024	FIGURE NO. 2
---------------	--------------------------	-----------------



Plattable Areas

El Paso County = 14,018 acres (21.9 sq mi)
 City of Colorado Spring/Excluding BLR Master Planned Area = 148 acres (0.23 sq mi)
 Banning Lewis Ranch Master Planned Area = 13,341 acres (20.84 sq mi)
 City of Fountain = 664 acre (1.01 sq mi)

Platted/Undevelopable Areas

-  El Paso County = 4,477 acres Undevelopable
-  City of Colorado Spring/Excluding BLR = 1,617 acres Undevelopable
-   Banning Lewis Ranch Master Plan = 3,505 acres Undevelopable
-  City of Fountain = 4,154 acres

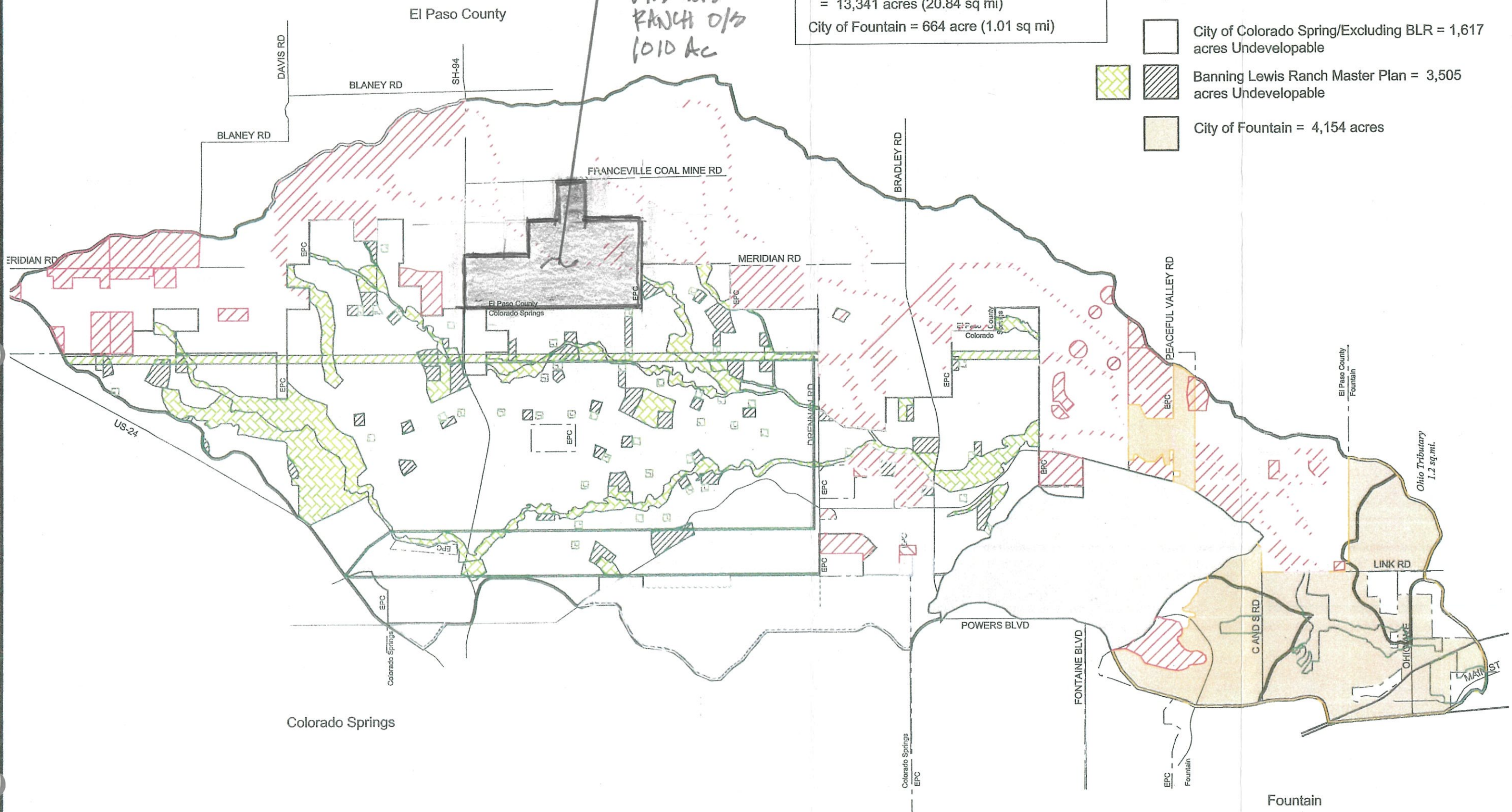

Project No.:	14008
Date:	OCTOBER 2014
Design:	
Drawn:	EAK
Check:	
Revisions:	

Fountain

FIGURE 3

Attachment 1: Memorandum

To: Jeff Mark, Leroy Landhuis, Landhuis Development

From: Rich Wray, Kiowa Engineering, (retired)

Subject: Bull Hill, Rolling Meadows and Lorson Ranch
Partial Basin Closing Analysis
Jimmy Camp Creek Drainage Basin
El Paso County, Colorado

Date: **February 27, 2023**

I. Background information

2014 Jimmy Camp Creek DBPS- Kiowa Engineering
Hydrology, selected plan layout, improvement costs and fee estimates

1987 Jimmy Camp Creek DBPS

2022 Drainage basin planning study (in-progress)

2022 Drainage fees as approved by BOCC

2006 Rolling Hills Ranch MDDP prepared by Kiowa Engineering

II. 2014 Jimmy Camp Creek DBPS

1. Study was approved and adopted by the City of Colorado Springs and the City of Fountain. Hydrology is now being used in the planning for future development of the Banning-Lewis Ranch (City of Colorado Springs), and for developments within the City of Fountain. The hydrology and hydraulic analyses conducted for the watershed covered the following drainageways:

Unimproved major drainageways that lie in El Paso County include:

Lower Jimmy Camp Creek	14,000 LF
Upper Jimmy Camp Creek	4,000 LF
Stripmine Tributary	7,600 LF
Franceville Tributary	8,500 LF
East Fork Jimmy Camp Creek	<u>21,500 LF</u>
Total Major Drainageways	55,600 LF

Unimproved sub-drainageways that lie in El Paso County include:

Upper Jimmy Camp Creek	2,300 LF
Blaney Tributary	2,600 LF
Corral Tributary	5,000 LF

Stripmine Tributary	29,500 LF
Franceville Tributary	14,500 LF
East Fork Jimmy Camp Creek	<u>22,200 LF</u>
 Total Sub-drainageways	 76,100 LF

The major unimproved receiving and sub-drainageways that were evaluated in the 2014 DBPS that impact the subject Landhuis property include:

East Fork Jimmy Camp Creek	13,000 LF
East Fork Jimmy Camp Creek Sub-drainageways	2,000 LF

From the above numbers, 23 percent of the major drainageways studied in the DBPS cross through The Bull Hill and Rolling Meadows properties, Three (3) percent of the sub-drainageways lie within the Bull Hill and Rolling Meadows properties. All of the major and sub tributary drainageway facilities within Lorson Ranch have already been constructed.

2. The 2014 DBPS was not approved and accepted by El Paso County for use in the planning for development along the major receiving drainageways. It is presently required by the County that the hydrology from the 2014 DBPS be used in the design of structures. Reason for non-adoption by the county was that the location of future full spectrum detention basins (FSDs), were not shown in the DBPS. From a technical perspective, the location of FSDs is not needed for the design of major drainageways and bridge structures. The hydrologic affect of FSD once fully implemented is the maintenance of peak discharges at existing development levels for all recurrence intervals. The required FSD storage volume was provided in the DBPS and costs associated with FSD provided for the area of the watershed within El Paso County,

3. Drainage fees were estimated for areas within the City of Colorado Springs and El Paso County. Drainage fees were based upon only the capital improvement costs to stabilize the major receiving and sub- drainageways as defined in the DBPS. A storage fee associated with FSD was provided in the DBPS for both the County and City.

4. Since the City's acceptance of the 2014 DBPS, the area of the watershed within the Banning-Lewis Ranch (BLR), was determined to be a "closed basin" as part of the the Development Agreement between BLR and the City of Colorado Springs. With the assumption of a closed basin, drainage and bridge fees will not be assessed and reimbursement related to the construction of FSDs or stabilization of the major and sub-drainageways will not be allowed.

III. 1987 DBPS

This study is no longer used by the County when planning for development within the watershed, The location of regional detention basins shown in the 1987 DBPS are not used by the County for stormwater management planning. None of the regional detention basins shown in the 1987 DBPS have ever been built. However the present day drainage and bridge fees that were first determined in the 1987 DBPS were used by the County to develop the miscellaneous basin fee that is now assessed against plattable acreage within the Jimmy Camp Creek watershed.

IV. 2022 DBPS (in-progress)

EPC retained consulting engineering firm Stantec Engineering in 2021 to update the 2014 DBPS preliminary plan and to develop a fee structure for the County portion of the Jimmy Cam Creek watershed. At this time the study has progressed only into the hydrologic and hydraulic analyses phases and specifically the hydraulic analysis for the watershed's major tributaries. The hydraulic section of the report has been submitted to the County and is now being revised based upon County comments. County is presently waiting for a revised hydrology and hydraulic report. It is not clear at this time what the deliverable is for the hydraulic phase of the study. Being that the study has not been completed or reviewed through the hydraulic analysis phase, it is estimated that the development of the fee structure will not occur until mid-2023. Adoption of the updated study and fee structure may not occur until late 2023 or 2024. Development of the fee structure is usually one of the last steps of a DBPS scope and is routinely provided for public review prior to advancing the DBPS and fee(s) to Drainage Board and ultimately the BOCC.

It is advised at this time that stakeholders within the watershed (such as Landhuis Development), inquire with the County what the timing is for the completion of the DBPS. Until such time the study is ready for adoption, the stakeholders should be included in the review of the the updated DBPS so that impact upon their properties can be evaluated. It is not clear what level of stakeholder outreach has been carried out thus far in the process.

V. Drainage Basin Fees

1987 DBPS Basin Fees

The drainage fees developed as part of the 1987 DBPS included major drainageway facilities necessary or the stabilization of Jimmy Camp Creek and its major receiving drainageways. The drainage fee also included the cost for regional detention facilities that were shown in the 1987 DBPS. Stabilization of the drainageways was to be achieved through the installation of riprap bank linings in combination with drop or grade control structures necessary to reduce the longitudinal slopes. Location of the grade control structures was not defined in the 1987 DBPS. The hydraulic design of the major drainageways utilize the future development condition discharges. Water quality storage was not considered in the design of the regional detention basins. Onsite water quality storage for developments was not required by the County when the 1987 DBPS was prepared and adopted.

Bridge fees were developed for the watershed. The location of future roadway crossings defined as bridges under EPC engineering criteria in use at the time of the 1987 DBPS was based upon the regional transportation plan in affect in 1987. A few of the bridges shown in the 1987 DBPS have been built. There have also been two bridges built associated with arterial roadway projects that were not shown on the regional transportation plan relied upon when the 1987 DBPS was prepared.

The drainage and bridge fees estimated in the 1987 DBPS (with annual adjustments), were assessed against platted acreage until 1999. At that time the watershed was reclassified as a miscellaneous basin since the watershed did not have a current DBPS that adequately addressed stormwater management planning for the watershed. An average of the drainage and bridge fees using all watersheds that had had a DBPS prepared (since 1983) was calculated. This resulted in a significant increase in most all of the miscellaneous basins due in part to the high fees estimated in the 1987 DBPS. Additionally, by going to an average fee in 1999, the connection between fees and an actual list of identified stabilization measures was lost. The regional detention basin facilities and their contribution to the drainage fee is suspect as well. The use of regional detention is now discouraged by criteria and stormwater storage

cannot be located across a receiving waterway as defined by the U. S. Army Corps of Engineers.

Subsequent to the averaging of fees in 1999, the County revised the per acre requirement to “per impervious acre”, which is what is applied today. It is the opinion of the writer that the use of percent imperviousness as required when fees are estimated for a given parcel has caused the basin fee to be in deficit; that is, the cost of capital improvements remained unchanged but the plattable acreage subject to fee assessment decreased. This causes less fees to be collected that can then be used for reimburse costs for public facilities constructed in accordance with the governing DBPS. With this revision the drainage fee became further detached from the actual cost of the required stabilization and storage facilities. Due to the uncertainty of the adequacy of the fee structure for Jimmy Camp Creek as estimated in 1999, a surety was developed charged against impervious acreage. It is not clear how the amount of the surety was determined by the County.

2014 DBPS Basin Fees

Two fees were proposed for the portion of the Jimmy Camp Creek watershed within the City of Colorado Springs the 2014 DBPS; a major drainageway fee and a storage fee. The drainageway fee was for the capital costs of stabilizing the **major receiving drainageways** (reference Exhibit 1, 2014 Jimmy Camp Creek DBPS). Only the major drainageway of East Fork Jimmy Camp Creek impacts Bull Run and Rolling Meadows properties. Stabilization of East Fork Jimmy Camp Creek and Jimmy Camp Creek through Lorson Ranch has already been completed. For the major drainageways a variety of stabilization measures were proposed in the 2014 DBPS aimed at addressing environmental standards, floodplain preservation and long-term invert degradation depending upon the nature of the localized hydrology and floodplain configurations. Within the 2014 DBPS, drainage fees were provided separately for the City of Colorado Springs and El Paso County. The costs for drainageway improvements and the required FSD storage volume for the area of the watershed within the County were removed from the final report as the County was not prepared to adopt the DBPS at that time.

The storage fee for the watershed was determined using an estimate of the total FSD storage volume that would be required to store the increase in runoff due to development in the watershed. Unit costs for full FSD were developed using actual costs for FSDs constructed in the City and County. As with the drainage fee, a storage fee was estimated for both the City and the County. Per County requirements, the drainage and storage fees were combined into a single drainage basin fee.

As part of gaining approval for the 2014 DBPS, El Paso County requested that the drainage and storage fees estimated for the County area be omitted from the final report. Primary reason was that the 2014 DBPS did not go far enough in presenting the location(s) of FSDs within the County. Because of this the County reverted back to the current fee structure when assessing bridge and drainage fees.

It was discussed with the County that the location of the FSDs cannot be accurately determined and therefore just created potential conflicts in the future as the watershed develops. It was also pointed out that it does not matter where the FSDs are sited, only the total volume of the increase in runoff due to urbanization matters. Finally it was argued that a fee should not be assessed based upon facilities that are required by **criteria** and that the cost and implementation of FSD was the responsibility of the developer. It is therefore important at this time to understand the assumptions that will go into any fees developed as part of the County’s ongoing DBPS update.

Bridge fees were not estimated in the 2014 DBPS. Reasoning for this was that all future bridges will be sized to carry existing condition discharges as presented in the 2014 DBPS. As such there is no technical basis to assessing a bridge fee since development is required to provide FSD which acts to maintain peak discharges to predevelopment conditions.

The fees developed for the City of Colorado Springs:

Major Drainageway Fee	\$ 6,519 per acre
Storage Fee	\$ 2,125 per acre

The above fees are presented as a reference point to what could be expected for the area within El Paso County if similar assumptions are applied. As stated in the DBPS, only a per acre fee to cover the stabilization costs for the major receiving and sub- drainageways was proposed for two reasons: (1) the major drainageways serve all areas within the watershed regardless of jurisdiction and therefore should be a shared cost even though the predevelopment discharges are assumed because of the implementation of FSD, and (2) even with FSD the major receiving drainageways will be negatively impacted by the urbanization of the watershed due to the increase in the duration of runoff. Bank and invert stabilization is still necessary even with the implementation of FSD.

Stabilization measures and associated costs for the subtributaries were included in the 2014 DBPS. It was suggested during the preparation and associated review of the 2014 DBPS that the stabilization of the subtributaries not be included in the estimation of drainage fee as their design and costs cannot be adequately defined at the DBPS level of analysis. Costs for the stabilization of the subtributaries were ultimately included in the total capital costs and used for the estimation of drainage fees.

A storage fee was estimated based upon the costs for existing FSD facilities constructed and in operation at the time the 2014 DBPS was prepared. A per acre storage volume was developed as well as a per acre storage fee. Storage fee estimated in the the 2014 DBPS was \$2,125 per acre. The cost to provide FSD is highly dependent upon the physical layout of the developing watershed. The future land uses assumed in this DBPS, while accurate for the proposes of a planning level study, cannot be used to exactly determine the location of future FSDs. As stated in the 2014 DBPS, the location of FSDs should be determined at the MDDP level.

As it relates to this analysis, it is the writer's opinion that fees to cover the costs of future FSDs should not be considered by the County since the implementation of FSD is a requirement of criteria. There is no reliable way to come up with a cost for FSD storage since the total FSD volume is dependent upon the imperviousness of the sub-watershed draining to it. As such the implementation of a "storage fee" would constantly be subject to revision as requests associated with the reimbursement of accepted FSDs are made to Drainage Board. Cost for the construction of FSDs should be borne solely by the developer and reimbursement of required FSD facilities not allowed.

VI. Analysis of Basin Closing for Bull Hill, Rolling Meadows and Lorson Ranch Properties

The following information has been used in the evaluation of an assumption that all proprieties owned by Landhuis should be considered for a closed basin due to the extensive holdings within the El Paso County portion of the watershed. An amended Exhibit 1 from the 2014 DBPS has been included with this memorandum and shows the location the Bull Hill, Rolling Meadows and Lorson Ranch parcels subject to the closing of the basin to fees.

1. Area of watershed within EPC:	28.9 SM (18,496 acres)
2. Un-platted area of within EPC per 2014 DBPS:	21.9 SM (14,028 acres)
3. Present day plattable acreage subject to fees	7,800 acres
4. Unplatted acreage owned by Landhuis Properties	1,890 acres
5. 2022 fees for JCC	Drainage \$21,134
	Bridge \$989
	Surety \$7,285

The plattable acreage shown above was determined using the 14,028 acres presented in the 2014 DBPS less the areas within the County that has developed since 2014 (Lorson Ranch and the National Cemetery), and those areas of the County that were shown to be undevelopable, primarily that portion of the watershed that lie along the Corral Bluffs (reference Figure VII-2, 2014 DBPS). The drainage fee as currently assessed by the County theoretically includes the cost for stormwater storage facilities,

Costs for Major and Sub-drainageway Stabilization and Stormwater Storage

Using actual construction costs for the East Fork Jimmy Camp Creek within Lorson Ranch, a unit stabilization cost was estimated at \$1000 per lineal foot. The design of the drainageways upstream from Bull Hill and Rolling Meadows (42,600 lineal feet), would probably be similar to what was constructed for the East Fork Jimmy Camp Creek in Lorson Ranch. Using this unit cost a total major drainageway cost of \$42.6 million was estimated.

A 60 percent design has been completed by Matrix Engineering for the East Fork Jimmy Camp Creek drainageway through Bull Hill and Rolling Meadows (13,000 lineal feet). A 60 percent design cost of \$26.8 million has been estimated. Total estimate for the major drainageways in El Paso County is \$69.4 million.

Using the hydraulic design and channel sections developed in the 2014 DBPS for the sub-drainageways, a unit cost of \$600 per lineal foot was estimated. Using this unit cost the total cost for sub-drainageways in El Paso County was estimated at \$45.7 million.

In order to be consistent with the current fee structure that technically includes the cost of stormwater detention facilities, an estimate of the storage costs for the entire basin was made. The cost of the storage facilities was assumed to be equal to the per acre fee developed in the 2014 DBPS brought forward to 2022. Storage costs for El Paso County was estimated at \$22.7 million.

Total for the major and sub- drainageways and stormwater storage in El Paso County is estimated at \$137.8 million.

Total major and sub-tributary drainageway facility costs for Bull Hill and Rolling Meadows is estimated at \$28.0 million. (reference, Matrix 60 percent Opinion of Cost, Bull Hill and Rolling Meadows Channel Design). The estimated cost for stormwater storage within Bull Hill, Rolling Meadows and Lorson Ranch is \$5,3 million. Total stormwater facilities are estimated at \$33.3 million.

Drainage Fees for Bull Hill, Rolling Meadows and Lorson Ranch

Based upon the **current** fee structure for the Jimmy Camp Creek watershed total fees have been estimated. Fees have been estimated using 1,815 developable acres which assumes that the East Fork Jimmy Camp Creek 100-year floodplain is not subject to fee assessment (60 acres per 2018 El Paso County Flood Insurance Study).

Drainage and Surety Fees:	\$28,419/acre
Acreage of Landhuis property subject to fees	1,815 acres
Total drainage fees	\$51.6 million

The estimate for fees due on plattable land within Bull Hill, Rolling Meadows and Lorson Ranch far exceeds the total capital costs by a factor of 1.5. Note that this is using a conservative unit cost for the stabilization of the major and sub-drainageways (60 % design), within Bull Hill and Rolling Meadows. The unit costs for the offsite major drainageways will most likely be less than those applied herein because of the decreased discharges in the upper watershed due to lower densities of future development above Drennan Road. The conclusion that can only be reached is that the drainage and surety fees currently being assessed by El Paso County do not reflect the anticipated costs for stabilization and storage, and that the surety is not only excessive, but not necessary to cover future costs

Projected Drainage Fees for Jimmy Camp Creek Watershed

Using the estimated lengths of the major and sub-drainageways and the the unit costs presented above, a total stabilization cost for the watershed, inclusive of Bull Hill and Rolling Meadows was determined. The total cost was then used to develop a per acre fee:

Total major drainageway stabilization	\$69.4 million
Total sub-drainageways	\$45.7 million
Storage cost	<u>\$22.8 million</u>
Total stormwater facility costs	\$137.9 million
Total developable acreage (2022)	7,800 acres
Drainage fee for stabilization and storage	\$17,679 per acre

The above fee was then recalculated to reflect the removal of the 1,830 developable acres associated with Bull Hill, Rolling Meadows and Lorson Ranch. The cost for the stabilization of the major and sub- drainageways within Bull Hill and Rolling Meadows was removed from the total stabilization costs estimated for the entire watershed:

Total major drainageway stabilization	\$42.6 million
Total sub-drainageway cost	\$44.5 million
Total storage costs	<u>\$17.4 million</u>
Total stormwater facilities	\$104.5 million
Total developable acreage	5,970 acres
Drainage fee for stabilization and storage	\$17,410 per acre

As reflected in the the above fees estimates, removing the acreage and stabilization costs associated with Bull Hill, Rolling Meadows and Lorson Ranch from the fee calculation illustrates that there would be no increase in the drainage, fee and possibly a slight reduction. Accordingly, those properties that would remain within the County's Jimmy Camp Creek fee system would not be impacted by higher fees as a result of the property covered by Bull Hill, Rolling Meadows and the remaining unplatted parcels within Lorson Ranch being removed from the calculation of fees. The land still subject to platting within Lorosn Ranch includes:

Ridge 2	57.7 acres
Hillside:	85.1 acres
Creekside 2	6.0 acres
Future commercial:	27.7 acres

The effect of taking into account the impervious acreage in the closing calculations may have an impact upon whether the drainage fee is increased, or decreased with the removal of Bull Hill, Rolling Meadows and Lorson Ranch from the overall watershed acreage. Calculations thus far have used gross acreage. An average impervious value of 57.5 percent was developed in the 2014 DBPS. It is very likely that the average imperviousness for the remaining areas of the County within the Jimmy Camp Creek watershed, including East Fork Jimmy Camp Creek, is less than 57.5 percent. Therefore future FSD storage facility costs would probably be less than that estimated in the 2014 DBPS

Feasibility of Closing the Basin

When requesting that property be closed from the overall watershed fee system what being proposed is that a subject property will not be assessed drainage fees in return for covering the cost of drainageway stabilization and storage as part of developing the property without reimbursement through the fee system. Past experience with basin closing issues is that exempting a property from fee assessment have only been considered when the subject fees are **not increased at all** for those properties that remain in the fee system. In this case it appears that removing the property encompassed by Bull Hill and Rolling Meadows as well and the remaining unplatted land within Lorson Ranch, **would not increase** the drainage fee. The cost estimates for drainageway stabilization shown herein and used for the calculation of fees shown above are feasibility level except for the 60 percent design produced by Matrix for Bull Hill and Rolling Meadows. Through further design analysis it may be possible to mitigate any possible increase in the fee. Drainageway planning for the property as well as the Jimmy Camp Creek watershed in general as is now being conducted needs to advance to a higher level of design. At that point a more accurate estimate of costs and fees can be applied. .

One other possibility to be considered could be to close the entire East Fork Jimmy Camp Basin related to the assessment of drainage fees. With what has already been constructed of the East Fork as part of the Lorson Ranch development and the 13,000 lineal feet that crosses through Bull Hill and Rolling Meadows, very little major drainageway remains in the East Fork watershed, all of which lies north of Drennan Road. The the land north of Drennan Road will more than likely develop at lower densities due to the topography of the upper watershed. Lower densities such a rural residential pay very little in drainage fees to begin with (due to lower imperviousness), and typically have lower overall stormwater facility costs.

VII. Conclusions and Recommendations

Based upon the feasibility level analysis conduct herein, conclusions and recommendations have been developed for consideration by Landhuis Development.

Conclusions

1. The current fee structure being used by the County for the assessment of drainage fees is overestimating the actual cost of future stabilization and storage measures and therefore causing high per acre fees. The assessment of a surety further inflates the fees being assessed.
2. The drainage fees as now assessed are not based upon a technically current concept for what the stabilization will look like going forward. Therefore the current drainage fees for Jimmy Camp Creek within El Paso County are not founded on a firm technical basis. Updating the DBPS should help to remedy this situation.
3. There is feasibility in pursuing the concept of closing the Bull Hill, Rolling Meadows and Lorson Ranch properties to fee assessment. The finding of no impact upon fees as estimated herein may prove to be accurate, however further design analysis needs to be completed. Future planning needs to be completed to gain a more reliable estimate of future costs.
4. There appears not to be a reason to have a bridge fee in the Jimmy Camp Creek watershed. The construction of further arterial roadway bridges (which meet the County's definition of what qualifies to be considered a bridge), is not anticipated. Additionally the implementation of FSD by the County results in bridges only needing to have hydraulic capacity to pass existing condition discharges.
5. It is likely that the fees produced in the update to the DBPS will be lower than the fees as now assessed.

Interim Recommendations

1. Establish and maintain contact with El Paso County Engineering regarding the status of the DBPS update. If possible Landhuis should establish itself as a stakeholder in the basin. This is pretty routine in the process of completing a DBPS, however at this time it is not known if outreach to stakeholders has taken place thus far in the process.
2. Update the Rolling Hills MDDP so as to be better prepared to provide design concepts for the drainageway and so that the concepts can be reflected in the updated DBPS. (It is not clear if the County's consultant has incorporated the East Fork Jimmy Camp design as shown in the approved Rolling Hills MDDP or the design shown in the 2014 DBPS for that matter).
3. Landhuis should provide the County and its consultant updated development plans for Bull Hill, Rolling Meadows and Lorson Ranch if they are available. If Landhuis is moving forward with the a revised site plan(s) the ODP will need to be updated as well. Siting of FSD's in the DBPS should be consistent with the what is envisioned in the ODP.
4. In the absence of timely approval of the updated Jimmy Camp Creek DBPS and the adoption of revised drainage fees (say two years from now or longer), Landhuis may want to seek an opinion as to whether or not the County can legally assess the drainage fees based upon the weak technical foundation related to capital drainageway costs as now represented in the current fee and surety. It has been established herein that the current fee is overestimating the actual costs of facilities.

5. As the DBPS update moves to completion, Landhuis should request to be included in the review capital costs and fee calculations. The calculation of a fee depends upon an accurate assessment of plattable acreage that remains in the basin. Once the plattable acreage is reestablished in the DBPS update, the potential impact of closing the basin can be more accurately assessed. Reviewing the updated DBPS in this regard is a key step.

6. Based upon the calculations presented, Landhuis Properties should have discussions with the County regarding reimbursement of sureties that have been paid today associated with the platting of Lorson Ranch.

7. Attend workshops that are used to inform the Drainage Board. Workshops have generally been conducted over one or two sessions depending upon the complexity of the watershed or the number of comments received by the Drainage Board regarding the update.

Attachment 2: Memorandum

To: Jeff Mark, Landhuis Development

From: Rich Wray, Kiowa Engineering, (retired)

Subject: Bull Hill, Rolling Meadows and Lorson Ranch
Partial Basin Basin Closing Analysis
Jimmy Camp Creek Drainage Basin
El Paso County, Colorado

Date: **July 15, 2023**

As a follow-up to the previously submitted memoranda and technical analysis related to the above subject, a summary of work completed to date has been prepared. This summary includes a request by Landhuis Development that a definitive response from the County be provided regarding the issue of closing the remaining un-platted parcels in Lorson Ranch, and future plats in Bull Hill and Rolling Meadows. As of the above date, all comments received by Landhuis Development through the EDARP system related to the basin closing request have to our knowledge been addressed. The following primary conclusions have been reached:

1. The drainage and surety fees as presently assessed do not have any technical relationship to the drainage facilities that will be needed in the future.
2. Drainage fee analysis has shown that the present fee is higher than what is needed to cover the reimbursement of future drainage improvements.
3. Surety fee as presently assessed against developing parcels is not needed to cover future reimbursement of drainage facilities.
4. The exemption of the undeveloped parcels within Lorson Ranch, Bull Hill and Rolling Meadows to drainage assessment will not negatively impact the remaining undeveloped properties within the watershed in the form of higher fees.
5. The removal of the land encompassed by the future Wild Horse Ranch Open Space will not impact the basin fee system in the form of higher drainage fees for the remaining undeveloped parcels in the watershed. The removal of costs for future drainage facilities attributed to the Open Space offset the loss of acreage in the calculation of drainage fees.
6. The completion of an updated Jimmy Camp Creek Drainage Basin Planning Study (DBPS), is a necessary step in determining a future drainage fee structure. While updating the DBPS is ongoing, there is no reliable time line when the DBPS will be finished, and therefore no timeline when the fee structure for the watershed would be advanced for approval by the Drainage Board and the BOCC.

Based upon the above findings, Landhuis Development is asking that EPC PCD formally respond to their request to remove the undeveloped parcels within Lorson Ranch, Bull Hill and Rolling Meadows from fee assessment. While staff has indicated that they do not support removing the remaining undeveloped parcels within Lorson Ranch from the collection of fees, there has not been a definitive reason provided to Landhuis Development by PCD as to why staff does not support closing the Lorson parcels to drainage fee assessment.

As platting is ongoing within Lorson Ranch, and platting is anticipated within Rolling Meadows in the near future, a timely response to closing the undeveloped land within Lorson Ranch, Bull Run and Rolling Meadows to drainage fee assessment is now requested. The decision

regarding closing these properties to future drainage fee assessment is vital to Landhuis Development's land and financial planning for these parcels.



Know what's below.
Call before you dig.

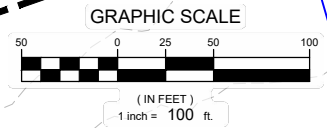
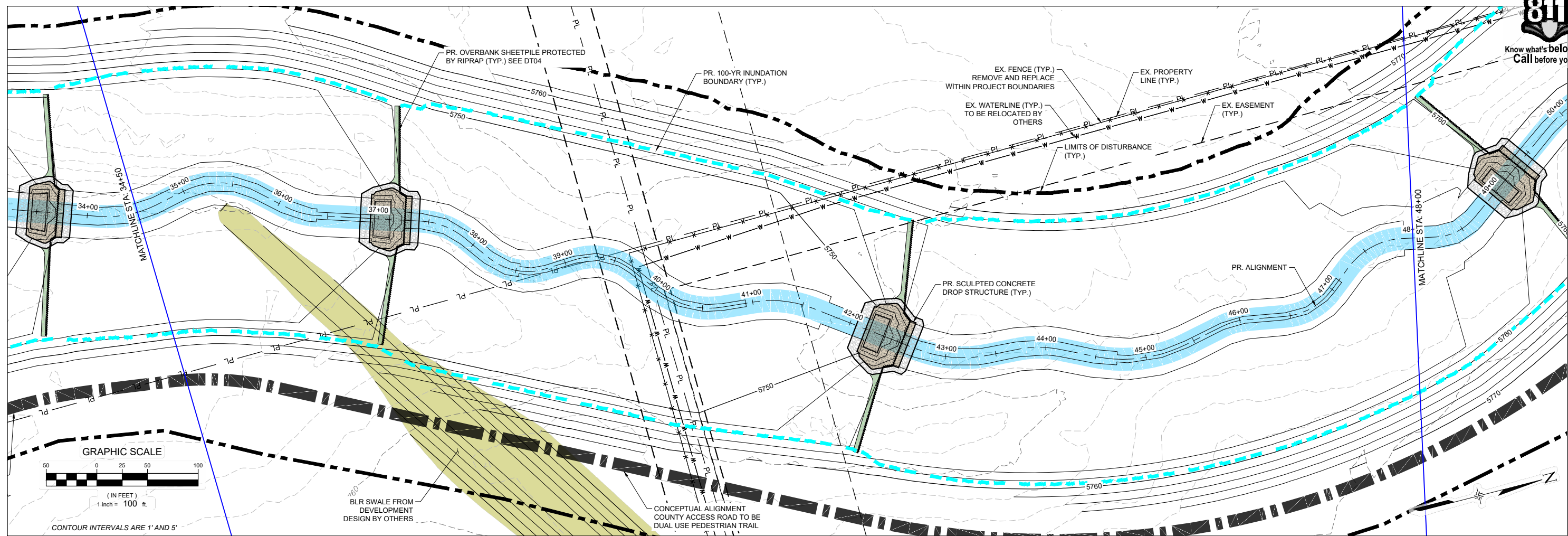

CONTOUR INTERVALS ARE 1' AND 5'

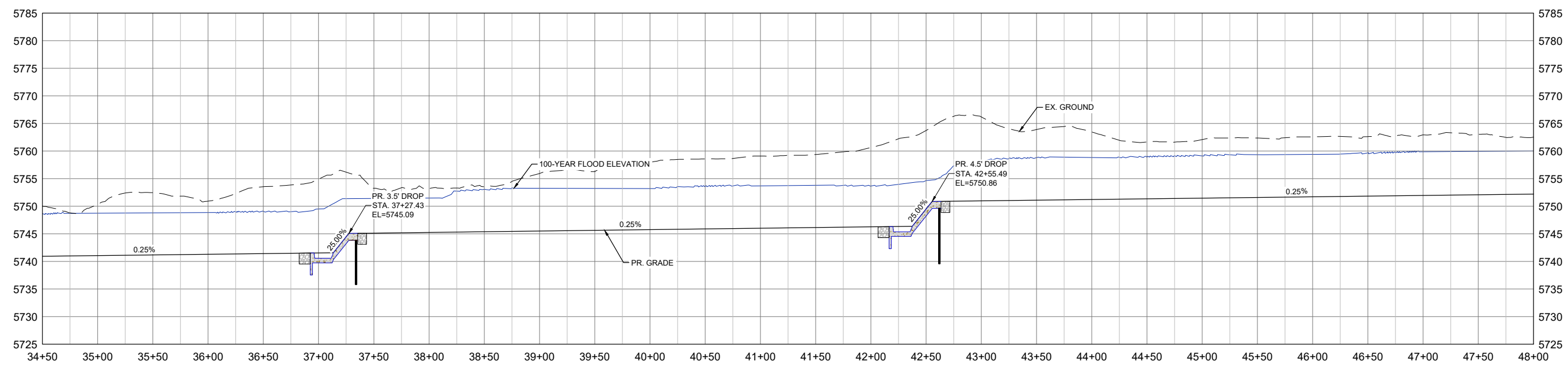

REFERENCE DRAWINGS			
No.	DATE	DESCRIPTION	BY
COMPUTER FILE MANAGEMENT			
FILE NAME: S:\21.1129.009 Rolling Hills Floodplain and Permitting\Drawings\Design Plans\1129.009-PP01-08 DS Alignment_60%.dwg			
CTB FILE: Matrix(black).ctb			
PLOT DATE: January 31, 2023 11:59:29 AM			
THIS DRAWING IS CURRENT AS OF PLOT DATE AND MAY BE SUBJECT TO CHANGE.			

60% DESIGN PLANS

NOTICE:
THIS DOCUMENT IS RELEASED FOR THE PURPOSE OF INTERIM REVIEW UNDER THE AUTHORITY OF AARON SUTHERLIN, PE. IT IS NOT TO BE USED FOR CONSTRUCTION, BIDDING OR PERMIT PURPOSES.



SEAL

PRELIMINARY
THIS DRAWING HAS NOT BEEN APPROVED BY GOVERNING AGENCIES AND IS SUBJECT TO CHANGE

THE LANDHUIS COMPANY			
ROLLING MEADOWS CHANNEL & FLOODPLAIN MODIFICATION 60% DESIGN PLANS			
PLAN AND PROFILE STA. 34+50 - 48+00			
DESIGNED BY: TKM	SCALE: HORIZ 1" = 100'	DATE ISSUED: JANUARY 2023	DRAWING No. PP05
CHECKED BY: AJS	VERT. 1" = 20'	SHEET 15 OF 48	

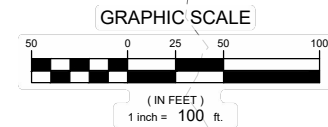

CONTOUR INTERVALS ARE 1' AND 5'

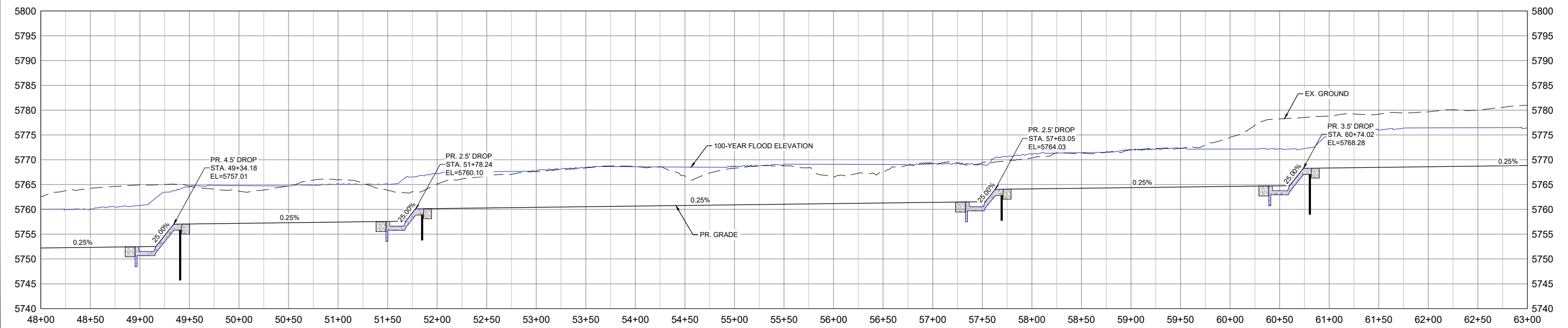
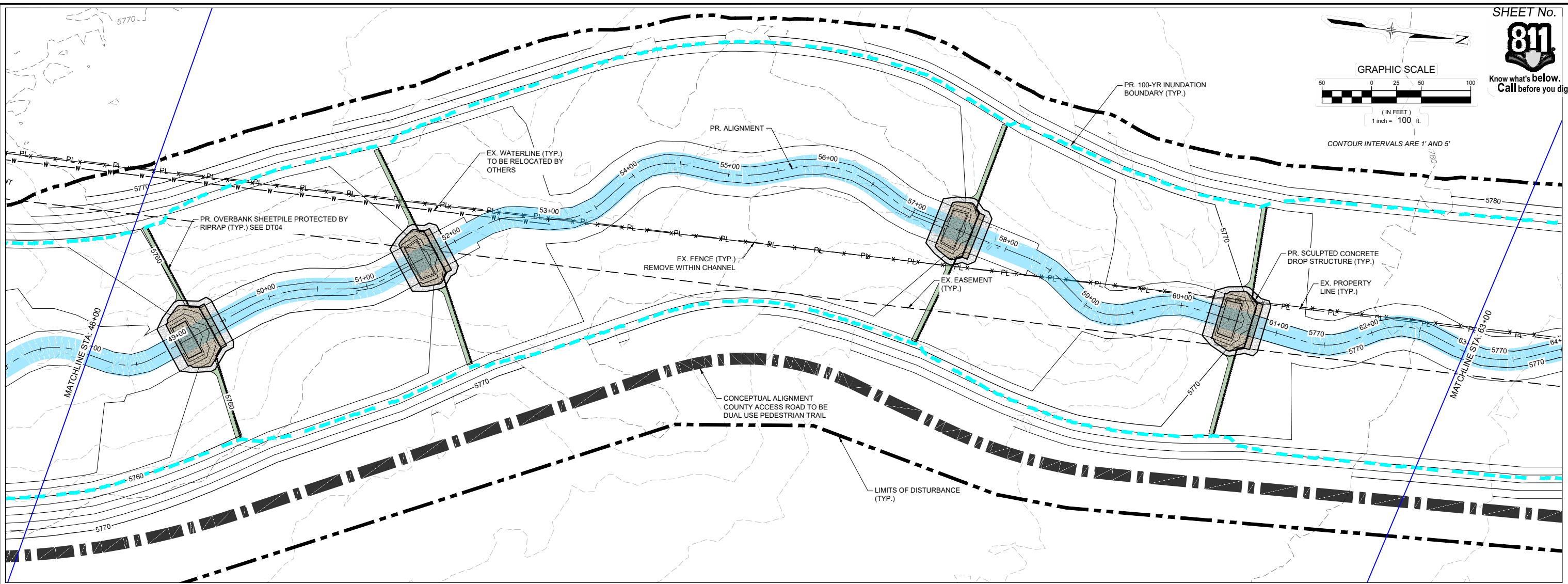

REFERENCE DRAWINGS			
X-1129-PARCELS			
X-1129-PR STRUCT			
X-1129-UTLITIES			
X-1129-MD02234			
No.	DATE	DESCRIPTION REVISIONS	BY
COMPUTER FILE MANAGEMENT			
FILE NAME: S:\21.1129.009 Rolling Hills Floodplain and Permitting\Drawings\Design Plans\1129.009-PP01-08 DS Alignment_60%.dwg			
CTB FILE: Matrix(black).ctb			
PLOT DATE: January 31, 2023 11:56:49 AM			
THIS DRAWING IS CURRENT AS OF PLOT DATE AND MAY BE SUBJECT TO CHANGE.			

60% DESIGN PLANS

NOTICE:
THIS DOCUMENT IS RELEASED FOR THE PURPOSE OF INTERIM REVIEW UNDER THE AUTHORITY OF AARON SUTHERLIN, PE. IT IS NOT TO BE USED FOR CONSTRUCTION, BIDDING OR PERMIT PURPOSES.

THE LANDHUIS COMPANY

PREPARED BY:

Matrix
Excellence by Design

SEAL

PRELIMINARY
THIS DRAWING HAS NOT BEEN APPROVED BY GOVERNING AGENCIES AND IS SUBJECT TO CHANGE

THE LANDHUIS COMPANY

ROLLING MEADOWS CHANNEL & FLOODPLAIN MODIFICATION
60% DESIGN PLANS

PLAN AND PROFILE
STA. 48+00 - 63+00

DESIGNED BY: TKM	SCALE: HORIZ 1" = 100'	DATE ISSUED: JANUARY 2023	DRAWING No. PP06
CHECKED BY: AJS	VERT. 1" = 20'	SHEET 16 OF 48	



Know what's below.
Call before you dig.

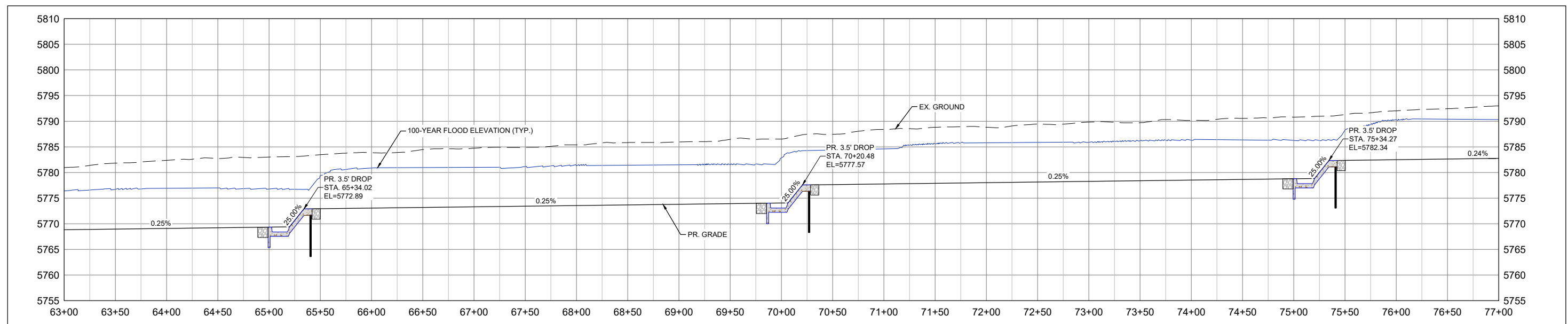
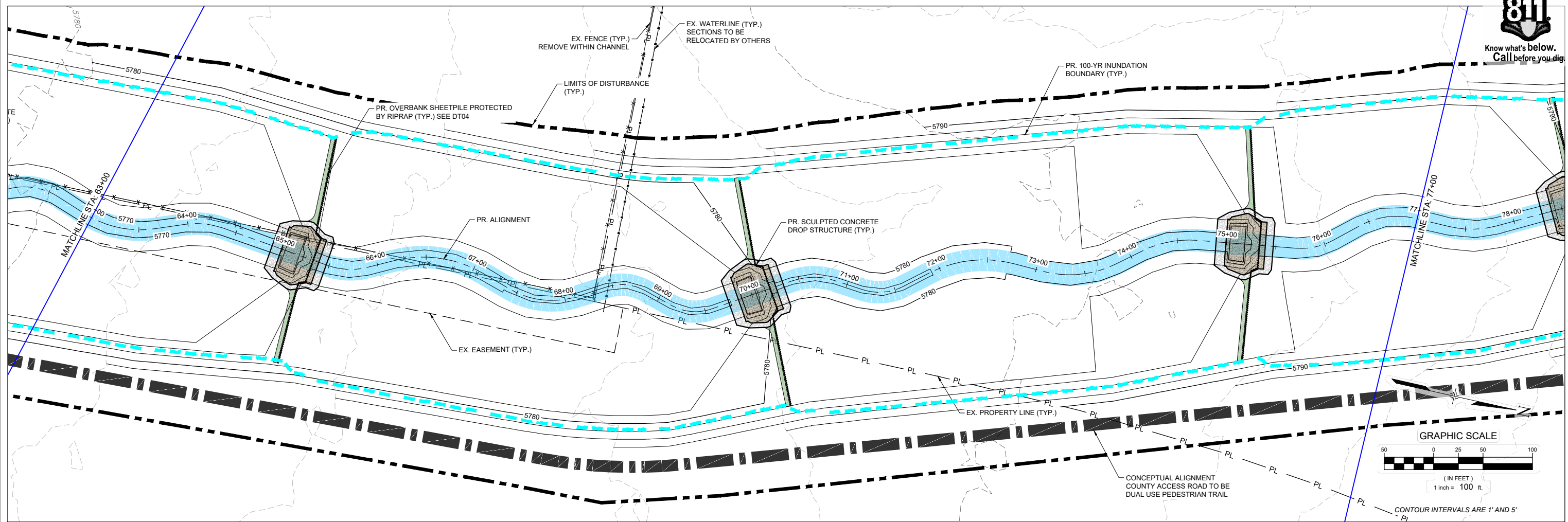

No.	DATE	DESCRIPTION REVISIONS	BY

COMPUTER FILE MANAGEMENT

FILE NAME: S:\21.1129.009 Rolling Hills Floodplain and Permitting\Drawings\Design Plans\1129.009-PP01-08 DS Alignment_60%.dwg
 CTB FILE: Matrix(black).ctb
 PLOT DATE: January 31, 2023 11:58:03 AM
 THIS DRAWING IS CURRENT AS OF PLOT DATE AND MAY BE SUBJECT TO CHANGE.

60% DESIGN PLANS

NOTICE:
 THIS DOCUMENT IS RELEASED FOR THE PURPOSE OF INTERIM REVIEW UNDER THE AUTHORITY OF AARON SUTHERLIN, PE. IT IS NOT TO BE USED FOR CONSTRUCTION, BIDDING OR PERMIT PURPOSES.



PREPARED BY:

SEAL

PRELIMINARY
 THIS DRAWING HAS NOT BEEN APPROVED BY GOVERNING AGENCIES AND IS SUBJECT TO CHANGE

FOR AND ON BEHALF OF
 MATRIX DESIGN GROUP, INC.
 PROJECT No. 21.1129.009

THE LANDHUIS COMPANY			
ROLLING MEADOWS CHANNEL & FLOODPLAIN MODIFICATION 60% DESIGN PLANS			
PLAN AND PROFILE STA. 63+00 - 77+00			
DESIGNED BY: TKM	SCALE: HORIZ 1" = 100'	DATE ISSUED: JANUARY 2023	DRAWING No. PP07
CHECKED BY: AJS	VERT. 1" = 20'	SHEET 17 OF 48	



Know what's below.
Call before you dig.

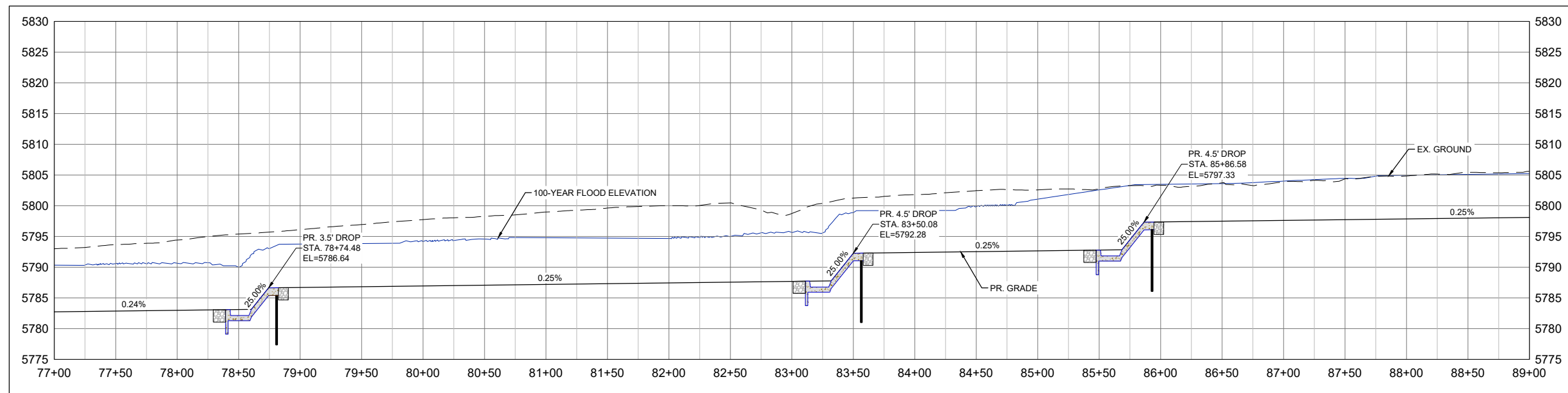
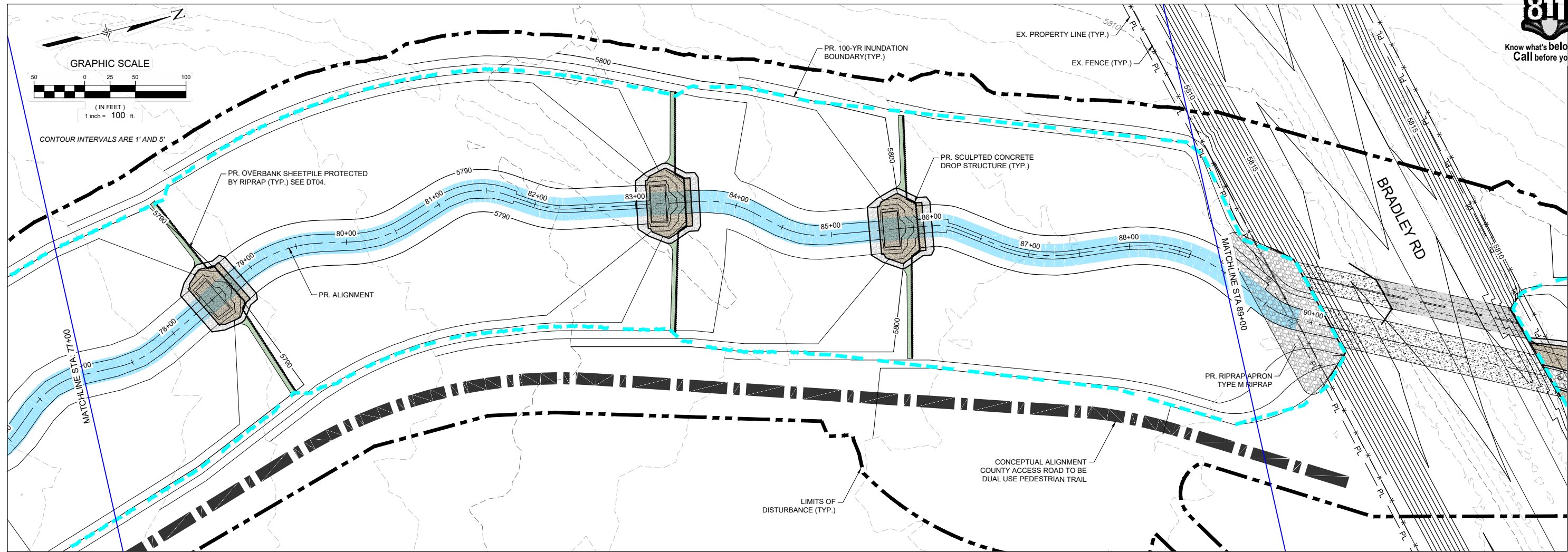

No.	DATE	DESCRIPTION REVISIONS	BY
COMPUTER FILE MANAGEMENT			
FILE NAME: S:\21.1129.009 Rolling Hills Floodplain and Permitting\Drawings\Design Plans\1129.009-PP01-08 DS Alignment_60%.dwg			
CTB FILE: Matrix(black).ctb			
PLOT DATE: January 31, 2023 11:59:04 AM			
THIS DRAWING IS CURRENT AS OF PLOT DATE AND MAY BE SUBJECT TO CHANGE.			

60% DESIGN PLANS

NOTICE:
THIS DOCUMENT IS RELEASED FOR THE PURPOSE OF INTERIM REVIEW UNDER THE AUTHORITY OF AARON SUTHERLIN, PE. IT IS NOT TO BE USED FOR CONSTRUCTION, BIDDING OR PERMIT PURPOSES.



PREPARED BY:

Matrix
Excellence by Design

THE LANDHUIS COMPANY			
ROLLING MEADOWS CHANNEL & FLOODPLAIN MODIFICATION 60% DESIGN PLANS			
PLAN AND PROFILE STA. 77+00 - 89+00			
DESIGNED BY: TKM	SCALE: HORIZ 1" = 100'	DATE ISSUED: JANUARY 2023	DRAWING No. PP08
CHECKED BY: AJS	VERT. 1" = 20'	SHEET 18 OF 48	

SEAL

PRELIMINARY
THIS DRAWING HAS NOT BEEN APPROVED BY GOVERNING AGENCIES AND IS SUBJECT TO CHANGE

FOR AND ON BEHALF OF
MATRIX DESIGN GROUP, INC.
PROJECT No. 21.1129.009



Know what's below.
Call before you dig.

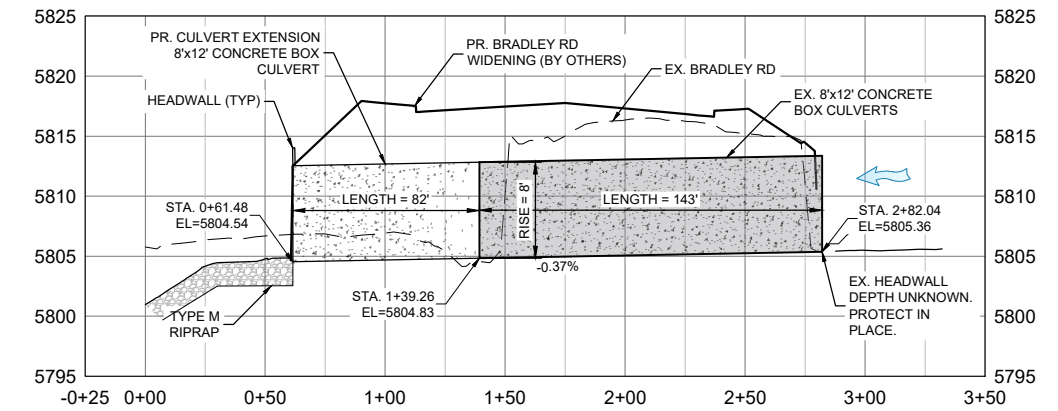
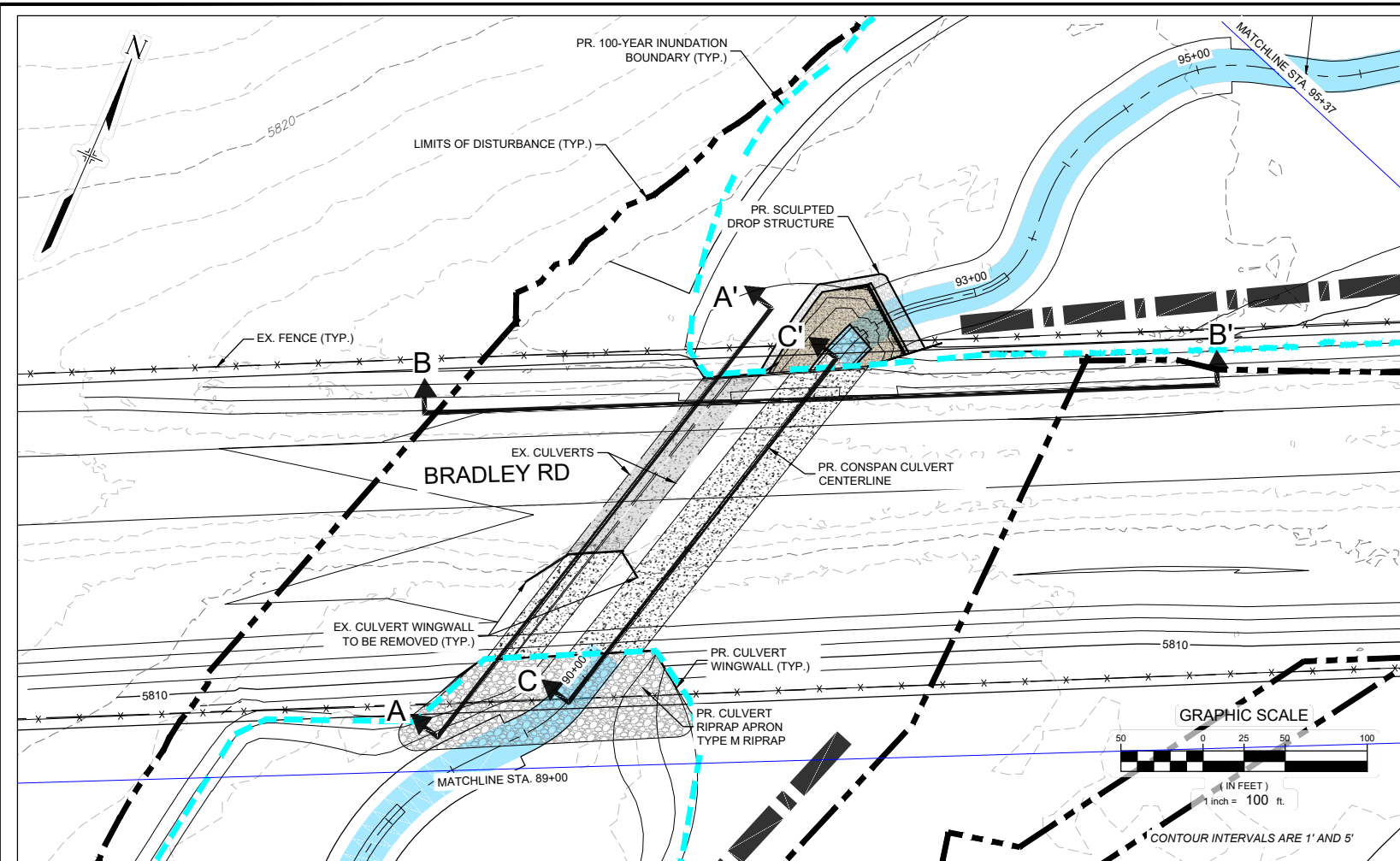

A-A' PROFILE ALONG EX. 8'x12' CULTVERT

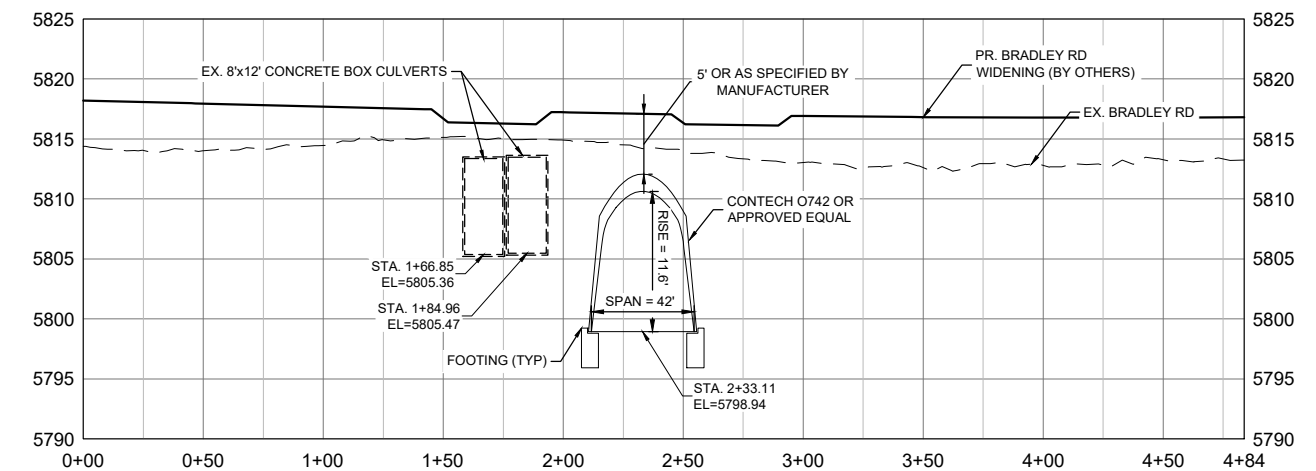

B-B' CROSS SECTION AT BRADLEY RD.

VERTICAL SCALE: 1" = 20'

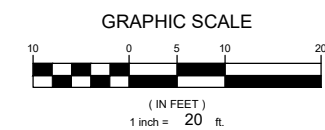

HORIZONTAL SCALE: 1" = 80'

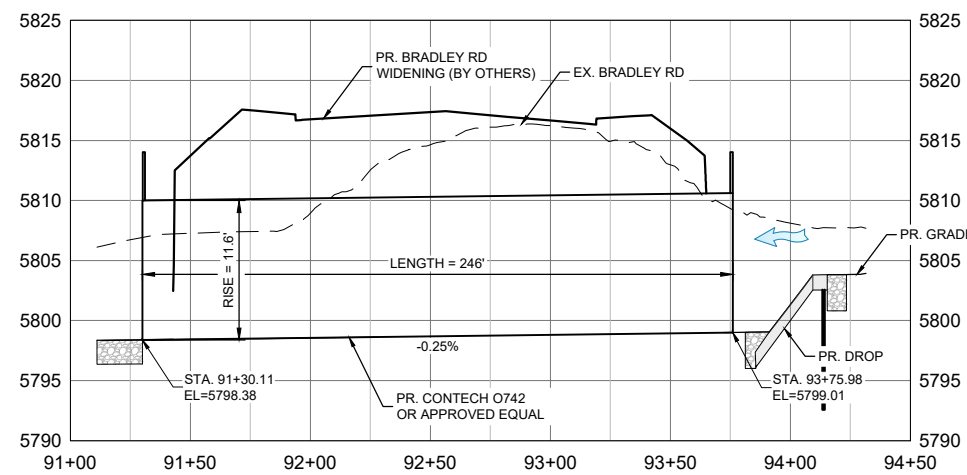
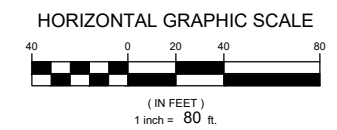

C-C' PROFILE ALONG PROPOSED CONSPAN CULTVERT

NOTE:
FOLLOWS THE PR. CHANNEL ALIGNMENT
HORIZONTAL SCALE: 1" = 80'
VERTICAL SCALE: 1" = 20'

No.	DATE	DESCRIPTION REVISIONS	BY
COMPUTER FILE MANAGEMENT			
FILE NAME: S:\21.1129.009 Rolling Hills Floodplain and Permitting\Drawings\Design Plans\1129.009-PP02-15 US Alignment_60%.dwg			
CTB FILE: Matrix(black).ctb			
PLOT DATE: January 31, 2023 12:09:57 PM			
THIS DRAWING IS CURRENT AS OF PLOT DATE AND MAY BE SUBJECT TO CHANGE.			

60% DESIGN PLANS

NOTICE:
THIS DOCUMENT IS RELEASED FOR THE PURPOSE OF INTERIM REVIEW UNDER THE AUTHORITY OF AARON SUTHERLIN, PE. IT IS NOT TO BE USED FOR CONSTRUCTION, BIDDING OR PERMIT PURPOSES.



PREPARED BY:
Matrix
Excellence by Design

SEAL
PRELIMINARY
THIS DRAWING HAS NOT BEEN APPROVED BY GOVERNING AGENCIES AND IS SUBJECT TO CHANGE

FOR AND ON BEHALF OF
MATRIX DESIGN GROUP, INC.
PROJECT No. 21.1129.009

THE LANDHUIS COMPANY			
ROLLING MEADOWS CHANNEL & FLOODPLAIN MODIFICATION 60% DESIGN PLANS			
PLAN AND PROFILE STA. 89+00 - 95+37			
DESIGNED BY: TKM	SCALE: HORIZ. VARIES VERT. 1" = 20'	DATE ISSUED: JANUARY 2023	DRAWING No. PP09
CHECKED BY: AJS		SHEET 19 OF 48	



Know what's below.
Call before you dig.

CAUTION: OVERHEAD ELECTRIC AND BURIED GAS LINES
CONTRACTOR SHALL COORDINATE WITH UTILITY OWNERS
PRIOR TO CONSTRUCTION.

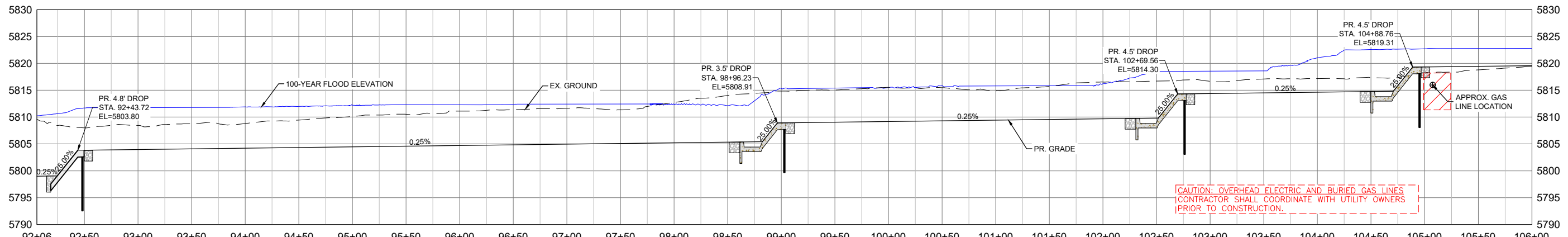
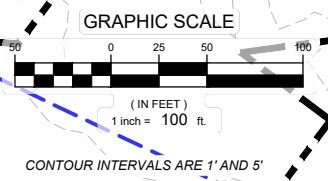
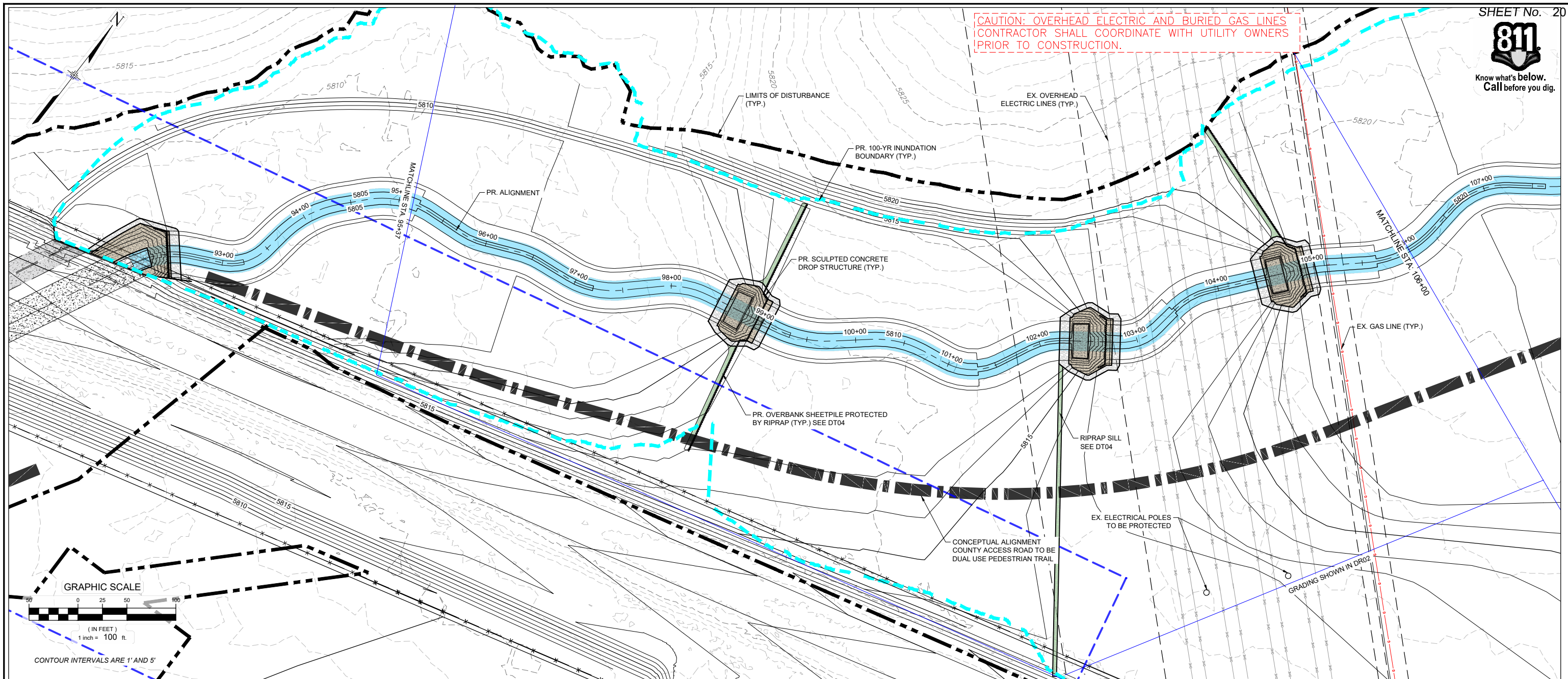

REFERENCE DRAWINGS			
No.	DATE	DESCRIPTION	BY
X-1129-UTILITIES			
X-1129-PARCELS			
X-1129-PR STRUCT			
X-1129-MD022034			
COMPUTER FILE MANAGEMENT			
FILE NAME: S:\21.1129.009 Rolling Hills Floodplain and Permitting\DWG\Design Plans\1129.009-PP02-15 US Alignment_60%.dwg			
CTB FILE: Matrix(black).ctb			
PLOT DATE: January 30, 2023 4:57:43 PM			
THIS DRAWING IS CURRENT AS OF PLOT DATE AND MAY BE SUBJECT TO CHANGE.			

60% DESIGN PLANS

NOTICE:
THIS DOCUMENT IS RELEASED FOR THE PURPOSE OF INTERIM REVIEW UNDER THE AUTHORITY OF AARON SUTHERLIN, PE. IT IS NOT TO BE USED FOR CONSTRUCTION, BIDDING OR PERMIT PURPOSES.

PREPARED BY:

SEAL

PRELIMINARY
THIS DRAWING HAS NOT BEEN APPROVED BY GOVERNING AGENCIES AND IS SUBJECT TO CHANGE

THE LANDHUIS COMPANY

ROLLING MEADOWS CHANNEL & FLOODPLAIN MODIFICATION
60% DESIGN PLANS

PLAN AND PROFILE
STA. 92+06 - 106+00

DESIGNED BY: TKM	SCALE: HORIZ 1" = 100'	DATE ISSUED: JANUARY 2023	DRAWING No. PP10
DRAWN BY: EAL	VERT. 1" = 20'	SHEET 20 OF 48	
CHECKED BY: AJS			



Know what's below.
Call before you dig.

CAUTION: OVERHEAD ELECTRIC AND BURIED GAS LINES
CONTRACTOR SHALL COORDINATE WITH UTILITY OWNERS
PRIOR TO CONSTRUCTION.

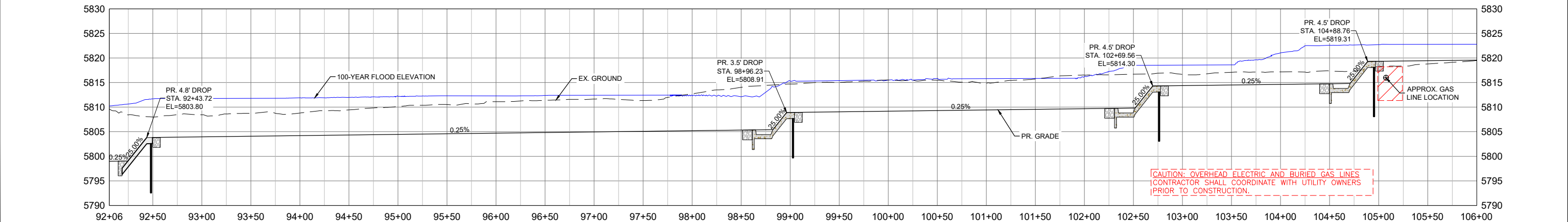
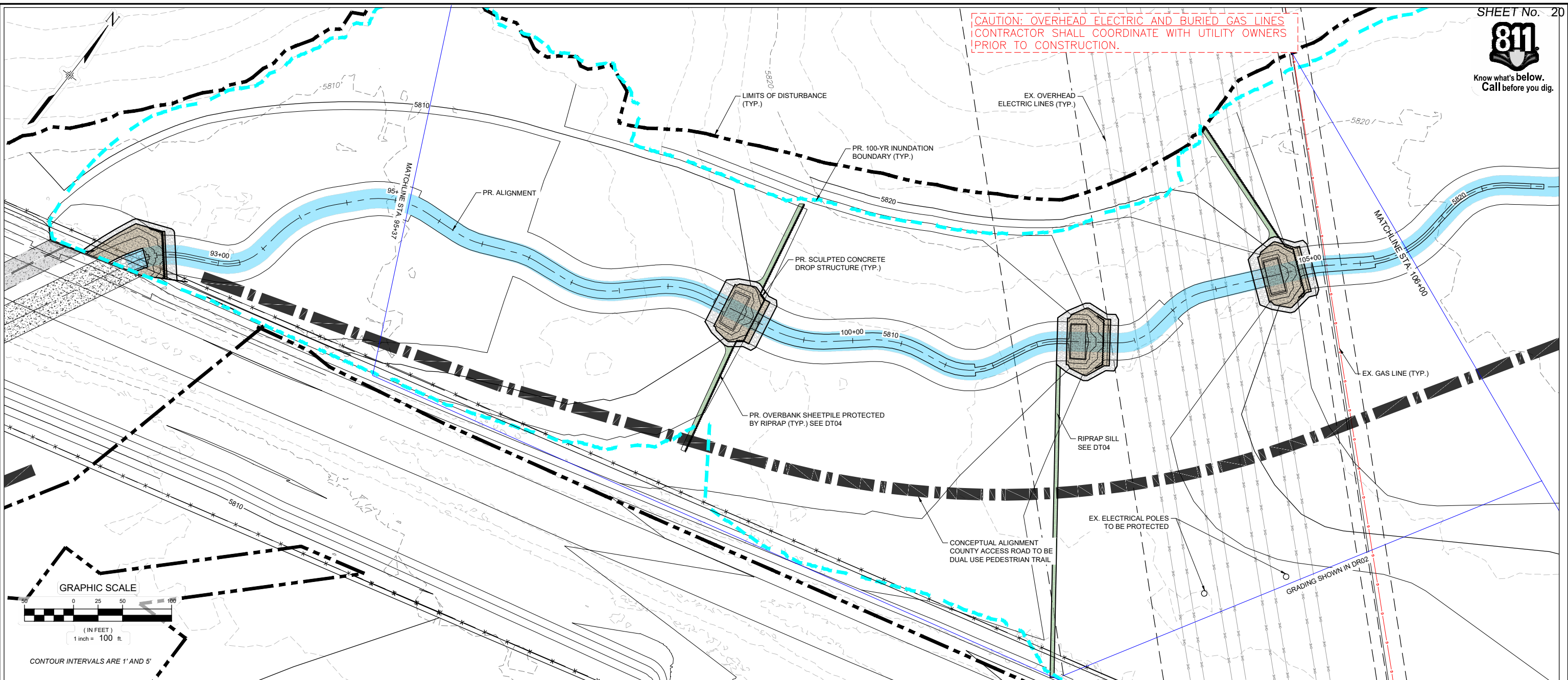

REFERENCE DRAWINGS			
No.	DATE	DESCRIPTION	BY
X-1129-UTILITIES			
X-1129-PARCELS			
X-1129-PR STRUCT			
X-1129-MD22034			
COMPUTER FILE MANAGEMENT			
FILE NAME: S:\21.1129.009 Rolling Hills Floodplain and Permitting\DWG\Design Plans\1129.009-PP02-15 US Alignment_60%.dwg			
CTB FILE: Matrix(black).ctb			
PLOT DATE: January 31, 2023 1:14:05 PM			
THIS DRAWING IS CURRENT AS OF PLOT DATE AND MAY BE SUBJECT TO CHANGE.			

60% DESIGN PLANS

NOTICE:
THIS DOCUMENT IS RELEASED FOR THE PURPOSE OF INTERIM REVIEW UNDER THE AUTHORITY OF AARON SUTHERLIN, PE. IT IS NOT TO BE USED FOR CONSTRUCTION, BIDDING OR PERMIT PURPOSES.

THE LANDHUIS COMPANY

PREPARED BY:

Matrix
Excellence by Design

SEAL

PRELIMINARY
THIS DRAWING HAS NOT BEEN APPROVED BY GOVERNING AGENCIES AND IS SUBJECT TO CHANGE

THE LANDHUIS COMPANY

ROLLING MEADOWS CHANNEL & FLOODPLAIN MODIFICATION
60% DESIGN PLANS

PLAN AND PROFILE
STA. 92+06 - 106+00

DESIGNED BY: TKM	SCALE: HORIZ 1" = 100'	DATE ISSUED: JANUARY 2023	DRAWING No. PP10
DRAWN BY: EAL	VERT. 1" = 20'	SHEET 20 OF 48	
CHECKED BY: AJS			



Know what's below.
Call before you dig.

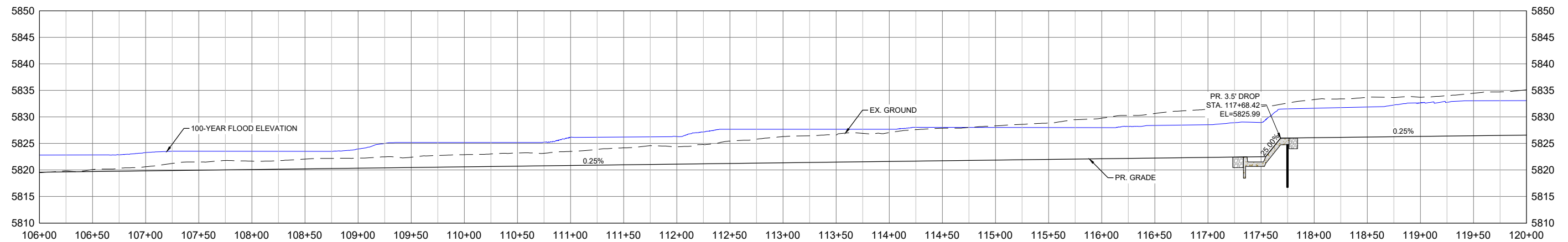
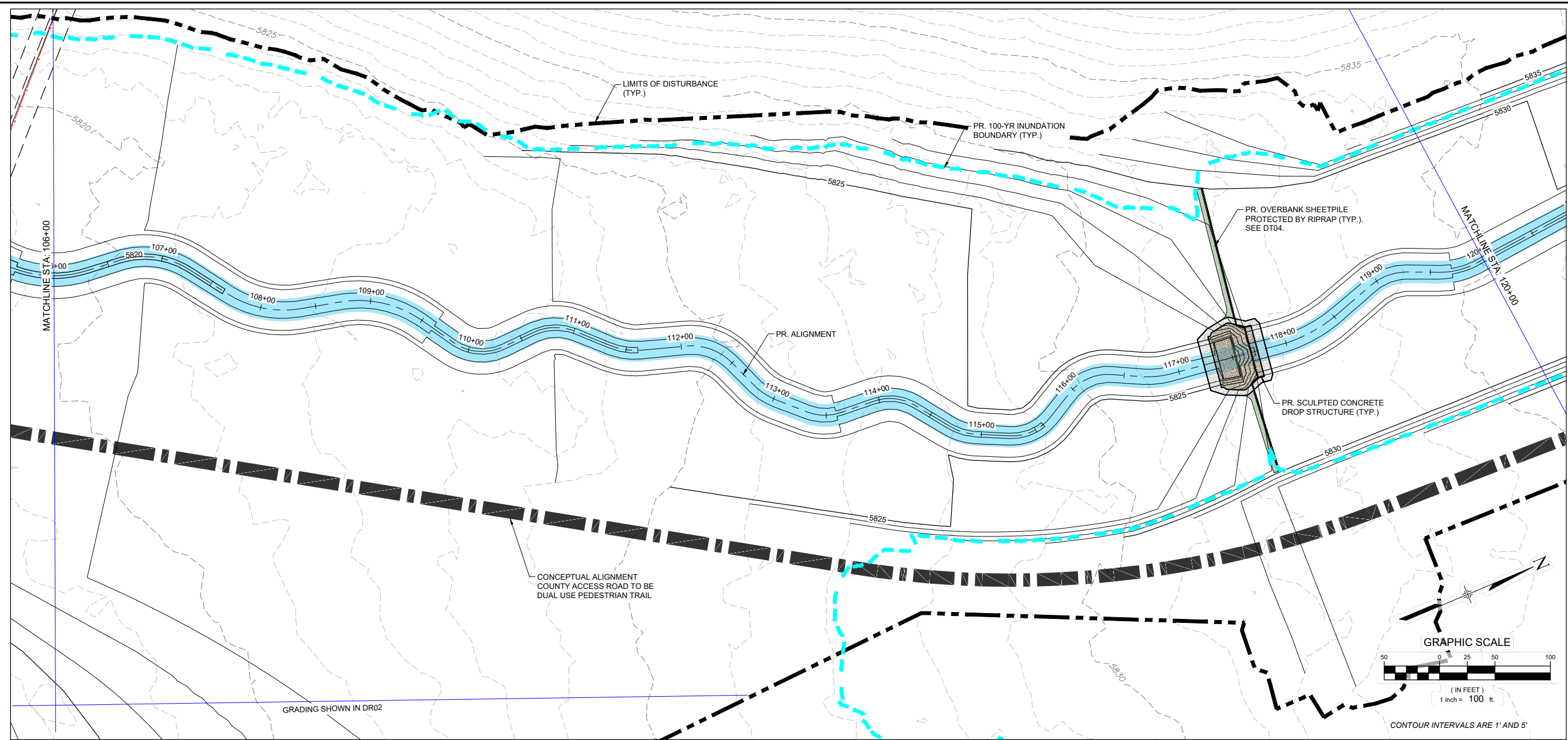

No.	DATE	DESCRIPTION	BY
COMPUTER FILE MANAGEMENT			
FILE NAME: S:\21.1129.009 Rolling Hills Floodplain and Permitting\Drawings\Design Plans\1129.009-PP02-15 US Alignment_60%.dwg			
CTB FILE: Matrix(black).ctb			
PLOT DATE: January 30, 2023 5:12:02 PM			
THIS DRAWING IS CURRENT AS OF PLOT DATE AND MAY BE SUBJECT TO CHANGE.			

60% DESIGN PLANS

NOTICE:
THIS DOCUMENT IS RELEASED FOR THE PURPOSE OF INTERIM REVIEW UNDER THE AUTHORITY OF AARON SUTHERLIN, PE. IT IS NOT TO BE USED FOR CONSTRUCTION, BIDDING OR PERMIT PURPOSES.



PREPARED BY:

Matrix
Excellence by Design

SEAL

PRELIMINARY
THIS DRAWING HAS NOT BEEN APPROVED BY GOVERNING AGENCIES AND IS SUBJECT TO CHANGE

FOR AND ON BEHALF OF
MATRIX DESIGN GROUP, INC.
PROJECT No. 21.1129.009

THE LANDHUIS COMPANY			
ROLLING MEADOWS CHANNEL & FLOODPLAIN MODIFICATION 60% DESIGN PLANS			
PLAN AND PROFILE STA. 106+00 - 120+00			
DESIGNED BY: TKM	SCALE: HORIZ 1" = 100'	DATE ISSUED: JANUARY 2023	DRAWING No. PP11
CHECKED BY: AJS	VERT. 1" = 20'	SHEET 21 OF 48	



Know what's below.
Call before you dig.

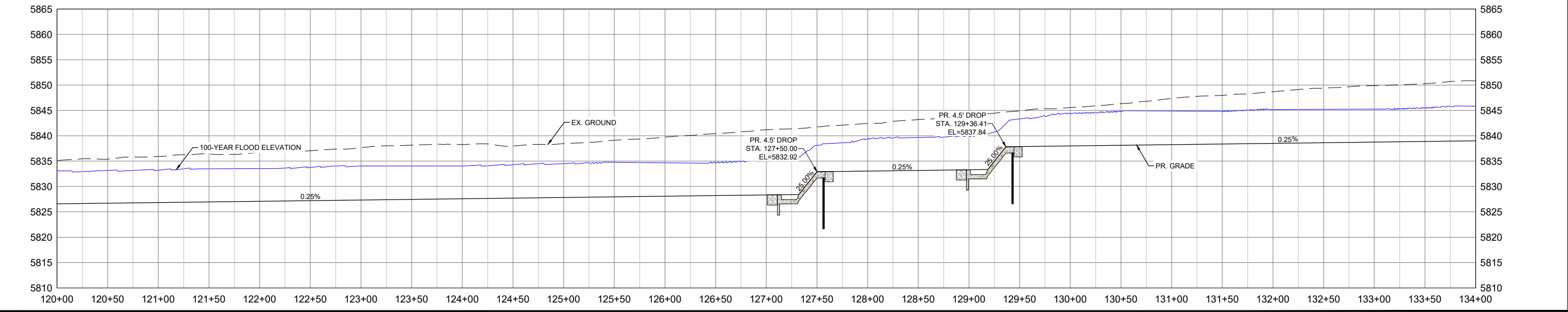
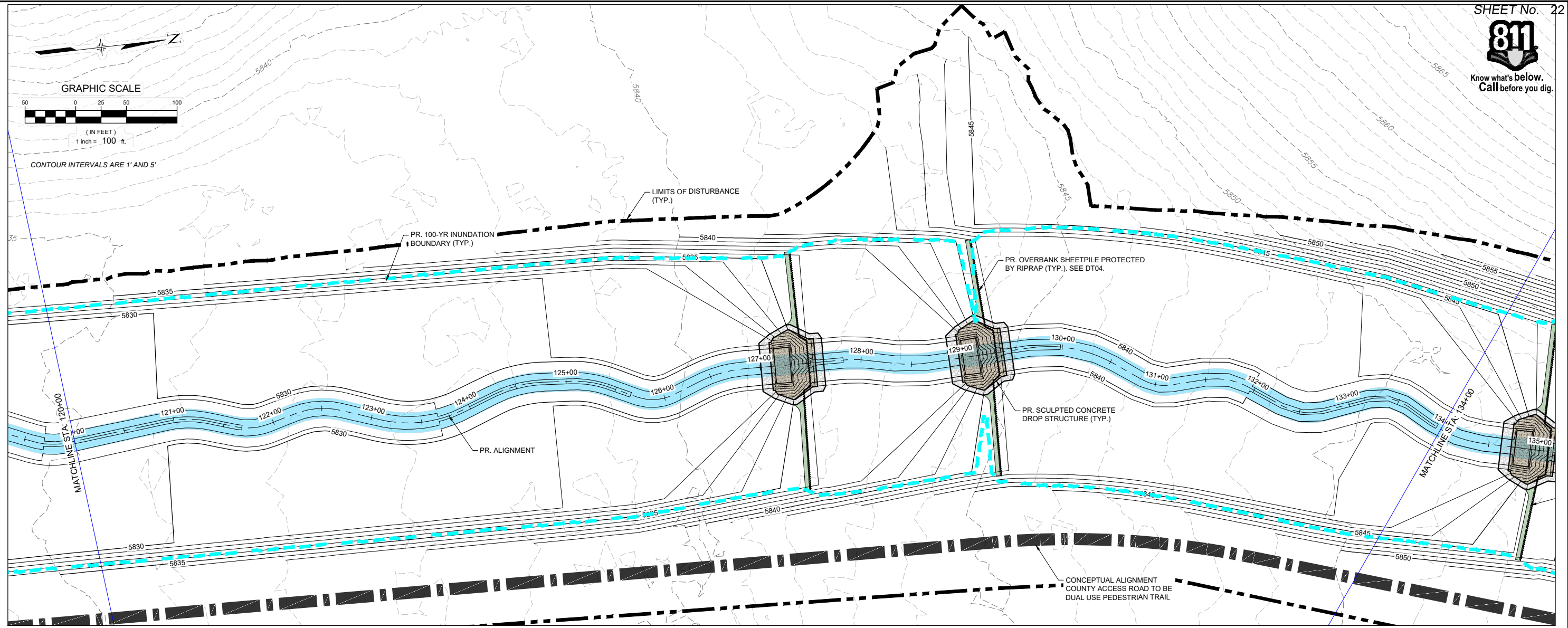

REFERENCE DRAWINGS			
No.	DATE	DESCRIPTION	BY
COMPUTER FILE MANAGEMENT			
FILE NAME: S:\21.1129.009 Rolling Hills Floodplain and Permitting\Design Plans\1129.009-PP02-15 US Alignment_60% .dwg			
CTB FILE: Matrix(black).ctb			
PLOT DATE: January 30, 2023 5:13:30 PM			
THIS DRAWING IS CURRENT AS OF PLOT DATE AND MAY BE SUBJECT TO CHANGE.			

60% DESIGN PLANS

NOTICE:
THIS DOCUMENT IS RELEASED FOR THE PURPOSE OF INTERIM REVIEW UNDER THE AUTHORITY OF AARON SUTHERLIN, PE. IT IS NOT TO BE USED FOR CONSTRUCTION, BIDDING OR PERMIT PURPOSES.



PREPARED BY:

SEAL

THE LANDHUIS COMPANY

ROLLING MEADOWS CHANNEL & FLOODPLAIN MODIFICATION
60% DESIGN PLANS

PLAN AND PROFILE
STA. 120+00 - 134+00

DESIGNED BY: TKM	SCALE: HORIZ 1" = 100'	DATE ISSUED: JANUARY 2023	DRAWING No. PP12
CHECKED BY: AJS	VERT. 1" = 20'	SHEET 22 OF 48	

FOR AND ON BEHALF OF MATRIX DESIGN GROUP, INC. PROJECT No. 21.1129.009



Know what's below.
Call before you dig.

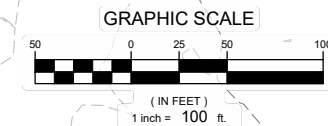

CONTOUR INTERVALS ARE 1' AND 5'

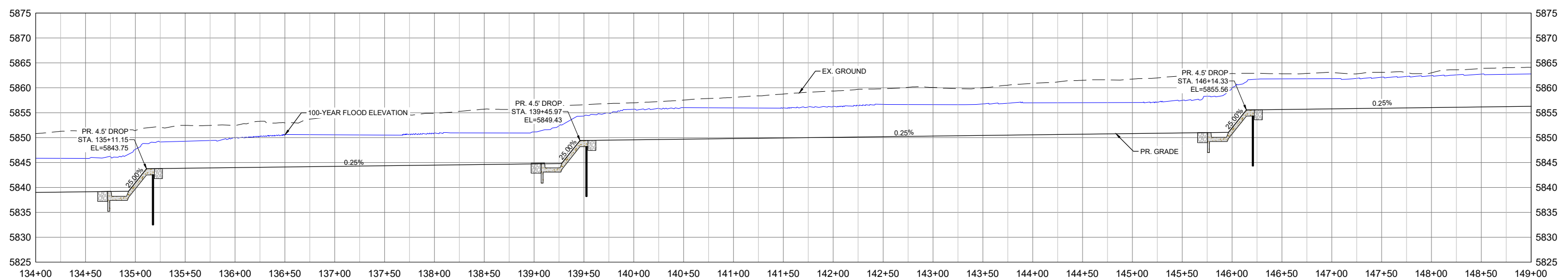
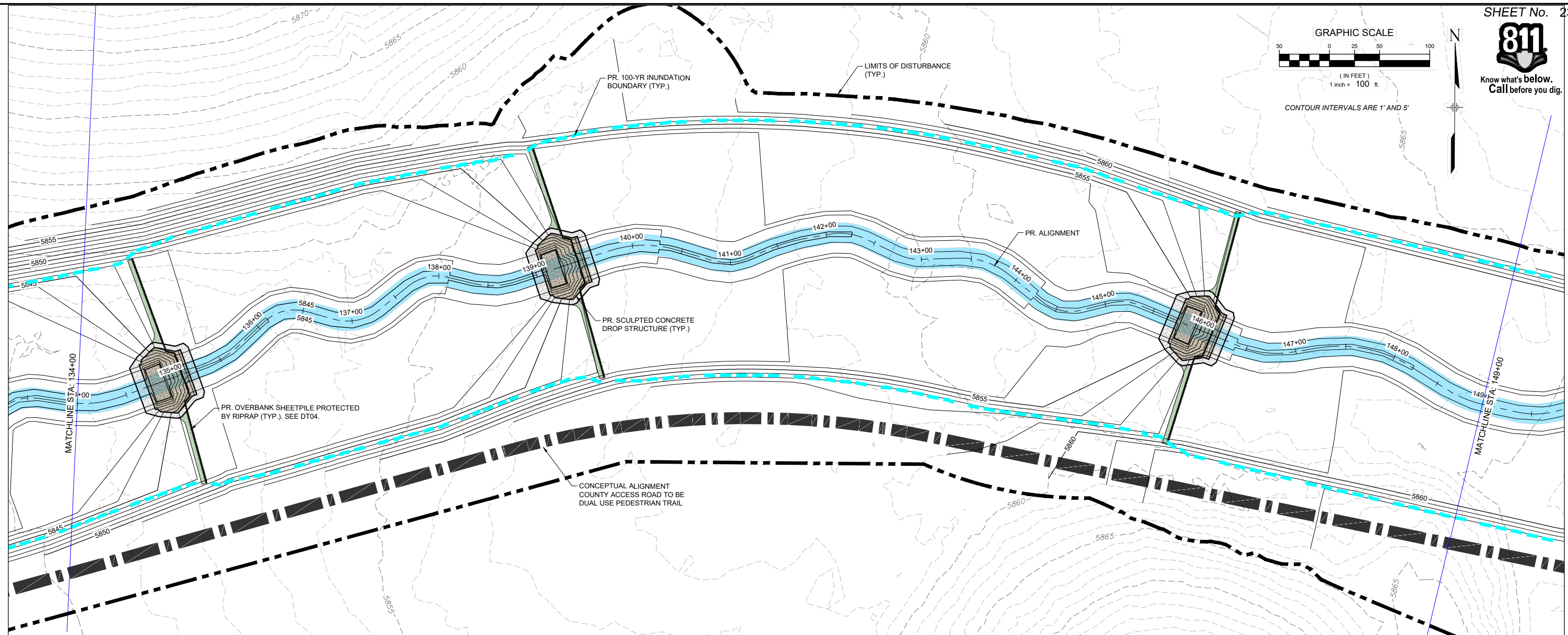

No.	DATE	DESCRIPTION REVISIONS	BY

COMPUTER FILE MANAGEMENT

FILE NAME: S:\21.1129.009 Rolling Hills Floodplain and Permitting\Design Plans\1129.009-PP02-15 US Alignment_60%.dwg
 CTB FILE: Matrix(black).ctb
 PLOT DATE: January 30, 2023 5:15:31 PM
 THIS DRAWING IS CURRENT AS OF PLOT DATE AND MAY BE SUBJECT TO CHANGE.

60% DESIGN PLANS

NOTICE:
 THIS DOCUMENT IS RELEASED FOR THE PURPOSE OF INTERIM REVIEW UNDER THE AUTHORITY OF AARON SUTHERLIN, PE. IT IS NOT TO BE USED FOR CONSTRUCTION, BIDDING OR PERMIT PURPOSES.



SEAL

PRELIMINARY
 THIS DRAWING HAS NOT BEEN APPROVED BY GOVERNING AGENCIES AND IS SUBJECT TO CHANGE

THE LANDHUIS COMPANY			
ROLLING MEADOWS CHANNEL & FLOODPLAIN MODIFICATION 60% DESIGN PLANS			
PLAN AND PROFILE STA. 134+00 - 149+00			
DESIGNED BY: TKM	SCALE: HORIZ 1" = 100'	DATE ISSUED: JANUARY 2023	DRAWING No. PP13
CHECKED BY: AJS	VERT. 1" = 20'	SHEET 23 OF 48	



Know what's below.
Call before you dig.

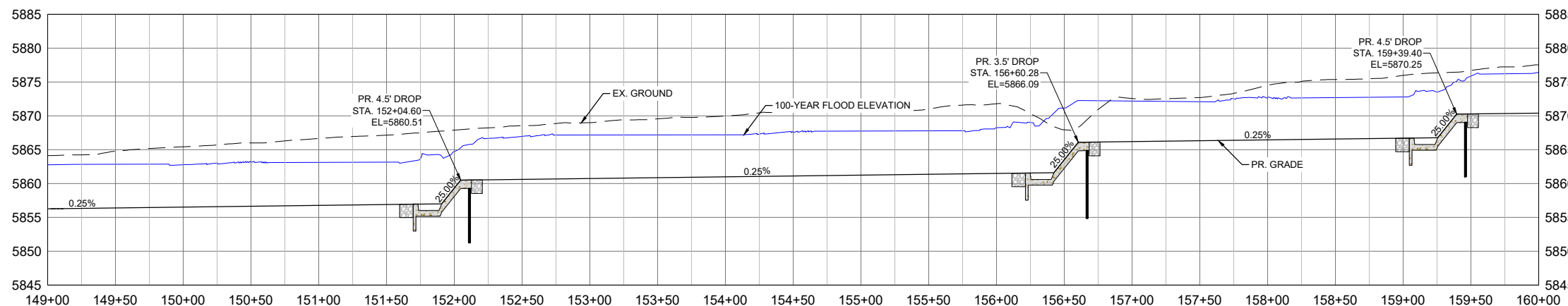
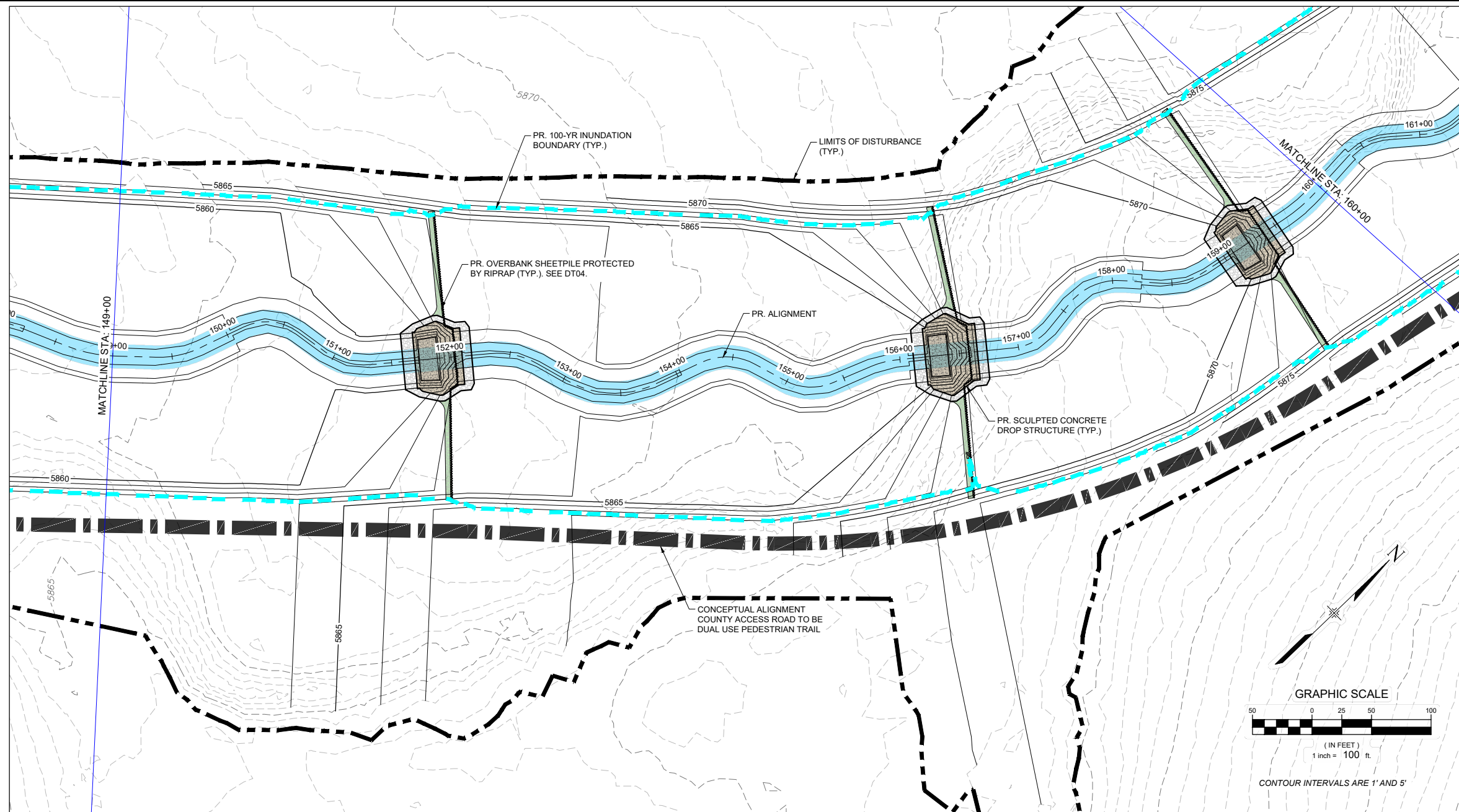

REFERENCE DRAWINGS			
No.	DATE	DESCRIPTION	BY
X-1129-UTILITIES			
X-1129-PARCELS			
X-1129-PR STRUCT			
X-1129-MDQ2234			
COMPUTER FILE MANAGEMENT			
FILE NAME: S:\21.1129.009 Rolling Hills Floodplain and Permitting\Design Plans\1129.009-PP02-15 US Alignment_60%.dwg			
CTB FILE: Matrix(black).ctb			
PLOT DATE: January 30, 2023 5:16:40 PM			
THIS DRAWING IS CURRENT AS OF PLOT DATE AND MAY BE SUBJECT TO CHANGE.			

60% DESIGN PLANS

NOTICE:
THIS DOCUMENT IS RELEASED FOR THE PURPOSE OF INTERIM REVIEW UNDER THE AUTHORITY OF AARON SUTHERLIN, PE. IT IS NOT TO BE USED FOR CONSTRUCTION, BIDDING OR PERMIT PURPOSES.



PREPARED BY:
Matrix
Excellence by Design

THE LANDHUIS COMPANY			
ROLLING MEADOWS CHANNEL & FLOODPLAIN MODIFICATION 60% DESIGN PLANS			
PLAN AND PROFILE STA. 149+00 - 160+00			
DESIGNED BY: TKM	SCALE: HORIZ 1" = 100'	DATE ISSUED: JANUARY 2023	DRAWING No. PP14
CHECKED BY: AJS	VERT. 1" = 20'	SHEET 24 OF 48	

SEAL

PRELIMINARY
THIS DRAWING HAS NOT BEEN APPROVED BY GOVERNING AGENCIES AND IS SUBJECT TO CHANGE

FOR AND ON BEHALF OF
MATRIX DESIGN GROUP, INC.
PROJECT No. 21.1129.009



Know what's below.
Call before you dig.

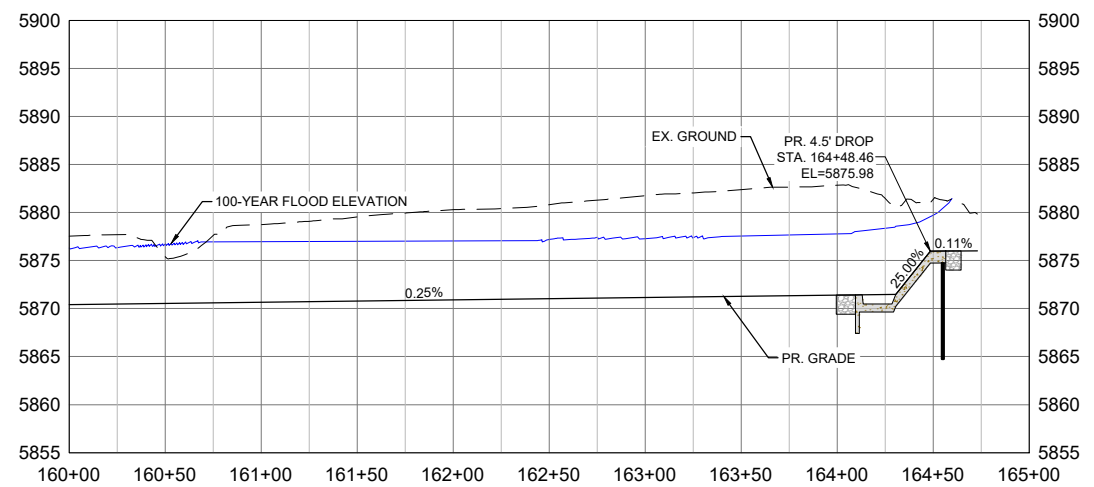
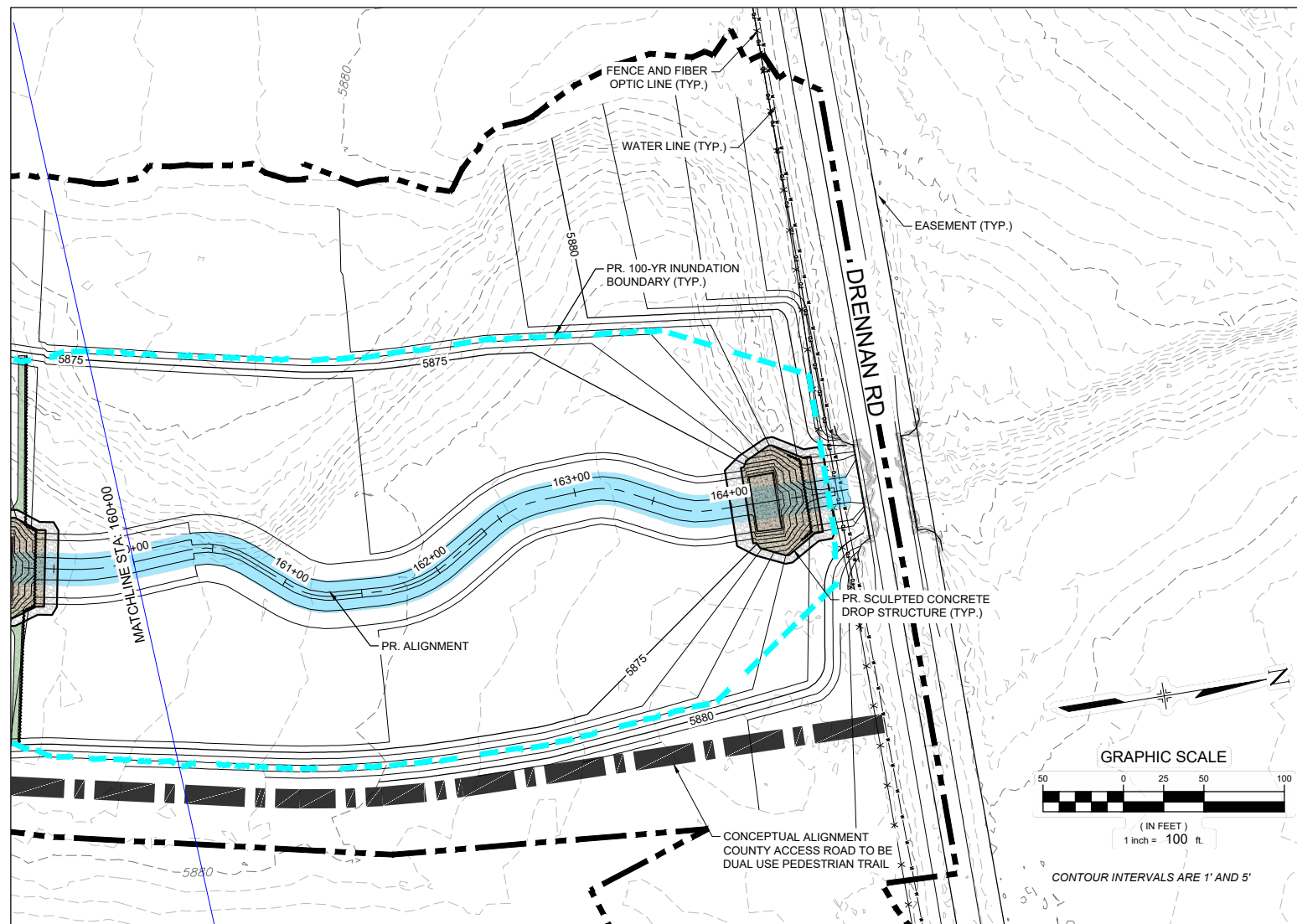

REFERENCE DRAWINGS			
X-1129-UTILITIES			
X-1129-PARCELS			
X-1129-PR STRUCT			
X-1129-MDQ22034			
No.	DATE	DESCRIPTION REVISIONS	BY
COMPUTER FILE MANAGEMENT			
FILE NAME: S:\21.1129.009 Rolling Hills Floodplain and Permitting\Drawings\Design Plans\1129.009-PP02-15 US Alignment_60%.dwg			
CTB FILE: Matrix(black).ctb			
PLOT DATE: January 30, 2023 5:20:48 PM			
THIS DRAWING IS CURRENT AS OF PLOT DATE AND MAY BE SUBJECT TO CHANGE.			

60% DESIGN PLANS

NOTICE:
THIS DOCUMENT IS RELEASED FOR THE PURPOSE OF INTERIM REVIEW UNDER THE AUTHORITY OF AARON SUTHERLIN, PE. IT IS NOT TO BE USED FOR CONSTRUCTION, BIDDING OR PERMIT PURPOSES.



SEAL

PRELIMINARY
THIS DRAWING HAS NOT BEEN APPROVED BY GOVERNING AGENCIES AND IS SUBJECT TO CHANGE

THE LANDHUIS COMPANY			
ROLLING MEADOWS CHANNEL & FLOODPLAIN MODIFICATION 60% DESIGN PLANS			
PLAN AND PROFILE STA. 160+00 - 165+00			
DESIGNED BY: TKM	SCALE: HORIZ 1" = 100'	DATE ISSUED: JANUARY 2023	DRAWING No.
CHECKED BY: AJS	VERT. 1" = 20'	SHEET 25 OF 48	PP15