

5590 KINGSBORO DR
parcel 65124-16-027
LOT 8 BLK 1
FOUNTAIN VALLEY RANCH
SUB FIL NO 7C

5590 Kingsboro Dr C/S CO 6911

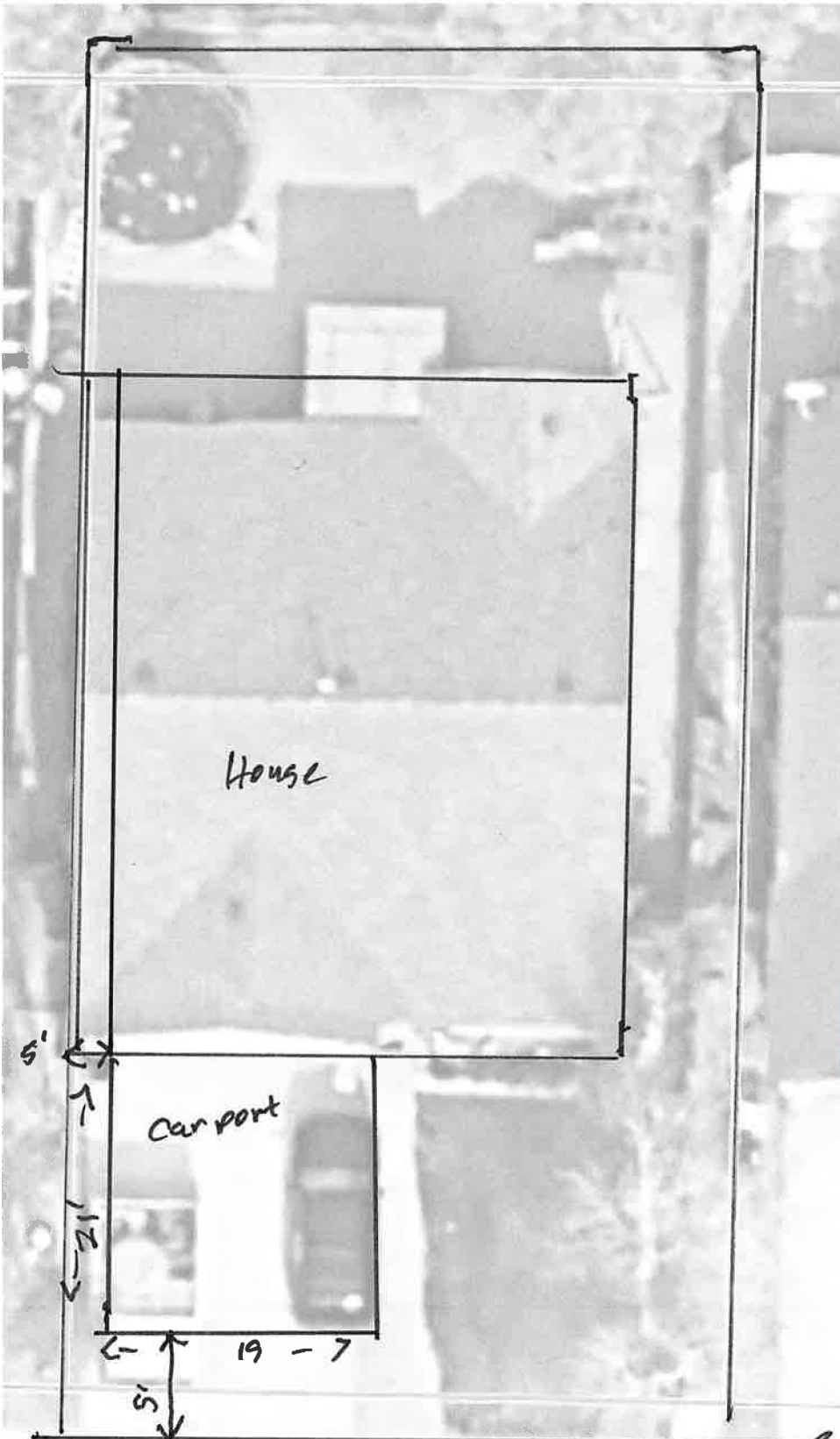

ADD23495
PLAT 9942
ZONE PUD CAD-O
4743 SQFT

carport
21'x19

APPROVED

Plan Review

08/21/2023 8:30:17 AM
dsdarchuleta

EPC Planning & Community
Development Department

**Not Required
BESQCP**

08/21/2023 8:30:24 AM
dsdarchuleta

EPC Planning & Community
Development Department



ANY APPROVAL GIVEN BY
EL PASO COUNTY
DOES NOT OBLIATE THE NEED
TO COMPLY WITH APPLICABLE
FEDERAL, STATE, OR LOCAL
LAWS AND/OR REGULATION

Planning & Community Development Department
approval is contingent upon compliance with all
applicable notes on the recorded plat.

An access permit must be granted by the
Planning & Community Development Department
prior to the establishment of any driveway onto a
County road.

Diversion or blockage of any drainage way
is not permitted without approval of the
Planning & Community Development Department



It is the owner's responsibility to
coordinate with easement holders
to avoid impact to utilities that
may be located in the easements.