

EL PASO



COUNTY

COMMISSIONERS:
DARRYL GLENN (PRESIDENT)
MARK WALLER (PRESIDENT PRO TEMPORE)

STAN VANDERWERF
LONGINOS GONZALEZ
PEGGY LITTLETON

PLANNING AND COMMUNITY DEVELOPMENT DEPARTMENT
CRAIG DOSSEY, EXECUTIVE DIRECTOR
January 31, 2018

This letter is to inform you of the following petition which has been submitted to El Paso County:

SKP-17-001

FITZPATRICK

**SKETCH PLAN AMENDMENT
MERIDIAN RANCH**

A request by Meridian Ranch Investments, Inc., for approval of a sketch plan amendment for 848.8 acres zoned PUD (Planned Unit Development). The property is located at the northwest corner of the intersection of Stapleton Drive and Eastonville Road. (Parcel Nos. 42000-00-375, 42000-00-401, 42000-00-402, 42000-00-407, 42000-00-408, 42000-00-411, 42000-00-412, 42000-00-413, 42000-00-415, 42304-00-001) (Commissioner District No. 2) (Raimere Fitzpatrick)

Type of Hearing: Quasi-Judicial

_____ For _____ Against _____ No Opinion _____

Comments: _____

(FOR ADDITIONAL COMMENTS, PLEASE ATTACH ANOTHER SHEET.)

- **This item is scheduled to be heard by the El Paso County Planning Commission on February 20, 2018.** The meeting begins at 9:00 a.m. and will be conducted in the Second Floor Hearing Room of the Pikes Peak Regional Development Center, 2880 International Circle, Colorado Springs.
- **The item will also be heard by the El Paso County Board of County Commissioners on March 13, 2018.** The meeting begins at 9:00 a.m. and will be conducted in the Centennial Hall Auditorium, 200 South Cascade Avenue, Colorado Springs.
- The date and order when this item will be considered can be obtained by calling the Planning and Community Development Department or through El Paso County's Web site (www.elpasoco.com). Actions taken by the El Paso County Board of County Commissioners are posted on the internet following the meeting.
- The Staff Report for this Agenda item can be found at:
<http://adm.elpasoco.com/Development%20Services/Pages/PlanningCommission2018.aspx>

Your response will be a matter of public record and available to the applicant prior to the hearing. You are welcome to appear in person at the hearing to further express your opinion on this petition. If we can be of any assistance, please call 719-520-6300.

Sincerely,

Raimere Fitzpatrick, Project Manager/Planner II

Your Name: _____ (printed) _____ (signature)

Address: _____

Property Location: _____ Phone: _____

2880 INTERNATIONAL CIRCLE, SUITE 110
PHONE: (719) 520-6300



COLORADO SPRINGS, CO 80910-3127
FAX: (719) 520-6695

El Paso County Parcel Information

File Name: SKP-17-001

Zone Map No.: --

Date: January 31, 2018

PARCEL	NAME
4200000407	MERIDIAN RANCH INVESTMENTS INC
4200000401	MERIDIAN RANCH INVESTMENTS INC
4200000402	MERIDIAN RANCH INVESTMENTS INC
4200000375	MERIDIAN RANCH INVESTMENTS INC
4200000408	MERIDIAN SERVICE METRO DISTRICT
4200000412	MERIDIAN RANCH INVESTMENTS INC
4200000413	MERIDIAN RANCH INVESTMENTS INC
4200000411	MERIDIAN RANCH INVESTMENTS INC
4200000415	MERIDIAN RANCH INVESTMENTS INC
4230400001	GTL INC

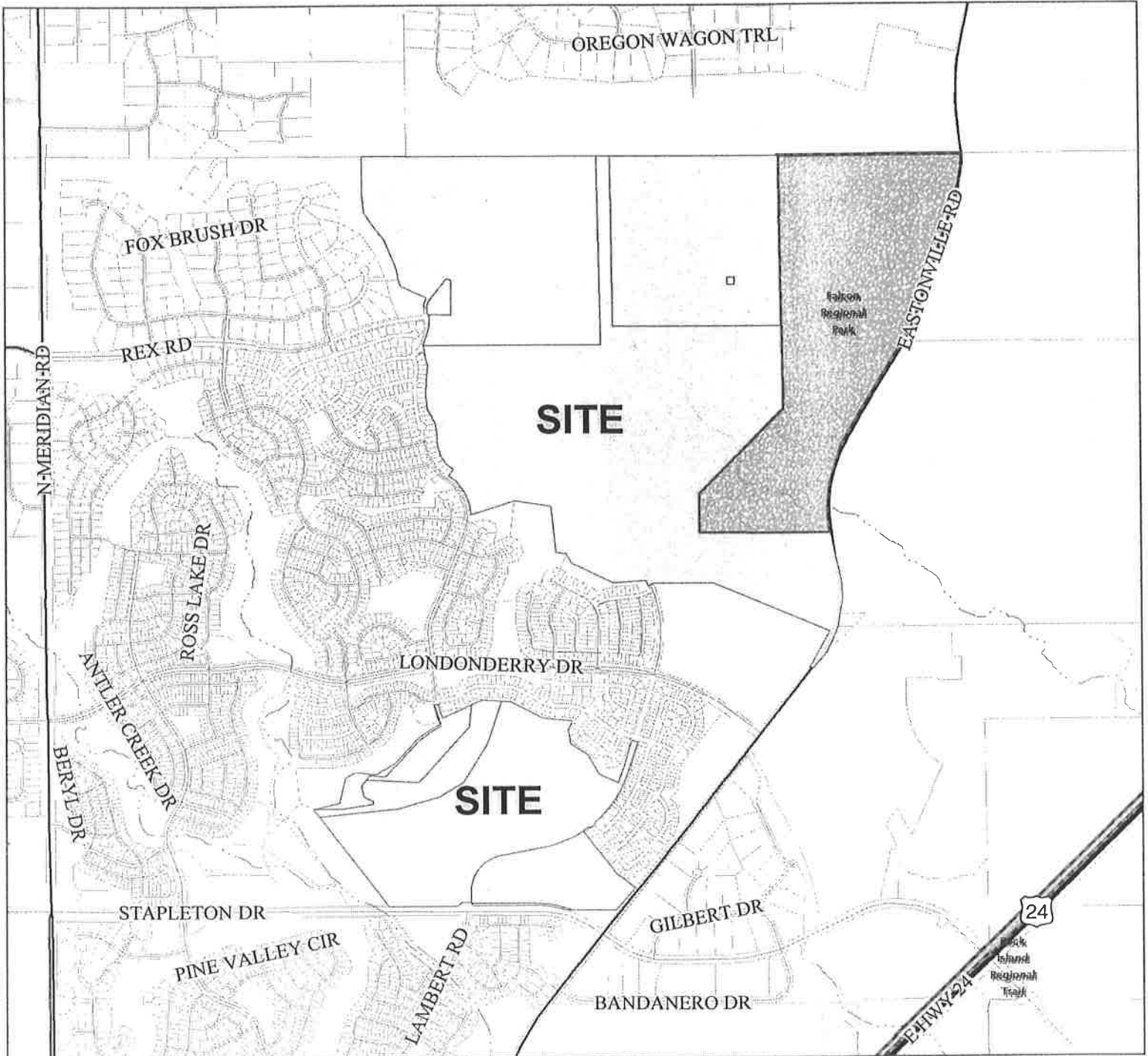

Please report any parcel discrepancies to:
 El Paso County Assessor
 1675 W. Garden of the Gods Rd
 Colorado Springs, CO 80907
 (719) 520-6600



COPYRIGHT 2017 by the Board of County Commissioners, El Paso County, Colorado. All rights reserved. No part of this document or data contained herein may be reproduced, used to prepare derivative products, or distributed without the specific written approval of the Board of County Commissioners, El Paso County, Colorado. This document was prepared from the best data available at the time of printing. El Paso County, Colorado, makes no claim as to the completeness or accuracy of the data contained herein.



EL PASO COUNTY

PLANNING AND COMMUNITY DEVELOPMENT DEPARTMENT
2880 INTERNATIONAL CIRCLE, SUITE 110
COLORADO SPRINGS, CO 80910

CLEVELAND CARSON C 4232208046
12906 DEVILS THUMB PL
PEYTON, CO 80831

USPS
CD 802
02 FEB 18
PM 3 L



FEB 12 2018

NIXIE 808 CE 1 8602/07/18

RETURN TO SENDER
NOT DELIVERABLE AS ADDRESSED
UNABLE TO FORWARD

8C: 80910313250 * 2278-00020-02-46

808665433250

EL PASO COUNTY

PLANNING AND COMMUNITY DEVELOPMENT DEPARTMENT
2880 INTERNATIONAL CIRCLE, SUITE 110
COLORADO SPRINGS, CO 80910

PLAINVIEW PROPERTIES LLC 4200000397
13908 ELBERT RD
PEYTON, CO 80831

DENVER
CO 802
02 FEB '18
PM 2 L



NIXIE 808 CE 2 8502/07/18

RETURN TO SENDER
NO SUCH STREET
UNABLE TO FORWARD

RC: 80910314835 *1736-01590-02-46
808314835

NSS
808314835



EL PASO COUNTY

PLANNING AND COMMUNITY DEVELOPMENT DEPARTMENT
2880 INTERNATIONAL CIRCLE, SUITE 110
COLORADO SPRINGS, CO 80910

WOODMEN HILLS METROPOLITAN DIST
4232202005
7643 MCLAUGHLIN RD PMB #205
PEYTON, CO 80831

LENSER
CO 802
02 FEB '18
PM 3 L



NIXIE 808 CE 1 8502/07/18

RETURN TO SENDER
NOT DELIVERABLE AS ADDRESSED

BC: 80910314235 *2278-01579-02-46

808 314 235 46
with

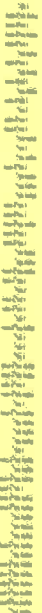

EL PASO COUNTY



PLANNING AND COMMUNITY DEVELOPMENT DEPARTMENT
2880 INTERNATIONAL CIRCLE, SUITE 110
COLORADO SPRINGS, CO 80910

BELDEROL CHRISTINE D 4232208042
12954 DEVILS THUMB PL
PEYTON, CO 80831

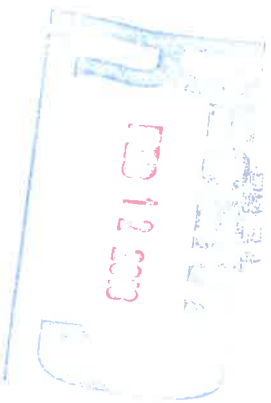

UNITED STATES
CO 80831
02 FEB '18



NIXIE 808 CE 1 8602/07/18

RETURN TO SENDER
NOT DELIVERABLE AS ADDRESSED
UNABLE TO FORWARD

BC: 50910618799 *2275-00889-82-45

808 344 4444 UTP