

# EL PASO COUNTY



COLORADO

*Copied 8/25/21  
mailed 8/27/21*

COMMISSIONERS:  
STAN VANDERWERF (CHAIR)  
LONGINOS GONZALEZ, JR. (VICE-CHAIR)

HOLLY WILLIAMS  
CARRIE GEITNER  
CAMI BREMER

PLANNING AND COMMUNITY DEVELOPMENT DEPARTMENT  
CRAIG DOSSEY, EXECUTIVE DIRECTOR

8/24/2021

RE: Walters OS Re-Plat – Final Plat

File: SF-20-031

Parcel ID Nos.: 7123102049, 7124103028, 7124201001, 7124201003, 7124202236  
7124204023, 7124204029

To Whom It May Concern:

This letter is to inform property owners adjacent to the property located at parcel numbers 7123102049, 7124103028, 7124201001, 7124201003, 7124202236, 7124204023, 7124204029 that the applicant, WOSC, has requested approval of an application for a Final Plat to combine five existing tracts for open space within an existing subdivision.

The Planning and Community Development Director may make a formal decision regarding the Final Plat application on 9/7/2021. Any comments or questions may be forwarded to me prior to that decision. Administrative approval by the Planning and Community Development Director is subject to the appeal provisions of the Land Development Code.

You may view the application documents online at [www.epcdevplanreview.com](http://www.epcdevplanreview.com). Please feel free to contact me with any questions, comments, or concerns you may have prior to the decision.

Respectfully,

John Green  
El Paso County Planning and Community Development  
719-520-6442  
[johngreen@elpasoco.com](mailto:johngreen@elpasoco.com)

2880 INTERNATIONAL CIRCLE, SUITE 110  
PHONE: (719) 520-6300



COLORADO SPRINGS, CO 80910-3127  
FAX: (719) 520-6695

[WWW.ELPASOCO.COM](http://WWW.ELPASOCO.COM)

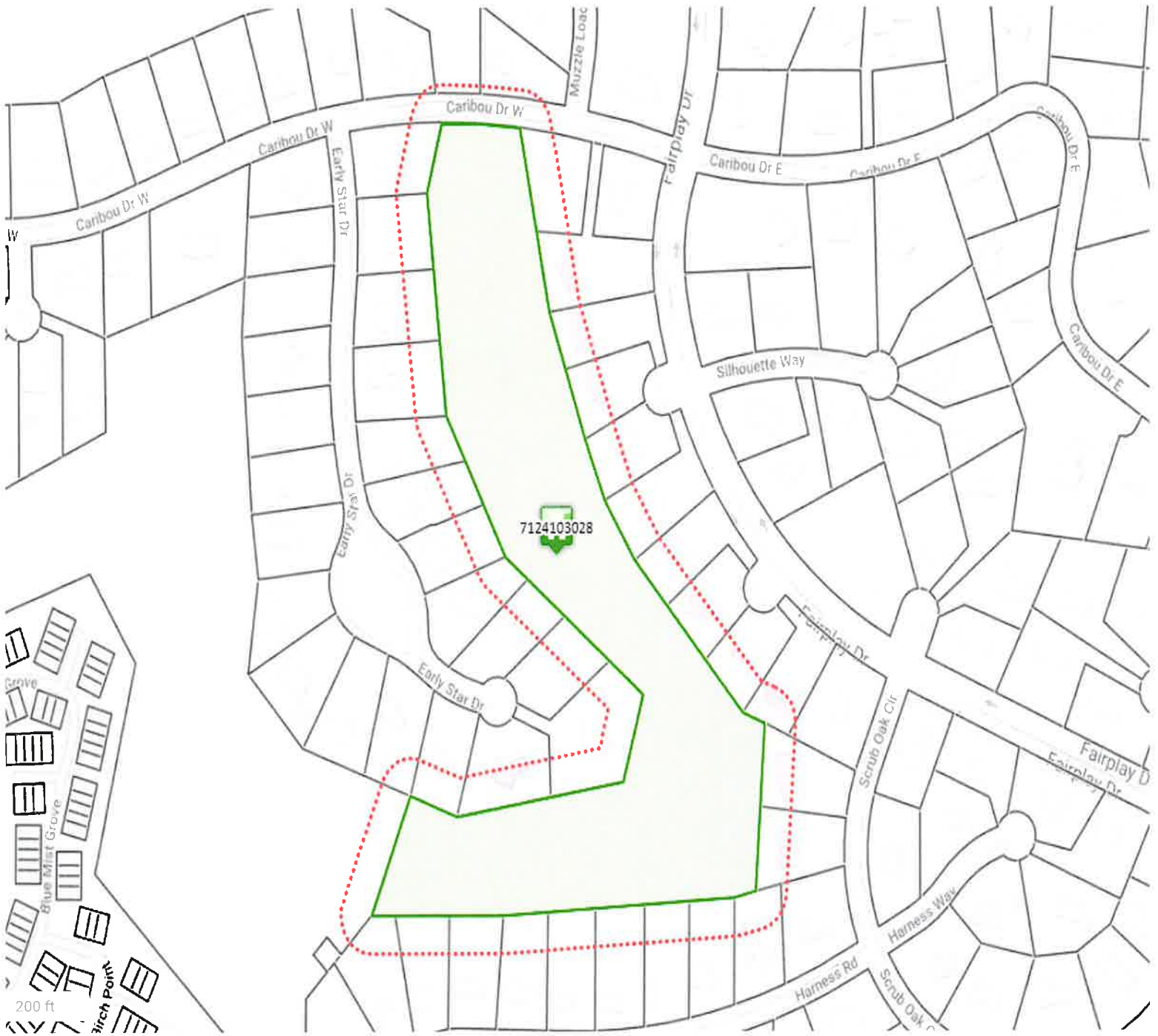

V CARIBOU DR

7124103028  
WOSC LLC

Market Value \$13,201



**Disclaimer**

We have made a good-faith effort to provide you with the most recent and most accurate information available. However, if you need to use this information in any legal or official venue, you will need to obtain official copies from the Assessor's Office. Do be aware that this data is subject to change on a daily basis. If you believe that any of this information is incorrect, please call us at (719) 520-6600.

BINA DAVID A  
17350 FAIRPLAY DR  
MONUMENT CO 80132-8541

LAMB RICHARD E  
17320 FAIRPLAY DR  
MONUMENT CO 80132-8541

SCHLUETER RICHARD A  
17290 FAIRPLAY DR  
MONUMENT CO 80132-8541

PRICE BRIAN A SR  
17280 FAIRPLAY DR  
MONUMENT CO 80132

STAUBER WILLIAM B  
17270 FAIRPLAY DR  
MONUMENT CO 80132-8541

NORMOYLE FAMILY REVOC LIV TRUST  
17260 FAIRPLAY DR  
MONUMENT CO 80132-8541

PEDERSEN JOEL  
495 SCRUB OAK CIR  
MONUMENT CO 80132-8558

WEIER SHARON A  
485 SCRUB OAK CIR  
MONUMENT CO 80132-8558

HOFF BRIAN T  
475 SCRUB OAK CIR  
MONUMENT CO 80132-8558

HANNEN BRUCE R  
510 HARNESS RD  
MONUMENT CO 80132-7414

BAUGH ROSANNE K LIVING TRUST  
1730 DUNES CLUB PL  
FERNANDINA BEACH FL 32034-6665

ROYBAL PROCOPIO J  
560 HARNESS RD  
MONUMENT CO 80132-7414

LINDLEY CHRISTOPHER  
580 HARNESS RD  
MONUMENT CO 80132-7414

HINDMARSH LIVING TRUST  
610 HARNESS RD  
MONUMENT CO 80132-8563

KOHLHASE PETER H  
620 HARNESS RD  
MONUMENT CO 80132-8563

PIEPER BRUCE R  
630 HARNESS RD  
MONUMENT CO 80132-8563

EISELE WARREN D  
640 HARNESS RD  
MONUMENT CO 80132-8563

BOHLER JOSEPH S  
PO BOX 387  
MONUMENT CO 80132-0387

FOUTCH FAMILY LIVING TRUST  
17140 EARLY STAR DR  
MONUMENT CO 80132-8566

LEFFINGWELL DON O  
17120 EARLY STAR DR  
MONUMENT CO 80132-8566

BURKHART FAMILY REVOC LIV TRUST  
17115 EARLY STAR DR  
MONUMENT CO 80132-8565

BERLS GEORGE O  
28039 RIDGEBROOK CT  
RANCHO PALOS VERDES CA  
90275-3373

ARTLEY ANDREA L  
17155 EARLY STAR DR  
MONUMENT CO 80132-8565

BAILEY BENNY L JR  
17215 EARLY STAR DR  
MONUMENT CO 80132-8589

WOSC LLC  
902 CARIBOU DR W  
MONUMENT CO 80132

MENDELL THOMAS A  
625 CARIBOU DR W  
MONUMENT CO 80132-8577

BEKKER JOHN E  
645 CARIBOU DR W  
MONUMENT CO 80132-8577

MORGAN GREGORY K  
17235 EARLY STAR DR  
MONUMENT CO 80132-8589

ELDRED NANCY  
17330 FAIRPLAY DR  
MONUMENT CO 80132-8541

SEGLEM MARK K  
17340 FAIRPLAY DR  
MONUMENT CO 80132-8541

FOWLER THOMAS  
660 CARIBOU DR W  
MONUMENT CO 80132-8544

WOSC LLC  
902 CARIBOU DR W  
MONUMENT CO 80132

HOLMES TERRY J  
720 CARIBOU DR W  
MONUMENT CO 80132-8570

BIRD JOHN M  
17160 EARLY STAR DR  
MONUMENT CO 80132-8566

HATFIELD MARK C  
660 HARNESS RD  
MONUMENT CO 80132-8563

WOSC LLC  
902 CARIBOU DR W  
MONUMENT CO 80132

BHATIA SAMEER  
17275 EARLY STAR DR  
MONUMENT CO 80132-8589

ANDERSON ELIZABETH A  
715 W CARIBOU DR  
MONUMENT CO 80132-8569

TUCKER DAVID  
17365 EARLY STAR DR  
MONUMENT CO 80132-8590

NICHOLLS GEOFFREY A  
17325 EARLY STAR DR  
MONUMENT CO 80132-8590

KUSSEROW STEVEN K  
17305 EARLY STAR DR  
MONUMENT CO 80132-8590

HAGGLOF JAMES T  
17255 EARLY STAR DR  
MONUMENT CO 80132-8589