

Label any areas of customer parking. If there are areas where customers get out of the car, you might have to offer HC accessible parking as well. Verify with Pike's Peak Building. That level of detail can be worked out at time of site plan but if there is customer parking you should at least generally show location on this exhibit and surfacing material.

The code requires roadway landscaping along 94 (1 tree per 20 feet of road frontage excluding the driveway width)

The code requires buffer and screen areas between non-residential uses and residential zoning districts. A 6' solid opaque fence or wall is required along the lot, parcel, or tract line where non-residential use abuts residential zoning district. Also one tree for each 25 feet of common lot, parcel, or tract line is required.

**SITE PLAN**  
 Address: 11556 Highway 94  
 Colorado Springs, CO, 80929

Scale 1"=120'

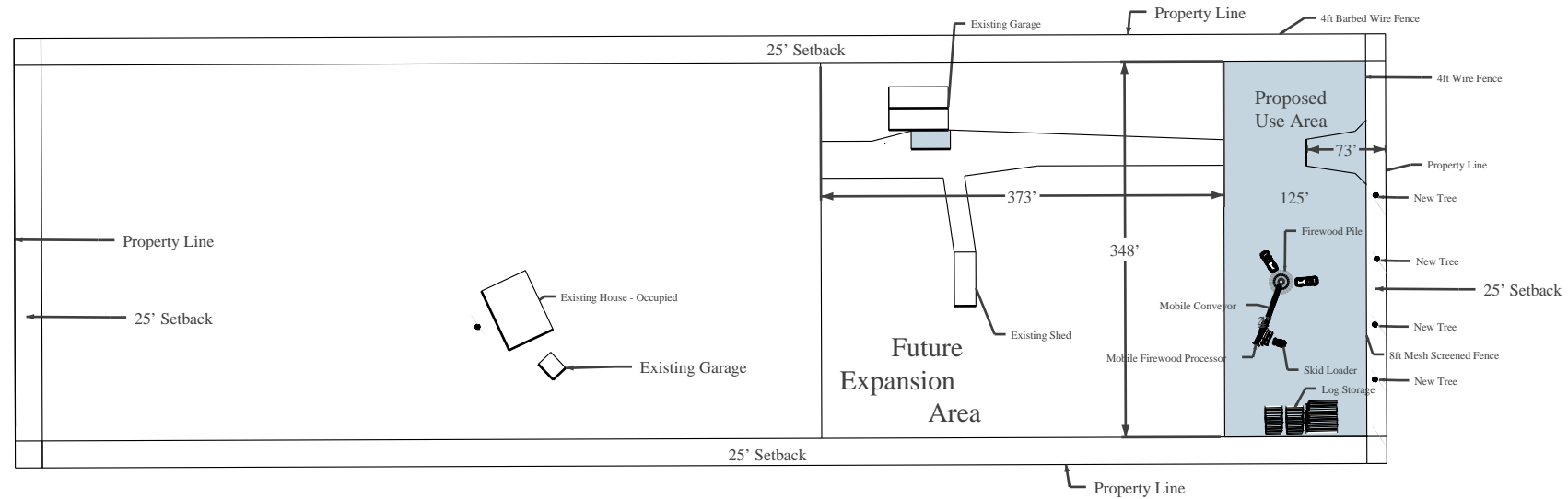

Will you have office space on-site? If so, where located?

The Code requires areas of outside storage of equipment and/or materials to be screened with solid fencing that is a minimum height of 6 feet. Chain link fencing with screen is not considered solid. Additionally, if you provide a fence taller than 7 feet, it is considered a structure and shall meet setbacks.