

# THE SHOP'S AT MERIDIAN RANCH

## FILING NO. 1, LOT 4 PHOTOMETRIC PLAN EL PASO COUNTY, COLORADO. FALCON, COLORADO

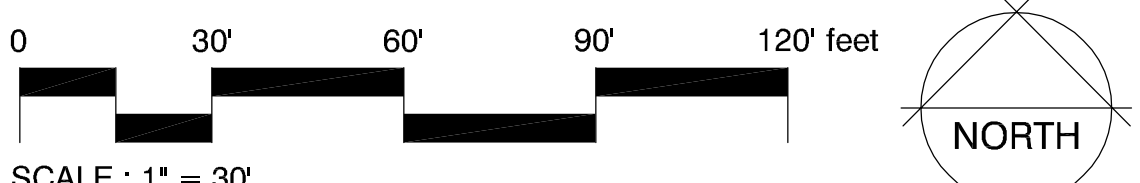
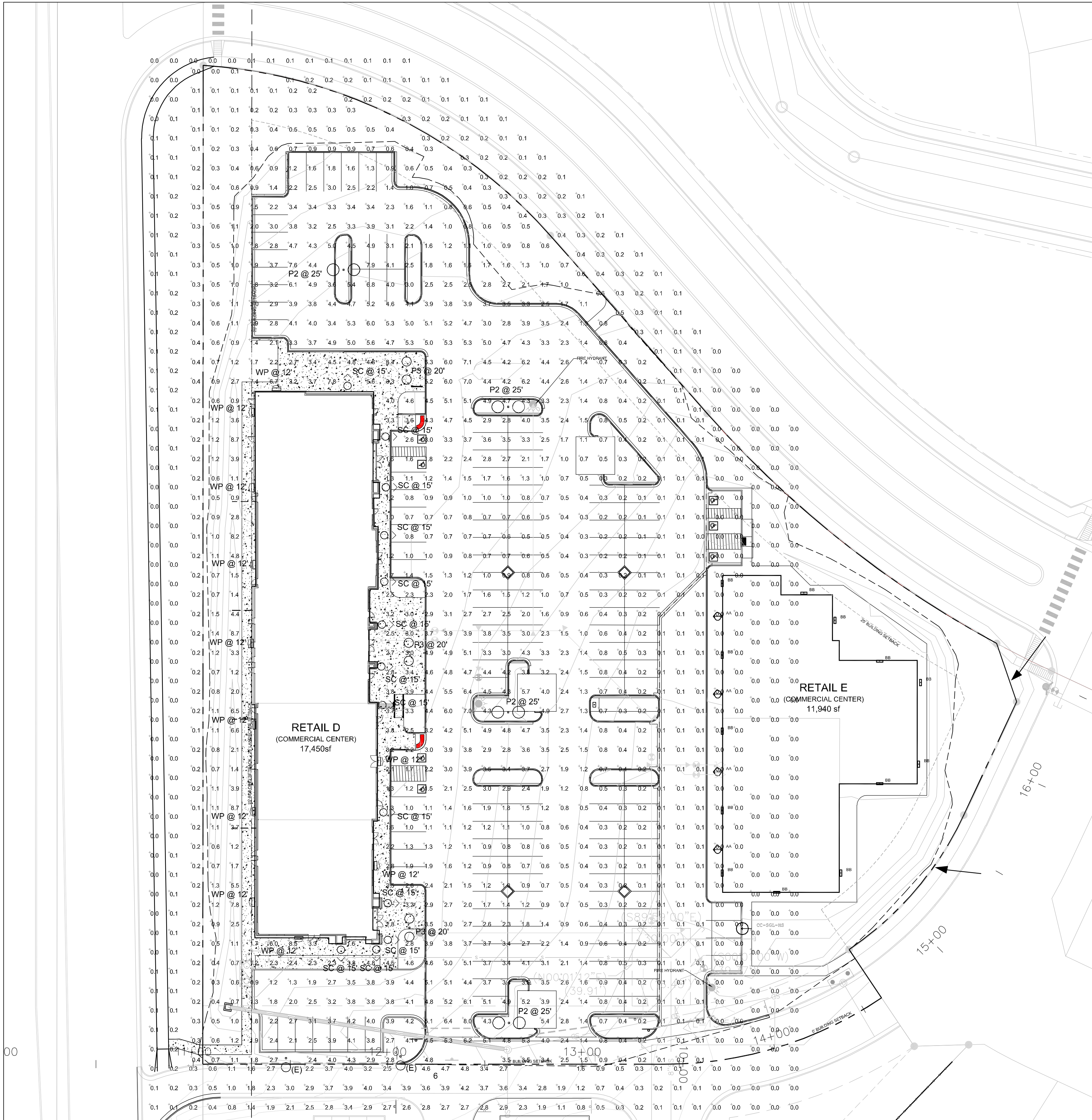

Symbol	Qty	Label	Arrangement	Total Lamp Lumens	LLF	Description	Lum. Watts	Total Watts
AA	15	AA	SINGLE	0.900		UCS-STR-12LED-NW	28.9	28.9
BB	23	BB	SINGLE	0.900		VWPH-L30-730-T3-SDGL-OPT-EDD-UNW	35.7	35.7
AA-DBL	2	AA-DBL	BACK-BACK	0.900		2B/CC253P70-96L4K	216.9	1735.2
AA-SGL	1	AA-SGL	SINGLE	0.900		1A/CC253P70-96L4K	216.9	650.7
BB-VE	7	BB-VE	BACK-BACK	0.900		2-UCM-ANG-T3-32LED-4K-700-AWT	71.3	998.2001

**KIM LIGHTING** 25" Arm  
Job Name: Meridian Ranch  
Type: AA-DBL  
Cat. No.: CC25A-DPTD-96L4K-DB-NFO  
Mount: CCS-STR-12LED-NW

**REQUIREMENTS**  
• 1/2" depth  
• 1/2" depth  
• 1/2" depth

**FEATURES**  
• Type 1, 2, 3, 4, 5, 6, 7, 8, 9, 10, 11, 12, 13, 14, 15, 16, 17, 18, 19, 20, 21, 22, 23, 24, 25, 26, 27, 28, 29, 30, 31, 32, 33, 34, 35, 36, 37, 38, 39, 40, 41, 42, 43, 44, 45, 46, 47, 48, 49, 50, 51, 52, 53, 54, 55, 56, 57, 58, 59, 60, 61, 62, 63, 64, 65, 66, 67, 68, 69, 70, 71, 72, 73, 74, 75, 76, 77, 78, 79, 80, 81, 82, 83, 84, 85, 86, 87, 88, 89, 90, 91, 92, 93, 94, 95, 96, 97, 98, 99, 100

**ORDERING CODE**

**KIM LIGHTING** 25" Arm  
Job Name: Meridian Ranch  
Type: AA-DBL  
Cat. No.: CC25A-DPTD-96L4K-DB-NFO  
Mount: CCS-STR-12LED-NW

**REQUIREMENTS**  
• 1/2" depth  
• 1/2" depth  
• 1/2" depth

**FEATURES**  
• Type 1, 2, 3, 4, 5, 6, 7, 8, 9, 10, 11, 12, 13, 14, 15, 16, 17, 18, 19, 20, 21, 22, 23, 24, 25, 26, 27, 28, 29, 30, 31, 32, 33, 34, 35, 36, 37, 38, 39, 40, 41, 42, 43, 44, 45, 46, 47, 48, 49, 50, 51, 52, 53, 54, 55, 56, 57, 58, 59, 60, 61, 62, 63, 64, 65, 66, 67, 68, 69, 70, 71, 72, 73, 74, 75, 76, 77, 78, 79, 80, 81, 82, 83, 84, 85, 86, 87, 88, 89, 90, 91, 92, 93, 94, 95, 96, 97, 98, 99, 100

**ORDERING CODE**

**KIM LIGHTING** 25" Arm Mounted, Curvilinear, Pico/Pro-LED  
Job Name: Meridian Ranch  
Type: AA-DBL  
Cat. No.: CC/CCS25  
Mount: CCS-STR-12LED-NW

**Standard Features**  
• Use Type III on Phase II

**Mounting**  
• 2" depth  
• 2" depth

**Features**  
• Type 1, 2, 3, 4, 5, 6, 7, 8, 9, 10, 11, 12, 13, 14, 15, 16, 17, 18, 19, 20, 21, 22, 23, 24, 25, 26, 27, 28, 29, 30, 31, 32, 33, 34, 35, 36, 37, 38, 39, 40, 41, 42, 43, 44, 45, 46, 47, 48, 49, 50, 51, 52, 53, 54, 55, 56, 57, 58, 59, 60, 61, 62, 63, 64, 65, 66, 67, 68, 69, 70, 71, 72, 73, 74, 75, 76, 77, 78, 79, 80, 81, 82, 83, 84, 85, 86, 87, 88, 89, 90, 91, 92, 93, 94, 95, 96, 97, 98, 99, 100

**Electrical Module**  
• Type 1, 2, 3, 4, 5, 6, 7, 8, 9, 10, 11, 12, 13, 14, 15, 16, 17, 18, 19, 20, 21, 22, 23, 24, 25, 26, 27, 28, 29, 30, 31, 32, 33, 34, 35, 36, 37, 38, 39, 40, 41, 42, 43, 44, 45, 46, 47, 48, 49, 50, 51, 52, 53, 54, 55, 56, 57, 58, 59, 60, 61, 62, 63, 64, 65, 66, 67, 68, 69, 70, 71, 72, 73, 74, 75, 76, 77, 78, 79, 80, 81, 82, 83, 84, 85, 86, 87, 88, 89, 90, 91, 92, 93, 94, 95, 96, 97, 98, 99, 100

**KIM LIGHTING** 25" Arm  
Job Name: Meridian Ranch  
Type: BB-VE  
Cat. No.: CC25A-DPTD-96L4K-DB-NFO  
Mount: CCS-STR-12LED-NW

**REQUIREMENTS**  
• 1/2" depth  
• 1/2" depth  
• 1/2" depth

**FEATURES**  
• Type 1, 2, 3, 4, 5, 6, 7, 8, 9, 10, 11, 12, 13, 14, 15, 16, 17, 18, 19, 20, 21, 22, 23, 24, 25, 26, 27, 28, 29, 30, 31, 32, 33, 34, 35, 36, 37, 38, 39, 40, 41, 42, 43, 44, 45, 46, 47, 48, 49, 50, 51, 52, 53, 54, 55, 56, 57, 58, 59, 60, 61, 62, 63, 64, 65, 66, 67, 68, 69, 70, 71, 72, 73, 74, 75, 76, 77, 78, 79, 80, 81, 82, 83, 84, 85, 86, 87, 88, 89, 90, 91, 92, 93, 94, 95, 96, 97, 98, 99, 100

**ORDERING CODE**

**KIM LIGHTING** 25" Arm  
Job Name: Meridian Ranch  
Type: AA  
Cat. No.: CC25A-DPTD-96L4K-DB-NFO  
Mount: CCS-STR-12LED-NW

**REQUIREMENTS**  
• 1/2" depth  
• 1/2" depth  
• 1/2" depth

**FEATURES**  
• Type 1, 2, 3, 4, 5, 6, 7, 8, 9, 10, 11, 12, 13, 14, 15, 16, 17, 18, 19, 20, 21, 22, 23, 24, 25, 26, 27, 28, 29, 30, 31, 32, 33, 34, 35, 36, 37, 38, 39, 40, 41, 42, 43, 44, 45, 46, 47, 48, 49, 50, 51, 52, 53, 54, 55, 56, 57, 58, 59, 60, 61, 62, 63, 64, 65, 66, 67, 68, 69, 70, 71, 72, 73, 74, 75, 76, 77, 78, 79, 80, 81, 82, 83, 84, 85, 86, 87, 88, 89, 90, 91, 92, 93, 94, 95, 96, 97, 98, 99, 100

**ORDERING CODE**

**KIM LIGHTING** 25" Arm  
Job Name: Meridian Ranch  
Type: BB  
Cat. No.: CC25A-DPTD-96L4K-DB-NFO  
Mount: CCS-STR-12LED-NW

**REQUIREMENTS**  
• 1/2" depth  
• 1/2" depth  
• 1/2" depth

**FEATURES**  
• Type 1, 2, 3, 4, 5, 6, 7, 8, 9, 10, 11, 12, 13, 14, 15, 16, 17, 18, 19, 20, 21, 22, 23, 24, 25, 26, 27, 28, 29, 30, 31, 32, 33, 34, 35, 36, 37, 38, 39, 40, 41, 42, 43, 44, 45, 46, 47, 48, 49, 50, 51, 52, 53, 54, 55, 56, 57, 58, 59, 60, 61, 62, 63, 64, 65, 66, 67, 68, 69, 70, 71, 72, 73, 74, 75, 76, 77, 78, 79, 80, 81, 82, 83, 84, 85, 86, 87, 88, 89, 90, 91, 92, 93, 94, 95, 96, 97, 98, 99, 100

**ORDERING CODE**

**OWNER INFO**  
company name: SHOPS AT MERIDIAN RANCH LLC  
address/city/state: P.O. BOX 80036 SAN DIEGO CA 91288  
phone no:



**YOW ARCHITECTS PC**  
ARCHITECTURE & PLANNING  
115 S. Weber Colorado Springs, Colorado 475-8133

Structural:  
Electrical:  
Mechanical:  
Plumbing:

**Shop's @ Meridian Ranch**  
Site Development Plan  
Meridian Road  
Falcon, CO

Job No: 18-113  
Directory: Planning  
File: Site Development plan-449-19  
Drawn By: DBN  
Date: 6/22/2018  
Revised: 10/4/2018  
11/28/2018  
4/8/2019

DRAWING NO.  
**4**  
PHOTOMETRIC PLAN