



COMMISSIONERS:  
MARK WALLER (CHAIR)  
LONGINOS GONZALEZ, JR. (VICE-CHAIR)

HOLLY WILLIAMS  
STAN VANDERWERF  
CAMI BREMER

Mailed 6/23/20  
TL

PLANNING AND COMMUNITY DEVELOPMENT DEPARTMENT  
CRAIG DOSSEY, EXECUTIVE DIRECTOR

June 22, 2020

RE: Administrative Special Use Request for 1425 Burnham Street Workzone Special Use

File: AL-19-006

Parcel ID: 65102-14-001, 6510214018

To Whom It May Concern:

This letter is to inform property owners adjacent to 1425 Burnham Street that they have requested a special use to allow for a contractor's equipment yard within the CS (Commercial Community) zoning district. The Planning and Community Development Director may make a formal decision regarding the request on July 8, 2020 at 4:30 P.M. Any comments or questions may be forwarded to me prior to that decision. At the discretion of the Planning and Community Development Director, the approval process may be elevated to the Board of County Commissioners for consideration. Administrative approval by the Planning and Community Development Director is subject to the appeal provisions of the Land Development Code.

You may view the application documents online at [www.epcdevplanreview.com](http://www.epcdevplanreview.com). Please feel free to contact me with any questions, comments, or concerns you may have prior to the decision.

Respectfully,

Gabe Sevigny, Planner II  
El Paso County Planning and Community Development  
719-520-7943  
[gabesevigny@elpasoco.com](mailto:gabesevigny@elpasoco.com)

2880 INTERNATIONAL CIRCLE, SUITE 110  
PHONE: (719) 520-6300



COLORADO SPRINGS, CO 80910-3127  
FAX: (719) 520-6695

[WWW.ELPASOCO.COM](http://WWW.ELPASOCO.COM)



6510214001  
RAJ  
LLC

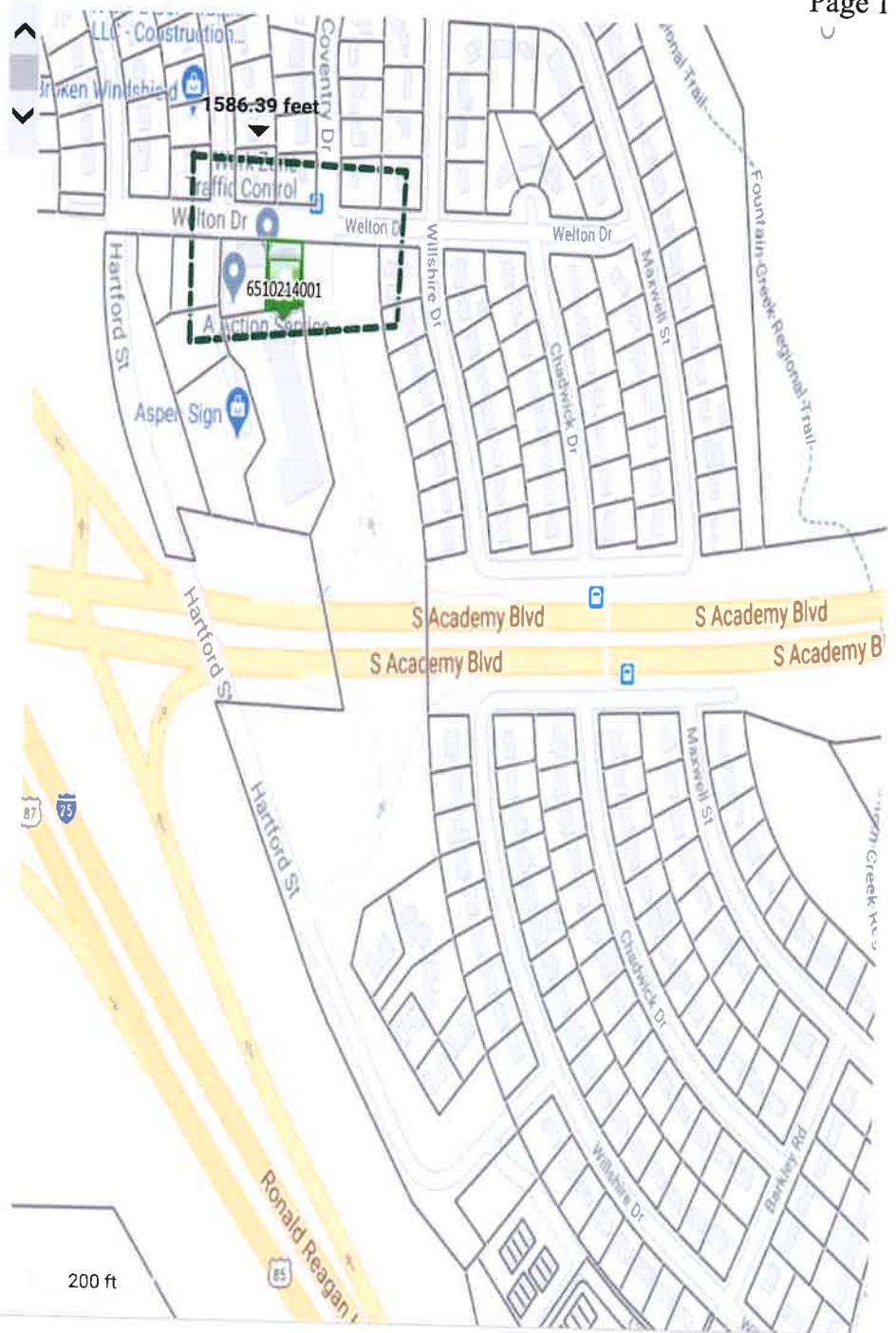

Disclaimer

We have made a good-faith effort to provide you with the most recent and most accurate information available. However, if you need to use this information in any legal or official venue, you will need to obtain official copies from the Assessor's Office. Do be aware that this data is subject to change on a daily basis. If you believe that any of this information is incorrect, please call us at (719) 520-6600.

GREBENIK DOYLE  
1280 FOOTHILLS FAR WAY  
COLORADO SPRINGS CO 80921-3954

ADAMS JOSHUA LEE  
1305 BURNHAM ST  
COLORADO SPRINGS CO 80906-5604

LANZAS JUANA ESMERALDA  
1307 BURNHAM ST  
COLORADO SPRINGS CO 80906-5604

THOMAS ARLINDA K  
1306 COVENTRY DR  
COLORADO SPRINGS CO 80906-5611

OLIPHANT BURTON PAUL  
1308 COVENTRY DR  
COLORADO SPRINGS CO 80906-5611

GARIBAY JOSHUA  
1309 BURNHAM ST  
COLORADO SPRINGS CO 80906-5604

FAIRBANKS CHESTER E JR  
1311 BURNHAM ST  
COLORADO SPRINGS CO 80906-5604

ANAYA SANDRA NOAMI  
1310 COVENTRY DR  
COLORADO SPRINGS CO 80906-5611

SAWALL NANCY L  
1312 COVENTRY DR  
COLORADO SPRINGS CO 80906

SOTO BRENDA L  
1313 BURNHAM ST  
COLORADO SPRINGS CO 80906-5604

GREBENIK DOYLE  
1280 FOOTHILLS FARM WAY  
COLORADO SPRINGS CO 80921-3954

SOCHOVKA REBECCA A  
1305 HARTFORD ST  
COLORADO SPRINGS CO 80906-5614

MARTINEZ STEFANIE T  
1308 BURNHAM ST  
COLORADO SPRINGS CO 80906-5605

THEISEN TIFFANY DAWN  
4534 ADIEU CIR  
COLORADO SPRINGS CO 80917-2508

PORTERA FRANKIE  
1101 CAMBRIDGE AVE  
COLORADO SPRINGS CO 80906-5510

ZUBIA DAMASO G LEDEZMA  
1307 HARTFORD ST  
COLORADO SPRINGS CO 80906-5614

GRAVES TIMOTHY DESHAUN  
1309 HARTFORD ST  
COLORADO SPRINGS CO 80906-5614

DEHAAN STEPHAN MARK  
1302 WILLSHIRE DR  
COLORADO SPRINGS CO 80906-5628

RICHARDSON WILLIAM M  
1308 MAXWELL ST  
COLORADO SPRINGS CO 80906-5634

RASMUSSEN ANDREA  
PO BOX 4232  
WOODLAND PARK CO 80866-4232

PAXTON RONALD R  
1304 WILLSHIRE DR  
COLORADO SPRINGS CO 80906-5628

REID-BRYAN DEBRA A  
1306 WILLSHIRE DR  
COLORADO SPRINGS CO 80906-5628

GARCIA FREDIA M  
1305 COVENTRY DR  
COLORADO SPRINGS CO 80906-5610

DERIEUX IAN M  
1307 COVENTRY DR  
COLORADO SPRINGS CO 80906-5610

VERIGAN WILLIAM R  
1308 WILLSHIRE DR  
COLORADO SPRINGS CO 80906-5628

DEMAREE LISA M  
1418 EAGLE VIEW DR  
COLORADO SPRINGS CO 80909-2918

CYPRIAN L TANYA  
1305 WILLSHIRE DR  
COLORADO SPRINGS CO 80906-5627

DUKES JOSEPH ORLANDO II  
1307 WILLSHIRE DR  
COLORADO SPRINGS CO 80906-5627

EL PASO COUNTY  
200 S CASCADE AVE STE 150  
COLORADO SPRINGS CO 80903

EL PASO COUNTY  
200 S CASCADE AVE STE 150  
COLORADO SPRINGS CO 80903

IDLEMAN JAMES L  
1401 WILLSHIRE DR  
COLORADO SPRINGS CO 80906-5629

WITCHER GERALD E  
1403 WILLSHIRE DR  
COLORADO SPRINGS CO 80906-5629

GREBENIK MICHAEL R  
6055 LEON YOUNG DR  
COLORADO SPRINGS CO 80924-2035

PELUSO THOMAS E  
1402 WILLSHIRE DR  
COLORADO SPRINGS CO 80906-5630

TALAIN CESAR C  
7808 MCLAUGHLIN RD  
PEYTON CO 80831-6123

BOWSER RANDEE L  
1406 WILLSHIRE DR  
COLORADO SPRINGS CO 80906-5630

QUIJANO PAULA MILENA MOLANO  
1408 WILLSHIRE DR  
COLORADO SPRINGS CO 80906-5630

WEAVER CRAIG L  
1410 WILLSHIRE DR  
COLORADO SPRINGS CO 80906-5630

TRUJILLO LEROY B  
12645 W CRESTINE AVE  
LITTLETON CO 80127

~~RAJ LLC  
1115 FIR ST  
PUEBLO CO 81001-4508~~

~~CIMARRON MOUNTAIN PROPERTIES  
LLC  
1454 BURNHAM ST  
COLORADO SPRINGS CO 80906-5640~~

~~CIMARRON MOUNTAIN PROPERTIES  
LLC  
1454 BURNHAM ST  
COLORADO SPRINGS CO 80906-5640~~

~~CIMARRON MOUNTAIN PROPERTIES  
LLC  
1454 BURNHAM ST  
COLORADO SPRINGS CO 80906-5640~~

~~CIMARRON MOUNTAIN PROPERTIES  
LLC  
1454 BURNHAM ST  
COLORADO SPRINGS CO 80906-5640~~

~~BURNHAM PARTNERS LLC  
PO BOX 60280  
COLORADO SPRINGS CO 80960-0280~~

RAJ LLC  
1115 FIR ST  
PUEBLO CO 81001-4508