

4/25/2022 10:16:47 AM mitchell plant
c:\projects\2022\22037 fall mountain farm site plan\2 drawings\3.4 electrical\22037.dwg

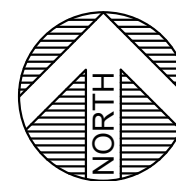
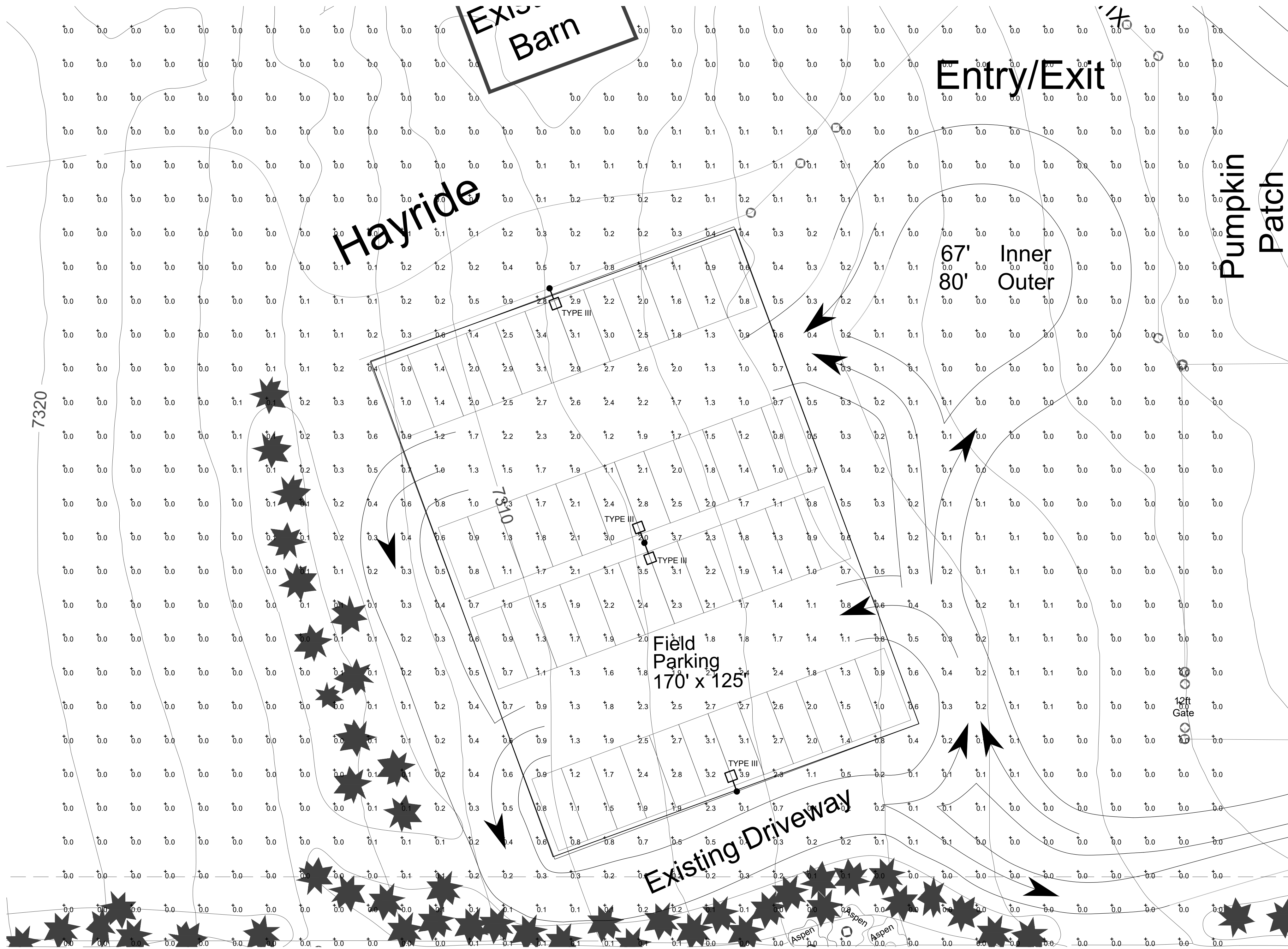

ELECTRICAL PHOTOMETRIC SITE PLAN

SCALE: 1" = 20'-0"

Calculation Summary							
Label	CalcType	Units	Avg	Max	Min	Avg/Min	Max/Min
Site	Illuminance	Fc	0.32	3.9	0.0	N.A.	N.A.
Field Parking	Illuminance	Fc	1.72	3.9	0.5	3.44	7.80

Luminaire Schedule								
Symbol	Qty	Label	Arrangement	Description	LLF	Luminaire Lumens	Luminaire Watts	Total Watts
➡➡	2	DSX1_LED_P3_40K_T3M_MVOLT_HS	Single	DSX1 LED P3 40K T3M MVOLT HS	0.850	9898	102	204
➡➡➡	1	DSX1_LED_P3_40K_T5W_MVOLT	Back-Back	DSX1 LED P3 40K T5W MVOLT	0.850	12968	102	204

GENERAL PHOTOMETRY NOTES

- THESE PHOTOMETRIC CALCULATIONS ARE BASED ON MANUFACTURER'S IES FILES AND 0.85 LIGHT DEPRECIATION FACTOR.
- ACTUAL ILLUMINANCE LEVELS MAY DIFFER FROM THE FOOTCANDLE LEVELS SHOWN DUE TO VARIABLE FIELD CONDITIONS, SUCH AS NEARBY EXISTING LUMINAIRES, LUMINAIRE DIRT DEPRECIATION, LANDSCAPING, AND FUTURE DEVELOPMENTS.
- THIS PLAN IS BASED ON THE INFORMATION AVAILABLE. THE LUMINAIRE LOCATIONS SHOWN MUST BE COORDINATED WITH EXISTING OR FUTURE FIELD CONDITIONS.

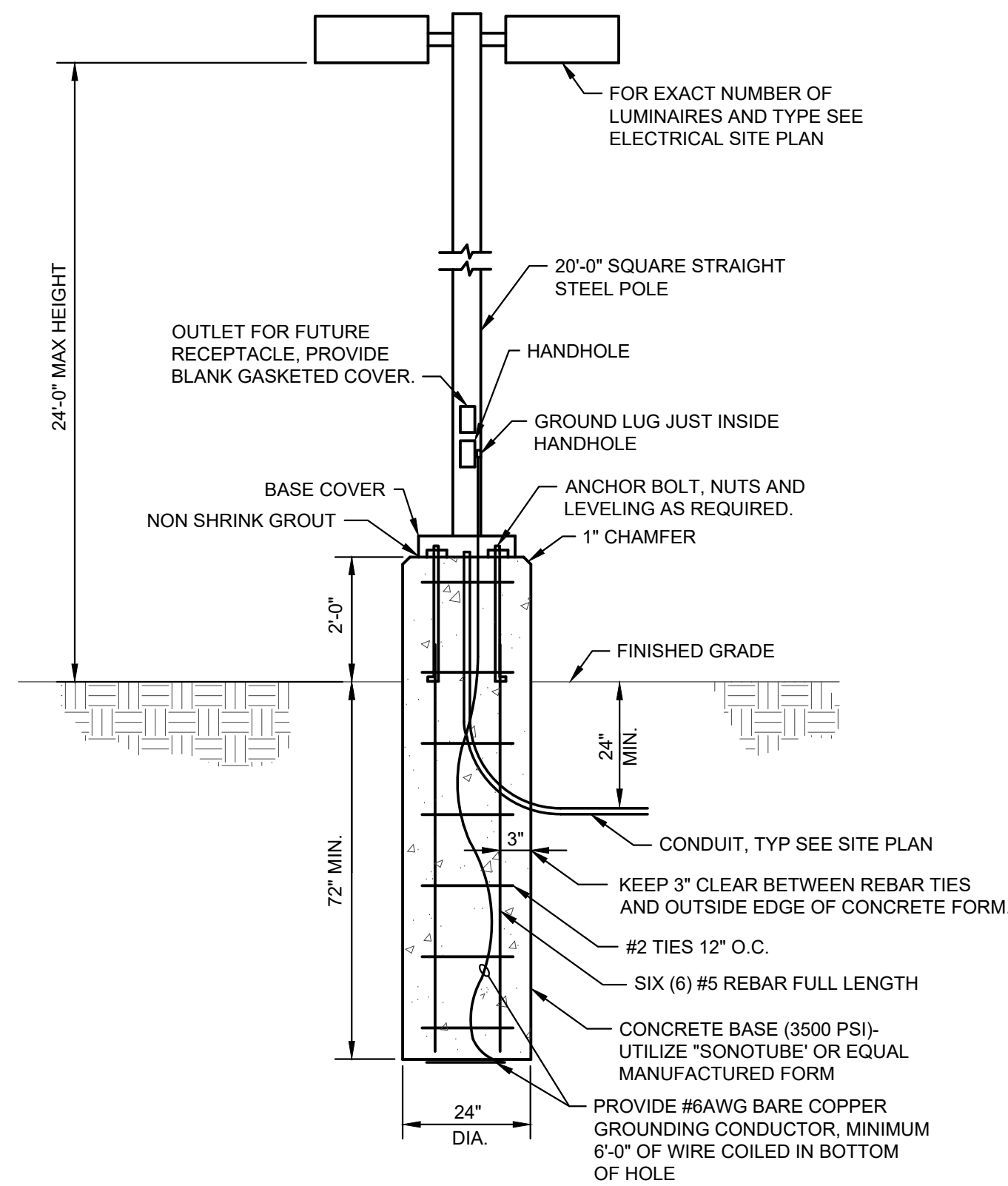

1 POLE BASE DETAIL

NOT TO SCALE

FALL MOUNTAIN FARM DEVELOPMENT PHOTOMETRIC SITE PLAN

16300 MOUNT HERMAN, MONUMENT, CO 80132

REVISIONS	DATE	COMMENT
MARK	04/22/2022	ISSUE FOR PLANNING REVIEW

ELECTRICAL PHOTOMETRIC SITE PLAN

© COPYRIGHT 2022 ALL DRAWN & WRITTEN INFORMATION APPEARING HEREIN SHALL NOT BE DUPLICATED, DISCLOSED OR OTHERWISE USED WITHOUT WRITTEN CONSENT OF PLANT ENGINEERING CONSULTANTS.

PROJECT	22037
DATE	04/22/2022
DRAWN	RSM
CHECKED	MPP

SHEET

DP1



PLANT
ENGINEERING CONSULTANTS
320 W FILLMORE SUITE 100 COLORADO SPRINGS CO 80907
719 473 7077
www.planted.com



The outstanding photometric performance results in sites with excellent uniformity, greater pole spacing and lower power density. It is ideal for replacing up to 750W metal halide in pedestrian and area lighting applications with typical energy savings of 65% and expected service life of over 100,000 hours.

DSX1-LED
Rev. 07/19/21
Page 1 of 8

One Lithonia Way • Conyers, Georgia 30012 • Phone: 1-800-705-SERV (7378) • www.lithonia.com
© 2011-2021 Acuity Brands Lighting, Inc. All rights reserved.

[illegible]

One Lithonia Way • Conyers, Georgia 30012 • Phone: 1-800-705-SERV (7378) • www.lithonia.com
© 2011-2021 Acuity Brands Lighting, Inc. All rights reserved.

One Lithonia Way • Conyers, Georgia 30012 • Phone: 1-800-705-SERV (7378) • www.lithonia.com
© 2011-2021 Acuity Brands Lighting, Inc. All rights reserved.

One Lithonia Way • Conyers, Georgia 30012 • Phone: 1-800-705-SERV (7378) • www.lithonia.com
© 2011-2021 Acuity Brands Lighting, Inc. All rights reserved.

One Lithonia Way • Conyers, Georgia 30012 • Phone: 1-800-705-SERV (7378) • www.lithonia.com
© 2011-2021 Acuity Brands Lighting, Inc. All rights reserved.