

**Notice to Mineral Estate Owners**  
**§24-65.5-101, et seq., C.R.S. – Checklist and Certification**

**An examination of the records of the Clerk and Recorder's Office established the following:**

**Checklist**

- \_\_\_\_\_ identity of the owner(s) of mineral estate
- \_\_\_\_\_ the mineral estate owner(s) has filed a proper notification form
- \_\_\_\_\_ the mineral estate owner(s) has recorded an instrument satisfying an applicable dormant mineral interest act
- \_\_\_\_\_ no mineral estate owner(s) was found
- \_\_\_\_\_ mineral owner(s) waived the right to notice in writing to the Applicant.

**If a mineral estate owner(s) exists, a Notice shall be sent to the mineral estate owner no less than thirty (30) days prior to the initial public hearing. The Notice shall include:**

- \_\_\_\_\_ time and place of initial public hearing
- \_\_\_\_\_ nature of hearing
- \_\_\_\_\_ location of property/subject of hearing
- \_\_\_\_\_ name of applicant
- \_\_\_\_\_ notice was sent to mineral estate owner(s) no less than thirty (30) days prior to initial public hearing (do not count day of mailing in thirty (30) day calculation).

**If a mineral estate owner(s) exists, a copy of the Notice shall be sent to the local government at the same time as notice s mailed to the mineral owner(s) and no less than thirty (30) days prior to the initial public hearing. The Notice shall include:**

- \_\_\_\_\_ time and place of initial public hearing
- \_\_\_\_\_ nature of hearing
- \_\_\_\_\_ location of property/subject of hearing
- \_\_\_\_\_ name of applicant
- \_\_\_\_\_ name and address of mineral estate owner
- \_\_\_\_\_ notice was sent to El Paso County Planning Department no less than thirty (30) days prior to initial public hearing (do not count day of mailing in thirty (30) day calculation).

**CERTIFICATION:**

I CRIS CLOTHIER researched the records of the El Paso County Clerk and Recorder and established that there was/was not a mineral estate owner(s) on the real property known as 6035 SIOUX TRAIL CHIPITA PARK CO 80809 An initial public hearing on \_\_\_\_\_ which is the subject of the hearing, is scheduled for \_\_\_\_\_, 2018.

Pursuant to §24-65.5-103(4), C.R.S., I certify that a Notice of an initial public hearing was mailed to the mineral estate owner(s) (if established above) and a copy was mailed to the El Paso County Planning Department on \_\_\_\_\_, 2018.

Dated this 10<sup>TH</sup> day of OCTOBER, ~~2010~~ 2018

CRIS CLOTHIER

Signature

STATE OF COLORADO )  
  ) s.s.  
COUNTY OF EL PASO )

The foregoing certification was acknowledged before me this 10<sup>th</sup> day of October, 2018, by Cris Clothier

Witness my hand and official seal.

My Commission Expires: 09/02/2020

Petra Rangel  
Notary Public

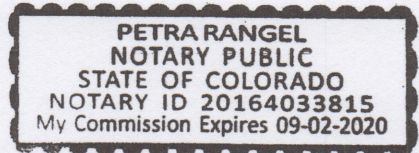

EL PASO COUNTY ENVIRONMENTAL HEALTH SERVICES *replacement*  
301 South Union Boulevard Colorado Springs, CO 80910-3123

APPLICATION FOR A NEW REMODEL, REPAIR, OR ADDITION  
TO AN INDIVIDUAL SEWAGE DISPOSAL SYSTEM

Owner JERRY & Lois Koepfen Phone (316) 326-5672 Kans.  
(719) 684-2040 Colo.  
Address of Property 6035 Sioux TR. <sup>Chippin Park</sup> Lot Size 19' 400 sq ft Water Supply City  
Tax Sch # 8316-03-014 Septic Contractor & Phone # Kaye Armentrout 687-0502  
Legal Description Attached  
Type of Building 2 Bed Home Owner's Mailing Address P.O. Box #6 Wellington, Kans 67152

MAXIMUM POTENTIAL BEDROOMS	<u>2 Bedrooms</u>						
Basement	<input checked="" type="radio"/> N	Percolation Test Attached	<input checked="" type="radio"/> N	Garbage Disposal	<input checked="" type="radio"/> N	Clothes Washer	<input checked="" type="radio"/> N

I have supplied a plot plan as described on the back of this form. I acknowledge the completeness of the application is conditional upon such further mandatory and additional tests and reports as may be required by the Department to be made and furnished by a applicant for purposes of evaluating the application, and issuance of the permit is subject to such terms and conditions as deemed necessary to ensure compliance with rules and regulations adopted pursuant to C.R. 10-25-101 et. seq. I hereby certify all represented to be true and correct to the best of my knowledge and belief, and are designed to be relied on by the El Paso County Department of Health and Environment in evaluating the application and in legal action for perjury as provided for herein. I further understand any falsification or misrepresentation may result in the denial of the application or revocation of any permit granted based upon said application.

OWNER'S SIGNATURE Jerry Koepfen Date 11-10-97 *10/10/97*

DEPARTMENT OF HEALTH USE ONLY		
Absorption Area	Tank Capacity	Date of Site Inspection
<u>322</u>	<u>1000</u>	<u>10/21/97</u>

REMARKS: Install per EPCRD regulation. Profile to be inspected by engineer + soil description supplied to this office at time of installation.

EHS INSPECTOR [Signature] Date 5/20/97 *pending BOA*  
 APPROVED  DENIED  
PERMIT # 11866 FEE NO FEE DATE TO EPC PLANNING DEPT 10-15-97  
Check # 7114 2/25/98 *(owner walking to Sharon) 10/24/97 at planners*

Acres 18,400-99 ft. **EL PASO COUNTY • DEPARTMENT OF HEALTH AND ENVIRONMENT**  
City 301, South Union Blvd. • Colorado Springs, Colorado • 578-3125 Permit 11065  
 Water Supply \_\_\_\_\_

**PERMIT**

**TO CONSTRUCT, ALTER, REPAIR OR MODIFY ANY INDIVIDUAL SEWAGE DISPOSAL SYSTEM**

Issued to JERRY & LOIS KOEPPEN Date 10-22-97 Receipt No. 687-0502  
 Address of Property 6035 SIOUX TRAIL, PARTS OF LOTS 4, 5, 6, CHIPITA PARK Phone 684-2040

(Permit valid at this address only)  
KAYO ARMENTROUT

Sewage-Disposal System work to be performed by \_\_\_\_\_ Phone 687-0502  
 This Permit is issued in accordance with 25-10-106 Colorado Revised Statutes 1973, as amended. PERMIT EXPIRES upon completion of installation of sewage-disposal system or at the end of twelve (12) months from date of issue—whichever occurs first—(unless work is in progress). This permit is revokable if all stated requirements are not met.

**- THIS PERMIT DOES NOT DENOTE APPROVAL OF ZONING AND ACREAGE REQUIREMENTS -**

\$245.00  
 PERMIT FEE (NOT REFUNDABLE)

10-22-98  
 DATE OF EXPIRATION

Steve J. Eustader, HD  
 DIRECTOR, DEPARTMENT OF HEALTH AND ENVIRONMENT  
Steve J. Eustader - 578-3143  
 ENVIRONMENTALIST

NOTE: LEAVE ENTIRE SEWAGE-DISPOSAL SYSTEM UNCOVERED FOR FINAL INSPECTION. 48 HOUR ADVANCE NOTICE REQUIRED.	
SEPTIC TANK: <u>1000</u> gallons	BED SYSTEM: _____
total square feet _____	total square feet _____
_____ ft. of trench _____ inches wide	_____ rings or _____ diam. x _____ w/d
_____ ft. of trench _____ inches wide	SEE PAGE PIT SYSTEM: _____

**NOTES: INSTALL PER EL PASO COUNTY DEPT. OF HEALTH & ENVIRONMENT. PROFILE HOLE TO BE INSECTED BY ENGINEER AND SOIL DESCRIPTION SUPPLIED TO THIS OFFICE AT TIME OF INSTALLATION.**

The Health Office shall assume no responsibility in case of failure or inadequacy of a sewage-disposal system, beyond consulting in good faith with the property owner or representative. Free access to the property shall be authorized at reasonable time for the purpose of making such inspections as are necessary to determine compliance with requirements of this law.

We require the ORIGINAL of your percolation (PERC) TEST.

The following information must be on your PLOT PLAN.

Property lines

Proposed septic system site

Well(s)

Building(s)

Water line

Subsoil drain(s)

Property dimensions

Designated alternate septic system site

Adjacent property well(s)

Proposed building(s)

Cistern

If any of these are within 100 feet of your proposed septic system include on your plot plan

Spring(s)

Pond(s)

Dry Gulch(s)

Lake(s)

Stream(s)

Natural drainage course(s)

PROPERTY AND PERC HOLES MUST BE CLEARLY MARKED OR POSTED

GIVE COMPLETE DIRECTIONS TO THE PROPERTY FROM A MAIN HIGHWAY

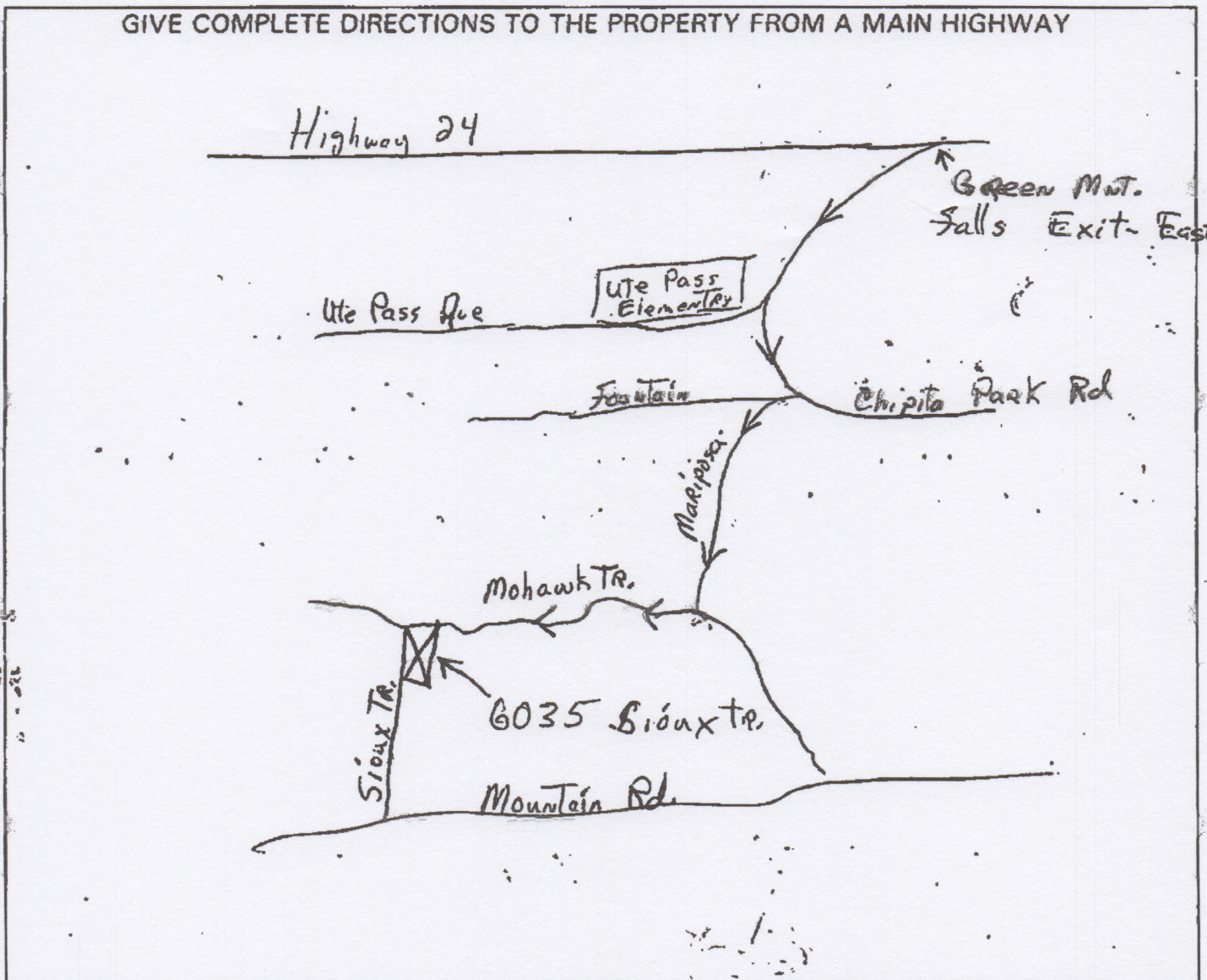

Soils Evaluation Report for Nonmun ipal Waste  
Disposal Systems Field Notes

#8316103014

6-16-98 E

Location 6035 Sioux Trail

Date 9-29-97

Applicant JERRY & LOIS KOEPPEN  
ROBERT & MARY PAYNE

County EI PASO

Hole #1 Depth of Hole 5'

Time Intervals	Inches of Water	Minute/In.
7:45 AM	36"	
7:50 AM	35	5 min
7:55 AM	34	5 min
8:00 AM	33	5 min

Soil Profile

Depth	Description
0-5"	TOP SOIL
5"-4'	DECOMPOSED GRANITE

Hole #2 Depth of Hole 8'

Time Intervals in Minutes	Inches of Water	Minute/In
8:10	48"	
8:16	47"	6 min
8:22	46"	6 min
8:28	45"	6 min

Site Layout

DEEP PROFILE  
TO BE DONE  
AT LATER DATE

Hole #3 Depth of Hole 8'

Time Intervals	Inches of Water	Minute/In
8:30 AM	36"	
8:34 AM	35	4 min
8:38 AM	34	4 min
8:42 AM	33	4 min

Michael T. Orsillo



Depth to first ground water N.A. ft.

Depth to first impervious clay, shale or rock formation N.A. ft.

*[Signature]*  
Signature of person making test

YON#

#8316103014

EL PASO COUNTY DEPARTMENT OF HEALTH AND ENVIRONMENT  
INDIVIDUAL SEWAGE DISPOSAL SYSTEM INSPECTION FORM

Permit # 4466  
Date 6/16/98

*[Handwritten initials]*

APPROVED: YES  NO

ENVIRONMENTALIST Coitler *P*

Address 6035 Sioux Trl Owner Ferry + Lois Koeppe

Legal Description Part of Lots 4, 5 & 6, Cipita Park  
Residence , # of bedrooms 2; Commercial ; System Installer Kayo Peruch

SEPTIC TANK:  
Commercial ; Noncommercial  L     , W     , WD       
Construction Material concrete, capacity 1250 gallons.

DISPOSAL FIELD:  
Rock Systems: Arrowhead

Trench: depth     , width     , total length     , sq. feet       
Bed: depth 6'6", length 22, width 11/17, sq. feet 701

Rock type Run Rock, depth 5'6", under PVC 5', over PVC 2"

Seepage Pits: # of pits     , total # of rings     , working depth(s)       
size of pit(s) L X W     , lining material     , total sq. feet     

Rockless Systems:  
Chamber: Type     , number of chambers     , bed     , trench       
sq. ft./section     , reduction allowed     %, sq. ft required       
total sq. ft. installed     , depth of installation     

Engineer Design Y or  Designing Engineer       
Approval letter provided? Y or N

Well 50 feet from tank Y or N 100 feet from leach field Y or N

Well installed at time of septic system inspection Y or N Public Water       
\*Approval will be revoked if in the future the well is found to be within 50 feet of the septic tank and/or 100 feet of the disposal field.

NOTES: System installed to meet requirements for a 3-BE house

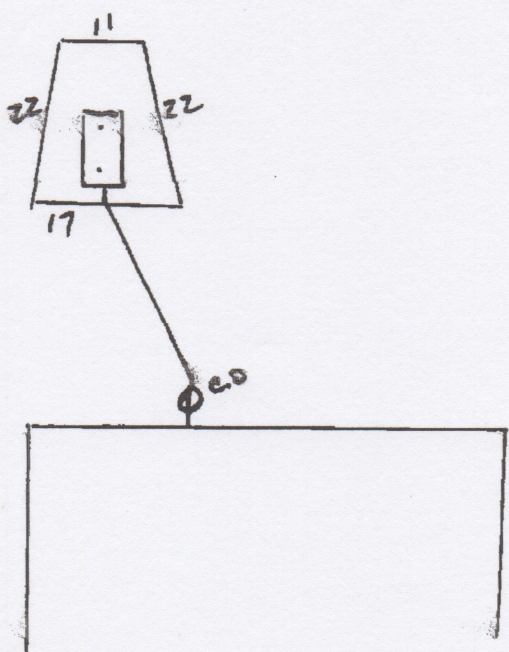
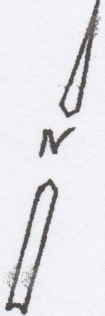

*JE*