

T*REX ARCHITEX
 146 Madison Street
 Denver, CO 80206
 303.388.2918
 DRAWN BY: CT

DRAWINGS
 Drawings and Specifications as instruments of service are and shall remain the property of the architect whether the Project for which they are made is executed or not. The Owner shall be permitted to make copies, including reproducible copies, of Drawings and Specifications for information and reference in connection with the Owner's use and occupancy of the Project. The Drawings and Specifications shall not be used by the Owner or other parties for additions to this Project or for the completion of this Project by others provided the Architect is not in default under the Agreement, except by agreement in writing and with appropriate compensation to the Architect.

PROJECT FOR
THE SOD GUY WAREHOUSE / OFFICE

DATE ISSUED
MARCH 20, 2019

DATE	ISSUED AS
----	ZD APPROVAL
----	CD PRELIMINARY / REVIEW
----	BID SETS
----	PERMIT SUBMITTED

DATE	REVISIONS
----	----
----	----
----	----
----	----
----	----
----	----
----	----
----	----
----	----
----	----

PROJECT NAME
THE SOD GUY
KURT HUGHES
 OFFICE / WAREHOUS

COUNTY OF EL PASO
 STATE OF COLORADO

A1.1
 ENLARGED PLANS

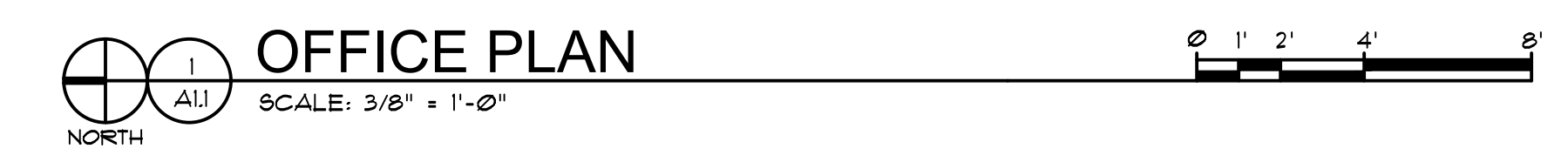
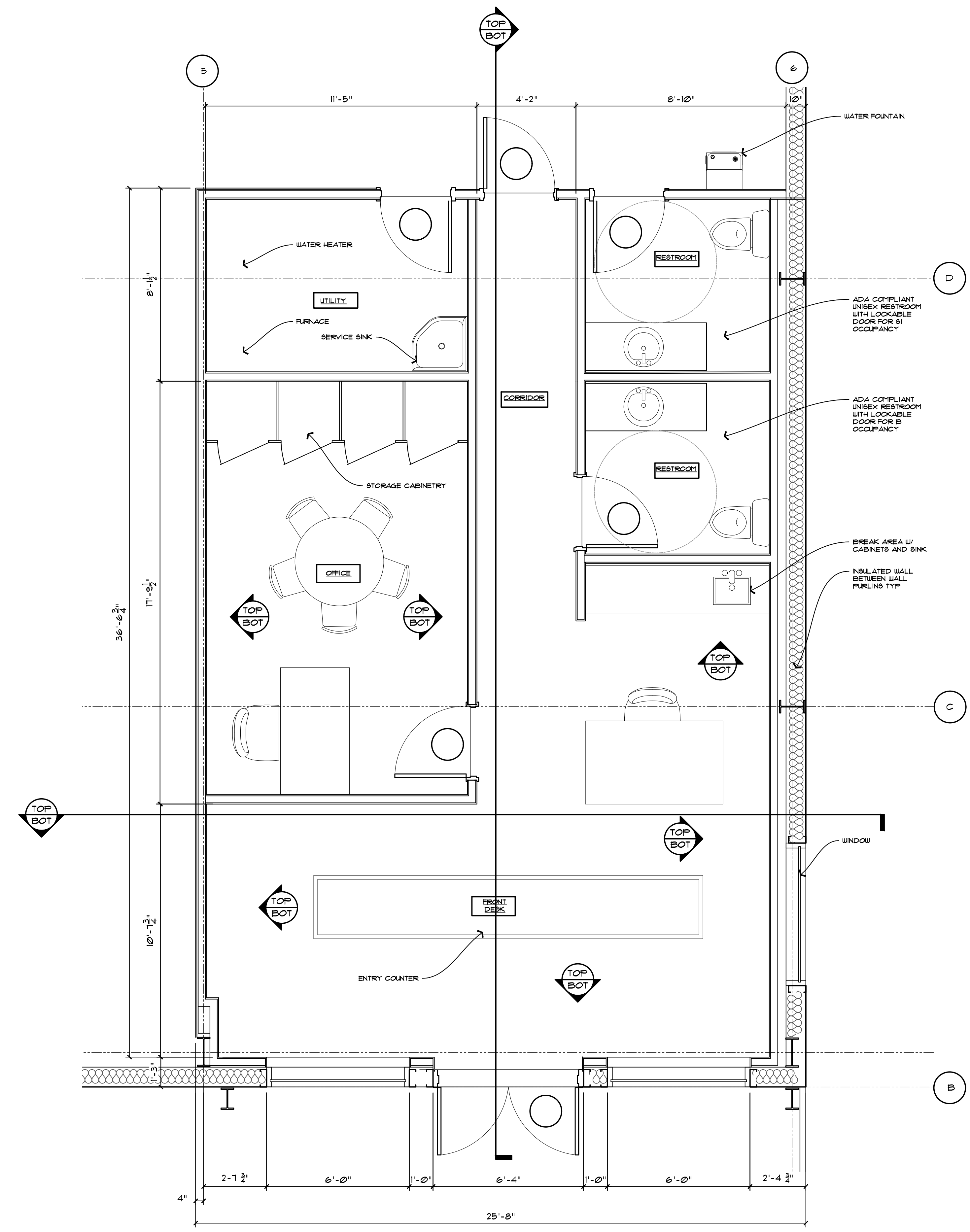

Floor Plans_v1-redline.pdf Markup Summary

Unlocked (1)

Is there a sales area?

Subject: Text Box
Page Label: [1] The Sod Guy office warehouse
CURRENT4-T1.0 (TITLE SHEET)
Lock: Unlocked
Author: dsdkendall
Date: 6/14/2019 11:57:46 AM
Status:
Color: ■
Layer:
Space:

Is there a sales area?