

IF BAR DOES NOT MEASURE ONE INCH, SCALE OF THIS DRAWING HAS BEEN ALTERED

2023/07/19 4:06 PM By: Nicholas M. Johnson\0395 IDS: Hydro\23-01 Sterling WTP\Drawing\_LIGHTING\_PLAN.dwg

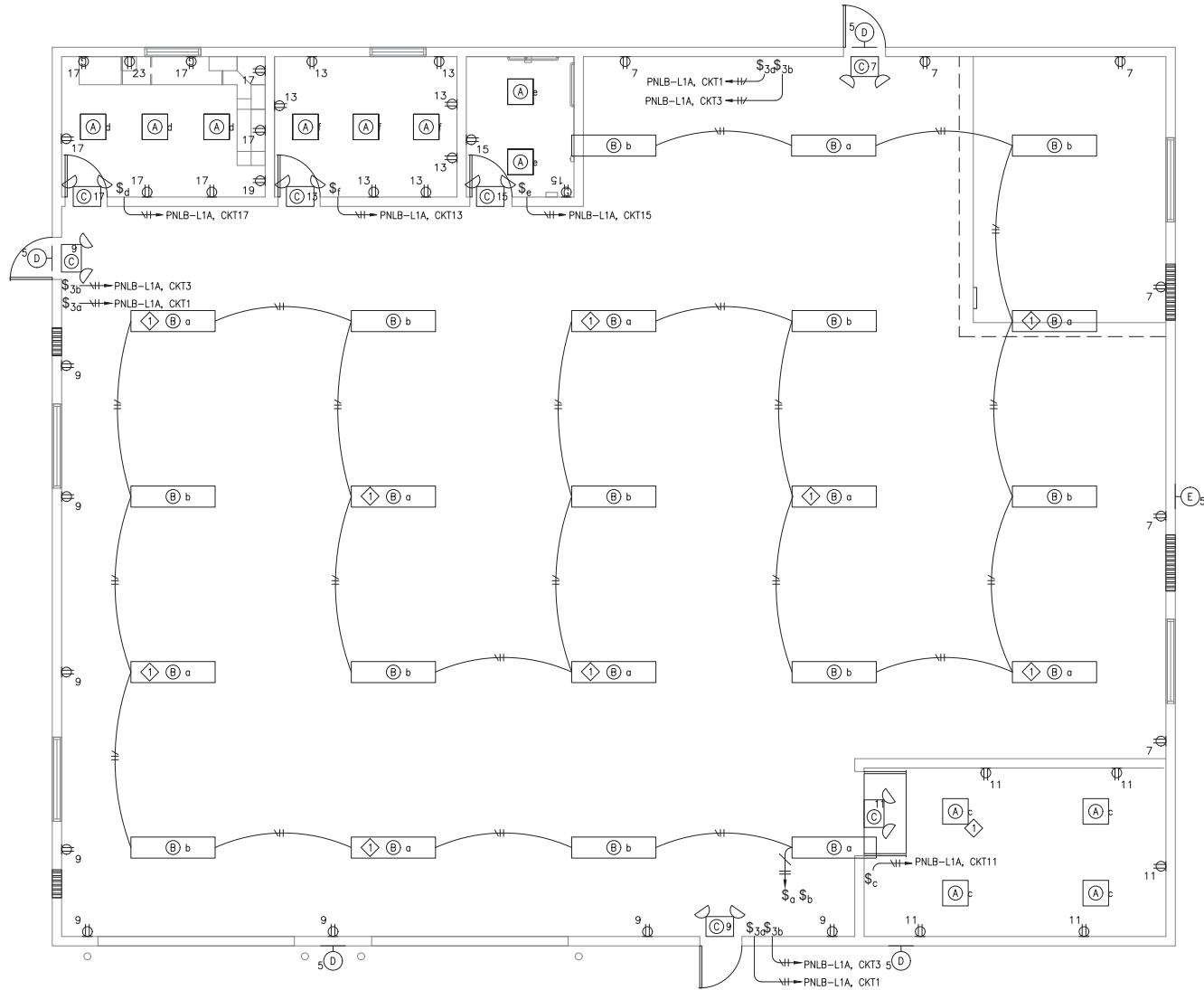

**SHEET NOTES**

1. REFER TO E3.0 FOR FIXTURE SCHEDULE
2. LIGHTING AND RECEPTACLE WIRES ARE #12AWG UNLESS NOTED OTHERWISE.
3. REFER TO CIVIL PLANS FOR BUILDING SPECIFICATIONS AND DIMENSIONS.

**KEY NOTES**

1. FIXTURE TO HAVE BATTERY BACKUP OPTION TO FUNCTION AS SECONDARY EMERGENCY LIGHTING.

**1 LIGHTING AND RECEPTACLE PLAN**  
SCALE: 1/4"=1'-0"

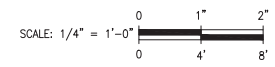

**OWNER INFORMATION:**  
FALCON AREA WATER AND WASTEWATER AUTHORITY  
2138 FLYING HORSE CLUB DR.  
COLORADO SPRINGS, CO 80921  
CONTACT: LOREN MORELAND  
PHONE: (719) 785-9270  
EMAIL: LMORELAND@CLASSICHOMES.COM

**PROPERTY ADDRESS:**  
9255 ARROYA LANE  
COLORADO SPRINGS, CO 80908  
PROJECT: 0395-23-01



1095 S FEDERAL WAY  
BOISE, IDAHO 83705  
(208) 433-9987  
(208) 426-0550 FAX

**Control Engineers**

Colorado Springs, CO  
5500 Tech Center Dr., Suite 100  
Colorado Springs, CO 80919  
www.cespa.com

**FALCON AREA WATER & WASTEWATER AUTH**  
**STERLING RANCH WATER TREATMENT PLANT**  
LIGHTING AND RECEPTACLE PLAN

NO.	DESCRIPTION	REVISIONS		DATE
		BY	APP.	
1	FOR REVIEW	ZRP	SAM	03/24/23
2	LIGHTING UPDATES	ZRP	SAM	05/03/23
3	60% DESIGN SET	NMJ	SAM	07/19/23
4				
5				
6				
7				

**PRELIMINARY**

Proj.#: W02242.22  
Date: 03/24/23  
Design: NMJ/ZRP  
Drawn: NMJ/ZRP  
Check: SAM

E2.5  
SHEET 13 OF 20



**1 MAIN - INTERIOR PHOTOMETRIC CALCULATIONS**  
 SCALE: 1/8"=1'-0"

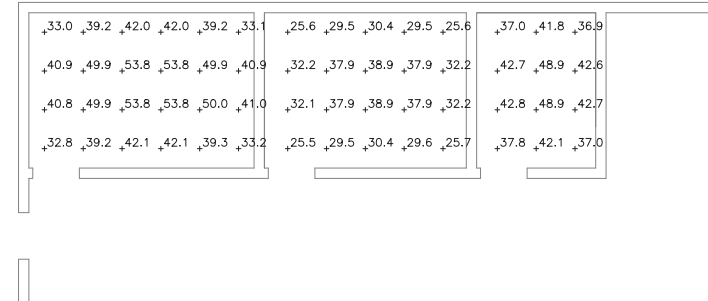

**2 NORTH ROOMS - INTERIOR PHOTOMETRIC CALCULATIONS**  
 SCALE: 1/4"=1'-0"

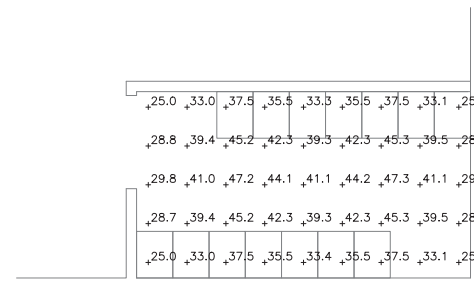

**3 ELECTRICAL ROOM PHOTOMETRIC CALCULATIONS**  
 SCALE: 1/4"=1'-0"

**SHEET NOTES**

- LUMINOUS UNITS IN FOOT CANDLES (FC).
- REFER TO CIVIL PLANS FOR BUILDING SPECIFICATIONS AND DIMENSIONS.

Colorado Springs, Co  
 5500 Tech Center Dr., Suite 100  
 Colorado Springs, CO 80919  
 www.cespa.com

FALCON AREA WATER & WASTEWATER AUTH  
 STERLING RANCH WATER TREATMENT PLANT  
 INTERIOR PHOTOMETRIC CALCULATIONS

NO.	DESCRIPTION	BY	APP.	DATE
1	FOR REVIEW	ZRP	SAM	03/24/23
2	LIGHTING UPDATES	ZRP	SAM	05/03/23
3	60% DESIGN SET	NMJ	SAM	07/19/23
4				
5				
6				
7				

PRELIMINARY

OWNER INFORMATION:  
 FALCON AREA WATER AND  
 WASTEWATER AUTHORITY  
 2138 FLYING HORSE CLUB DR.  
 COLORADO SPRINGS, CO 80921  
 CONTACT: LOREN MORELAND  
 PHONE: (719) 785-9270  
 EMAIL: LMORELAND@CLASSICHOMES.COM

PROPERTY ADDRESS:  
 9255 ARROYA LANE  
 COLORADO SPRINGS, CO 80908

PROJECT: 0395-23-01



1095 S FEDERAL WAY  
 BOISE, IDAHO 83705  
 (208) 433-9987  
 (208) 428-0550 FAX

**Control Engineers**

Proj.#: W02242.22  
 Date: 03/24/23  
 Design: NMJ/ZRP  
 Drawn: NMJ/ZRP  
 Check: SAM

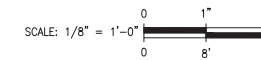

IF BAR DOES NOT MEASURE ONE INCH SCALE OF THIS DRAWING HAS BEEN ALTERED

2023/07/19 4:07 PM By: Nicholas M. Johnson\0395 IDS: Hydro\23-01 Sterling WTP\Drawing PHOTOMETRIC PLAN.dwg

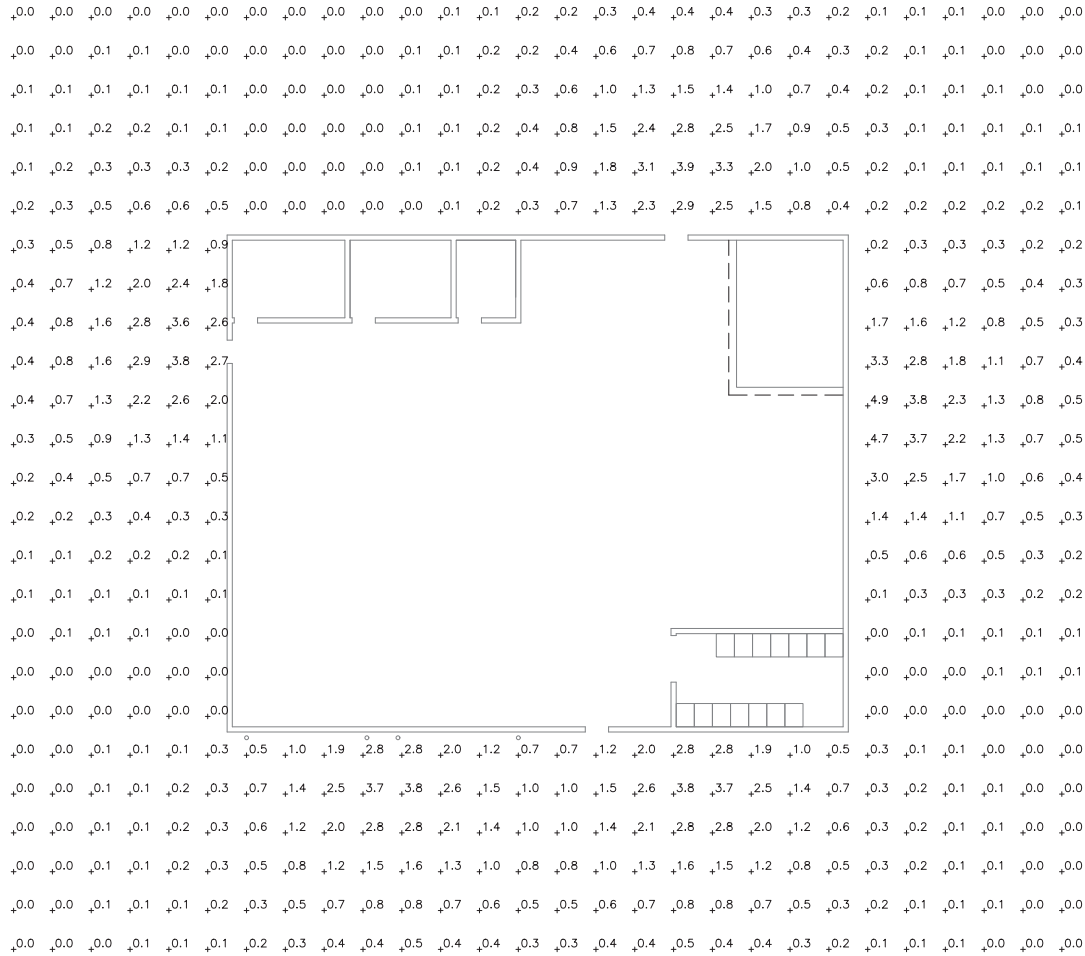

### 1 EXTERIOR PHOTOMETRIC CALCULATIONS

SCALE: 1/8"=1'-0"

### SHEET NOTES

- LUMINOUS UNITS IN FOOT CANDLES (FC).
- REFER TO CIVIL PLANS FOR BUILDING SPECIFICATIONS AND DIMENSIONS.
- EXTERIOR CALCULATIONS WERE LIMITED TO 30 FEET FROM BUILDING.

Colorado Springs, CO  
 5500 Tech Center Dr., Suite 100  
 Colorado Springs, CO 80919  
 www.cespa.com



FALCON AREA WATER & WASTEWATER AUTH  
 STERLING RANCH WATER TREATMENT PLANT  
 EXTERIOR PHOTOMETRIC CALCULATIONS

NO.	DESCRIPTION	REVISIONS		DATE
		BY	APP.	
1	FOR REVIEW	ZRP	SAM	03/24/23
2	LIGHTING UPDATES	ZRP	SAM	05/03/23
3	60% DESIGN SET	NMJ	SAM	07/19/23
4				
5				
6				
7				

PRELIMINARY

OWNER INFORMATION:  
 FALCON AREA WATER AND  
 WASTEWATER AUTHORITY  
 2138 FLYING HORSE CLUB DR.  
 COLORADO SPRINGS, CO 80921  
 CONTACT: LOREN MORELAND  
 PHONE: (719) 785-9270  
 EMAIL: LMORELAND@CLASSICHOMES.COM

PROPERTY ADDRESS:  
 9255 ARROYA LANE  
 COLORADO SPRINGS, CO 80908

PROJECT: 0395-23-01  

 1095 S FEDERAL WAY  
 BOISE, IDAHO 83705  
 (208) 433-9987  
 (208) 428-0550 FAX

Control Engineers

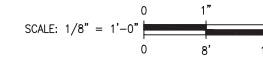

Proj.#: W02242.22  
 Date: 03/24/23  
 Design: NMJ/ZRP  
 Drawn: NMJ/ZRP  
 Check: SAM

E2.7  
 SHEET 15 OF 20

CODE	DESCRIPTION	VOLTAGE	WATTS	MAKE/MODEL	MANUFACTURER	MOUNTING	MOUNTING HEIGHT	NOTES	DRAWING
A	CPX LED PANEL 2'X2'	120-277VAC	26.59W	CPX 2X2 3200LMHE 80CRI 40K SWL 347	LITHONIA LIGHTING	CEILING	10 FT		E2.5
B	UFIT 48" LED STRIPLIGHT	120-277VAC	57.2W	UFIT L48 8000LM HEF MVOLT G210 40K 80CRI WH	LITHONIA LIGHTING	CEILING/SUSPENDED	12 FT		E2.5
C	ECC EMERGENCY EXIT COMBO LIGHT	120-277VAC	1.1W	ECC M12	LITHONIA LIGHTING	CEILING/SUSPENDED	8 FT	ABOVE DOOR	E2.5
D	ARC1 LED ARCHITECTURAL WALLPACK	120-277VAC	17.0W	ARC1 LED P2 40K MVOLT FAO	LITHONIA LIGHTING	WALLPACK	14 FT	FIELD ADJUSTABLE LIGHT OUTPUT	E2.5
E	HGX MOTION SENSING FLOOD LIGHT	120-277VAC	26.0W	HGX LED 2RH ALO SWW2 120 PIR WH	LITHONIA LIGHTING	WALLPACK	14 FT	MOTION SENSING	E2.5
F									

**1 LUMINAIRE FIXTURE SCHEDULE**  
SCALE: NONE

Colorado Springs, CO  
5500 Tech Center Dr., Suite 100  
Colorado Springs, CO 80919  
www.respac.com



FALCON AREA WATER & WASTEWATER AUTH  
STERLING RANCH WATER TREATMENT PLANT  
LIGHTING SCHEDULE

NO.	DESCRIPTION	REVISIONS		DATE
		BY	APP.	
1	FOR REVIEW	ZRP	SAM	03/24/23
2	LIGHTING UPDATES	ZRP	SAM	05/03/23
3	60% DESIGN SET	NMJ	SAM	07/19/23
4				
5				
6				
7				

PRELIMINARY

OWNER INFORMATION:  
FALCON AREA WATER AND  
WASTEWATER AUTHORITY  
2138 FLYING HORSE CLUB DR.  
COLORADO SPRINGS, CO 80921  
CONTACT: LOREN MORELAND  
PHONE: (719) 785-9270  
EMAIL: LMORELAND@CLASSICHOMES.COM

PROPERTY ADDRESS:  
9255 ARROYA LANE  
COLORADO SPRINGS, CO 80908

PROJECT: 0395-23-01  
1095 S FEDERAL WAY  
BOISE, IDAHO 83705  
(208) 433-8987  
(208) 428-0550 FAX



Control Engineers

Proj.#: W02242.22  
Date: 03/24/23  
Design: NMJ/ZRP  
Drawn: NMJ/ZRP  
Check: SAM

E3.0  
SHEET 16 OF 20

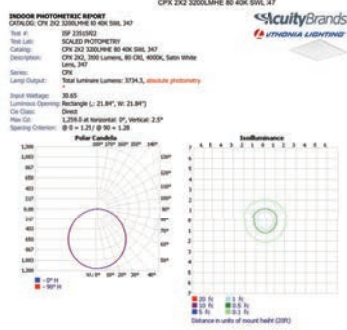

\*Not based on absolute photometry unless lamp lumens/lumen foot.  
 \*\*Self Classification and efficiency cannot be properly calculated for absolute photometry.  
 Visual Performance: Test 1.2 at 1000000 2023, Acuity Brands Lighting  
 This Performance report has been generated using methods recommended by the IESNA. Calculations are based on Photometric data provided by the manufacturer, and the data of this Performance report is dependent on the accuracy of the data provided. Data used in environmental and application calculations, but not included in report, shall be the responsibility of the manufacturer. This report is provided without warranty as to accuracy, completeness, reliability or otherwise. In no event will Acuity Brands Lighting be responsible for any loss resulting from any use of this report.  
 IGP 22002H  
 IESNA, Photometric Tools

**1 FIXTURE A PHOTMETRIC DIAGRAM**  
SCALE: NONE

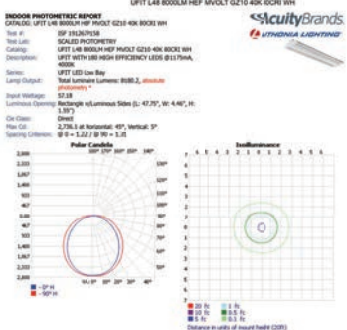

\*Not based on absolute photometry unless lamp lumens/lumen foot.  
 \*\*Self Classification and efficiency cannot be properly calculated for absolute photometry.  
 Visual Performance: Test 1.2 at 1000000 2023, Acuity Brands Lighting  
 This Performance report has been generated using methods recommended by the IESNA. Calculations are based on Photometric data provided by the manufacturer, and the data of this Performance report is dependent on the accuracy of the data provided. Data used in environmental and application calculations, but not included in report, shall be the responsibility of the manufacturer. This report is provided without warranty as to accuracy, completeness, reliability or otherwise. In no event will Acuity Brands Lighting be responsible for any loss resulting from any use of this report.  
 IGP 10000H  
 IESNA, Photometric Tools

**2 FIXTURE B PHOTMETRIC DIAGRAM**  
SCALE: NONE

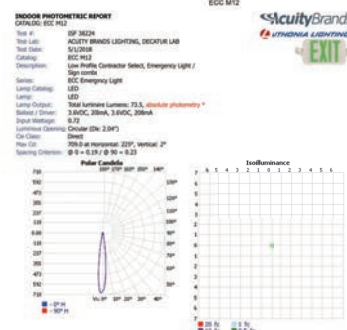

\*Not based on absolute photometry unless lamp lumens/lumen foot.  
 \*\*Self Classification and efficiency cannot be properly calculated for absolute photometry.  
 Visual Performance: Test 1.2 at 1000000 2023, Acuity Brands Lighting  
 This Performance report has been generated using methods recommended by the IESNA. Calculations are based on Photometric data provided by the manufacturer, and the data of this Performance report is dependent on the accuracy of the data provided. Data used in environmental and application calculations, but not included in report, shall be the responsibility of the manufacturer. This report is provided without warranty as to accuracy, completeness, reliability or otherwise. In no event will Acuity Brands Lighting be responsible for any loss resulting from any use of this report.  
 IGP M12A  
 IESNA, Photometric Tools

**3 FIXTURE C PHOTMETRIC DIAGRAM**  
SCALE: NONE



\*Not based on absolute photometry unless lamp lumens/lumen foot.  
 \*\*Self Classification and efficiency cannot be properly calculated for absolute photometry.  
 Visual Performance: Test 1.2 at 1000000 2023, Acuity Brands Lighting  
 This Performance report has been generated using methods recommended by the IESNA. Calculations are based on Photometric data provided by the manufacturer, and the data of this Performance report is dependent on the accuracy of the data provided. Data used in environmental and application calculations, but not included in report, shall be the responsibility of the manufacturer. This report is provided without warranty as to accuracy, completeness, reliability or otherwise. In no event will Acuity Brands Lighting be responsible for any loss resulting from any use of this report.  
 IGP 20000H  
 IESNA, Photometric Tools

**4 FIXTURE D PHOTMETRIC DIAGRAM**  
SCALE: NONE

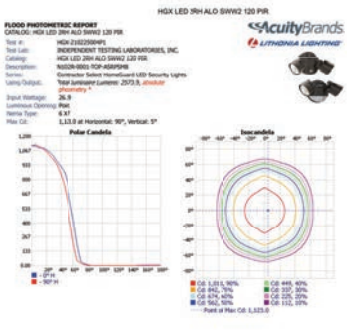

\*Not based on absolute photometry unless lamp lumens/lumen foot.  
 \*\*Self Classification and efficiency cannot be properly calculated for absolute photometry.  
 Visual Performance: Test 1.2 at 1000000 2023, Acuity Brands Lighting  
 This Performance report has been generated using methods recommended by the IESNA. Calculations are based on Photometric data provided by the manufacturer, and the data of this Performance report is dependent on the accuracy of the data provided. Data used in environmental and application calculations, but not included in report, shall be the responsibility of the manufacturer. This report is provided without warranty as to accuracy, completeness, reliability or otherwise. In no event will Acuity Brands Lighting be responsible for any loss resulting from any use of this report.  
 IGP 200000H  
 IESNA, Photometric Tools

**5 FIXTURE E PHOTMETRIC DIAGRAM**  
SCALE: NONE

Colorado Springs, CO  
 5500 Tech Center Dr., Suite 100  
 Colorado Springs, CO 80919  
 www.cespa.com

FALCON AREA WATER & WASTEWATER AUTH  
 STERLING RANCH WATER TREATMENT PLANT  
 MANUFACTURER FIXTURE DATA

NO.	REVISIONS	DATE
1	FOR REVIEW	03/24/23
2	LIGHTING UPDATES	05/03/23
3	60K DESIGN SET	07/19/23
4		
5		
6		
7		

PRELIMINARY

**OWNER INFORMATION:**  
 FALCON AREA WATER AND  
 WASTEWATER AUTHORITY  
 2138 FLYING HORSE CLUB DR.  
 COLORADO SPRINGS, CO 80921  
 CONTACT: LOREN MORELAND  
 PHONE: (719) 785-9270  
 EMAIL: LMORELAND@CLASSICHOMES.COM

**PROPERTY ADDRESS:**  
 9255 ARROYA LANE  
 COLORADO SPRINGS, CO 80908  
 PROJECT: 0395-23-01

Control Engineers

Proj #: W02242.22  
 Date: 03/24/23  
 Design: NMJ/ZRP  
 Drawn: NMJ/ZRP  
 Check: SAM