

PRAIRIERIDGE FILING NO. 1

A PORTION OF THE SOUTHWEST QUARTER OF SECTION 28 AND THE NORTHWEST QUARTER OF SECTION 33, TOWNSHIP 12 SOUTH, RANGE 65 WEST OF THE SIXTH PRINCIPAL MERIDIAN, EL PASO COUNTY, STATE OF COLORADO

RR-2.5 Rezone Map

REZONE EXHIBIT

NOVEMBER 2023

2024 and month

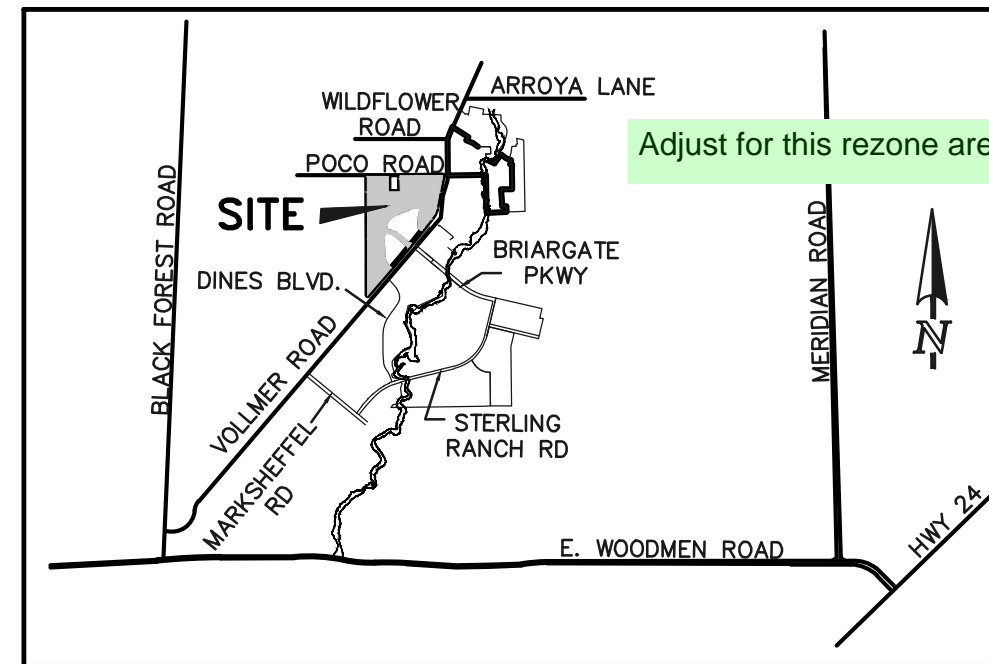

VICINITY MAP
N.T.S.

SITE DATA

TAX ID NUMBERS: PORTION OF 52280-00-024 & 52280-00-025
 SKETCH PLAN: SKP 22-225 **SKP-22-005**
 CURRENT ZONING: RR-5
 PROPOSED ZONING: RR-2.5
 TOTAL AREA: 108.89 ACRES
 REZONE AREA (RR-2.5): 17.25 ACRES

Rezone Map to include the following elements, as appropriate:		
1	Boundary description of the subject property, which shall illustrate the legal description	Completed
2	Existing land uses and zoning on the property and within five hundred (500) feet of the boundary	Need
3	Adjoining property ownership	Need to south and east, west
4	Existing private roads	private roads completed
5	Existing structures	Need Existing
6	Existing easements	Structures/easements
7	Name and address of the petitioner, owners of all interests (including mineral interests), in the property, and preparer	Completed

Parcel A
LEGAL DESCRIPTION
 A PARCEL OF LAND BEING LOCATED IN A PORTION OF THE SOUTHWEST QUARTER OF SECTION 28, TOWNSHIP 12 SOUTH, RANGE 65 WEST OF THE SIXTH PRINCIPAL MERIDIAN, EL PASO COUNTY, COLORADO, BEING MORE PARTICULARLY DESCRIBED AS FOLLOWS:
 BASIS OF BEARINGS: THE SOUTH LINE OF THE SOUTHEAST QUARTER OF THE NORTHEAST QUARTER OF SECTION 28, TOWNSHIP 12 SOUTH, RANGE 65 WEST OF THE SIXTH PRINCIPAL MERIDIAN, BEING MONUMENTED AT THE WEST END WHICH IS THE SOUTHWEST CORNER OF THE SOUTHEAST QUARTER OF THE NORTHEAST QUARTER OF SAID SECTION 28, BY A 3-1/4" ALUMINUM SURVEYORS CAP STAMPED "ESI PLS 10376, 2006" AND AT THE EAST END, WHICH IS A 30" WITNESS CORNER TO THE EAST OF THE EAST QUARTER CORNER OF SAID SECTION 28, BY A 3-1/4" ALUMINUM SURVEYORS CAP STAMPED "ESI 10376, 2006", IS ASSUMED TO BEAR N89°08'28"E, A DISTANCE OF 1326.68 FEET.
COMMENCING AT THE CENTER-EAST 1/16 CORNER OF SAID SECTION 28, TOWNSHIP 12 SOUTH, RANGE 65 WEST OF THE SIXTH PRINCIPAL MERIDIAN, EL PASO COUNTY, COLORADO;
 THENCE S83°37'56"W, A DISTANCE OF 62.10 FEET TO A POINT ON THE NORTH LINE OF THE SOUTH HALF OF SECTION 28 SAID POINT BEING THE NORTHEASTERLY CORNER OF LAND SURVEY PLAT RECORDED UNDER RECEPTION NO. 211900027;
 THENCE S89°13'54"W, ON SAID LINE, A DISTANCE OF 2575.04 FEET TO A POINT ON THE WEST LINE OF THE EAST HALF OF THE SOUTHWEST QUARTER OF SAID SECTION 28 TO THE **POINT OF BEGINNING**;
 THENCE N89°13'54"E, ON SAID NORTH LINE OF THE SOUTH HALF OF SECTION 28, A DISTANCE OF 717.48 FEET TO THE WEST LINE OF LOT 1 OF JAYNES SUBDIVISION RECORDED IN PLAT BOOK X-3 AT PAGE 96;
 THENCE S00°46'12"E, ON SAID WESTERLY LINE, A DISTANCE OF 544.44 FEET TO THE SOUTHWESTERLY CORNER OF SAID LOT 1;
 THENCE S89°43'27"W, A DISTANCE OF 722.15 FEET TO A POINT ON THE SAID WEST LINE OF THE EAST HALF OF THE SOUTHWEST QUARTER OF SAID SECTION 28;
 THENCE N00°16'33"W, ON SAID WEST LINE, A DISTANCE OF 538.25 FEET TO THE **POINT OF BEGINNING**.
 THE DESCRIPTION ABOVE PRODUCES A CALCULATED AREA OF 389,662 SQUARE FEET, (8.94541 ACRES) OF LAND MORE OR LESS AND IS DEPICTED ON THE ATTACHED GRAPHICAL EXHIBIT FOR REFERENCE.

Parcel B
LEGAL DESCRIPTION
 A PARCEL OF LAND BEING LOCATED IN A PORTION OF THE SOUTH HALF OF SECTION 28, TOWNSHIP 12 SOUTH, RANGE 65 WEST OF THE SIXTH PRINCIPAL MERIDIAN, EL PASO COUNTY, COLORADO, BEING A PORTION OF LAND SURVEY PLAT RECORDED UNDER RECEPTION NO. 211900027, BEING MORE PARTICULARLY DESCRIBED AS FOLLOWS:
 BASIS OF BEARINGS: THE SOUTH LINE OF THE SOUTHEAST QUARTER OF THE NORTHEAST QUARTER OF SECTION 28, TOWNSHIP 12 SOUTH, RANGE 65 WEST OF THE SIXTH PRINCIPAL MERIDIAN, BEING MONUMENTED AT THE WEST END WHICH IS THE SOUTHWEST CORNER OF THE SOUTHEAST QUARTER OF THE NORTHEAST QUARTER OF SAID SECTION 28, BY A 3-1/4" ALUMINUM SURVEYORS CAP STAMPED "ESI PLS 10376, 2006" AND AT THE EAST END, WHICH IS A 30" WITNESS CORNER TO THE EAST OF THE EAST QUARTER CORNER OF SAID SECTION 28, BY A 3-1/4" ALUMINUM SURVEYORS CAP STAMPED "ESI 10376, 2006", IS ASSUMED TO BEAR N89°08'28"E, A DISTANCE OF 1326.68 FEET.
COMMENCING AT THE CENTER-EAST 1/16 CORNER OF SAID SECTION 28, TOWNSHIP 12 SOUTH, RANGE 65 WEST OF THE SIXTH PRINCIPAL MERIDIAN, EL PASO COUNTY, COLORADO;
 THENCE S83°37'56"W, A DISTANCE OF 62.10 FEET TO A POINT ON THE NORTH LINE OF THE SOUTH HALF OF SECTION 28 SAID POINT BEING THE NORTHEASTERLY CORNER OF LAND SURVEY PLAT RECORDED UNDER RECEPTION NO. 211900027 SAID POINT BEING ALSO IN THE WESTERLY RIGHT OF WAY LINE OF VOLLMER ROAD SAID POINT BEING THE **POINT OF BEGINNING**;
 THENCE ON SAID WESTERLY RIGHT OF WAY LINE THE FOLLOWING TWO (2) COURSES:
 1. THENCE S09°36'29"W, A DISTANCE OF 114.58 FEET;
 2. THENCE S11°14'07"W, A DISTANCE OF 89.25 FEET;
 THENCE S89°13'54"W, A DISTANCE OF 1,178.37 FEET;
 THENCE S00°46'54"E, A DISTANCE OF 228.70 FEET;
 THENCE S32°23'37"W, A DISTANCE OF 63.56 FEET;
 THENCE S68°55'19"W, A DISTANCE OF 180.00 FEET;
 THENCE S89°13'29"W, A DISTANCE OF 36.40 FEET TO THE EASTERLY BOUNDARY OF LOT 1 OF JAYNES SUBDIVISION RECORDED IN PLAT BOOK X-3 AT PAGE 96;
 THENCE N00°46'54"W, ON SAID EASTERLY BOUNDARY, A DISTANCE OF 544.39 FEET TO THE SAID NORTH LINE OF THE SOUTH HALF OF SECTION 28;
 THENCE N89°13'54"E, ON SAID NORTH LINE, A DISTANCE OF 1,457.61 FEET TO THE **POINT OF BEGINNING**.
 THE DESCRIPTION ABOVE PRODUCES A CALCULATED AREA OF 362,027 SQUARE FEET, (8.31100 ACRES) OF LAND MORE OR LESS AND IS DEPICTED ON THE ATTACHED GRAPHICAL EXHIBIT FOR REFERENCE.

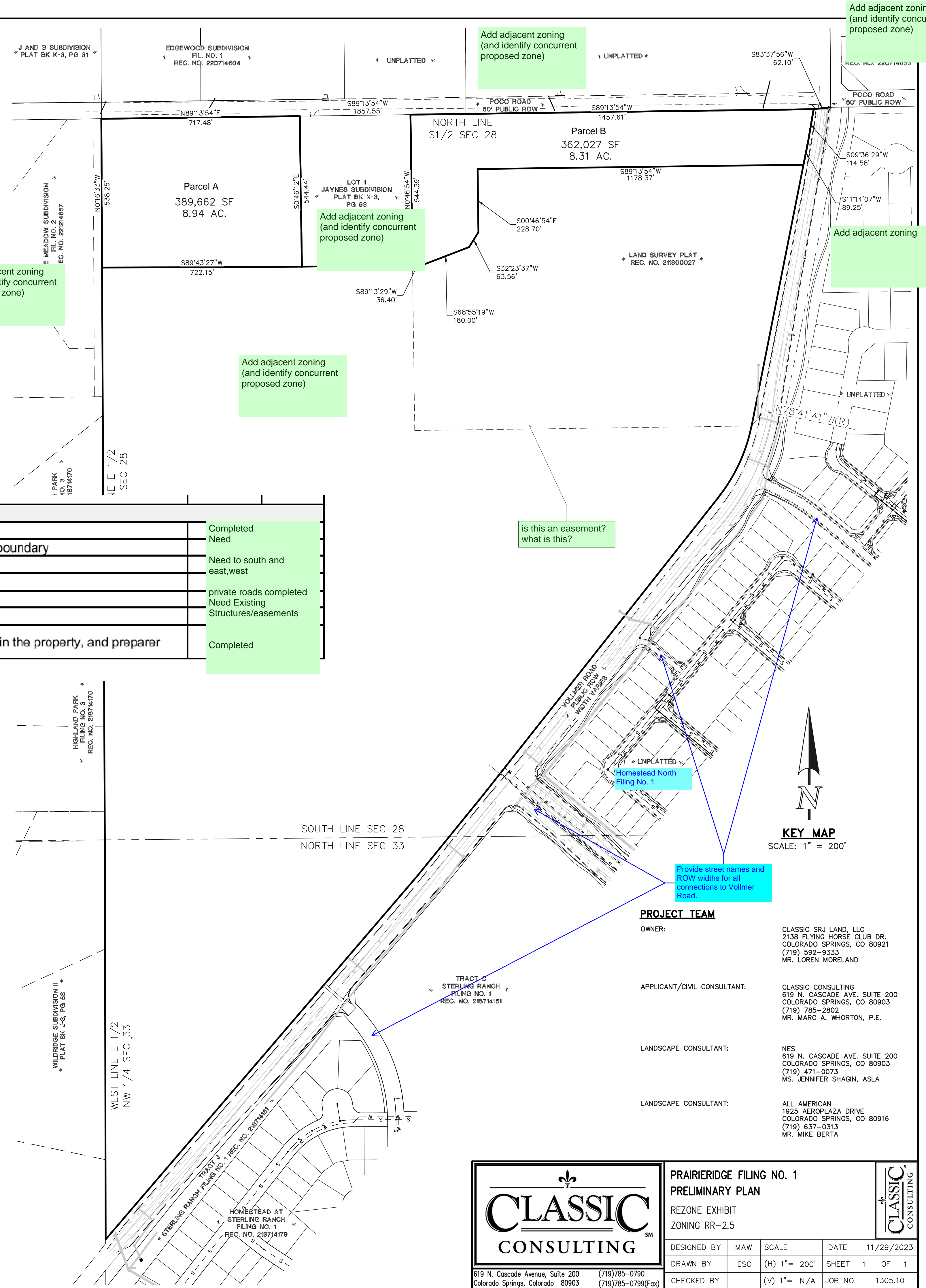

is this an easement?
what is this?

Provide street names and ROW widths for all connections to Vollmer Road.

PROJECT TEAM
 OWNER: CLASSIC SRJ LAND, LLC
 2138 FLYING HORSE CLUB DR.
 COLORADO SPRINGS, CO 80921
 (719) 592-9333
 MR. LOREN MORELAND
 APPLICANT/CIVIL CONSULTANT: CLASSIC CONSULTING
 619 N. CASCADE AVE., SUITE 200
 COLORADO SPRINGS, CO 80903
 (719) 785-2802
 MR. MARC A. WHORTON, P.E.
 LANDSCAPE CONSULTANT: NES
 619 N. CASCADE AVE., SUITE 200
 COLORADO SPRINGS, CO 80903
 (719) 471-0073
 MS. JENNIFER SHAGIN, ASLA
 LANDSCAPE CONSULTANT: ALL AMERICAN
 1925 AEROPAZA DRIVE
 COLORADO SPRINGS, CO 80916
 (719) 637-0313
 MR. MIKE BERTA

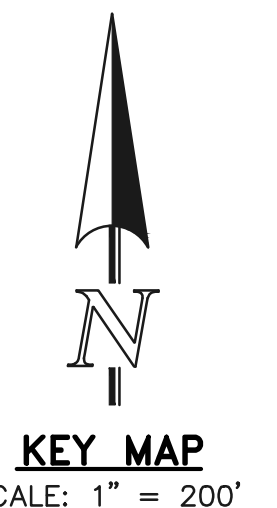

619 N. Cascade Avenue, Suite 200
Colorado Springs, Colorado 80903

PRAIRIERIDGE FILING NO. 1
PRELIMINARY PLAN
 REZONE EXHIBIT
 ZONING RR-2.5

DESIGNED BY	MAW	SCALE	DATE	11/29/2023
DRAWN BY	ESO	(H) 1" = 200'	SHEET	1 OF 1
CHECKED BY	(V) 1" = N/A	JOB NO.	1305.10	

V1_Zoning Map R1 comments.pdf Markup Summary

CDurham (3)

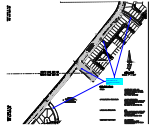

Subject: Callout
Page Label: [1] Layout1
Author: CDurham
Date: 1/22/2024 9:24:11 AM
Status:
Color: ■
Layer:
Space:

Provide street names and ROW widths for all connections to Vollmer Road.



Subject: Text Box
Page Label: [1] Layout1
Author: CDurham
Date: 1/22/2024 9:24:25 AM
Status:
Color: ■
Layer:
Space:

Homestead North Filing No. 1

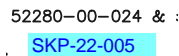

Subject: Text Box
Page Label: [1] Layout1
Author: CDurham
Date: 1/22/2024 9:24:39 AM
Status:
Color: ■
Layer:
Space:

SKP-22-005

dspdparsons (14)

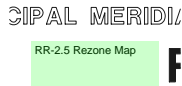

Subject: Planner
Page Label: [1] Layout1
Author: dspdparsons
Date: 1/24/2024 9:48:25 AM
Status:
Color: ■
Layer:
Space:

RR-2.5 Rezone Map



Subject: Planner
Page Label: [1] Layout1
Author: dspdparsons
Date: 1/24/2024 9:48:29 AM
Status:
Color: ■
Layer:
Space:

—



Subject: Planner
Page Label: [1] Layout1
Author: dspdparsons
Date: 1/24/2024 9:48:32 AM
Status:
Color: ■
Layer:
Space:

—

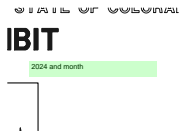

Subject: Planner
Page Label: [1] Layout1
Author: dsdparsons
Date: 1/24/2024 9:48:44 AM
Status:
Color: ■
Layer:
Space:

2024 and month

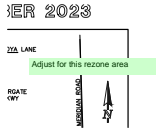

Subject: Planner
Page Label: [1] Layout1
Author: dsdparsons
Date: 1/24/2024 9:49:07 AM
Status:
Color: ■
Layer:
Space:

Adjust for this rezone area

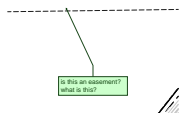

Subject: Planner
Page Label: [1] Layout1
Author: dsdparsons
Date: 1/24/2024 9:55:44 AM
Status:
Color: ■
Layer:
Space:

is this an easement? what is this?

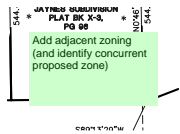

Subject: Planner
Page Label: [1] Layout1
Author: dsdparsons
Date: 1/24/2024 9:50:58 AM
Status:
Color: ■
Layer:
Space:

Add adjacent zoning (and identify concurrent proposed zone)

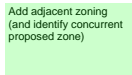

Subject: Planner
Page Label: [1] Layout1
Author: dsdparsons
Date: 1/24/2024 9:51:05 AM
Status:
Color: ■
Layer:
Space:

Add adjacent zoning (and identify concurrent proposed zone)

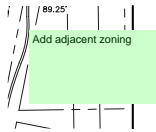

Subject: Planner
Page Label: [1] Layout1
Author: dsdparsons
Date: 1/24/2024 9:51:18 AM
Status:
Color: ■
Layer:
Space:

Add adjacent zoning

Add adjacent zoning
(and identify concurrent
proposed zone)

E AREA
REG. IN

Subject: Planner
Page Label: [1] Layout1
Author: dsdparsons
Date: 1/24/2024 9:51:21 AM
Status:
Color: ■
Layer:
Space:

Add adjacent zoning (and identify concurrent proposed zone)

Add adjacent zoning
(and identify concurrent
proposed zone)

POGO ROAD
NOT IN ROW
589

Subject: Planner
Page Label: [1] Layout1
Author: dsdparsons
Date: 1/24/2024 9:51:30 AM
Status:
Color: ■
Layer:
Space:

Add adjacent zoning (and identify concurrent proposed zone)

Add adjacent zoning
(and identify concurrent
proposed zone)

TRUCK TRAIL
589

Subject: Planner
Page Label: [1] Layout1
Author: dsdparsons
Date: 1/24/2024 9:51:37 AM
Status:
Color: ■
Layer:
Space:

Add adjacent zoning (and identify concurrent proposed zone)



Subject: Image
Page Label: [1] Layout1
Author: dsdparsons
Date: 1/24/2024 9:54:00 AM
Status:
Color: ■
Layer:
Space:

SW 1/4
Completed
Need
Need to south and east side
Private roads completed
Need Existing Structures/easements
Completed

Subject: Planner
Page Label: [1] Layout1
Author: dsdparsons
Date: 1/24/2024 9:55:41 AM
Status:
Color: ■
Layer:
Space:

Completed
Need
Need to south and east,west
private roads completed
Need Existing Structures/easements
Completed