

EXISTING LAND USE:

Vacant / grazing

CURRENT ZONING:

A-35 (Agricultural)

PROPOSED ZONING:

A-35 (Agricultural) Approval of Location and Subdivision Exemption Plat applications have been submitted concurrently with Development Plan

PLACETYPE:

'Large-Lot Residential' (Immediately adjacent to 'Employment Center' [Your El Paso County Master Plan 2021])

PROPOSED LAND USE DATA TABLE:

LAND USE:	GROSS AREA:	ACREAGE:	NET AREA:	NET ACREAGE:
Water Treatment Facility	85,813sf	1.97ac	72,838sf	1.67ac
Vocational Education Campus	1,094,227sf	25.12ac	989,066sf	22.70ac
Campus Residential	1,094,644sf	24.90ac	896,692sf	20.35ac
Open Space Tract A	316,245sf	7.26ac	316,245sf	7.26ac
Open Space Tract B	320,166sf	7.35ac	316,110sf	7.25ac
Open Space Tract C	183,823sf	4.22ac	175,412sf	4.02ac
Open Space Tract D	213,444sf	4.90ac	114,008sf	2.61ac
Electric Transmission Easement	464,350sf	10.66ac	464,350sf	10.66ac
Street R.O.W.	included	included	427,991sf	9.86ac
TOTAL:	3,762,712sf	86.38ac	3,762,712sf	86.38ac

*all numbers rounded

PROPOSED LAND USES:

- A. Water Treatment Facility (developed and owned by PPBOCES)
- Vocational Education Building
- B. Construction Trades Training Facility (carpentry, plumbing, electrical)
- C. Law Enforcement Training facility (in conjunction with the El Paso County Sheriff department)
- D. Fire Fighting and Protection Training facility (in conjunction with the Peyton and Falcon Fire Protection Districts)
- E. Medical Training facility (EMT/paramedic training)
- F. Food Services facility (Culinary Arts)
- G. Meat Processing facility
- H. Veterinary Sciences Training facility (Animal husbandry)
- I. Information Technology facility (Computer Sciences and website development)
- J. Horticultural Sciences Training facilities (Greenhouse management, Aquaponics, and Turf Grass Management)
- K. Other Vocational Education training facilities based upon future needs of the community
- L. Workforce/Campus Housing for PPBOCES teachers, instructors, and member District staff.

ADJACENT LAND OWNERS:

- | | | | |
|----------|--|----------|--|
| PLAN KEY | OWNER/TSN | PLAN KEY | OWNER/TSN |
| ① | Jane Davis Living Trust
9060 Elbert Road
Peyton, CO 80831-8319
TSN 4200000470 | ⑦ | Brent Houser Enterprises, LLC
11890 Garrett Road
Peyton, CO 80831-7685
TSN 4300000537 |
| ② | Thomas J. Elliott
8995 Elbert Road
Peyton, CO 80831-8318
TSN 4200000245 | ⑧ | Gorilla Capital
1342 High Street
Eugene, OR 97401
TSN 4300000335 |
| ③ | Tyler Ayers
8127 Burl Wood Drive
Colorado Springs, CO 80808
TSN 4200000437 | ⑨ | Adam C. Moody
16365 Judge Orr Road
Peyton, CO 80831
TSN 4300000568 |
| ④ | Michael Lockhart
4133 Knollvale Drive
Colorado Springs, CO 80922
TSN 4200000362 | ⑩ | David Fitzpatrick 16525 Judge Orr Road
Peyton, CO 4300000569 |
| ⑤ | Andrew Townsend
16360 Judge Orr Road
Peyton, CO 80831
TSN 4200000454 | | |
| ⑥ | Brent Houser Enterprises, LLC
11890 Garrett Road
Peyton, CO 80831-7685
TSN 4300000534 | | |

UTILITY PROVIDERS:

- A. Water (domestic, fire protection); Central water system. Pikes Peak Board of Cooperative Education Services [PPBOCES] water district.
- B. Sanitary / wastewater; Median Service Metropolitan District (Will Serve letter provided with Development Plan application).
- C. Electric; Mountain View Electric Association [MVEA] (Will Serve letter provided with Development Plan application).
- D. Natural Gas; Black Hills Energy | Colorado Springs Utilities [CSU] (Will Serve letters provided with Development Plan application).

PIKES PEAK BOCES

PLOT PLAN

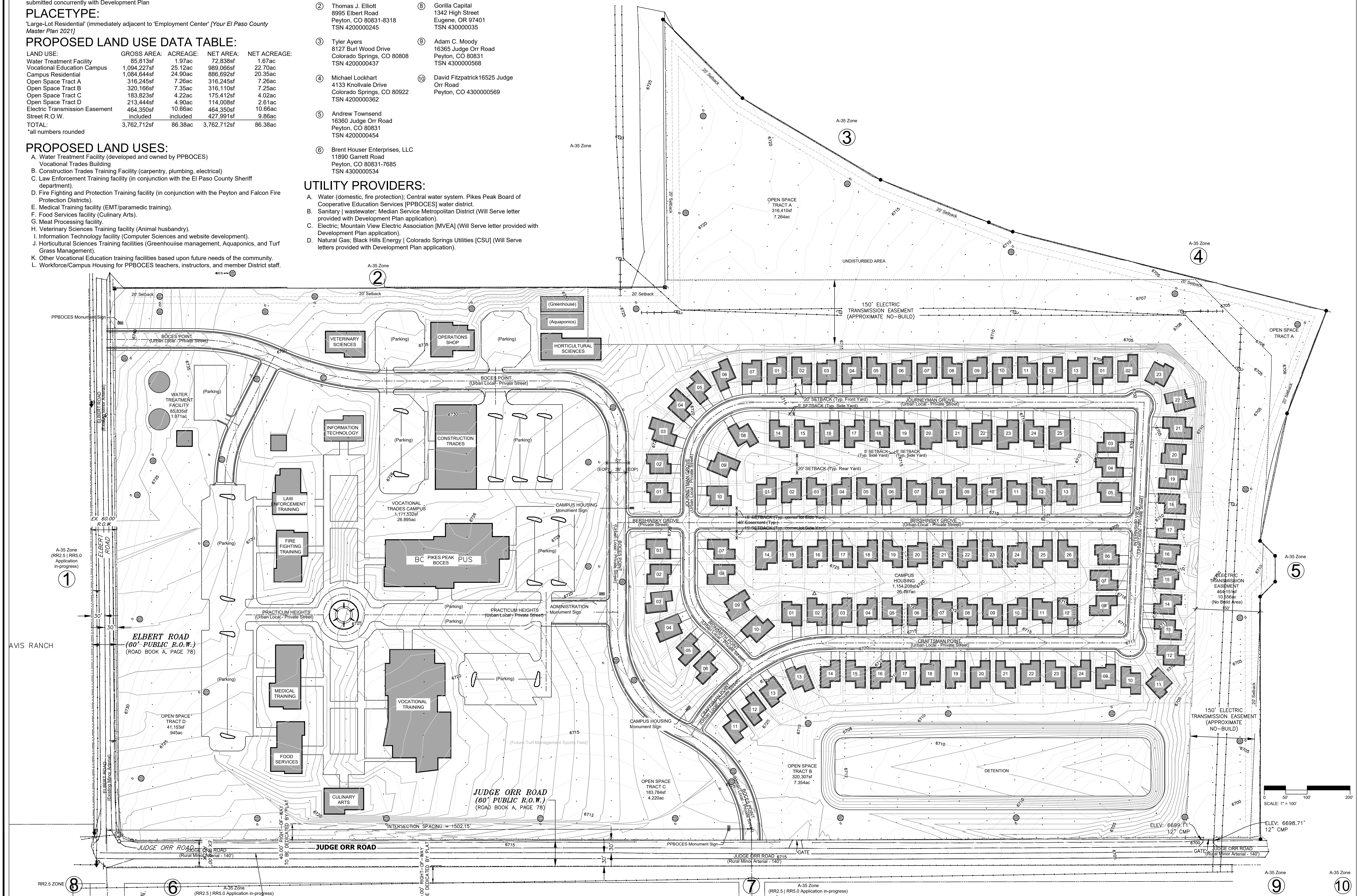

THIS DRAWING IS AN INSTRUMENT OF SERVICE AND IS NOT BEING USED FOR ANY OTHER PURPOSE. THE CLIENT IS RESPONSIBLE FOR OBTAINING ALL NECESSARY PERMITS AND APPROVALS FROM THE APPROPRIATE AGENCIES. THE CLIENT IS RESPONSIBLE FOR OBTAINING ALL NECESSARY PERMITS AND APPROVALS FROM THE APPROPRIATE AGENCIES. THE CLIENT IS RESPONSIBLE FOR OBTAINING ALL NECESSARY PERMITS AND APPROVALS FROM THE APPROPRIATE AGENCIES.

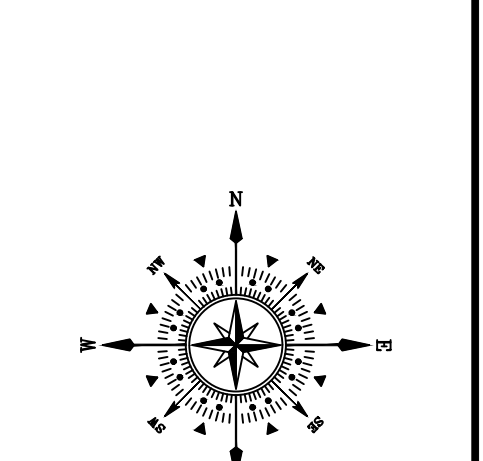

PLAN NORTH:

PROJECT NAME: Pikes Peak BOCES Board of Cooperative Educational Services

PROJECT ADDRESS: Judge Orr Road Peyton, CO 80831

PROJECT DESCRIPTION: Plot Plan

DATE:	02/21/2024
DESIGNED BY:	WFG
CHECKED:	

REVISIONS:	DATE:	BY:	DESCRIPTION:
	02/21/2024	WFG	REVISED PHASE 2 & 3 LIMITS
	02/27/2024	WFG	REVISED PHASING AND LAYOUT PLAN

PLAN SCALE: 1" = 100' (OR AS NOTED ON PLAN)

SHEET TITLE: PLOT PLAN

SHEET NO.: PP1.1

2 OF 2 SHEETS

FILE NO.: FILE#