

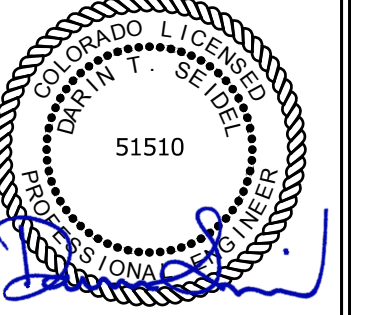

FREDDY'S FROZEN CUSTARD
7575 FALCON MARKETPLACE
FALCON, CO.

2/21/2022



DAN WINTER
ARCHITECT
1024 EAST
FIRST STREET
WICHITA, KS.
67214
PH. 316-267-7142

ELECTRICAL
 SITE PLAN

DATE
01/27/2022
 REV 1 - 02/17/22

DRAWN BY:
SM/MS
 CHECKED BY:
DS/EK

SHEET NO.
E-5

SITE ELECTRICAL PLAN NOTES

- 1 CONNECT TO MENU BOARD AND PRE-SELL BOARD PER MANUFACTURER'S INSTRUCTIONS. ONE CIRCUIT THRU TIMECLOCK AND ONE CIRCUIT UNSWITCHED FOR SPEAKER POST. REFER TO KEYNOTE 29 ON SHEET E1.
- 2 RECEPTACLE FOR OCB. MOUNT WEATHERPROOF DUPLEX INSIDE POST AT +24". CONDUIT TO BE RUN INSIDE POST.
- 3 PROPOSED PAD-MOUNTED TRANSFORMER - SEE ELECTRICAL RISER DIAGRAM ON SHEET E4. COORDINATE EXACT LOCATION WITH LOCAL UTILITY COMPANY.
- 4 SECONDARY CONDUCTORS FROM TRANSFORMER. SEE RISER DIAGRAM ON SHEET E4.
- 5 4" C FOR PRIMARY CABLES BY UTILITY COMPANY. COORDINATE ROUTING & TERMINATION POINT WITH LOCAL SERVICE PROVIDER.
- 6 (2)2" C TO PROPERTY FOR TELEPHONE SERVICE. TERMINATE AT LOCATION DIRECTED BY LOCAL SERVICE PROVIDER.
- 7 ROUTE CIRCUIT TO PANEL INDICATED VIA EXTERIOR LIGHTING CONTROLS. SEE DETAIL ON SHEET E2.
- 8 NOT USED.
- 9 NOT USED.
- 10 LOCATION OF FLAG POLE AND IN-GROUND LIGHTING. REFER TO SHEET E2 FOR LIGHTING CIRCUITING AND CONTROLS.

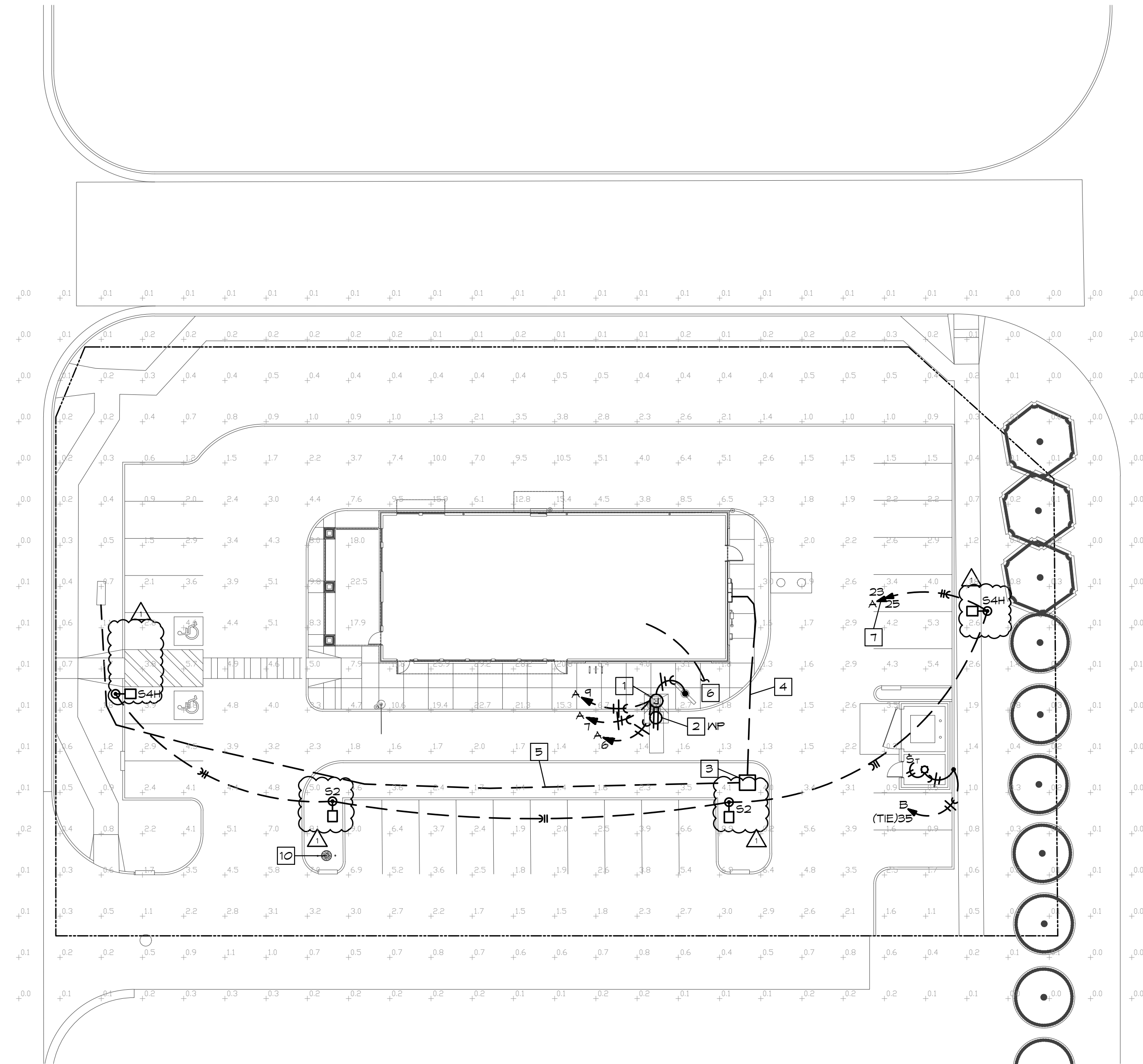

ELECTRICAL SITE PLAN
 SCALE: 1"=20'
 NORTH

STATISTICAL AREA SUMMARY

AREA	AVG FC	MAX FC	MIN FC	MAX/MIN	AVG/MIN
PARKING	4.0	10.2	0.4	25.5:1	10.0:1

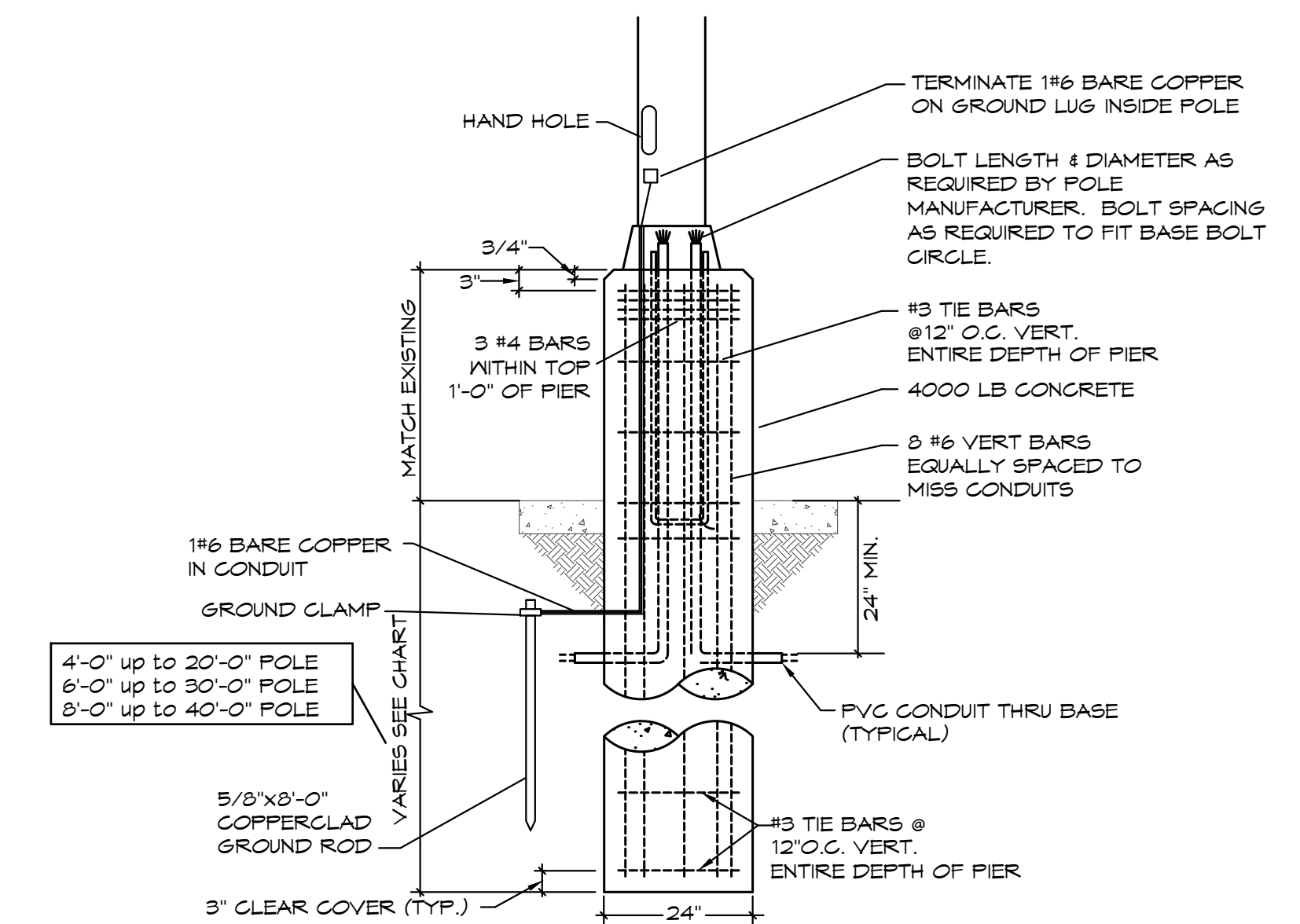

POLE FOUNDATION DETAIL
 SCALE: NONE

BC PROJECT #: 21959

This drawing has been prepared by the Engineer, or under his supervision. This drawing is provided as an instrument of service by the Designer/Engineer and is intended for use on the project only. Pursuant to the Architectural/Professional Regulation Act of 2000, all drawings, specifications, plans and designs, including the overall form, arrangement and composition of spaces and elements according to levels, constitute the original, copyrighted work of the Designer/Engineer. Any reproduction, use, or disclosure of information contained herein without prior written consent of the Engineer is strictly prohibited. © 2021 BC Engineers, Inc.

BC ENGINEERS
INCORPORATED
 5720 Reeder Shawnee, Ks. 66203 (913)262-1772