

2290 OLD RANCH ROAD

LOTS 8, BLOCK E, AMENDED FILING OF SPRINGS CREST SUBDIVISION
NW 1/4, SEC. 28, T.12 S., R. 66 W OF THE 6TH P.M.
COUNTY OF EL PASO, STATE OF COLORADO

GRADING LEGEND

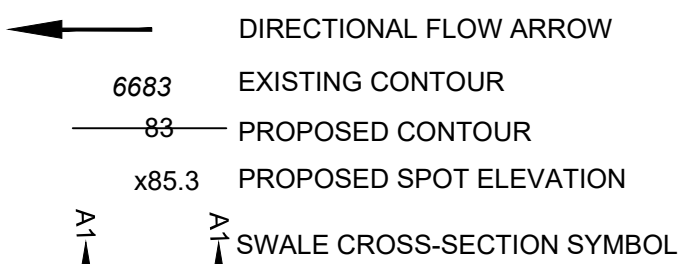

NOTE: THERE WILL BE NO DEDICATED ASPHALT/CONCRETE BATCH PLANTS.

LEGEND

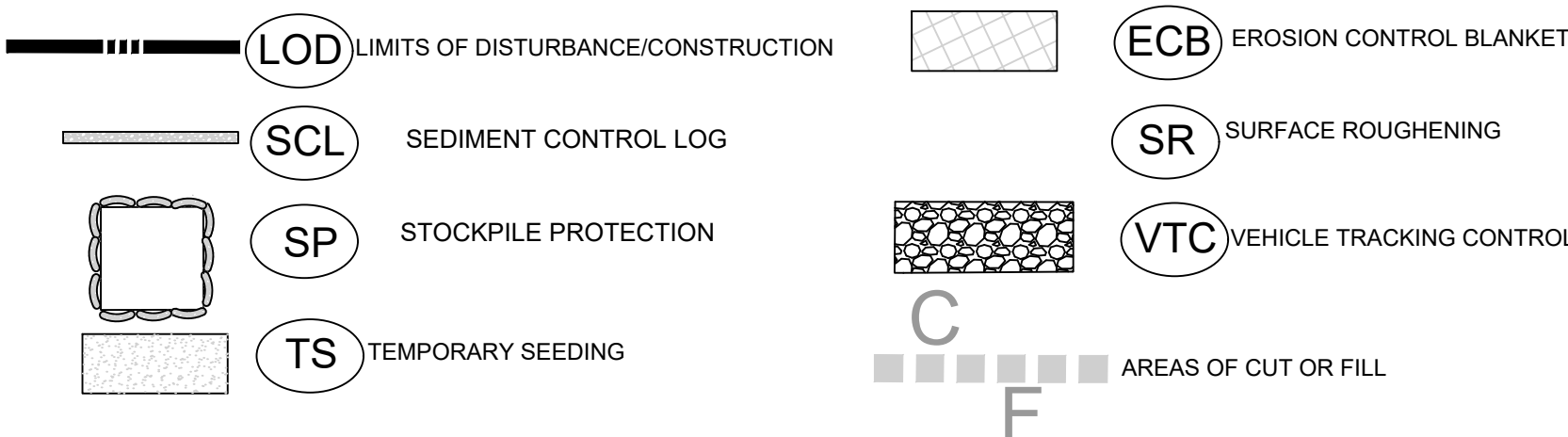
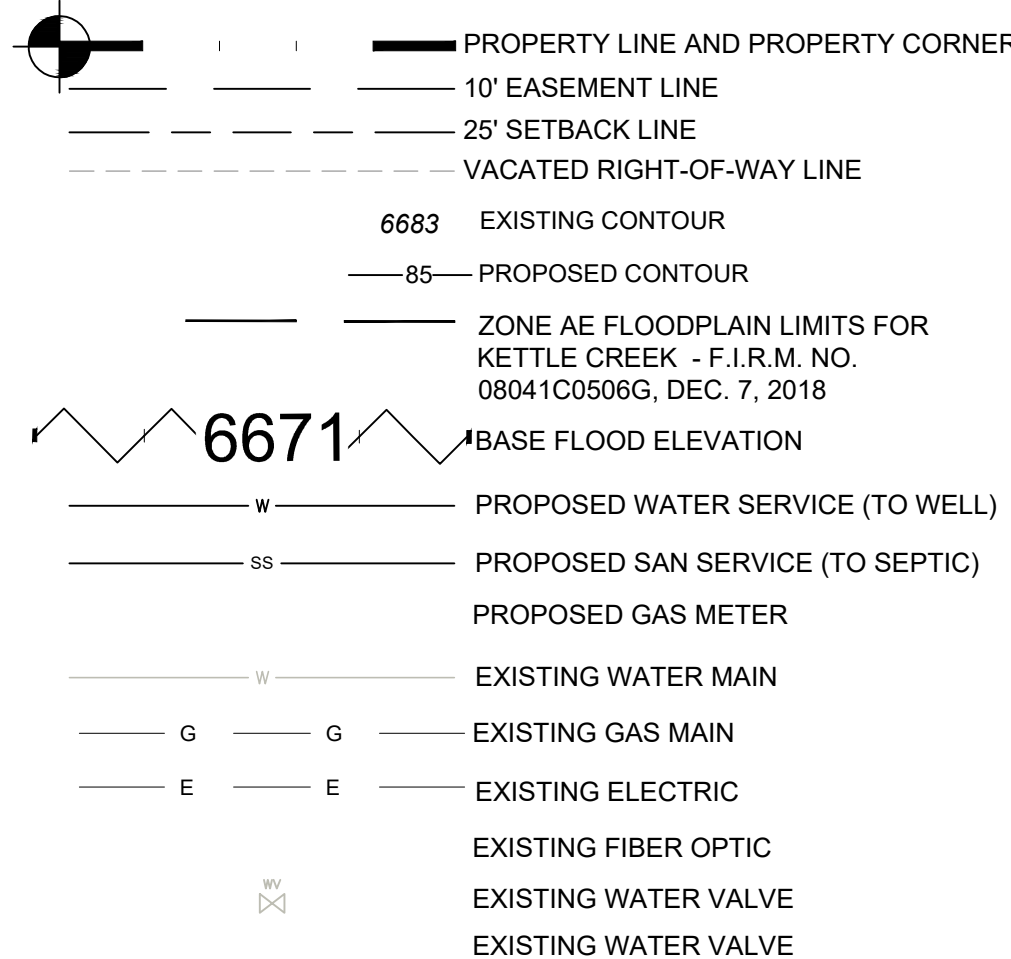

DISTURBED AREA

37,740 SF = 0.87AC.
38,345 SF = 0.88AC.

PENDLETON SUBDIVISION
PARCEL: 6228001007

AMD. FILING SPRING CREST SUBDIVISION
PARCEL: 6228005038

AMD. FILING SPRING CREST SUBDIVISION
PARCEL: 62280050338

Approved

By: Gilbert LaForce, P.E.
Engineering Manager

Date: 05/02/2025 8:54:41 AM
El Paso County Department of Public Works

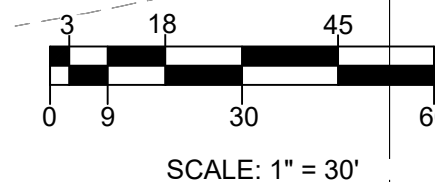

BEFORE YOU DIG
CALL UTILITY NOTIFICATION
CENTER OF COLORADO
811
CALL 2 BUSINESS DAYS IN ADVANCE BEFORE
YOU BEGIN ANY EXCAVATION WORK
MARKING OF UNDERGROUND MEMBER UTILITIES

NO.	DATE	BY	DESCRIPTION
1	01-15-24	CLE	COUNTY COMMENTS
2	02-12-24	CLE	COUNTY COMMENTS
3	04-07-25	CLE	CLIENT CHANGES

PREPARED BY:
TRUE WEST CO., LLC
16352 E Bates Drive
Aurora, CO 80013
303-523-3664
truewest@truewest.net

DESCRIPTION:
GRADING AND EROSION CONTROL PLAN
FERRANTI RESIDENCE
2290 OLD RANCH ROAD

ENGINEERS SEAL:



DESIGNED BY:

CLE

DRAWN BY:

CLE

CHECKED BY:

CLE

DRAWER NUMBER:

DATE:

11/02/23

SCALE:

1" = 30'

SHEET NUMBER:

2 OF 3

EPC's EDARP File Number CDR2320